



Comal County

OFFICE OF COMAL COUNTY ENGINEER

License to Operate On-Site Sewage Treatment and Disposal Facility

Issued This Date: 04/02/2019 Permit Number: 108313

Location Description: 241 LAUBACH LN  
NEW BRAUNFELS, TX 78132  
Subdivision: Herbelin Ranch  
Unit:  
Lot: 1B2  
Block:  
Acreage:

Type of System: Septic Tank  
ET Beds

Issued to: Cara B. Laubach

This license is authorization for the owner to operate and maintain a private facility at the location described in accordance to the rules and regulations for on-site sewerage facilities of Comal County, Texas, and the Texas Commission on Environmental Quality.

The license grants permission to operate the facility. It does not guarantee successful operation. It is the responsibility of the owner to maintain and operate the facility in a satisfactory manner.

Alterations to this permit including, but not limited to:

- Increase in the square feet of living area
- Increase in the number of bedrooms
- A change of use (i.e. residential to commercial)
- Relocation of system components (including the relocation of spray heads)
- Installation of landscaping
- Adding new structures to the system

may require a new permit. **It is the responsibility of the owner to apply for a new permit, if applicable.**

Inspection and licensing of a facility indicates only that the facility meets certain minimum requirements. It does not impede any governmental entity in taking the proper steps to prevent or control pollution, to abate nuisance, or to protect the public health.

This license to operate is valid for an indefinite period. The holder may transfer it to a succeeding owner, provided the facility has not been remodeled and is functioning properly.

Licensing Authority  
Comal County Environmental Health

 OS8497  
ENVIRONMENTAL HEALTH INSPECTOR

  
ENVIRONMENTAL HEALTH COORDINATOR

OS 0025599

## Contra Costa Environmental Health OSSF Inspection Sheet

Installer Name: Krause Septic      OSSF Installer #: 05 0008285  
 1st Inspection Date: 3/19/19      2nd Inspection Date: \_\_\_\_\_      3rd Inspection Date: 4/2/19  
 Inspector Name: Mike T.      Inspector Name: \_\_\_\_\_      Inspector Name: Mike T.  
 Permit #: 108313      Address: Hebelein Ranch / 241 Lanbach Ln.

Item	Code	Notes	1st Insp.	2nd Insp.	3rd Insp.
1	285.31(a) 285.30(b)(1)(A)(iv) 285.30(b)(1)(A)(v) 285.30(b)(1)(A)(vi) 285.30(b)(1)(A)(vii) 285.30(b)(1)(A)(viii)		3/19/19	3/22/19	4/2/19
2	285.91(10) 285.30(b)(4) 285.31(d)				
3	285.32(a)(1)				
4	285.32(a)(3)				
5	285.32(a)(5)				
6	285.32(b)(1)(G) 285.32(b)(1)(E)(N) 285.32(b)(1)(E)(M) 285.32(b)(1)(F) 285.32(b)(1)(D) 285.32(b)(1)(C)(I) 285.32(b)(1)(C)(II) 285.32(b)(1)(D) 285.32(b)(1)(E) 285.32(b)(1)(A) 285.32(b)(1)(E)(R)(II) 285.32(b)(1)(E)(I) 285.32(b)(1)(E)(M)(I)				
7	285.34(d)				

MT-3/19/19  
 Tank set, leveled  
 1) 7'8"  
 2) 8'9"  
 3' 5"  
 5' 5" 6" 7' 8"

MT-3/22/19  
 Pipe & gravel leveled.  
 1) 6'2"    2) 7'5"  
 Ready For Cover

MT-4/2/19  
 Covered.

**Comal County Environmental Health  
OSSF Inspection Sheet**

	Compliance	Code	1st Insp.	2nd Insp.	3rd Insp.	
8 SEPTIC TANK Tank(s) Clearly Marked SEPTIC TANK If Single Tank, 2 Compartments Provided with Baffle SEPTIC TANK Inlet Flowline Greater than 3" and "T" Provided on Inlet and Outlet SEPTIC TANK Septic Tank(s) Meet Minimum Requirements	✓	285.32(b)(1)(E) 285.91(2) 285.32(b)(1)(F) 285.32(b)(1)(E)(M) 285.32(b)(1)(E)(W)(M) 285.32(b)(1)(E)(W)(I) 285.32(b)(1)(E)(I) 285.32(b)(1)(D) 285.32(b)(1)(C)(B) 285.32(b)(1)(C)(I) 285.32(b)(1)(B) 285.32(b)(1)(A) 285.32(b)(1)(E)(M)		3/19/19	3/22/19	4/2/19
9 ALL TANKS installed on 4" Sand Cushion/ Proper Backfill Used	✓	285.32(b)(1)(F) 285.32(b)(1)(G) 285.34(b)				
10 SEPTIC TANK Inspection / Clean Out Port & Risers Provided on Tanks Buried Greater than 12" Sealed and Capped	✓	285.38(d)				
11 SEPTIC TANK Secondary restraint system provided SEPTIC TANK Riser permanently fastened to lid or cast into tank SEPTIC TANK Riser cap protected against unauthorized intrusions	✓	285.38(d) 285.38(e)				
12 SEPTIC TANK Tank Volume Installed	✓		1000 gal Dual			
13 PUMP TANK Volume Installed						
14 AEROBIC TREATMENT UNIT Size Installed						
15 AEROBIC TREATMENT UNIT Manufacturer AEROBIC TREATMENT UNIT Model Number						
16 DISPOSAL SYSTEM Absorptive		285.33(a)(4) 285.33(a)(1) 285.33(a)(2) 285.33(a)(3)				
17 DISPOSAL SYSTEM Leaching Chamber		285.33(a)(1) 285.33(a)(3) 285.33(a)(4) 285.33(a)(2)				
18 DISPOSAL SYSTEM Evapo-transpirative	✓	285.33(a)(3) 285.33(a)(4) 285.33(a)(1) 285.33(a)(2)	3/19/19	3/22/19	4/2/19	

**Comal County Environmental Health  
OSSF Inspection Sheet**

	Description	Amper	Classifications	Status	1st Insp.	2nd Insp.	3rd Insp.
19			285.33(a)(1) 285.33(a)(2) 285.33(a)(4) 285.33(a)(2)				
20	DISPOSAL SYSTEM Soil Substitution		285.33(d)(4)				
21	DISPOSAL SYSTEM Pumped Effluent		285.33(a)(3) 285.33(b)(1) 285.33(a)(2)				
22	DISPOSAL SYSTEM Gravelless Pipe		285.33(a)(3) 285.33(a)(2) 285.33(a)(4) 285.33(a)(1)				
23	DISPOSAL SYSTEM Mound		285.33(a)(3) 285.33(a)(1) 285.33(a)(2) 285.33(a)(4)				
24	DISPOSAL SYSTEM Other (describe) (Approved Design)		285.33(d)(6) 285.33(c)(4)				
25	DRAINFIELD Absorptive Drainline 3" PVC or 4" PVC	✓					4/2/19
26	DRAINFIELD Area Installed						
27	DRAINFIELD Level to within 1 inch per 25 feet and within 3 inches over entire excavation		285.33(b)(1)(A)(v)				
28	DRAINFIELD Excavation Width DRAINFIELD Excavation Depth DRAINFIELD Excavation Separation DRAINFIELD Depth of Porous Media DRAINFIELD Type of Porous Media						
29	DRAINFIELD Pipe and Gravel - Geotextile Fabric in Place		285.33(b)(1)(E)				
30	DRAINFIELD Leaching Chambers DRAINFIELD Chambers - Open End Plates w/Splash Plate, Inspection Port & Closed End Plates in Place (per manufacturers spec.)		285.33(c)(2)				
31	LOW PRESSURE DISPOSAL SYSTEM Adequate Trench Length & Width, and Adequate Separation Distance between Trenches		285.33(d)(1)(C)(i)				

**Comal County Environmental Health  
OSSF Inspection Sheet**

Item	Description	Response	Code	Notes	Lat. Insp.	Time Insp.	Ins. Insp.
32	<p>EFFLUENT DISPOSAL SYSTEM Utilized Only by Single Family Dwelling</p> <p>EFFLUENT DISPOSAL SYSTEM Topographic Slopes &lt; 2.0% EFFLUENT DISPOSAL SYSTEM Adequate Length of Drain Field ( 1000 Linear ft. for 2 bedrooms or Less &amp; an additional 400 ft. for each additional bedroom )</p> <p>EFFLUENT DISPOSAL SYSTEM Lateral Depth of 18 inches to 3 ft. &amp; Vertical Separation of 1ft on bottom and 2 ft. to restrictive horizon and ground water respectfully</p> <p>EFFLUENT DISPOSAL SYSTEM Lateral Drain Pipe (1.25 - 1.5" dia.) &amp; Pipe Holes ( 3/16 - 1/4" dia. Hole Size ) 5 ft. Apart</p>		<p>285.33(b)(3)(A)</p> <p>285.33(b)(3)(A)</p> <p>285.33(b)(3)(B)</p> <p>285.91(13)</p> <p>285.33(b)(3)(D)</p> <p>285.33(b)(3)(F)</p>				
33	AEROBIC TREATMENT UNIT Is Aerobic Unit Installed According to Approved Guidelines		285.33(c)(1)				
34	<p>AEROBIC TREATMENT UNIT Inspection/Clean Out Port &amp; Risers Provided</p> <p>AEROBIC TREATMENT UNIT Secondary restraint system provided</p> <p>AEROBIC TREATMENT UNIT Riser permanently fastened to lid or cast into tank</p> <p>AEROBIC TREATMENT UNIT Riser cap protected against unauthorized intrusions</p>						
35	AEROBIC TREATMENT UNIT Chlorinator Properly installed with Chlorine Tablets in Place						
36	<p>PUMP TANK Is the Pump Tank an approved concrete tank or other acceptable materials &amp; construction</p> <p>PUMP TANK Sampling Port Provided in the Treated Effluent Line</p> <p>PUMP TANK Check Valve and/or Anti- Siphon Device Present When Required</p> <p>PUMP TANK Audible and Visual High Water Alarm Installed on Separate Circuit From Pump</p>						
37	<p>PUMP TANK Inspection/Clean Out Port &amp; Risers Provided</p> <p>PUMP TANK Secondary restraint system provided</p> <p>PUMP TANK Riser permanently fastened to lid or cast into tank</p> <p>PUMP TANK Riser cap protected against unauthorized intrusions</p>						
38	PUMP TANK Secondary restraint system provided						
39	PUMP TANK Electrical Connections in Approved Junction Boxes / Wiring Buried						

**Comal County Environmental Health  
OSSF Inspection Sheet**

	Code	Answer	Options	Notes	1st Insp.	2nd Insp.	3rd Insp.
40	APPLICATION AREA Installation Pipe, Fittings, Sanitary Heads & Wave Counter Color Coded Purple?		285.33(d)(2)(G)(iii)(ii) 285.33(d)(2)(G)(iii)(i) 285.33(d)(2)(G)(iii)(ii) 285.33(d)(2)(G)(iii)(i) 285.33(d)(2)(G)(iii)(ii) 285.33(d)(2)(G)(iii)(i) 285.33(d)(2)(G)(iii)(ii) 285.33(d)(2)(G)(iii)(i) 285.33(d)(2)(G)(iii)(ii) 285.33(d)(2)(G)(iii)(i) 285.33(d)(2)(G)(iii)(ii) 285.33(d)(2)(G)(iii)(i)				4/2/19
41	APPLICATION AREA Low Angle Manhole Cover / Pressure to be inspected APPLICATION AREA Acceptable Area, existing within 10 ft of manhole heads? APPLICATION AREA The Landscaping Plan is as Designed		285.33(d)(2)(G)(i) 285.33(d)(2)(A) 285.33(d)(2)(F)				
42	APPLICATION AREA Area Installed						4/2/19
43	PUMP TANK Meets Minimum Reserve Capacity Requirements						
44	PUMP TANK Material Type & Manufacturer						
45	PUMP TANK Type/Size of Pump Installed						

## Comal County Environmental Health OSSF Inspection Sheet

Installer Name: Krause Septic OSSF Installer #: 05 0008285

1st Inspection Date: 3/19/19 2nd Inspection Date: \_\_\_\_\_ 3rd Inspection Date: \_\_\_\_\_

Inspector Name: Mike T. Inspector Name: \_\_\_\_\_ Inspector Name: \_\_\_\_\_

Permit #: 108313 Address: Hebelin Ranch / 241 Laubach Ln.

No.	Description	Amended	Conditions	Notes	1st Insp.	2nd Insp.	3rd Insp.
1	SITE AND SOIL CONDITIONS & SETBACK DISTANCES Site and Soil Conditions Consistent with Submitted Planning Materials	✓	285.31(a) 285.30(b)(1)(A)(iv) 285.30(b)(1)(A)(v) 285.30(b)(1)(A)(III) 285.30(b)(1)(A)(II) 285.30(b)(1)(A)(I)		3/19/19	3/22/19	
2	SITE AND SOIL CONDITIONS & SETBACK DISTANCES Setback Distances Meet Minimum Standards	✓	285.91(10) 285.30(b)(4) 285.31(d)				
3	SEWER PIPE Proper Type Pipe from Structure to Disposal System (Cast Iron, Ductile Iron, Sch. 40, SDR 26)	✓	285.32(a)(1)				
4	SEWER PIPE Slope from the Sewer to the Tank at least 1/8 Inch Per Foot	✓	285.32(a)(3)				
5	SEWER PIPE Two Way Sanitary - Type Cleanout Properly Installed (Add. C/O Every 100' &/or 90 degree bends)	✓	285.32(a)(5)				
6	PRETREATMENT Installed (if required) TCEQ Approved List PRETREATMENT Septic Tank(s) Meet Minimum Requirements		285.32(b)(1)(G) 285.32(b)(1)(E)(III) 285.32(b)(1)(E)(iv) 285.32(b)(1)(F) 285.32(b)(1)(B) 285.32(b)(1)(C)(i) 285.32(b)(1)(C)(ii) 285.32(b)(1)(D) 285.32(b)(1)(E) 285.32(b)(1)(A) 285.32(b)(1)(E)(II)(II) 285.32(b)(1)(E)(I) 285.32(b)(1)(E)(II)(I)				
7	PRETREATMENT Grease Interceptors if required for commercial	✓	285.34(d)				

MT-3/19/19

Tank set, leveled

1) 7'8"  
2) 8'9"  
3'6"  
5'2"  
5'6" 7'8"

MT-3/22/19

Pipe & gravel leveled.

1) 6'2 2) 7'5"

Ready For Cover

**Comal County Environmental Health  
OSSF Inspection Sheet**

No.	Description	Answer	Citations	Notes	1st Insp.	2nd Insp.	3rd Insp.	
8	SEPTIC TANK Tank(s) Clearly Marked SEPTIC TANK If Single Tank, 2 Compartments Provided with Baffle SEPTIC TANK Inlet Flowline Greater than 3" and " T " Provided on Inlet and Outlet SEPTIC TANK Septic Tank(s) Meet Minimum Requirements	✓	285.32(b)(1)(E) 285.91(2) 285.32(b)(1)(F) 285.32(b)(1)(E)(iii) 285.32(b)(1)(E)(ii)(ii) 285.32(b)(1)(E)(ii)(i) 285.32(b)(1)(E)(i) 285.32(b)(1)(D) 285.32(b)(1)(C)(ii) 285.32(b)(1)(C)(i) 285.32(b)(1)(B) 285.32(b)(1)(A) 285.32(b)(1)(E)(iv)			3/19/19	3/22/19	
9	ALL TANKS installed on 4" Sand Cushion/ Proper Backfill Used	✓	285.32(b)(1)(F) 285.32(b)(1)(G) 285.34(b)					
10	SEPTIC TANK Inspection / Clean Out Port & Risers Provided on Tanks Buried Greater than 12" Sealed and Capped	✓	285.38(d)					
11	SEPTIC TANK Secondary restraint system provided SEPTIC TANK Riser permanently fastened to lid or cast into tank SEPTIC TANK Riser cap protected against unauthorized intrusions	✓	285.38(d) 285.38(e)					
12	SEPTIC TANK Tank Volume Installed	✓		1000 gal Dual				
13	PUMP TANK Volume Installed							
14	AEROBIC TREATMENT UNIT Size Installed							
15	AEROBIC TREATMENT UNIT Manufacturer AEROBIC TREATMENT UNIT Model Number							
16	DISPOSAL SYSTEM Absorptive		285.33(a)(4) 285.33(a)(1) 285.33(a)(2) 285.33(a)(3)					
17	DISPOSAL SYSTEM Leaching Chamber		285.33(a)(1) 285.33(a)(3) 285.33(a)(4) 285.33(a)(2)					
18	DISPOSAL SYSTEM Evapo-transpirative	✓	285.33(a)(3) 285.33(a)(4) 285.33(a)(1) 285.33(a)(2)		3/19/19	3/22/19		



**Comal County Environmental Health  
OSSF Inspection Sheet**

No.	Description	Amisar	Citations	Notes	1st Insp.	2nd Insp.	3rd Insp.
19	DISPOSAL SYSTEM Drip Irrigation		285.33(a)(1) 285.33(a)(3) 285.33(a)(4) 285.33(a)(2)				
20	DISPOSAL SYSTEM Soil Substitution		285.33(d)(4)				
21	DISPOSAL SYSTEM Pumped Effluent		285.33(a)(3) 285.33(a)(1) 285.33(a)(2)				
22	DISPOSAL SYSTEM Gravelless Pipe		285.33(a)(3) 285.33(a)(2) 285.33(a)(4) 285.33(a)(1)				
23	DISPOSAL SYSTEM Mound		285.33(a)(3) 285.33(a)(1) 285.33(a)(2) 285.33(a)(4)				
24	DISPOSAL SYSTEM Other (describe) (Approved Design)		285.33(d)(6) 285.33(c)(4)				
25	DRAINFIELD Absorptive Drainline 3" PVC or 4" PVC	✓					
26	DRAINFIELD Area Installed						
27	DRAINFIELD Level to within 1 inch per 25 feet and within 3 inches over entire excavation		285.33(b)(1)(A)(v)				
28	DRAINFIELD Excavation Width DRAINFIELD Excavation Depth DRAINFIELD Excavation Separation DRAINFIELD Depth of Porous Media DRAINFIELD Type of Porous Media						
29	DRAINFIELD Pipe and Gravel - Geotextile Fabric in Place		285.33(b)(1)(E)				
30	DRAINFIELD Leaching Chambers DRAINFIELD Chambers - Open End Plates w/Splash Plate, Inspection Port & Closed End Plates in Place (per manufacturers spec.)		285.33(c)(2)				
31	LOW PRESSURE DISPOSAL SYSTEM Adequate Trench Length & Width, and Adequate Separation Distance between Trenches		285.33(d)(1)(C)(i)				

**Comal County Environmental Health  
OSSF Inspection Sheet**

No.	Description	Answer	Citations	Notes	1st Insp.	2nd Insp.	3rd Insp.
32	<p>EFFLUENT DISPOSAL SYSTEM Utilized Only by Single Family Dwelling</p> <p>EFFLUENT DISPOSAL SYSTEM Topographic Slopes &lt; 2.0%</p> <p>EFFLUENT DISPOSAL SYSTEM Adequate Length of Drain Field ( 1000 Linear ft. for 2 bedrooms or Less &amp; an additional 400 ft. for each additional bedroom )</p> <p>EFFLUENT DISPOSAL SYSTEM Lateral Depth of 18 inches to 3 ft. &amp; Vertical Separation of 1ft on bottom and 2 ft. to restrictive horizon and ground water respectfully</p> <p>EFFLUENT DISPOSAL SYSTEM Lateral Drain Pipe (1.25 - 1.5" dia.) &amp; Pipe Holes ( 3/16 - 1/4" dia. Hole Size ) 5 ft. Apart</p>		<p>285.33(b)(3)(A)</p> <p>285.33(b)(3)(A)</p> <p>285.33(b)(3)(B)</p> <p>285.91(13)</p> <p>285.33(b)(3)(D)</p> <p>285.33(b)(3)(F)</p>				
33	<p>AEROBIC TREATMENT UNIT is Aerobic Unit Installed According to Approved Guidelines.</p>		285.32(c)(1)				
34	<p>AEROBIC TREATMENT UNIT Inspection/Clean Out Port &amp; Risers Provided</p> <p>AEROBIC TREATMENT UNIT Secondary restraint system provided</p> <p>AEROBIC TREATMENT UNIT Riser permanently fastened to lid or cast into tank</p> <p>AEROBIC TREATMENT UNIT Riser cap protected against unauthorized intrusions</p>						
35	<p>AEROBIC TREATMENT UNIT Chlorinator Properly Installed with Chlorine Tablets in Place.</p>						
36	<p>PUMP TANK Is the Pump Tank an approved concrete tank or other acceptable materials &amp; construction</p> <p>PUMP TANK Sampling Port Provided in the Treated Effluent Line</p> <p>PUMP TANK Check Valve and/or Anti- Siphon Device Present When Required</p> <p>PUMP TANK Audible and Visual High Water Alarm Installed on Separate Circuit From Pump</p>						
37	<p>PUMP TANK Inspection/Clean Out Port &amp; Risers Provided</p> <p>PUMP TANK Secondary restraint system provided</p> <p>PUMP TANK Riser permanently fastened to lid or cast into tank</p> <p>PUMP TANK Riser cap protected against unauthorized intrusions</p>						
38	<p>PUMP TANK Secondary restraint system provided</p>						
39	<p>PUMP TANK Electrical Connections in Approved Junction Boxes / Wiring Buried</p>						

**Comal County Environmental Health  
OSSF Inspection Sheet**

No.	Description	Answer	Citations	Notes	1st Insp.	2nd Insp.	3rd Insp.
40	APPLICATION AREA Distribution Pipe, Fitting, Sprinkler Heads & Valve Covers Color Coded Purple?		285.33(d)(2)(G)(iii)(II)285.33(d)(2)(G)(iii)(III)285.33(d)(2)(G)(v) 285.33(d)(2)(G)(iii) 285.33(d)(2)(G)(iv) 285.33(d)(2)(G)(i) 285.33(d)(2)(G)(ii) 285.33(d)(2)(G)(iii)(I)				
41	APPLICATION AREA Low Angle Nozzles Used / Pressure is as required APPLICATION AREA Acceptable Area, nothing within 10 ft of sprinkler heads? APPLICATION AREA The Landscape Plan is as Designed		285.33(d)(2)(G)(i) 285.33(d)(2)(A) 285.33(d)(2)(F)				
42	APPLICATION AREA Area Installed						
43	PUMP TANK Meets Minimum Reserve Capacity Requirements						
44	PUMP TANK Material Type & Manufacturer						
45	PUMP TANK Type/Size of Pump Installed						

**Comal County Environmental Health  
OSSF Inspection Sheet**

No.	Description	Answer	Citations	Notes	1st Insp.	2nd Insp.	3rd Insp.
8	SEPTIC TANK Tank(s) Clearly Marked SEPTIC TANK If Single Tank, 2 Compartments Provided with Baffle SEPTIC TANK Inlet Flowline Greater than 3" and " T " Provided on Inlet and Outlet SEPTIC TANK Septic Tank(s) Meet Minimum Requirements	✓	285.32(b)(1)(E) 285.91(2) 285.32(b)(1)(F) 285.32(b)(1)(E)(iii) 285.32(b)(1)(E)(ii)(II) 285.32(b)(1)(E)(ii)(I) 285.32(b)(1)(E)(i) 285.32(b)(1)(D) 285.32(b)(1)(C)(ii) 285.32(b)(1)(C)(i) 285.32(b)(1)(B) 285.32(b)(1)(A) 285.32(b)(1)(E)(iv)		3/19/19		
9	ALL TANKS Installed on 4" Sand Cushion/ Proper Backfill Used	✓	285.32(b)(1)(F) 285.32(b)(1)(G) 285.34(b)				
10	SEPTIC TANK Inspection / Clean Out Port & Risers Provided on Tanks Buried Greater than 12" Sealed and Capped	✓	285.38(d)				
11	SEPTIC TANK Secondary restraint system provided SEPTIC TANK Riser permanently fastened to lid or cast into tank SEPTIC TANK Riser cap protected against unauthorized intrusions	✓	285.38(d) 285.38(e)				
12	SEPTIC TANK Tank Volume Installed	✓		1000 gal Dual			
13	PUMP TANK Volume Installed						
14	AEROBIC TREATMENT UNIT Size Installed						
15	AEROBIC TREATMENT UNIT Manufacturer AEROBIC TREATMENT UNIT Model Number						
16	DISPOSAL SYSTEM Absorptive		285.33(a)(4) 285.33(a)(1) 285.33(a)(2) 285.33(a)(3)				
17	DISPOSAL SYSTEM Leaching Chamber		285.33(a)(1) 285.33(a)(3) 285.33(a)(4) 285.33(a)(2)				
18	DISPOSAL SYSTEM Evapo-transpirative	✓	285.33(a)(3) 285.33(a)(4) 285.33(a)(1) 285.33(a)(2)		3/19/19		

## Comal County Environmental Health OSSF Inspection Sheet

Installer Name: Krause Septic OSSF Installer #: \_\_\_\_\_

1st Inspection Date: 3/19/19 2nd Inspection Date: \_\_\_\_\_ 3rd Inspection Date: \_\_\_\_\_

Inspector Name: Mike T. Inspector Name: \_\_\_\_\_ Inspector Name: \_\_\_\_\_

Permit#: 108313 Address: Hebelin Ranch / 241 Laubach Ln.

No.	Description	Answer	Citations	Notes	1st Insp.	2nd Insp.	3rd Insp.
1	SITE AND SOIL CONDITIONS & SETBACK DISTANCES Site and Soil Conditions Consistent with Submitted Planning Materials	✓	285.31(a) 285.30(b)(1)(A)(iv) 285.30(b)(1)(A)(v) 285.30(b)(1)(A)(iii) 285.30(b)(1)(A)(ii) 285.30(b)(1)(A)(i)		3/19/19		
2	SITE AND SOIL CONDITIONS & SETBACK DISTANCES Setback Distances Meet Minimum Standards	✓	285.91(10) 285.30(b)(4) 285.31(d)				
3	SEWER PIPE Proper Type Pipe from Structure to Disposal System (Cast Iron, Ductile Iron, Sch. 40, SDR 26)	✓	285.32(a)(1)				
4	SEWER PIPE Slope from the Sewer to the Tank at least 1/8 Inch Per Foot	✓	285.32(a)(3)				
5	SEWER PIPE Two Way Sanitary - Type Cleanout Properly Installed (Add. C/O Every 100' &/or 90 degree bends)	✓	285.32(a)(5)				
6	PRETREATMENT Installed (if required) TCEQ Approved List PRETREATMENT Septic Tank(s) Meet Minimum Requirements		285.32(b)(1)(G) 285.32(b)(1)(E)(III) 285.32(b)(1)(E)(iv) 285.32(b)(1)(F) 285.32(b)(1)(B) 285.32(b)(1)(C)(i) 285.32(b)(1)(C)(ii) 285.32(b)(1)(D) 285.32(b)(1)(E) 285.32(b)(1)(A) 285.32(b)(1)(E)(ii)(II) 285.32(b)(1)(E)(i) 285.32(b)(1)(E)(ii)(I)				
7	PRETREATMENT Grease Interceptors if required for commercial		285.34(d)				

WT-3/19/19

Tank set, leveled

1) 7'8"

2) 8'9"

3'6"

5'2" 5'6 1/2 7'8"

**Comal County Environmental Health  
OSSF Inspection Sheet**

No.	Description	Answer	Citations	Notes	1st Insp.	2nd Insp.	3rd Insp.
19	DISPOSAL SYSTEM Drip Irrigation		285.33(a)(1) 285.33(a)(3) 285.33(a)(4) 285.33(a)(2)				
20	DISPOSAL SYSTEM Soil Substitution		285.33(d)(4)				
21	DISPOSAL SYSTEM Pumped Effluent		285.33(a)(3) 285.33(a)(1) 285.33(a)(2)				
22	DISPOSAL SYSTEM Gravelless Pipe		285.33(a)(3) 285.33(a)(2) 285.33(a)(4) 285.33(a)(1)				
23	DISPOSAL SYSTEM Mound		285.33(a)(3) 285.33(a)(1) 285.33(a)(2) 285.33(a)(4)				
24	DISPOSAL SYSTEM Other (describe) (Approved Design)		285.33(d)(6) 285.33(c)(4)				
25	DRAINFIELD Absorptive Drainline 3" PVC or 4" PVC	✓					
26	DRAINFIELD Area Installed						
27	DRAINFIELD Level to within 1 inch per 25 feet and within 3 inches over entire excavation		285.33(b)(1)(A)(v)				
28	DRAINFIELD Excavation Width DRAINFIELD Excavation Depth DRAINFIELD Excavation Separation DRAINFIELD Depth of Porous Media DRAINFIELD Type of Porous Media						
29	DRAINFIELD Pipe and Gravel - Geotextile Fabric in Place		285.33(b)(1)(E)				
30	DRAINFIELD Leaching Chambers DRAINFIELD Chambers - Open End Plates w/Splash Plate, Inspection Port & Closed End Plates in Place (per manufacturers spec.)		285.33(c)(2)				
31	LOW PRESSURE DISPOSAL SYSTEM Adequate Trench Length & Width, and Adequate Separation Distance between Trenches		285.33(d)(1)(C)(i)				

**Comal County Environmental Health  
OSSF Inspection Sheet**

No.	Description	Answer	Citations	Notes	1st Insp.	2nd Insp.	3rd Insp.
32	<p>EFFLUENT DISPOSAL SYSTEM Utilized Only by Single Family Dwelling</p> <p>EFFLUENT DISPOSAL SYSTEM Topographic Slopes &lt; 2.0%</p> <p>EFFLUENT DISPOSAL SYSTEM Adequate Length of Drain Field ( 1000 Linear ft. for 2 bedrooms or Less &amp; an additional 400 ft. for each additional bedroom )</p> <p>EFFLUENT DISPOSAL SYSTEM Lateral Depth of 18 inches to 3 ft. &amp; Vertical Separation of 1ft on bottom and 2 ft. to restrictive horizon and ground water respectfully</p> <p>EFFLUENT DISPOSAL SYSTEM Lateral Drain Pipe (1.25 - 1.5" dia.) &amp; Pipe Holes ( 3/16 - 1/4" dia. Hole Size ) 5 ft. Apart</p>		<p>285.33(b)(3)(A)</p> <p>285.33(b)(3)(A)</p> <p>285.33(b)(3)(B)</p> <p>285.91(13)</p> <p>285.33(b)(3)(D)</p> <p>285.33(b)(3)(F)</p>				
33	<p>AEROBIC TREATMENT UNIT Is Aerobic Unit Installed According to Approved Guidelines.</p>		285.32(c)(1)				
34	<p>AEROBIC TREATMENT UNIT Inspection/Clean Out Port &amp; Risers Provided</p> <p>AEROBIC TREATMENT UNIT Secondary restraint system provided</p> <p>AEROBIC TREATMENT UNIT Riser permanently fastened to lid or cast into tank</p> <p>AEROBIC TREATMENT UNIT Riser cap protected against unauthorized intrusions</p>						
35	<p>AEROBIC TREATMENT UNIT Chlorinator Properly installed with Chlorine Tablets in Place.</p>						
36	<p>PUMP TANK Is the Pump Tank an approved concrete tank or other acceptable materials &amp; construction</p> <p>PUMP TANK Sampling Port Provided in the Treated Effluent Line</p> <p>PUMP TANK Check Valve and/or Anti- Siphon Device Present When Required</p> <p>PUMP TANK Audible and Visual High Water Alarm Installed on Separate Circuit From Pump</p>						
37	<p>PUMP TANK Inspection/Clean Out Port &amp; Risers Provided</p> <p>PUMP TANK Secondary restraint system provided</p> <p>PUMP TANK Riser permanently fastened to lid or cast into tank</p> <p>PUMP TANK Riser cap protected against unauthorized intrusions</p>						
38	<p>PUMP TANK Secondary restraint system provided</p>						
39	<p>PUMP TANK Electrical Connections in Approved Junction Boxes / Wiring Buried</p>						

**Comal County Environmental Health  
OSSF Inspection Sheet**

No.	Description	Answer	Citations	Notes	1st Insp.	2nd Insp.	3rd Insp.
40	APPLICATION AREA Distribution Pipe, Fitting, Sprinkler Heads & Valve Covers Color Coded Purple?		285.33(d)(2)(G)(iii)(II)285.33(d)(2)(G)(iii)(III)285.33(d)(2)(G)(v) 285.33(d)(2)(G)(iii) 285.33(d)(2)(G)(iv) 285.33(d)(2)(G)(I) 285.33(d)(2)(G)(II) 285.33(d)(2)(G)(iii)(I)				
41	APPLICATION AREA Low Angle Nozzles Used / Pressure is as required APPLICATION AREA Acceptable Area, nothing within 10 ft of sprinkler heads? APPLICATION AREA The Landscape Plan is as Designed		285.33(d)(2)(G)(i) 285.33(d)(2)(A) 285.33(d)(2)(F)				
42	APPLICATION AREA Area Installed						
43	PUMP TANK Meets Minimum Reserve Capacity Requirements						
44	PUMP TANK Material Type & Manufacturer						
45	PUMP TANK Type/Size of Pump Installed						



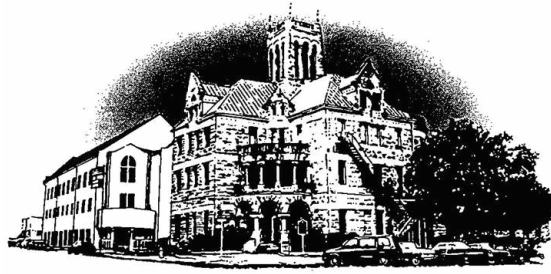

# Comal County

OFFICE OF COMAL COUNTY ENGINEER

## **Permit of Authorization to Construct an On-Site Sewage Facility Permit Valid For One Year From Date Issued**

Permit Number: 108313  
Issued This Date: 11/07/2018  
This permit is hereby given to: Cara B. Laubach

To start construction of a private, on-site sewage facility located at:

241 LAUBACH LN  
NEW BRAUNFELS, TX 78132

Subdivision: Herbelin Ranch

Unit:

Lot: 1B2

Block:

Acreage:

APPROVED MINIMUM SIZES AS PER ATTACHED DESIGN

Type of System: Septic Tank  
ET Beds

This permit gives permission for the construction of the above referenced on-site facility to commence. Installation must be completed by an installer holding a valid registration card from the Texas Commission on Environmental Quality (TCEQ). Installation and inspection must comply with current TCEQ and Comal County requirements.

Call (830) 608-2090 to schedule inspections.

OSSF DEVELOPMENT APPLICATION CHECKLIST

Staff will complete shaded

<i>items Date Received</i>	<i>initials</i>

<i>Permit Number</i>

Instructions:

Place a check mark next to all items that apply. For items that do not apply, place "N/A". This OSSF Development Application Checklist **must** accompany the completed application.

OSSF Permit

Completed Application for Permit for Authorization to Construct an On-Site Sewage Facility and License to Operate

Site/Soil Evaluation Completed by a Certified Site Evaluator or a Professional Engineer

Planning Materials of the OSSF as Required by the TCEQ Rules for OSSF Chapter 285. Planning Materials shall consist of a scaled design and all system specifications.

Required Permit Fee

Copy of Recorded Deed

Surface Application/Aerobic Treatment System

Recorded Certification of OSSF Requiring Maintenance/Affidavit to the Public

Signed Maintenance Contract with Effective Date as Issuance of License to Operate

RECEIVED  
 NOV 02 2018  
 COUNTY ENGINEER'S OFFICE

I affirm that I have provided all information required for my OSSF Development Application and that this application constitutes a completed OSSF Development Application.

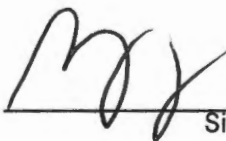
  
 \_\_\_\_\_  
 Signature of Applicant

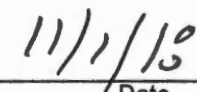
  
 \_\_\_\_\_  
 Date

<input type="checkbox"/> COMPLETE APPLICATION	
Check No. _____	Receipt No. _____

<input type="checkbox"/> INCOMPLETE APPLICATION
(Missing Items Circled, Application Refused)

APPLICATION FOR PERMIT FOR AUTHORIZATION TO CONSTRUCT AN ON-SITE SEWAGE FACILITY AND LICENSE TO OPERATE

Date 10/31/18

Permit # 108313

Owner Name Cara Laubach  
Mailing Address 241 Laubach Ln.  
City, State, Zip New Braunfels, Tx  
Phone# 830.708.3290  
Email cara laubach@hotmail.com

Agent Name GREG W. JOHNSON  
Agent Address 170 HOLLOW OAK  
City, State, Zip NEW BRAUNFELS, TX 78132  
Phone # 830-905-2778  
Email greg.johnsonpec@yahoo.com

All correspondence should be sent to:  Owner  Agent  Both

Method:  Mail  Email

Subdivision Name HERBEIN RANCH Unit/Phase/Section \_\_\_\_\_ Lot 1B2 Block \_\_\_\_\_

Acreage/Legal \_\_\_\_\_

Street Name/Address 241 LAUBACH LANE City NEW BRAUNFELS Zip 78132

Type of Development:

Single Family Residential

Type of Construction (House, Mobile, RV, Etc.) HOUSE

Number of Bedrooms 4

Indicate Sq Ft of Living Area 2424

RECEIVED  
NOV 02 2018  
COUNTY ENGINEER

Commercial or Institutional Facility

(Planning materials must show adequate land area for doubling the required land needed for treatment units and disposal area)

Type of Facility \_\_\_\_\_

Offices, Factories, Churches, Schools, Parks, Etc. - Indicate Number Of Occupants \_\_\_\_\_

Restaurants, Lounges, Theaters - Indicate Number of Seats \_\_\_\_\_

Hotel, Motel, Hospital, Nursing Home - Indicate Number of Beds \_\_\_\_\_

Travel Trailer/RV Parks - Indicate Number of Spaces \_\_\_\_\_

Miscellaneous \_\_\_\_\_

Estimated Cost of Construction: \$ 325,000 (Structure Only)

Is any portion of the proposed OSSF located in the United States Army Corps of Engineers (USACE) flowage easement?

Yes  No (if yes, owner must provide approval from USACE for proposed OSSF improvements within the USACE flowage easement)

Source of Water  Public  Private Well

Are Water Saving Devices Being Utilized Within the Residence?  Yes  No

By signing this application, I certify that:

- the completed application and all additional information submitted does not contain any false information and does not conceal any material facts.
- Authorization is hereby given to the permitting authority and designated agents to enter upon the above described property for the purpose of site/soil evaluation and inspection of private sewage facilities.
- I also understand that a permit of authorization to construct will not be issued until the Floodplain Administrator has performed the reviews required by the Comal County Flood Damage Prevention Order.
- I affirmatively consent to the online posting/public release of my e-mail address associated with this permit application, as applicable.

Cara Laubach  
Signature of Owner

10/31/18  
Date

\*\*\* COMAL COUNTY OFFICE OF ENVIRONMENTAL HEALTH \*\*\*

APPLICATION FOR PERMIT FOR AUTHORIZATION TO CONSTRUCT AN ON-SITE SEWAGE FACILITY AND LICENSE TO OPERATE

Planning Materials & Site Evaluation as Required Completed By GREG W. JOHNSON, P.E.

System Description STANDARD; SEPTIC TANK AND UNLINED E.T. BEDS

Size of Septic System Required Based on Planning Materials & Soil Evaluation

1000 GAL. DUAL COMP. SEPTIC

Tank Size(s) (Gallons) TANK Absorption/Application Area (Sq Ft) 3200

Gallons Per Day (As Per TCEQ Table III) 300

(Sites generating more than 5000 gallons per day are required to obtain a permit through TCEQ)

Is the property located over the Edwards Recharge Zone? [X] Yes [ ] No

(If yes, the planning materials must be completed by a Registered Sanitarian (R.S.) or Professional Engineer (P.E.))

Is there an existing TCEQ approved WPAP for the property? [ ] Yes [X] No

(if yes, the R. S. or P. E. shall certify that the OSSF design complies with all provisions of the existing WPAP.)

If there is no existing WPAP, does the proposed development activity require a TCEQ approved WPAP? [ ] Yes [X] No

(If yes, the R.S. or P. E. shall certify that the OSSF design will comply with all provisions of the proposed WPAP. A Permit to Construct will not be issued for the proposed OSSF until the proposed WPAP has been approved by the appropriate regional office.)

Is the property located over the Edwards Contributing Zone? [ ] Yes [X] No

Is there an existing TCEQ approval CZP for the property? [ ] Yes [X] No

(if yes, the P.E. or R.S. shall certify that the OSSF design complies with all provisions of the existing CZP)

If there is no existing CZP, does the proposed development activity require a TCEQ approved CZP? [ ] Yes [ ] No

(if yes, the P.E. or R.S. shall certify that the OSSF design will comply with all provisions of the proposed CZP. A Permit to construct will not be issued for the proposed OSSF until the CZP has been approved by the appropriate regional office.)

Is this property within an incorporated city? [ ] Yes [X] No

If yes, indicate the city:



FIRM #2585

By signing this application, I certify that:

- The information provided above is true and correct to the best of my knowledge.
- I affirmatively consent to the online posting/public release of my e-mail address associated with this permit application, as applicable

Signature of Designer (Handwritten Signature)

Date November 1, 2018

Greg W. Johnson, P.E.  
170 Hollow Oak  
New Braunfels, Texas 78132  
830/905-2778

November 1, 2018

Comal County Office of Environmental Health  
195 David Jonas Drive  
New Braunfels, Texas 78132-3760

RE- SEPTIC DESIGN  
241 LAUBACH LANE  
HERBELIN RANCH, LOT 1B2  
NEW BRAUNFELS, TX 78132  
LAUBACH RESIDENCE

RECEIVED

NOV 02 2018

COUNTY ENGINEER

Ms. Brenda Ritzen / Sandra Hernandez,

The referenced property is located within the Edwards Aquifer Recharge Zone. This property is exempt from a WPAP because it is not regulated activity according to §213.3 (27)(B)(v) "construction of single-family residence on lots that are larger than five acres, were no more than one single-family residence is located on each lot." To my knowledge no WPAP exists for this property.

Temporary erosion and sedimentation controls should be utilized as necessary prior to construction. If any sensitive feature (caves, solution cavities, sink holes, etc.) is discovered during construction, activities must be suspended immediately and the applicant or his agent must immediately notify the TCEQ Regional Office. After that operations can only proceed after the Executive Director approves required additional engineered impact plans.

Designed in accordance with Chapter 285, Subchapter D, §285.40, 285.41, & 285.42, Texas Commission on Environmental Quality (Effective December 27, 2012).

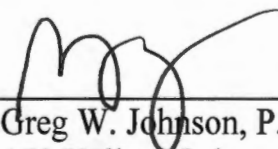
  
\_\_\_\_\_  
Greg W. Johnson, P.E. No. 67587 / S.E. 11561  
170 Hollow Oak  
New Braunfels, Texas 78132 - 830/905-2778



FIRM #2585

# ON-SITE SEWERAGE FACILITY SOIL EVALUATION REPORT INFORMATION

Date Soil Survey Performed: October 31, 2018

Site Location: HERBELIN RANCH, LOT 1B2

Proposed Excavation Depth: 18" to 26"

**Requirements:**

At least two soil excavations must be performed on the site, at opposite ends of the proposed disposal area. Locations of soil boring or dug pits must be shown on the site drawing. For subsurface disposal, soil evaluations must be performed to a depth of at least two feet below the proposed excavation depth. For surface disposal, the surface horizon must be evaluated. Describe each soil horizon and identify any restrictive features on the form. Indicate depths where features appear.

RECEIVED  
NOV 02 2018  
PROPERTY ENGINEER

SOIL BORING NUMBER <u>1</u>						
Depth (Feet)	Texture Class	Soil Texture	Gravel Analysis	Drainage (Mottles/ Water Table)	Restrictive Horizon	Observations
0	<b>IV</b>	<b>CLAY</b>	<b>N/A</b>	<b>NONE OBSERVED</b>	<b>LIMESTONE @ 48"</b>	<b>BROWN</b>
1						
2						
3						
4						
5						

SOIL BORING NUMBER <u>2 &amp; 3</u>						
Depth (Feet)	Texture Class	Soil Texture	Gravel Analysis	Drainage (Mottles/ Water Table)	Restrictive Horizon	Observations
0	<b>SAME</b>		<b>AS</b>		<b>ABOVE</b>	
1						
2						
3						
4						
5						

I certify that the findings of this report are based on my field observations and are accurate to the best of my ability.

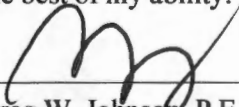
  
 \_\_\_\_\_  
 Greg W. Johnson, P.E. 67587-F2585, S.E. 11561

10/31/18  
 \_\_\_\_\_  
 Date

**OSSF SOIL EVALUATION REPORT INFORMATION**

Date: November 01, 2018

**Applicant Information:**

Name: CARA B. LAUBACH  
Address: c/o P.O. BOX 310245  
City: NEW BRAUNFELS State: TEXAS  
Zip Code: 78131 Phone: (210) 846-6363

**Site Evaluator Information:**

Name: Greg W. Johnson, P.E., R.S., S.E. 11561  
Address: 170 Hollow Oak  
City: New Braunfels State: Texas  
Zip Code: 78132 Phone & Fax (830)905-2778

**Property Location:**

Lot 1B2 Unit \_\_\_ Blk \_\_\_ Subd. HERBELIN RANCH  
Street Address: 241 LAUBACH LANE  
City: NEW BRAUNFELS Zip Code: 78132  
Additional Info.: \_\_\_\_\_

**Installer Information:**

Name: \_\_\_\_\_  
Company: \_\_\_\_\_  
Address: \_\_\_\_\_  
City: \_\_\_\_\_ State: \_\_\_\_\_  
Zip Code: \_\_\_\_\_ Phone \_\_\_\_\_

**Topography**, Slope within proposed disposal area: 5 %  
Presence of 100 yr. Flood Zone: YES \_\_\_ NO X  
Existing or proposed water well in nearby area. YES X NO \_\_\_ >100'  
Presence of adjacent ponds, streams, water impoundments YES \_\_\_ NO X  
Presence of upper water shed YES \_\_\_ NO X  
Organized sewage service available to lot YES \_\_\_ NO X

RECEIVED  
NOV 02 2018  
COUNTY ENGINEER

**Design Calculations for Evapotranspiration Beds:**

**Commercial**

Q = \_\_\_\_\_ GPD \_\_\_\_\_

Residential Water conserving fixtures to be utilized? Yes X No \_\_\_\_\_  
Number of Bedrooms the septic system is sized for: 4 Total sq. ft. living area 2424  
Q gal/day = (Bedrooms +1) \* 75 GPD - (20% reduction for water conserving fixtures)  
Q = (4 + 1) \* 75 - (20 %) = 300

**Evapotranspiration Beds**

A = 1.6Q/Ret = 1.6 \* 300 / .15 = 3200 sq. ft.

Tank Size = (~3 \* Q) = 1000 Gal. Dual Comp.

**Excavation Length & Width**

L = A/W = 3200 / 20' = 160' of 20' WIDE

**FINAL GRADE TO BE COVERED WITH VEGETATION TO MAXIMIZE TRANSPIRATION**

I HAVE PERFORMED A THOROUGH INVESTIGATION BEING A REGISTERED PROFESSIONAL ENGINEER AND SITE EVALUATOR IN ACCORDANCE WITH CHAPTER 285, SUBCHAPTER D, §285.30, & §285.40 (REGARDING RECHARGE FEATURES), TEXAS COMMISSION OF ENVIRONMENTAL QUALITY (EFFECTIVE DECEMBER 29, 2016).

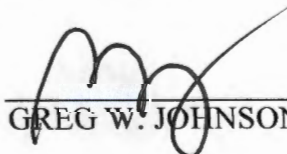
  
GREG W. JOHNSON, P.E. 67587 - F#2585

11/01/18  
DATE



**FIRM #2585**

LAUBACH LANE

575.00'

INSTALL 3200sf OF UNLINED E.T. BEDS. THERE SHALL BE NO PARKING, DRIVING OR STORAGE ON THE SEPTIC FIELD AT ANY TIME FOR ANY REASON.

\*USE TWO WAY CLEANOUT  
\*\*USE SCH-40 OR SDR-26 TO TANK

X= TEST HOLE

RECEIVED  
NOV 02 2018  
COUNTY ENGINEER

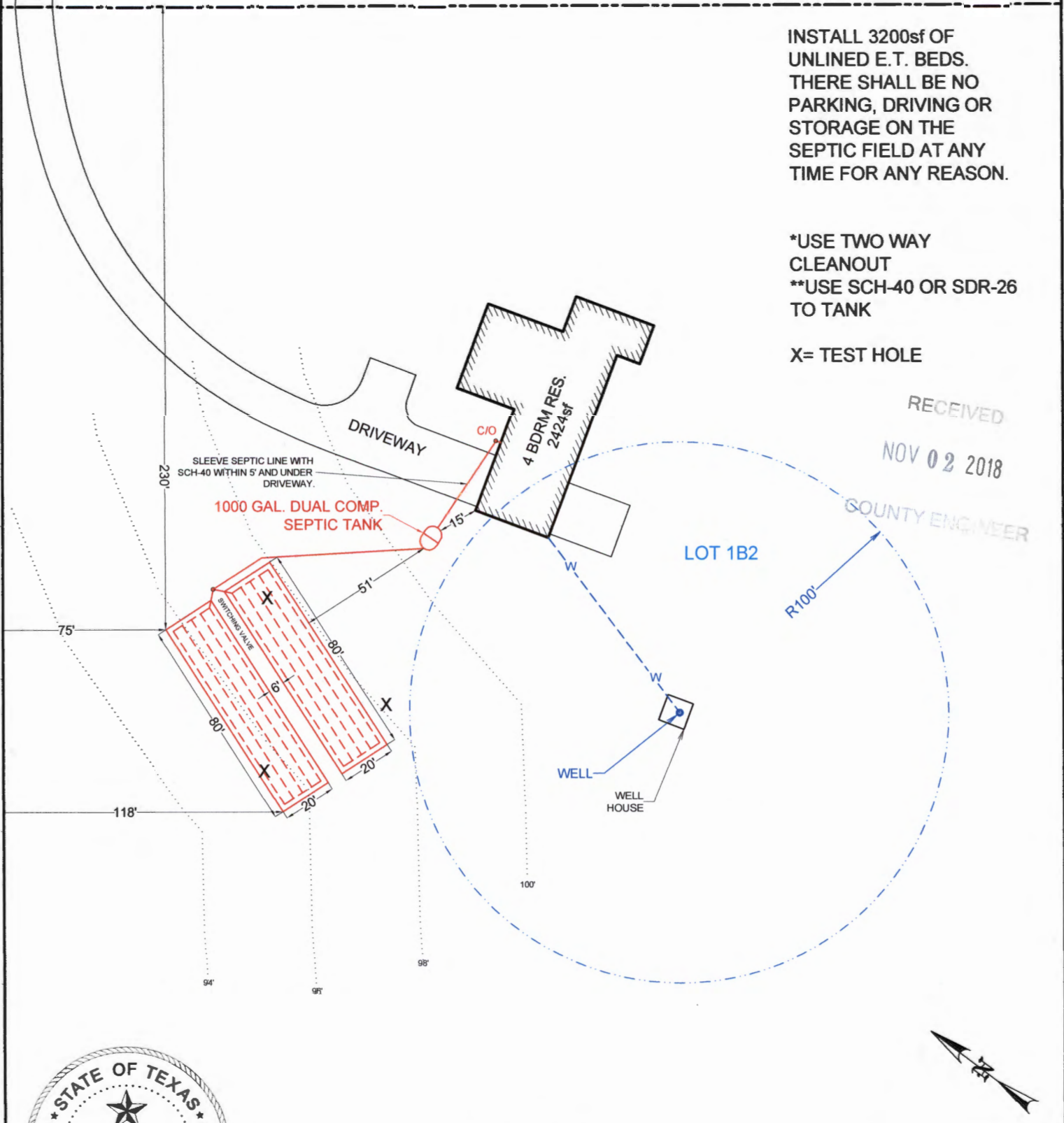

OWNER: CARA B. LAUBACH		DRAWN BY: EJS III	
STREET ADDRESS: 241 LAUBACH LANE			
LEGAL DESC: HERBERLIN RANCH	UNIT/SECTION/PHASE:	BLOCK:	LOT: 1B2
PREPARED BY: GREG W. JOHNSON, P.E. F#002585	SCALE: 1"=50'	DATE: 11/1/2018	REVISED:





INSTALL 3200sf OF UNLINED E.T. BEDS. THERE SHALL BE NO PARKING, DRIVING OR STORAGE ON THE SEPTIC FIELD AT ANY TIME FOR ANY REASON.

\*USE TWO WAY CLEANOUT  
 \*\*USE SCH-40 OR SDR-26 TO TANK

X= TEST HOLE

RECEIVED

NOV 02 2018

COUNTY ENGINEER

433.10'

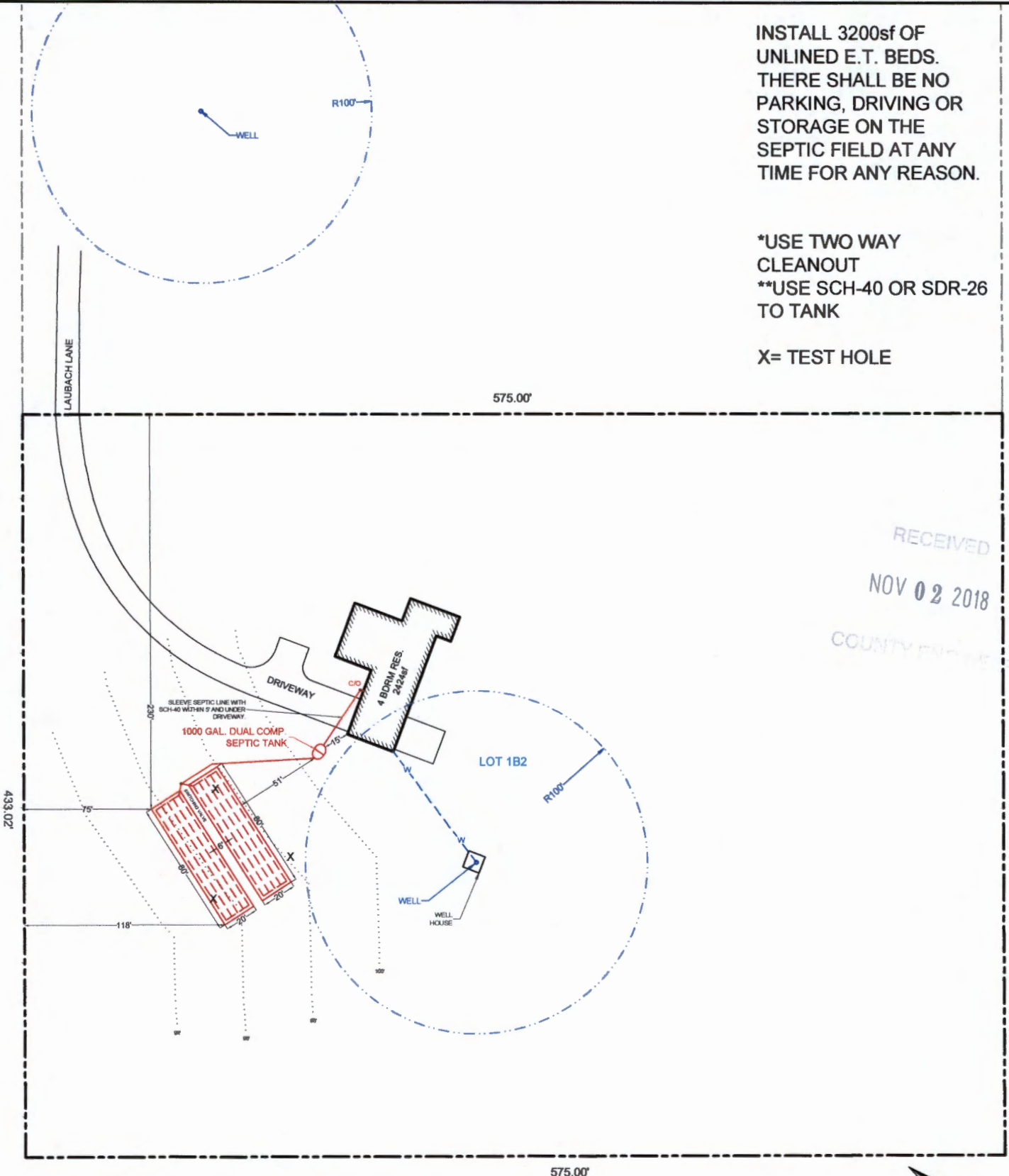

OWNER: CARA B. LAUBACH		DRAWN BY: EJS III	
STREET ADDRESS: 241 LAUBACH LANE			
LEGAL DESC: HERBERLIN RANCH	UNIT/SECTION/PHASE:	BLOCK:	LOT: 1B2
PREPARED BY: GREG W. JOHNSON, P.E. F#002585	SCALE: 1"=80'	DATE: 11/1/2018	REVISED:

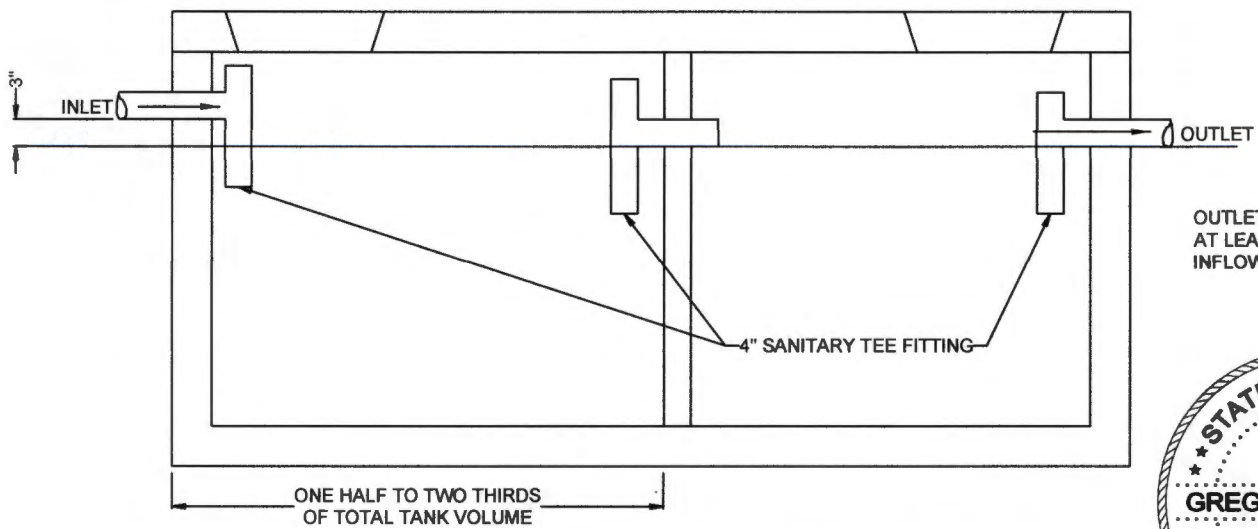

OUTLET PIPE MUST BE AT LEAST 3" LOWER THAN INFLOW PIPE

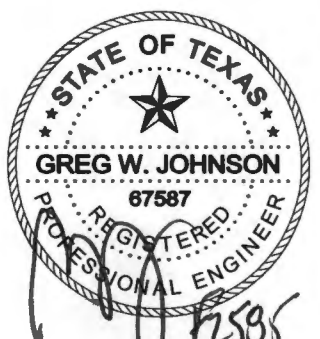

### TYPICAL TWO COMPARTMENT SEPTIC TANK

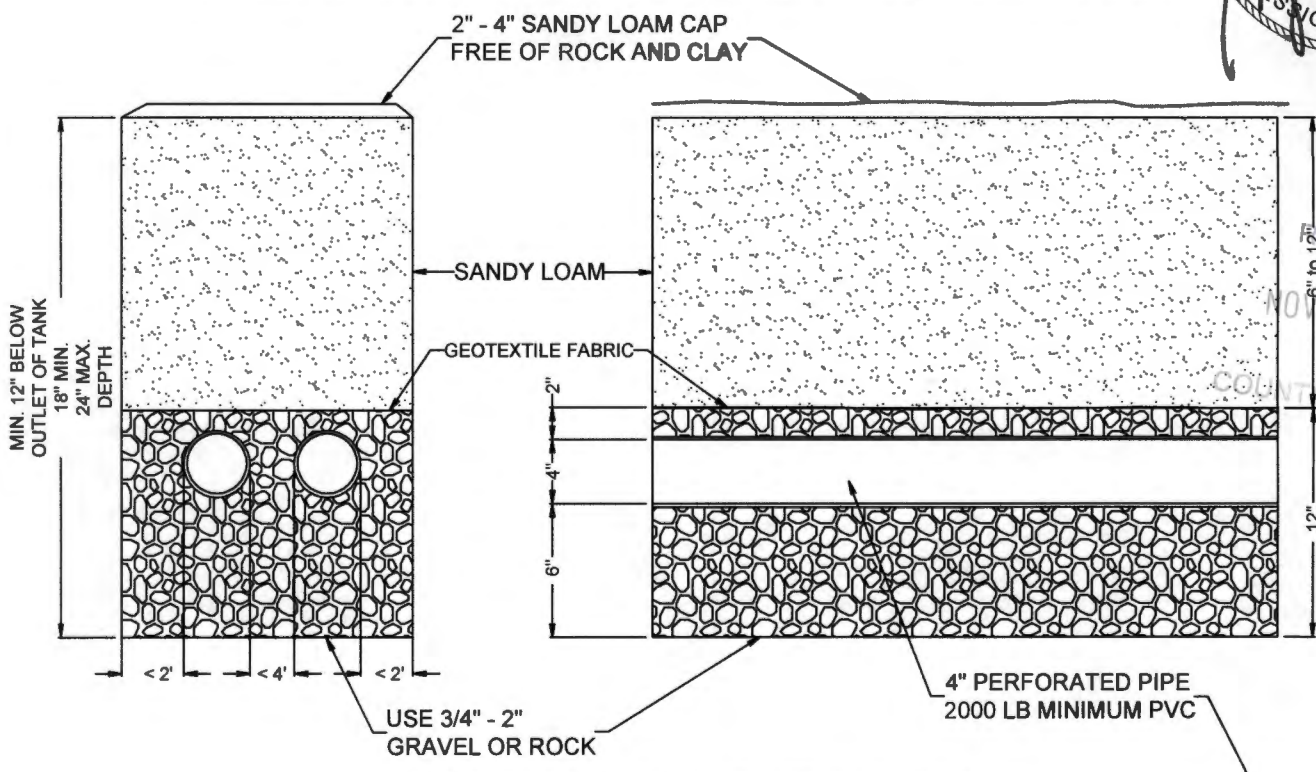

RECEIVED  
NOV 02 2018  
COUNTY ENGINEER

### UNLINED E.T. BED DETAIL

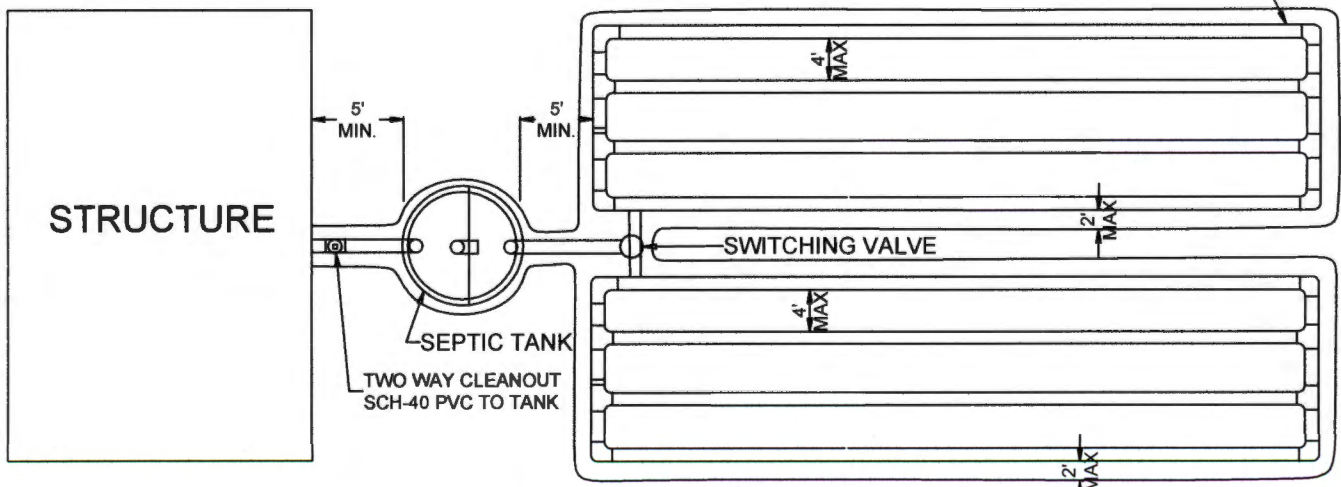

### BED TYPE DRAINFIELD SYSTEM

421

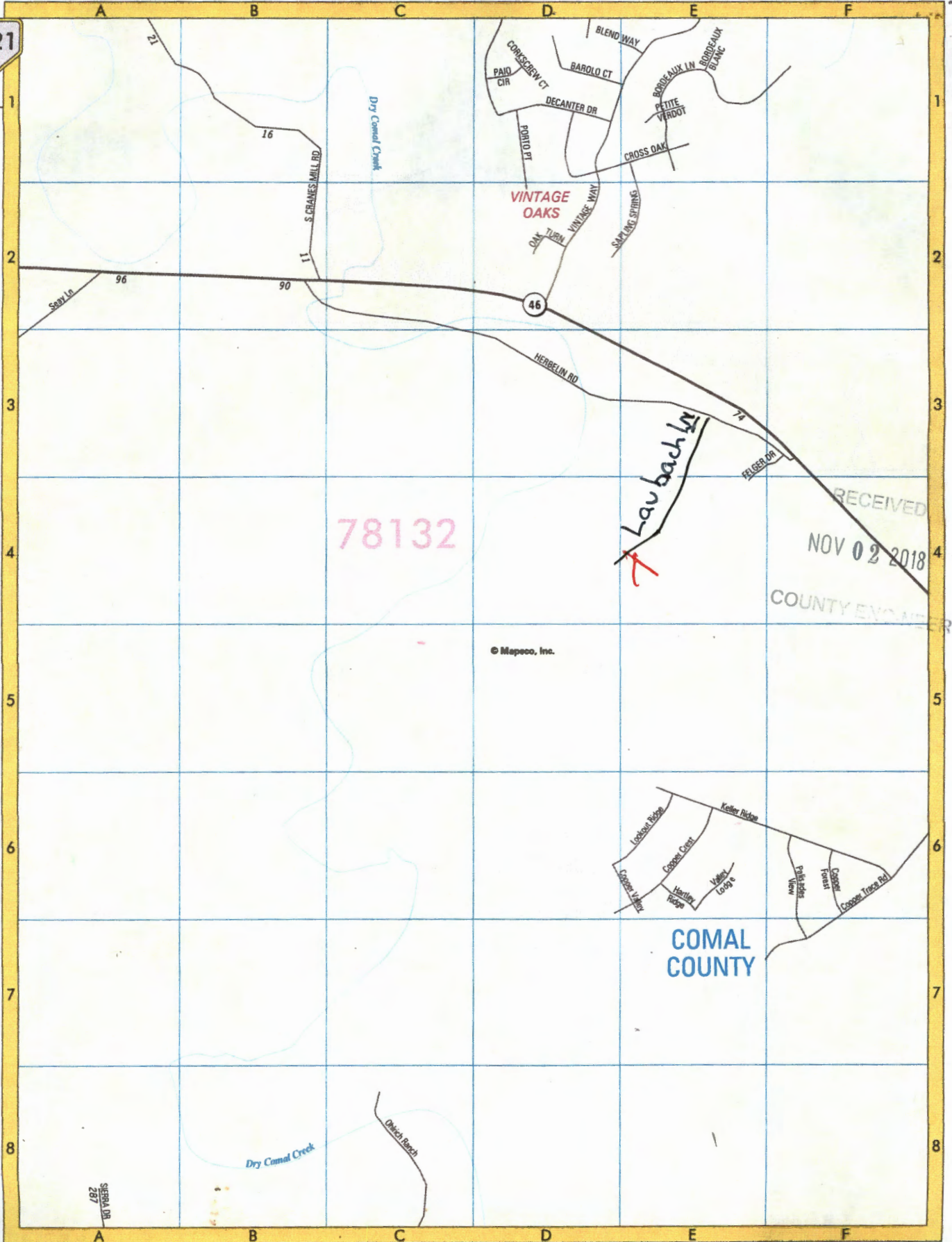

CONTINUED ON MAP 420

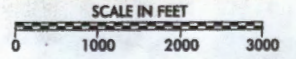



2/c

**Special Warranty Gift Deed**

Date: November 29, 2017

Grantor: Kenneth C. Laubach and Victoria Beth Laubach, a married couple

**Grantor's Mailing Address:**

Kenneth C. Laubach and Victoria Beth Laubach  
633 Herbelin Road  
New Braunfels, Texas 78132

Grantee: Cara B. Laubach, a single person

**Grantee's Mailing Address:**

**Cara B. Laubach**  
633 Herbelin Road  
New Braunfels, Texas 78132

RECEIVED  
NOV 02 2018  
COUNTY CLERK

**Consideration:**

Love of, and affection for, Grantee.

**Property (including any improvements):**

**Lot 1B2 of HERBELIN RANCH SUBDIVISION**, Comal County, Texas,  
according to replat recorded as Document No. 201706048373, Official Public  
Records of Comal County, Texas.

**Reservations from Conveyance:**

None

**Exceptions to Conveyance and Warranty:**

Validly existing easements, rights-of-way, and prescriptive rights, whether of record or not; all presently recorded and validly existing instruments, other than conveyances of the surface fee estate, that affect the Property; and taxes for 2017, which Grantee assumes and agrees to pay, and subsequent assessments for that and prior years due to change in land usage, ownership, or both, the payment of which Grantee assumes.

Grantor, for the Consideration and subject to the Reservations from Conveyance and the Exceptions to Conveyance and Warranty, grants, gives, and conveys to

Grantee the Property, together with all and singular the rights and appurtenances thereto in any way belonging, to have and to hold it to Grantee and Grantee's heirs, successors, and assigns forever. Grantor binds Grantor and Grantor's heirs and successors to warrant and forever defend all and singular the Property to Grantee and Grantee's heirs, successors, and assigns against every person whomsoever lawfully claiming or to claim the same or any part thereof when the claim is by, through, or under Grantor but not otherwise, except as to the Reservations from Conveyance and the Exceptions to Conveyance and Warranty.

Grantor grants and conveys the Property to Grantee as separate property.

When the context requires, singular nouns and pronouns include the plural

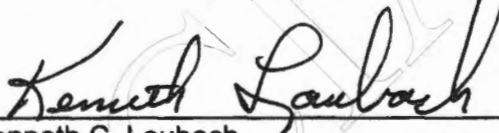
  
\_\_\_\_\_  
Kenneth C. Laubach

  
\_\_\_\_\_  
Victoria Beth Laubach

RECEIVED  
NOV 02 2018

STATE OF TEXAS

COUNTY OF COMAL

This instrument was acknowledged before me on November 29, 2017,  
by Kenneth C. Laubach and Victoria Beth Laubach.

  
\_\_\_\_\_  
Notary Public, State of Texas

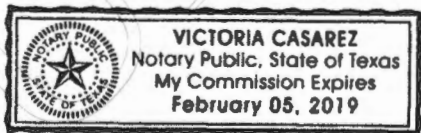

Filed and Recorded  
Official Public Records  
Bobbie Koepf, County Clerk  
Comal County, Texas  
11/30/2017 01:16:12 PM  
JESSICA 2 Page(s)  
201706052035



