



Comal County

OFFICE OF COMAL COUNTY ENGINEER

License to Operate On-Site Sewage Treatment and Disposal Facility

Issued This Date: 03/20/2019 Permit Number: 108384

Location Description: 1360 HILLTOP RDG
NEW BRAUNFELS, TX 78132
Subdivision: Summit Extension
Unit: 7
Lot: 408
Block:
Acreage:

Type of System: Aerobic
Surface Irrigation

Issued to: Jim & Melissa Kautz

This license is authorization for the owner to operate and maintain a private facility at the location described in accordance to the rules and regulations for on-site sewerage facilities of Comal County, Texas, and the Texas Commission on Environmental Quality.

The license grants permission to operate the facility. It does not guarantee successful operation. It is the responsibility of the owner to maintain and operate the facility in a satisfactory manner.

Alterations to this permit including, but not limited to:

- Increase in the square feet of living area
- Increase in the number of bedrooms
- A change of use (i.e. residential to commercial)
- Relocation of system components (including the relocation of spray heads)
- Installation of landscaping
- Adding new structures to the system

may require a new permit. It is the responsibility of the owner to apply for a new permit, if applicable.

Inspection and licensing of a facility indicates only that the facility meets certain minimum requirements. It does not impede any governmental entity in taking the proper steps to prevent or control pollution, to abate nuisance, or to protect the public health.

This license to operate is valid for an indefinite period. The holder may transfer it to a succeeding owner, provided the facility has not been remodeled and is functioning properly.

Licensing Authority

Comal County Environmental Health

Signature of Environmental Health Inspector

ENVIRONMENTAL HEALTH INSPECTOR

Signature of Environmental Health Coordinator with OS0007722 stamp

ENVIRONMENTAL HEALTH COORDINATOR

OS0034322



## Comal County Environmental Health OSSF Inspection Sheet

Installer Name: Countryside Const. OSSF Installer #: OS 0002929  
 1st Inspection Date: 3.1.19 2nd Inspection Date: 3.6.19 3rd Inspection Date: 3.19.19  
 Inspector Name: S. Helms Inspector Name: andrea R. Inspector Name: andrea R.

Permit#: 109384 Address: 1360 Hilltop Rdg - Summit Est

No.	Description	Answer	Citations	Notes	1st Insp.	2nd Insp.	3rd Insp.
1	SITE AND SOIL CONDITIONS & SETBACK DISTANCES Site and Soil Conditions Consistent with Submitted Planning Materials	✓	285.31(a) 285.30(b)(1)(A)(iv) 285.30(b)(1)(A)(v) 285.30(b)(1)(A)(iii) 285.30(b)(1)(A)(ii) 285.30(b)(1)(A)(i)		3-1-19		
2	SITE AND SOIL CONDITIONS & SETBACK DISTANCES Setback Distances Meet Minimum Standards	✓	285.91(10) 285.30(b)(4) 285.31(d)				
3	SEWER PIPE Proper Type Pipe from Structure to Disposal System (Cast Iron, Ductile Iron, Sch. 40, SDR 26)	✓	285.32(a)(1)				
4	SEWER PIPE Slope from the Sewer to the Tank at least 1/8 Inch Per Foot	✓	285.32(a)(3)				
5	SEWER PIPE Two Way Sanitary - Type Cleanout Properly Installed (Add. C/O Every 100' &/or 90 degree bends)	✓	285.32(a)(5)				
6	PRETREATMENT Installed (if required) TCEQ Approved List PRETREATMENT Septic Tank(s) Meet Minimum Requirements		285.32(b)(1)(G)285.32(b)(1)(E)(iii) 285.32(b)(1)(E)(iv) 285.32(b)(1)(F) 285.32(b)(1)(B) 285.32(b)(1)(C)(i) 285.32(b)(1)(C)(ii) 285.32(b)(1)(D) 285.32(b)(1)(E) 285.32(b)(1)(A) 285.32(b)(1)(E)(iii)(II) 285.32(b)(1)(E)(i) 285.32(b)(1)(E)(ii)(I)				
7	PRETREATMENT Grease Interceptors if required for commercial		285.34(d)				

tank check only 3.6.19  
 tank set, level - operational. system turned on alarms  
 can cover tank & lines - need revision. not working. check alarms on final.  
 - Tank not covered. Air spray closet to tank.  
 - Remove shrods with 10 pt of last spray.  
3.19.19  
 alarms on and working on covered trees: rocks removed.



**Comal County Environmental Health  
OSSF Inspection Sheet**

No.	Description	Answer	Citations	Notes	1st Insp.	2nd Insp.	3rd Insp.
8	SEPTIC TANK Tank(s) Clearly Marked SEPTIC TANK If Single Tank, 2 Compartments Provided with Baffle SEPTIC TANK Inlet Flowline Greater than 3" and " T " Provided on Inlet and Outlet SEPTIC TANK Septic Tank(s) Meet Minimum Requirements	✓	285.32(b)(1)(E) 285.91(2) 285.32(b)(1)(F) 285.32(b)(1)(E)(iii) 285.32(b)(1)(E)(ii)(II) 285.32(b)(1)(E)(ii)(I) 285.32(b)(1)(E)(i) 285.32(b)(1)(D) 285.32(b)(1)(C)(ii) 285.32(b)(1)(C)(i) 285.32(b)(1)(B) 285.32(b)(1)(A) 285.32(b)(1)(E)(iv)		3.1.19		
9	ALL TANKS Installed on 4" Sand Cushion/ Proper Backfill Used	✓	285.32(b)(1)(F) 285.32(b)(1)(G) 285.34(b)				
10	SEPTIC TANK Inspection / Clean Out Port & Risers Provided on Tanks Buried Greater than 12" Sealed and Capped	✓	285.38(d)				
11	SEPTIC TANK Secondary restraint system provided SEPTIC TANK Riser permanently fastened to lid or cast into tank SEPTIC TANK Riser cap protected against unauthorized intrusions	✓	285.38(d) 285.38(e)				
12	SEPTIC TANK Tank Volume Installed	✓					
13	PUMP TANK Volume installed	✓					
14	AEROBIC TREATMENT UNIT Size Installed	✓		600			
15	AEROBIC TREATMENT UNIT Manufacturer AEROBIC TREATMENT UNIT Model Number	✓		Clearstream			
16	DISPOSAL SYSTEM Absorptive		285.33(a)(4) 285.33(a)(1) 285.33(a)(2) 285.33(a)(3)				
17	DISPOSAL SYSTEM Leaching Chamber		285.33(a)(1) 285.33(a)(3) 285.33(a)(4) 285.33(a)(2)				
18	DISPOSAL SYSTEM Evapo-transpirative		285.33(a)(3) 285.33(a)(4) 285.33(a)(1) 285.33(a)(2)				



**Comal County Environmental Health  
OSSF Inspection Sheet**

No.	Description	Answer	Citations	Notes	1st Insp.	2nd Insp.	3rd Insp.
19	DISPOSAL SYSTEM Drip Irrigation		285.33(a)(1) 285.33(a)(3) 285.33(a)(4) 285.33(a)(2)				
20	DISPOSAL SYSTEM Soil Substitution		285.33(d)(4)				
21	DISPOSAL SYSTEM Pumped Effluent		285.33(a)(4) 285.33(a)(3) 285.33(a)(1)				
22	DISPOSAL SYSTEM Gravelless Pipe		285.33(a)(3) 285.33(a)(2) 285.33(a)(4) 285.33(a)(1)				
23	DISPOSAL SYSTEM Mound		285.33(a)(3) 285.33(a)(1) 285.33(a)(2) 285.33(a)(4)				
24	DISPOSAL SYSTEM Other (describe) (Approved Design)		285.33(d)(6) 285.33(c)(4)				
25	DRAINFIELD Absorptive Drainline 3" PVC or 4" PVC						
26	DRAINFIELD Area Installed						
27	DRAINFIELD Level to within 1 inch per 25 feet and within 3 inches over entire excavation		285.33(b)(1)(A)(v)				
28	DRAINFIELD Excavation Width DRAINFIELD Excavation Depth DRAINFIELD Excavation Separation DRAINFIELD Depth of Porous Media DRAINFIELD Type of Porous Media						
29	DRAINFIELD Pipe and Gravel - Geotextile Fabric in Place		285.33(b)(1)(E)				
30	DRAINFIELD Leaching Chambers DRAINFIELD Chambers - Open End Plates w/Splash Plate, Inspection Port & Closed End Plates in Place (per manufacturers spec.)		285.33(c)(2)				
31	LOW PRESSURE DISPOSAL SYSTEM Adequate Trench Length & Width, and Adequate Separation Distance between Trenches		285.33(d)(1)(C)(i)				



**Comal County Environmental Health  
OSSF Inspection Sheet**

No.	Description	Answer	Citations	Notes	1st Insp.	2nd Insp.	3rd Insp.
32	<p>EFFLUENT DISPOSAL SYSTEM Utilized Only by Single Family Dwelling</p> <p>EFFLUENT DISPOSAL SYSTEM Topographic Slopes &lt; 2.0% EFFLUENT DISPOSAL SYSTEM Adequate Length of Drain Field ( 1000 Linear ft. for 2 bedrooms or Less &amp; an additional 400 ft. for each additional bedroom )</p> <p>EFFLUENT DISPOSAL SYSTEM Lateral Depth of 18 inches to 3 ft. &amp; Vertical Separation of 1ft on bottom and 2 ft. to restrictive horizon and ground water respectfully</p> <p>EFFLUENT DISPOSAL SYSTEM Lateral Drain Pipe (1.25 - 1.5" dia.) &amp; Pipe Holes ( 3/16 - 1/4" dia. Hole Size ) 5 ft. Apart</p>		<p>285.33(b)(3)(A)</p> <p>285.33(b)(3)(A)</p> <p>285.33(b)(3)(B)</p> <p>285.91(13)</p> <p>285.33(b)(3)(D)</p> <p>285.33(b)(3)(F)</p>				
33	<p>AEROBIC TREATMENT UNIT Is Aerobic Unit Installed According to Approved Guidelines.</p>	✓	285.32(c)(1)			✓	
34	<p>AEROBIC TREATMENT UNIT Inspection/Clean Out Port &amp; Risers Provided</p> <p>AEROBIC TREATMENT UNIT Secondary restraint system provided AEROBIC TREATMENT UNIT Riser permanently fastened to lid or cast into tank</p> <p>AEROBIC TREATMENT UNIT Riser cap protected against unauthorized intrusions</p>	✓				✓	
35	<p>AEROBIC TREATMENT UNIT Chlorinator Properly Installed with Chlorine Tablets in Place.</p>	✓			3-1-19	✓	
36	<p>PUMP TANK Is the Pump Tank an approved concrete tank or other acceptable materials &amp; construction</p> <p>PUMP TANK Sampling Port Provided in the Treated Effluent Line</p> <p>PUMP TANK Check Valve and/or Anti- Siphon Device Present When Required</p> <p>PUMP TANK Audible and Visual High Water Alarm Installed on Separate Circuit From Pump</p>						
37	<p>PUMP TANK Inspection/Clean Out Port &amp; Risers Provided</p> <p>PUMP TANK Secondary restraint system provided</p> <p>PUMP TANK Riser permanently fastened to lid or cast into tank</p> <p>PUMP TANK Riser cap protected against unauthorized intrusions</p>						
38	<p>PUMP TANK Secondary restraint system provided</p>						

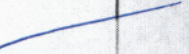

Comal County Environmental Health  
OSSF Inspection Sheet

39 PUMP TANK Electrical Connections in Approved Junction Boxes / Wiring Buried						
--	---	--	--	--	---	--



**Comal County Environmental Health  
OSSF Inspection Sheet**

No.	Description	Answer	Citations	Notes	1st Insp.	2nd Insp.	3rd Insp.
40	APPLICATION AREA Distribution Pipe, Fitting, Sprinkler Heads & Valve Covers Color Coded Purple?	✓	285.33(d)(2)(G)(iii)(II)285.33(d)(2)(G)(iii)(III)285.33(d)(2)(G)(v) 285.33(d)(2)(G)(iii) 285.33(d)(2)(G)(iv) 285.33(d)(2)(G)(I) 285.33(d)(2)(G)(II) 285.33(d)(2)(G)(iii)(I)		3.1.19		
41	APPLICATION AREA Low Angle Nozzles Used / Pressure is as required APPLICATION AREA Acceptable Area, nothing within 10 ft of sprinkler heads? APPLICATION AREA The Landscape Plan is as Designed	/	285.33(d)(2)(G)(i) 285.33(d)(2)(A) 285.33(d)(2)(F)	See Notes		/	
42	APPLICATION AREA Area Installed	/				/	
43	PUMP TANK Meets Minimum Reserve Capacity Requirements						
44	PUMP TANK Material Type & Manufacturer						
45	PUMP TANK Type/Size of Pump Installed						



# Comal County Environmental Health OSSF Inspection Sheet

Installer Name: Countryside Const. OSSF Installer #: OS 0002929

1st Inspection Date: 3.1.19 2nd Inspection Date: 3.6.19 3rd Inspection Date: \_\_\_\_\_

Inspector Name: S. Helmke Inspector Name: andreea d. Inspector Name: \_\_\_\_\_

Permit#: 109384 Address: 1360 Hilltop Rdg - Summit Est

No.	Description	Answer	Citations	Notes	1st Insp.	2nd Insp.	3rd Insp.
1	SITE AND SOIL CONDITIONS & SETBACK DISTANCES Site and Soil Conditions Consistent with Submitted Planning Materials	✓	285.31(a) 285.30(b)(1)(A)(iv) 285.30(b)(1)(A)(v) 285.30(b)(1)(A)(iii) 285.30(b)(1)(A)(ii) 285.30(b)(1)(A)(i)		3-1-19		
2	SITE AND SOIL CONDITIONS & SETBACK DISTANCES Setback Distances Meet Minimum Standards	✓	285.91(10) 285.30(b)(4) 285.31(d)				
3	SEWER PIPE Proper Type Pipe from Structure to Disposal System (Cast Iron, Ductile Iron, Sch. 40, SDR 26)	✓	285.32(a)(1)				
4	SEWER PIPE Slope from the Sewer to the Tank at least 1/8 Inch Per Foot	✓	285.32(a)(3)				
5	SEWER PIPE Two Way Sanitary - Type Cleanout Properly Installed (Add. C/O Every 100' &/or 90 degree bends)	✓	285.32(a)(5)				
6	PRETREATMENT Installed (if required) TCEQ Approved List PRETREATMENT Septic Tank(s) Meet Minimum Requirements		285.32(b)(1)(G)285.32(b)(1)(E)(iii) 285.32(b)(1)(E)(iv) 285.32(b)(1)(F) 285.32(b)(1)(B) 285.32(b)(1)(C)(i) 285.32(b)(1)(C)(ii) 285.32(b)(1)(D) 285.32(b)(1)(E) 285.32(b)(1)(A) 285.32(b)(1)(E)(ii)(II) 285.32(b)(1)(E)(i) 285.32(b)(1)(E)(ii)(I)				
7	PRETREATMENT Grease Interceptors if required for commercial		285.34(d)				

tank check only  
 tank set, level  
 can cover tank & lines

3.6.19  
 - operational. system turned on alarms not working. check alarms on final.  
 - need revision  
 Air spray closet to house.  
 - Tank not covered.  
 - Remove shrobs with 10pt of last spray.



**Comal County Environmental Health  
OSSF Inspection Sheet**

No.	Description	Answer	Citations	Notes	1st Insp.	2nd Insp.	3rd Insp.
8	SEPTIC TANK Tank(s) Clearly Marked SEPTIC TANK If Single Tank, 2 Compartments Provided with Baffle SEPTIC TANK Inlet Flowline Greater than 3" and " T " Provided on Inlet and Outlet SEPTIC TANK Septic Tank(s) Meet Minimum Requirements	✓	285.32(b)(1)(E) 285.91(2) 285.32(b)(1)(F) 285.32(b)(1)(E)(iii) 285.32(b)(1)(E)(ii)(II) 285.32(b)(1)(E)(ii)(I) 285.32(b)(1)(E)(i) 285.32(b)(1)(D) 285.32(b)(1)(C)(iii) 285.32(b)(1)(C)(I) 285.32(b)(1)(B) 285.32(b)(1)(A) 285.32(b)(1)(E)(iv)		3.1.19		
9	ALL TANKS Installed on 4" Sand Cushion/ Proper Backfill Used	✓	285.32(b)(1)(F) 285.32(b)(1)(G) 285.34(b)				
10	SEPTIC TANK Inspection / Clean Out Port & Risers Provided on Tanks Buried Greater than 12" Sealed and Capped	✓	285.38(d)				
11	SEPTIC TANK Secondary restraint system provided SEPTIC TANK Riser permanently fastened to lid or cast into tank SEPTIC TANK Riser cap protected against unauthorized intrusions	✓	285.38(d) 285.38(e)				
12	SEPTIC TANK Tank Volume Installed	✓					
13	PUMP TANK Volume installed	✓					
14	AEROBIC TREATMENT UNIT Size Installed	✓		600			
15	AEROBIC TREATMENT UNIT Manufacturer AEROBIC TREATMENT UNIT Model Number	✓		Clearstream			
16	DISPOSAL SYSTEM Absorptive		285.33(a)(4) 285.33(a)(1) 285.33(a)(2) 285.33(a)(3)				
17	DISPOSAL SYSTEM Leaching Chamber		285.33(a)(1) 285.33(a)(3) 285.33(a)(4) 285.33(a)(2)				
18	DISPOSAL SYSTEM Evapo-transpirative		285.33(a)(3) 285.33(a)(4) 285.33(a)(1) 285.33(a)(2)				



**Comal County Environmental Health  
OSSF Inspection Sheet**

No.	Description	Answer	Citations	Notes	1st Insp.	2nd Insp.	3rd Insp.
19	DISPOSAL SYSTEM Drip Irrigation		285.33(a)(1) 285.33(a)(3) 285.33(a)(4) 285.33(a)(2)				
20	DISPOSAL SYSTEM Soil Substitution		285.33(d)(4)				
21	DISPOSAL SYSTEM Pumped Effluent		285.33(a)(4) 285.33(a)(3) 285.33(a)(1)				
22	DISPOSAL SYSTEM Gravelless Pipe		285.33(a)(3) 285.33(a)(2) 285.33(a)(4) 285.33(a)(1)				
23	DISPOSAL SYSTEM Mound		285.33(a)(3) 285.33(a)(1) 285.33(a)(2) 285.33(a)(4)				
24	DISPOSAL SYSTEM Other (describe) (Approved Design)		285.33(d)(6) 285.33(c)(4)				
25	DRAINFIELD Absorptive Drainline 3" PVC or 4" PVC						
26	DRAINFIELD Area Installed						
27	DRAINFIELD Level to within 1 inch per 25 feet and within 3 inches over entire excavation		285.33(b)(1)(A)(v)				
28	DRAINFIELD Excavation Width DRAINFIELD Excavation Depth DRAINFIELD Excavation Separation DRAINFIELD Depth of Porous Media DRAINFIELD Type of Porous Media						
29	DRAINFIELD Pipe and Gravel - Geotextile Fabric in Place		285.33(b)(1)(E)				
30	DRAINFIELD Leaching Chambers DRAINFIELD Chambers - Open End Plates w/Splash Plate, Inspection Port & Closed End Plates in Place (per manufacturers spec.)		285.33(c)(2)				
31	LOW PRESSURE DISPOSAL SYSTEM Adequate Trench Length & Width, and Adequate Separation Distance between Trenches		285.33(d)(1)(C)(i)				



**Comal County Environmental Health  
OSSF Inspection Sheet**

No.	Description	Answer	Citations	Notes	1st Insp.	2nd Insp.	3rd Insp.
32	<p>EFFLUENT DISPOSAL SYSTEM Utilized Only by Single Family Dwelling</p> <p>EFFLUENT DISPOSAL SYSTEM Topographic Slopes &lt; 2.0%</p> <p>EFFLUENT DISPOSAL SYSTEM Adequate Length of Drain Field ( 1000 Linear ft. for 2 bedrooms or Less &amp; an additional 400 ft. for each additional bedroom )</p> <p>EFFLUENT DISPOSAL SYSTEM Lateral Depth of 18 inches to 3 ft. &amp; Vertical Separation of 1ft on bottom and 2 ft. to restrictive horizon and ground water respectfully</p> <p>EFFLUENT DISPOSAL SYSTEM Lateral Drain Pipe (1.25 - 1.5" dia.) &amp; Pipe Holes ( 3/16 - 1/4" dia. Hole Size ) 5 ft. Apart</p>		<p>285.33(b)(3)(A)</p> <p>285.33(b)(3)(A)</p> <p>285.33(b)(3)(B)</p> <p>285.91(13)</p> <p>285.33(b)(3)(D)</p> <p>285.33(b)(3)(F)</p>				
33	<p>AEROBIC TREATMENT UNIT Is Aerobic Unit Installed According to Approved Guidelines.</p>		285.32(c)(1)			/	
34	<p>AEROBIC TREATMENT UNIT Inspection/Clean Out Port &amp; Risers Provided</p> <p>AEROBIC TREATMENT UNIT Secondary restraint system provided</p> <p>AEROBIC TREATMENT UNIT Riser permanently fastened to lid or cast into tank</p> <p>AEROBIC TREATMENT UNIT Riser cap protected against unauthorized intrusions</p>					/	
35	<p>AEROBIC TREATMENT UNIT Chlorinator Properly Installed with Chlorine Tablets in Place.</p>	✓			3-1-19	/	
36	<p>PUMP TANK Is the Pump Tank an approved concrete tank or other acceptable materials &amp; construction</p> <p>PUMP TANK Sampling Port Provided in the Treated Effluent Line</p> <p>PUMP TANK Check Valve and/or Anti- Siphon Device Present When Required</p> <p>PUMP TANK Audible and Visual High Water Alarm Installed on Separate Circuit From Pump</p>						
37	<p>PUMP TANK Inspection/Clean Out Port &amp; Risers Provided</p> <p>PUMP TANK Secondary restraint system provided</p> <p>PUMP TANK Riser permanently fastened to lid or cast into tank</p> <p>PUMP TANK Riser cap protected against unauthorized intrusions</p>						
38	<p>PUMP TANK Secondary restraint system provided</p>						



Comal County Environmental Health  
OSSF Inspection Sheet

39	PUMP TANK Electrical Connections in Approved Junction Boxes / Wiring Buried						
----	---	--	--	--	--	--	--



**Comal County Environmental Health  
OSSF Inspection Sheet**

No.	Description	Answer	Citations	Notes	1st Insp.	2nd Insp.	3rd Insp.
40	APPLICATION AREA Distribution Pipe, Fitting, Sprinkler Heads & Valve Covers Color Coded Purple?	✓	285.33(d)(2)(G)(iii)(II)285.33(d)(2)(G)(iii)(III)285.33(d)(2)(G)(v) 285.33(d)(2)(G)(iii) 285.33(d)(2)(G)(iv) 285.33(d)(2)(G)(i) 285.33(d)(2)(G)(ii) 285.33(d)(2)(G)(iii)(I)		3.1.19		
41	APPLICATION AREA Low Angle Nozzles Used / Pressure Is as required APPLICATION AREA Acceptable Area, nothing within 10 ft of sprinkler heads? APPLICATION AREA The Landscape Plan is as Designed		285.33(d)(2)(G)(i) 285.33(d)(2)(A) 285.33(d)(2)(F)	<i>See notes</i>			
42	APPLICATION AREA Area Installed						
43	PUMP TANK Meets Minimum Reserve Capacity Requirements						
44	PUMP TANK Material Type & Manufacturer						
45	PUMP TANK Type/Size of Pump Installed						



# Comal County Environmental Health OSSF Inspection Sheet

Installer Name: Countryside Const. OSSF Installer #: OS 0002929

1st Inspection Date: 3.1.19 2nd Inspection Date: \_\_\_\_\_ 3rd Inspection Date: \_\_\_\_\_

Inspector Name: S. Helmske Inspector Name: \_\_\_\_\_ Inspector Name: \_\_\_\_\_

Permit#: 109384 Address: 1360 Hilltop Rdg - Summit Ext

No.	Description	Answer	Citations	Notes	1st Insp.	2nd Insp.	3rd Insp.
1	SITE AND SOIL CONDITIONS & SETBACK DISTANCES Site and Soil Conditions Consistent with Submitted Planning Materials	✓	285.31(a) 285.30(b)(1)(A)(iv) 285.30(b)(1)(A)(v) 285.30(b)(1)(A)(iii) 285.30(b)(1)(A)(ii) 285.30(b)(1)(A)(i)		3.1.19		
2	SITE AND SOIL CONDITIONS & SETBACK DISTANCES Setback Distances Meet Minimum Standards	✓	285.91(10) 285.30(b)(4) 285.31(d)				
3	SEWER PIPE Proper Type Pipe from Structure to Disposal System (Cast Iron, Ductile Iron, Sch. 40, SDR 26)	✓	285.32(a)(1)				
4	SEWER PIPE Slope from the Sewer to the Tank at least 1/8 Inch Per Foot	✓	285.32(a)(3)				
5	SEWER PIPE Two Way Sanitary - Type Cleanout Properly Installed (Add. C/O Every 100' &/or 90 degree bends)	✓	285.32(a)(5)				
6	PRETREATMENT Installed (if required) TCEQ Approved List PRETREATMENT Septic Tank(s) Meet Minimum Requirements		285.32(b)(1)(G) 285.32(b)(1)(E)(iii) 285.32(b)(1)(E)(iv) 285.32(b)(1)(F) 285.32(b)(1)(B) 285.32(b)(1)(C)(i) 285.32(b)(1)(C)(ii) 285.32(b)(1)(D) 285.32(b)(1)(E) 285.32(b)(1)(A) 285.32(b)(1)(E)(ii)(II) 285.32(b)(1)(E)(i) 285.32(b)(1)(E)(ii)(I)				
7	PRETREATMENT Grease Interceptors if required for commercial		285.34(d)				

tank check only  
tank set, level  
can cover  
tank & lines



**Comal County Environmental Health  
OSSF Inspection Sheet**

No.	Description	Answer	Citations	Notes	1st Insp.	2nd Insp.	3rd Insp.
8	SEPTIC TANK Tank(s) Clearly Marked SEPTIC TANK If Single Tank, 2 Compartments Provided with Baffle SEPTIC TANK Inlet Flowline Greater than 3" and " T " Provided on Inlet and Outlet SEPTIC TANK Septic Tank(s) Meet Minimum Requirements	✓	285.32(b)(1)(E) 285.91(2) 285.32(b)(1)(F) 285.32(b)(1)(E)(iii) 285.32(b)(1)(E)(ii)(II) 285.32(b)(1)(E)(ii)(I) 285.32(b)(1)(E)(i) 285.32(b)(1)(D) 285.32(b)(1)(C)(ii) 285.32(b)(1)(C)(i) 285.32(b)(1)(B) 285.32(b)(1)(A) 285.32(b)(1)(E)(iv)		3.1.19		
9	ALL TANKS Installed on 4" Sand Cushion/ Proper Backfill Used	✓	285.32(b)(1)(F) 285.32(b)(1)(G) 285.34(b)				
10	SEPTIC TANK Inspection / Clean Out Port & Risers Provided on Tanks Buried Greater than 12" Sealed and Capped	✓	285.38(d)				
11	SEPTIC TANK Secondary restraint system provided SEPTIC TANK Riser permanently fastened to lid or cast into tank SEPTIC TANK Riser cap protected against unauthorized intrusions	✓	285.38(d) 285.38(e)				
12	SEPTIC TANK Tank Volume Installed	✓					
13	PUMP TANK Volume Installed	✓					
14	AEROBIC TREATMENT UNIT Size Installed	✓		600			
15	AEROBIC TREATMENT UNIT Manufacturer AEROBIC TREATMENT UNIT Model Number	✓		Clearstream			
16	DISPOSAL SYSTEM Absorptive		285.33(a)(4) 285.33(a)(1) 285.33(a)(2) 285.33(a)(3)				
17	DISPOSAL SYSTEM Leaching Chamber		285.33(a)(1) 285.33(a)(3) 285.33(a)(4) 285.33(a)(2)				
18	DISPOSAL SYSTEM Evapo-transpirative		285.33(a)(3) 285.33(a)(4) 285.33(a)(1) 285.33(a)(2)				



**Comal County Environmental Health  
OSSF Inspection Sheet**

No.	Description	Answer	Citations	Notes	1st Insp.	2nd Insp.	3rd Insp.
19	DISPOSAL SYSTEM Drip Irrigation		285.33(a)(1) 285.33(a)(3) 285.33(a)(4) 285.33(a)(2)				
20	DISPOSAL SYSTEM Soil Substitution		285.33(d)(4)				
21	DISPOSAL SYSTEM Pumped Effluent		285.33(a)(4) 285.33(a)(3) 285.33(a)(1)				
22	DISPOSAL SYSTEM Gravelless Pipe		285.33(a)(3) 285.33(a)(2) 285.33(a)(4) 285.33(a)(1)				
23	DISPOSAL SYSTEM Mound		285.33(a)(3) 285.33(a)(1) 285.33(a)(2) 285.33(a)(4)				
24	DISPOSAL SYSTEM Other (describe) (Approved Design)		285.33(d)(6) 285.33(c)(4)				
25	DRAINFIELD Absorptive Drainline 3" PVC or 4" PVC						
26	DRAINFIELD Area Installed						
27	DRAINFIELD Level to within 1 inch per 25 feet and within 3 inches over entire excavation		285.33(b)(1)(A)(v)				
28	DRAINFIELD Excavation Width DRAINFIELD Excavation Depth DRAINFIELD Excavation Separation DRAINFIELD Depth of Porous Media DRAINFIELD Type of Porous Media						
29	DRAINFIELD Pipe and Gravel - Geotextile Fabric in Place		285.33(b)(1)(E)				
30	DRAINFIELD Leaching Chambers DRAINFIELD Chambers - Open End Plates w/Splash Plate, Inspection Port & Closed End Plates in Place (per manufacturers spec.)		285.33(c)(2)				
31	LOW PRESSURE DISPOSAL SYSTEM Adequate Trench Length & Width, and Adequate Separation Distance between Trenches		285.33(d)(1)(C)(i)				



**Comal County Environmental Health  
OSSF Inspection Sheet**

No.	Description	Answer	Citations	Notes	1st Insp.	2nd Insp.	3rd Insp.
32	EFFLUENT DISPOSAL SYSTEM Utilized Only by Single Family Dwelling EFFLUENT DISPOSAL SYSTEM Topographic Slopes < 2.0% EFFLUENT DISPOSAL SYSTEM Adequate Length of Drain Field ( 1000 Linear ft. for 2 bedrooms or Less & an additional 400 ft. for each additional bedroom ) EFFLUENT DISPOSAL SYSTEM Lateral Depth of 18 inches to 3 ft. & Vertical Separation of 1ft on bottom and 2 ft. to restrictive horizon and ground water respectfully EFFLUENT DISPOSAL SYSTEM Lateral Drain Pipe (1.25 - 1.5" dia.) & Pipe Holes ( 3/16 - 1/4" dia. Hole Size ) 5 ft. Apart		285.33(b)(3)(A) 285.33(b)(3)(A) 285.33(b)(3)(B) 285.91(13) 285.33(b)(3)(D) 285.33(b)(3)(F)				
33	AEROBIC TREATMENT UNIT Is Aerobic Unit Installed According to Approved Guidelines.		285.32(c)(1)				
34	AEROBIC TREATMENT UNIT Inspection/Clean Out Port & Risers Provided AEROBIC TREATMENT UNIT Secondary restraint system provided AEROBIC TREATMENT UNIT Riser permanently fastened to lid or cast into tank AEROBIC TREATMENT UNIT Riser cap protected against unauthorized intrusions						
35	AEROBIC TREATMENT UNIT Chlorinator Properly Installed with Chlorine Tablets in Place.	✓			3-1-19		
36	PUMP TANK Is the Pump Tank an approved concrete tank or other acceptable materials & construction PUMP TANK Sampling Port Provided in the Treated Effluent Line PUMP TANK Check Valve and/or Anti- Siphon Device Present When Required PUMP TANK Audible and Visual High Water Alarm Installed on Separate Circuit From Pump						
37	PUMP TANK Inspection/Clean Out Port & Risers Provided PUMP TANK Secondary restraint system provided PUMP TANK Riser permanently fastened to lid or cast into tank PUMP TANK Riser cap protected against unauthorized intrusions						
38	PUMP TANK Secondary restraint system provided						



Comal County Environmental Health  
OSSF Inspection Sheet

39	PUMP TANK Electrical Connections in Approved Junction Boxes / Wiring Buried						
----	---	--	--	--	--	--	--



**Comal County Environmental Health  
OSSF Inspection Sheet**

No.	Description	Answer	Citations	Notes	1st Insp.	2nd Insp.	3rd Insp.
40	APPLICATION AREA Distribution Pipe, Fitting, Sprinkler Heads & Valve Covers Color Coded Purple?	✓	285.33(d)(2)(G)(iii)(I)285.33(d)(2)(G)(iii)(II)285.33(d)(2)(G)(iv) 285.33(d)(2)(G)(i) 285.33(d)(2)(G)(ii) 285.33(d)(2)(G)(iii)(f)		3.1.19		
41	APPLICATION AREA Low Angle Nozzles Used / Pressure is as required APPLICATION AREA Acceptable Area, nothing within 10 ft of sprinkler heads? APPLICATION AREA The Landscape Plan is as Designed		285.33(d)(2)(G)(i) 285.33(d)(2)(A) 285.33(d)(2)(F)				
42	APPLICATION AREA Area Installed						
43	PUMP TANK Meets Minimum Reserve Capacity Requirements						
44	PUMP TANK Material Type & Manufacturer						
45	PUMP TANK Type/Size of Pump Installed						





# Comal County

OFFICE OF COMAL COUNTY ENGINEER

## **Permit of Authorization to Construct an On-Site Sewage Facility Permit Valid For One Year From Date Issued**

Permit Number: 108384  
Issued This Date: 11/27/2018  
This permit is hereby given to: Jim & Melissa Kautz

To start construction of a private, on-site sewage facility located at:

1360 HILLTOP RDG  
NEW BRAUNFELS, TX 78132

Subdivision: Summit Extension  
Unit: 7  
Lot: 408  
Block:  
Acreage:

APPROVED MINIMUM SIZES AS PER ATTACHED DESIGN

Type of System: Aerobic  
Surface Irrigation

This permit gives permission for the construction of the above referenced on-site facility to commence. Installation must be completed by an installer holding a valid registration card from the Texas Commission on Environmental Quality (TCEQ). Installation and inspection must comply with current TCEQ and Comal County requirements.

Call (830) 608-2090 to schedule inspections.



OSSF DEVELOPMENT APPLICATION CHECKLIST

Staff will complete shaded

items Date Received	initials

108384
Permit Number

Instructions:

Place a check mark next to all items that apply. For items that do not apply, place "N/A". This OSSF Development Application Checklist **must** accompany the completed application.

OSSF Permit

Completed Application for Permit for Authorization to Construct an On-Site Sewage Facility and License to Operate

Site/Soil Evaluation Completed by a Certified Site Evaluator or a Professional Engineer

Planning Materials of the OSSF as Required by the TCEQ Rules for OSSF Chapter 285. Planning Materials shall consist of a scaled design and all system specifications.

Required Permit Fee

Copy of Recorded Deed

Surface Application/Aerobic Treatment System

Recorded Certification of OSSF Requiring Maintenance/Affidavit to the Public

Signed Maintenance Contract with Effective Date as Issuance of License to Operate

RECEIVED

NOV 20 2018

COUNTY ENGINEER

I affirm that I have provided all information required for my OSSF Development Application and that this application constitutes a completed OSSF Development Application.

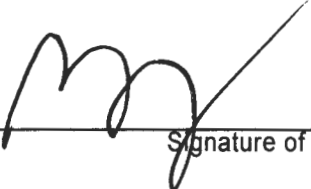
  
 \_\_\_\_\_  
 Signature of Applicant

11/20/18  
 \_\_\_\_\_  
 Date

___ COMPLETE APPLICATION	
Check No. _____	Receipt No. _____

___ INCOMPLETE APPLICATION
(Missing Items Circled, Application Refused)



\*\*\* COMAL COUNTY OFFICE OF ENVIRONMENTAL HEALTH \*\*\*

APPLICATION FOR PERMIT FOR AUTHORIZATION TO CONSTRUCT AN ON-SITE SEWAGE FACILITY AND LICENSE TO OPERATE

Date November 2, 2018

Permit # 108384

Owner Name JIM & MELISSA KAUTZ
Mailing Address 2325 6TH ST N
City, State, Zip TEXAS CITY, TEXAS 77590
Phone# 830-822-0373
Email jkautzjr77@yahoo.com

Agent Name GREG W. JOHNSON, P.E.
Agent Address 170 HOLLOW OAK
City, State, Zip NEW BRAUNFELS, TX 78132
Phone # (830) 905-2778
Email gregjohnsonpe@yahoo.com

All correspondence should be sent to: [ ] Owner [X] Agent [ ] Both Method: [ ] Mail [X] Email

Subdivision Name SUMMIT EXTENSION Unit/Phase/Section PHASE 7 Lot 408 Block
Acreage/Legal
Street Name/Address 1360 HILLTOP RIDGE City NEW BRAUNFELS Zip 78132

Type of Development:

[X] Single Family Residential

Type of Construction (House, Mobile, RV, Etc.) HOUSE

Number of Bedrooms 3

Indicate Sq Ft of Living Area 1753

RECEIVED
NOV 20 2018
COUNTY ENGINEER

[ ] Commercial or Institutional Facility

(Planning materials must show adequate land area for doubling the required land needed for treatment units and disposal area)

Type of Facility

Offices, Factories, Churches, Schools, Parks, Etc. - Indicate Number Of Occupants

Restaurants, Lounges, Theaters - Indicate Number of Seats

Hotel, Motel, Hospital, Nursing Home - Indicate Number of Beds

Travel Trailer/RV Parks - Indicate Number of Spaces

Miscellaneous

Estimated Cost of Construction: \$ 275,000 (Structure Only)

Is any portion of the proposed OSSF located in the United States Army Corps of Engineers (USACE) flowage easement?

[ ] Yes [X] No (if yes, owner must provide approval from USACE for proposed OSSF improvements within the USACE flowage easement)

Source of Water [X] Public [ ] Private Well

Are Water Saving Devices Being Utilized Within the Residence? [X] Yes [ ] No

By signing this application, I certify that:

- the completed application and all additional information submitted does not contain any false information and does not conceal any material facts.
-Authorization is hereby given to the permitting authority and designated agents to enter upon the above described property for the purpose of site/soil evaluation and inspection of private sewage facilities.
-I also understand that a permit of authorization to construct will not be issued until the Floodplain Administrator has performed the reviews required by the Comal County Flood Damage Prevention Order.
-I affirmatively consent to the online posting/public release of my e-mail address associated with this permit application, as applicable.

Signature of Owner

Date 11-9-18



\*\*\* COMAL COUNTY OFFICE OF ENVIRONMENTAL HEALTH \*\*\*

108384

APPLICATION FOR PERMIT FOR AUTHORIZATION TO CONSTRUCT AN ON-SITE SEWAGE FACILITY AND LICENSE TO OPERATE

Planning Materials & Site Evaluation as Required Completed By GREG W. JOHNSON, P.E.

System Description PROPRIETARY; AEROBIC TREATMENT AND SURFACE IRRIGATION

Size of Septic System Required Based on Planning Materials & Soil Evaluation

Tank Size(s) (Gallons) CLEARSTREAM 600NC3T Absorption/Application Area (Sq Ft) 5654

Gallons Per Day (As Per TCEQ Table III) 240

(Sites generating more than 5000 gallons per day are required to obtain a permit through TCEQ)

Is the property located over the Edwards Recharge Zone? [X] Yes [ ] No

(If yes, the planning materials must be completed by a Registered Sanitarian (R.S.) or Professional Engineer (P.E.))

RECEIVED

NOV 20 2018

Is there an existing TCEQ approved WPAP for the property? [X] Yes [ ] No

(if yes, the R. S. or P. E. shall certify that the OSSF design complies with all provisions of the existing WPAP.)

COUNTY ENGINEER

If there is no existing WPAP, does the proposed development activity require a TCEQ approved WPAP? [ ] Yes [ ] No

(If yes, the R.S. or P. E. shall certify that the OSSF design will comply with all provisions of the proposed WPAP. A Permit to Construct will not be issued for the proposed OSSF until the proposed WPAP has been approved by the appropriate regional office.)

Is the property located over the Edwards Contributing Zone? [ ] Yes [X] No

Is there an existing TCEQ approval CZP for the property? [ ] Yes [X] No

(if yes, the P.E. or R.S. shall certify that the OSSF design complies with all provisions of the existing CZP)

If there is no existing CZP, does the proposed development activity require a TCEQ approved CZP? [ ] Yes [ ] No

(if yes, the P.E. or R.S. shall certify that the OSSF design will comply with all provisions of the proposed CZP. A Permit to construct will not be issued for the proposed OSSF until the CZP has been approved by the appropriate regional office.)

Is this property within an incorporated city? [ ] Yes [X] No

If yes, indicate the city:



FIRM #2585

By signing this application, I certify that:

- The information provided above is true and correct to the best of my knowledge.

I affirmatively consent to the online posting/public release of my e-mail address associated with this permit application, as applicable

Signature of Designer

November 7, 2018

Date

Greg W. Johnson, P.E.  
170 Hollow Oak  
New Braunfels, Texas 78132  
830/905-2778

November 7, 2018

Comal County Office of Environmental Health  
195 David Jonas Drive  
New Braunfels, Texas 78132-3760

RE- SEPTIC DESIGN  
1360 HILLTOP RIDGE  
SUMMIT EXTENSION, PHASE 7, LOT 408  
NEW BRAUNFELS, TX 78132  
KAUTZ RESIDENCE

RECEIVED  
NOV 20 2018  
COUNTY ENGINEER

Ms. Brenda Ritzen/Sandra Hernandez,

The referenced property is located within the Edwards Aquifer Recharge Zone. This OSSF design will comply with requirements in the WPAP.

Temporary erosion and sedimentation controls should be utilized as necessary prior to construction. If any sensitive feature (caves, solution cavities, sink holes, etc.) is discovered during construction, activities must be suspended immediately and the applicant or his agent must immediately notify the TCEQ Regional Office. After that operations can only proceed after the Executive Director approves required additional engineered impact plans.

Designed in accordance with Chapter 285, Subchapter D, §285.40, 285.41, & 285.42, Texas Commission on Environmental Quality (Effective December 29, 2016).

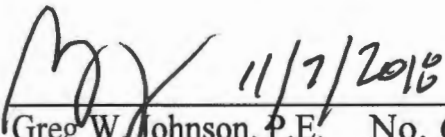
 11/7/2018  
\_\_\_\_\_  
Greg W. Johnson, P.E. No. 67587 / F#2585  
170 Hollow Oak  
New Braunfels, Texas 78132 - 830/905-2778





AFFIDAVIT



201806044913 11/20/2018 11:41:05 AM 1/1

THE COUNTY OF COMAL  
STATE OF TEXAS

Yes

CERTIFICATION OF OSSF REQUIRING MAINTENANCE

According to Texas Commission on Environmental Quality Rules for On-Site Sewage Facilities (OSSF's), this document is filed in the Deed Records of Comal County, Texas.

RECEIVED

NOV 20 2018

I

The Texas Health and Safety Code, Chapter 366 authorizes the Texas Commission on Environmental Quality (TCEQ) to regulate on-site sewage facilities (OSSFs). Additionally, the Texas Water Code (TWC), § 5.012 and § 5.013, gives the commission primary responsibility for implementing the laws of the State of Texas relating to water and adopting rules necessary to carry out its powers and duties under the TWC. The commission, under the authority of the TWC and the Texas Health and Safety code, requires owner's to provide notice to the public that certain types of OSSFs are located on specific pieces of property. To achieve this notice, the commission requires a recorded affidavit. Additionally, the owner must provide proof of the recording to the OSSF permitting authority. This recorded affidavit is not a representation or warranty by the commission of the suitability of this OSSF, nor does it constitute any guarantee by the commission that the appropriate OSSF was installed.

COMAL COUNTY ENGINEER

II

An OSSF requiring a maintenance contract, according to 30 Texas Administrative Code §285.91(12) will be installed on the property described as (insert legal description):

7 UNIT/PHASE/SECTION            BLOCK 408 LOT            SUMMIT EXTENSION            SUBDIVISION

IF NOT IN SUBDIVISION:            ACREAGE            SURVEY

The property is owned by (insert owner's full name): JIM KAUTZ & MELISSA KAUTZ

This OSSF must be covered by a continuous maintenance contract for the first two years. After the initial two-year service policy, the owner of an aerobic treatment system for a single family residence shall either obtain a maintenance contract within 30 days or maintain the system personally.

Upon sale or transfer of the above-described property, the permit for the OSSF shall be transferred to the buyer or new owner. A copy of the planning materials for the OSSF can be obtained from the Comal County Engineer's Office.

WITNESS BY HAND(S) ON THIS 9 DAY OF November, 2018

[Signature]  
Owner(s) signature(s)

Jim Kautz  
Melissa Kautz  
Owner (s) Printed name (s)

Jim + Melissa Kautz  
November, 2018  
[Signature]  
Notary Public Signature

SWORN TO AND SUBSCRIBED BEFORE ME ON THIS 9 DAY OF

THIS AREA FOR COMAL COUNTY CLERK RECORDING PURPOSES ONLY

Filed and Recorded  
Official Public Records  
Bobbie Koepf, County Clerk  
Comal County, Texas  
11/20/2018 11:41:05 AM  
TERRI 1 Page(s)  
201806044913



(Notary Seal Here)



Bobbie Koepf



**Countryside Construction, Inc.**  
**300 Chapman Parkway, Canyon Lake, TX. 78133**  
**Phone: 830-899-2615 or 1-888-379-3721 Fax: 830-899-6662**  
**Septic System Service Agreement**

In consideration of payment for this service contract, we will abide by and agree to its terms and conditions:

Name: JIM KAUTZ & MELISSA KAUTZ Address: 1360 HILLTOP RIDGE  
Sub-Div./County: SUMMIT EXTENSION / COMAL City, State-Zip: NEW BRAUNFELS, TX 78132  
Permit #: \_\_\_\_\_ Model #: CLEARSTREAM 600NC3T Serial #: \_\_\_\_\_  
Phone #: 830-822-0373

RECEIVED

NOV 20 2018

COUNTY ENGINEER

( X ) Initial Two Year Service Agreement & Two Year Limited Warranty ( ) One Year Service Agreement

The effective date of this initial maintenance contract shall be the date the License to Operate is issued.

Legal Description: SUMMIT EXTENSION, PHASE 7, LOT 408

This contract will be in effect FROM LTO TO \_\_\_\_\_ and will provide the following:

- A: An inspection/service call every (4) four months which will include: inspection, adjustments and servicing of the mechanical & electrical components as necessary to insure proper function of the system.
- B: An effluent quality inspection consisting of a visual check for color, turbidity, scum, overflow and odor.
- C: The property owner is responsible for "purchasing and keeping chlorine" in the chlorinator, (if applicable). If the chlorine test reveals "No Chlorine" in the system, the property owner may incur an additional cost.
- D: If any improper operation is observed (which cannot be corrected at that time) the property owner will be notified immediately of the conditions and the estimated cost.
- E: The response time to a complaint by the property owner regarding operation of the system, shall be within "48 hours," from the time of notification.
- F: ANY PARTS, WARRANTY OR NON-WARRANTY, OR FREIGHT CHARGES, LABOR OR SERVICE CALLS DUE NOT PAID FOR REMAIN THE PROPERTY OF COUNTRYSIDE CONSTRUCTION AND COULD RESULT IN REPOSSION OF PARTS BY COUNTRYSIDE CONSTRUCTION.
- G: THE SIGNING OF THIS SERVICE AGREEMENT AUTHORIZES COUNTRYSIDE CONSTRUCTION TO ENTER THE PROPERTY TO EXECUTE ALL TERMS OF THIS CONTRACT.

Countryside Construction, Inc., will warranty installation of the septic system to be according to state and county regulations and the designs approved by the county. **HOMEOWNER WILL BE RESPONSIBLE FOR SERVICE CALLS, LABOR AND SHIPPING COSTS ON ANY "WARRANTED PARTS" EXCHANGED DURING WARRANTY.** All other components will be according to manufacture's warranties.

**Important:** As Countryside Construction, Inc. cannot control what or how much effluent goes into this septic system, we cannot warranty how the system will function. Refer to manufacturers or installer's instructions, for suggestions on septic operation. This service agreement does not cover the cost of "Service Calls, Labor or Materials that are required or parts out of warranty, the failure to maintain electrical power to the system, sprinklers that are broken, leaking, stopped-up or otherwise mal-functioning; or sewage flows exceeding the hydraulic/organic design capabilities and the input of non-biodegradable materials (solvents, grease, oil, paints, etc.), or any usage contrary to the requirements as advised by authorized service representative. Laboratory test work is available at an additional cost. Chlorine, filters, or parts that are out of warranty are available at a reasonable cost.

This contract does not include the pumping of a tank or of any compartment of a tank, or settlement of soil on or around any part of the system regardless of reason:

Violations of the warranty also include: Disconnecting the alarm, restricting ventilation to the aerator, over loading the system above its rated capacity; or flooding by external means. Rodent, insect or Fire Ant damage or any other form of unusual abuse is a violation.

A renewal service contract should be "**Activated**" (30) **thirty days** before expiration of existing contract. We will contact property owner prior to expiration of existing contract.

Serviced by: Countryside Construction Inc.  
Walker Chapman - Operator Licensee #2929

  
Property Owner Signature \_\_\_\_\_ Print Name Jim Kautz Date: 11/9/18

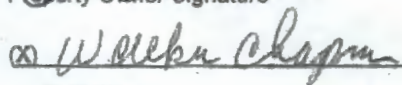
  
Date: 11/9/18 Authorized Service Representative (revised 10/9/09)



**ON-SITE SEWERAGE FACILITY  
SOIL EVALUATION REPORT INFORMATION**

Date Soil Survey Performed: November 06, 2018

Site Location: SUMMIT EXTENSION, PHASE 7, LOT 408

Proposed Excavation Depth: N/A

RECEIVED  
NOV 20 2018  
COUNTY ENGINEER

**Requirements:**

At least two soil excavations must be performed on the site, at opposite ends of the proposed disposal area. Locations of soil boring or dug pits must be shown on the site drawing. For subsurface disposal, soil evaluations must be performed to a depth of at least two feet below the proposed excavation depth. For surface disposal, the surface horizon must be evaluated. Describe each soil horizon and identify any restrictive features on the form. Indicate depths where features appear.

SOIL BORING NUMBER		SURFACE EVALUATION				
Depth (Feet)	Texture Class	Soil Texture	Gravel Analysis	Drainage (Mottles/ Water Table)	Restrictive Horizon	Observations
0	III	CLAY LOAM	N/A	NONE OBSERVED	LIMESTONE @ 4"	BROWN
1						
2						
3						
4						
5						

SOIL BORING NUMBER		SURFACE EVALUATION				
Depth (Feet)	Texture Class	Soil Texture	Gravel Analysis	Drainage (Mottles/ Water Table)	Restrictive Horizon	Observations
0	SAME		AS		ABOVE	
1						
2						
3						
4						
5						

I certify that the findings of this report are based on my field observations and are accurate to the best of my ability.

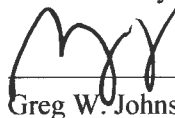
  
Greg W. Johnson, P.E. 67587-F2585, S.E. 11561

11/06/18  
Date





**REVISED**

12:16 pm, Mar 07, 2019

#108384

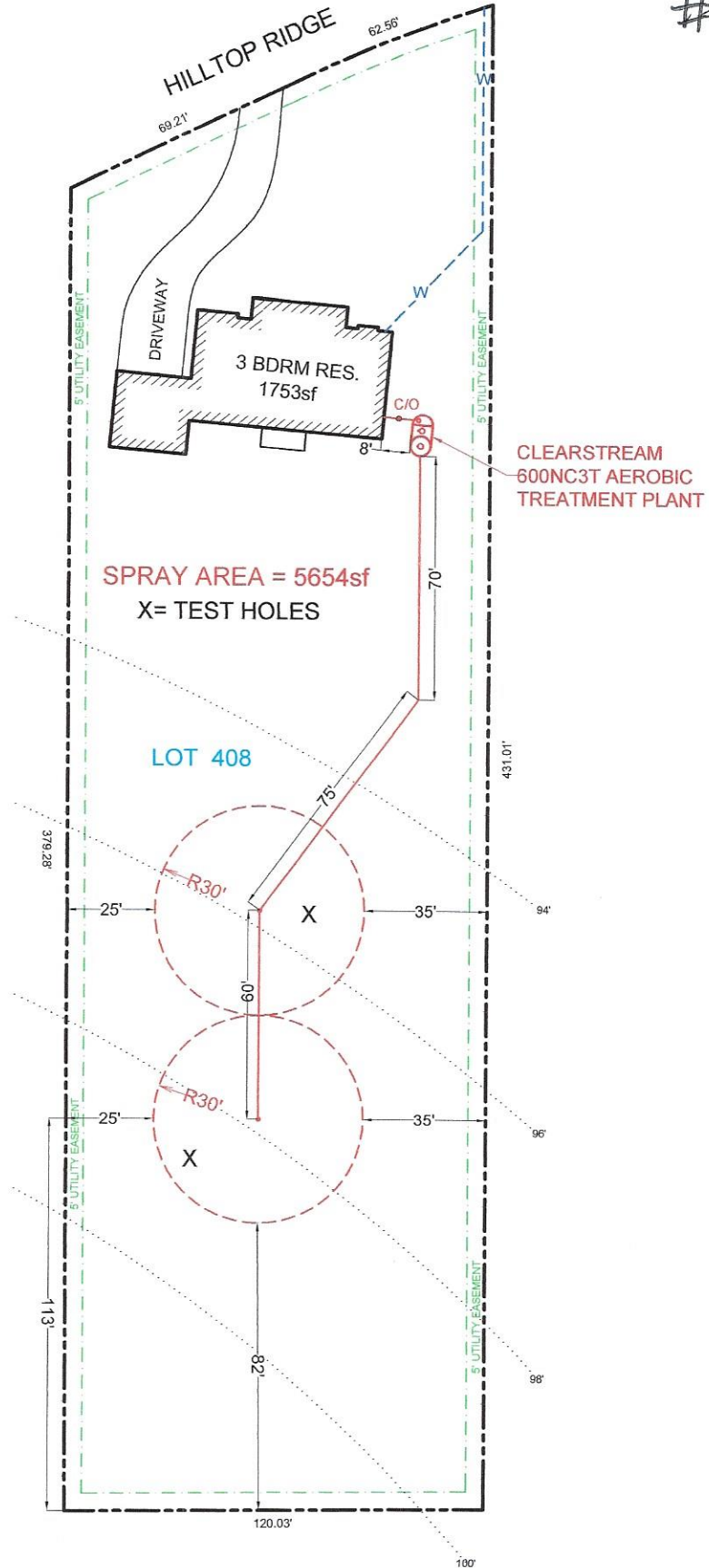

OWNER: JIM & MELISSA KAUTZ		DRAWN BY: EJS III	
STREET ADDRESS: 1360 HILLTOP RIDGE			
LEGAL DESC: SUMMIT EXTENSION	UNIT/SECTION/PHASE: 7	BLOCK:	LOT: 408
PREPARED BY: GREG W. JOHNSON, P.E. F#002585	SCALE: 1"=50'	DATE: 11/7/2018	REVISED: 3/6/2019

**TANK NOTES:**

Tanks must be set to allow a minimum of 1/8" per foot fall from the residence.

Tightlines to the tank shall be SCH-40 PVC.

A two way sanitary tee is required between residence and tank.

A minimum of 4" of sand, sandy loam, clay loam free of rock shall be placed under and around tanks

Tanks must be left uncovered and full of water for inspection by the permitting authority.

RECEIVED

NOV 20 2018

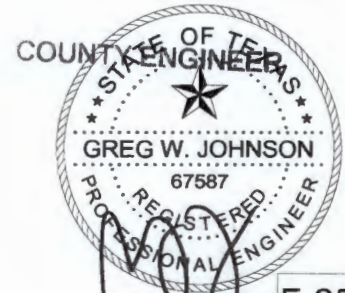

F-2585

4/6/18

**ALL WIRING MUST BE IN COMPLIANCE WITH THE MOST RECENT NATIONAL ELECTRIC CODE**

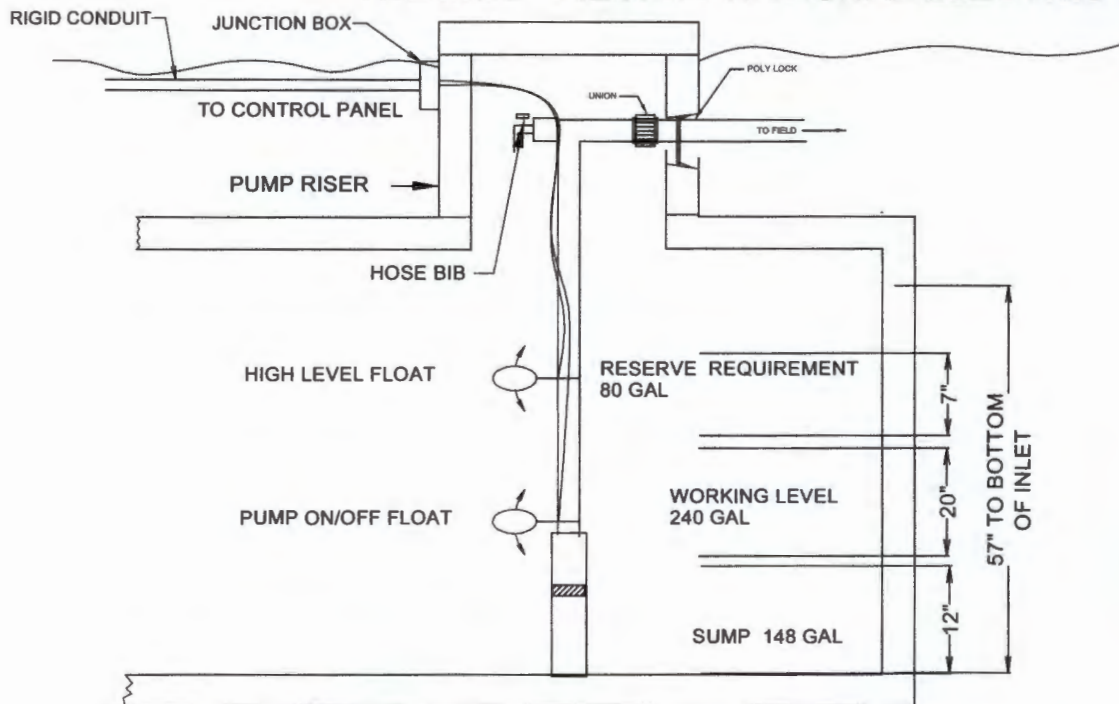

**TYPICAL PUMP TANK CONFIGURATION  
CLEARSTREAM 600NC3T W/ 700 GAL PUMP TANK**



RECEIVED  
NOV 20 2018  
COUNTY ENGINEER

358

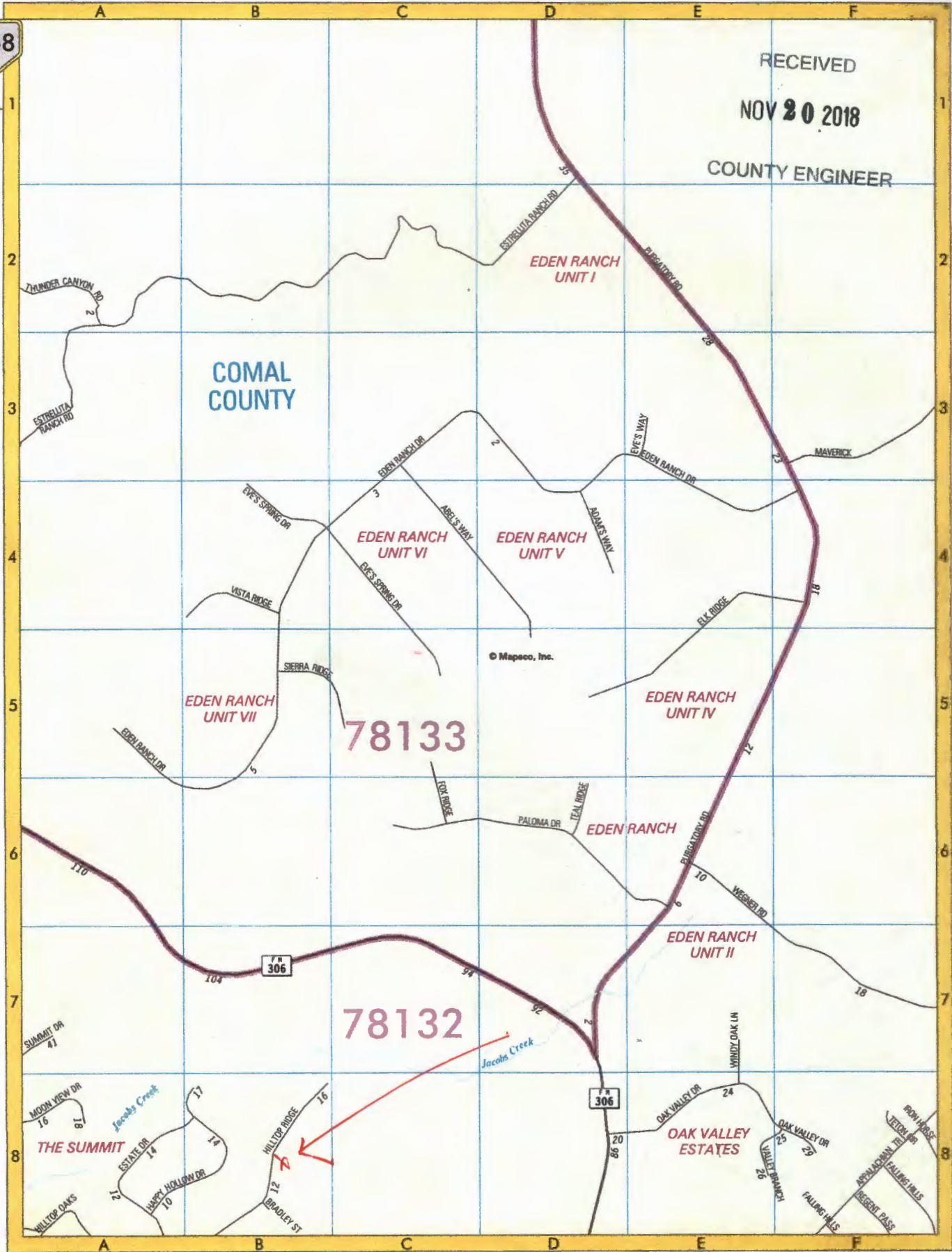

CONTINUED ON MAP 357

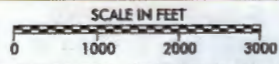
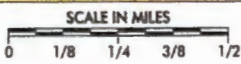

**VOID**

RECEIVED

NOV 20 2018

COUNTY ENGINEER

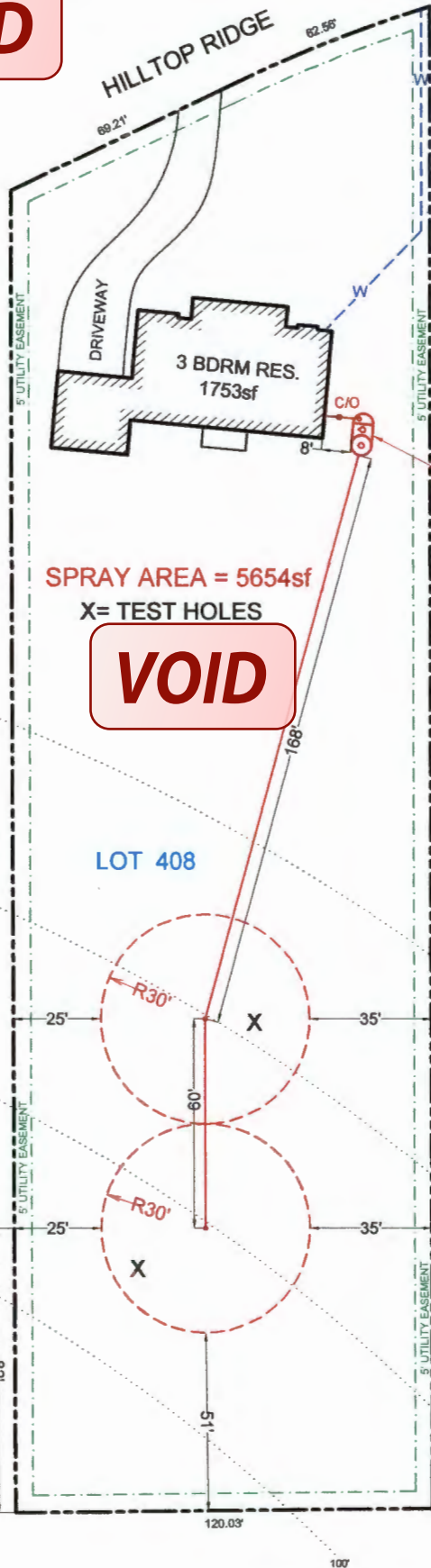

CLEARSTREAM  
600NC3T AEROBIC  
TREATMENT PLANT

SPRAY AREA = 5654sf

X= TEST HOLES

**VOID**

LOT 408



OWNER: JIM & MELISSA KAUTZ		DRAWN BY: EJS III	
STREET ADDRESS: 1360 HILLTOP RIDGE			
LEGAL DESC: SUMMIT	UNIT/SECTION/PHASE: 7	BLOCK:	LOT: 408
PREPARED BY: GREG W. JOHNSON, P.E.	F#002585	SCALE: 1"=50'	DATE: 11/7/2018
		REVISED:	

**VOID**



TTTGF# 6026NB / Clear NF

NOTICE OF CONFIDENTIALITY RIGHTS: IF YOU ARE A NATURAL PERSON, YOU MAY REMOVE OR STRIKE ANY OR ALL OF THE FOLLOWING INFORMATION FROM ANY INSTRUMENT THAT TRANSFERS AN INTEREST IN REAL PROPERTY BEFORE IT IS FILED FOR RECORD IN THE PUBLIC RECORDS: YOUR SOCIAL SECURITY NUMBER OR YOUR DRIVER'S LICENSE NUMBER.

GENERAL WARRANTY DEED

THE STATE OF TEXAS §  
§ KNOW ALL BY THESE PRESENTS: THAT  
COUNTY OF COMAL §

PAUL A. PERALEZ AND MOSES A. RAMOS, A MARRIED COUPLE ("Grantor"), whose mailing address is 1431 W. REXWOOD, SAN ANTONIO, TX 78201

for and in consideration of the sum of TEN AND NO/100 DOLLARS (\$10.00) cash and other good and valuable consideration to Grantor in hand paid by JIM KAUTZ AND MELISSA KAUTZ ("Grantee"), whose mailing address is 2325 6<sup>th</sup> ST N Texas City, TX 77590

the receipt and sufficiency of which consideration is hereby acknowledged and confessed, has GRANTED, SOLD AND CONVEYED, and by these presents does GRANT, SELL AND CONVEY unto Grantee, the following real property, together with all improvements thereon (the "Property"):

LOT 408 OF SUMMIT EXTENSION PHASE 7, A SUBDIVISION IN COMAL COUNTY, TEXAS ACCORDING TO THE PLAT RECORDED IN VOLUME 9, PAGES 216-218 OF THE MAP AND PLAT RECORDS OF COMAL COUNTY, TEXAS.

TO HAVE AND TO HOLD the Property, together with all and singular the rights and appurtenances thereto in any way belonging to have and to hold unto Grantee, and Grantee's heirs, successors and assigns, forever; and Grantor does hereby bind Grantor and Grantor's heirs and successors to WARRANT AND FOREVER DEFEND all and singular the Property unto Grantee, Grantee's heirs, successors and assigns, against every person whomsoever lawfully claiming or to claim the same, or any part thereof, provided, however, that this conveyance is made by Grantor and accepted by Grantee subject to (i) the liens securing payment of ad valorem taxes for the current and all subsequent years and (ii) easements, liens, reservations, covenants, conditions, and restrictions of record in Comal County, Texas, or visible or apparent on the ground to the extent the foregoing affect the Property. By acceptance of this deed, Grantee assumes and agrees to perform all of the obligations of Grantor under said easements, reservations, covenants, conditions and restrictions, and agrees to pay and indemnifies and agrees to hold Grantor harmless from and against all ad valorem taxes relating to the Property, for the current and all subsequent years.

When the context requires, singular nouns and pronouns include the plural.

RECEIVED  
NOV 20 2018  
COUNTY ENGINEER

EXECUTED AS OF AND EFFECTIVE the 9<sup>th</sup> day of August, 2018.

**GRANTOR:**

Paul A. Perez  
PAUL A. PERALEZ

Moses A. Ramos  
MOSES A. RAMOS

**ACKNOWLEDGEMENT**

STATE OF TEXAS §  
COUNTY OF Bexar §

Before me, a Notary Public, on the 9<sup>th</sup> day of August, 2018, personally appeared PAUL A. PERALEZ AND MOSES A. RAMOS, who acknowledged that they did sign the foregoing instrument, and acknowledged to me that they executed the same for the uses and purposes and consideration therein expressed.

RECEIVED  
NOV 20 2018  
COUNTY ENGINEER

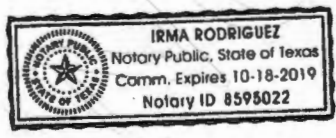

Irma Rodriguez  
Notary Public, State of Texas

**PREPARED IN THE OFFICE OF:**

THE HAY LEGAL GROUP PLLC  
611 W. 5th Street, Suite 300  
Austin, Texas 78701

Filed and Recorded  
Official Public Records  
Bobbie Koepf, County Clerk  
Comal County, Texas  
08/10/2018 09:43:36 AM  
LAURA 2 Pages(s)  
201806031568



Bobbie Koepf



COUNTRYSIDE CONSTRUCTION, INC.  
 300 CHAPMAN PARKWAY  
 CANYON LAKE, TX 75133

Phone: 830-899-2615  
 Fax: 830-899-0652

### TESTING AND REPORTING RECORD

This Testing and Reporting Record shall be completed, signed and dated at each inspection.

1. Inspection Date: JULY 30, 2019 Installed: 3/20/2019 Service Expires: 3/20/2021

**BILLING ADDRESS**

JIM & MELISSA KAUTE  
 1360 HILLTOP RIDGE  
 NEW BRAUNFELS, TX 78130

**PHYSICAL ADDRESS**

1360 HILLTOP RIDGE  
 NEW BRAUNFELS, TX 78130

TELEPHONE 281-841-3164  
 ALT. PHONE

LOT LT 400

PERMIT # 108384  
 COUNTY COMAL  
 S# 1906776  
 MAP# NOT AVAILABLE

SUBDIVISION SUBMIT EXTENSION Manufacturer: CLEARSTEM 0000001

**NOTES**

TYPE OF SYSTEM: SPRAY

Inspected Item	Operational	Temperature	Remarks (Make of Parts or Details noted, and system just if components replaced)
Operators OCPM Compressor PSI (Record Pressure Reading)	<u>31.25</u>		
Filters	<u>/</u>		
Irrigation Pumps	<u>/</u>		<u>CHECKED pump, Alarm</u>
Recirculation Pumps	<u>N/A</u>		
Disinfection Device	<u>/</u>		<u>FLOATS, SPRINKLERS,</u>
Chlorine Supply	<u>/</u>		<u>chlorine,</u>
Electrical Controls	<u>/</u>		
Distribution System	<u>/</u>		
Sprayfield Vegetation	<u>/</u>		<u>COMPRESSOR/FILTER</u>
Back Flush, Drop Field, if applicable	<u>N/A</u>		
Other as Noted	<u>/</u>		
Access Posts are Required	<u>Yes</u>	No	

**2. Tests required and results:**

	Required		Results	Test Method
	Yes	No		
EOD (Grab)				
TSS (Grab)		<u>/</u>	<u>CLEAR</u>	
Chl (Grab)	<u>/</u>			
Fecal Coliform				

Copies of this report have been forwarded to the following: COMAL county: homeowner

Maintenance Technician: Thomas 11

Date of completion: 6-11-19 Start Job Time: Stop Job Time:

Maintenance Provider: Walton Company

EDMUNTRYSIDE CONSTRUCTION, INC.  
 300 CHAPMAN PARKWAY  
 CANYON LAKE, TX 75133

Phone: 830-899-2615  
 Fax: 830-899-6662

TESTING AND REPORTING RECORD

The Device and Reporting Record will be completed, signed and dated for each inspection.

Inspection Date: NOVEMBER 03, 2019 Inspected By: JEFFREY WOODRUFF Service Engineer: 30072001

BILLING ADDRESS

OFFICIAL ADDRESS

TM & MELISSA KADTZ  
 100 HILTOP RIDGE  
 NEW BRAUNFELS, TX 78132

100 HILTOP RIDGE  
 NEW BRAUNFELS, TX 78132

TELEPHONE: 361-841-9104  
 ALT PHONE:

LIT IT AS

PERMIT # 18384  
 COUNTY DOWALL  
 ST 1900706  
 CITY NOT AVAILABLE

SECTION: SINKHOLE EXPANSION MANUFACTURER: CLEARSTANI DOWCORP

NOTES  
 TYPE OF SYSTEM: SPRAY

Inspected Item:

Operational

1. Action taken if specific or needed repairs or equipment had to be replaced.

Appl's: 5000 PSI Compressor PN  
 Factory Pressure Setting:

1.5

Insulation Applied:

N/A

Insulation Device:

1

Checked power Alarms,  
 Floats, Chlorine,

Electrical Control:

1

SPRINKLERS

Manufacturer System:

1

Compressor

Backflow Prevention:

N/A

Other as Noted:

1

N

3 Tests Required and Results:

	Required	Results	Test
NO	NO	YES! open 15 min & close	Leakage
NO	1	OK	
NO	1	OK	
NO	1	OK	
NO	1	OK	

Copies of this report have been forwarded to the following: CONTACT OWNER / MANAGER:

1 Approved by Technician:

Thomas

11

Date of completion:

12/5/19

4:35

300 IN TEST

4:40

1 Approved by Owner:

Walter Chapman



COUNTRYSIDE CONSTRUCTION, INC.  
 300 CHAPMAN PARKWAY  
 CANYON LAKE, TX 78133

Phone: 830-899-2615  
 Fax: 830-899-6662

TESTING AND REPORTING RECORD

This Testing and Reporting Record shall be completed, signed and dated after each inspection.

1. Inspection Date: JULY 20, 2020 Installed: 3/20/2019 Service Expires: 3/20/2021

BILLING ADDRESS:  
 JIM & MELISSA KAUTZ  
 1360 HILLTOP RIDGE  
 NEW BRAUNFELS, TX 78132

PHYSICAL ADDRESS:  
 1360 HILLTOP RIDGE  
 NEW BRAUNFELS, TX 78132

TELEPHONE: 281-841-3104  
 ALT. PHONE:

LOT: LT 408,

PERMIT#: 108384

COUNTY: COMAL

SN: 18060706

SUBDIVISION: SUMMIT EXTENSION

MEG: CLEARSTRM 600NC3T

MAPSCO: N/A

NOTES:

TYPE OF SYSTEM: SPRAY

Inspected Item: Operational Inoperative

Inspected Item:	Operational	Inoperative
Aerators		
SCFM/Compressors PSI (Record Pressure Reading)	3.0	
Filters	/	
Irrigation Pumps	/	
Recirculation Pumps	MA	
Disinfection Device	/	
Chlorine Supply	/	
Electrical Circuits	/	
Distribution System	/	
Sprayfield Vegetation	/	
Back Flush Drip Field, if applicable	N/A	
Other as Noted		

2. Action taken or Repairs or  
 Needed repairs to system (list all  
 components replaced):

checked compressor

cleaned air filter

checked chlorine,

flows and sprinklers

set timer

SYSTEM OPERATING AS DESIGNED? Y/N

Address Posts are Secured Yes No

3. Tests required and results:

	Required		Results mg/l mpn/100ml or Trace	Test Method
	Yes	No		
BOD (Grab)				
TSS (Grab)			CLPR	grab
Cl (Grab)	-		1.0	ota
Fecal Coliform				

Copies of this report have been forwarded to the following: COMAL county / homeowner.

Maintenance Technician: Mistle

2

Date of completion: 07-30-20 Start Job Time: \_\_\_\_\_ Stop Job Time: \_\_\_\_\_

Maintenance Provider: walton chapman

COUNTRYSIDE CONSTRUCTION, INC.  
 300 CHAPMAN PARKWAY  
 CANYON LAKE, TX 78133

Phone: 830-899-2615  
 Fax: 830-899-6662

### TESTING AND REPORTING RECORD

This Testing and Reporting Record shall be completed, signed and dated after each inspection.

1. Inspection Date: MARCH 20, 2020 Installed: 3/20/2019 Service Expires: 3/20/2021

BILLING ADDRESS:  
 JIM & MELISSA KAUTZ  
 1360 HILLTOP RIDGE  
 NEW BRAUNFELS, TX 78132

PHYSICAL ADDRESS:  
 1360 HILLTOP RIDGE  
 NEW BRAUNFELS, TX 78132

TELEPHONE: 281-841-3104  
 ALT. PHONE:

LOT: LT 408,

PERMIT# 108384

COUNTY: COMAL

SN: 18060706

MAPSCO: N/A

SUBDIVISION: SUMMIT EXTENSION

MFG: CLEARSTRM 600NC3T

NOTES:

TYPE OF SYSTEM: SPRAY

Inspected Item:	Operational	Inoperative
Aerators		
SCFM/Compressors PSI		
Record Pressure Reading	3.0	
Filters	/	
Irrigation Pumps	/	
Recirculation Pumps	N/A	
Disinfection Device	/	
Chlorine Supply	/	
Electrical Circuits	/	
Distribution System	/	
Sprayfield Vegetation	/	
Back Flush Drip Field, if applicable	N/A	
Other as Noted		

2. Action taken or Repairs or Needed repairs to system (list all components replaced):

Checked compressor  
 cleaned air filter  
 checked chlorine,  
 floats and sprinklers  
 set timer

SYSTEM OPERATING AS DESIGNED? Y/N

Access Posts are Secured  Yes  No

3. Tests required and results:

	Required		Results mg/l mpn/100ml or Trace	Test Method
	Yes	No		
BOD (Grab)				
TSS (Grab)		/	Clear	grab
Cl (Grab)			1.2	oto
Fecal Coliform				

Copies of this report have been forwarded to the following: COMAL county / homeowner.

Maintenance Technician: Wisk

2

Date of completion: 04-29-20 Start Job Time: \_\_\_\_\_ Stop Job Time: \_\_\_\_\_

Maintenance Provider: Waebn Chapman



COUNTRYSIDE CONSTRUCTION, INC.  
 300 CHAPMAN PARKWAY  
 CANYON LAKE, TX 78133

Phone: 830-899-2615  
 Fax: 830-899-6662

**TESTING AND REPORTING RECORD**

This Testing and Reporting Record shall be completed, signed and dated after each inspection.

1. Inspection Date: NOVEMBER 20, 2020 Installed: 3/20/2019 Service Expires: 3/20/2021

BILLING ADDRESS:  
 JIM & MELISSA KAUTZ  
 1360 HILLTOP RIDGE  
 NEW BRAUNFELS, TX 78132

PHYSICAL ADDRESS:  
 1360 HILLTOP RIDGE  
 NEW BRAUNFELS, TX 78132

TELEPHONE: 281-841-3104  
 ALT. PHONE:

LOT: LT 408,

PERMIT#: 108384  
 COUNTY: COMAL  
 SN: 18060706  
 MAPSCO: N/A

SUBDIVISION: SUMMIT EXTENSION MFG: CLEARSTRM 600NC3T

NOTES:  
 TYPE OF SYSTEM: SPRAY

Inspected Item: Operational Inoperative

Inspected Item:	Operational	Inoperative
Aerators		
SCFM/Compressors PSI (Record Pressure Reading)	3.0	
Filters	/	
Irrigation Pumps	/	
Recirculation Pumps	N/A	
Disinfection Device	/	
Chlorine Supply	/	
Electrical Circuits	/	
Distribution System	/	
Sprayfield Vegetation	/	
Back Flush Drip Field, if applicable	N/A	
Other as Noted		

2. Action taken or Repairs or Needed repairs to system (list all components replaced):

Checked Compressor  
 cleaned air filter  
 checked chlorine,  
 floats and sprinklers  
 set timer

SYSTEM OPERATING AS DESIGNED?  Y/N

Access Posts are Secured

Yes

No

3. Tests required and results:

	Required		Results mg/l mpn/100ml or Trace	Test Method
	Yes	No		
BOD (Grab)				
TSS (Grab)		/	Clear	y grab
Cl (Grab)	/		1.0	oto
Fecal Coliform				

Copies of this report have been forwarded to the following COMAL county / homeowner.

Maintenance Technician: Mike

2

Date of completion: 2-14-20

Start Job Time: \_\_\_\_\_

Stop Job Time: \_\_\_\_\_

Maintenance Provider: Walker Chapman

COUNTRYSIDE CONSTRUCTION, INC.  
 300 CHAPMAN PARKWAY  
 CANYON LAKE, TX 78133

Phone: 830-899-2615  
 Fax: 830-899-6662

**TESTING AND REPORTING RECORD**

This Testing and Reporting Record shall be completed, signed and dated after each inspection.

1. Inspection Date: MARCH 20, 2021 Installed: 3/20/2019 Service Expires: 3/20/2021

BILLING ADDRESS:  
 JIM & MELISSA KAUTZ  
 1360 HILLTOP RIDGE  
 NEW BRAUNFELS, TX 78132

PHYSICAL ADDRESS:  
 1360 HILLTOP RIDGE  
 NEW BRAUNFELS, TX 78132

TELEPHONE: 281-841-3104  
 ALT. PHONE:

LOT: LT 408,

PERMIT#: 108384  
 COUNTY: COMAL  
 SN: 18060706  
 MAPSCO: N/A

SUBDIVISION: SUMMIT EXTENSION MFG: CLEARSTRM 600NC3T

NOTES:  
 TYPE OF SYSTEM: SPRAY

Inspected Item:	Operational	Inoperative
Aerators		
SCFM/Compressors PSI (Record Pressure Reading)	2.0	
Filters	-	
Irrigation Pumps	-	
Recirculation Pumps	NA	
Disinfection Device	-	
Chlorine Supply	-	
Electrical Circuits	-	
Distribution System	-	
Sprayfield Vegetation	-	
Back Flush Drip Field, if applicable	NA	
Other as Noted		

2. Action taken or Repairs or  
 Needed repairs to system (list all  
 components replaced):

Cleaned air filter

CKD. Pump, floats

Alarm, & sprayers

CKD. Chlorine

SYSTEM OPERATING AS DESIGNED?  Y  N

Access Posts are Secured

Yes

No

3. Tests required and results:

	Required		Results mg/l mpn/100mi or Trace	Test Method
	Yes	No		
BOD (Grab)				
TSS (Grab)		✓		
Cl (Grab)	✓		1.0	OTO
Fecal Coliform				

Copies of this report have been forwarded to the following: COMAL county / homeowner.

Maintenance Technician: Walker

4

Date of completion: 3-18-21 Start Job Time: \_\_\_\_\_ Stop Job Time: \_\_\_\_\_

Maintenance Provider: Walkers Construction