



Comal County

OFFICE OF COMAL COUNTY ENGINEER

License to Operate On-Site Sewage Treatment and Disposal Facility

Issued This Date: 04/25/2019 Permit Number: 108642

Location Description: 581 LOST CREEK DR BULVERDE, TX 78163
Subdivision: Comal Trace
Unit: 2
Lot: 37
Block:
Acreage:

Type of System: Aerobic Surface Irrigation

Issued to: Kristy L. Curl

This license is authorization for the owner to operate and maintain a private facility at the location described in accordance to the rules and regulations for on-site sewerage facilities of Comal County, Texas, and the Texas Commission on Environmental Quality.

The license grants permission to operate the facility. It does not guarantee successful operation. It is the responsibility of the owner to maintain and operate the facility in a satisfactory manner.

Alterations to this permit including, but not limited to:

- Increase in the square feet of living area
- Increase in the number of bedrooms
- A change of use (i.e. residential to commercial)
- Relocation of system components (including the relocation of spray heads)
- Installation of landscaping
- Adding new structures to the system

may require a new permit. It is the responsibility of the owner to apply for a new permit, if applicable.

Inspection and licensing of a facility indicates only that the facility meets certain minimum requirements. It does not impede any governmental entity in taking the proper steps to prevent or control pollution, to abate nuisance, or to protect the public health.

This license to operate is valid for an indefinite period. The holder may transfer it to a succeeding owner, provided the facility has not been remodeled and is functioning properly.

Licensing Authority
Comal County Environmental Health

Signature of Michael Lopez, OS8497
ENVIRONMENTAL HEALTH INSPECTOR

Signature of Brenda J. ...
ENVIRONMENTAL HEALTH COORDINATOR

OS0007722

Comal County Environmental Health OSSF Inspection Sheet

Installer Name: MT Septic OSSF Installer #: _____

1st Inspection Date: 4/1/19 2nd Inspection Date: _____ 3rd Inspection Date: 4/25/19

Inspector Name: Mike T. Inspector Name: _____ Inspector Name: Mike T.

Permit#: 108642 Address: Comal Trace / 581 Lost Creek Dr.

No.	Description	Answer	Citations	Notes	1st Insp.	2nd Insp.	3rd Insp.
1	SITE AND SOIL CONDITIONS & SETBACK DISTANCES Site and Soil Conditions Consistent with Submitted Planning Materials	✓	285.31(a) 285.30(b)(1)(A)(iv) 285.30(b)(1)(A)(v) 285.30(b)(1)(A)(iii) 285.30(b)(1)(A)(ii) 285.30(b)(1)(A)(i)		4/1/19		4/25/19
2	SITE AND SOIL CONDITIONS & SETBACK DISTANCES Setback Distances Meet Minimum Standards	✓	285.91(10) 285.30(b)(4) 285.31(d)				
3	SEWER PIPE Proper Type Pipe from Structure to Disposal System (Cast Iron, Ductile Iron, Sch. 40, SDR 26)	✓	285.32(a)(1)				
4	SEWER PIPE Slope from the Sewer to the Tank at least 1/8 Inch Per Foot	✓	285.32(a)(3)				
5	SEWER PIPE Two Way Sanitary - Type Cleanout Properly Installed (Add. C/O Every 100' &/or 90 degree bends)	✓	285.32(a)(5)				
6	PRETREATMENT Installed (if required) TCEQ Approved List PRETREATMENT Septic Tank(s) Meet Minimum Requirements		285.32(b)(1)(G) 285.32(b)(1)(E)(iii) 285.32(b)(1)(E)(iv) 285.32(b)(1)(F) 285.32(b)(1)(B) 285.32(b)(1)(C)(i) 285.32(b)(1)(C)(ii) 285.32(b)(1)(D) 285.32(b)(1)(E) 285.32(b)(1)(A) 285.32(b)(1)(E)(ii)(ii) 285.32(b)(1)(E)(i) 285.32(b)(1)(E)(ii)(i)				
7	PRETREATMENT Grease Interceptors if required for commercial		285.34(d)				

MT-4/1/19
Tanks set only, leveled.

MT-4/25/19
operational & covered.

**Comal County Environmental Health
OSSF Inspection Sheet**

No.	Description	Answer	Citations	Notes	1st Insp.	2nd Insp.	3rd Insp.
8	SEPTIC TANK Tank(s) Clearly Marked SEPTIC TANK If Single Tank, 2 Compartments Provided with Baffle SEPTIC TANK Inlet Flowline Greater than 3" and "T" Provided on Inlet and Outlet SEPTIC TANK Septic Tank(s) Meet Minimum Requirements		285.32(b)(1)(E) 285.91(2) 285.32(b)(1)(F) 285.32(b)(1)(E)(iii) 285.32(b)(1)(E)(ii)(II) 285.32(b)(1)(E)(ii)(I) 285.32(b)(1)(E)(i) 285.32(b)(1)(D) 285.32(b)(1)(C)(ii) 285.32(b)(1)(C)(i) 285.32(b)(1)(B) 285.32(b)(1)(A) 285.32(b)(1)(E)(iv)				
9	ALL TANKS Installed on 4" Sand Cushion/ Proper Backfill Used		285.32(b)(1)(F) 285.32(b)(1)(G) 285.34(b)				
10	SEPTIC TANK Inspection / Clean Out Port & Risers Provided on Tanks Buried Greater than 12" Sealed and Capped		285.38(d)				
11	SEPTIC TANK Secondary restraint system provided SEPTIC TANK Riser permanently fastened to lid or cast into tank SEPTIC TANK Riser cap protected against unauthorized intrusions		285.38(d) 285.38(e)				
12	SEPTIC TANK Tank Volume Installed						
13	PUMP TANK Volume Installed						
14	AEROBIC TREATMENT UNIT Size Installed	✓		800	4/1/19		4/25/19
15	AEROBIC TREATMENT UNIT Manufacturer AEROBIC TREATMENT UNIT Model Number	✓		Prof 10			
16	DISPOSAL SYSTEM Absorptive		285.33(a)(4) 285.33(a)(1) 285.33(a)(2) 285.33(a)(3)				
17	DISPOSAL SYSTEM Leaching Chamber		285.33(a)(1) 285.33(a)(3) 285.33(a)(4) 285.33(a)(2)				
18	DISPOSAL SYSTEM Evapo-transpirative		285.33(a)(3) 285.33(a)(4) 285.33(a)(1) 285.33(a)(2)				

**Comal County Environmental Health
OSSF Inspection Sheet**

No.	Description	Answer	Citations	Notes	1st Insp.	2nd Insp.	3rd Insp.
19	DISPOSAL SYSTEM Drip Irrigation		285.33(a)(1) 285.33(a)(3) 285.33(a)(4) 285.33(a)(2)				
20	DISPOSAL SYSTEM Soil Substitution.		285.33(d)(4)				
21	DISPOSAL SYSTEM Pumped Effluent		285.33(a)(3) 285.33(a)(1) 285.33(a)(2)				
22	DISPOSAL SYSTEM Gravelless Pipe		285.33(a)(3) 285.33(a)(2) 285.33(a)(4) 285.33(a)(1)				
23	DISPOSAL SYSTEM Mound		285.33(a)(3) 285.33(a)(1) 285.33(a)(2) 285.33(a)(4)				
24	DISPOSAL SYSTEM Other (describe) (Approved Design)		285.33(d)(6) 285.33(c)(4)				
25	DRAINFIELD Absorptive Drainline 3" PVC or 4" PVC						
26	DRAINFIELD Area Installed						
27	DRAINFIELD Level to within 1 inch per 25 feet and within 3 inches over entire excavation		285.33(b)(1)(A)(v)				
28	DRAINFIELD Excavation Width DRAINFIELD Excavation Depth DRAINFIELD Excavation Separation DRAINFIELD Depth of Porous Media DRAINFIELD Type of Porous Media						
29	DRAINFIELD Pipe and Gravel - Geotextile Fabric in Place		285.33(b)(1)(E)				
30	DRAINFIELD Leaching Chambers DRAINFIELD Chambers - Open End Plates w/Splash Plate, Inspection Port & Closed End Plates in Place (per manufacturers spec.)		285.33(c)(2)				
31	LOW PRESSURE DISPOSAL SYSTEM Adequate Trench Length & Width, and Adequate Separation Distance between Trenches		285.33(d)(1)(C)(i)				

**Comal County Environmental Health
OSSF inspection Sheet**

No.	Description	Answer	Citations	Notes	1st Insp.	2nd Insp.	3rd Insp.
32	EFFLUENT DISPOSAL SYSTEM Utilized Only by Single Family Dwelling EFFLUENT DISPOSAL SYSTEM Topographic Slopes < 2.0% EFFLUENT DISPOSAL SYSTEM Adequate Length of Drain Field (1000 Linear ft. for 2 bedrooms or Less & an additional 400 ft. for each additional bedroom) EFFLUENT DISPOSAL SYSTEM Lateral Depth of 18 inches to 3 ft. & Vertical Separation of 1ft on bottom and 2 ft. to restrictive horizon and ground water respectfully EFFLUENT DISPOSAL SYSTEM Lateral Drain Pipe (1.25 - 1.5" dia.) & Pipe Holes (3/16 - 1/4" dia. Hole Size) 5 ft. Apart		285.33(b)(3)(A) 285.33(b)(3)(A) 285.33(b)(3)(B) 285.91(13) 285.33(b)(3)(D) 285.33(b)(3)(F)				
33	AEROBIC TREATMENT UNIT is Aerobic Unit installed According to Approved Guidelines.	/	285.32(c)(1)		4/1/19		4/23/19
34	AEROBIC TREATMENT UNIT Inspection/Clean Out Port & Risers Provided AEROBIC TREATMENT UNIT Secondary restraint system provided AEROBIC TREATMENT UNIT Riser permanently fastened to lid or cast into tank AEROBIC TREATMENT UNIT Riser cap protected against unauthorized intrusions	/					
35	AEROBIC TREATMENT UNIT Chlorinator Properly Installed with Chlorine Tablets in Place.	/					
36	PUMP TANK is the Pump Tank an approved concrete tank or other acceptable materials & construction PUMP TANK Sampling Port Provided in the Treated Effluent Line PUMP TANK Check Valve and/or Anti-Siphon Device Present When Required PUMP TANK Audible and Visual High Water Alarm Installed on Separate Circuit From Pump	/					
37	PUMP TANK Inspection/Clean Out Port & Risers Provided PUMP TANK Secondary restraint system provided PUMP TANK Riser permanently fastened to lid or cast into tank PUMP TANK Riser cap protected against unauthorized intrusions	/					
38	PUMP TANK Secondary restraint system provided	/					
39	PUMP TANK Electrical Connections in Approved Junction Boxes / Wiring Buried	/					

**Comal County Environmental Health
OSSF Inspection Sheet**

No.	Description	Answer	Citations	Notes	1st Insp.	2nd Insp.	3rd Insp.
40	APPLICATION AREA Distribution Pipe, Fitting, Sprinkler Heads & Valve Covers Color Coded Purple?	✓	285.33(d)(2)(G)(III)(II)285.33(d)(2)(G)(III)(III)285.33(d)(2)(G)(v) 285.33(d)(2)(G)(III) 285.33(d)(2)(G)(iv) 285.33(d)(2)(G)(i) 285.33(d)(2)(G)(II) 285.33(d)(2)(G)(III)(I)		4/1/19 		4/25/19
41	APPLICATION AREA Low Angle Nozzles Used / Pressure is as required APPLICATION AREA Acceptable Area, nothing within 10 ft of sprinkler heads? APPLICATION AREA The Landscape Plan is as Designed	✓	285.33(d)(2)(G)(i) 285.33(d)(2)(A) 285.33(d)(2)(F)				
42	APPLICATION AREA Area Installed	✓					
43	PUMP TANK Meets Minimum Reserve Capacity Requirements						
44	PUMP TANK Material Type & Manufacturer						
45	PUMP TANK Type/Size of Pump Installed						

Comal County Environmental Health OSSF Inspection Sheet

Installer Name: M.T. Septic OSSF Installer #: _____

1st Inspection Date: 4/1/19 2nd Inspection Date: _____ 3rd Inspection Date: _____

Inspector Name: Mike T. Inspector Name: _____ Inspector Name: _____

Permit#: 108642 Address: Comal Trace / 581 Lost Creek Dr.

No.	Description	Answer	Citations	Notes	1st Insp.	2nd Insp.	3rd Insp.
1	SITE AND SOIL CONDITIONS & SETBACK DISTANCES Site and Soil Conditions Consistent with Submitted Planning Materials	✓	285.31(a) 285.30(b)(1)(A)(iv) 285.30(b)(1)(A)(v) 285.30(b)(1)(A)(iii) 285.30(b)(1)(A)(ii) 285.30(b)(1)(A)(i)		4/1/19		
2	SITE AND SOIL CONDITIONS & SETBACK DISTANCES Setback Distances Meet Minimum Standards	✓	285.91(10) 285.30(b)(4) 285.31(d)				
3	SEWER PIPE Proper Type Pipe from Structure to Disposal System (Cast Iron, Ductile Iron, Sch. 40, SDR 26)	✓	285.32(a)(1)				
4	SEWER PIPE Slope from the Sewer to the Tank at least 1/8 Inch Per Foot	✓	285.32(a)(3)				
5	SEWER PIPE Two Way Sanitary - Type Cleanout Properly Installed (Add. C/O Every 100' &/or 90 degree bends)	✓	285.32(a)(5)				
6	PRETREATMENT Installed (if required) TCEQ Approved List PRETREATMENT Septic Tank(s) Meet Minimum Requirements		285.32(b)(1)(G)285.32(b)(1)(E)(iii) 285.32(b)(1)(E)(iv) 285.32(b)(1)(F) 285.32(b)(1)(B) 285.32(b)(1)(C)(i) 285.32(b)(1)(C)(ii) 285.32(b)(1)(D) 285.32(b)(1)(E) 285.32(b)(1)(A) 285.32(b)(1)(E)(ii)(II) 285.32(b)(1)(E)(i) 285.32(b)(1)(E)(ii)(I)				
7	PRETREATMENT Grease Interceptors if required for commercial		285.34(d)				

MT - 4/1/19

Tanks set only, leveled.

**Comal County Environmental Health
OSSF Inspection Sheet**

No.	Description	Answer	Citations	Notes	1st Insp.	2nd Insp.	3rd Insp.
8	SEPTIC TANK Tank(s) Clearly Marked SEPTIC TANK If Single Tank, 2 Compartments Provided with Baffle SEPTIC TANK Inlet Flowline Greater than 3" and " T " Provided on Inlet and Outlet SEPTIC TANK Septic Tank(s) Meet Minimum Requirements		285.32(b)(1)(E) 285.91(2) 285.32(b)(1)(F) 285.32(b)(1)(E)(iii) 285.32(b)(1)(E)(ii)(II) 285.32(b)(1)(E)(ii)(I) 285.32(b)(1)(E)(i) 285.32(b)(1)(D) 285.32(b)(1)(C)(ii) 285.32(b)(1)(C)(i) 285.32(b)(1)(B) 285.32(b)(1)(A) 285.32(b)(1)(E)(iv)				
9	ALL TANKS Installed on 4" Sand Cushion/ Proper Backfill Used		285.32(b)(1)(F) 285.32(b)(1)(G) 285.34(b)				
10	SEPTIC TANK Inspection / Clean Out Port & Risers Provided on Tanks Buried Greater than 12" Sealed and Capped		285.38(d)				
11	SEPTIC TANK Secondary restraint system provided SEPTIC TANK Riser permanently fastened to lid or cast into tank SEPTIC TANK Riser cap protected against unauthorized intrusions		285.38(d) 285.38(e)				
12	SEPTIC TANK Tank Volume Installed						
13	PUMP TANK Volume Installed						
14	AEROBIC TREATMENT UNIT Size Installed	✓		800	4/1/19		
15	AEROBIC TREATMENT UNIT Manufacturer AEROBIC TREATMENT UNIT Model Number	✓		Prof 10			
16	DISPOSAL SYSTEM Absorptive		285.33(a)(4) 285.33(a)(1) 285.33(a)(2) 285.33(a)(3)				
17	DISPOSAL SYSTEM Leaching Chamber		285.33(a)(1) 285.33(a)(3) 285.33(a)(4) 285.33(a)(2)				
18	DISPOSAL SYSTEM Evapo-transpirative		285.33(a)(4) 285.33(a)(1) 285.33(a)(2)				

**Comal County Environmental Health
OSSF Inspection Sheet**

No.	Description	Answer	Citations	Notes	1st Insp.	2nd Insp.	3rd Insp.
19	DISPOSAL SYSTEM Drip Irrigation		285.33(a)(1) 285.33(a)(3) 285.33(a)(4) 285.33(a)(2)				
20	DISPOSAL SYSTEM Soil Substitution.		285.33(d)(4)				
21	DISPOSAL SYSTEM Pumped Effluent		285.33(a)(3) 285.33(a)(1) 285.33(a)(2)				
22	DISPOSAL SYSTEM Gravelless Pipe		285.33(a)(3) 285.33(a)(2) 285.33(a)(4) 285.33(a)(1)				
23	DISPOSAL SYSTEM Mound		285.33(a)(3) 285.33(a)(1) 285.33(a)(2) 285.33(a)(4)				
24	DISPOSAL SYSTEM Other (describe) (Approved Design)		285.33(d)(6) 285.33(c)(4)				
25	DRAINFIELD Absorptive Drainline 3" PVC or 4" PVC						
26	DRAINFIELD Area Installed						
27	DRAINFIELD Level to within 1 inch per 25 feet and within 3 inches over entire excavation		285.33(b)(1)(A)(v)				
28	DRAINFIELD Excavation Width DRAINFIELD Excavation Depth DRAINFIELD Excavation Separation DRAINFIELD Depth of Porous Media DRAINFIELD Type of Porous Media						
29	DRAINFIELD Pipe and Gravel - Geotextile Fabric in Place		285.33(b)(1)(E)				
30	DRAINFIELD Leaching Chambers DRAINFIELD Chambers - Open End Plates w/Splash Plate, Inspection Port & Closed End Plates in Place (per manufacturers spec.)		285.33(c)(2)				
31	LOW PRESSURE DISPOSAL SYSTEM Adequate Trench Length & Width, and Adequate Separation Distance between Trenches		285.33(d)(1)(C)(i)				

**Comal County Environmental Health
OSSF Inspection Sheet**

No.	Description	Answer	Citations	Notes	1st Insp.	2nd Insp.	3rd Insp.
32	EFFLUENT DISPOSAL SYSTEM Utilized Only by Single Family Dwelling EFFLUENT DISPOSAL SYSTEM Topographic Slopes < 2.0% EFFLUENT DISPOSAL SYSTEM Adequate Length of Drain Field (1000 Linear ft. for 2 bedrooms or Less & an additional 400 ft. for each additional bedroom) EFFLUENT DISPOSAL SYSTEM Lateral Depth of 18 inches to 3 ft. & Vertical Separation of 1ft on bottom and 2 ft. to restrictive horizon and ground water respectfully EFFLUENT DISPOSAL SYSTEM Lateral Drain Pipe (1.25 - 1.5" dia.) & Pipe Holes (3/16 - 1/4" dia. Hole Size) 5 ft. Apart		285.33(b)(3)(A) 285.33(b)(3)(A) 285.33(b)(3)(B) 285.91(13) 285.33(b)(3)(D) 285.33(b)(3)(F)				
33	AEROBIC TREATMENT UNIT Is Aerobic Unit Installed According to Approved Guidelines.	<input checked="" type="checkbox"/>	285.32(c)(1)		4/1/19		
34	AEROBIC TREATMENT UNIT Inspection/Clean Out Port & Risers Provided AEROBIC TREATMENT UNIT Secondary restraint system provided AEROBIC TREATMENT UNIT Riser permanently fastened to lid or cast into tank AEROBIC TREATMENT UNIT Riser cap protected against unauthorized intrusions	<input checked="" type="checkbox"/>					
35	AEROBIC TREATMENT UNIT Chlorinator Properly Installed with Chlorine Tablets in Place.	<input checked="" type="checkbox"/>					
36	PUMP TANK Is the Pump Tank an approved concrete tank or other acceptable materials & construction PUMP TANK Sampling Port Provided in the Treated Effluent Line PUMP TANK Check Valve and/or Anti- Siphon Device Present When Required PUMP TANK Audible and Visual High Water Alarm Installed on Separate Circuit From Pump	<input checked="" type="checkbox"/>					
37	PUMP TANK Inspection/Clean Out Port & Risers Provided PUMP TANK Secondary restraint system provided PUMP TANK Riser permanently fastened to lid or cast into tank PUMP TANK Riser cap protected against unauthorized intrusions	<input checked="" type="checkbox"/>					
38	PUMP TANK Secondary restraint system provided	<input checked="" type="checkbox"/>					
39	PUMP TANK Electrical Connections in Approved Junction Boxes / Wiring Buried	<input checked="" type="checkbox"/>					

**Comal County Environmental Health
OSSF Inspection Sheet**

No.	Description	Answer	Citations	Notes	1st Insp.	2nd Insp.	3rd Insp.
40	APPLICATION AREA Distribution Pipe, Fitting, Sprinkler Heads & Valve Covers Color Coded Purple?	✓	285.33(d)(2)(G)(iii)(II)285.33(d)(2)(G)(iii)(III)285.33(d)(2)(G)(v) 285.33(d)(2)(G)(iii) 285.33(d)(2)(G)(iv) 285.33(d)(2)(G)(i) 285.33(d)(2)(G)(ii) 285.33(d)(2)(G)(iii)(I)		4/1/19 		
41	APPLICATION AREA Low Angle Nozzles Used / Pressure is as required APPLICATION AREA Acceptable Area, nothing within 10 ft of sprinkler heads? APPLICATION AREA The Landscape Plan is as Designed	✓	285.33(d)(2)(G)(i) 285.33(d)(2)(A) 285.33(d)(2)(F)				
42	APPLICATION AREA Area Installed						
43	PUMP TANK Meets Minimum Reserve Capacity Requirements						
44	PUMP TANK Material Type & Manufacturer						
45	PUMP TANK Type/Size of Pump Installed						

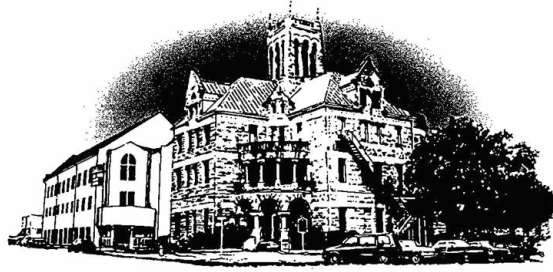

Comal County

OFFICE OF COMAL COUNTY ENGINEER

Permit of Authorization to Construct an On-Site Sewage Facility Permit Valid For One Year From Date Issued

Permit Number: 108642
Issued This Date: 01/24/2019
This permit is hereby given to: Kristy L. Curl

To start construction of a private, on-site sewage facility located at:

581 LOST CREEK DR
BULVERDE, TX 78163

Subdivision: Comal Trace
Unit: 2
Lot: 37
Block:
Acreage:

APPROVED MINIMUM SIZES AS PER ATTACHED DESIGN

Type of System: Aerobic
Surface Irrigation

This permit gives permission for the construction of the above referenced on-site facility to commence. Installation must be completed by an installer holding a valid registration card from the Texas Commission on Environmental Quality (TCEQ). Installation and inspection must comply with current TCEQ and Comal County requirements.

Call (830) 608-2090 to schedule inspections.

* * * **COMAL COUNTY OFFICE OF ENVIRONMENTAL HEALTH** * * *
APPLICATION FOR PERMIT FOR AUTHORIZATION TO CONSTRUCT AN
ON-SITE SEWAGE FACILITY AND LICENSE TO OPERATE

Date 01/10/19

Permit # 108642

Owner Name Kristy L. Curl
Mailing Address 1623 Mountain Cove
City, State, Zip San Antonio, Texas 78258
Phone # 956-878-5900
Email brian@bcurlconstruction.com

Agent Name John J. Haag, P.E.
Agent Address 15831 Secret Trail
City, State, Zip San Antonio, Tx. 78247
Phone # 210-705-4268
Email jhaag@satx.rr.com

All correspondence should be sent to: Owner Agent Both Method: Mail Email

Subdivision Name Comal Trace Unit 2 Lot 37 Block _____

Acreage/Legal 2.00

Street Name/Address 581 Lost Creek City Bulverde Zip 78163

Type of Development:

Single Family Residential

Type of Construction (House, Mobile, RV, Etc.) House

Number of Bedrooms 4

Indicate Sq Ft of Living Area 4792

Commercial or Institutional Facility

(Planning materials must show adequate land area for doubling the required land needed for treatment units and disposal area)

Type of Facility _____

Offices, Factories, Churches, Schools, Parks, Etc. - Indicate Number Of Occupants _____

Restaurants, Lounges, Theaters - Indicate Number of Seats _____

Hotel, Motel, Hospital, Nursing Home - Indicate Number of Beds _____

Travel Trailer/RV Parks - Indicate Number of Spaces _____

Miscellaneous _____

Estimated Cost of Construction: \$ 440,000 (Structure Only)

Is any portion of the proposed OSSF located in the United States Army Corps of Engineers (USACE) flowage easement?

Yes No (If yes, owner must provide approval from USACE for proposed OSSF improvements within the USACE flowage easement)

Source of Water Public Private Well

Are Water Saving Devices Being Utilized Within the Residence? Yes No

By signing this application, I certify that:

- The completed application and all additional information submitted does not contain any false information and does not conceal any material facts.
- Authorization is hereby given to the permitting authority and designated agents to enter upon the above described property for the purpose of site/soil evaluation and inspection of private sewage facilities..
- I understand that a permit of authorization to construct will not be issued until the Floodplain Administrator has performed the reviews required by the Comal County Flood Damage Prevention Order.
- I affirmatively consent to the online posting/public release of my e-mail address associated with this permit application, as applicable.

Kristy Curl
Signature of Owner

1-11-19
Date

* * * **COMAL COUNTY OFFICE OF ENVIRONMENTAL HEALTH** * * *
APPLICATION FOR PERMIT FOR AUTHORIZATION TO CONSTRUCT AN
ON-SITE SEWAGE FACILITY AND LICENSE TO OPERATE

Planning Materials & Site Evaluation as Required Completed By John J. Haag, P.E.

System Description Proprietary aerobic treatment with surface spray disposal

Size of Septic System Required Based on Planning Materials & Soil Evaluation

Tank Size(s) (Gallons) 1250 gal. min. w/1000 gal Pump TANK Absorption/Application Area (Sq Ft) 6563 min.

Gallons Per Day (As Per TCEQ Table III) 420

(Sites generating more than 5000 gallons per day are required to obtain a permit through TCEQ.)

RECEIVED

Is the property located over the Edwards Recharge Zone? Yes No

(If yes, the planning materials must be completed by a Registered Sanitarian (R.S.) or Professional Engineer (P.E.))

JAN 17 2019

Is there an existing TCEQ approved WPAP for the property? Yes No

(If yes, the R.S. or P.E. shall certify that the OSSF design complies with all provisions of the existing WPAP.)

COUNTY ENGINEER

If there is no existing WPAP, does the proposed development activity require a TCEQ approved WPAP? Yes No

(If yes, the R.S. or P.E. shall certify that the OSSF design will comply with all provisions of the proposed WPAP. A Permit to Construct will not be issued for the proposed OSSF until the proposed WPAP has been approved by the appropriate regional office.)

Is the property located over the Edwards Contributing Zone? Yes No

Is there an existing TCEQ approval CZP for the property? Yes No

(If yes, the P.E. or R.S. shall certify that the OSSF design complies with all provisions of the existing CZP.)

If there is no existing CZP, does the proposed development activity require a TCEQ approved CZP? Yes No

(If yes, the R.S. or P.E. shall certify that the OSSF design will comply with all provisions of the proposed CZP. A Permit to Construct will not be issued for the proposed OSSF until the CZP has been approved by the appropriate regional office.)

Is this property within an incorporated city? Yes No

If yes, indicate the city: _____

By signing this application, I certify that:

- The information provided above is true and correct to the best of my knowledge.

- I affirmatively consent to the online posting/public release of my e-mail address associated with this permit application, as applicable.

J.J. Haag, P.E.
Signature of Designer

01/17/19
Date

Vc



201906001971 01/17/2019 03:08:27 PM 1/1

THE COUNTY OF COMAL

STATE OF TEXAS

CERTIFICATION OF OSSF REQUIRING MAINTENANCE

According to Texas Commission on Environmental Quality (TCEQ) Rules for On- Site Sewage Facilities, this document is filed in the Deed Records of Comal County, Texas.

I

The Texas Health and Safety Code, Chapter 366 authorizes the TCEQ to regulate on-site sewage facilities (OSSFs). Additionally, the Texas Water Code (TWC), § 5.012 and § 5.013, gives the TCEQ primary responsibility for implementing the laws of the State of Texas relating to water and adopting rules necessary to carry out its powers and duties under the TWC. The TCEQ, under the authority of the TWC and the Texas Health and Safety Code, requires owner's to provide notice to the public that certain types of OSSFs are located on specific pieces of property. To achieve this notice, the TCEQ requires a recorded affidavit. Additionally, the owner must provide proof of the recording to the OSSF permitting authority. This recorded affidavit is not a representation or warranty by the TCEQ of the suitability of this OSSF, nor does it constitute any guarantee by the TCEQ that the appropriate OSSF was installed.

II

An OSSF requiring a maintenance contract, according to 30 Texas Administrative Code §285.91(12) will be installed on the property described as (insert legal description):

Legal Description: Lot 37, Comal Trace Subdivision, Unit 2

This property is owned by: Kristy L. Curl

This OSSF must be covered by a continuous maintenance contract for the first two years. After the initial two year service policy, the owner of an aerobic system for a single family residence shall either obtain a maintenance contract within 30 days or maintain the system personally.

The owner will, upon any sale or transfer of the above-described property, request a transfer of the permit for the OSSF to the buyer or new owner. A copy of the planning materials for the OSSF can be obtained from Comal County.

WITNESS BY HAND(S) ON THIS 14 DAY OF January, 2019.

Kristy Curl
Kristy L. Curl, Owner

RECEIVED

JAN 17 2019

COUNTY ENGINEER

SWORN TO AND SUBSCRIBED BEFORE ME ON THIS 14 DAY OF January, 2019.

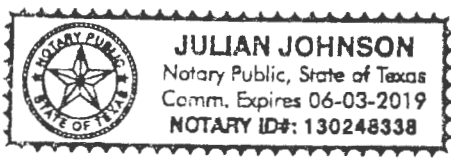

[Signature]
Notary Public, State of Texas

Filed and Recorded
Official Public Records
Bobbie Koepf, County Clerk
Comal County, Texas
01/17/2019 03:08:27 PM
JESSICA 1 Page(s)
201906001971



Bobbie Koepf

MJ Central Texas Septic, LLC

DBA MJ Septic

27552 Old Blanco Road
 San Antonio, Texas 78260
 (210) 875-3625 * (210) 889-4606
mjseptic@satx.rr.com (email)
www.mjseptic.com

Aerobic Installation * Aerobic Maintenance Contracts
 Real Estate Inspections * Cleaning/Pumping

Michael J. Long, MP 0001294 Licensed by T.C.E.Q.

RECEIVED
 JAN 27 2019

COUNTY ENGINEER

PROPERTY ADDRESS: 581 Lost Creek, Bulverde, Texas 78163

The Texas Commission on Environmental Quality (TCEQ) require all ATU's to be checked and maintained every four months for the life of the unit (some permitting authorities may stipulate this requirement, after the first two years after installation; call your county to inquire). Upon expiration of this contract, MJ Septic will offer a continuation of your maintenance contract to cover labor and routine maintenance/reports. Lab testing, if required, for coliform, TSS, BOD etc. are NOT included in this policy and applicable fees are the owner's responsibility. MJ Septic will inspect and service your ATU once every 4 months for the duration of your 2-year initial contract. For a new single family dwelling, this is the date of installation, required by state guidelines dated June 13, 2001. For an existing single family dwelling, this is the date the notice of approval is issued by your permitting authority. The effective date of this maintenance contract shall be the date the LTO (license to operate) is issued. MJ Septic will address all major concerns/complaints (excluding weekends & holidays) within 72 hours from the initial point of contact with homeowner(s).

- The annual fee on your contract includes the following:** an inspection every four months (three times annually) which include inspecting the mechanical, electrical and other applicable components to ensure proper function. The annual fee does not include any parts, cleaning/pumping, chlorine/bleach (tablets or liquid), additional service calls or additional testing that may be required by any regulating authority. If for any reason, we are unable to obtain access to your property or system to perform a service check, you may be charged a \$75 service call for re-scheduling. It is very important that we have all proper gate codes, combination locks etc. to inspect your system.
- Repairs I:** If repairs or replacement of parts is needed during routine inspection, we will try to contact the homeowner for approval if we are able to repair onsite. If we are unable to repair/replace parts onsite, client will be notified via email and/or USPS that repairs/replacement of parts is needed. All MAJOR part replacements come with a 2-year warranty (see notes below). There will be a \$75 warranty credit fee assessed on all parts. Warranted items will only be honored when a valid maintenance contract is in effect with MJ Septic. If the contract has a lapse, ALL WARRANTIES items are VOIDED.
- Repairs II:** For ATU's under initial installation warranty (2 years from initial installation date) if warranted items are required to be replaced within 30 days of installation, part will be replaced with no fees, after 30 days there will be a \$75 warranty credit fee assessed on all parts. Warranted items will only be honored when a valid maintenance contract is in effect with MJ Septic.
- Additional Service Calls/Charges:** If a service call is required by homeowner/renter between regular inspections, a service call fee of \$75 (not including parts and/or cleaning/pumping) will be assessed. We may waive this fee at our discretion. These calls include but are not limited to the following: red light alarms, high water alarms, chlorinator checks, leaky airlines, timer adjustments, spray head adjustments and system power failure.
- Chlorine:** The property owner is responsible for maintaining the chlorine supply. TCEQ regulation requires proper chlorination. For liquid chlorinators, homeowners are to add 2-3 gallons of liquid chlorine/bleach per month. (If the chlorinator is completely empty, DO NOT add more than 3 1/2 gallons of liquid chlorine/bleach at a time) For tablet chlorinators, homeowners can purchase Calcium Hypochlorite tablets at their local Home Depot or Lowe's. **DO NOT USE POOL TABLETS** (this can cause a volatile reaction)
- Cleaning/Pumping:** The cleaning/pumping of your ATU is not included in your maintenance contract. We always recommend pumping between 10-12" of sludge. *A typical/average household will need to have their system pumped every 2-5 years; this all depends on usage and will vary per household*
- Transfer of Property/Ownership:** The fee of this maintenance contract is non-refundable, however is fully transferrable to the new owner(s). If this policy is sold within the contract period, the signing party is responsible for all repairs unless the new homeowner(s) information is provided before repairs are made and transfer contract is signed (by new homeowner) and returned to us. The new homeowner(s) will be required to meet for a walk-through orientation with one of our technicians during their first visit of their transfer contract. **RENTAL HOMES:** The PROPERTY OWNER is responsible for all fees associated with this contract. Renters will be required to have a walk-through orientation during their first visit to ensure proper usage, etc.
- Altering the system:** Do not allow alteration to any part of the system or sprinkler head locations. Alterations would put the system out of compliance and would cause the property owner additional expense to bring the system back into compliance. Any use of another company to make repairs to the system will violate any warranties and be considered as a breach of this maintenance contract. If client chooses to purchase and use their own parts, MJ Septic will not install nor work on these parts.
- Violations of Warranty:** Violations of the warranty include but are not limited to the following: turning off your system at any time, disconnecting the alarm; restricting airflow to the Air Compressor, overloading the system above its daily rated capacity, introducing excessive amounts of harmful matter (including harsh chemicals, cleaners, antibiotics, etc.) into the system or any other harmful usage of your OSSF/ATU. Refusing to Clean/Pump Out Septic when recommended and/or replacing necessary parts as needed. Necessary treatment of ants. Homeowner must keep grass, weeds and plants trimmed and clear of tank access points, control panel, Air Compressor, etc. Moving sprinkler lines without proper documentation, etc. Building over septic tank, lids, etc.
- Terms of Payment:** Payment is due in full for the maintenance contract at time of signing. Payment for parts, repairs, cleaning/pumping, service calls, etc. are due prior to or at time of service, unless otherwise specifically noted. If payment is not received within ten (10) business days of service date, a 1.5% finance charge will be assessed per month. If payment is delinquent, your next service check/maintenance contract may be cancelled. If payment is more than 90 days past due, contract will be cancelled and we will send to collections.
- Maintenance Tips/Owner Guide:** Please read the attached Maintenance Tips/Owner Guide. Following these easy steps can help prevent unnecessary and avoidable expenses to the homeowner(s). Please initial here that you've received a copy of this document: _____ (keep the maintenance tips/guide for your reference)

CIRCLE ONE CHOICE BELOW

Contract Verified (office use only) _____

1 YEAR	2 YEAR	3 YEAR	2 YEAR INITIAL	Paid in Full at Sign Up, Non-Refundable, Does Not Include Additional Charges Noted Above. Homeowner(s) are NOT required to be present at inspections. They will receive phone call notification the day of service and a door hanger will be left if no one is home. Reports emailed/mailed within a few business days.
\$285	\$530	\$675	Included In Installation	

Acceptance of Maintenance Contract: The above prices, specifications, and conditions are satisfactory and are hereby accepted. MJ Septic is authorized to enter property to perform routine maintenance inspections as agreed. I have read and agree to the maintenance contract guidelines stated above and have also read and agree to comply with the Maintenance Tips/Owner Guide.

Accepted by Signature: Kristy Curl Printed Name: Kristy L. Curl Email: brian@bcurlconstruction.com
 Phone Numbers: (Home) _____ (Mr. Cell) _____ (Mrs. Cell) 956-878-5900 (Work) _____
 Subdivision: Comal Trace, Unit 2 # of Occupants in Home: _____ Gate Codes/Combination Locks, etc. N/A Biting Dogs: _____
 (MJ Septic will assess a \$75 service fee if we are not notified of gate code changes, biting dogs, etc.)

MJ Central Texas Septic, LLC Authorized Signature: Stephanie E. Perez

Date: _____

ON-SITE SEWAGE FACILITY (OSSF) SITE EVALUATION FORM

1. OWNER INFORMATION	
Property Owner's Full Legal Name: Kristy L. Curl	

2. PROPERTY INFORMATION				
City: Bulverde			Zip Code: 78163	
Legal Description:				
Lot: 37	Block:	Subdivision: Comal Trace	Sec:	Unit: 2
If not located in subdivision: Survey:				
Abstract:			Recorded (Vol/Pg):	

3. SITE EVALUATION INFORMATION:	
Name of Site Evaluator: John J. Haag	PE #: 90158
Date Performed: 10/30/08	Proposed Excavation Depth: Surface

4. REQUIREMENTS:

- At least two soil evaluations must be performed on the site at opposite ends of the proposed disposal area. Locations of soil evaluations must be shown on the application site drawing or designer's site drawing.
- For subsurface disposal, soil evaluations must be performed to a depth of at least 2 feet below the proposed excavation depth. For surface disposal, the surface horizon must be evaluated.

Soil Profile Hole Number: 1					
Depth (ft.)	Textural Class	Gravel Analysis	Drainage (Mottles/Water Table)	Restrictive Horizon	Observations
0	III	<30%	No	Yes	Type III to 14" then limestone
1					
2					
3					
4					
5					

RECEIVED
JAN 17 2019
COUNTY ENGINEER

ON-SITE SEWAGE FACILITY (OSSF) SITE EVALUATION FORM

Soil Profile Hole Number: 2					
Depth (ft.)	Textural Class	Gravel Analysis	Drainage (Mottles/Water Table)	Restrictive Horizon	Observations
0	III	<30%	No	Yes	Type III to 7" then limestone
1					
2					
3					
4					
5					

5. FEATURES OF SITE AREA:

- | | |
|---|---|
| Presence of 100 year flood zone: | <input type="checkbox"/> Yes <input checked="" type="checkbox"/> No |
| Presence of adjacent ponds, streams or water impoundments | <input type="checkbox"/> Yes <input checked="" type="checkbox"/> No |
| Existing or proposed water well in nearby area | <input type="checkbox"/> Yes <input checked="" type="checkbox"/> No |
| Organized sewage available to lot or tract | <input type="checkbox"/> Yes <input checked="" type="checkbox"/> No |
| Recharge features within 150 feet | <input type="checkbox"/> Yes <input checked="" type="checkbox"/> No (None observed) |

6. I certify that the above statements are true and correct and are based on my own field observations.

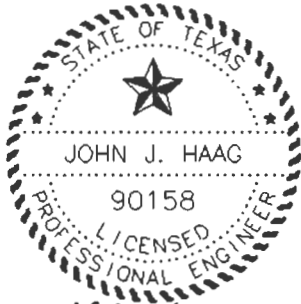

John J. Haag, P.E.

10/30/18

Haag Engineering Consultants, Inc.
Firm: F-5789

Aerobic With Surface Disposal

by Felix I. Bernal, P.E. (c) 2002 - 2013

SITE EVALUATION PERFORMED ON:

30-Oct-18

by

John J. Haag, P.E.

Date: 10/30/18

APPLICANT: Kristy L. Curl

MAILING ADDRESS:

CITY, ST, ZIP

CONTRACTOR

SITE ADDRESS: 581 Lost Creek

CITY, ST, ZIP Bulverde, Texas 78163

LEGAL DESCRIPTION: Lot 37, Comal Trace 2

WATER SOURCE: Public

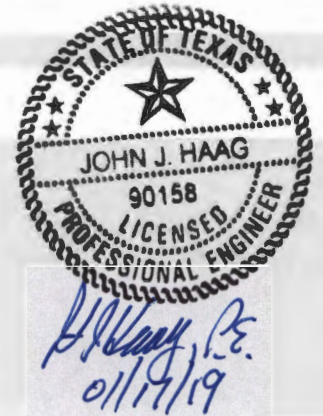

SOIL TYPE 3 AT SLOPE OF <15% BEDROOMS 4 Sq. Ft. 4792
Normally Required 375 GPD 525 GPD

WATER SAVING DEVICES? Y
APPLICATION RATE = 0.064 GALLONS PER SQ. FT. PER DAY
USAGE FLOW = 420 GALLONS PER DAY WHICH IS 80% OF 525 GPD
SEPTIC TANK VOLUME = 1,250 GALLONS TWO COMPARTMENT TANK REQUIRED
RESERVE CAPACITY = 140 (8 HOURS USAGE AFTER HIGH LEVEL ALARM)

AREA REQUIRED = 6,563 SQ. FT. OF ABSORPTION AREA OR 0.15 ACRES
WITHOUT WATER SAVING DEVICES 8,203 SQ. FT. OF ABSORPTION AREA OR 0.19 ACRES

Use a 800 GPD Treatment Plant Model *200 P T S L* by *PRO FLO*
Nozzle # PSI (K-Rain ProPlus Low Angle Sprinkler Nozzle) *TANK* *SIPRECAST*
3 40 PSI WITH A 32 FOOT RADIUS AND 3.1

GPM/ SPRINKLER WITH A TOTAL OF 7.8 GPM FOR THE SYSTEM

AREA COVERED BY PROPOSED SPRINKLER HEADS

LINEAR FEET OF DISTRIBUTION = 179.0 FT. OF 1 INCH SCH-40 PURPLE PIPE 150 C (HAZEN-WILLIAMS)
SPACE BETWEEN SPRINKLER HEADS = 58 FT

WITH ANGLE OF DISTRIBUTION = 360 SPRINKLERS FOR A DOSE TIME OF 54 MINUTES
AREA PER SPRINKLER = 3,217 sf
OF ABSORPTION AREA RECEIVED

SPRINKLERS	LENGTH OF PIPE	Dist. Angle	Flow GPM	Q GPM	Hf ft of head	Area
4	35 FT	360	3.1	7.750	1.50	3217.0
3	64 FT	180	1.55	4.650	1.07	1608.5
2	53 FT	180	1.55	3.100	0.42	1608.5
1	27 FT	180	1.55	1.550	0.06	1608.5
0			0	0.000	0.00	0.0
0			0	0.000	0.00	0.0
0			0	0.000	0.00	0.0
0			0	0.000	0.00	0.0
0			0	0.000	0.00	0.0
0			0	0.000	0.00	0.0

SUM= 179 feet of pipe 7.750 3.04 ft of head 8042.5 sf Provided

fittings factor 1.20

3.65 ft of head

Hf for Dist Line 7.6719559 ft of head

(Note: 0.4335= 62.424/144 for water at 39.2°F) 40.00 psi divided by 0.4335 = 92.27 ft of head

elevation difference 6.00 ft of head

head required for sprinkling 109.59 ft of head

pressure required for sprinkling 47.51 psi

7053 SF ACTUAL

GENERAL NOTES

- 1 NO VEHICULAR TRAFFIC IS ALLOWED ON ANY PORTION OF THE DISPOSAL SYSTEM, UNLESS THE DESIGN SPECIFIES OTHERWISE
- 2 PIPE ALIGNMENT TO THE DISPOSAL BEDS MAY BE ALTERED AS REQUIRED. ANY CHANGE FROM THE PLANS MUST BE APPROVED BY THE ENGINEER AND THE APPROPRIATE GOVERNMENTAL AGENCY(IES)
- 3 CONTRACTOR SHALL PROTECT TREES WHICH ARE NOT IN THE EXCAVATED CONSTRUCTION AREAS. CONTRACTOR SHALL MINIMIZE ROOT DAMAGE AND REASONABLY ADHERE TO THE DESIGN
- 4 CONTRACTOR IS RESPONSIBLE FOR VERIFYING A MINIMUM OF 1/4" PER FOOT OF FALL FROM THE BUILDING TO THE SEPTIC TANK
- 5 NO AUTOMATIC SPRINKLER SYSTEM SHALL BE INSTALLED OVER THE DISPOSAL AREAS. ANY WATERING IN THESE AREAS SHALL BE DONE BY HAND AND ONLY WHEN REQUIRED TO MAINTAIN GRASS COVER
- 6 ALL CONSTRUCTION SHALL CONFORM TO THE RULES AND REGULATIONS OF THE APPROPRIATE AUTHORITY. TEXAS COMMISSION ON ENVIRONMENTAL QUALITY (TCEQ) AND ANY APPLICABLE LOCAL BUILDING AND SAFETY CODES
- 7 CONTRACTOR SHALL BE RESPONSIBLE FOR LOCATING AND VERIFYING THE LOCATION OF ALL EXISTING UNDERGROUND UTILITIES THAT MAY BE AFFECTED BY THE CONSTRUCTION OF THIS SYSTEM
- 8 SPRAY APPLICATION AREAS SHALL BE COVERED WITH PERENNIAL GRASSES TO TAKE ADVANTAGE OF TRANSPIRATION. IF GRASSES ARE USED WHICH HAVE DORMANT PERIODS, STEPS SHOULD BE TAKEN TO PROVIDE SOME TYPE OF VEGETATION ON THE BEDS DURING THESE PERIODS
- 8.1 RECOMMENDED COVERAGE
 - 8.1.1 BERMUDA 1 LB/1000 S.F
 - 8.1.2 RYE 10 LB/1000 S.F
 - 8.1.3 OR ST. AUGUSTINE SOD
- 9 SPRAY APPLICATION AREAS MUST BE MOWED AT REGULAR INTERVALS. FAILURE TO PROPERLY MAINTAIN VEGETATIVE COVER MAY RESULT IN SYSTEM FAILURE AND SHALL BE THE RESPONSIBILITY OF THE OWNER
- 10 ALL PIPES SHALL BE SCHEDULE 40 PVC OR APPROVED EQUAL, UNLESS NOTED OTHERWISE. ALL JOINTS SHALL BE CLEANED WITH THE APPROPRIATE SOLVENT AND GULED IN ACCORDANCE WITH THE MANUFACTURER'S RECOMMENDATION
- 11 ALL POTABLE WATER LINES SHALL BE A MINIMUM OF 10 FEET FROM ANY DISPOSAL SYSTEM OR SEWERAGE PIPE. THE CONTRACTOR SHALL NOTIFY THE ENGINEER OF WATER LINES LESS THAN 10 FEET FROM THE DISPOSAL AREA
- 12 HIGH WATER ALARM SHALL BE LOCATED IN A NOTICEABLE LOCATION. THE ALARM SHALL BE A VISUAL AND AUDIBLE ALARM AND WIRED ON A SEPARATE CIRCUIT FROM THE PUMPS. ALL EXTERIOR CONTROLS AND CONNECTIONS SHALL BE ENCLOSED IN A WEATHER-PROOF HOUSING
- 13 ELECTRICAL CONSTRUCTION SHALL COMPLY WITH ALL LOCAL ELECTRICAL AND BUILDING CODES
- 14 NO EXCAVATION IS PERMITTED NEAR THE DISPOSAL AREAS THAT WILL RESULT IN THE NONCOMPLIANCE OF APPLICABLE SETBACKS STATED IN THE RULES AND REGULATIONS OF THE APPROPRIATE AUTHORITY
- 15 ONLY GOOD QUALITY SANDY LOAM SHALL BE APPLIED OVER THE DISPOSAL AREAS. CLAY LOAM IS UNACCEPTABLE AND WILL CAUSE SYSTEM FAILURE. SANDY LOAM SHALL BE DEFINED AS SHOWN IN TABLE VI (USDA SOIL TEXTURAL CLASSIFICATIONS) OF THE RULES AND REGULATIONS OF THE TCEQ
- 16 THE INSTALLER IS RESPONSIBLE FOR VERIFYING THE QUALITY OF EACH LOAD OF LOAM PLACED ON THE SYSTEM
- 17 STORM WATER (RAINFALL RUNOFF) SHOULD NOT BE ALLOWED TO FLOW OVER THE DISPOSAL FIELDS OR THE TANKS. DIVERSION BERMS, SWALES AND/OR RAIN GUTTERS SHOULD BE INSTALLED AS NECESSARY TO PREVENT SUCH RUNOFF
- 18 THE CONTRACTOR IS RESPONSIBLE FOR STAKING AND VERIFYING THE GRADES PRIOR TO EXCAVATION. ANY DISCREPANCIES OF MORE THAN 6 INCHES SHALL BE REPORTED TO THE ENGINEER PRIOR TO EXCAVATION. THE CONTRACTOR SHALL NOT DEVIATE FROM THESE PLANS WITHOUT THE WRITTEN CONSENT OF THE APPROPRIATE AUTHORITY AND THE ENGINEER
- 19 WATER SOFTENER SHALL NOT BE CONNECTED TO THE SEPTIC TANK
- 20 CONTRACTOR SHALL REPORT TO THE ENGINEER ANY ELEVATION DIFFERENCES GREATER THAN 4 FEET BETWEEN THE HIGHEST AND LOWEST TRENCH IN THE FIELD. THIS SHOULD BE CHECKED PRIOR TO INSTALLING THE LATERALS AND MANIFOLD
- 21 THIS DISPOSAL SYSTEM HAS BEEN DESIGNED TO OPERATE PROPERLY AT SPECIFICATIONS NOTED IN THESE PLANS. ALTERATIONS TO THE SYSTEM BY THE OWNER, INCLUDING BUT NOT LIMITED TO LANDSCAPING, DRAINAGE, BUILDING AND/OR WATER USAGE, MAY CAUSE PNEUMATIC FAILURE AND SHALL BE THE SOLE RESPONSIBILITY OF THE OWNER
- 22 CONTRACTOR SHALL BE RESPONSIBLE FOR VERIFYING ALL PLUMBING FIXTURES ARE CONNECTED TO THE DESIGNATED SEPTIC TANK(S). LOW FLOW TOILETS (1.9 GAL), SHOWERHEADS AND FAUCETS SHALL BE USED IN THE STRUCTURES
- 23 CONTRACTOR SHALL BE RESPONSIBLE FOR JOBSITE SAFETY AND PROTECTION OF THE PUBLIC FROM INJURY DURING CONSTRUCTION. THE OWNER SHALL BE RESPONSIBLE FOR THE PREVENTION OF PERSONAL INJURY TO ANYONE ON OR NEAR THE DISPOSAL SYSTEM
- 24 CONTRACTOR SHALL BE RESPONSIBLE TO ENSURE THAT ALL TANKS HAVE ADEQUATE STRENGTH AND INTEGRITY TO PERFORM SATISFACTORILY AS SHOWN ON THESE PLANS
- 25 THE WASTE WATER FLOW TO THE SEPTIC SYSTEM SHALL NOT EXCEED THE DESIGN FLOW SHOWN ON THIS PLAN

SI CPE NOTE

INSTALLER SHALL CUT OR FILL EXIST. GROUND WITHIN SPRAY DISPOSAL LIMITS SO THAT TOP OF FINISHED GROUND SLOPES WITHIN SAID LIMITS DO NOT EXCEED 15%

ASSUMED LOCATION OF WATER SERVICE ALIGNMENT FROM METER TO HOUSE. NOTE: WATER SERVICE LINE SHALL BE SLEEVED WITH SCH. 40 PVC WHEREVER IT IS 10' OR CLOSER TO PROPOSED OSSF DISPOSAL AREA LIMITS AND/OR ANY SYSTEM COMPONENT(S). EXTEND PVC SLEEVING 10' MIN BEYOND EACH SIDE OF OSSF DISPOSAL AREA LIMITS AND/OR SYSTEM COMPONENTS.

ADDL. NOTES

- 1 SPRINKLER OPERATION SHALL BE TIMED TO DOSE BETWEEN MIDNIGHT AND 5:00 a.m.
- 2 DESIGN DAILY WASTEWATER FLOW = 420 GPD (WATER SAVING DEVICES WERE ASSUMED FOR SEPTIC SYSTEM DESIGN)
- 3 TOPOGRAPHIC DATA SOURCE: FEMA 2011 DATA
- 4 THE OSSF INSTALLER SHALL FIELD VERIFY ALL PROPERTY LINE AND EASEMENT LOCATIONS THAT THIS DESIGN REFERENCES PRIOR TO ANY OSSF INSTALLATIONS

1" = 50'

01/17/19

**OSSF LAYOUT
LOT 37, LOST CREEK
COMAL TRACE SUBD., UNIT 2
BULVERDE, TEXAS**

NOTE: OSSF IS NOT WITHIN FEMA 100 YEAR FLOODPLAIN.

OSSF IS NOT WITHIN THE EDWARDS AQUIFER RECHARGE ZONE.

SITE EVALUATION BY JOHN J. HAAG, P.E. ON 10/30/18

DRAWN BY: JJJ
CHECKED BY: JJJ
DATE: 01/17/19
JOB NO. SAHM18001

SHEET 1 OF 1

HAAG ENGINEERING CONSULTANTS

15831 SECRET TRAILS
SAN ANTONIO, TEXAS 78247
FIRM: F-5789

TEL: (210) 705-4268
FAX: (210) 855-8383

©COPYRIGHT 2018 HAAG ENGINEERING CONSULTANTS; ALL RIGHTS RESERVED

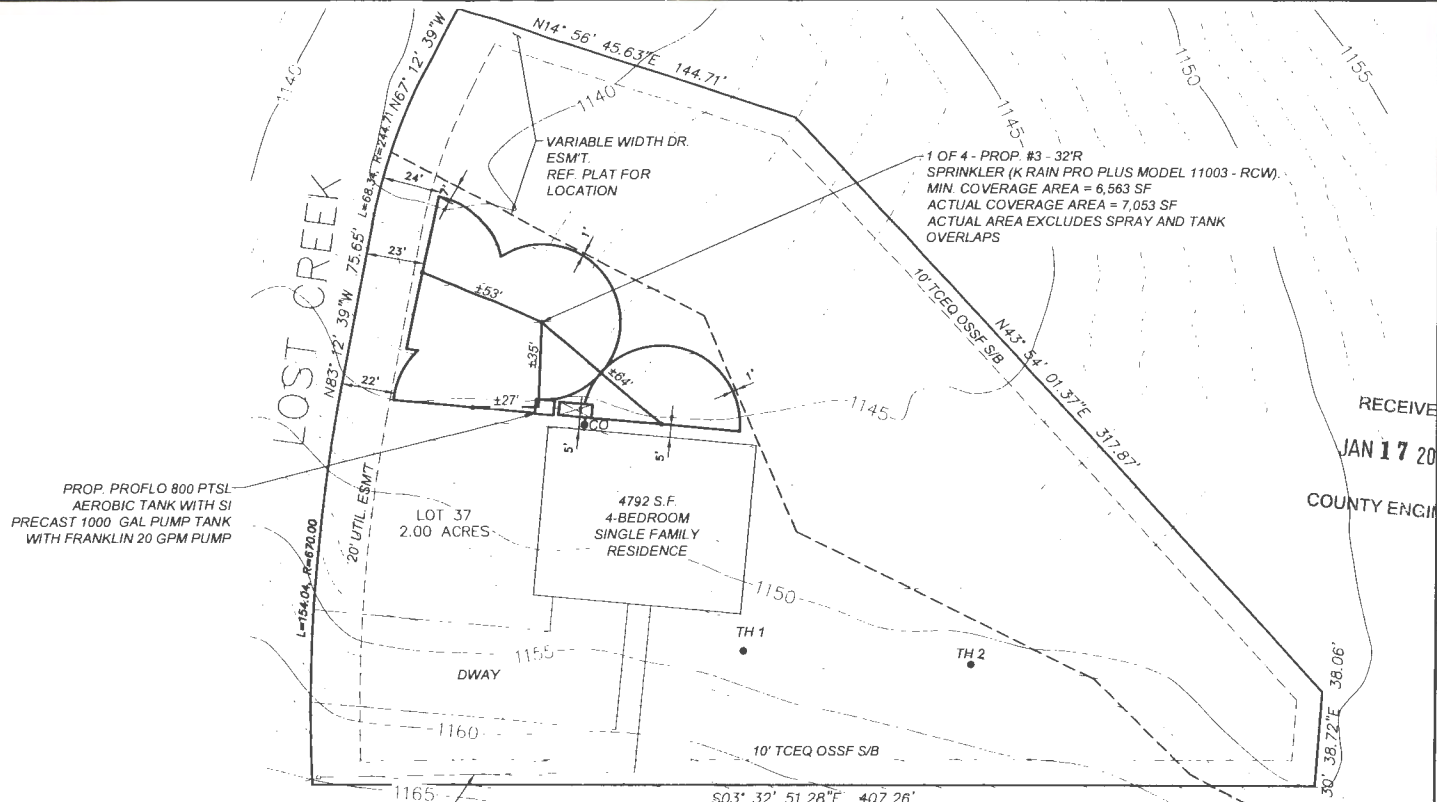

RECEIVED
JAN 17 2019
COUNTY ENGINEER

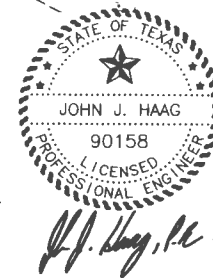

Pro Flo 800 PTSL System Diagram

Configurations may vary.

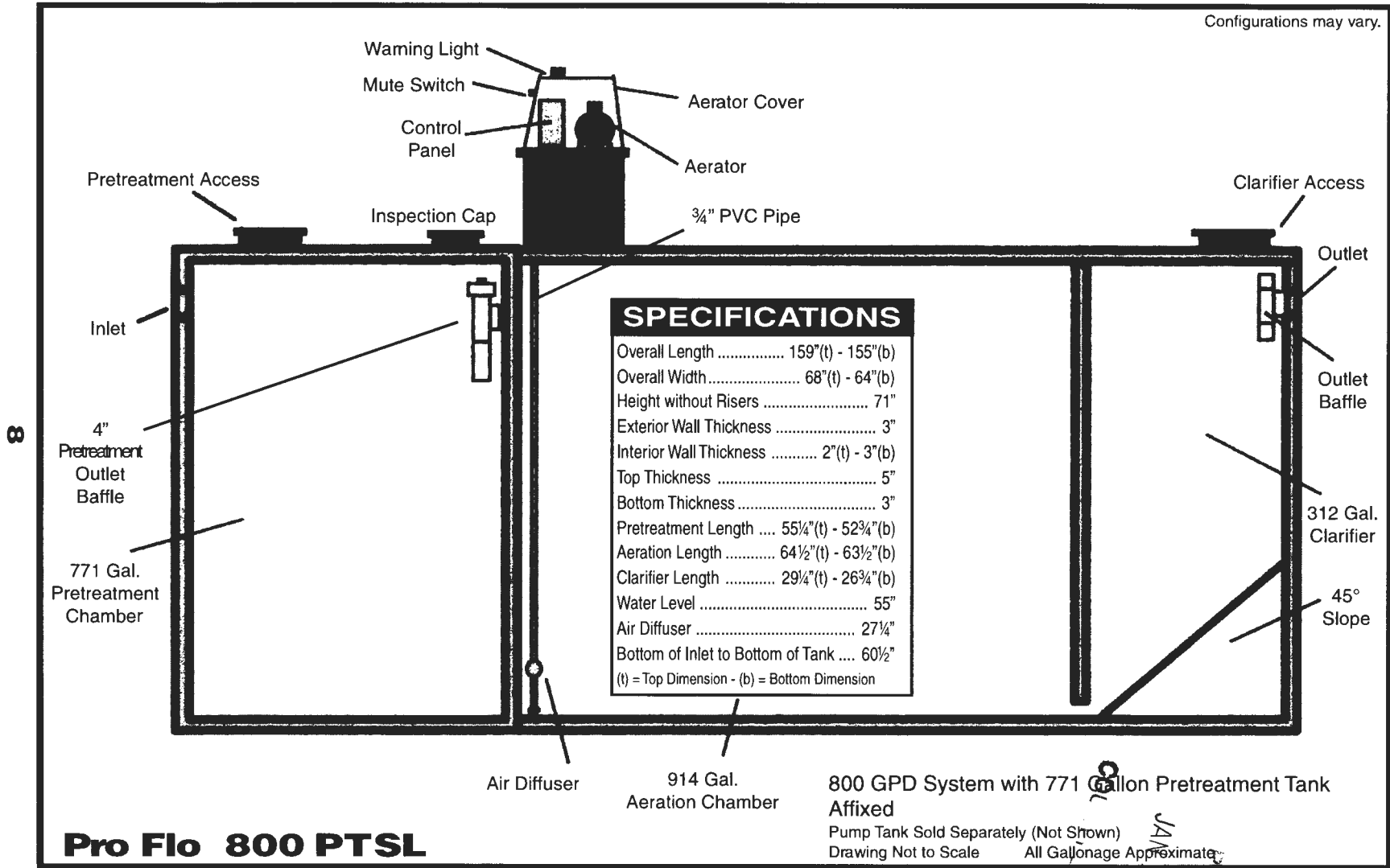

RECEIVED
JAN 7 2019



1000 GALLON SEPTIC TANK

RECEIVED
JAN 17 2019

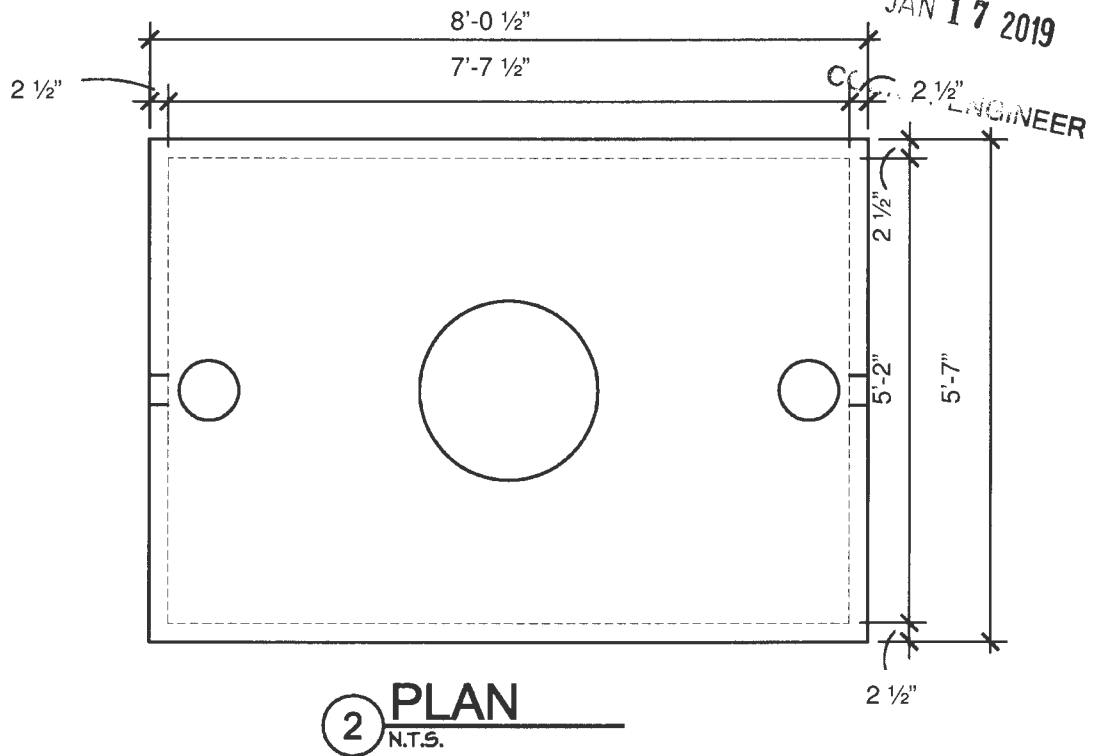

Stock #: 701060

Monolithic Tank
Meets ASTM-C-1227
Spec. for water and
wastewater tanks

Minimum Concrete
Compressive Strength
5,000 PSI

Butyl rubber sealant
between base and lid

Inlet= 49 1/2"
Outlet= 46 1/2"

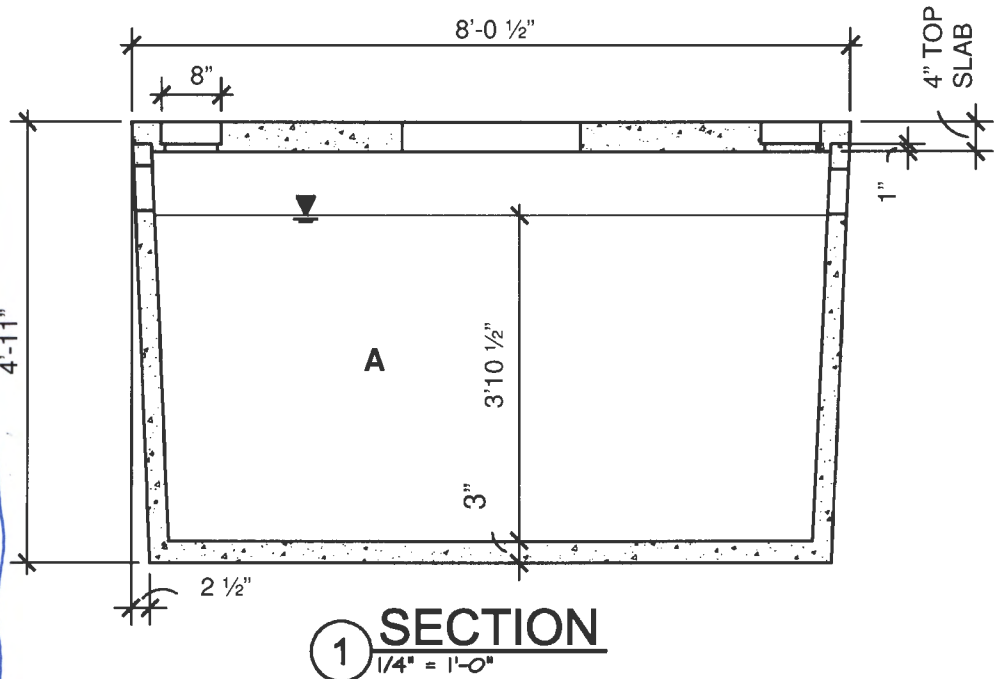

Pump settings for 420 GPD:
 Pump off: 12" above tank bott. (294 gal)
 Pump on: 29.25" above tank bott. (716 gal)
 Alarm on: 35.25" above tank bott. (864 gal)
 275 gal reserve cap. approx. 46.5" above
 tank bott.



YOUR TOTAL WASTEWATER SOLUTION	First Compartment (A)	Gallons / inch Compartment (A)	Approximate weight
www.siprecast.com	1141 gal.	24.5 gal. / inch	8,000 lbs.

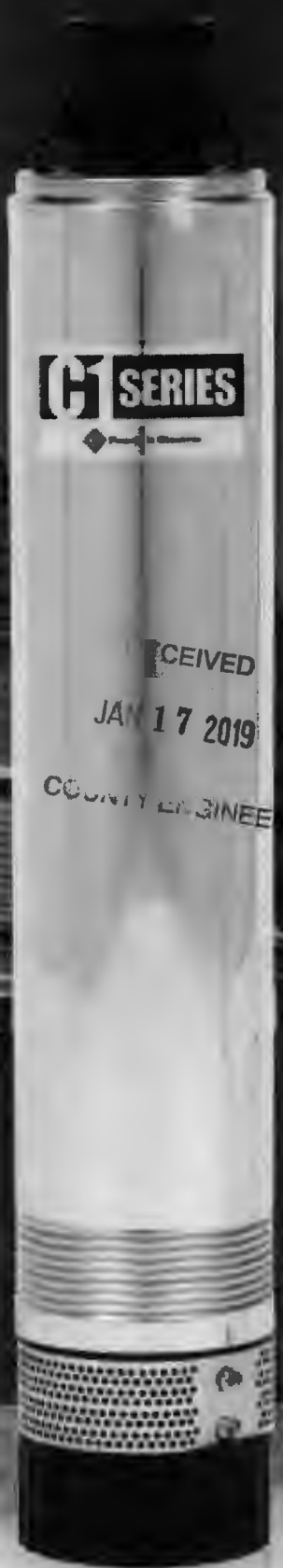

C1 SERIES

CISTERN PUMPS

Designed for use in raw water / filtered water applications, the C1 Series pump provides high performance and long life. The C1 Series pump is able to pass solids up to 1/2" (12.7 mm) without clogging the internal hydraulic components.

The pump's unique bottom suction design allows it to be installed in a cistern without compromising availability of clean water and it does not require the use of a riser pipe or suction sleeve. Intended specifically for agricultural, residential and commercial applications.



franklinwater.com



Franklin Electric

C1 Series Family Curve

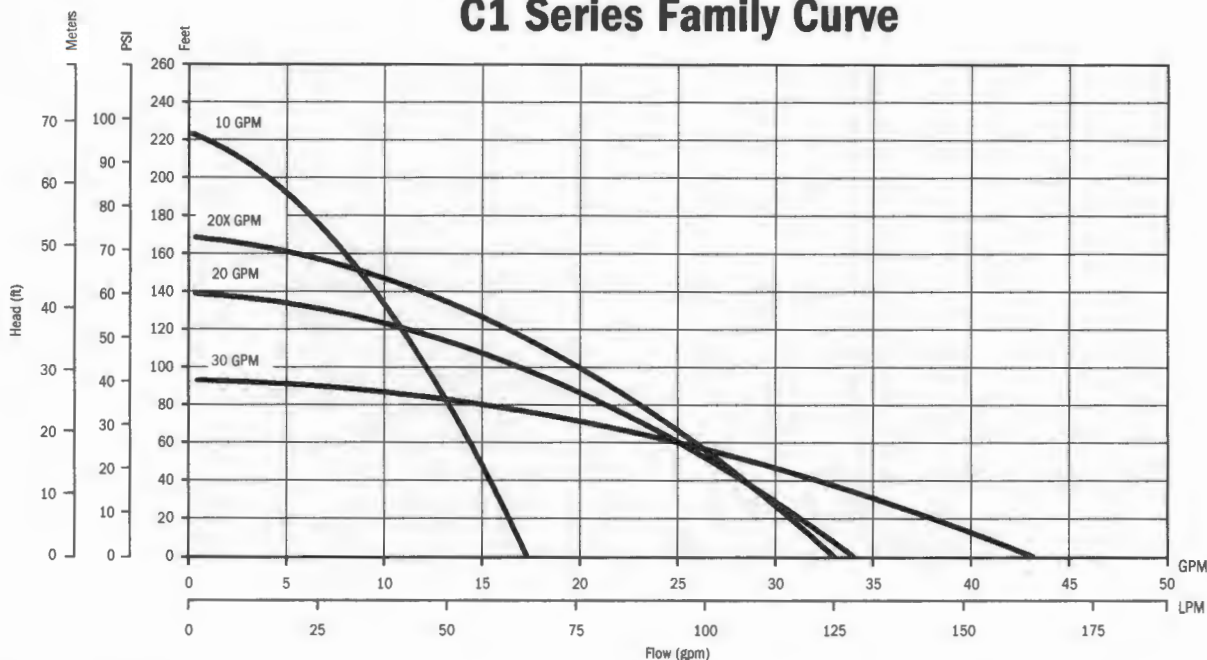

FEATURES

- Supplied with a removable 5" base for secure and reliable mounting
- Bottom suction design
- Robust thermoplastic discharge head design resists breakage during installation and operation
- Single shell housing design provides a compact unit while ensuring cool and quiet operation
- Hydraulic components molded from high quality engineered thermoplastics
- Optimized hydraulic design allows for increased performance and decreased power usage
- All metal components are made of high grade stainless steel for corrosion resistance
- Available with a high quality 115 V or 230 V, 1/2 hp motor
- Fluid flows of 10, 20, and 30 gpm, with a max shut-off pressure of over 100 psi
- Heavy duty 600 V 10 foot SJ00W jacketed lead

APPLICATIONS

- Gray water pumping
- Filtered effluent service water pumping
- Water reclamation projects such as pumping from rain catchment basins
- Aeration and other foundation or pond applications
- Agriculture and livestock water pumping

RECEIVED
JAN 17 2019

SECURITY ENGINEER

ORDERING INFORMATION

C1 Series Pumps							
GPM	HP	Volts	Stage	Model No.	Order No.	Length (in)	Weight (lbs)
10	1/2	115	7	10C1-05P4-2W115	90301005	26	17
		230	7	10C1-05P4-2W230	90301010	26	17
20		115	5	20C1-05P4-2W115	90302005	25	16
		230	5	20C1-05P4-2W230	90302010	25	16
20X		115	6	20XC1-05P4-2W115	90302015	26	17
		230	6	20XC1-05P4-2W230	90302020	26	17
30		115	4	30C1-05P4-2W115	90303005	25	16
		230	4	30C1-05P4-2W230	90303010	25	16

Note: All units have 10 foot long SJ00W leads.

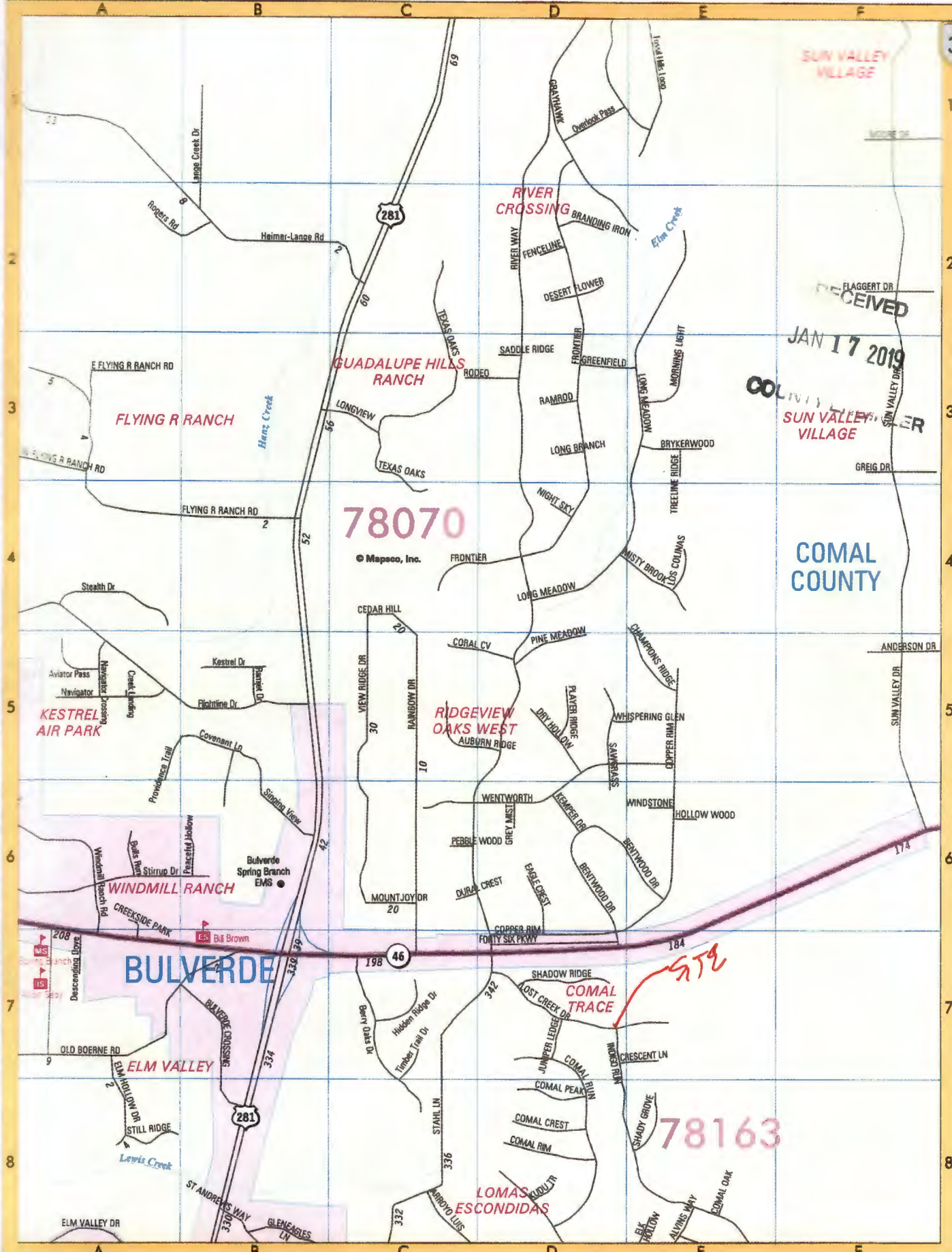

RECEIVED
 JAN 17 2019
 COLLEGE
 SUN VALLEY VILLAGE
 SUN VALLEY DR
 GREIG DR

78070
 © Mapso, Inc.

78163

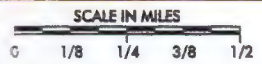

NOTICE OF CONFIDENTIALITY RIGHTS: IF YOU ARE A NATURAL PERSON, YOU MAY REMOVE OR STRIKE ANY OR ALL OF THE FOLLOWING INFORMATION FROM ANY INSTRUMENT THAT TRANSFERS AN INTEREST IN REAL PROPERTY BEFORE IT IS FILED FOR RECORD IN THE PUBLIC RECORDS: YOUR SOCIAL SECURITY NUMBER OR YOUR DRIVER'S LICENSE NUMBER.

GENERAL WARRANTY DEED

Date: September 27, 2017

Chicago TITLE GF# 4300271700 606
JJ

Grantor: Frederick Andrew Hawkins and wife, Mischa Hawkins

Grantor's Mailing Address:

11115 Wilson Oaks
San Antonio, TX 78249

RECORDED
31 JAN 2019
COUNTY

Grantee: Kristy L. Curl, a married person

Grantee's Mailing Address:

Consideration:

Ten and No/100 Dollars (\$10.00) and other good and valuable consideration, the receipt and sufficiency of which are hereby acknowledged.

Property (including any improvements):

LOT 37, COMAL TRACE SUBDIVISION, UNIT 2, COMAL COUNTY, TEXAS, ACCORDING TO THE MAP OR PLAT THEREOF RECORDED IN VOLUME 12, PAGES 295-296, MAP OR PLAT RECORDS OF COMAL COUNTY, TEXAS

Reservations from Conveyance and Warranty: None

This conveyance is made and accepted subject to any and all valid easements and rights-of-way of record, all presently recorded restrictions, reservations, covenants, conditions and other instruments other than liens and conveyances, filed of record, to the extent, if any, that they are valid and subsisting against the Property or any part thereof.

Grantor, for the consideration and subject to the reservations from and exceptions to conveyance and warranty, grants, sells, and conveys to Grantee the Property, together with all and singular the rights and appurtenances thereto in any wise belonging, to have and hold it to Grantee, Grantee's heirs, executors and administrators forever. Grantor binds Grantor and Grantor's heirs, executors and administrators to warrant and forever defend all and singular the Property to Grantee and Grantee's successors and assigns against every person whomsoever lawfully claiming or to claim the same or any part thereof, except as to the reservations from and exceptions to conveyance and warranty.

Ad valorem taxes and assessments attributable to the year 2017 have been prorated between Grantor and Grantee as of the date of this General Warranty Deed and Grantee hereby expressly assumes and agrees to pay the same for the current year and subsequent years.

When the context requires, singular nouns and pronouns include the plural.

GRANTOR:

Frederick Andrew Hawkins
Frederick Andrew Hawkins
Mischa Hawkins
Mischa Hawkins

FILED
JAN 27 2019
COURT

THE STATE OF TEXAS §
COUNTY OF GUADALUPE §

The foregoing instrument was acknowledged before me this 27th day of September, 2017 by **Frederick Andrew Hawkins**, in his individual capacity.

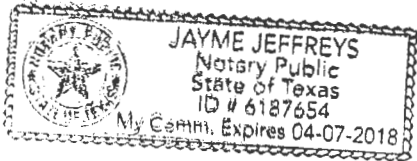

Jayme Jeffreys
Notary Public, State of Texas

THE STATE OF TEXAS §
COUNTY OF GUADALUPE §

The foregoing instrument was acknowledged before me this 27th day of September, 2017 by **Mischa Hawkins**, in her individual capacity.

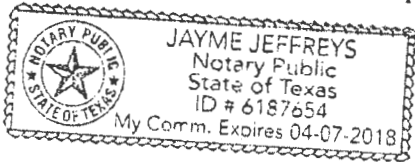

Jayme Jeffreys
Notary Public, State of Texas

AFTER RECORDING, PLEASE RETURN TO:

Chicago Title of Texas, LLC
Attn: Amber Volkmann
17115 IH 35, Suite 125
Schertz, Texas 78154

Filed and Recorded
Official Public Records
Bobbie Koeppe, County Clerk
Comal County, Texas
09/28/2017 03:51:35 PM
TERRI 2 Pages(s)
201706044305



Bobbie Koeppe

OSSF DEVELOPMENT APPLICATION CHECKLIST

Staff will complete shaded

items	Date Received
	Initials

Permit Number

Instructions:

Place a check mark next to all items that apply. For items that do not apply, place "N/A". This OSSF Development Application Checklist **must** accompany the completed application.

RECEIVED

JAN 17 2019

COUNTY ENGINEER

OSSF Permit

- Completed Application for Permit for Authorization to Construct an On-Site Sewage Facility and License to Operate
- Site/Soil Evaluation Completed by a Certified Site Evaluator or a Professional Engineer
- Planning Materials of the OSSF as Required by the TCEQ Rules for OSSF Chapter 285. Planning Materials shall consist of a scaled design and all system specifications.
- Required Permit Fee
- Copy of Recorded Deed
- Surface Application/Aerobic Treatment System
 - Recorded Certification of OSSF Requiring Maintenance/Affidavit to the Public
 - Signed Maintenance Contract with Effective Date as Issuance of License to Operate

I affirm that I have provided all information required for my OSSF Development Application and that this application constitutes a completed OSSF Development Application.

Signature of Applicant

Date

___ COMPLETE APPLICATION	
Check No. _____	Receipt No. _____

___ INCOMPLETE APPLICATION
(Missing Items Circled, Application Refused)

MJ Septic, LLC
27552 Old Blanco Road
San Antonio, TX 78260

Phone: (210) 875-3625

www.mjseptic.com mjseptic@mjseptic.com

To: **Brian and Kristy Curl**
581 Lost Creek Drive
Bulverde, TX 78163

Printed: 8/23/2019
Site: 581 Lost Creek Drive
Bulverde, TX 78163
(956) 878-5900

Permit #: **108642**

Agency: Comal County Environmental Health Comal County Environmental Health
County: Comal Sub: Comal Trace
Mfg / Brand: -
Treatment Type: Aerobic
Disposal: Surface Application

Customer ID: 5022

Contract Dates: 4/26/2019 - 4/26/2021

Scheduled Date: 8/26/2019

Inspection 1 of 6

Service Type: Scheduled Inspection

Visit Date: 8/12/2019

Time In: 3:45pm

This counts as a type of "Scheduled Inspection"

Entered By: Adela Shapiro

Method: Other

Technician: Manuel Guerrero

Copy emailed to the Agency
Agency Emailed: 8/23/2019

Maint. Provider: Michael J. Long

Aerators: Operational

Sludge Levels

Filters: Operational

For Tank 1: 0-1

Irrigation Pumps: Operational

Disinfection Device: Operational

Chlorine Supply: Operational

Chlorine Residual: 0.1mg/L

Tank Lid / Riser: Secured

Electric Circuits: Operational

Distribution System: Operational

Sprayfield Veg: Operational

Odor: Good

Alarm: Operational

Comments

Service Completed

- Technician Secured the Tank Lid and/or Riser prior to leaving location.
- *Septic tank cleaning is recommended between 10 and 12 inches of sludge in the pump tank (tank 1) or unless otherwise recommended by technician for other reasons such as full trash tank, etc.*
- *This inspection report is not valid for any real estate transactions*

Insp ID #: 27205

Provider: Michael J. Long

License #: MP0001294

Expires: 8/31/2019

MJ Septic, LLC
27552 Old Blanco Road
San Antonio, TX 78260

Phone: (210) 875-3625

www.mjseptic.com mjseptic@mjseptic.com

To: **Brian and Kristy Curl**
581 Lost Creek Drive
Bulverde, TX 78163

Printed: 9/20/2019
Site: 581 Lost Creek Drive
Bulverde, TX 78163
(956) 878-5900

Permit #: **108642**

Agency: Comal County Environmental Health
County: Comal
Mfg / Brand: -
Treatment Type: Aerobic
Disposal: Surface Application

Customer ID: 5022
Contract Dates: 4/26/2019 - 4/26/2021
Scheduled Date: 8/26/2019 Inspection 1 of 6

Service Type: Scheduled Inspection

This counts as a type of "Scheduled Inspection"

Visit Date: **8/12/2019**

Time In: 3:45pm

Entered By: Adela Shapiro

Method: Other

Technician: Manuel Guerrero

Copy emailed to the Agency
Agency Emailed: 8/23/2019

Maint. Provider: Michael J. Long

Aerators: Operational

Sludge Levels

For Tank 1: 0-1

Filters: Operational

Irrigation Pumps: Operational

Disinfection Device: Operational

Chlorine Supply: Operational

Chlorine Residual: 0.1mg/L

Tank Lid / Riser: Secured

Electric Circuits: Operational

Distribution System: Operational

Sprayfield Veg: Operational

Odor: Good

Alarm: Operational

Service Completed

Comments

- Technician Secured the Tank Lid and/or Riser prior to leaving location.
- *Septic tank cleaning is recommended between 10 and 12 inches of sludge in the pump tank (tank 1) or unless otherwise recommended by technician for other reasons such as full trash tank, etc.*
- *This inspection report is not valid for any real estate transactions*

Owner signature: _____

Insp ID #: 27205

Provider: *Michael J. Long*

License #: MP0001294

Expires: 8/31/2022

MJ Septic, LLC
27552 Old Blanco Road
San Antonio, TX 78260

Phone: (210) 875-3625

www.mjseptic.com mjseptic@mjseptic.com

To: **Brian and Kristy Curl**
581 Lost Creek Drive
Bulverde, TX 78163

Printed: 12/13/2019
Site: 581 Lost Creek Drive
Bulverde, TX 78163
(956) 878-5900

Permit #: **108642**

Customer ID: 5022

Agency: Comal County Environmental Health
County: Comal Sub: Comal Trace

Contract Dates: 4/26/2019 - 4/26/2021

Scheduled Date: 12/26/2019

Inspection 2 of 6

Mfg / Brand: -

Treatment Type: Aerobic

Disposal: Surface Application

Service Type: Scheduled Inspection

This counts as a type of "Scheduled Inspection"

Visit Date: 12/12/2019

Time In: 1:03pm

Entered By: Adela Shapiro

Method: Other

Copy emailed to Customer

Customer Emailed: 12/13/2019

Technician: Manuel Guerrero

Copy emailed to the Agency

Agency Emailed: 12/13/2019

Maint. Provider: Michael J. Long

Aerators: Operational

Sludge Levels

Filters: Operational

For Tank 1: 0-1

Irrigation Pumps: Operational

Disinfection Device: Operational

Chlorine Supply: Operational

Chlorine Residual: 0.1mg/L

Tank Lid / Riser: Secured

Electric Circuits: Operational

Distribution System: Operational

Sprayfield Veg: Operational

Odor: Good

Alarm: Operational

Service Completed

Comments

- Technician Secured the Tank Lid and/or Riser prior to leaving location.
- *Septic tank cleaning is recommended between 10 and 12 inches of sludge in the pump tank (tank 1) or unless otherwise recommended by technician for other reasons such as full trash tank, etc.*
- *This inspection report is not valid for any real estate transactions* - Copy emailed to the customer on 12/13/2019.

Insp ID #:29076

Provider: Michael J. Long

License #: MP0001294

Expires: 8/31/2022

MJ Septic, LLC
27552 Old Blanco Road
San Antonio, TX 78260

Phone: (210) 875-3625

www.mjseptic.com mjseptic@mjseptic.com

To: **Brian and Kristy Curl**
581 Lost Creek Drive
Bulverde, TX 78163

Printed: 4/17/2020
Site: 581 Lost Creek Drive
Bulverde, TX 78163
(956) 878-5900

Permit #: **108642**

Agency: Comal County Environmental Health Comal County Environmental Health
County: Comal Sub: Comal Trace
Mfg / Brand: -
Treatment Type: Aerobic
Disposal: Surface Application

Customer ID: 5022

Contract Dates: 4/26/2019 - 4/26/2021

Scheduled Date: 4/26/2020

Inspection 3 of 6

Service Type: Scheduled Inspection

Visit Date: 4/10/2020

Time In: 1:05p

Method: Other

Technician: Manuel Guerrero

Maint. Provider: Michael J. Long

This counts as a type of "Scheduled Inspection"

Entered By: Dolores Castaneda

- Copy emailed to Customer
Customer Emailed: 4/10/2020
- Copy emailed to the Agency
Agency Emailed: 4/17/2020

Aerators: Operational

Filters: Operational

Irrigation Pumps: Operational

Disinfection Device: Operational

Chlorine Supply: Operational

Chlorine Residual: 0.1mg/L

Sludge Levels

For Tank 1: 0-1

Chlorinator: Op

Tank Lid / Riser: Secured

Electric Circuits: Operational

Distribution System: Operational

Sprayfield Veg: Operational

Alarm: Operational

Comments

Service Completed

- Technician Secured the Tank Lid and/or Riser prior to leaving location.
- *Septic tank cleaning is recommended between 10 and 12 inches of sludge in the pump tank (tank 1) or unless otherwise recommended by technician for other reasons such as full trash tank, etc.*
- *This inspection report is not valid for any real estate transactions* - Copy emailed to the customer on 4/10/2020.

Insp ID #: 31220

Provider: *Michael J. Long*

License #: MP0001294

Expires: 8/31/2022

MJ Septic, LLC
27552 Old Blanco Road
San Antonio, TX 78260

Phone: (210) 875-3625

www.mjseptic.com mjseptic@mjseptic.com

To: **Brian and Kristy Curl**
581 Lost Creek Drive
Bulverde, TX 78163

Printed: 8/14/2020
Site: 581 Lost Creek Drive
Bulverde, TX 78163
(956) 878-5900

Permit #: **108642**

Customer ID: 5022

Agency: Comal County Environmental Health Comal County Environmental Health

Contract Dates: 4/26/2019 - 4/26/2021

County: Comal

Sub: Comal Trace

Scheduled Date: 8/26/2020

Inspection 4 of 6

Mfg / Brand: -

Treatment Type: Aerobic

Disposal: Surface Application

Service Type: Scheduled Inspection

This counts as a type of "Scheduled Inspection"

Visit Date: **8/11/2020**

Time In: 12:43 pm

Entered By: Adela Shapiro

Method: **Other**

Technician: Manuel Guerrero

Copy emailed to Customer

Customer Emailed: 8/11/2020

Maint. Provider: Michael J. Long

Copy emailed to the Agency

Agency Emailed: 8/14/2020

Aerators: Operational

Sludge Levels

Filters: Operational

For Tank 1: 0-1

Irrigation Pumps: Operational

Disinfection Device: Operational

Chlorine Supply: Operational

Chlorine Residual: 0.1mg/L

Tank Lid / Riser: Secured

Electric Circuits: Operational

Distribution System: Operational

Sprayfield Veg: Operational

Odor: Good

Alarm: Operational

Service Completed

Comments

- Technician Secured the Tank Lid and/or Riser prior to leaving location.

- *Septic tank cleaning is recommended between 10 and 12 inches of sludge in the pump tank (tank 1) or unless otherwise recommended by technician for other reasons such as full trash tank, etc.*

- *This inspection report is not valid for any real estate transactions* - Copy emailed to the customer on 8/11/2020. - Copy emailed to the customer on 8/11/2020.

Insp ID #:33277

Provider: *Michael J. Long*

License Info: MP0001294 Expires: 8/31/2022

MJ Septic, LLC
27552 Old Blanco Road
San Antonio, TX 78260

Phone: (210) 875-3625

www.mjseptic.com mjseptic@mjseptic.com

To: **Brian and Kristy Curl**
581 Lost Creek Drive
Bulverde, TX 78163

Printed: 12/18/2020
Site: 581 Lost Creek Drive
Bulverde, TX 78163
(956) 878-5900

Permit #: **108642**

Agency: Comal County Environmental Health Comal County Environmental Health
County: Comal Sub: Comal Trace
Mfg / Brand: -
Treatment Type: Aerobic
Disposal: Surface Application

Customer ID: 5022

Contract Dates: 4/26/2019 - 4/26/2021

Scheduled Date: 12/26/2020 Inspection 5 of 6

Service Type: Scheduled Inspection

Visit Date: **12/11/2020**

Time In: 12:22pm

Method: **Other**

Technician: Manuel Guerrero

Maint. Provider: Michael J. Long

This counts as a type of "Scheduled Inspection"

Entered By: Ashley Nicole Larcom

Copy emailed to Customer

Customer Emailed: 12/11/2020

Copy emailed to the Agency

Agency Emailed: 12/18/2020

Aerators: Operational

Filters: Operational

Irrigation Pumps: Operational

Disinfection Device: Operational

Chlorine Supply: Operational

Chlorine Residual: 0.1mg/L

Sludge Levels

For Tank 1: 0-1

Tank Lid / Riser: Secured

Electric Circuits: Operational

Distribution System: Operational

Sprayfield Veg: Operational

Odor: Good

Alarm: Operational

Comments

Service Completed

- Technician Secured the Tank Lid and/or Riser prior to leaving location.
- *Septic tank cleaning is recommended between 10 and 12 inches of sludge in the pump tank (tank 1) or unless otherwise recommended by technician for other reasons such as full trash tank, etc.*
- *This inspection report is not valid for any real estate transactions* - Copy emailed to the customer on 12/11/2020.

Insp ID #:35349

Provider: *Michael J. Long*

License Info: MP0001294 Expires: 8/31/2022

MJ Septic, LLC
27552 Old Blanco Road
San Antonio, TX 78260

Phone: (210) 875-3625

www.mjseptic.com mjseptic@mjseptic.com

To: **Brian and Kristy Curl**
581 Lost Creek Drive
Bulverde, TX 78163

Printed: 4/16/2021
Site: 581 Lost Creek Drive
Bulverde, TX 78163
(956) 878-5900

Permit #: **108642**

Customer ID: 5022

Agency: Comal County Environmental Health Comal County Environmental Health

Contract Dates: 4/26/2021 - 4/26/2022

County: Comal

Sub: Comal Trace

Scheduled Date: 4/26/2021

Inspection 6 of 6

Mfg / Brand: -

Treatment Type: Aerobic

Disposal: Surface Application

Service Type: Scheduled Inspection

This counts as a type of "Scheduled Inspection"

Visit Date: 4/13/2021

Time In: 1:40PM

Entered By: Catherine Jefferson

Method: Other

Copy emailed to Customer

Customer Emailed: 4/16/2021

Technician: Manuel Guerrero

Copy emailed to the Agency

Agency Emailed: 4/16/2021

Maint. Provider: Michael J. Long

Aerators: Operational

Sludge Levels

Filters: Operational

For Tank 1: 0"

Irrigation Pumps: Operational

Disinfection Device: Operational

Chlorine Supply: Operational

Chlorine Residual: 0.1mg/L

Chlorinator: Op

Tank Lid / Riser: Secured

Electric Circuits: Operational

Distribution System: Operational

Sprayfield Veg: Operational

Alarm: Operational

Comments

Service Completed

- Tech reset your timer. - Technician Secured the Tank Lid and/or Riser prior to leaving location. - *Septic tank cleaning is recommended between 10 and 12 inches of sludge in the pump tank (tank 1) or unless otherwise recommended by technician for other reasons such as full trash tank, etc.* - *This inspection report is not valid for any real estate transactions* - Copy emailed to the customer on 4/16/2021.

Insp ID #:37458

Provider: Michael J. Long

License Info: MP0001294 Expires: 8/31/2022

MJ Septic, LLC
1328 W Borgfeld
San Antonio, TX 78260

Phone: (210) 875-3625

www.mjseptic.com mjseptic@mjseptic.com

To: **Brian and Kristy Curl**
581 Lost Creek Drive
Bulverde, TX 78163

Printed: 9/2/2021
Site: 581 Lost Creek Drive
Bulverde, TX 78163
(956) 878-5900

Permit #: **108642**

Customer ID: 5022

Agency: Comal County Environmental Health Comal County Environmental Health
County: Comal Sub: Comal Trace
Mfg / Brand: -

Contract Dates: 4/26/2021 - 4/26/2022

Scheduled Date: 8/6/2021

Inspection 1 of 3

Treatment Type: Aerobic

Disposal: Surface Application

Service Type: Scheduled Inspection

This counts as a type of "Scheduled Inspection"

Visit Date: **8/11/2021**

Time In: 5:40 pm

Entered By: Hailey Long

Method: Other

Copy emailed to Customer

Customer Emailed: 8/12/2021

Technician: Manuel Guerrero

Copy emailed to the Agency

Agency Emailed: 9/2/2021

Maint. Provider: Michael J. Long

Aerators: Operational

Sludge Levels

Filters: Operational

For Tank 1: 0"

Irrigation Pumps: Operational

Disinfection Device: Operational

Chlorine Supply: Operational

Chlorine Residual: 0.1mg/L

Chlorinator: Op

Tank Lid / Riser: Secured

Electric Circuits: Operational

Distribution System: Operational

Sprayfield Veg: Operational

Alarm: Operational

Comments

Service Completed

- Technician Secured the Tank Lid and/or Riser prior to leaving location. - *Septic tank cleaning is recommended between 10 and 12 inches of sludge in the pump tank (tank 1) or unless otherwise recommended by technician for other reasons such as full trash tank, etc.* - *This inspection report is not valid for any real estate transactions* - Tech reset your timer. - Copy emailed to the customer on 8/12/2021.

Insp ID #:39633

Provider: *Michael J. Long*

License Info: MP0001294 Expires: 8/31/2022

MJ Septic, LLC
1328 W Borgfeld
San Antonio, TX 78260

Phone: (210) 875-3625

www.mjseptic.com mjseptic@mjseptic.com

To: **Brian & Kristy Curl**
581 Lost Creek Dr
Bulverde, TX 78163

Printed:12/17/2021
Site: 581 Lost Creek Dr
Bulverde, TX 78163
(956) 878-5900

Permit #: **108642**

Agency: Comal County Environmental Health Comal County Environmental Health
County: Comal Sub: Comal Trace
Mfg / Brand: -
Treatment Type: Aerobic
Disposal: Surface Application

Customer ID: 5022
Contract Dates: 4/26/2021 - 4/26/2022
Scheduled Date: 12/6/2021 Inspection 2 of 3

Service Type: Scheduled Inspection

This counts as a type of "Scheduled Inspection"

Visit Date: **12/13/2021**

Time In: 2:11PM

Entered By: Catherine Jefferson

Method: **Other**

Copy emailed to Customer
Customer Emailed: 12/14/2021

Technician: Manuel Guerrero

Copy emailed to the Agency
Agency Emailed: 12/17/2021

Maint. Provider: Michael J. Long

Aerators: Operational

Sludge Levels

Filters: Operational

For Tank 1: 1"

Irrigation Pumps: Operational

Disinfection Device: Operational

Chlorine Supply: Operational

Chlorine Residual: 0.1mg/L

Chlorinator: Op

Tank Lid / Riser: Secured

Electric Circuits: Operational

Distribution System: Operational

Sprayfield Veg: Operational

Alarm: Operational

Comments

Service Completed

- Tech reset your timer. - Technician Secured the Tank Lid and/or Riser prior to leaving location. - *Septic tank cleaning is recommended between 10 and 12 inches of sludge in the pump tank (tank 1) or unless otherwise recommended by technician for other reasons such as full trash tank, etc.* - *This inspection report is not valid for any real estate transactions* - Copy emailed to the customer on 12/14/2021.

Insp ID #:41844

Provider: *Michael J. Long*

License Info: MP0001294 Expires: 8/31/2022

MJ Septic, LLC
1328 W Borgfeld
San Antonio, TX 78260

Phone: (210) 875-3625

www.mjseptic.com mjseptic@mjseptic.com

To: **Brian & Kristy Curl**
581 Lost Creek Dr
Bulverde, TX 78163

Printed: 4/15/2022
Site: 581 Lost Creek Dr
Bulverde, TX 78163
(956) 878-5900

Permit #: **108642 & 112708**

Agency: Comal County Environmental Health Comal County Environmental Health
County: Comal Sub: Comal Trace
Mfg / Brand: Pro Flo Aerobic Systems, LP - Pro Flo Aerobic Systems, LP
Treatment Type: Aerobic
Disposal: Surface Application

Customer ID: 5022
Contract Dates: 4/26/2021 - 4/26/2022
Scheduled Date: 4/6/2022 Inspection 3 of 3

Service Type: Scheduled Inspection

This counts as a type of "Scheduled Inspection"

Visit Date: **4/8/2022**

Time In: 3:35 PM

Entered By: Tracy Murphy

Method: Other

Copy emailed to Customer
Customer Emailed: 4/11/2022

Technician: Manuel Guerrero

Copy emailed to the Agency
Agency Emailed: 4/15/2022

Maint. Provider: Michael J. Long

Aerators: Operational

Sludge Levels

Filters: Operational

For Tank 1: 2"

Irrigation Pumps: Operational

Disinfection Device: Operational

Chlorine Supply: Operational

Chlorine Residual: 0.1mg/L

Chlorinator: Op

Tank Lid / Riser: Secured

Electric Circuits: Operational

Distribution System: Operational

Sprayfield Veg: Operational

Alarm: Operational

Comments

Service Completed

- Tech reset your timer. - Technician Secured the Tank Lid and/or Riser prior to leaving location. - *Septic tank cleaning is recommended between 10 and 12 inches of sludge in the pump tank (tank 1) or unless otherwise recommended by technician for other reasons such as full trash tank, etc.* - *This inspection report is not valid for any real estate transactions*

- ***This was your FINAL inspection for your current contract, please call (210) 875-3625 to renew your contract, to stay in compliance*** - Copy emailed to the customer on 4/11/2022.

Insp ID #:44023

Provider: *Michael J. Long*

License Info: MP0001294 Expires: 8/31/2022

PS Septic Supply & Service
23011 FM 306
Canyon Lake, TX 78133

Phone: (830) 850-0080
Fax: (830) 935-4932

Printed: 11/18/2022 Insp ID #: 23033 Permit #:

To: Brian Curl (main house system)
581 Lost Creek Drive
Bulverde, TX 78613

Main Phone: (830) 714-3022
Work:
Cell Phone:
Alt Cell:

Customer ID: 4574
Contract Dates: 7/19/2022 - 7/19/2024
Scheduled Date: 11/19/2022 Inspection 1 of 6

Agency: Comal County
County:
Mfg / Brand: -

GPS Coordinates: Latitude: 29.79476 Longitude: -98.40184

Service Type: Scheduled Inspection

This counts as a type of "Scheduled Inspection"

Visit Date: 11/17/2022

Entered By: Nicole Loria

Method: Grab

Copy emailed to Customer

Customer Emailed: 11/18/2022

Technician: Not Assigned

Maint. Provider: Ryan Seidensticker

Aerators: Operational

Sludge Levels

Filters: Operational

For Tank 1: 12

Irrigation Pumps: Operational

For Tank 2: N/A

Disinfection Device: Operational

For Tank 3: 2

Chlorine Supply: Operational

Chlorine Residual: .24

Electric Circuits: Operational

Tank Lid / Riser: Secured

Distribution System: Operational

Insp. Port / Plug: Secured

Sprayfield Veg: Operational

Alarm: Operational

Comments

Service Completed

- Scum on pretreatment 4 - Technician Secured the Tank Lid and/or Riser prior to leaving location. - Inspection Port Plug was noted as Secured prior to leaving. - Copy emailed to the customer on 11/18/2022. - The Agency was emailed a PDF Copy on 11/18/2022.

Site: 581 Lost Creek Drive, Bulverde, TX 78613

Provider: *Christopher Ryan Seidensticker*
PS Septic Supply & Service

License Info: MP0001708 Expires: