

Comal County

OFFICE OF COMAL COUNTY ENGINEER

License to Operate On-Site Sewage Treatment and Disposal Facility

Issued This Date: **03/19/2019** Permit Number: **108765**

Location Description: **1562 HILLCREST FOREST
CANYON LAKE, TX 78133**

Subdivision: Canyon Lake Forest
Unit: 1
Lot: 83
Block:
Acreage:

Type of System: **Aerobic
Drip Irrigation**

Issued to: **BGRM, LP**

This license is authorization for the owner to operate and maintain a private facility at the location described in accordance to the rules and regulations for on-site sewerage facilities of Comal County, Texas, and the Texas Commission on Environmental Quality.

The license grants permission to operate the facility. It does not guarantee successful operation. It is the responsibility of the owner to maintain and operate the facility in a satisfactory manner.

Alterations to this permit including, but not limited to:

- Increase in the square feet of living area
- Increase in the number of bedrooms
- A change of use (i.e. residential to commercial)
- Relocation of system components (including the relocation of spray heads)
- Installation of landscaping
- Adding new structures to the system

may require a new permit. **It is the responsibility of the owner to apply for a new permit, if applicable.**

Inspection and licensing of a facility indicates only that the facility meets certain minimum requirements. It does not impede any governmental entity in taking the proper steps to prevent or control pollution, to abate nuisance, or to protect the public health.

This license to operate is valid for an indefinite period. The holder may transfer it to a succeeding owner, provided the facility has not been remodeled and is functioning properly.

Licensing Authority
Comal County Environmental Health

ENVIRONMENTAL HEALTH INSPECTOR

OS0034322

ENVIRONMENTAL HEALTH COORDINATOR

OS 0025599

10:30

Comal County Environmental Health OSSF Inspection Sheet

Installer Name: J.R. Avila OSSF Installer #: 050021674
 1st Inspection Date: 2-28-19 2nd Inspection Date: 3-8-19 3rd Inspection Date: 3-19-19
 Inspector Name: A. Helmer Inspector Name: Aneread Inspector Name: Andrew
 Permit#: 108765 Address: 1562 Hillcrest Forest - C.L. Forest

No.	Description	Answer	Citations	Notes	1st Insp.	2nd Insp.	3rd Insp.
1	SITE AND SOIL CONDITIONS & SETBACK DISTANCES Site and Soil Conditions Consistent with Submitted Planning Materials	✓	285.31(a) 285.30(b)(1)(A)(iv) 285.30(b)(1)(A)(v) 285.30(b)(1)(A)(iii) 285.30(b)(1)(A)(ii) 285.30(b)(1)(A)(i)		2-28-19		
2	SITE AND SOIL CONDITIONS & SETBACK DISTANCES Setback Distances Meet Minimum Standards	✓	285.91(10) 285.30(b)(4) 285.31(d)				
3	SEWER PIPE Proper Type Pipe from Structure to Disposal System (Cast Iron, Ductile Iron, Sch. 40, SDR 26)	✓	285.32(a)(1)				
4	SEWER PIPE Slope from the Sewer to the Tank at least 1/8 Inch Per Foot	✓	285.32(a)(3)				
5	SEWER PIPE Two Way Sanitary - Type Cleanout Properly Installed (Add. C/O Every 100' &/or 90 degree bends)	✓	285.32(a)(5)				
6	PRETREATMENT Installed (if required) TCEQ Approved List PRETREATMENT Septic Tank(s) Meet Minimum Requirements	✓	285.32(b)(1)(G) 285.32(b)(1)(E)(iii) 285.32(b)(1)(E)(iv) 285.32(b)(1)(F) 285.32(b)(1)(B) 285.32(b)(1)(C)(I) 285.32(b)(1)(C)(II) 285.32(b)(1)(D) 285.32(b)(1)(E) 285.32(b)(1)(A) 285.32(b)(1)(E)(ii)(III) 285.32(b)(1)(E)(i) 285.32(b)(1)(E)(ii)(I)				
7	PRETREATMENT Grease Interceptors if required for commercial		285.34(d)				

2-28-19-SH
 tank check only
 set + level
 water line allowed

3-8-19
 operational
 ready for
 cover.

3-19-19
 covered
 per design.

**Comal County Environmental Health
OSSF Inspection Sheet**

No.	Description	Answer	Citations	Notes	1st Insp.	2nd Insp.	3rd Insp.
8	SEPTIC TANK Tank(s) Clearly Marked SEPTIC TANK if Single Tank, 2 Compartments Provided with Baffle SEPTIC TANK Inlet Flowline Greater than 3" and " T " Provided on Inlet and Outlet SEPTIC TANK Septic Tank(s) Meet Minimum Requirements	✓	285.32(b)(1)(E) 285.91(2) 285.32(b)(1)(F) 285.32(b)(1)(E)(iii) 285.32(b)(1)(E)(ii)(I) 285.32(b)(1)(E)(ii)(I) 285.32(b)(1)(E)(i) 285.32(b)(1)(D) 285.32(b)(1)(C)(ii) 285.32(b)(1)(C)(i) 285.32(b)(1)(B) 285.32(b)(1)(A) 285.32(b)(1)(E)(iv)		2-28-19		
9	ALL TANKS Installed on 4" Sand Cushion/ Proper Backfill Used	✓	285.32(b)(1)(F) 285.32(b)(1)(G) 285.34(b)				
10	SEPTIC TANK Inspection / Clean Out Port & Risers Provided on Tanks Buried Greater than 12" Sealed and Capped	✓	285.38(d)				
11	SEPTIC TANK Secondary restraint system provided SEPTIC TANK Riser permanently fastened to lid or cast into tank SEPTIC TANK Riser cap protected against unauthorized intrusions	✓	285.38(d) 285.38(e)				
12	SEPTIC TANK Tank Volume Installed	✓					
13	PUMP TANK Volume Installed	✓		550			
14	AEROBIC TREATMENT UNIT Size Installed	✓		600			
15	AEROBIC TREATMENT UNIT Manufacturer AEROBIC TREATMENT UNIT Model Number	✓		Hiwater			
16	DISPOSAL SYSTEM Absorptive		285.33(a)(4) 285.33(a)(1) 285.33(a)(2) 285.33(a)(3)				
17	DISPOSAL SYSTEM Leaching Chamber		285.33(a)(1) 285.33(a)(3) 285.33(a)(4) 285.33(a)(2)				
18	DISPOSAL SYSTEM Evapo-transpirative		285.33(a)(3) 285.33(a)(4) 285.33(a)(1) 285.33(a)(2)				

**Comal County Environmental Health
OSSF Inspection Sheet**

No.	Description	Answer	Citations	Notes	1st Insp.	2nd Insp.	3rd Insp.
19	DISPOSAL SYSTEM Drip Irrigation	✓	285.33(a)(1) 285.33(a)(3) 285.33(a)(4) 285.33(a)(2)			✓	✓
20	DISPOSAL SYSTEM Soil Substitution		285.33(d)(4)				
21	DISPOSAL SYSTEM Pumped Effluent		285.33(a)(4) 285.33(a)(3) 285.33(a)(1)				
22	DISPOSAL SYSTEM Gravelless Pipe		285.33(a)(3) 285.33(a)(2) 285.33(a)(4) 285.33(a)(1)				
23	DISPOSAL SYSTEM Mound		285.33(a)(3) 285.33(a)(1) 285.33(a)(2) 285.33(a)(4)				
24	DISPOSAL SYSTEM Other (describe) (Approved Design)		285.33(d)(6) 285.33(c)(4)				
25	DRAINFIELD Absorptive Drainline 3" PVC or 4" PVC	✓				✓	
26	DRAINFIELD Area Installed	✓				✓	
27	DRAINFIELD Level to within 1 inch per 25 feet and within 3 inches over entire excavation		285.33(b)(1)(A)(v)				
28	DRAINFIELD Excavation Width DRAINFIELD Excavation Depth DRAINFIELD Excavation Separation DRAINFIELD Depth of Porous Media DRAINFIELD Type of Porous Media						
29	DRAINFIELD Pipe and Gravel - Geotextile Fabric in Place		285.33(b)(1)(E)				
30	DRAINFIELD Leaching Chambers DRAINFIELD Chambers - Open End Plates w/Splash Plate, Inspection Port & Closed End Plates in Place (per manufacturers spec.)		285.33(c)(2)				
31	LOW PRESSURE DISPOSAL SYSTEM Adequate Trench Length & Width, and Adequate Separation Distance between Trenches		285.33(d)(1)(C)(i)				

**Comal County Environmental Health
OSSF Inspection Sheet**

No.	Description	Answer	Citations	Notes	1st Insp.	2nd Insp.	3rd Insp.
32	<p>EFFLUENT DISPOSAL SYSTEM Utilized Only by Single Family Dwelling</p> <p>EFFLUENT DISPOSAL SYSTEM Topographic Slopes < 2.0%</p> <p>EFFLUENT DISPOSAL SYSTEM Adequate Length of Drain Field (1000 Linear ft. for 2 bedrooms or Less & an additional 400 ft. for each additional bedroom)</p> <p>EFFLUENT DISPOSAL SYSTEM Lateral Depth of 18 inches to 3 ft. & Vertical Separation of 1ft on bottom and 2 ft. to restrictive horizon and ground water respectfully</p> <p>EFFLUENT DISPOSAL SYSTEM Lateral Drain Pipe (1.25 - 1.5" dia.) & Pipe Holes (3/16 - 1/4" dia. Hole Size) 5 ft. Apart</p>		<p>285.33(b)(3)(A)</p> <p>285.33(b)(3)(A)</p> <p>285.33(b)(3)(B)</p> <p>285.91(13)</p> <p>285.33(b)(3)(D)</p> <p>285.33(b)(3)(F)</p>				
33	<p>AEROBIC TREATMENT UNIT Is Aerobic Unit Installed According to Approved Guidelines.</p>	✓	285.32(c)(1)			✓	
34	<p>AEROBIC TREATMENT UNIT Inspection/Clean Out Port & Risers Provided</p> <p>AEROBIC TREATMENT UNIT Secondary restraint system provided</p> <p>AEROBIC TREATMENT UNIT Riser permanently fastened to lid or cast into tank</p> <p>AEROBIC TREATMENT UNIT Riser cap protected against unauthorized intrusions</p>	✓				✓	
35	<p>AEROBIC TREATMENT UNIT Chlorinator Properly Installed with Chlorine Tablets In Place.</p>	✓				✓	
36	<p>PUMP TANK Is the Pump Tank an approved concrete tank or other acceptable materials & construction</p> <p>PUMP TANK Sampling Port Provided in the Treated Effluent Line</p> <p>PUMP TANK Check Valve and/or Anti- Siphon Device Present When Required</p> <p>PUMP TANK Audible and Visual High Water Alarm Installed on Separate Circuit From Pump</p>						
37	<p>PUMP TANK Inspection/Clean Out Port & Risers Provided</p> <p>PUMP TANK Secondary restraint system provided</p> <p>PUMP TANK Riser permanently fastened to lid or cast into tank</p> <p>PUMP TANK Riser cap protected against unauthorized intrusions</p>						
38	<p>PUMP TANK Secondary restraint system provided</p>						

Comal County Environmental Health
OSSF Inspection Sheet

39 PUMP TANK Electrical Connections in Approved Junction Boxes / Wiring Buried	✓				✓	
--	---	--	--	--	---	--

**Comal County Environmental Health
OSSF Inspection Sheet**

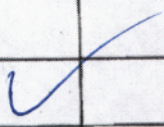
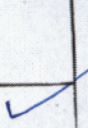
No.	Description	Answer	Citations	Notes	1st Insp.	2nd Insp.	3rd Insp.
40	APPLICATION AREA Distribution Pipe, Fitting, Sprinkler Heads & Valve Covers Color Coded Purple?		285.33(d)(2)(G)(iii)(ii)285.33(d)(2)(G)(iii)(iii)285.33(d)(2)(G)(v) 285.33(d)(2)(G)(iii) 285.33(d)(2)(G)(iv) 285.33(d)(2)(G)(i) 285.33(d)(2)(G)(ii) 285.33(d)(2)(G)(iii)(i)				
41	APPLICATION AREA Low Angle Nozzles Used / Pressure is as required APPLICATION AREA Acceptable Area, nothing within 10 ft of sprinkler heads? APPLICATION AREA The Landscape Plan is as Designed		285.33(d)(2)(G)(i) 285.33(d)(2)(A) 285.33(d)(2)(F)				
42	APPLICATION AREA Area Installed						
43	PUMP TANK Meets Minimum Reserve Capacity Requirements						
44	PUMP TANK Material Type & Manufacturer						
45	PUMP TANK Type/Size of Pump Installed						

10:30

Comal County Environmental Health OSSF Inspection Sheet

Installer Name: J.R. Avila OSSF Installer #: 050021674

1st Inspection Date: 2.28.19 2nd Inspection Date: 3.8.19 3rd Inspection Date: _____

Inspector Name: K. Helms Inspector Name: Amerca Inspector Name: _____

Permit#: 108765 Address: 1562 Hillcrest Forest - C.L. Forest

No.	Description	Answer	Citations	Notes	1st Insp.	2nd Insp.	3rd Insp.
1	SITE AND SOIL CONDITIONS & SETBACK DISTANCES Site and Soil Conditions Consistent with Submitted Planning Materials	✓	285.31(a) 285.30(b)(1)(A)(iv) 285.30(b)(1)(A)(v) 285.30(b)(1)(A)(iii) 285.30(b)(1)(A)(ii) 285.30(b)(1)(A)(i)		2.28.19		
2	SITE AND SOIL CONDITIONS & SETBACK DISTANCES Setback Distances Meet Minimum Standards	✓	285.91(10) 285.30(b)(4) 285.31(d)				
3	SEWER PIPE Proper Type Pipe from Structure to Disposal System (Cast Iron, Ductile Iron, Sch. 40, SDR 26)	✓	285.32(a)(1)				
4	SEWER PIPE Slope from the Sewer to the Tank at least 1/8 Inch Per Foot	✓	285.32(a)(3)				
5	SEWER PIPE Two Way Sanitary - Type Cleanout Properly Installed (Add. C/O Every 100' &/or 90 degree bends)	✓	285.32(a)(5)				
6	PRETREATMENT Installed (if required) TCEQ Approved List PRETREATMENT Septic Tank(s) Meet Minimum Requirements		285.32(b)(1)(G) 285.32(b)(1)(E)(iii) 285.32(b)(1)(E)(iv) 285.32(b)(1)(F) 285.32(b)(1)(B) 285.32(b)(1)(C)(i) 285.32(b)(1)(C)(ii) 285.32(b)(1)(D) 285.32(b)(1)(E) 285.32(b)(1)(A) 285.32(b)(1)(E)(ii)(II) 285.32(b)(1)(E)(i) 285.32(b)(1)(E)(ii)(I)				
7	PRETREATMENT Grease Interceptors if required for commercial		285.34(d)				

2.28.19. SH
tank check only
set + level
water line allowed

3.8.19
operational
Ready for
cover.

**Comal County Environmental Health
OSSF Inspection Sheet**

No.	Description	Answer	Citations	Notes	1st Insp.	2nd Insp.	3rd Insp.
8	SEPTIC TANK Tank(s) Clearly Marked SEPTIC TANK If Single Tank, 2 Compartments Provided with Baffle SEPTIC TANK Inlet Flowline Greater than 3" and " T " Provided on Inlet and Outlet SEPTIC TANK Septic Tank(s) Meet Minimum Requirements	✓	285.32(b)(1)(E) 285.91(2) 285.32(b)(1)(F) 285.32(b)(1)(E)(iii) 285.32(b)(1)(E)(ii)(II) 285.32(b)(1)(E)(ii)(I) 285.32(b)(1)(E)(i) 285.32(b)(1)(D) 285.32(b)(1)(C)(ii) 285.32(b)(1)(C)(i) 285.32(b)(1)(B) 285.32(b)(1)(A) 285.32(b)(1)(E)(iv)				
9	ALL TANKS Installed on 4" Sand Cushion/ Proper Backfill Used	✓	285.32(b)(1)(F) 285.32(b)(1)(G) 285.34(b)				
10	SEPTIC TANK Inspection / Clean Out Port & Risers Provided on Tanks Buried Greater than 12" Sealed and Capped	✓	285.38(d)				
11	SEPTIC TANK Secondary restraint system provided SEPTIC TANK Riser permanently fastened to lid or cast into tank SEPTIC TANK Riser cap protected against unauthorized intrusions	✓	285.38(d) 285.38(e)				
12	SEPTIC TANK Tank Volume Installed	✓					
13	PUMP TANK Volume Installed	✓		550			
14	AEROBIC TREATMENT UNIT Size Installed	✓		600			
15	AEROBIC TREATMENT UNIT Manufacturer AEROBIC TREATMENT UNIT Model Number	✓		Nuwater			
16	DISPOSAL SYSTEM Absorptive		285.33(a)(4) 285.33(a)(1) 285.33(a)(2) 285.33(a)(3)				
17	DISPOSAL SYSTEM Leaching Chamber		285.33(a)(1) 285.33(a)(3) 285.33(a)(4) 285.33(a)(2)				
18	DISPOSAL SYSTEM Evapo-transpirative		285.33(a)(3) 285.33(a)(4) 285.33(a)(1) 285.33(a)(2)				

2-28-19

**Comal County Environmental Health
OSSF Inspection Sheet**

No.	Description	Answer	Citations	Notes	1st Insp.	2nd Insp.	3rd Insp.
19	DISPOSAL SYSTEM Drip Irrigation	✓	285.33(a)(1) 285.33(a)(3) 285.33(a)(4) 285.33(a)(2)			✓	
20	DISPOSAL SYSTEM Soil Substitution		285.33(d)(4)				
21	DISPOSAL SYSTEM Pumped Effluent		285.33(a)(4) 285.33(a)(3) 285.33(a)(1)				
22	DISPOSAL SYSTEM Gravelless Pipe		285.33(a)(3) 285.33(a)(2) 285.33(a)(4) 285.33(a)(1)				
23	DISPOSAL SYSTEM Mound		285.33(a)(3) 285.33(a)(1) 285.33(a)(2) 285.33(a)(4)				
24	DISPOSAL SYSTEM Other (describe) (Approved Design)		285.33(d)(6) 285.33(c)(4)				
25	DRAINFIELD Absorptive Drainline 3" PVC or 4" PVC						
26	DRAINFIELD Area Installed	✓				✓	
27	DRAINFIELD Level to within 1 inch per 25 feet and within 3 inches over entire excavation		285.33(b)(1)(A)(v)				
28	DRAINFIELD Excavation Width DRAINFIELD Excavation Depth DRAINFIELD Excavation Separation DRAINFIELD Depth of Porous Media DRAINFIELD Type of Porous Media						
29	DRAINFIELD Pipe and Gravel - Geotextile Fabric in Place		285.33(b)(1)(E)				
30	DRAINFIELD Leaching Chambers DRAINFIELD Chambers - Open End Plates w/Splash Plate, Inspection Port & Closed End Plates in Place (per manufacturers spec.)		285.33(c)(2)				
31	LOW PRESSURE DISPOSAL SYSTEM Adequate Trench Length & Width, and Adequate Separation Distance between Trenches		285.33(d)(1)(C)(i)				

**Comal County Environmental Health
OSSF Inspection Sheet**

No.	Description	Answer	Citations	Notes	1st Insp.	2nd Insp.	3rd Insp.
32	<p>EFFLUENT DISPOSAL SYSTEM Utilized Only by Single Family Dwelling</p> <p>EFFLUENT DISPOSAL SYSTEM Topographic Slopes < 2.0%</p> <p>EFFLUENT DISPOSAL SYSTEM Adequate Length of Drain Field (1000 Linear ft. for 2 bedrooms or Less & an additional 400 ft. for each additional bedroom)</p> <p>EFFLUENT DISPOSAL SYSTEM Lateral Depth of 18 inches to 3 ft. & Vertical Separation of 1ft on bottom and 2 ft. to restrictive horizon and ground water respectfully</p> <p>EFFLUENT DISPOSAL SYSTEM Lateral Drain Pipe (1.25 - 1.5" dia.) & Pipe Holes (3/16 - 1/4" dia. Hole Size) 5 ft. Apart</p>		<p>285.33(b)(3)(A)</p> <p>285.33(b)(3)(A)</p> <p>285.33(b)(3)(B)</p> <p>285.91(13)</p> <p>285.33(b)(3)(D)</p> <p>285.33(b)(3)(F)</p>				
33	<p>AEROBIC TREATMENT UNIT Is Aerobic Unit Installed According to Approved Guidelines.</p>	✓	285.32(c)(1)			✓	
34	<p>AEROBIC TREATMENT UNIT Inspection/Clean Out Port & Risers Provided</p> <p>AEROBIC TREATMENT UNIT Secondary restraint system provided</p> <p>AEROBIC TREATMENT UNIT Riser permanently fastened to lid or cast into tank</p> <p>AEROBIC TREATMENT UNIT Riser cap protected against unauthorized intrusions</p>	✓				✓	
35	<p>AEROBIC TREATMENT UNIT Chlorinator Properly installed with Chlorine Tablets In Place.</p>	✓				✓	
36	<p>PUMP TANK Is the Pump Tank an approved concrete tank or other acceptable materials & construction</p> <p>PUMP TANK Sampling Port Provided in the Treated Effluent Line</p> <p>PUMP TANK Check Valve and/or Anti- Siphon Device Present When Required</p> <p>PUMP TANK Audible and Visual High Water Alarm Installed on Separate Circuit From Pump</p>						
37	<p>PUMP TANK Inspection/Clean Out Port & Risers Provided</p> <p>PUMP TANK Secondary restraint system provided</p> <p>PUMP TANK Riser permanently fastened to lid or cast into tank</p> <p>PUMP TANK Riser cap protected against unauthorized intrusions</p>						
38	<p>PUMP TANK Secondary restraint system provided</p>						

Comal County Environmental Health
OSSF Inspection Sheet

39	PUMP TANK Electrical Connections in Approved Junction Boxes / Wiring Buried	✓				✓	
----	---	---	--	--	--	---	--

**Comal County Environmental Health
OSSF Inspection Sheet**

No.	Description	Answer	Citations	Notes	1st Insp.	2nd Insp.	3rd Insp.
40	APPLICATION AREA Distribution Pipe, Fitting, Sprinkler Heads & Valve Covers Color Coded Purple?		285.33(d)(2)(G)(iii)(I)285.33(d)(2)(G)(ii)(III)285.33(d)(2)(G)(v) 285.33(d)(2)(G)(iii) 285.33(d)(2)(G)(iv) 285.33(d)(2)(G)(i) 285.33(d)(2)(G)(ii) 285.33(d)(2)(G)(iii)(I)				
41	APPLICATION AREA Low Angle Nozzles Used / Pressure is as required APPLICATION AREA Acceptable Area, nothing within 10 ft of sprinkler heads? APPLICATION AREA The Landscape Plan is as Designed		285.33(d)(2)(G)(I) 285.33(d)(2)(A) 285.33(d)(2)(F)				
42	APPLICATION AREA Area Installed						
43	PUMP TANK Meets Minimum Reserve Capacity Requirements						
44	PUMP TANK Material Type & Manufacturer						
45	PUMP TANK Type/Size of Pump Installed						

Comal County Environmental Health OSSF Inspection Sheet

Installer Name: J.R. Avila OSSF Installer #: 050021674

1st Inspection Date: 2-28-19 2nd Inspection Date: _____ 3rd Inspection Date: _____

Inspector Name: A. Helmke Inspector Name: _____ Inspector Name: _____

Permit#: 108765 Address: 1562 Hillcrest Forest - C.L. Forest

No.	Description	Answer	Citations	Notes	1st Insp.	2nd Insp.	3rd Insp.
1	SITE AND SOIL CONDITIONS & SETBACK DISTANCES Site and Soil Conditions Consistent with Submitted Planning Materials	✓	285.31(a) 285.30(b)(1)(A)(iv) 285.30(b)(1)(A)(v) 285.30(b)(1)(A)(iii) 285.30(b)(1)(A)(ii) 285.30(b)(1)(A)(i)		2-28-19		
2	SITE AND SOIL CONDITIONS & SETBACK DISTANCES Setback Distances Meet Minimum Standards	✓	285.91(10) 285.30(b)(4) 285.31(d)				
3	SEWER PIPE Proper Type Pipe from Structure to Disposal System (Cast Iron, Ductile Iron, Sch. 40, SDR 26)	✓	285.32(a)(1)				
4	SEWER PIPE Slope from the Sewer to the Tank at least 1/8 Inch Per Foot	✓	285.32(a)(3)				
5	SEWER PIPE Two Way Sanitary - Type Cleanout Properly Installed (Add. C/O Every 100' &/or 90 degree bends)	✓	285.32(a)(5)				
6	PRETREATMENT Installed (if required) TCEQ Approved List PRETREATMENT Septic Tank(s) Meet Minimum Requirements		285.32(b)(1)(G)285.32(b)(1)(E)(iii) 285.32(b)(1)(E)(iv) 285.32(b)(1)(F) 285.32(b)(1)(B) 285.32(b)(1)(C)(i) 285.32(b)(1)(C)(ii) 285.32(b)(1)(D) 285.32(b)(1)(E) 285.32(b)(1)(A) 285.32(b)(1)(E)(ii)(II) 285.32(b)(1)(E)(i) 285.32(b)(1)(E)(ii)(I)				
7	PRETREATMENT Grease Interceptors if required for commercial		285.34(d)				

2-28-19-SH

tank check only
set + level
water line sleeved

**Comal County Environmental Health
OSSF Inspection Sheet**

No.	Description	Answer	Citations	Notes	1st Insp.	2nd Insp.	3rd Insp.
8	SEPTIC TANK Tank(s) Clearly Marked SEPTIC TANK If Single Tank, 2 Compartments Provided with Baffle SEPTIC TANK Inlet Flowline Greater than 3" and " T " Provided on Inlet and Outlet SEPTIC TANK Septic Tank(s) Meet Minimum Requirements	✓	285.32(b)(1)(E) 285.91(2) 285.32(b)(1)(F) 285.32(b)(1)(E)(iii) 285.32(b)(1)(E)(ii)(II) 285.32(b)(1)(E)(ii)(I) 285.32(b)(1)(E)(i) 285.32(b)(1)(D) 285.32(b)(1)(C)(ii) 285.32(b)(1)(C)(i) 285.32(b)(1)(B) 285.32(b)(1)(A) 285.32(b)(1)(E)(iv)		2-28-19		
9	ALL TANKS Installed on 4" Sand Cushion/ Proper Backfill Used	✓	285.32(b)(1)(F) 285.32(b)(1)(G) 285.34(b)				
10	SEPTIC TANK Inspection / Clean Out Port & Risers Provided on Tanks Buried Greater than 12" Sealed and Capped	✓	285.38(d)				
11	SEPTIC TANK Secondary restraint system provided SEPTIC TANK Riser permanently fastened to lid or cast into tank SEPTIC TANK Riser cap protected against unauthorized intrusions	✓	285.38(d) 285.38(e)				
12	SEPTIC TANK Tank Volume Installed	✓					
13	PUMP TANK Volume Installed	✓		550			
14	AEROBIC TREATMENT UNIT Size Installed	✓		600			
15	AEROBIC TREATMENT UNIT Manufacturer AEROBIC TREATMENT UNIT Model Number	✓		Nuwater			
16	DISPOSAL SYSTEM Absorptive		285.33(a)(4) 285.33(a)(1) 285.33(a)(2) 285.33(a)(3)				
17	DISPOSAL SYSTEM Leaching Chamber		285.33(a)(1) 285.33(a)(3) 285.33(a)(4) 285.33(a)(2)				
18	DISPOSAL SYSTEM Evapo-transpirative		285.33(a)(3) 285.33(a)(4) 285.33(a)(1) 285.33(a)(2)				

**Comal County Environmental Health
OSSF Inspection Sheet**

No.	Description	Answer	Citations	Notes	1st Insp.	2nd Insp.	3rd Insp.
19	DISPOSAL SYSTEM Drip Irrigation		285.33(a)(1) 285.33(a)(3) 285.33(a)(4) 285.33(a)(2)				
20	DISPOSAL SYSTEM Soil Substitution		285.33(d)(4)				
21	DISPOSAL SYSTEM Pumped Effluent		285.33(a)(4) 285.33(a)(3) 285.33(a)(1)				
22	DISPOSAL SYSTEM Gravelless Pipe		285.33(a)(3) 285.33(a)(2) 285.33(a)(4) 285.33(a)(1)				
23	DISPOSAL SYSTEM Mound		285.33(a)(3) 285.33(a)(1) 285.33(a)(2) 285.33(a)(4)				
24	DISPOSAL SYSTEM Other (describe) (Approved Design)		285.33(d)(6) 285.33(c)(4)				
25	DRAINFIELD Absorptive Drainline 3" PVC or 4" PVC						
26	DRAINFIELD Area Installed						
27	DRAINFIELD Level to within 1 inch per 25 feet and within 3 inches over entire excavation		285.33(b)(1)(A)(v)				
28	DRAINFIELD Excavation Width DRAINFIELD Excavation Depth DRAINFIELD Excavation Separation DRAINFIELD Depth of Porous Media DRAINFIELD Type of Porous Media						
29	DRAINFIELD Pipe and Gravel - Geotextile Fabric in Place		285.33(b)(1)(E)				
30	DRAINFIELD Leaching Chambers DRAINFIELD Chambers - Open End Plates w/Splash Plate, Inspection Port & Closed End Plates in Place (per manufacturers spec.)		285.33(c)(2)				
31	LOW PRESSURE DISPOSAL SYSTEM Adequate Trench Length & Width, and Adequate Separation Distance between Trenches		285.33(d)(1)(C)(i)				

**Comal County Environmental Health
OSSF Inspection Sheet**

No.	Description	Answer	Citations	Notes	1st Insp.	2nd Insp.	3rd Insp.
32	<p>EFFLUENT DISPOSAL SYSTEM Utilized Only by Single Family Dwelling</p> <p>EFFLUENT DISPOSAL SYSTEM Topographic Slopes < 2.0%</p> <p>EFFLUENT DISPOSAL SYSTEM Adequate Length of Drain Field (1000 Linear ft. for 2 bedrooms or Less & an additional 400 ft. for each additional bedroom)</p> <p>EFFLUENT DISPOSAL SYSTEM Lateral Depth of 18 inches to 3 ft. & Vertical Separation of 1ft on bottom and 2 ft. to restrictive horizon and ground water respectfully</p> <p>EFFLUENT DISPOSAL SYSTEM Lateral Drain Pipe (1.25 - 1.5" dia.) & Pipe Holes (3/16 - 1/4" dia. Hole Size) 5 ft. Apart</p>		<p>285.33(b)(3)(A)</p> <p>285.33(b)(3)(A)</p> <p>285.33(b)(3)(B)</p> <p>285.91(13)</p> <p>285.33(b)(3)(D)</p> <p>285.33(b)(3)(F)</p>				
33	<p>AEROBIC TREATMENT UNIT Is Aerobic Unit Installed According to Approved Guidelines.</p>		285.32(c)(1)				
34	<p>AEROBIC TREATMENT UNIT Inspection/Clean Out Port & Risers Provided</p> <p>AEROBIC TREATMENT UNIT Secondary restraint system provided</p> <p>AEROBIC TREATMENT UNIT Riser permanently fastened to lid or cast into tank</p> <p>AEROBIC TREATMENT UNIT Riser cap protected against unauthorized intrusions</p>						
35	<p>AEROBIC TREATMENT UNIT Chlorinator Properly Installed with Chlorine Tablets in Place.</p>						
36	<p>PUMP TANK Is the Pump Tank an approved concrete tank or other acceptable materials & construction</p> <p>PUMP TANK Sampling Port Provided in the Treated Effluent Line</p> <p>PUMP TANK Check Valve and/or Anti- Siphon Device Present When Required</p> <p>PUMP TANK Audible and Visual High Water Alarm Installed on Separate Circuit From Pump</p>						
37	<p>PUMP TANK inspection/Clean Out Port & Risers Provided</p> <p>PUMP TANK Secondary restraint system provided</p> <p>PUMP TANK Riser permanently fastened to lid or cast into tank</p> <p>PUMP TANK Riser cap protected against unauthorized intrusions</p>						
38	<p>PUMP TANK Secondary restraint system provided</p>						

**Comal County Environmental Health
OSSF Inspection Sheet**

39	PUMP TANK Electrical Connections in Approved Junction Boxes / Wiring Buried						
----	---	--	--	--	--	--	--

**Comal County Environmental Health
OSSF Inspection Sheet**

No.	Description	Answer	Citations	Notes	1st Insp.	2nd Insp.	3rd Insp.
40	APPLICATION AREA Distribution Pipe, Fitting, Sprinkler Heads & Valve Covers Color Coded Purple?		285.33(d)(2)(G)(iii)(I)285.33(d)(2)(G)(iii)(III)285.33(d)(2)(G)(v) 285.33(d)(2)(G)(iii) 285.33(d)(2)(G)(iv) 285.33(d)(2)(G)(i) 285.33(d)(2)(G)(ii) 285.33(d)(2)(G)(iii)(I)				
41	APPLICATION AREA Low Angle Nozzles Used / Pressure is as required APPLICATION AREA Acceptable Area, nothing within 10 ft of sprinkler heads? APPLICATION AREA The Landscape Plan is as Designed		285.33(d)(2)(G)(i) 285.33(d)(2)(A) 285.33(d)(2)(F)				
42	APPLICATION AREA Area Installed						
43	PUMP TANK Meets Minimum Reserve Capacity Requirements						
44	PUMP TANK Material Type & Manufacturer						
45	PUMP TANK Type/Size of Pump Installed						

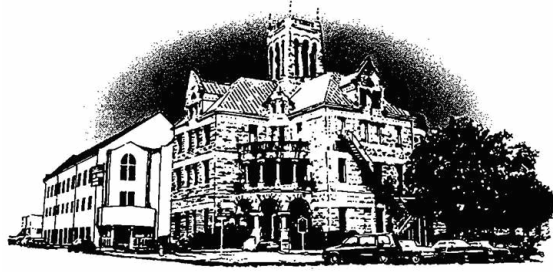

Comal County

OFFICE OF COMAL COUNTY ENGINEER

Permit of Authorization to Construct an On-Site Sewage Facility Permit Valid For One Year From Date Issued

Permit Number: 108765
Issued This Date: 02/21/2019
This permit is hereby given to: BGRM, LP

To start construction of a private, on-site sewage facility located at:

1562 HILLCREST FOREST
CANYON LAKE, TX 78133

Subdivision: Canyon Lake Forest
Unit: 1
Lot: 83
Block:
Acreage:

APPROVED MINIMUM SIZES AS PER ATTACHED DESIGN

Type of System: Aerobic
Drip Irrigation

This permit gives permission for the construction of the above referenced on-site facility to commence. Installation must be completed by an installer holding a valid registration card from the Texas Commission on Environmental Quality (TCEQ). Installation and inspection must comply with current TCEQ and Comal County requirements.

Call (830) 608-2090 to schedule inspections.

APPLICATION FOR PERMIT FOR AUTHORIZATION TO CONSTRUCT AN ON-SITE SEWAGE FACILITY AND LICENSE TO OPERATE

Date February 13, 2019

Permit # 108765

Owner Name BGRM, LP
Mailing Address 20540 HWY 46W STE 115-139
City, State, Zip SPRING BRANCH TEXAS 78070
Phone# 830-481-8880
Email brivalama@yahoo.com

Agent Name GREG W. JOHNSON, P.E.
Agent Address 170 HOLLOW OAK
City, State, Zip NEW BRAUNFELS, TX 78132
Phone # (830) 905-2778
Email gregjohnsonpe@yahoo.com

All correspondence should be sent to: [] Owner [X] Agent [] Both Method: [] Mail [X] Email

Subdivision Name CANYON LAKE FOREST Unit/Phase/Section 1 Lot 83 Block
Acreage/Legal
Street Name/Address 1562 HILLCREST FOREST City CANYON LAKE Zip 78133

Type of Development:

[X] Single Family Residential
Type of Construction (House, Mobile, RV, Etc.) HOUSE
Number of Bedrooms 3
Indicate Sq Ft of Living Area 1300

RECEIVED

FEB 14 2019

COUNTY ENGINEER

[] Commercial or Institutional Facility
(Planning materials must show adequate land area for doubling the required land needed for treatment units and disposal area)
Type of Facility
Offices, Factories, Churches, Schools, Parks, Etc. - Indicate Number Of Occupants
Restaurants, Lounges, Theaters - Indicate Number of Seats
Hotel, Motel, Hospital, Nursing Home - Indicate Number of Beds
Travel Trailer/RV Parks - Indicate Number of Spaces
Miscellaneous

Estimated Cost of Construction: \$ 185,000 (Structure Only)

Is any portion of the proposed OSSF located in the United States Army Corps of Engineers (USACE) flowage easement?

[] Yes [X] No (if yes, owner must provide approval from USACE for proposed OSSF improvements within the USACE flowage easement)

Source of Water [X] Public [] Private Well

Are Water Saving Devices Being Utilized Within the Residence? [X] Yes [] No

By signing this application, I certify that:

- the completed application and all additional information submitted does not contain any false information and does not conceal any material facts.
-Authorization is hereby given to the permitting authority and designated agents to enter upon the above described property for the purpose of site/soil evaluation and inspection of private sewage facilities.
-I also understand that a permit of authorization to construct will not be issued until the Floodplain Administrator has performed the reviews required by the Comal County Flood Damage Prevention Order.
-I affirmatively consent to the online posting/public release of my e-mail address associated with this permit application, as applicable.

Signature of Owner

Date 2/13/19

#18765

*** COMAL COUNTY OFFICE OF ENVIRONMENTAL HEALTH ***

APPLICATION FOR PERMIT FOR AUTHORIZATION TO CONSTRUCT AN ON-SITE SEWAGE FACILITY AND LICENSE TO OPERATE

REVISED

9:04 am, Mar 08, 2019

Planning Materials & Site Evaluation as Required Completed By GREG W. JOHNSON, P.E.

System Description PROPRIETARY; AEROBIC TREATMENT AND DRIP TUBING

Size of Septic System Required Based on Planning Materials & Soil Evaluation

Tank Size(s) (Gallons) NUWATER B-550-PC Absorption/Application Area (Sq Ft) 1896

Gallons Per Day (As Per TCEQ Table III) 240

(Sites generating more than 5000 gallons per day are required to obtain a permit through TCEQ)

Is the property located over the Edwards Recharge Zone? [] Yes [X] No

(If yes, the planning materials must be completed by a Registered Sanitarian (R.S.) or Professional Engineer (P.E.))

Is there an existing TCEQ approved WPAP for the property? [] Yes [X] No

(if yes, the R. S. or P. E. shall certify that the OSSF design complies with all provisions of the existing WPAP.)

If there is no existing WPAP, does the proposed development activity require a TCEQ approved WPAP? [] Yes [] No

(If yes, the R.S. or P. E. shall certify that the OSSF design will comply with all provisions of the proposed WPAP. A Permit to Construct will not be issued for the proposed OSSF until the proposed WPAP has been approved by the appropriate regional office.)

Is the property located over the Edwards Contributing Zone? [X] Yes [] No

Is there an existing TCEQ approval CZP for the property? [] Yes [X] No

(if yes, the P.E. or R.S. shall certify that the OSSF design complies with all provisions of the existing CZP)

If there is no existing CZP, does the proposed development activity require a TCEQ approved CZP? [] Yes [X] No

(if yes, the P.E. or R.S. shall certify that the OSSF design will comply with all provisions of the proposed CZP. A Permit to construct will not be issued for the proposed OSSF until the CZP has been approved by the appropriate regional office.)

Is this property within an incorporated city? [] Yes [X] No

If yes, indicate the city:



FIRM #2585

By signing this application, I certify that:

- The information provided above is true and correct to the best of my knowledge.
- I affirmatively consent to the online posting/public release of my e-mail address associated with this permit application, as applicable

Signature of Designer (Handwritten Signature)

Date February 14, 2019

11c

AFFIDAVIT

**THE COUNTY OF COMAL
STATE OF TEXAS**



201706047962 10/27/2017 12:50:30 PM 1/1

CERTIFICATION OF OSSF REQUIRING MAINTENANCE

According to Texas Commission on Environmental Quality Rules for On-Site Sewage Facilities (OSSF's), this document is filed in the Deed Records of Comal County, Texas.

RECEIVED
OCT 27 2017

I

The Texas Health and Safety Code, Chapter 366 authorizes the Texas Commission on Environmental Quality (TCEQ) to regulate on-site sewage facilities (OSSFs). Additionally, the Texas Water Code (TWC), § 5.012 and § 5.013, gives the commission primary responsibility for implementing the laws of the State of Texas relating to water and adopting rules necessary to carry out its powers and duties under the TWC. The commission, under the authority of the TWC and the Texas Health and Safety code, requires owner's to provide notice to the public that certain types of OSSFs are located on specific pieces of property. To achieve this notice, the commission requires a recorded affidavit. Additionally, the owner must provide proof of the recording to the OSSF permitting authority. This recorded affidavit is not a representation or warranty by the commission of the suitability of this OSSF, nor does it constitute any guarantee by the commission that the appropriate OSSF was installed.

COUNTY ENGINEER

II

An OSSF requiring a maintenance contract, according to 30 Texas Administrative Code §285.91(12) will be installed on the property described as (insert legal description):

RECEIVED

FEB 14 2019

COUNTY ENGINEER
SUBDIVISION

1 UNIT/PHASE/SECTION _____ BLOCK 83 LOT _____ CANYON LAKE FOREST

IF NOT IN SUBDIVISION: _____ ACREAGE _____ SURVEY _____

The property is owned by (insert owner's full name): BGRM, LP

This OSSF must be covered by a continuous maintenance contract for the first two years. After the initial two-year service policy, the owner of an aerobic treatment system for a single family residence shall either obtain a maintenance contract within 30 days or maintain the system personally.

Upon sale or transfer of the above-described property, the permit for the OSSF shall be transferred to the buyer or new owner. A copy of the planning materials for the OSSF can be obtained from the Comal County Engineer's Office.

WITNESS BY HAND(S) ON THIS 26 DAY OF October, 2017

[Signature]
Owner(s) signature(s)

BRIAN GATTI
Owner (s) Printed name (s)

BRIAN GATTI
October, 2017

SWORN TO AND SUBSCRIBED BEFORE ME ON THIS 26 DAY OF

[Signature]
Notary Public Signature

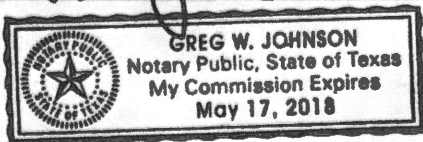

(Notary Seal Here)

THIS AREA FOR RECORDING PURPOSES ONLY

Filed and Recorded
Official Public Records
Bobbie Koepf, County Clerk
Comal County, Texas
10/27/2017 12:50:30 PM
CHRISTY 1 Page(s)
201706047962



Bobbie Koepf

D.R.
Johnson
19-2777

15188 FM 306
Canyon Lake, TX 78133
Phone (830)964-2365 Fax (830) 964-2659



Routine Maintenance and Inspection Agreement

General

This Work for Hire Agreement (hereinafter referred to as this "Agreement") is entered into by and between BGRM, LP (referred to as "Client") and Aerobic Services of South Texas (Thomas W. Hampton MP 349) (hereinafter referred to as "Contractor") located at 15188 FM 306, Texas 78133 (830) 964-2365. By this Agreement the Contractor agrees to render professional service, as described herein, and the Client agrees to fulfill the terms of this Agreement as described herein.

This contract will provide for all required inspections, testing and service for your Aerobic Treatment System. The policy will include the following:

1. 3 inspections a year/services calls (at least one every 4 months), for a total of 6 over the two year period including inspection, adjustment and servicing of the mechanical, electrical and other applicable component parts to ensure proper function. This includes inspecting control panel, air pumps, air filters, diffuser operation, Any alarm situation affecting the proper function of the Aerobic process will be address within a 48-hour time Frame. Repair work on non-warranty parts will include price for parts & labor. The prices will be quoted before work is performed.
2. An effluent quality inspection consisting of a visual check for color, turbidity, scum overflow and examination for odors. A test for chlorine residual and pH will be taken and reported as necessary.
3. If any improper operation is observed, which cannot be corrected at the time of the service visit, you will be notified immediately in writing of the conditions and estimated date of correction.
4. The customer is responsible for the chlorine tablets; they must be filled before or during the service visit.
5. Any additional visits, inspections or sample collection required by specific Municipalities, Water/River Authorities, and County Agencies the TCEQ or any other authorized regulatory agency in your jurisdiction will be covered by this policy.

The Homeowners Manual must be strictly followed or warranties are subject to invalidation. **Pumping of sludge build-up is not covered by this policy and will result in additional charges.**

ACCESS BY CONTRACTOR

The Contractor or anyone authorized by the Contractor may enter the property at reasonable times without prior notice for the purpose of the above described Services. The contractor may access the System components including the tanks by means of excavation for the purpose of evaluations if necessary. Soil Is to be replaced with the excavated material as best as possible.

RECEIVED

OCT 27 2017

COUNTY ENGINEER RECEIVED

FEB 14 2019

COUNTY ENGINEER

Termination of Agreement

Either party may terminate this agreement within ten days written notice in the event of substantial failure to perform in accordance with its terms by the other party without fault of the terminating party. If this Agreement is so terminated, the Contractor will immediately notify the appropriate health authority of the termination.

Limit of Liability

In no event shall the Contractor be liable for indirect, consequential, incidental or punitive damages, whether in contract tort or any other theory. In no event shall the Contractor's liability for direct damages exceed the price for the services described in this Agreement.

Dispute Resolution

If a dispute between the Client and the Designer arises that cannot be settled in good faith negotiations then the parties shall choose a mutually acceptable arbitrator and shall share the cost of the arbitration services equally.

Entire Agreement

This Agreement contains the entire agreement of the parties, and there are no other promises or conditions in any other agreement either oral or written.

Severability

If any provision of this Agreement shall be held to be invalid or unenforceable for any reason, the remaining provisions shall continue to be valid and enforceable. If a court finds that any provision of this agreement is invalid or unenforceable, but that by limiting such provision it would become valid and enforceable, then such provision shall be deemed to be written, construed, and enforced as so limited.

Legal Description: CANYON LAKE FOREST, UNIT 1, LOT 83

Property Address: 1562 HILLCREST FOREST

HOME OWNER

BGRM, LP
Name
20540 HWY 46W, SUITE 115-139
Address
SPRING BRANCH, TX 78070
City, State
830-481-8880
Phone
[Signature]
Signature of Home Owner

SERVICE PROVIDER

Aerobic Services of South Texas Inc.
Name
15188 FM 306
Address
Canyon Lake, Texas 78133
City, State
(830) 964 - 2365
Phone
[Signature] OS0024597/MP349
Thomas Hampton
Signature of Service Provider and License #

EFFECTIVE DATE _____ EXPIRED DATE _____ INSTALLED _____

Model # _____ Blower/Panel Serial # _____

The effective date of this initial maintenance contract shall be the date license to operate is issued.

**ON-SITE SEWERAGE FACILITY
SOIL EVALUATION REPORT INFORMATION**

Date Soil Survey Performed: October 16, 2017

Site Location: CANYON LAKE FOREST, UNIT 1, LOT 83

Proposed Excavation Depth: N/A

Requirements:

At least two soil excavations must be performed on the site, at opposite ends of the proposed disposal area. Locations of soil boring or dug pits must be shown on the site drawing. For subsurface disposal, soil evaluations must be performed to a depth of at least two feet below the proposed excavation depth. For surface disposal, the surface horizon must be evaluated. Describe each soil horizon and identify any restrictive features on the form. Indicate depths where features appear.

SOIL BORING NUMBER <u> </u> SURFACE EVALUATION <u> </u>						
Depth (Feet)	Texture Class	Soil Texture	Gravel Analysis	Drainage (Mottles/ Water Table)	Restrictive Horizon	Observations
0	III	CLAY LOAM	N/A	NONE OBSERVED	LIMESTONE @ 10"	RECEIVED FEB 14 2019 BROWN COUNTY ENGINEER
10"						
1						
2						
3						
4						
5						

SOIL BORING NUMBER <u> </u> SURFACE EVALUATION <u> </u>						
Depth (Feet)	Texture Class	Soil Texture	Gravel Analysis	Drainage (Mottles/ Water Table)	Restrictive Horizon	Observations
0	SAME		AS		ABOVE	
1						
2						
3						
4						
5						

I certify that the findings of this report are based on my field observations and are accurate to the best of my ability.

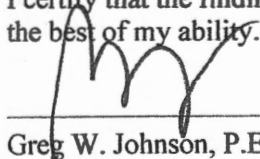

Greg W. Johnson, P.E. 67587-F2585, S.E. 11561

10/16/17

Date

DRIP TUBING SYSTEM
DESIGNED FOR:
BGRM, LP
20540 HWY 46 W, SUITE 115-139
SPRING BRANCH, TX 78070

SITE DESCRIPTION:

Located in Canyon Lake Forest, Unit 1, Lot 83, at 1562 Hillcrest Forest, this septic will serve a three bedroom residence (1300 sf) in area with Type-III soil as described in the Soil Evaluation Report. An aerobic treatment plant utilizing drip irrigation was chosen as the most appropriate system to serve the conditions on this lot.

PROPOSED SYSTEM:

A 3 inch SCH-40 pipe discharges from the residence into a Nu-Water B550PC 600gpd aerobic treatment plant containing a 353 gal. pretreatment chamber and a 768 gal. pump chamber. The effluent after processing gravity feeds into the pump chamber. The pump chamber contains a 0.5 HP FPS submersible well pump. The well pump is activated by mercury floats and a timer set to cycle eight times per day with a ten minute run time. A high level audible and visual alarm will activate should the pump fail. Distribution is through a self flushing 100 micron Arkal Disc filter then through a 1" SCH-40 manifold to a 1896 sf. drip tubing field, with *Netifim Bioline* drip lines set approximately two feet apart with 0.61 gph emitters set every two feet, as per the attached schematic. A pressure regulator Model PMR30MF installed in the pump tank on the manifold to the field will maintain pressure at 30 psi. A 1" SCH-40 return line is installed to continuously flush the system by cycling a 1" ball valve. Solids caught in the disc filter are flushed each cycle back to the trash tank. Agricultural Products, Inc. (Model #VBK-1) 1" PVC vacuum breakers installed at the highest point on each manifold will prevent siphoning of effluent from higher to lower parts of the field. Prior to trenching the site must be scarified and built up with 4" of Type II or III soil. Drip tubing will be laid and the entire field area will be capped with 6" of sandy loam (Type 2 - **NOT SAND**). The field area will be sodded with a hearty grass such as Bermuda, St. Augustine, etc. prior to system startup.

DESIGN SPECIFICATIONS:

Q = 240 gallons per day - 3 bedroom residence (Table III)

Pretreatment tank size: 353 Gal

Plant Size: Nu-Water B550PC 600 gpd (TCEQ Approved)

Pump tank size: 768 Gal

Reserve capacity after High Level: 80 gal. (>1/3 day usage)

Application Rate: Ra = 0.2 gal/sf

Total absorption area: $Q/Ra = 240 \text{ GPD}/0.20 = 1200 \text{ sf}$ (Actual 1896 sf.).

Total linear feet drip tubing: 948' *Netifim Bioline* drip tubing .61 GPH

Pump requirement: 474 emitters @ 0.61 gph @ 30 psi = 4.819 gpm

Pump: 0.5 HP FPS E-Series 20FE05P4-2W115 submersible pump or equivalent.

Dosing volume: 50-70 gal.

Pump Tank Calculations: 768 Gal (14.5 gal/in.)

Volume below working level = 15" = 219 gal

Working level = 240 gal = 17"

Reserve Requirement = 1/3 day = 80 gal. = 6"

MINIMUM SCOUR VELOCITY (MSV) > 2 FPS

IN DRIP TUBING W/ NOM. DIA. 0.55" ID

$MSV = 2 \text{ FPS} ((ID \uparrow 2) / 4) * 7.48 \text{ gal/cf} * 60 \text{ sec/min}$

$MSV = 2(3.14159((.55/12) \uparrow 2) / 4) * 7.48 * 60$

$MSV = 1.5 \text{ gpm} \times 3 = 4.5 \text{ gpm MIN FLOW RATE}$

IN RETURN MANIFOLD W/ NOM. DIA 1.049" ID

$MSV = 2 \text{ FPS} ((ID \uparrow 2) / 4) * 7.48 \text{ gal/cf} * 60 \text{ sec/min}$

$MSV = 2(3.14159((1.049/12) \uparrow 2) / 4) * 7.48 * 60$

$MSV = 5.4 \text{ GPM}$

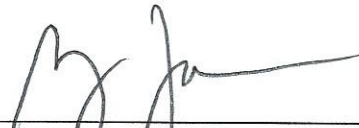
 03/08/19

Greg W. Johnson, P.E. No. 67587, F#2585

170 Hollow Oak

New Braunfels, Texas 78132

830/905-2778



REVISED

9:04 am, Mar 08, 2019

#108765

INSTALL 1896sf OF
FIELD USING 948'
OF DRIP TUBING

*USE TWO WAY
CLEANOUT

**USE SCH-40 OR
SDR-26 TO TANK

X= TEST HOLE

1" VACUUM
BREAKERS

**NUWATER B 550 PC
AEROBIC TREATMENT
PLANT**

SLEEVE WATER LINE WITH 2"-SCH-40
PVC PIPE WHEN ENTERING CLOSER
THAN 10' FROM SEPTIC SYSTEM OR
SEPTIC FIELD.

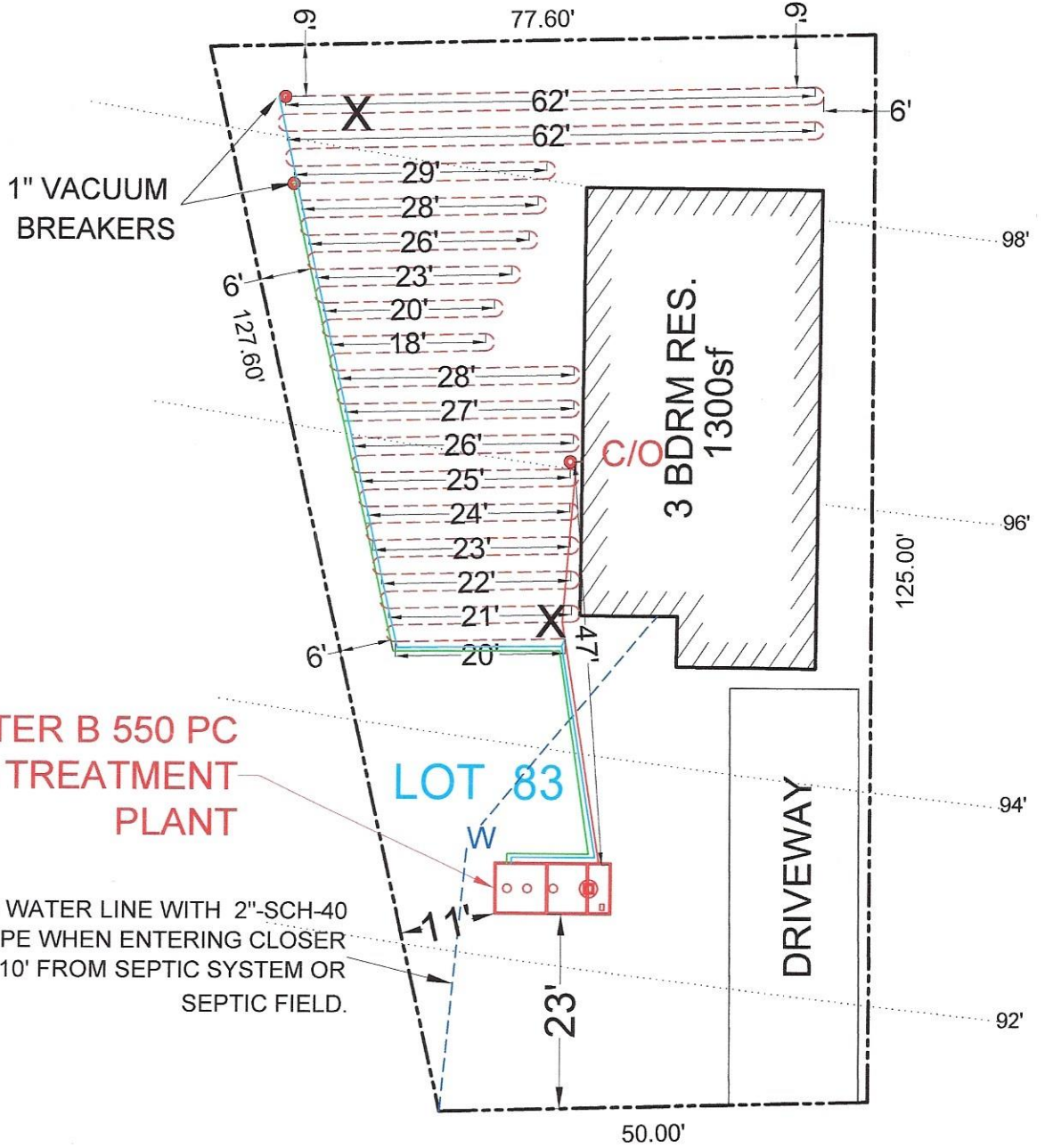

HILLCREST FOREST



OWNER: BGRM, LP.		DRAWN BY: EJS III	
STREET ADDRESS: 1562 HILLCREST FOREST			
LEGAL DESC: CANYON LAKE FOREST	UNIT/SECTION/PHASE: 1	BLOCK:	LOT: 83
PREPARED BY: GREG W. JOHNSON, P.E. F#002585	SCALE: 1"=20'	DATE: 10/17/2017	REVISED: 03/08/2019

TANK NOTES:

Tanks must be set to allow a minimum of 1/8" per foot fall from the residence.

Tightlines to the tank shall be SCH-40 PVC.

A two way sanitary tee is required between residence and tank.

A minimum of 4" of sand, sandy loam, clay loam free of rock shall be placed under and around tanks

RECEIVED

FEB 14 2019

COUNTY ENGINEER

ALL WIRING MUST BE IN COMPLIANCE WITH THE MOST RECENT NATIONAL ELECTRIC CODE

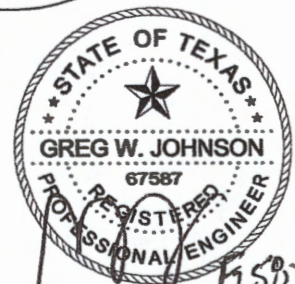
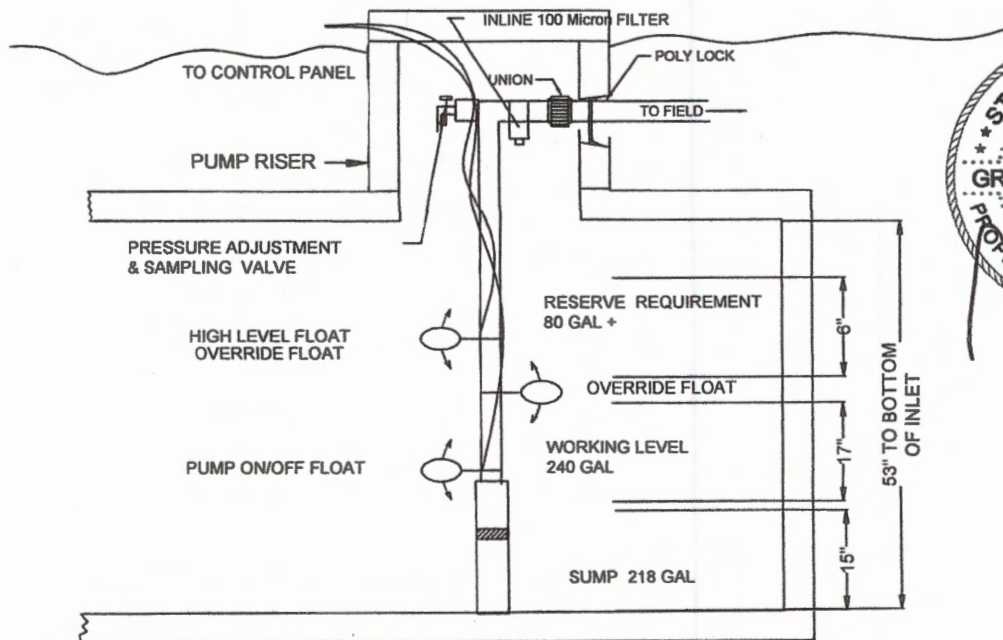

**TYPICAL PUMP TANK CONFIGURATION
NU-WATER 550PC -400PT 768 GAL PUMP TANK**



Bioline® Dripperline

Pressure Compensating Dripperline for Wastewater

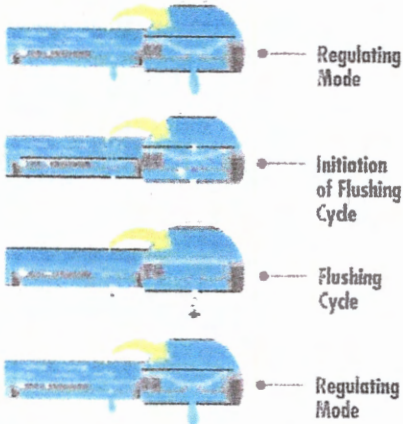

Bioline's Self-Cleaning, Pressure Compensating Dripper is a fully self-contained unit molded to the interior wall of the dripper tubing.

As shown at left, Bioline is continuously self-cleaning during operation, not just at the beginning and end of a cycle. The result is dependable, clog free operation, year after year.

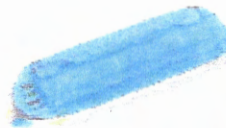

Product Advantages

The Proven Performer

- Tens of millions of feet used in wastewater today.
- Bioline is permitted in every state allowing drip disposal.
- Backed by the largest, most quality-driven manufacturer of drip products in the U.S.
- Preferred choice of major wastewater designers and regulators.
- Proven track record of success for many years of hard use in wastewater applications.

Quality Manufacturing with Specifications Designed to Meet Your Needs

- Pressure compensating drippers assure the highest application uniformity - even on sloped or rolling terrain.
- Excellent uniformity with runs of 400 feet or more - reducing installation costs.
- Highest quality-control standards in the industry: Cv of 0.25 (coefficient of manufacturer's variation).
- A selection of flows and spacings to satisfy the designer's demand for almost any application rate.

Long-Term Reliability

- Protection against plugging:
 - Dripper inlet raised 0.27" above wall of tubing to prevent sediment from entering dripper.
 - Drippers impregnated with Vinyzene to prevent buildup of microbial slime.
 - Unique self-flushing mechanism passes small particles before they can build up.

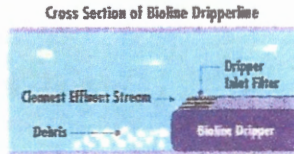

Root Safe

- A physical barrier on each Bioline dripper helps prevent root intrusion.
- Protection never wears out - never depletes - releases nothing to the environment.
- Working reliably for up to 15 years in subsurface wastewater installations.
- Additional security of chemical root inhibition with Techfilter - supplies Trifluralin to the entire system, effectively inhibiting root growth to the dripper outlets.

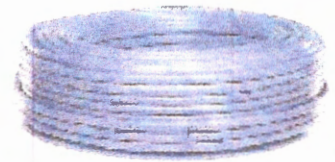

Applications

- For domestic strength wastewater disposal.
- Installed following a treatment process.
- Can be successfully used on straight septic effluent with proper design, filtration and operation.
- Suitable for reuse applications using municipally treated effluent designated for irrigation water.

Specifications

Wall thickness (mil): 45*

Nominal flow rates (GPH): .4, .6, .9*

Common spacings: 12", 18", 24"*

Recommended filtration: 120 mesh

Inside diameter: .570*

Color: Purple tubing indicates non-potable source

*Additional flows, spacings, and pipe sizes available by request. Please contact Netafim USA Customer Service for details.

RECEIVED
FEB 14 2019

COUNTY ENGINEER

BIOLINE Flow Rate vs. Pressure

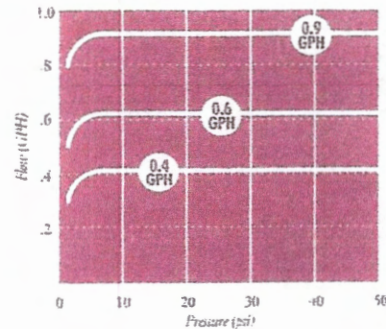

NETAFIM USA
5470 E. Home Ave. • Fresno, CA 93727
888.638.2346 • 559.453.6800
FAX 800.695.4753
www.netafimusa.com

Arkal 1" Super Filter

Catalog No. 1102 0 _ _ _

Features

- ◆ A "T" shaped filter with two 1" male threads.
- ◆ A "T" volume filter for in-line installation on 1" pipelines.
- ◆ The filter prevents clogging due to its enlarged filtering area that collects sediments and particles.
- ◆ Manufactured entirely from fiber reinforced plastic.
- ◆ A cylindrical column of grooved discs constitutes the filter element.
- ◆ Spring keeps the discs compressed.
- ◆ Screw-on filter cover.
- ◆ Filter discs are available in various filtration grades.

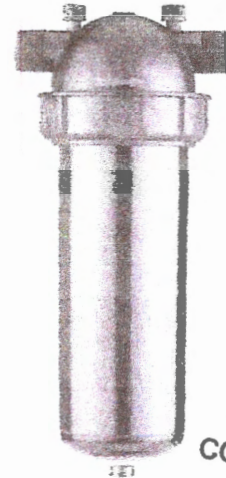

RECEIVED
FEB 14 2019
COUNTY ENGINEER

Technical Data

Inlet/outlet diameter	1" BSPT (male)	1" NPT (male)
	25.0 mm – nominal diameter	
	33.6 mm – pipe diameter (O. D.)	
Maximum pressure	10 atm	145 psi
Maximum flow rate	8 m ³ /h (1.7 l/sec)	35 gpm
General filtration area	500 cm ²	77.5 in ²
Filtration volume	600 cm ³	37 in ³
Filter length L	340 mm	13 13/32"
Filter width W	130 mm	5 3/32"
Distance between end connections A	158 mm	6 7/32"
Weight	1.420 kg	3.13 lbs.
Maximum temperature	70° C	158 °F
pH	5-11	5-11

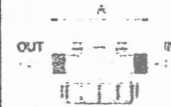

Filtration Grades

- Blue (400 micron / 40 mesh)
- Yellow (200 micron / 80 mesh)
- Red (130 micron / 120 mesh)
- Black (100 micron / 140 mesh)
- Green (55 micron)

Head Loss Chart

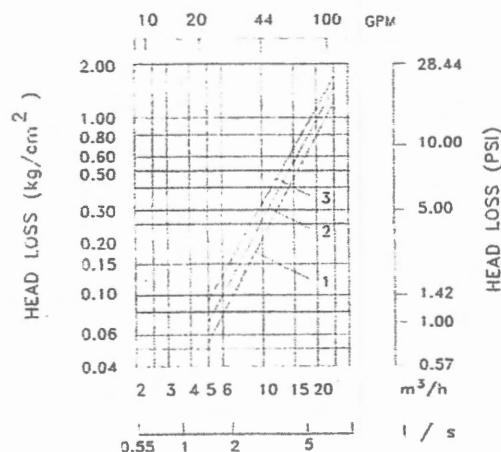



OCT 27 2017
355
COUNTY ENGINEER

RECEIVED
FEB 14 2019
COUNTY ENGINEER

CONTINUED ON MAP 325



NETAFIM WASTEWATER DISPERSAL SYSTEM DESIGN GUIDE

SAMPLE DESIGNS

SINGLE TRENCH LAYOUT

Rectangular field with supply and flush manifold on same side and in same trench;

- Locate supply and flush manifold in same trench
- Dripperlines are looped at the end opposite the supply and flush manifolds
- The longest Bioline length should not exceed 400 ft. Drip fields 200 ft. in length might loop the Bioline once; drip dispersal fields under 100 ft. might be looped twice, as illustrated

RECEIVED

FEB 14 2019

COUNTY ENGINEER

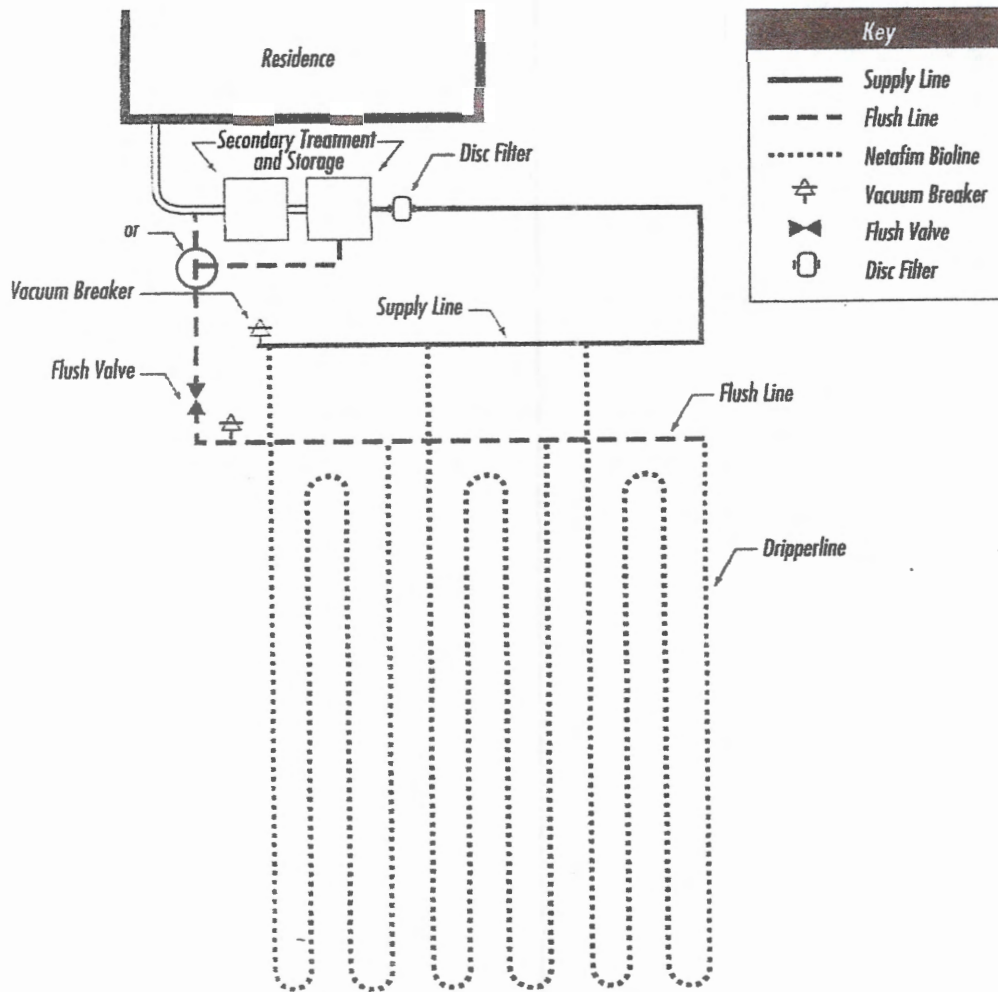

VOID

DRIP TUBING SYSTEM

DESIGNED FOR:

BGRM, LP

20540 HWY 46 W, SUITE 115-139

SPRING BRANCH, TX 78070

RECEIVED

FEB 14 2019

COUNTY ENGINEER

SITE DESCRIPTION:

Located in Canyon Lake Forest, Unit 1, Lot 83, at 1562 Hillcrest Forest, this septic will serve a three bedroom residence (1300 sf) in area with Type-III soil as described in the Soil Evaluation Report. An aerobic treatment plant utilizing drip irrigation was chosen as the most appropriate system to serve the conditions on this lot.

PROPOSED SYSTEM:

A 3 inch SCH-40 pipe discharges from the residence into a Nu-Water B550PC 600gpd aerobic treatment plant containing a 353 gal. pretreatment chamber and a 768 gal. pump chamber. The effluent after processing gravity feeds into the pump chamber. The pump chamber contains a 0.5 HP FPS submersible well pump. The well pump is activated by mercury floats and a timer set to cycle eight times per day with a ten minute run time. A high level audible and visual alarm will sound the pump fail. Distribution is through a self flushing 100 micron Arka Disc Distributor through a 1" SCH-40 manifold to a 2000 sf. drip tubing field, with *Netifim Bioline* drip lines set approximately two feet apart with 0.61 gph emitters set every two feet, as per the attached schematic. A pressure regulator Model PMR30MF installed in the pump tank on the manifold to the field will maintain pressure at 30 psi. A 1" SCH-40 return line is installed to periodically flush the system by cycling a 1" ball valve. Solids caught in the spin filter are flushed each cycle back to the trash tank. Agricultural Products, Inc. (Model #VBK-1) 1" PVC vacuum breakers installed at the highest point on each manifold will prevent siphoning of effluent from higher to lower parts of the field. Prior to trenching the site must be scarified and built up with 4" of Type II or III soil. Drip tubing will be laid and the entire field area will be capped with 6" of sandy loam (Type 2 - **NOT SAND**). The field area will be sodded with a hearty grass such as Bermuda, St. Augustine, etc. prior to system startup.

DESIGN SPECIFICATIONS:

Q = 240 gallons per day - 3 bedroom residence (Table III)

Pretreatment tank size: 353 Gal

Plant Size: Nu-Water B550PC 600 gpd (TCEQ Approved)

Pump tank size: 768 Gal

Reserve capacity after High Level: 80 gal. (>1/3 day usage)

Application Rate: Ra = 0.2 gal/sf

Total absorption area: Q/Ra = 240 GPD/0.20 = 1200 sf (Actual 2000 sf).

*** COMAL COUNTY OFFICE OF ENVIRONMENTAL HEALTH ***

APPLICATION FOR PERMIT FOR AUTHORIZATION TO CONSTRUCT AN ON-SITE SEWER TREATMENT SYSTEM AND LICENSE TO OPERATE



Planning Materials & Site Evaluation as Required Completed By GREG W. JOHNSON, P.E.

System Description PROPRIETARY; AEROBIC TREATMENT AND DRIP TUBING

Size of Septic System Required Based on Planning Materials & Soil Evaluation

Tank Size(s) (Gallons) NUWATER B-550-PC Absorption/Application Area (Sq Ft) 2000

Gallons Per Day (As Per TCEQ Table III) 240

(Sites generating more than 5000 gallons per day are required to obtain a permit through TCEQ)

RECEIVED

Is the property located over the Edwards Recharge Zone? [] Yes [X] No

(If yes, the planning materials must be completed by a Registered Sanitarian (R.S.) or Professional Engineer (P.E.))

FEB 14 2019

Is there an existing TCEQ approved WPAP for the property? [] Yes [X] No

(if yes, the R. S. or P. E. shall certify that the OSSF design complies with all provisions of the existing WPAP.)

COUNTY ENGINEER

If there is no existing WPAP, does the proposed development activity require a TCEQ approved WPAP? [] Yes [] No

(If yes, the R.S. or P. E. shall certify that the OSSF design will comply with all provisions of the proposed WPAP. A Permit to Construct will not be issued for the proposed OSSF until the proposed WPAP has been approved by the appropriate regional office.)



Is the property located over the Edwards Contributing Zone? [X] Yes [] No

Is there an existing TCEQ approval CZP for the property? [] Yes [X] No

(if yes, the P.E. or R.S. shall certify that the OSSF design complies with all provisions of the existing CZP)

If there is no existing CZP, does the proposed development activity require a TCEQ approved CZP? [] Yes [X] No

(if yes, the P.E. or R.S. shall certify that the OSSF design will comply with all provisions of the proposed CZP. A Permit to construct will not be issued for the proposed OSSF until the CZP has been approved by the appropriate regional office.)

Is this property within an incorporated city? [] Yes [X] No

If yes, indicate the city:



FIRM #2585

By signing this application, I certify that:

- The information provided above is true and correct to the best of my knowledge.
- I affirmatively consent to the online posting/public release of my e-mail address associated with this permit application, as applicable

Signature of Designer

Date February 14, 2019

VOID

Total linear feet drip tubing: 1000' *Netifim Bioline* drip tubing .61 GPH
Pump requirement: 500 emitters @ 0.61 gph @ 30 psi = 5.0833 gpm
Pump: 0.5 HP FPS E-Series 20FE05P4-2W115 submersible pump or equivalent.
Dosing volume: 50-70 gal.

Pump Tank Calculations: 768 Gal (14.5 gal/in.)
Volume below working level = 15" = 219 gal
Working level = 240 gal = 17"
Reserve Requirement = 1/3 day = 80 gal. = 6"

MINIMUM SCOUR VELOCITY (MSV) > 2 FPS
IN DRIP TUBING W/ NOM. DIA. 0.55" ID
MSV = 2 FPS $(\pi d^2) / 4 * 7.48 \text{ gal/cf} * 60 \text{ sec/min}$
MSV = $2(3.14159((.55/12)^2) / 4) * 7.48 * 60$
MSV = 1.5 gpm x 3 = 4.5 gpm MIN FLOW RATE

IN RETURN MANIFOLD W/ NOM. DIA 1.049" ID
MSV = 2 FPS $(\pi d^2) / 4 * 7.48 \text{ gal/cf} * 60 \text{ sec/min}$
MSV = $2(3.14159((1.049/12)^2) / 4) * 7.48 * 60$
MSV = 5.4 GPM

VOID

Greg W. Johnson 10/17/17

Greg W. Johnson, P.E. No. 67587, F#2585
170 Hollow Oak
New Braunfels, Texas 78132
830/905-2778



RECEIVED
FEB 14 2019
COUNTY ENGINEER

INSTALL 2000sf OF
FIELD USING 1000'
OF DRIP TUBING

*USE TWO WAY
CLEANOUT
**USE SCH-40 OR
SDR-26 TO TANK

X= TEST HOLE

VOID

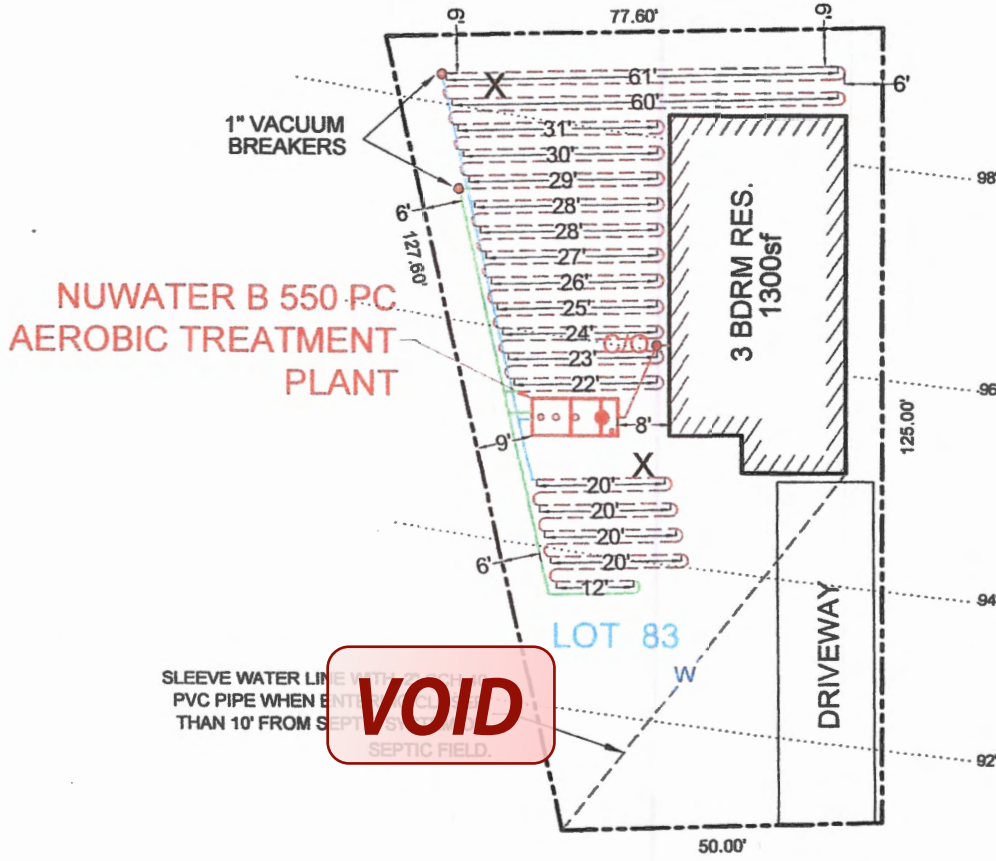

RECEIVED
FEB 14 2019
COUNTY ENGINEER

VOID

HILLCREST FOREST



OWNER: BGRM, LP.		DRAWN BY: EJS III		
STREET ADDRESS: 1562 HILLCREST FOREST				
LEGAL DESC: CANYON LAKE FOREST	UNIT/SECTION/PHASE: 1	BLOCK:	LOT: 83	
PREPARED BY: GREG W. JOHNSON, P.E. F#002585	SCALE: 1"=30'	DATE: 10/17/2017	REVISED:	

FILED BY ATC
SPRING BRANCH

GF# 4000131700509

Notice of confidentiality rights: If you are a natural person, you may remove or strike any or all of the following information from any instrument that transfers an interest in real property before it is filed for record in the public records: your Social Security number or your driver's license number.

WARRANTY DEED WITH VENDOR'S LIEN

STATE OF TEXAS §

KNOW ALL MEN BY THESE PRESENTS:

COUNTY OF COMAL §

Executed on date of acknowledgement to be Effective on: July 17, 2017

Grantor: CARLOS ANDRES CHAVIRA

Grantor's Mailing Address (including county): 21720 Hardy Oak Blvd
San Antonio TX 78258 Bexar County

Grantee: **BGRM, LP**

Grantee's Mailing Address: 20540 Hwy 46, Ste. 115, PMB 139, Spring Branch, Comal County, Texas 78070

Consideration: Cash and the further consideration of the execution and delivery by the said Grantee of one certain promissory note of even date herewith in the principal sum of TWENTY-ONE THOUSAND FIVE HUNDRED AND NO/100 DOLLARS (\$21,500.00), payable to the order of Grantor, bearing interest and being payable as therein provided; said note providing for acceleration of maturity in the event of default and for attorney's fees; the payment of which note is secured by the vendor's lien herein retained, and is additionally secured by a Deed of Trust of even date herewith to KRISTEN QUINNEY PORTER, Trustee.

Property (including any improvements): **Lots 81, 82 and 83, Canyon Lake Forest, Unit No. 1, Comal County, Texas, according to plat thereof recorded in Volume 1, Pages 53-54, Deed and Plat Records of Comal County, Texas.**

Reservations from Conveyance: None.

Exceptions to Conveyance and Warranty: All presently recorded restrictions, reservations, easements, covenants and conditions that affect the property and taxes for the current year, the payment of which Grantee assumes.

RECEIVED
FEB 14 2019
COUNTY ENGINEER

Grantor, for the Consideration and subject to the Reservations from Conveyance and the Exceptions to Conveyance and Warranty, grants, sells, and conveys to Grantee the Property, together with all and singular the rights and appurtenances thereto in any way belonging, to have and to hold it to Grantee and Grantee's heirs, successors, and assigns forever. Grantor binds Grantor and Grantor's heirs and successors to warrant and forever defend all and singular the Property to Grantee and Grantee's heirs, successors, and assigns against every person whomsoever lawfully claiming or to claim the same or any part thereof, except as to the Reservations from Conveyance and the Exceptions to Conveyance and Warranty.

The vendor's lien against and superior title to the Property are retained until each note described is fully paid according to its terms, at which time this deed will become absolute.

When the context requires, singular nouns and pronouns include the plural.

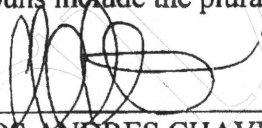

CARLOS ANDRES CHAVIRA

RECEIVED
FEB 14 2019

COUNTY ENGINEER

THE STATE OF TEXAS *
COUNTY OF Comal *

This instrument was acknowledged before me on this the 17th day of July, 2017, by CARLOS ANDRES CHAVIRA.

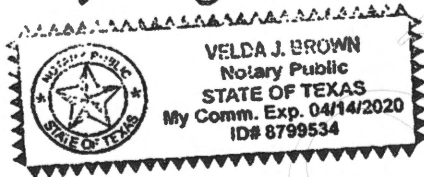

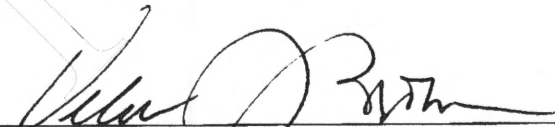

NOTARY PUBLIC, STATE OF TEXAS
Notary's Name Printed: _____
My Commission Expires: _____

AFTER RECORDING RETURN TO:
ALAMO TITLE COMPANY
GF No. 4000131700509

PREPARED IN THE LAW OFFICE OF:
KRISTEN QUINNEY PORTER, LLC
P.O. Box 312643
New Braunfels, Texas 78131-2643

Filed and Recorded
Official Public Records
Bobbie Koepp, County Clerk
Comal County, Texas
07/25/2017 08:23:58 AM
TERRI 2 Pages(s)
201706034760



Bobbie Koepp

Aerobic Services of South Texas
15188 FM 306
Canyon Lake, TX 78133

ENTERED



Phone: (830) 964-2365
 Fax: (830) 964-2659
 www.aerobicservices.com
Permit #: 108765

Printed: 6/25/2019

MAILED

To: BGRM LP
20540 HWY 46 W Suite 115-139
Spring Branch, TX 78070

Tech: Not Assigned
 Brand/Mfg.: Nuwater B 550 PC -
 System S/N:
 Aerator and S/N:

Contract: 3/19/2019 - 3/19/2021
 Inspections per year: 3
 Service Due: **7/19/2019**
 Alt Phone:

Site: 1562 Hillcrest Forest, Spring Branch
 Agency: Comal County Environmental Health
 County: Comal
 Subdivision: Canyon Lake Forest

Phone: (830) 481-8880
 Cell:
 Work:

Inspection Type: Scheduled

Item	Operational	Inoperative	N/A
Aerator:	<u> </u>	<u> </u>	<u> </u>
Irrigation pump:	<u> </u>	<u> </u>	<u> </u>
Air compressor:	<u> </u>	<u> </u>	<u> </u>
Disinfection device:	<u> </u>	<u> </u>	<u> </u>
Chlorine supply:	<u> </u>	<u> </u>	<u> </u>
Spray field vegetation:	<u> </u>	<u> </u>	<u> </u>
Sprinkler / Drip backwash:	<u> </u>	<u> </u>	<u> </u>
Controls/ Electric Circuits	<u> </u>	<u> </u>	<u> </u>

Air Pressure 60

Test Results and observations: (As Required)
 Chlorine Residual:
 Test Method:
 BOD:
 TSS:
 Access Ports Secured YES / NO
 Repairs made: YES / NO

Mixed Liquor
 Aeration 0
 Sludge Levels
 Clarifier 6
 Pump 5

Repairs and Comments: Cleared die filter & Backwashed line

Inspector: Tom Hampton
 Tom Hampton VP
 MP349/OS24597

Date: 8-1-19

Area: / 0
 GPS: ID = 61115132

1562 Hillcrest Forest, Spring Branch

RECEIVED
 AUG 12 2019
 COUNTY ENGINEER

Aerobic Services of South Texas
15188 FM 306
Canyon Lake, TX 78133

MAILED



ENTERED

Phone: (830) 964-2365
Fax: (830) 964-2659

www.aerobicservices.com

To: **Greg Garcia**
1562 Hillcrest Forest
Canyon Lake, TX 78133

Printed: 8/15/2019
Site: 1562 Hillcrest Forest
Canyon Lake, TX 78133
(210) 815-6732

Permit #: **108765**

Customer ID: 61115132

Agency: Comal County Environmental Health Comal County Environmental Health Comal C
County: Comal Sub: Canyon Lake Forest

Contract Dates: 3/19/2019 - 3/19/2021

Scheduled Date: 11/19/2019

Mfg / Brand: - Nuwater B 550 PC
Treatment Type: Aerobic
Disposal: Drip Emitters

ACTIVE

Service Type: Repair

Entered By: Lisa Bybee

Visit Date: 8/14/2019

Method: Grab

Technician: Dakota

Maint. Provider: Hampton, Thomas

Aerators: Operational

Filters: Operational

Irrigation Pumps: Operational

Disinfection Device: Operational

Tank Lid / Riser: Secured

Electric Circuits: Operational

Distribution System: Operational

Sprayfield Veg: Operational

Alarm: Operational

Comments

- Technician Secured the Tank Lid and/or Riser prior to leaving location.
Driop filter was clogged Cleaned filter, system pumping down may need pumping of pump tank

Service Completed

Insp ID #: 116814

Provider: **Thomas Hampton**

License #: MP0000349

Expires: 9/30/2020

RECEIVED

AUG 20 2019

COUNTY ENGINEER

Aerobic Services of South Texas
15188 FM 306
Canyon Lake, TX 78133



ENTERED

Printed: 9/24/2019

Phone: (830) 964-2365
Fax: (830) 964-2669
www.aerobic-services.com
Permit #: 108765

To: **Greg Garcia**
1562 Hillcrest Forest
Canyon Lake, TX 78133

Tech: Not Assigned
Brand/Mfg.: Nuwater B 550 PC -
System S/N:
Aerator and S/N:

Site: 1562 Hillcrest Forest, Canyon Lake
Agency: Comal County Environmental Health
County: Comal
Subdivision: Canyon Lake Forest

Contract: 3/19/2019 - 3/19/2021
Inspections per year: 3
Service Due: 11/19/2019
All Phone: 2

Inspection Type: _____

Item	Operational	Inoperative	N/A
Aerator:	_____	_____	_____
Irrigation pump:	_____	_____	_____
Air compressor:	_____	_____	_____
Disinfection device:	_____	_____	_____
Chlorine supply:	_____	_____	_____
Spray field vegetation:	_____	_____	_____
Sprinkler / Drip backwash:	_____	_____	_____
Controls/ Electric Circuits	_____	_____	_____

Air Pressure _____

Test Results and observations: (As Required)

Chlorine Residual: _____
Test Method: _____
BOD: _____
TSS: _____

Mixed Liquor Aeration _____
Sludge Levels _____
Clarifier _____
Pump _____

Access Ports Secured YES / NO
Repairs made: YES / NO

Repairs and Comments:

*unable to service need to upgrade
To a call first control.*

Inspector: Tom
Tom Hampton VP
MP349/OS24597

Date: 1-3-19

Area: / 0
GPS: ID = 61115132

1562 Hillcrest Forest, Canyon Lake

*DOG chained up over
system. could not
inspect. Left note 12-10-19
1-2-20*

DOGS Chained over system

Aerobic Services of South Texas
15188 FM 306
Canyon Lake, TX 78133



ENTERED

Printed: 9/24/2019

Phone: (830) 964-2365
Fax: (830) 964-2659
www.aerobicservices.com
Permit #: 108765

To: Greg Garcia
1562 Hillcrest Forest
Canyon Lake, TX 78133

Tech: Not Assigned
Brand/Mfg.: Nuwater B 550 PC -
System S/N:
Aerator and S/N:

Site: 1562 Hillcrest Forest, Canyon Lake
Agency: Comal County Environmental Health
County: Comal
Subdivision: Canyon Lake Forest

Contract: 3/19/2019 - 3/19/2021
Inspections per year: 3
Service Due: 11/19/2019
Alt Phone: (2)

Inspection Type: _____

Item	Operational	Inoperative	N/A	
Aerator:	_____	_____	_____	Air Pressure _____
Irrigation pump:	_____	_____	_____	
Air compressor:	_____	_____	_____	
Disinfection device:	_____	_____	_____	
Chlorine supply:	_____	_____	_____	
Spray field vegetation:	_____	_____	_____	
Sprinkler / Drip backwash:	_____	_____	_____	
Controls/ Electric Circuits	_____	_____	_____	

Test Results and observations: (As Required)

Chlorine Residual: _____
Test Method: _____
BOD: _____
TSS: _____

Mixed Liquor Aeration _____
Sludge Levels _____
Clarifier _____
Pump _____

Access Ports Secured YES / NO
Repairs made: YES / NO

Repairs and Comments: _____
_____ unable to service need to upgrade
_____ To a call first contract.

Inspector: Tom Hampton VP
MP349/OS24597
Date: 1-3-19

Area: / 0
GPS: ID = 61115132

1562 Hillcrest Forest, Canyon Lake

Dog chained up over system, could not inspect. Left note 12-10-19
1-2-20

Dogs Chained over system

RECEIVED

JAN 13 2020

COUNTY ENGINEER

Aerobic Services of South Texas
15188 FM 306
Canyon Lake, TX 78133

ENTERED



(830) 964-2365
Fax: (830) 964-2659
www.aerobicservices.com
Permit #: 108765

To: Greg Garcia
1562 Hillcrest Forest
Canyon Lake, TX 78133

Tech: Not Assigned
Brand/Mfg.: Nuwater B 550 PC -
System S/N:
Aerator and S/N:

Site: 1562 Hillcrest Forest, Canyon Lake
Agency: Comal County Environmental Health
County: Comal
Subdivision: Canyon Lake Forest

Contract: 3/19/2019 - 3/19/2021
Inspections per year: 3
Service Due: 3/19/2020
Alt Phone:
Warranty Ending: ③

Inspection Type: Scheduled

Item	Operational	Inoperative	N/A
Aerator:	<u>/</u>	<u>/</u>	<u>/</u>
Irrigation pump:	<u>/</u>	<u>/</u>	<u>/</u>
Air compressor:	<u>/</u>	<u>/</u>	<u>/</u>
Disinfection device:	<u>/</u>	<u>/</u>	<u>/</u>
Chlorine supply:	<u>/</u>	<u>/</u>	<u>/</u>
Spray field vegetation:	<u>/</u>	<u>/</u>	<u>/</u>
Sprinkler / Drip backwash:	<u>/</u>	<u>/</u>	<u>/</u>
Controls/ Electric Circuits	<u>/</u>	<u>/</u>	<u>/</u>

Air Pressure 60

Test Results and observations: (As Required)

Chlorine Residual: _____
Test Method: DOP
BOD: _____
TSS: _____
Access Ports Secured: YES/NO
Repairs made: YES/NO

Mixed Liquor Aeration 12
Sludge Levels Clarifier 12
Pump 3

Repairs and Comments: Cleared drip filter

Inspector: Tom Hampton
Tom Hampton VP
MP349/OS24597

Date: 4-1-20

someone is always home KNOCK

Area: / 0
GPS:
ID = 61115132
Printed: 3/31/2020

1562 Hillcrest Forest, Canyon Lake

Aerobic Services of South Texas
15188 FM 306
Canyon Lake, TX 78133



Phone: (830) 964-2365
Fax: (830) 964-2659
www.aerobicservices.com

Printed: 4/21/2020
Site: 1562 Hillcrest Forest
Canyon Lake, TX 78133
(210) 815-6732

To: **Greg Garcia**
1562 Hillcrest Forest
Canyon Lake, TX 78133

Permit #: **108765** Customer ID: 61115132
Agency: Comal County Environmental Health Comal County Environmental Health Comal C Contract Dates: 3/19/2019 - 3/19/2021
County: Comal Sub: Canyon Lake Forest Scheduled Date: 7/19/2020
Mfg / Brand: - Nuwater B 550 PC
Treatment Type: Aerobic
Disposal: Drip Emitters

Service Type: Repair

Entered By: Belinda

Visit Date: 4/20/2020

Method: Grab

Technician: Seth McDonald

Maint. Provider: Hampton, Thomas

Aerators: Operational

Filters: Operational

Irrigation Pumps: Operational

Disinfection Device: Operational

Tank Lid / Riser: Secured

Electric Circuits: Operational

Distribution System: Operational

Sprayfield Veg: Operational

Alarm: Operational

Comments

Service Completed

- Technician Secured the Tank Lid and/or Riser prior to leaving location.
- Float stuck or pump air locked. Pumped below alarm, and still pumping down.
- Needs pump out. 14" in pump tank.

Insp ID #:121918

Provider: *Thomas Hampton*

License #: MP0000349

Expires: 9/30/2020

Aerobic Services of South Texas
15188 FM 306
Canyon Lake, TX 78133



Phone: (830) 964-2365
 Fax: (830) 964-2659
 www.aerobicservices.com
Permit #: 108765

Printed: 7/8/2020

To: Greg & Mirim Garcia
1562 Hillcrest Forest
Canyon Lake, TX 78133

Tech: Not Assigned
 Brand/Mfg.: Nuwater B 550 PC -
 System S/N:
 Aerator and S/N:

Contract: 3/19/2019 - 3/19/2021
 Inspections per year: 3
 Service Due: 7/19/2020
 Alt Phone:

Phone: (210) 815-6732
 Cell: (956) 271-7702
 Work:

Site: 1562 Hillcrest Forest, Canyon Lake
 Agency: Comal County Environmental Health
 County: Comal
 Subdivision: Canyon Lake Forest

Inspection Type: Scheduled

Item	Operational	Inoperative	N/A
Aerator:	<u>✓</u>	<u> </u>	<u> </u>
Irrigation pump:	<u>✓</u>	<u> </u>	<u> </u>
Air compressor:	<u>✓</u>	<u> </u>	<u> </u>
Disinfection device:	<u>✓</u>	<u> </u>	<u> </u>
Chlorine supply:	<u>✓</u>	<u> </u>	<u> </u>
Spray field vegetation:	<u>✓</u>	<u> </u>	<u> </u>
Sprinkler / Drip backwash:	<u>✓</u>	<u> </u>	<u> </u>
Controls/ Electric Circuits	<u>✓</u>	<u> </u>	<u> </u>

Air Pressure 74

Test Results and observations: (As Required)
 Chlorine Residual: N/A
 Test Method: N/A
 BOD:
 TSS:
 Access Ports Secured YES/NO
 Repairs made: YES/NO

Mixed Liquor 0
 Aeration 0
 Sludge Levels 0
 Clarifier 0
 Pump 1

Repairs and Comments: cleaned drip filter. Backwashed
drip lines

Inspector: Ricky
 Tom Hampton VP
 MP349/OS24597

Date: 3/11/20

someone is always home KNOCK

Area: / 0
 GPS: ID = 61115132

1562 Hillcrest Forest, Canyon Lake

MAILED

Aerobic Services of South Texas
15188 FM 306
Canyon Lake, TX 78133

ENTERED



Phone: (830) 964-2365
Fax: (830) 964-2659
www.aerobicservices.com
Permit #: 108765

Printed: 9/22/2020

To: **Greg & Mirim Garcia**
1562 Hillcrest Forest
Canyon Lake, TX 78133

Tech: Not Assigned
Brand/Mfg.: Nuwater B 550 PC -
System S/N:
Aerator and S/N:

Contract: 3/19/2019 - 3/19/2021
Inspections per year: 3
Service Due: 11/19/2020

Site: 1562 Hillcrest Forest, Canyon Lake
Agency: Comal County Environmental Health
County: Comal
Subdivision: Canyon Lake Forest

Phone: (210) 815-6732
Cell: (956) 271-7702
Work:

Alt Phone: (5)

Inspection Type: Scheduled

Item	Operational	Inoperative	N/A
Aerator:	<u>/</u>	<u>/</u>	<u>/</u>
Irrigation pump:	<u>/</u>	<u>/</u>	<u>/</u>
Air compressor:	<u>/</u>	<u>/</u>	<u>/</u>
Disinfection device:	<u>/</u>	<u>/</u>	<u>/</u>
Chlorine supply:	<u>/</u>	<u>/</u>	<u>/</u>
Spray field vegetation:	<u>/</u>	<u>/</u>	<u>/</u>
Sprinkler / Drip backwash:	<u>/</u>	<u>/</u>	<u>/</u>
Controls/ Electric Circuits	<u>/</u>	<u>/</u>	<u>/</u>

Air Pressure 65

Test Results and observations: (As Required)
Chlorine Residual: 2.8
Test Method: DSP
BOD: _____
TSS: _____
Access Ports Secured YES / NO
Repairs made: YES / NO

Mixed Liquor
Aeration 12
Sludge Levels
Clarifier 2
Pump 24

Repairs and Comments: cleaned dirt filter

Inspector: Tom Hampton
Tom Hampton VP
MP349/OS24597

Date: 11/19/20

someone is always home KNOCK

Area: / 0
GPS: ID = 61115132

1562 Hillcrest Forest, Canyon Lake

Aerobic Services of South Texas
15188 FM 306
Canyon Lake, TX 78133

ENTERED

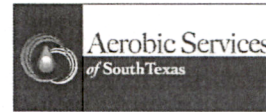

MAILED

Phone: (830) 964-2365

Fax: (830) 964-2659

www.aerobicservices.com

Printed: 5/19/2020

Site: 1562 Hillcrest Forest

Canyon Lake, TX 78133

(210) 815-6732

To: **Greg & Mirim Garcia**
1562 Hillcrest Forest
Canyon Lake, TX 78133

Permit #: **108765**

Customer ID: 61115132

Agency: Comal County Environmental Health Comal County Environmental Health Comal C Contract Dates: 3/19/2019 - 3/19/2021

County: Comal

Sub: Canyon Lake Forest

Scheduled Date: 7/19/2020

Mfg / Brand: - Nuwater B 550 PC

Treatment Type: Aerobic

Disposal: Drip Emitters

Service Type: Repair

Entered By: Belinda

Visit Date: 5/18/2020

Method: Grab

Technician: Dakota

Maint. Provider: Hampton, Thomas

Aerators: Operational

Filters: Operational

Irrigation Pumps: Operational

Disinfection Device: Operational

Tank Lid / Riser: Secured

Electric Circuits: Operational

Distribution System: Operational

Sprayfield Veg: Operational

Alarm: Operational

Comments

- Technician Secured the Tank Lid and/or Riser prior to leaving location.
- Replaced bad pump float

RECEIVED

JUN 02 2020

COUNTY ENGINEER

Service Completed

Insp ID #: 122494

Provider: *Thomas Hampton*

License #: MP0000349

Expires: 9/30/2020

Aerobic Services of South Texas
15188 FM 306
Canyon Lake, TX 78133



ENTERED

Phone: (830) 964-2365
 Fax: (830) 964-2659
 www.aerobicservices.com
 Permit #: 108765

Printed: 12/17/2020

MAILED

To: **Greg & Mirim Garcia**
1562 Hillcrest Forest
Canyon Lake, TX 78133

Tech: Not Assigned
 Brand/Mfg.: Nuwater B 550 PC -
 System S/N:
 Aerator and S/N:

Contract: 3/19/2019 - 3/19/2021
 Inspections per year: 3
 Service Due: **3/19/2021**
 Alt Phone:

Site: 1562 Hillcrest Forest, Canyon Lake
 Agency: Comal County Environmental Health
 County: Comal
 Subdivision: Canyon Lake Forest

Phone: (210) 815-6732
 Cell: (956) 271-7702
 Work:

Inspection Type: Scheduled

Item	Operational	Inoperative	N/A
Aerator:	<u>/</u>	<u> </u>	<u> </u>
Irrigation pump:	<u>/</u>	<u> </u>	<u> </u>
Air compressor:	<u>/</u>	<u> </u>	<u> </u>
Disinfection device:	<u>/</u>	<u> </u>	<u> </u>
Chlorine supply:	<u>/</u>	<u> </u>	<u>/</u>
Spray field vegetation:	<u>/</u>	<u> </u>	<u> </u>
Sprinkler / Drip backwash:	<u>NA</u>	<u> </u>	<u> </u>
Controls/ Electric Circuits	<u>/</u>	<u> </u>	<u> </u>

Air Pressure 58

Test Results and observations: (As Required)
 Chlorine Residual: NA
 Test Method: _____
 BOD: _____
 TSS: _____
 Access Ports Secured YES / NO
 Repairs made: YES / NO

Mixed Liquor
 Aeration 12
 Sludge Levels
 Clarifier 24
 Pump 2

Repairs and Comments:

Inspector: Seth
 Tom Hampton VP
 MP349/OS24597

Date: 4-6-21

someone is always home KNOCK

Area: / 0
 GPS: ID = 61115132

1562 Hillcrest Forest, Canyon Lake

ROUTINE MAINTENANCE AND INSPECTION AGREEMENT



Greg & Miriam Garcia
1562 Hillcrest Forest
Canyon Lake, TX 78133
P: (210) 815-6732

COUNTY: Comal

PERMIT: 108765

AGREEMENT LENGTH: 12 mos.

DESCRIPTION	TERM	AMOUNT	TAX	TOTAL
Residential Service Contract	06/30/23 - '24	370.00		370.00

GENERAL

This Work for Hire Agreement (hereinafter referred to as this "Agreement") is entered into by and between the client named above (referred to as to "Client") and Aerobic Services of South Texas (Thomas W. Hampton MP349) (hereinafter referred to as "Contractor") located at 15188 FM 306 Canyon Lake, Texas 78133. By this Agreement the Contractor agrees to render professional service, as described herein, and the Client agrees to fulfill the terms of this Agreement as described herein. This contract will provide for all required inspections, testing and service for your Aerobic Treatment System. The policy will include the following:

- 1. 3 inspections per year (1 every 4 months), for a total of 3 over the one year period including inspection**, adjustment and servicing of the mechanical, electrical and other applicable component parts to ensure proper function. This includes inspecting control panel, air pumps, air filters, diffuser operation. Any alarm situation affecting the proper function of the Aerobic process will be addressed within a 48-hour time frame. Repair work on non-warranty parts will include price for parts & labor. The prices will be quoted before work is performed.
2. An effluent quality inspection consisting of a visual check for color, turbidity, scum overflow and examination for odors. A test for chlorine residual and PH will be taken and reported as necessary.
3. If any improper operation is observed, which cannot be corrected at the time of the service visit, you will be notified immediately in writing of the conditions and estimated date of correction.
4. The client is responsible for chlorine. Must be filled before or during the service visit.
5. Any additional visits, inspections or sample collection required by specific Municipalities, Water/River Authorities, County Agencies the TCEQ or any other authorized regulatory agency in your jurisdiction will be covered by this policy.

The Homeowners Manual must be strictly followed or warranties are subject to invalidation. Pumping of sludge build-up is not covered by this policy and will result in additional charges.

ACCESS BY CONTRACTOR

The Contractor or anyone authorized by the Contractor may enter the property at reasonable times without prior notice for the purpose of the above described Services. The contractor may access the System components including the tanks by means of excavation for the purpose of evaluations if necessary. Soil is to be replaced with the excavated material as best as possible.

Termination of Agreement

Either party may terminate this agreement within ten days written notice in the event of substantial failure to perform in

accordance with its terms by the other party without fault of the terminating party. If this Agreement is so terminated, the Contractor will immediately notify the appropriate health authority of the termination.

Limit of Liability

In no event shall the Contractor be liable for indirect, consequential, incidental or punitive damages, whether in contract tort or any other theory. In no event shall the Contractor's liability for direct damages exceed the price for the services described in this Agreement.

Dispute Resolution

If a dispute between the Client and the Contractor arises that cannot be settled in good faith negotiations then the parties shall choose a mutually acceptable arbitrator and shall share the cost of the arbitration services equally.

Entire Agreement

This Agreement contains the entire agreement of the parties, and there are no other promises or conditions in any other agreement either oral or written.

Severability

If any provision of this Agreement shall be held to be invalid or unenforceable for any reason, the remaining provisions shall continue to be valid and enforceable. If a court finds that any provision of this agreement is invalid or unenforceable, but that by limiting such provision it would become valid and enforceable, then such provision shall be deemed to be written, construed, and enforced as so limited.

SERVICE PROVIDER

Aerobic Services of South Texas Inc.
15188 FM 306
Canyon Lake, Tx 78133

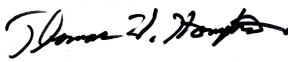

Signature

Tom Hampton VP

License# OS0024597 / MP 349

PLEASE REMIT	370.00
--------------	--------



Customer Signature

*****To pay online, proceed to the "Billing" section in your Customer Portal**

**IF MAILING YOUR PAYMENT: PLEASE RETURN THIS PORTION ALONG WITH YOUR PAYMENT
For Service at: 1562 Hillcrest Forest, Canyon Lake, TX 78133**



Greg & Miriam Garcia

PERMIT: 108765

COUNTY: Comal

TERM: 06/30/23 - '24

AGREEMENT LENGTH: 12 mos.

PLEASE REMIT	370.00
--------------	--------

Residential Service Contract

Signed on: Thursday, 06/08/2023

Aerobic Services of South Texas
15188 FM 306
Canyon Lake, TX 78133



Canyon Lake: (830) 964-2365
Bastrop: (512) 303-6922
 info@aerobicservices.com
 bastrop@aerobicservices.com
MP349 / OS24597
www.aerobicservices.com

To: Greg & Miriam Garcia
1562 Hillcrest Forest
Canyon Lake, TX 78133
 Agency: Comal County Enviromental Health
 County: Comal
 Permit No: 108765

Tech: Nyssa
 Phone: (210) 815-6732 Date: 2023-11-01
 Alt Ph: (956) 271-7702 Service _____
 Due: _____

Inspection Type: _____

Item	Operational	Inoperative	N/A
Aerator:	[X]	[]	[]
Irrigation pump:	[X]	[]	[]
Air compressor:	[X]	[]	[]
Disinfection device:	[X]	[]	[]
Chlorine supply:	[X]	[]	[]
Spray field vegetation:	[X]	[]	[]
Sprinkler / Drip backwash:	[X]	[]	[]
Controls / Electric Circuits:	[X]	[]	[]

Air Pressure: 60

Test Results and Observations: (As Required)

Chlorine Residual: _____

Test Method: Drip

BOD: _____

TSS: _____

Access Ports Secured: Yes [X] / NO []

Repairs Made: Yes [] / NO [X]

Mixed Liquor

Aeration: 48

Sludge Levels

Clarifier: Fog

Pump: 0

Repairs and Comments:

Cleaned filter and backwashed system

Inspector: _____

Date: 2023-11-01

Tom Hampton, VP
 MP349/OS24597

Aerobic Services
 15188 FM 306
 Canyon Lake, TX 78133



Canyon Lake: (830) 964-2365
Bastrop: (512) 303-6922
 info@aerobicservices.com
 bastrop@aerobicservices.com
MP349 / OS24597
 www.aerobicservices.com

To: Greg & Miriam Garcia
1562 Hillcrest Forest
Canyon Lake, TX 78133
 Agency: Comal County Environmental Health
 County: Comal
 Permit No: 108765

Tech: Seth
 Phone: (210) 815-6732 Date: 2024-04-04
 Alt Ph: (956) 271-7702 Service Due: _____

Inspection Type: Scheduled

Item	Operational	Inoperative	N/A
Aerator:	<input checked="" type="checkbox"/>	<input type="checkbox"/>	<input type="checkbox"/>
Irrigation Pump:	<input checked="" type="checkbox"/>	<input type="checkbox"/>	<input type="checkbox"/>
Air Compressor:	<input checked="" type="checkbox"/>	<input type="checkbox"/>	<input type="checkbox"/>
Pump Screen:	<input checked="" type="checkbox"/>	<input type="checkbox"/>	<input type="checkbox"/>
Chlorinator:	<input type="checkbox"/>	<input type="checkbox"/>	<input checked="" type="checkbox"/>
Spray Field Vegetation:	<input checked="" type="checkbox"/>	<input type="checkbox"/>	<input type="checkbox"/>
Filters:	<input checked="" type="checkbox"/>	<input type="checkbox"/>	<input type="checkbox"/>
Sprinkler / Drip Backwash:	<input checked="" type="checkbox"/>	<input type="checkbox"/>	<input type="checkbox"/>
Controls / Electric Circuits:	<input checked="" type="checkbox"/>	<input type="checkbox"/>	<input type="checkbox"/>

Air Pressure: 58

Test Results and Observations: (As Required)

Chlorine Residual: _____
 Test Method: _____
 BOD: _____
 TSS: _____

Mixed Liquor
 Aeration: 36
Sludge Levels
 Clarifier: 24
 Pump: 4

Tank Lids Secured: Yes / NO
 Pump Out Needed: Yes / NO
 Repairs Made: Yes / NO

Repairs and Comments:

Roots in aeration and pump tank. Recommend using copper sulfate as directed to stop roots in system.

Inspector: _____

Date: 2024-04-04

Tom Hampton, VP
 MP349/OS24597

Aerobic Services
15188 FM 306
Canyon Lake, TX 78133



Canyon Lake: (830) 964-2365
Bastrop: (512) 303-6922
info@aerobicservices.com
bastrop@aerobicservices.com
MP349 / OS24597
www.aerobicservices.com

To: Greg & Miriam Garcia
1562 Hillcrest Forest
Canyon Lake, TX 78133
Agency: Comal County Environmental Health
County: Comal
Permit No: 108765

Tech: Robert Salinas
Phone: (210) 815-6732 Date: 2024-07-18
Alt Ph: (956) 271-7702 Service Due: _____

Inspection Type: Scheduled

Item	Operational	Inoperative	Not Present	
Aerator:	<input checked="" type="checkbox"/>	<input type="checkbox"/>	<input type="checkbox"/>	Air Pressure: 59
Irrigation Pump:	<input checked="" type="checkbox"/>	<input type="checkbox"/>	<input type="checkbox"/>	
Air Compressor:	<input checked="" type="checkbox"/>	<input type="checkbox"/>	<input type="checkbox"/>	
Pump Screen:	<input checked="" type="checkbox"/>	<input type="checkbox"/>	<input type="checkbox"/>	
Chlorinator:	<input checked="" type="checkbox"/>	<input type="checkbox"/>	<input type="checkbox"/>	
Spray Field Vegetation:	<input checked="" type="checkbox"/>	<input type="checkbox"/>	<input type="checkbox"/>	
Filters:	<input checked="" type="checkbox"/>	<input type="checkbox"/>	<input type="checkbox"/>	
Sprinkler / Drip Backwash:	<input checked="" type="checkbox"/>	<input type="checkbox"/>	<input type="checkbox"/>	
Controls / Electric Circuits:	<input checked="" type="checkbox"/>	<input type="checkbox"/>	<input type="checkbox"/>	

Test Results and Observations: (As Required)

Chlorine Residual (ppm): 0.06
Test Method: DPD
BOD: N/a
TSS: N/a

Tank Lids Secured: Yes / NO
Pump Out Needed: Yes / NO
Repairs Made: Yes / NO

Mixed Liquor: all measurements in inches

Aeration: 37

Sludge Levels

Clarifier: 22
Pump: 3

Repairs and Comments:

Inspector: _____

Date: 2024-07-18

Tom Hampton, VP
MP349/OS24597