



COMAL COUNTY

ENGINEER'S OFFICE

License to Operate On-Site Sewage Treatment and Disposal Facility

Issued This Date: 06/22/2020 Permit Number: 109342

Location Description: 974 PARADISE DR
CANYON LAKE, TX 78133

Subdivision: Canyon Lake Hills
Unit: 4
Lot: 1907
Block:
Acreage:

Type of System: Aerobic
Drip Irrigation

Issued to: Chris R. Feller

This license is authorization for the owner to operate and maintain a private facility at the location described in accordance to the rules and regulations for on-site sewerage facilities of Comal County, Texas, and the Texas Commission on Environmental Quality.

The license grants permission to operate the facility. It does not guarantee successful operation. It is the responsibility of the owner to maintain and operate the facility in a satisfactory manner.

Alterations to this permit including, but not limited to:

- Increase in the square feet of living area
- Increase in the number of bedrooms
- A change of use (i.e. residential to commercial)
- Relocation of system components (including the relocation of spray heads)
- Installation of landscaping
- Adding new structures to the system

may require a new permit. **It is the responsibility of the owner to apply for a new permit, if applicable.**

Inspection and licensing of a facility indicates only that the facility meets certain minimum requirements. It does not impede any governmental entity in taking the proper steps to prevent or control pollution, to abate nuisance, or to protect the public health.

This license to operate is valid for an indefinite period. The holder may transfer it to a succeeding owner, provided the facility has not been remodeled and is functioning properly.

Licensing Authority

Comal County Environmental Health

OS0032485

ENVIRONMENTAL HEALTH INSPECTOR

ENVIRONMENTAL HEALTH COORDINATOR

OS0007722

Comal County Environmental Health OSSF Inspection Sheet

Installer Name: Varhol Const. / Dennis Varhol OSSF Installer #: OS0031132
 1st Inspection Date: 9/24/19 2nd Inspection Date: 6/5/20 3rd Inspection Date: 6/22/20 final
 Inspector Name: Mike T. Inspector Name: Mike T. Inspector Name: Connor
 Permit#: 109342 Address: C.L. Hills / 974 Paradise Dr.

No.	Description	Answer	Citations	Notes	1st Insp.	2nd Insp.	3rd Insp.
1	SITE AND SOIL CONDITIONS & SETBACK DISTANCES Site and Soil Conditions Consistent with Submitted Planning Materials	✓	285.31(a) 285.30(b)(1)(A)(iv) 285.30(b)(1)(A)(v) 285.30(b)(1)(A)(iii) 285.30(b)(1)(A)(ii) 285.30(b)(1)(A)(i)		9/24/19	6/5/20	
2	SITE AND SOIL CONDITIONS & SETBACK DISTANCES Setback Distances Meet Minimum Standards	✓	285.91(10) 285.30(b)(4) 285.31(d)				
3	SEWER PIPE Proper Type Pipe from Structure to Disposal System (Cast Iron, Ductile Iron, Sch. 40, SDR 26)	✓	285.32(a)(1)				
4	SEWER PIPE Slope from the Sewer to the Tank at least 1/8 Inch Per Foot	✓	285.32(a)(3)				
5	SEWER PIPE Two Way Sanitary - Type Cleanout Properly Installed (Add. C/O Every 100' &/or 90 degree bends)	✓	285.32(a)(5)				
6	PRETREATMENT Installed (if required) TCEQ Approved List PRETREATMENT Septic Tank(s) Meet Minimum Requirements		285.32(b)(1)(G)285.32(b)(1)(E)(iii) 285.32(b)(1)(E)(iv) 285.32(b)(1)(F) 285.32(b)(1)(B) 285.32(b)(1)(C)(i) 285.32(b)(1)(C)(ii) 285.32(b)(1)(D) 285.32(b)(1)(E) 285.32(b)(1)(A) 285.32(b)(1)(E)(ii)(iii) 285.32(b)(1)(E)(i) 285.32(b)(1)(E)(ii)(i)				
7	PRETREATMENT Grease Interceptors if required for commercial		285.34(d)				

MT- 9/24/19

Tank set only, leveled

6/19/20 JC covered

MT- 6/5/20

operational ✓
Ready For Cover

**Comal County Environmental Health
OSSF Inspection Sheet**

No.	Description	Answer	Citations	Notes	1st Insp.	2nd Insp.	3rd Insp.
8	SEPTIC TANK Tank(s) Clearly Marked SEPTIC TANK If Single Tank, 2 Compartments Provided with Baffle SEPTIC TANK Inlet Flowline Greater than 3" and " T " Provided on Inlet and Outlet SEPTIC TANK Septic Tank(s) Meet Minimum Requirements		285.32(b)(1)(E) 285.91(2) 285.32(b)(1)(F) 285.32(b)(1)(E)(iii) 285.32(b)(1)(E)(ii)(II) 285.32(b)(1)(E)(ii)(I) 285.32(b)(1)(E)(i) 285.32(b)(1)(D) 285.32(b)(1)(C)(ii) 285.32(b)(1)(C)(i) 285.32(b)(1)(B) 285.32(b)(1)(A) 285.32(b)(1)(E)(iv)				
9	ALL TANKS Installed on 4" Sand Cushion/ Proper Backfill Used		285.32(b)(1)(F) 285.32(b)(1)(G) 285.34(b)				
10	SEPTIC TANK Inspection / Clean Out Port & Risers Provided on Tanks Buried Greater than 12" Sealed and Capped		285.38(d)				
11	SEPTIC TANK Secondary restraint system provided SEPTIC TANK Riser permanently fastened to lid or cast into tank SEPTIC TANK Riser cap protected against unauthorized intrusions		285.38(d) 285.38(e)				
12	SEPTIC TANK Tank Volume Installed						
13	PUMP TANK Volume Installed						
14	AEROBIC TREATMENT UNIT Size Installed	✓		600	9/24/19	6/5/20	
15	AEROBIC TREATMENT UNIT Manufacturer AEROBIC TREATMENT UNIT Model Number	✓		No Water			
16	DISPOSAL SYSTEM Absorptive		285.33(a)(4) 285.33(a)(1) 285.33(a)(2) 285.33(a)(3)				
17	DISPOSAL SYSTEM Leaching Chamber		285.33(a)(1) 285.33(a)(3) 285.33(a)(4) 285.33(a)(2)				
18	DISPOSAL SYSTEM Evapo-transpirative		285.33(a)(3) 285.33(a)(4) 285.33(a)(1) 285.33(a)(2)				

**Comal County Environmental Health
OSSF Inspection Sheet**

Sl. No.	Description	Answer	Citations	Notes	1st Insp.	2nd Insp.	3rd Insp.
19	DISPOSAL SYSTEM Drip Irrigation		285.33(c)(3)(A)-(F)				
20	DISPOSAL SYSTEM Soil Substitution		285.33(d)(4)				
21	DISPOSAL SYSTEM Pumped Effluent		285.33(a)(3) 285.33(a)(1) 285.33(a)(2)				
22	DISPOSAL SYSTEM Gravelless Pipe		285.33(a)(3) 285.33(a)(2) 285.33(a)(4) 285.33(a)(1)				
23	DISPOSAL SYSTEM Mound		285.33(a)(3) 285.33(a)(1) 285.33(a)(2) 285.33(a)(4)				
24	DISPOSAL SYSTEM Other (describe) (Approved Design)		285.33(d)(6) 285.33(c)(4)				
25	DRAINFIELD Absorptive Drainline 3" PVC or 4" PVC						
26	DRAINFIELD Area Installed						
27	DRAINFIELD Level to within 1 inch per 25 feet and within 3 inches over entire excavation		285.33(b)(1)(A)(v)				
28	DRAINFIELD Excavation Width DRAINFIELD Excavation Depth DRAINFIELD Excavation Separation DRAINFIELD Depth of Porous Media DRAINFIELD Type of Porous Media						
29	DRAINFIELD Pipe and Gravel - Geotextile Fabric in Place		285.33(b)(1)(E)				
30	DRAINFIELD Leaching Chambers DRAINFIELD Chambers - Open End Plates w/Splash Plate, Inspection Port & Closed End Plates in Place (per manufacturers spec.)		285.33(c)(2)				
31	LOW PRESSURE DISPOSAL SYSTEM Adequate Trench Length & Width, and Adequate Separation Distance between Trenches		285.33(d)(1)(C)(i)				

**Comal County Environmental Health
OSSF Inspection Sheet**

	Description	Answer	Citations	Notes	1st Insp.	2nd Insp.	3rd Insp.
32	<p>EFFLUENT DISPOSAL SYSTEM Utilized Only by Single Family Dwelling</p> <p>EFFLUENT DISPOSAL SYSTEM Topographic Slopes < 2.0%</p> <p>EFFLUENT DISPOSAL SYSTEM Adequate Length of Drain Field (1000 Linear ft. for 2 bedrooms or Less & an additional 400 ft. for each additional bedroom)</p> <p>EFFLUENT DISPOSAL SYSTEM Lateral Depth of 18 inches to 3 ft. & Vertical Separation of 1ft on bottom and 2 ft. to restrictive horizon and ground water respectfully</p> <p>EFFLUENT DISPOSAL SYSTEM Lateral Drain Pipe (1.25 - 1.5" dia.) & Pipe Holes (3/16 - 1/4" dia. Hole Size) 5 ft. Apart</p>		<p>285.33(b)(3)(A)</p> <p>285.33(b)(3)(A)</p> <p>285.33(b)(3)(B)</p> <p>285.91(13)</p> <p>285.33(b)(3)(D)</p> <p>285.33(b)(3)(F)</p>				
33	<p>AEROBIC TREATMENT UNIT Is Aerobic Unit Installed According to Approved Guidelines.</p>	/	285.32(c)(1)			6/5/20	
34	<p>AEROBIC TREATMENT UNIT Inspection/Clean Out Port & Risers Provided</p> <p>AEROBIC TREATMENT UNIT Secondary restraint system provided</p> <p>AEROBIC TREATMENT UNIT Riser permanently fastened to lid or cast into tank</p> <p>AEROBIC TREATMENT UNIT Riser cap protected against unauthorized intrusions</p>	/					
35	<p>AEROBIC TREATMENT UNIT Chlorinator Properly Installed with Chlorine Tablets in Place.</p>	/					
36	<p>PUMP TANK Is the Pump Tank an approved concrete tank or other acceptable materials & construction</p> <p>PUMP TANK Sampling Port Provided in the Treated Effluent Line</p> <p>PUMP TANK Check Valve and/or Anti- Siphon Device Present When Required</p> <p>PUMP TANK Audible and Visual High Water Alarm Installed on Separate Circuit From Pump</p>						
37	<p>PUMP TANK Inspection/Clean Out Port & Risers Provided</p> <p>PUMP TANK Secondary restraint system provided</p> <p>PUMP TANK Riser permanently fastened to lid or cast into tank</p> <p>PUMP TANK Riser cap protected against unauthorized intrusions</p>						
38	<p>PUMP TANK Secondary restraint system provided</p>						
39	<p>PUMP TANK Electrical Connections in Approved Junction Boxes / Wiring Buried</p>						

**Comal County Environmental Health
OSSF Inspection Sheet**

final

No.	Description	Answer	Citations	Notes	1st Insp.	2nd Insp.	3rd Insp.
40	APPLICATION AREA Distribution Pipe, Fitting, Sprinkler Heads & Valve Covers Color Coded Purple?	✓	285.33(d)(2)(G)(iii)(I)285.33(d)(2)(G)(iii)(II)285.33(d)(2)(G)(v) 285.33(d)(2)(G)(iii) 285.33(d)(2)(G)(iv) 285.33(d)(2)(G)(I) 285.33(d)(2)(G)(II) 285.33(d)(2)(G)(iii)(I)			6/5/20 	
41	APPLICATION AREA Low Angle Nozzles Used / Pressure is as required APPLICATION AREA Acceptable Area, nothing within 10 ft of sprinkler heads? APPLICATION AREA The Landscape Plan is as Designed	✓ X	285.33(d)(2)(G)(I) 285.33(d)(2)(A) 285.33(d)(2)(F)				X
42	APPLICATION AREA Area Installed						
43	PUMP TANK Meets Minimum Reserve Capacity Requirements						
44	PUMP TANK Material Type & Manufacturer						
45	PUMP TANK Type/Size of Pump Installed						

Comal County Environmental Health OSSF Inspection Sheet

Installer Name: Varhol Const. / Dennis Varhol OSSF Installer #: _____

1st Inspection Date: 9/24/19 2nd Inspection Date: _____ 3rd Inspection Date: _____

Inspector Name: mike T. Inspector Name: _____ Inspector Name: _____

Permit#: 109342 Address: C.L. Hills / 974 Paradise Dr.

No.	Description	Answer	Citations	Notes	1st Insp.	2nd Insp.	3rd Insp.
1	SITE AND SOIL CONDITIONS & SETBACK DISTANCES Site and Soil Conditions Consistent with Submitted Planning Materials	✓	285.31(a) 285.30(b)(1)(A)(iv) 285.30(b)(1)(A)(v) 285.30(b)(1)(A)(iii) 285.30(b)(1)(A)(ii) 285.30(b)(1)(A)(i)		9/24/19 		
2	SITE AND SOIL CONDITIONS & SETBACK DISTANCES Setback Distances Meet Minimum Standards	✓	285.91(10) 285.30(b)(4) 285.31(d)				
3	SEWER PIPE Proper Type Pipe from Structure to Disposal System (Cast Iron, Ductile Iron, Sch. 40, SDR 26)	B	285.32(a)(1)				
4	SEWER PIPE Slope from the Sewer to the Tank at least 1/8 Inch Per Foot	B	285.32(a)(3)				
5	SEWER PIPE Two Way Sanitary - Type Cleanout Properly Installed (Add. C/O Every 100' &/or 90 degree bends)	B	285.32(a)(5)				
6	PRETREATMENT Installed (if required) TCEQ Approved List PRETREATMENT Septic Tank(s) Meet Minimum Requirements		285.32(b)(1)(G)285.32(b)(1)(E)(iii) 285.32(b)(1)(E)(iv) 285.32(b)(1)(F) 285.32(b)(1)(B) 285.32(b)(1)(C)(i) 285.32(b)(1)(C)(ii) 285.32(b)(1)(D) 285.32(b)(1)(E) 285.32(b)(1)(A) 285.32(b)(1)(E)(ii)(II) 285.32(b)(1)(E)(i) 285.32(b)(1)(E)(ii)(I)				
7	PRETREATMENT Grease Interceptors if required for commercial		285.34(d)				

MT- 9/24/19
Tank set only, leveled

**Comal County Environmental Health
OSSF Inspection Sheet**

No.	Description	Answer	Citations	Notes	1st Insp.	2nd Insp.	3rd Insp.
8	SEPTIC TANK Tank(s) Clearly Marked SEPTIC TANK If Single Tank, 2 Compartments Provided with Baffle SEPTIC TANK Inlet Flowline Greater than 3" and "T" Provided on Inlet and Outlet SEPTIC TANK Septic Tank(s) Meet Minimum Requirements		285.32(b)(1)(E) 285.91(2) 285.32(b)(1)(F) 285.32(b)(1)(E)(iii) 285.32(b)(1)(E)(ii)(II) 285.32(b)(1)(E)(ii)(I) 285.32(b)(1)(E)(i) 285.32(b)(1)(D) 285.32(b)(1)(C)(ii) 285.32(b)(1)(C)(i) 285.32(b)(1)(B) 285.32(b)(1)(A) 285.32(b)(1)(E)(iv)				
9	ALL TANKS Installed on 4" Sand Cushion/ Proper Backfill Used		285.32(b)(1)(F) 285.32(b)(1)(G) 285.34(b)				
10	SEPTIC TANK Inspection / Clean Out Port & Risers Provided on Tanks Buried Greater than 12" Sealed and Capped		285.38(d)				
11	SEPTIC TANK Secondary restraint system provided SEPTIC TANK Riser permanently fastened to lid or cast into tank SEPTIC TANK Riser cap protected against unauthorized intrusions		285.38(d) 285.38(e)				
12	SEPTIC TANK Tank Volume Installed						
13	PUMP TANK Volume Installed						
14	AEROBIC TREATMENT UNIT Size Installed	✓		600	9/24/19		
15	AEROBIC TREATMENT UNIT Manufacturer AEROBIC TREATMENT UNIT Model Number	✓		No Water			
16	DISPOSAL SYSTEM Absorptive		285.33(a)(4) 285.33(a)(1) 285.33(a)(2) 285.33(a)(3)				
17	DISPOSAL SYSTEM Leaching Chamber		285.33(a)(1) 285.33(a)(3) 285.33(a)(4) 285.33(a)(2)				
18	DISPOSAL SYSTEM Evapo-transpirative		285.33(a)(3) 285.33(a)(4) 285.33(a)(1) 285.33(a)(2)				

**Comal County Environmental Health
OSSF Inspection Sheet**

No.	Description	Answer	Citations	Notes	1st Insp.	2nd Insp.	3rd Insp.
19	DISPOSAL SYSTEM Drip Irrigation		285.33(c)(3)(A)-(F)				
20	DISPOSAL SYSTEM Soil Substitution		285.33(d)(4)				
21	DISPOSAL SYSTEM Pumped Effluent		285.33(a)(3) 285.33(a)(1) 285.33(a)(2)				
22	DISPOSAL SYSTEM Gravelless Pipe		285.33(a)(3) 285.33(a)(2) 285.33(a)(4) 285.33(a)(1)				
23	DISPOSAL SYSTEM Mound		285.33(a)(3) 285.33(a)(1) 285.33(a)(2) 285.33(a)(4)				
24	DISPOSAL SYSTEM Other (describe) (Approved Design)		285.33(d)(6) 285.33(c)(4)				
25	DRAINFIELD Absorptive Drainline 3" PVC or 4" PVC						
26	DRAINFIELD Area Installed						
27	DRAINFIELD Level to within 1 inch per 25 feet and within 3 inches over entire excavation		285.33(b)(1)(A)(v)				
28	DRAINFIELD Excavation Width DRAINFIELD Excavation Depth DRAINFIELD Excavation Separation DRAINFIELD Depth of Porous Media DRAINFIELD Type of Porous Media						
29	DRAINFIELD Pipe and Gravel - Geotextile Fabric in Place		285.33(b)(1)(E)				
30	DRAINFIELD Leaching Chambers DRAINFIELD Chambers - Open End Plates w/Splash Plate, Inspection Port & Closed End Plates in Place (per manufacturers spec.)		285.33(c)(2)				
31	LOW PRESSURE DISPOSAL SYSTEM Adequate Trench Length & Width, and Adequate Separation Distance between Trenches		285.33(d)(1)(C)(i)				

**Comal County Environmental Health
OSSF Inspection Sheet**

No.	Description	Answer	Citations	Notes	1st Insp.	2nd Insp.	3rd Insp.
32	<p>EFFLUENT DISPOSAL SYSTEM Utilized Only by Single Family Dwelling</p> <p>EFFLUENT DISPOSAL SYSTEM Topographic Slopes < 2.0%</p> <p>EFFLUENT DISPOSAL SYSTEM Adequate Length of Drain Field (1000 Linear ft. for 2 bedrooms or Less & an additional 400 ft. for each additional bedroom)</p> <p>EFFLUENT DISPOSAL SYSTEM Lateral Depth of 18 inches to 3 ft. & Vertical Separation of 1ft on bottom and 2 ft. to restrictive horizon and ground water respectfully</p> <p>EFFLUENT DISPOSAL SYSTEM Lateral Drain Pipe (1.25 - 1.5" dia.) & Pipe Holes (3/16 - 1/4" dia. Hole Size) 5 ft. Apart</p>		<p>285.33(b)(3)(A)</p> <p>285.33(b)(3)(A)</p> <p>285.33(b)(3)(B)</p> <p>285.91(13)</p> <p>285.33(b)(3)(D)</p> <p>285.33(b)(3)(F)</p>				
33	<p>AEROBIC TREATMENT UNIT is Aerobic Unit Installed According to Approved Guidelines.</p>		285.32(c)(1)				
34	<p>AEROBIC TREATMENT UNIT Inspection/Clean Out Port & Risers Provided</p> <p>AEROBIC TREATMENT UNIT Secondary restraint system provided</p> <p>AEROBIC TREATMENT UNIT Riser permanently fastened to lid or cast into tank</p> <p>AEROBIC TREATMENT UNIT Riser cap protected against unauthorized intrusions</p>						
35	<p>AEROBIC TREATMENT UNIT Chlorinator Properly Installed with Chlorine Tablets in Place.</p>						
36	<p>PUMP TANK Is the Pump Tank an approved concrete tank or other acceptable materials & construction</p> <p>PUMP TANK Sampling Port Provided in the Treated Effluent Line</p> <p>PUMP TANK Check Valve and/or Anti- Siphon Device Present When Required</p> <p>PUMP TANK Audible and Visual High Water Alarm Installed on Separate Circuit From Pump</p>						
37	<p>PUMP TANK Inspection/Clean Out Port & Risers Provided</p> <p>PUMP TANK Secondary restraint system provided</p> <p>PUMP TANK Riser permanently fastened to lid or cast into tank</p> <p>PUMP TANK Riser cap protected against unauthorized intrusions</p>						
38	<p>PUMP TANK Secondary restraint system provided</p>						
39	<p>PUMP TANK Electrical Connections in Approved Junction Boxes / Wiring Buried</p>						

**Comal County Environmental Health
OSSF Inspection Sheet**

No.	Description	Answer	Citations	Notes	1st Insp.	2nd Insp.	3rd Insp.
40	APPLICATION AREA Distribution Pipe, Fitting, Sprinkler Heads & Valve Covers Color Coded Purple?		285.33(d)(2)(G)(iii)(II)285.33(d)(2)(G)(iii)(III)285.33(d)(2)(G)(v) 285.33(d)(2)(G)(iii) 285.33(d)(2)(G)(iv) 285.33(d)(2)(G)(i) 285.33(d)(2)(G)(ii) 285.33(d)(2)(G)(iii)(I)				
41	APPLICATION AREA Low Angle Nozzles Used / Pressure is as required APPLICATION AREA Acceptable Area, nothing within 10 ft of sprinkler heads? APPLICATION AREA The Landscape Plan is as Designed		285.33(d)(2)(G)(i) 285.33(d)(2)(A) 285.33(d)(2)(F)				
42	APPLICATION AREA Area Installed						
43	PUMP TANK Meets Minimum Reserve Capacity Requirements						
44	PUMP TANK Material Type & Manufacturer						
45	PUMP TANK Type/Size of Pump Installed						

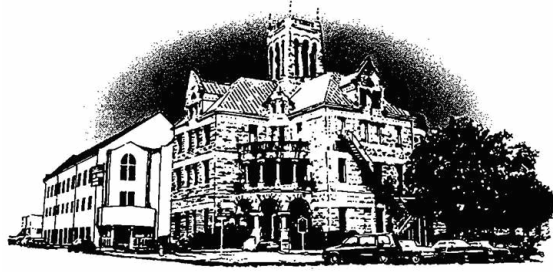

Comal County

OFFICE OF COMAL COUNTY ENGINEER

Permit of Authorization to Construct an On-Site Sewage Facility Permit Valid For One Year From Date Issued

Permit Number: 109342
Issued This Date: 07/05/2019
This permit is hereby given to: Chris R. Feller

To start construction of a private, on-site sewage facility located at:

974 PARADISE DR
CANYON LAKE, TX 78133

Subdivision: Canyon Lake Hills
Unit: 4
Lot: 1907
Block:
Acreage:

APPROVED MINIMUM SIZES AS PER ATTACHED DESIGN

Type of System: Aerobic
Drip Irrigation

This permit gives permission for the construction of the above referenced on-site facility to commence. Installation must be completed by an installer holding a valid registration card from the Texas Commission on Environmental Quality (TCEQ). Installation and inspection must comply with current TCEQ and Comal County requirements.

Call (830) 608-2090 to schedule inspections.

*** COMAL COUNTY OFFICE OF ENVIRONMENTAL HEALTH ***
APPLICATION FOR PERMIT FOR AUTHORIZATION TO CONSTRUCT AN
ON-SITE SEWAGE FACILITY AND LICENSE TO OPERATE

Date _____

Permit # 109342

Owner Name Chris R. Feller

Agent Name Douglas R. Dowlearn

Mailing Address 2546 Lakeview Drive

Agent Address 703 Oak Drive

City, State, Zip Canyon Lake, TX 78133

City, State, Zip Blanco, TX 78606

Phone # 830.832.0264

Phone # 210.240.2101

Email chrisrfler@icloud.com

Email txseptic@gmail.com

All correspondence should be sent to: Owner Agent Both Method: Mail Email

Subdivision Name Canyon Lake Hills Unit 4 Lot 1907 Block _____

Acreage/Legal .1722 Acres

Street Name/Address 974 Paradise Drive City Canyon Lake Zip 78133

Type of Development:

Single Family Residential

Type of Construction (House, Mobile, RV, Etc.) House

Number of Bedrooms 3

Indicate Sq Ft of Living Area 1400

Non-Single Family Residential

(Planning materials must show adequate land area for doubling the required land needed for treatment units and disposal area)

Type of Facility _____

Offices, Factories, Churches, Schools, Parks, Etc. - Indicate Number Of Occupants _____

Restaurants, Lounges, Theaters - Indicate Number of Seats _____

Hotel, Motel, Hospital, Nursing Home - Indicate Number of Beds _____

Travel Trailer/RV Parks - Indicate Number of Spaces _____

Miscellaneous _____

Estimated Cost of Construction: \$ 160,000⁰⁰ (Structure Only) **Complete**

Is any portion of the proposed OSSF located in the United States Army Corps of Engineers (USACE) flowage easement?

Yes No (If yes, owner must provide approval from USACE for proposed OSSF improvements within the USACE flowage easement)

Source of Water Public Private Well

Are Water Saving Devices Being Utilized Within the Residence? Yes No

By signing this application, I certify that:

- The completed application and all additional information submitted does not contain any false information and does not conceal any material facts.
- Authorization is hereby given to the permitting authority and designated agents to enter upon the above described property for the purpose of site/soil evaluation and inspection of private sewage facilities..
- I understand that a permit of authorization to construct will not be issued until the Floodplain Administrator has performed the reviews required by the Comal County Flood Damage Prevention Order.
- I affirmatively consent to the online posting/public release of my e-mail address associated with this permit application, as applicable.

[Signature]
Signature of Owner

6/24/19
Date

Sign Date

RECEIVED
JUL 01 2019
COUNTY ENGINEER

* * * **COMAL COUNTY OFFICE OF ENVIRONMENTAL HEALTH** * * *
APPLICATION FOR PERMIT FOR AUTHORIZATION TO CONSTRUCT AN
ON-SITE SEWAGE FACILITY AND LICENSE TO OPERATE

REVISED

8:25 am, May 26, 2020

Planning Materials & Site Evaluation as Required Completed By Douglas R. Dowlearn

System Description Aerobic Treatment with Drip Disposal

Size of Septic System Required Based on Planning Materials & Soil Evaluation

Tank Size(s) (Gallons) 600 gpd Absorption/Application Area (Sq Ft) 1200 Required

Gallons Per Day (As Per TCEQ Table III) 240

(Sites generating more than 5000 gallons per day are required to obtain a permit through TCEQ.)

Is the property located over the Edwards Recharge Zone? Yes No

(If yes, the planning materials must be completed by a Registered Sanitarian (R.S.) or Professional Engineer (P.E.))

Is there an existing TCEQ approved WPAP for the property? Yes No

(If yes, the R.S. or P.E. shall certify that the OSSF design complies with all provisions of the existing WPAP.)

If there is no existing WPAP, does the proposed development activity require a TCEQ approved WPAP? Yes No

(If yes, the R.S. or P.E. shall certify that the OSSF design will comply with all provisions of the proposed WPAP. A Permit to Construct will not be issued for the proposed OSSF until the proposed WPAP has been approved by the appropriate regional office.)

Is the property located over the Edwards Contributing Zone? Yes No

Is there an existing TCEQ approval CZP for the property? Yes No

(If yes, the P.E. or R.S. shall certify that the OSSF design complies with all provisions of the existing CZP.)

If there is no existing CZP, does the proposed development activity require a TCEQ approved CZP? Yes No

(If yes, the R.S. or P.E. shall certify that the OSSF design will comply with all provisions of the proposed CZP. A Permit to Construct will not be issued for the proposed OSSF until the CZP has been approved by the appropriate regional office.)

Is this property within an incorporated city? Yes No

If yes, indicate the city: _____

By signing this application, I certify that:

- The information provided above is true and correct to the best of my knowledge.
- I affirmatively consent to the online posting/public release of my e-mail address associated with this permit application, as applicable.



5/22/20

Signature of Designer

Date

Page 2 of 2



2/CS

AFFIDAVIT TO THE PUBLIC

THE COUNTY OF COMAL
STATE OF TEXAS

CERTIFICATION OF OSSF REQUIRING MAINTENANCE

According to Texas Commission on Environmental Quality Rules for On-Site Sewage Facilities (OSSF's), this document is filed in the Deed Records of Comal County, Texas.

The Texas Health and Safety Code, Chapter 366 authorizes the Texas Commission on Environmental Quality (commission) to regulate on-site sewage facilities (OSSFs). Additionally, the Texas Water Code (TWC), § 5.012 and § 5.013, gives the commission primary responsibility for implementing the laws of the State of Texas relating to water and adopting rules necessary to carry out its powers and duties under the TWC. The commission, under the authority of the TWC and the Texas Health and Safety code, requires owner's to provide notice to the public that certain types of OSSFs are located on specific pieces of property. To achieve this notice, the commission requires a recorded affidavit. Additionally, the owner must provide proof of the recording to the OSSF permitting authority. This recorded affidavit is not a representation or warranty by the commission of the suitability of this OSSF, nor does it constitute any guarantee by the commission that the appropriate OSSF was installed.

An OSSF requiring a maintenance contract, according to 30 Texas Administrative Code §285.91(12) will be installed on the property described as (insert legal description):

Lot 1907, Canyon Lake Hills Unit No. 4

RECEIVED

The property is owned by (insert owner's full name): Chris R. Feller

JUL 01 2019

This OSSF must be covered by a continuous maintenance contract for the first two years. After the initial two-year service policy, the owner of an aerobic treatment system for a single family residence shall either obtain a maintenance contract within 30 days or maintain the system personally.

Upon sale or transfer of the above-described property, the permit for the OSSF shall be transferred to the buyer or new owner. A copy of the planning materials for the OSSF can be obtained from the Comal County Engineering Office.

WITNESS BY HAND(S) ON THIS 24th DAY OF June 2019

[Signature]
Owner(s) signature(s)

SWORN TO AND SUBSCRIBED BEFORE ME ON THIS 24th DAY OF June 2019

[Signature]
Notary Public, State of Texas

Notary's Printed Name: Ashlee Sullivan
My Commission Expires: 07-19-2022





This page has been added to comply with the statutory requirement that the clerk shall stamp the recording information at the bottom of the last page.

This page becomes part of the document identified by the file clerk number affixed on preceding pages.

RECEIVED

JUL 01 2019

COUNTY ENGINEER

Filed and Recorded
Official Public Records
Bobbie Koepf, County Clerk
Comal County, Texas
06/25/2019 09:31:42 AM
TERRI 2 Page(s)
201906021688



Bobbie Koepf

WASTEWATER TREATMENT FACILITY MONITORING AGREEMENT

Regulatory Authority _____
Block Creek Aerobic Services, LLC
444 A Old Hwy #9
Comfort, TX 78013
Off. (830) 995-3189
Fax. (830) 995-4051

Permit/License Number _____
Customer Chris R. Feller
Site Address 974 Paradise Drive
City Canyon Lake Zip 78133
Mailing Address 2546 Lakeview Drive, Canyon Lake, TX 78133
County Comal Map # _____
Phone 830.832.0264
Email chrisrfler@icloud.com

I. General: This Work for Hire Agreement (hereinafter referred to as "Agreement") is entered into by and between Chris R. Feller (hereinafter referred to as "Customer") and Block Creek Aerobic Services, LLC. By this agreement, Block Creek Aerobic Services, LLC and its employees (hereinafter inclusively referred to as "Contractor") agree to render services at the site address stated above, as described herein, and the Customer agrees to fulfill his/hcr/their responsibilities, as described herein.

II. Effective Date: This Agreement commences on Issue date of License to Operate and ends on 2 yrs from License to Operate for a total of two (2) years (initial agreement) or one (1) year (thereafter). If this is an initial agreement (new installation), the Customer shall notify the Contractor within two (2) business days of the system's first use to establish the date of commencement. If no notification is received by Contractor within ninety (90) days after completion of installation or where county authority mandates, the date of commencement will be the date the "License to operate" (Notice of Approval) was issued by the permitting authority. This agreement may or may not commence at the same time as any warranty period of installed equipment, but in no case shall it extend the specified warranty.

III. Termination of Agreement: This Agreement may be terminated by either party for any reason, including for example, substantial failure of either party to perform in accordance with the terms of this Agreement, without fault or liability of the terminating party. The terminating party must provide written notice to the non-terminating party thirty (30) days prior to the termination of this Agreement. If this Agreement is terminated, Contractor will be paid at the rate of \$75.00 per hour for any work performed and for which compensation has not been received. After the deduction of all outstanding charges, any remaining monies from prepayment for services will be refunded to customer within thirty (30) days of termination of this Agreement. Either party terminating this Agreement for any reason, including non-renewal, shall notify in writing the equipment manufacturer and the appropriate regulatory agency a minimum of thirty (30) days prior to the date of such termination. Nonpayment of any kind shall be considered breach of contract and a termination of contract.

RECEIVED
OCT 01 2019

COUNTY ENGINEER

IV. Services:
Contractor will:
a. Inspect and perform routine upkeep on the On-Site Sewage Facility (hereinafter referred to as OSSF) as recommended by the treatment system manufacturer, and required by state and/or local regulation, for a total of three visits to site per year. The list of items checked at each visit shall be the: control panel, Electrical circuits, timer, Aeration including compressor and diffusers, CFM/PSI measured, lids safety pans, pump, compressor, sludge levels, and anything else required as per the manufacturer.
b. Provide a written record of visits to the site by means of an inspection tag attached to or contained in the control panel.
c. Repair or replace, if Contractor has the necessary materials at site, any component of the OSSF found to be failing or inoperative during the course of a routine monitoring visit. If such services are not covered by warranty, and the service(s) cost less than \$100.00, Customer hereby authorizes Contractor to perform the service(s) and bill Customer for said service(s). When service costs are greater than \$100.00, or if contractor does not have the necessary supplies at the site, Contractor will notify Customer of the required service(s) and the associated cost(s). Customer must notify Contractor of arrangements to affect repair of system with in two (2) business days after said notification.
d. Provide sample collection and laboratory testing of TSS and BOD on a yearly basis (commercial systems only).
e. Forward copies of this Agreement and all reports to the regulatory agency and the Customer.
f. Visit site in response to Customer's request for unscheduled services within forty-eight (48) hours of the date of notification (weekends and holidays excluded) of said request. Unless otherwise covered by warranty, costs for such unscheduled responses will be billed to Customer.

Customer's Initials



BS

Contractor's Initials

V. Disinfection:

Not required; required. The responsibility to maintain the disinfection device(s) and provide any necessary chemicals is that of the Customer.

VI. Electronic Monitoring:

Electronic Monitoring is not included in this Agreement.

VII. Performance of Agreement:

Commencement of performance by Contractor under this Agreement is contingent on the following conditions:

a. If this is an initial Agreement (new installation):

1. Contractor's receipt of a fully executed original copy or facsimile of this agreement and all documentation requested by Contractor.

If the above conditions are not met, Contractor is not obligated to perform any portion of this Agreement.

VIII. Customer's Responsibilities:

The customer is responsible for each and all of the following:

a. Provide all necessary yard or lawn maintenance and removal of all obstacles, including but not limited to dogs and other animals, vehicles, trees, brush, trash, or debris, as needed to allow the OSSF to function properly, and to allow Contractor safe and easy access to all parts of the OSSF.

b. Protect equipment from physical damage including but not limited to that damage caused by insects.

c. Maintain a current license to operate, and abide by the conditions and limitations of that license, and all requirements for and OSSF from the State and/or local regulatory agency, whichever requirements are more stringent, as well as the proprietary system's manufacturer recommendations.

d. Notify Contactor immediately of any and all alarms, and/or any and all problems with, including failure of, the OSSF.

e. Provide, upon request by Contractor, water usage records for the OSSF so that the Contractor can perform a proper evaluation of the performance of the OSSF.

f. Allow for samples at both the inlet and outlet of the OSSF to be obtained by Contractor for the purpose of evaluating the OSSF's performance. If these samples are taken to a laboratory for testing, with the exception of the service provided under Section IV (d) above, Customer agrees to pay Contractor for the sample collection and transportation, portal to portal, at a rate of \$35.00 per hour, plus the associated fees for laboratory testing.

g. Prevent the backwash or flushing of water treatment or conditioning equipment from entering the OSSF.

h. Prevent the condensation from air conditioning or refrigeration units, or the drains of icemakers, from hydraulically overloading the aerobic treatment units. Drain lines may discharge into the surface application pump tank if approved by system designer.

i. Provide for pumping and cleaning of tanks and treatment units, when and as recommended by Contactor, at Customer's expense.

j. Maintain site drainage to prevent adverse effects on the OSSF.

k. Pay promptly and fully, all Contractor's fees, bills, or invoices as described herein.

RECEIVED
JUL 01 2019

COUNTY...

IX. Access by Contractor:

Contractor is hereby granted an easement to the OSSF for the purpose of performing services described herein. Contractor may enter the property during Contractor's normal business hours and/or other reasonable hours without prior notice to Customer to perform the Services and/or repairs described herein. Contractor shall have access to the OSSF electrical and physical components. Tanks and treatment units shall be accessible by means of man ways, or risers and removable covers, for the purpose of evaluation as required by State and/or local rules and the proprietary system manufacturer. It is Customers responsibility to keep lids exposed and accessible at all times.

X. Limit of Liability:

Contractor shall not be held liable for any incidental, consequential, or special damages, or for economic loss due to expense, or for loss of profits or income, or loss of use to Customer, whether in contract tort or any other theory. In no event shall Contractor be liable in an amount exceeding the total Fee for Services amount paid by Customer under this Agreement.

XI. Indemnification:

Customer (whether one or more) shall and does hereby agree to indemnify, hold harmless and defend Contractor and each of its successors, assigns, heirs, legal representatives, devisees, employees, agents and/or counsel (collectively "Indemnitees") from and against any and all liabilities, claims, damages, losses, liens, causes of action, suits, fines, judgments and other expenses (including, but not limited to, attorneys' fees and expenses and costs of investigation), of any kind, nature or description, (hereinafter collectively referred to as "Liabilities") arising out of, caused by, or resulting, in whole or in part, from this Agreement.

[Handwritten signature]

Customer's Initials

BS



Contractor's Initials

THIS INDEMNIFICATION APPLIES EVEN IF SUCH LIABILITIES ARE CAUSED BY THE CONCURRENT OR CONTRIBUTORY NEGLIGENCE OR BY THE STRICT LIABILITY OF ANY INDEMNITEE.

RECEIVED

JUL 01 2019

COUNTY ENGINEER

Customer hereby waives its right of recourse as to any Indemnitee when Indemnification applies, and Customer shall require its insurer(s) to waive its/their right of subrogation to the extent such action is required to render such waiver of subrogation effective. Customer shall be subrogated to Indemnitees with respect to all rights Indemnitees may have against third parties with respect to matters as to which Customer provides indemnity and/or defense to Indemnitees. No Indemnification is provided to Indemnitees when the liability or loss results from (1) the sole responsibility of such Indemnitee; or, (2) the willful misconduct of such Indemnitee. Upon irrevocable acceptance of this Indemnification obligation, Customer, in its sole discretion, shall select and pay counsel to defend Indemnitees of and from any action that is subject to this Indemnification provision. Indemnitees hereby covenant not to compromise or settle any claim or cause of action for which Customer has provided Indemnification without the consent of Customer.

XII. Severability:

If any provision of the "Proposal and Contract" shall be held to be invalid or unenforceable for any reason, the remaining provisions shall continue to be valid and enforceable. If a court finds that any provision of the "Agreement" is invalid or unenforceable, but that by limiting such provision it would become valid and enforceable, then such provision shall be deemed to be written, construed, and enforced as so limited.

XIII. Fee for Services:

The Fee for Services does not include any fees for equipment, material, labor necessary for non-warranty repairs, unscheduled inspections, or Customer requested visits to the site.

XIV. Payment:

Full payment is due upon execution of this Agreement (Required of new Customer). For any other service(s) or repair(s) provided by Contractor the Customer shall pay the invoice(s) for said service(s) or repair(s) within thirty (30) days of the invoice date. The Contractor shall mail all invoices on the date of invoice. All payments not received within thirty (30) days from the invoice date will be subject to a \$29.00 late penalty and a 1.5% per month carrying charge, as well as any reasonable attorney's fees, and all collection and court costs incurred by Contractor in collection of unpaid debt(s). Contractor may terminate contract at any time for nonpayment for services. Any check returned to Contractor for any reason will be assessed a \$30.00 return check fee.

XV. Application or Transfer of payment:

The fees paid for this agreement may be transferred to subsequent property owner(s); however, this Agreement is not transferable. Customer shall advise the subsequent property owner(s) of the State requirement that they sign a replacement agreement authorizing Contractor to perform the herein described Services, and accepting Customer's Responsibilities. This replacement Agreement must be signed and received in Contractor's offices within ten (10) business days of date of transfer of property ownership. Contractor will apply all funds received from Customer first to any past due obligation arising from this Agreement including late fees or penalties, return check fees, and/or charges for services or repairs not paid within thirty (30) days of invoice date. Any remaining monies shall be applied to the funding of the replacement Agreement. The consumption of funds in this manner may cause a reduction in the termination date of effective coverage per this Agreement. See Section IV.

XVI. Entire Agreement:

This agreement contains the entire Agreement of the parties, and there are no other conditions in any other agreement, oral or written.

Brent S. Sidman

Block Creek Aerobic Services, LLC,
Contractor
MC# 000042 and MC#000002

[Handwritten Signature]

Customer Signature

6/24/19
Date

[Handwritten Initials]

Customer's Initials

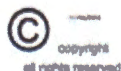

BS

Contractor's Initials

OSSF SOIL EVALUATION REPORT INFORMATION

REVISED

8:25 am, May 26, 2020

Date: 5/22/20

Applicant Information:

Name: Chris R. Feller

Address: 2546 Lakeview Drive

City, State & Zip Code: Canyon Lake, TX 78133

Phone: 830.832.0264

Email: chrisrfler@icloud.com

Site Evaluator Information:

Name: Douglas R. Dowlearn

Company: D.A.D. Services, Inc.

Address: 703 Oak Drive

City, State & Zip: Blanco, TX 78606

Phone: (210)240-2101 Fax: (866)260-7687

Email: txseptic@gmail.com

Property Location:

Lot: 1907 Unit: 4 Subdivision: Canyon Lake Hills

Street/Road Address: 974 Paradise Drive

City: Canyon Lake Zip: 78133

Additional Info: Comal County/.1722 Acres

Installer Information:

Name:

Company:

Address:

City, State & Zip:

Phone: Fax:

Depth	Texture Class	Soil Texture	Structure (For Class III - blocky, platy or massive)	Drainage (Mottles/Water Table)	Restrictive Horizon	Observation
Soil Boring #1 60"	III	0-12" Clay Loam 12"+ Limestone	Blocky	<30% Gravel	12"+ Limestone	None
Soil Boring #2 60"		Same as above				

DESIGN SPECIFICATIONS

Application Rate (RA): 0.2

OSSF is designed for: 3 BR (1400 Sq. Ft.)

240 Gallons per day required

An aerobic treatment/drip disposal system is to be utilized based on the site evaluation.

1200 sq. ft. disposal area required

600 gallon/day aerobic tank required

Calculations: Absorption Area: $Q/RA = 240/0.2 = 1200$ Sq. Ft.

FEATURES OF SITE AREA

Presence of 100-year flood zone: NO

Existing or proposed water well in nearby area: NO

Presence of adjacent ponds, streams, water impoundments: NO

Presence of upper water shed: NO

Organized sewage service available to lot: NO

I certify that the findings of this report are based on my field observations and are accurate to the best of my ability. The site evaluation and OSSF design are subject to approval by the TCEQ or the local authorized agent. The planning materials and the OSSF design should not be considered final until a permit to construct has been issued.

Site Evaluator:

NAME: Douglas R. Dowlearn, R.S.

License No. OS9902 - Exp. 6/30/2020

TDH: #2432 - Exp. 2/28/2021

Signature:



REVISED

9:11 am, May 26, 2020

D.A.D SERVICES, INC.
DOUG DOWLEARN
703 OAK DRIVE, BLANCO, TX 78606
Designed for: Chris R. Feller

The installation site is on Lot 1907 of the Canyon Lake Hills, Unit 4 Subdivision in Comal County, TX. The proposed OSSF will treat the wastewater from a 3 Bedroom (1400 sq. ft.) residence. The proposed method of wastewater treatment is aerobic treatment with drip irrigation. This method was chosen because of unsuitable soil conditions.

PROPOSED SYSTEM:

A 4" PVC pipe will discharge from the residence to a pre-treatment tank, which flows into a 600 gpd aerobic treatment plant. The pump is activated by a time controller allowing the distribution 8 times per day with a 7 minute run time with float switches set to pump 240 gallons per day. A high level audible and visual alarm will activate should the pump fail. Distribution from the pump is through a self flushing 100 mesh spin filter then through a 1" SCH-40 manifold to an 888 L.F. drip tubing field, with drip lines set approximately two feet apart with 0.61 emitters set every two feet, as per the attached schematic. A hose bib will be installed in the pump tank on the supply manifold to the drip field. A 1" SCH 40 return line with a pressure gauge is installed to periodically flush the system and will maintain pressure between 20 to 40 psi. Solids caught in the spin filter are flushed each cycle back to the pre-treatment tank. Vacuum breakers installed at the highest point on each manifold will prevent siphoning of effluent from higher to lower parts of the field. The placement of the drip tubing will be on soil that has been roughed up and 2" of Class II added; the tubing will be covered with 6" of Class II soil.

DESIGN SPECIFICATIONS:

Daily Waste Flow: 240 gpd
Application rate: 0.2
Application area required: $240/.2 = 1200$ ft. sq.
Application area utilized: 1776 sq. ft.
Pump tank reserve capacity: 120 gal minimum



Douglas R. Dowlearn

5/22/20

SYSTEM COMPONENTS:

SCH 40 PVC sewer line
1" purple PVC supply line
600 gpd aerobic treatment plant with manual or timed controls
Liquid chlorinator
Pump tank
Pretreatment tank

REVISED

9:11 am, May 26, 2020

LANDSCAPING:

The native vegetation in the distribution area should consist of low level shrubs, plains grass, bluestem or bermuda. The entire area of the drip disposal must be covered with a ground cover such as grass seed or sod prior to the final inspection. . The drip disposal tubing will be laid on top of roughed up soil covered with 2" of Class II soil; the tubing will then be covered with 6" of Class II soil. In the event the natural cover is disturbed, a suitable ground cover must be installed on all excavated areas.

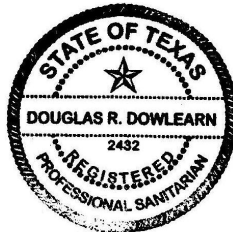

Douglas R. Dowlearn

5/22/20

REVISED

8:26 am, May 26, 2020

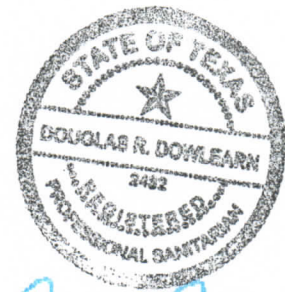

Douglas R. Dowlearn

5/22/20

Chris R. Feller
974 Paradise Drive
Canyon Lake, TX 78133
Lot 1907
Canyon Lake Hills, Unit 4
Comal County

1" = 20'

* = test holes

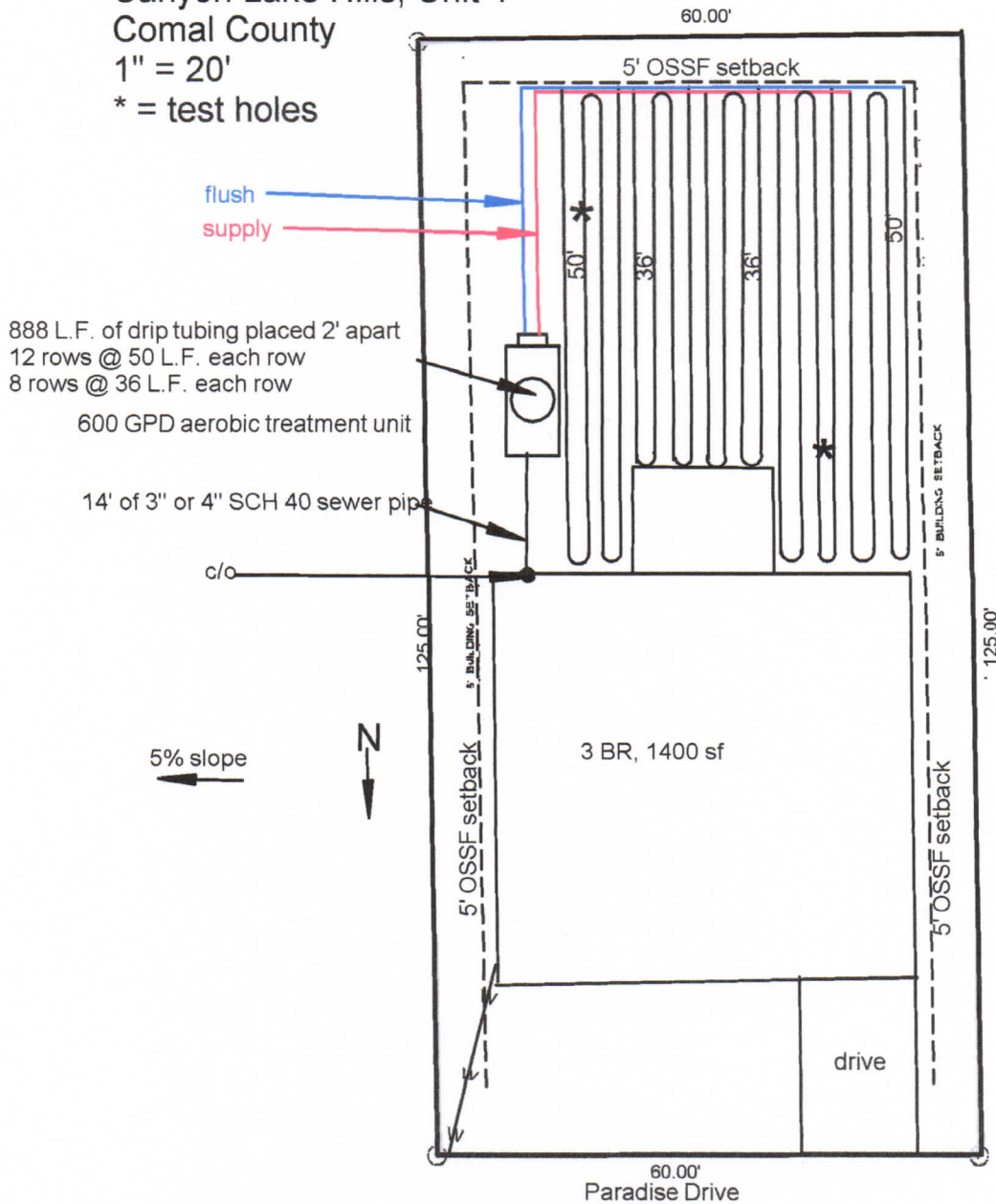

Assembly Details

OSSF



JUL 01 2019

COUNTY ENGINEER

Douglas R. Dowlearn
6/28/19

14.49 Gallons per inch

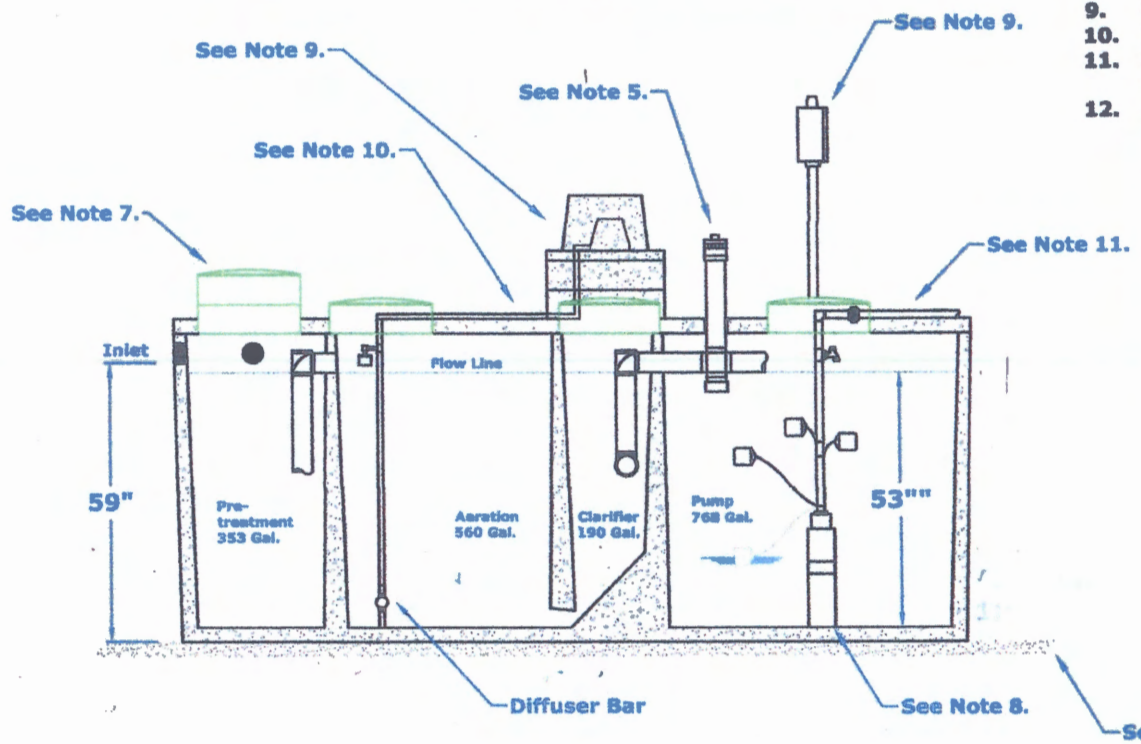

GENERAL NOTES:

1. Plant structure material to be precast concrete and steel.
2. Maximum burial depth is 30" from slab top to grade.
3. Weight = 14,900 lbs.
4. Treatment capacity is 600 GPD. Pump compartment set-up for a 360 GPD Flow Rate (4 bedroom, < 4,000 sq/ft living area). Please specify for additional set-up requirements. BOD Loading = 1.62 lbs. per day.
5. Standard tablet chlorinator or Optional Liquid chlorinator. NSF approved chlorinators (tablet & liquid) available.
6. Bio-Robix B-550 Control Center w/ Timer for night spray application. Optional Micro Dose (min/sec) timer available for drip applications. Electrical Requirement to be 115 Volts, 60 Hz, Single Phase, 30 AMP, Grounded Receptacle.
7. 20" Ø access riser w/ lid (Typical 4). Optional extension risers available.
8. 20 GPM 1/2 HP, high head effluent pump.
9. HIBLOW Air Compressor w/ concrete housing.
10. 1/2" Sch. 40 PVC Air Line (Max. 50 Lft from Plant).
11. 1" Sch. 40 PVC pipe to distribution system provided by contractor.
12. 4" min. compacted sand or gravel pad by Contractor

41"-53" - Reserve - 174 Gal
41" - Alarm
13"-41" - Working Level - 405 Gal
10"-13" - On/Off Tether - 44 Gal
0"-10" - Sump - 145 Gal

DIMENSIONS:
 Outside Height: 67"
 Outside Width: 63"
 Outside Length: 164"

MINIMUM EXCAVATION DIMENSIONS:
 Width: 76"
 Length: 176"

NuWater B-550 (600 GPD)
Aerobic Treatment Plant (Assembled)

Model: B-550-PC-400PT

March, 2012 - Rev 1
 By: A.S.

Scale:
 * All Dimensions subject to allowable specification tolerances.

Dwg. #: ADV-B550-3



Advantage Wastewater Solutions llc.
 444 A Old Hwy No 9
 Comfort, TX 78013
 830-995-3189
 fax 830-995-4051

APPLICATION FOR PERMIT FOR AUTHORIZATION TO CONSTRUCT AN ON-SITE SEWAGE TREATMENT SYSTEM AND LICENSE TO OPERATE

VOID

Planning Materials & Site Evaluation as Required Completed By Douglas R. Dowlearn

System Description Aerobic Treatment with Drip Disposal

Size of Septic System Required Based on Planning Materials & Soil Evaluation

Tank Size(s) (Gallons) 600 gpd Absorption/Application Area (Sq Ft) 2400 Required

Gallons Per Day (As Per TCEQ Table III) 240

(Sites generating more than 5000 gallons per day are required to obtain a permit through TCEQ.)

Is the property located over the Edwards Recharge Zone? Yes No

(If yes, the planning materials must be completed by a Registered Sanitarian (R.S.) or Professional Engineer (P.E.))

Is there an existing TCEQ approved WPAP for the property? No

(If yes, the R.S. or P.E. shall certify that the OSSF design complies with all provisions of the existing WPAP.)

VOID

If there is no existing WPAP, does the proposed development activity require a TCEQ approved WPAP? Yes No

(If yes, the R.S. or P.E. shall certify that the OSSF design will comply with all provisions of the proposed WPAP. A Permit to Construct will not be issued for the proposed OSSF until the proposed WPAP has been approved by the appropriate regional office.)

Is the property located over the Edwards Contributing Zone? Yes No

Is there an existing TCEQ approval CZP for the property? Yes No

(If yes, the P.E. or R.S. shall certify that the OSSF design complies with all provisions of the existing CZP.)

If there is no existing CZP, does the proposed development activity require a TCEQ approved CZP? Yes No

(If yes, the R.S. or P.E. shall certify that the OSSF design will comply with all provisions of the proposed CZP. A Permit to Construct will not be issued for the proposed OSSF until the CZP has been approved by the appropriate regional office.)

Is this property within an incorporated city? Yes No

If yes, indicate the city: _____

RECEIVED

JUL 01 2019

COUNTY ENGINEER

VOID

By signing this application, I certify that:

- The information provided above is true and correct to the best of my knowledge.
- I affirmatively consent to the online posting/public release of my e-mail address associated with this permit application, as applicable.

Signature of Designer

Douglas R. Dowlearn

6/13/19

Date

REVISED

8:26 am, May 26, 2020

VOID

D.A. DOWLEARN INC.
DOUG DOWLEARN

703 OAK DRIVE, BLANCO, TX 78606

Designed for: Chris R. Feller

The installation site is on Lot 1907 of the Canyon Lake Hills, Unit 4 Subdivision in Comal County, TX. The proposed OSSF will treat the wastewater from a 3 Bedroom (1400 sq. ft.) residence. The proposed method of wastewater treatment is aerobic treatment with drip irrigation. This method was chosen because of unsuitable soil conditions.

PROPOSED SYSTEM:

A 4" PVC pipe will discharge from the residence to a pre-treatment tank, which flows into a 600 gpd aerobic treatment plant. The pump is activated by a time controller allowing the distribution 8 times per day with a 7 minute run time with float switches set to pump 240 gallons per day. A high level audible and visual alarm will activate should the pump fail. Flow from the pump is through a self flushing 100 mesh spin filter then through a 1" SCH-40 manifold to an 888 L.F. drip tubing field, with drip lines set approximately two feet apart with 0.61 emitters set every two feet, as per the attached schematic. A hose bib will be installed in the pump tank on the supply manifold to the drip field. A 1" SCH 40 return line with a pressure gauge is installed to periodically flush the system and will maintain pressure between 20 to 40 psi. Solids caught in the spin filter are flushed each cycle back to the pre-treatment tank. Vacuum breakers installed at the highest point on each manifold will prevent siphoning of effluent from higher to lower parts of the field. The placement of the drip tubing will be on soil that has been roughed up and 2" of Class II added; the tubing will be covered with 6" of Class II soil.

DESIGN SPECIFICATIONS:

Daily Waste Flow: 240 gpd
Application rate: 0.1
Application area required: $240/.2 = 1200$ ft. sq.
Application area utilized: 1776 sq. ft.
Pump tank reserve capacity: 120 gal minimum



Douglas R. Dowlearn
5/22/20

SYSTEM COMPONENTS:

SCH 40 PVC sewer line
1" purple PVC supply line
600 gpd aerobic treatment plant with manual or timed controls
Liquid chlorinator
Pump tank
Pretreatment tank

VOID

REVISED

8:26 am, May 26, 2020

VOID

LANDSCAPING:

The native vegetation in the distribution area should consist of low level shrubs, plains grass, bluestem or bermuda. The entire area of the drip disposal must be covered with a ground cover such as grass seed or sod prior to the final inspection. The drip disposal tubing will be laid on top of roughed up soil covered with 2" of Class II soil; the tubing will then be covered with 6" of Class II soil. In the event the natural cover is disturbed, a suitable ground cover must be installed on all excavated areas.

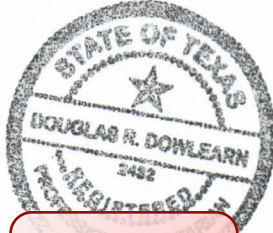

VOID

Douglas R. Dowlearn, P.E.

5/22/20

VOID

OSSF SOIL EVALUATION REPORT INFORMATION

VOID

Date: 6/19/19
Applicant Information:
Name: Chris R. Feller
Address: 2546 Lakeview Drive
City, State & Zip Code: Canyon Lake, TX 78133
Phone: 830.832.0264
Email: chrisrfler@icloud.com

Site Evaluator Information:
Name: Douglas R. Dowlearn
Company: D.A.D. Services, Inc.
Address: 703 Oak Drive
City, State & Zip: Blanco, TX 78606
Phone: (210)240-2101 **Fax:** (866)260-7687
Email: txseptic@gmail.com

Property Location:
Lot: 1907 **Unit:** 4 **Subdivision:** Canyon Lake Hills
Street/Road Address: 974 Paradise Drive
City: Canyon Lake **Zip:** 78133
Additional Info: Comal County/.1722 Acres

Installer Information:
Name:
Company:
Address:
City, State & Zip:
Phone: **Fax:**

Depth	Texture Class	Soil Texture	Structure (For Class III - blocky, platy or massive)	Drainage (Mottles/Water Table)	Restrictive Horizon	Observation
Soil Boring #1 60"	IV	0-12" Clay 12"+ Limestone		<30% Gravel	12"+ Limestone	None
Soil Boring #2 60"		Same as above	VOID			

DESIGN SPECIFICATIONS

Application Rate (RA): 0.1
OSSF is designed for: 3 BR (1400 Sq. Ft.)
240 Gallons per day required
An aerobic treatment/drip disposal system is to be utilized based on the site evaluation.
2400 sq. ft. disposal area required
600 gallon/day aerobic tank required
Calculations: Absorption Area: $Q/RA = 240/0.1 = 2400$ Sq. Ft.

RECEIVED
JUL 01 2019
COUNTY ENGINEER

FEATURES OF SITE AREA

Presence of 100-year flood zone: NO
Existing or proposed water well in nearby area: NO
Presence of adjacent ponds, streams, water impoundments: NO
Presence of upper water shed: NO
Organized sewage service available to lot: NO

I certify that the findings of this report are based on my field observations and are accurate to the best of my ability. The site evaluation and OSSF design are subject to approval by the TCEQ or the local authorized agent. The planning materials and the OSSF design should not be considered final until a permit to construct has been issued.

Site Evaluator:
NAME: Douglas R. Dowlearn, R.S.

License No. OS9902 - Exp. 6/30/2020
TDH: #2432 - Exp. 2/28/2021

Signature: 

VOID

VOID

D.A.E. SERVICES, INC.
DOUG DOWLEARN
703 OAK DRIVE, BLANCO, TX 78606
Designed for: Chris R. Feller

The installation site is on Lot 1907 of the Canyon Lake Hills, Unit 4 Subdivision in Comal County, TX. The proposed OSSF will treat the wastewater from a 3 Bedroom (1400 sq. ft.) residence. The proposed method of wastewater treatment is aerobic treatment with drip irrigation. This method was chosen because of unsuitable soil conditions.

PROPOSED SYSTEM:

A 4" PVC pipe will discharge from the residence to a pre-treatment tank, which flows into a 600 gpd aerobic treatment plant. The pump is activated by a time controller allowing the distribution 8 times per day with a 4 minute run time with float switches set to pump 240 gallons per day. A high level audible and visual alarm will activate should the pump fail. Distribution from the pump is through a self flushing 100 mesh spin filter. Distribution is through a 1" SCH-40 manifold to a 1200 L.F. drip tubing field, with drip lines spaced evenly two feet apart with 0.61 emitters set every two feet, as per the attached schematic. A pressure gauge and hose bib installed in the pump tank on the manifold to the field will maintain pressure at 30 to 50 psi. A 1" SCH-40 return line is installed to periodically flush the system by cycling a 1" ball valve. Solids caught in the spin filter are flushed each cycle back to the pump tank. Vacuum breakers installed at the highest point on each manifold will prevent siphoning of effluent from higher to lower parts of the field. The placement of the drip tubing will be on soil that has been roughed up and 2" of Class II added; the tubing will be covered with 6" of Class II soil.

VOID

RECEIVED

JUL 01 2019

DESIGN SPECIFICATIONS:

Daily Waste Flow: 240 gpd
Application rate: 0.1
Application area required: $240/.1 = 2400$ ft. sq.
Application area utilized: 2400 sq. ft.
Pump tank reserve capacity: 120 gal minimum



Douglas R. Dowlearn
6/19/19

SYSTEM COMPONENTS:

SCH 40 PVC sewer line
1" purple PVC supply line
600 gpd aerobic treatment plant with manual or timed controls
Liquid chlorinator
Pump tank
Pretreatment tank

VOID

VOID

LANDSCAPING:

The native vegetation in the distribution area should consist of low level shrubs, plains grass, bluestem or bermuda. The entire area of the drip disposal must be covered with a ground cover such as grass seed or sod prior to the final inspection. . The drip disposal tubing will be laid on top of roughed up soil covered with 2" of Class II soil; the tubing will then be covered with 6" of Class II soil. In the event the natural cover is disturbed, a suitable ground cover must be installed on all excavated areas.



Douglas R. Dowlearn

6/19/19

VOID

RECEIVED

JUL 01 2019

COUNTY ENGINEER

VOID

VOID

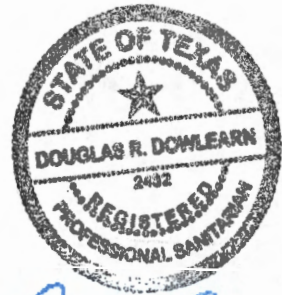

Douglas R. Dowlearn
6/19/19

Chris R. Feller
974 Paradise Drive
Canyon Lake, TX 78133
Lot 1907
Canyon Lake Hills, Unit 4
Comal County
1" = 20'

* = test holes

VOID

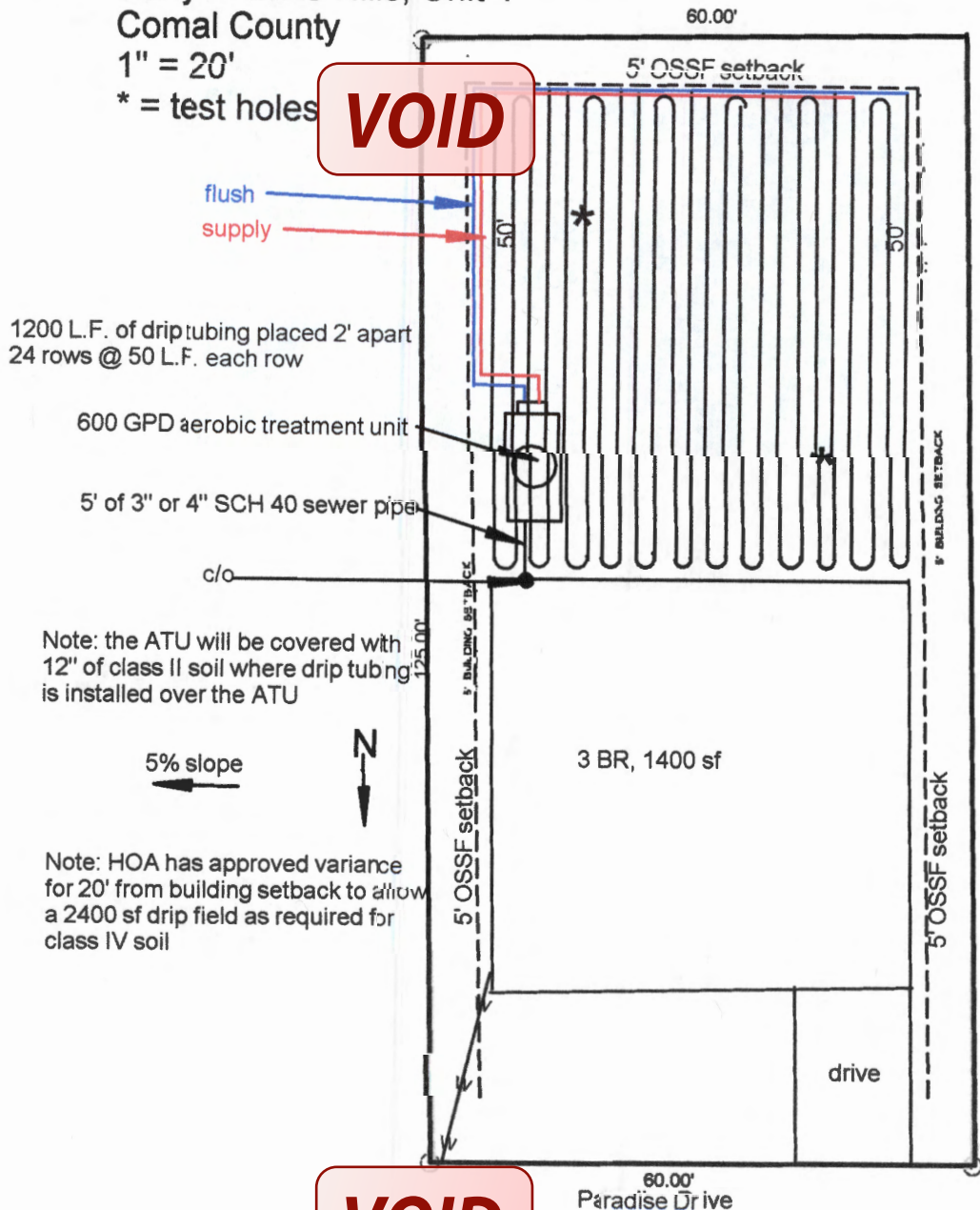

1200 L.F. of drip tubing placed 2' apart
24 rows @ 50 L.F. each row

600 GPD aerobic treatment unit

5' of 3" or 4" SCH 40 sewer pipe

c/o

Note: the ATU will be covered with
12" of class II soil where drip tubing
is installed over the ATU

5% slope



Note: HOA has approved variance
for 20' from building setback to allow
a 2400 sf drip field as required for
class IV soil

60.00'
Paradise Drive

VOID

RECEIVED

JUL 01 2019

COUNTY ENGINEER

1751
CV DWB JCS



General Warranty Deed

Date: September 8, 2018

Grantor: Rudy Family Lake House, LLC, a Texas limited liability company

Grantor's Mailing Address:

513 Laddingford Ln League City, TX 77573

Grantee: Chris R. Feller

Grantee's Mailing Address:

2546 Lakeview Dr Bryan Lake Tx 28133

RECEIVED
01 2019
COUNTY ENGINEER

Consideration:

Cash and other good and valuable consideration, the receipt and sufficiency of which are hereby acknowledged.

Property (Including any Improvements):

Lots 1905 and 1907, Canyon Lake Hills Unit No. 4, a subdivision in Comal County, Texas, according to the plat of said subdivision recorded in Volume 2, Page 37, Deed and Plat Records of Comal County, Texas

Reservations from Conveyance: None

Exceptions to Conveyance and Warranty:

Validly existing easements, rights-of-way, and prescriptive rights, whether of record or not; all presently recorded and validly existing instruments, other than conveyances of the surface fee estate, that affect the Property; and taxes for 2018, which Grantee assumes and agrees to pay, but not subsequent assessments for that and prior years due to change in land usage, ownership, or both, the payment of which Grantor assumes.

Grantor, for the Consideration and subject to the Reservations from Conveyance and the Exceptions to Conveyance and Warranty, grants, sells, and conveys to Grantee the Property, together with all and singular the rights and appurtenances thereto in any way belonging, to have and to hold it to Grantee and Grantee's heirs, successors, and assigns forever. Grantor binds Grantor and Grantor's heirs and successors to warrant and forever defend all and singular the Property to Grantee and Grantee's heirs,

successors, and assigns against every person whomsoever lawfully claiming or to claim the same or any part thereof, except as to the Reservations from Conveyance and the Exceptions to Conveyance and Warranty.

When the context requires, singular nouns and pronouns include the plural.

Robert P. Rudy

Robert P. Rudy, Registered Agent
Rudy Family Lake House, LLC
a Texas Limited Liability Company

STATE OF TEXAS)

COUNTY OF)

This instrument was acknowledged before me on September 18th, 2018, by Robert P. Rudy, Registered Agent, Rudy Family Lake House, LLC, a Texas Limited Liability Company

Clara De La Roche

Notary Public, State of Texas

PREPARED IN THE OFFICE OF:

DWAIN W BLASCHKE
P.O. Box 1744
Canyon Lake, TX 78133
Tel: (830) 964-4442
Fax: (830) 964-4426

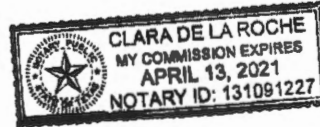

Filed and Recorded
Official Public Records
Bobbie Koepf, County Clerk
Comal County, Texas
09/21/2018 09:04:10 AM
TERRI 2 Page(s)
201806037284



Bobbie Koepf

OSSF DEVELOPMENT APPLICATION CHECKLIST

Staff will complete shaded

Items Date Received	Initials

Permit Number

Instructions:

Place a check mark next to all items that apply. For items that do not apply, place "N/A". This OSSF Development Application Checklist must accompany the completed application.

OSSF Permit

Completed Application for Permit for Authorization to Construct an On-Site Sewage Facility and License to Operate

Site/Soil Evaluation Completed by a Certified Site Evaluator or a Professional Engineer

Planning Materials of the OSSF as Required by the TCEQ Rules for OSSF Chapter 285. Planning Materials shall consist of a scaled design and all system specifications.

Required Permit Fee

Copy of Recorded Deed

Surface Application/Aerobic Treatment System

Recorded Certification of OSSF Requiring Maintenance/Affidavit to the Public

Signed Maintenance Contract with Effective Date as Issuance of License to Operate

N/A Portion of Proposed OSSF Located in the United States Army Corps of Engineers (USACE) Flowage Easement

N/A USACE Consent for proposed OSSF

RECEIVED
JUL 01 2019
COUNTY ENGINEER

I affirm that I have provided all information required for my OSSF Development Application and that this application constitutes a completed OSSF Development Application.

Signature of Applicant

sign & Date

6/24/19
Date

<input type="checkbox"/> COMPLETE APPLICATION	
Check No. _____	Receipt No. _____

<input type="checkbox"/> INCOMPLETE APPLICATION (Missing Items Circled, Application Refused)

Block Creek Concrete Products, LLC
444 A Old Hwy No 9
Comfort, TX 78013

Phone: (830) 995-3189

Fax: (830) 995-4051

To: Home Owner
974 Paradise Dr
Canyon Lake, TX 78133

Printed: 10/3/2020
Site: 974 Paradise Dr
Canyon Lake, TX 78133

Permit #: **109342**

Customer ID: 7089

Agency: Comal County

Contract Dates: 6/22/2020 - 6/22/2022

County: Comal

Sub:

Scheduled Date: 10/22/2020

Mfg / Brand: Advantage Wastewater LLC - Nu Water

Installed: 9/20/2019

Treatment Type: Aerobic With Chlorine System S/N: 25029

Warranty End: 9/20/2021

Disposal: Drip Emitters

GPS Coordinates - Latitude: 29.88144 Longitude: -98.26497

Service Type: Customer Request

Entered By: Alejandro Gonzalez

Visit Date: 10/3/2020

Method: Grab

Technician: Alejandro Gonzalez

Maint. Provider: Rudy Carson

Aerators: Operational

Filters: Operational

Irrigation Pumps: Operational

Disinfection Device: Operational

Tank Lid / Riser: Secured

Electric Circuits: Operational

Distribution System: Operational

Sprayfield Veg: Operational

Alarm: Operational

Comments

Service Completed

- Technician Secured the Tank Lid and/or Riser prior to leaving location. Owner stated red and yellow light were on. Diagnosed and found that red light was on due to no power to system and when powered on, red light was on due to high water level. Red light is now off. Yellow light is off due to no compressor being installed. Appears that someone may have stolen it before owner moved in new home, will have to come back to replace with new one. - Secured system in the on position with a lock bolt.

Insp ID #: 99761

Provider:

Rudy Carson

Technician:

Alejandro Gonzalez

License #: MP0002036

License #: MT0000996

Expires:

Rudy Carson
Rudy Carson

Alejandro Gonzalez

Block Creek Concrete Products, LLC
444 A Old Hwy No 9
Comfort, TX 78013

Phone: (830) 995-3189
Fax: (830) 995-4051

To: Home Owner
974 Paradise Dr
Canyon Lake, TX 78133

Printed: 10/6/2020
Site: 974 Paradise Dr
Canyon Lake, TX 78133

Permit #: **109342**
Agency: Comal County
County: Comal
Mfg / Brand: Advantage Wastewater LLC - Nu Water
Treatment Type: Aerobic With Chlorine
Disposal: Drip Emitters
Sub:
System S/N: 25029
Customer ID: 7089
Contract Dates: 6/22/2020 - 6/22/2022
Scheduled Date: 10/22/2020
Inspection 1 of 6
Installed: 9/20/2019
Warranty End: 9/20/2021
GPS Coordinates - Latitude: 29.88144 Longitude: -98.26497

Service Type: Scheduled Inspection

This counts as a type of "Scheduled Inspection"
Entered By: Michael Prosisie

Visit Date: 10/6/2020 Time In: 0950am Out: 1035am

Method: Grab

Technician: Michael Prosisie
Maint. Provider: Rudy Carson

Aerators: Operational
Filters: Operational
Irrigation Pumps: Operational
Disinfection Device: Operational

Sludge Levels
For Tank 1: 4"
For Tank 2: 0"
For Tank 3: 0"

CFM: 3.0

Air Filter: Good

Tank Lid / Riser: Secured

Electric Circuits: Operational
Distribution System: Operational
Sprayfield Veg: Operational

Alarm: Operational

PSI Pressure: 3.0

Service Completed

Comments

- Technician Secured the Tank Lid and/or Riser prior to leaving location. Compressor missing- installed new hp60 compressor, air alarm tubing, conduit, and acid washed diffusers. Resecured floats and checked drip filter, did not set psi due to gauge being on return side.

Insp ID #: 99766

Provider: *Rudy Carson*

Technician: **Michael Prosisie**

License #: MP0002036

License #: MP0002291

Expires: 2/28/2023

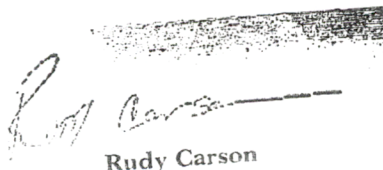
Rudy Carson



Block Creek Concrete Products, LLC
444 A Old Hwy No 9
Comfort, TX 78013

Phone: (830) 995-3189
Fax: (830) 995-4051

To: Cheryl Blum
974 Paradise Dr
Canyon Lake, TX 78133

Printed: 7/1/2021
Site: 974 Paradise Dr
Canyon Lake, TX 78133
(210) 589-6224

Permit #: **109342**

Agency: Comal County
County: Comal Sub:
Mfg / Brand: Advantage Wastewater LLC - Nu Water
Treatment Type: Aerobic With Chlorine System S/N: 25029
Disposal: Drip Emitters

Customer ID: 7089
Contract Dates: 6/22/2020 - 6/22/2022
Scheduled Date: 6/22/2021 Inspection 3 of 6
Installed: 9/20/2019
Warranty End: 9/20/2021
GPS Coordinates - Latitude: 29.88144 Longitude: -98.26497

Service Type: Scheduled Inspection

✓ This counts as a type of "Scheduled Inspection"

Visit Date: 7/1/2021

Time In: 3:20pm

Out: 3:40pm

Entered By: Ronnie W Krampota

Method: Grab

Technician: Ronnie W Krampota

Maint. Provider: Rudy Carson

Aerators: Operational

Filters: Operational

Irrigation Pumps: Operational

Disinfection Device: Operational

Sludge Levels

For Tank 1: 13

For Tank 2: 0"

For Tank 3: 0"

CFM: 3.0

Air Filter: Good

Tank Lid / Riser: Secured

Electric Circuits: Operational

Distribution System: Operational

Sprayfield Veg: Operational

Color: Good

Odor: Good

Alarm: Operational

PSI Pressure: 3.5

Comments

✓ **Service Completed**

- Technician Secured the Tank Lid and/or Riser prior to leaving location. - Secured system in the on position with a lock bolt -
Cleaned drip filter and back washed drip line - Scum in pretreatment is 4" - Cleaned compressor filter

Insp ID #: 110839

Provider: **Rudy Carson**

Technician: Ronnie W Krampota

License #: MP0002036

License #: MT0001175

Expires 7/31/2023

Block Creek Concrete Products, LLC
444 A Old Hwy No 9
Comfort, TX 78013

Phone: (830) 995-3189
Fax: (830) 995-4051

To: Cheryl Blum
974 Paradise Dr
Canyon Lake, TX 78133

Printed: 11/2/2021
Site: 974 Paradise Dr
Canyon Lake, TX 78133
(210) 589-6224

Permit #: **109342** Customer ID: 7089
Agency: Comal County Contract Dates: 6/22/2020 - 6/22/2022
County: Comal Sub: Scheduled Date: 10/22/2021 Inspection 4 of 6
Mfg / Brand: Advantage Wastewater LLC - Nu Water Installed: 9/20/2019
Treatment Type: Aerobic With Chlorine System S/N: 25029 Warranty End: 9/20/2021
Disposal: Drip Emitters GPS Coordinates - Latitude: 29.88144 Longitude: -98.26497

Service Type: Scheduled Inspection

This counts as a type of "Scheduled Inspection"

Visit Date: **11/2/2021** Time In: 1155 Out: 1210

Entered By: Alejandro Gonzalez

Method: **Grab**

Technician: Alejandro Gonzalez

Maint. Provider: Rudy Carson

Aerators: Operational
Filters: Operational
Irrigation Pumps: Operational
Disinfection Device: Operational

Sludge Levels
For Tank 1: 0"
For Tank 2: 20"
For Tank 3: 0"

Air Filter: Good

Tank Lid / Riser: Secured
Insp. Port / Plug: Secured

Electric Circuits: Operational
Distribution System: Operational
Sprayfield Veg: Operational

Color: Bad
Odor: Good

Alarm: Operational

Comments

- Technician Secured the Tank Lid and/or Riser prior to leaving location. - Inspection Port Plug was noted as Secured prior to leaving. - Scum in pretreatment is 12". - Cleaned compressor filter.

Service Completed

Insp ID #: 115251

Provider: **Rudy Carson**

Technician: **Alejandro Gonzalez**

License #: MP0002036

License #: MT0000996

Expires:

Block Creek Aerobic Services, LLC
444 A Old Hwy No 9
Comfort, TX 78013

Phone: (830) 995-3189
Fax: (830) 995-4051

To: Cheryl Blum
974 Paradise Dr
Canyon Lake, TX 78133

Printed: 6/2/2022
Insp ID #: 126257

Main Phone: (210) 589-6224
Work:
Cell Phone:
Alt Cell:

Permit #: **109342**

Agency: Comal County
County: Comal
Mfg / Brand: Advantage Wastewater LLC - Nu Water
Treatment Type: Aerobic With Chlorine System S/N: 25029
Disposal: Drip Emitters

Customer ID: 7089

Contract Dates: 6/22/2020 - 6/22/2022

Scheduled Date: 6/22/2022

Inspection 6 of 6

Installed: 9/20/2019

Warranty End: 9/20/2021

GPS Coordinates: Latitude: 29.88144 Longitude: -98.26497

Service Type: Scheduled Inspection

This counts as a type of "Scheduled Inspection"
Entered By: Trenton L Soldan

Visit Date: 6/2/2022

Time In:

Method: Grab

Technician: Trenton L Soldan

Maint. Provider: Rudy Carson

Aerators: Operational

Filters: Operational

Irrigation Pumps: Operational

Disinfection Device: Operational

Sludge Levels

For Tank 1: 7

For Tank 2: 0'

For Tank 3: 0'

Turbidity: Good

Floats: OP

Timer: OP

Air Filter: Good

Electric Circuits: Operational

Distribution System: Operational

Sprayfield Veg: Operational

Color: Good

Odor: Good

Alarm: Operational

Comments

- Scum in pretreatment is 2' cleaned compressor filter, cleaned drip filter, back flushed lines set to 45 degrees

Service Completed

Site: 974 Paradise Dr, Canyon Lake, TX 78133

Provider:

Rudy Carson

Technician: *Trenton L Soldan*

License Info: MP0002036 Expires:

License Info: MT0002287 Expires: 3/31/2025

Block Creek Aerobic Services, LLC
444 A Old Hwy No 9
Comfort, TX 78013

Phone: (830) 995-3189
Fax: (830) 995-4051

Customer ID: 7089

Contract Period

Start Date: 6/22/2022
End Date: 6/22/2024

To: Cheryl Blum
974 Paradise Dr
Canyon Lake, TX 78133

Main Phone: (210) 589-6224
Cell Phones:

Site: 974 Paradise Dr, Canyon Lake, TX 78133
County: Comal
Installer: Dennis Varhol
Agency: Comal County
Mfg/Brand: Advantage Wastewater LLC-Nu Water-25029

Installed: 9/20/2019
Warranty End: 9/20/2021

Permit #: 109342
Email: cherylblum@yahoo.com
Block Creek Concrete Products, LLC
3 visits per year - one every 4 months
600 gallons per day

This is to Certify that the above RESIDENTIAL sewage system has an INITIAL inspections agreement per Texas Commission on Environmental Quality (TCEQ) standards for on site sewerage facilities as required.

Inspection reports by the above service company will be filed with the authorized agency as required by the TCEQ regulations. A weather proof tag or label will be attached to the controller showing the month that each inspection was made.

Items included on the Inspection Report generally include aerators, filters, irrigation pump, air compressor, disinfection device, chlorine supply, OK System light, spray field vegetation, probe, sprinkler or drip backwash.

We will visit your site within 48 hours of you notifying us of a problem

Certified Inspector: _____

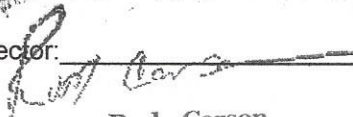

Rudy Carson

Date: _____

8/5/2022

Date Printed: 8/5/2022

Block Creek Aerobic Services, LLC
444 A Old Hwy No 9
Comfort, TX 78013

Phone: (830) 995-3189
Fax: (830) 995-4051

To: Cheryl Blum
974 Paradise Dr
Canyon Lake, TX 78133

Printed: 8/5/2022
Insp ID #: 128507

Main Phone: (210) 589-6224
Work:
Cell Phone:
Alt Cell:

Permit #: **109342**
Agency: Comal County
County: Comal
Mfg / Brand: Advantage Wastewater LLC - Nu Water
Treatment Type: Aerobic With Chlorine System S/N: 25029
Disposal: Drip Emitters

Customer ID: 7089
Contract Dates: 6/22/2020 - 6/22/2022
Scheduled Date

Installed: 9/20/2019
Warranty End: 9/20/2021

GPS Coordinates: Latitude: 29.88144 Longitude: -98.26497

Service Type: Customer Request

Visit Date: 8/5/2022

Time In: 0400pm

Out: 0415pm

Entered By: Michael Prosize

Method: Grab

Technician: Michael Prosize

Maint. Provider: Rudy Carson

Floats: OP
Timer: OP

Tank Lid / Riser: Secured

Comments

- Technician Secured the Tank Lid and/or Riser prior to leaving location. Red light- cleaned pump screen and drip filter. Red light will turn off in about 30 minutes.

Service Completed

Site: 974 Paradise Dr, Canyon Lake, TX 78133

Provider:

Rudy Carson

Technician: *Michael Prosize*

License Info: MP0002036 Expires:

License Info: MP0002291 Expires: 2/28/2023



Block Creek Aerobic Services, LLC
444 A Old Hwy No 9
Comfort, TX 78013

Phone: (830) 995-3189
Fax: (830) 995-4051

To: Cheryl Blum
974 Paradise Dr
Canyon Lake, TX 78133

Printed: 10/5/2022
Insp ID #: 131175
Main Phone: (210) 589-6224
Work:
Cell Phone:
Alt Cell:

Permit #: **109342**

Agency: Comal County
County: Comal
Mfg / Brand: Advantage Wastewater LLC - Nu Water
Treatment Type: Aerobic With Chlorine System S/N: 25029
Disposal: Drip Emitters

Customer ID: 7089
Contract Dates: 6/22/2022 - 6/22/2024
Scheduled Date: 10/22/2022 Inspection 1 of 6
Installed: 9/20/2019
Warranty End: 9/20/2021
GPS Coordinates: Latitude: 29.88144 Longitude: -98.26497

Service Type: Scheduled Inspection

Visit Date: 10/5/2022 Time In: Out: 11:10A

This counts as a type of "Scheduled Inspection"
Entered By: Trenton L Soldan

Method: Grab
Technician: Trenton L Soldan
Maint. Provider: Rudy Carson

**Pumping
Needed**

Aerators: Operational
Filters: Operational
Irrigation Pumps: Operational
Disinfection Device: Operational

Sludge Levels
For Tank 1: 10
For Tank 2: 16
For Tank 3: 6

Floats: OP
Timer: OP

Electric Circuits: Operational
Distribution System: Operational
Sprayfield Veg: Operational

Tank Lid / Riser: Secured

Alarm: Operational

Comments

- Technician Secured the Tank Lid and/or Riser prior to leaving location. - Tank1 needs Pumping for scum. - Scum in pretreatment is 20"!! - Cleaned compressor filter - Cleaned drip filter and back flushed drip filed. - *****SYSTEM PUMPING NEEDED****** We recommend R.W. Septic their number is 830-377-3995, Ferguson & Sons septic pumping 830-431-6104

Service Completed

Site: 974 Paradise Dr, Canyon Lake, TX 78133

Provider: Rudy Carson

Technician: Trenton L Soldan

License Info: MP0002036 Expires:

License Info: MT0002287 Expires: 3/31/2025

Block Creek Aerobic Services, LLC
444 A Old Hwy No 9
Comfort, TX 78013

Phone: (830) 995-3189
Fax: (830) 995-4051

To: Cheryl Blum
974 Paradise Dr
Canyon Lake, TX 78133

Printed: 12/8/2022
Insp ID #: 134399
Main Phone: (210) 589-6224
Work:
Cell Phone:
Alt Cell:

Permit #: **109342**

Agency: Comal County
County: Comal

Mfg / Brand: Advantage Wastewater LLC - Nu Water
Treatment Type: Aerobic With Chlorine System S/N: 25029
Disposal: Drip Emitters

Customer ID: 7089

Contract Dates: 6/22/2022 - 6/22/2024
Scheduled Date: 2/22/2023

Installed: 9/20/2019
Warranty End: 9/20/2021

GPS Coordinates: Latitude: 29.88144 Longitude: -98.26497

Service Type: Customer Request

Visit Date: 12/8/2022

Time In:

Out: 1220pm

Entered By: Noel J Aleman

Method: Grab

Technician: Noel J Aleman

Maint. Provider: Rudy Carson

Aerators: Operational

Filters: Operational

Irrigation Pumps: Operational

Disinfection Device: Operational

Floats: OP

Timer: OP

Electric Circuits: Operational

Tank Lid / Riser: Secured

Distribution System: Operational

Sprayfield Veg: Operational

Alarm: Operational

Comments

Service Completed

- Technician Secured the Tank Lid and/or Riser prior to leaving location. Break in Line- areas need more top soil.

Site: 974 Paradise Dr, Canyon Lake, TX 78133

Provider: Rudy Carson

Technician: Noel J Aleman

License Info: MP0002036 Expires: 11/30/2025

License Info: MT0002393 Expires: 8/30/2025



Block Creek Concrete Products, LLC
444 A Old Hwy No 9
Comfort, TX 78013

Phone: (830) 995-3189
Fax: (830) 995-4051

To: Cheryl Blum
974 Paradise Dr
Canyon Lake, TX 78133

Printed: 3/2/2022
Site: 974 Paradise Dr
Canyon Lake, TX 78133
(210) 589-6224

Permit #: **109342**
Agency: Comal County
County: Comal
Mfg / Brand: Advantage Wastewater LLC - Nu Water
Treatment Type: Aerobic With Chlorine System S/N: 25029
Disposal: Drip Emitters

Customer ID: 7089
Contract Dates: 6/22/2020 - 6/22/2022
Scheduled Date: 2/22/2022
Installed: 9/20/2019
Warranty End: 9/20/2021
GPS Coordinates - Latitude: 29.88144 Longitude: -98.26497

Service Type: Customer Request

Visit Date: 3/2/2022

Entered By: Rudy Carson

Method: Grab

Technician: Rudy Carson

Maint. Provider: Rudy Carson

Aerators: Operational

Filters: Operational

Irrigation Pumps: Operational

Disinfection Device: Operational

Tank Lid / Riser: Secured

Electric Circuits: Operational

Distribution System: Operational

Sprayfield Veg: Operational

Alarm: Operational

Comments

- Technician Secured the Tank Lid and/or Riser prior to leaving location. System back up we were just there- the t- baffel is clear and so is the clean out. Homeowner is going to call a plumber

Service Completed

Insp ID #: 121212

Provider: **Rudy Carson**

Technician: **Rudy Carson**

License Info: MP0002036 Expires:

License Info: MP0002036 Expires: 10/22/2022

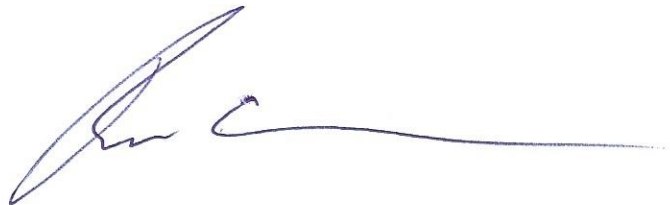

Block Creek Aerobic Services, LLC
444 A Old Hwy No 9
Comfort, TX 78013

Phone: (830) 995-3189
Fax: (830) 995-4051

To: Cheryl Blum
974 Paradise Dr
Canyon Lake, TX 78133

Printed: 3/1/2023
Insp ID #: 137204

Main Phone: (210) 589-6224
Work:
Cell Phone:
Alt Cell:

Permit #: **109342**

Agency: Comal County
County: Comal
Mfg / Brand: Advantage Wastewater LLC - Nu Water
Treatment Type: Aerobic With Chlorine System S/N: 25029
Disposal: Drip Emitters

Customer ID: 7089
Contract Dates: 6/22/2022 - 6/22/2024
Scheduled Date: 2/22/2023 Inspection 2 of 6
Installed: 9/20/2019
Warranty End: 9/20/2021
GPS Coordinates: Latitude: 29.88144 Longitude: -98.26497

Service Type: Scheduled Inspection

This counts as a type of "Scheduled Inspection"
Entered By: Julio C Esquivel

Visit Date: 3/1/2023 Time In:

Method: Grab
Technician: Julio C Esquivel
Maint. Provider: Rudy Carson

Aerators: Operational
Filters: Operational
Irrigation Pumps: Operational
Disinfection Device: Operational

Sludge Levels
For Tank 1: 9"
For Tank 2: 4"
For Tank 3: 1"

Floats: OP
Timer: OP

Electric Circuits: Operational
Distribution System: Operational
Sprayfield Veg: Operational

Tank Lid / Riser: Secured

Alarm: Operational

Comments

- Technician Secured the Tank Lid and/or Riser prior to leaving location. - Cleaned compressor filter - Scum in pretreatment is 0" -
Cleaned drip filter and back flushed drip filed

Service Completed

Site: 974 Paradise Dr, Canyon Lake, TX 78133

Provider: **Rudy Carson**

Technician: **Julio C Esquivel**

License Info: MP0002036 Expires: 11/30/2025

License Info: MT0002400 Expires: 10/31/2025

Block Creek Aerobic Services, LLC
444 A Old Hwy No 9
Comfort, TX 78013

Phone: (830) 995-3189
Fax: (830) 995-4051

To: Cheryl Blum
974 Paradise Dr
Canyon Lake, TX 78133

Printed: 7/18/2023
Insp ID #: 142898

Main Phone: (210) 589-6224
Work:
Cell Phone:
Alt Cell:

Permit #: **109342**

Agency: Comal County
County: Comal
Mfg / Brand: Advantage Wastewater LLC - Nu Water
Treatment Type: Aerobic With Chlorine System S/N: 25029
Disposal: Drip Emitters

Customer ID: 7089

Contract Dates: 6/22/2022 - 6/22/2024

Scheduled Date: 6/22/2023

Inspection 3 of 6

Installed: 9/20/2019

Warranty End: 9/20/2021

GPS Coordinates: Latitude: 29.88144 Longitude: -98.26497

Service Type: Scheduled Inspection

This counts as a type of "Scheduled Inspection"
Entered By: Ronnie W Krampota

Visit Date: 7/18/2023

Time In: 250pm

Out: 305pm

Method: Grab

Technician: Ronnie W Krampota

Maint. Provider: Rudy Carson

Aerators: Operational

Filters: Operational

Irrigation Pumps: Operational

Disinfection Device: Operational

Sludge Levels

For Tank 1: 11

For Tank 2: 12

For Tank 3: 0"

Floats: OP

Timer: OP

Air Filter: Good

Electric Circuits: Operational

Distribution System: Operational

Sprayfield Veg: Operational

Tank Lid / Riser: Secured

Color: Good

Odor: Good

Alarm: Operational

Comments

- Technician Secured the Tank Lid and/or Riser prior to leaving location. - Secured system in the on position with a lock bolt - - Cleaned drip filter and back flushed drip filed - Set valve - Cleaned compressor filter - Scum in pretreatment is 2"

Site: 974 Paradise Dr, Canyon Lake, TX 78133

Service Completed

Provider:

Rudy Carson

Technician: Ronnie W Krampota

License Info: MP0002036 Expires: 11/30/2025

License Info: MT0001175 Expires: 7/31/2023



Block Creek Aerobic Services, LLC
444 A Old Hwy No 9
Comfort, TX 78013

Phone: (830) 995-3189
Fax: (830) 995-4051

To: Cheryl Blum
974 Paradise Dr
Canyon Lake, TX 78133

Printed: 10/24/2023 Main Phone: (210) 589-6224
Insp ID #: 145907 Work:
Cell Phone:
Alt Cell:

Permit #: **109342**
Agency: Comal County
County: Comal
Mfg / Brand: Advantage Wastewater LLC - Nu Water
Treatment Type: Aerobic With Chlorine System S/N: 25029
Disposal: Drip Emitters

Customer ID: 7089
Contract Dates: 6/22/2022 - 6/22/2024
Scheduled Date: 10/22/2023 Inspection 4 of 6
Installed: 9/20/2019
Warranty End: 9/20/2021
GPS Coordinates: Latitude: 29.88144 Longitude: -98.26497

Service Type: Scheduled Inspection

This counts as a type of "Scheduled Inspection"
Entered By: Ronnie W Krampota

Visit Date: 10/24/2023 Time In: 1240pm Out: 100pm

Method: Grab
Technician: Ronnie W Krampota
Maint. Provider: Rudy Carson

Aerators: Operational
Filters: Operational
Irrigation Pumps: Operational
Disinfection Device: Operational

Sludge Levels
For Tank 1: 11
For Tank 2: 13
For Tank 3: 0"

Floats: OP
Timer: OP

Air Filter: Good

Electric Circuits: Operational
Distribution System: Operational
Sprayfield Veg: Operational

Tank Lid / Riser: Secured

Color: Good
Odor: Good

Alarm: Operational

Comments

Service Completed

- Technician Secured the Tank Lid and/or Riser prior to leaving location. - Secured system in the on position with a lock bolt - Cleaned drip filter and back flushed drip filed - Did not see any leaks - PSI 25 - Cleaned compressor filter - Scum in pretreatment is 5"

Site: 974 Paradise Dr, Canyon Lake, TX 78133

Provider: *Rudy Carson*

Technician: Ronnie W Krampota

License Info: MP0002036 Expires: 11/30/2025

License Info: MT0001175 Expires: 7/31/2023



Block Creek Aerobic Services, LLC

444 A Old Hwy No 9
Comfort, TX 78013

(830) 995-3189

Printed:1/26/2024

Permit: 109342

Site: 974 Paradise Dr, Canyon Lake, TX 78133

Main Phone: 2105896224

Cheryl Blum

974 Paradise Dr
Canyon Lake, TX 78133

Agency: Comal County
County: Comal

System Info: MFG: Advantage Wastewater LLC Brand: Nu Water Customer ID: 7089
Treatment Type: Aerobic With Chlorine Disposal Type: Drip Emitters Insp ID: 153450
Installed: 9/20/2019 Warranty Expiration: 9/20/2021 System S/N: 25029

Visit Details <----->
Visit Date: 1/26/2024 Entered By: Dalton James Vann GPS Lat: 29.88144 GPS Long: -98.26497
Scheduled Date: 6/22/2024 Contract Starts: 6/22/2022
Entered On: 1/26/2024 Contract Ends: 6/22/2024

Visit Results

Service Type: Customer Request

Method: Grab

Technician: Dalton James Vann

Provider: Rudy Carson

License #

MT0001113

MP0002036

Expires

2/28/2025

11/30/2025

Service Completed

Aerators: Operational

Filters: Operational

Irrigation Pumps: Operational

Disinfection Device: Operational

Chlorine Residual: 1

Tank Lid / Riser: Secured

Electric Circuits: Operational

Distribution System: Operational

Drip/Sprayfield Veg: Operational

Alarm: Operational

Comments

- Technician Secured the Tank Lid and/or Riser prior to leaving location. -Cust called about chirping alarm on system. No chirping on arrival, tested alarm float, float working great, tested buzzers, tested air switch, light bulbs both working. No issues found, advised cust to keep an eye on the system for now.

Provider: *Rudy Carson*

License: Number: MP0002036 Exp: 11/30/2025

Technician: *Dalton James Vann*

License: Number: MT0001113 Exp: 2/28/2025



Block Creek Aerobic Services, LLC

444 A Old Hwy No 9
Comfort, TX 78013

(830) 995-3189

Printed:1/18/2024

Permit: 109342

Site: 974 Paradise Dr, Canyon Lake, TX 78133

Main Phone: 2105896224

Cheryl Blum
974 Paradise Dr
Canyon Lake, TX 78133

Agency: Comal County
County: Comal

System Info: MFG: Advantage Wastewater LLC Brand: Nu Water Customer ID: 7089
 Treatment Type: Aerobic With Chlorine Disposal Type: Drip Emitters Insp ID: 152896
 Installed: 9/20/2019 Warranty Expiration: 9/20/2021 System S/N: 25029

Visit Details

Visit Date: 1/18/2024 Entered By: Trenton L Soldan GPS Lat: 29.88144 GPS Long: -98.26497

Scheduled Date: 2/22/2024 Time In: 1250 Contract Starts: 6/22/2022
 Entered On: 1/18/2024 Time Out: 104 Contract Ends: 6/22/2024

Visit Results

Service Type: Scheduled Inspection

Count: Inspection 5 of 6

Method: Grab

Technician: Kaleb Hernandez License # MT0002671 Expires 1/31/2027
 Provider: Rudy Carson License # MP0002036 Expires 11/30/2025 Service Completed

Aerators: Operational Sludge Level Tank 1: 0"
 Filters: Operational Sludge Level Tank 2: 16"
 Irrigation Pumps: Operational Sludge Level Tank 3: 0"
 Disinfection Device: Operational Turbidity: Good

Chlorine Residual: 1

Air Filter: Good

Tank Lid / Riser: Secured

Electric Circuits: Operational
 Distribution System: Operational
 Drip/Sprayfield Veg: Operational Color: Good
 Alarm: Operational Odor: Good

Comments

- Scum in pretreatment is 10" - Cleaned compressor filter - Cleaned drip filter and back flushed drip field - Technician Secured the Tank Lid and/or Riser prior to leaving location.

Provider: *Rudy Carson* Technician: Kaleb Hernandez
 License: Number: MP0002036 Exp: 11/30/2025 License: Number: MT0002671 Exp: 1/31/2027

Aerobic Services
 15188 FM 306
 Canyon Lake, TX 78133



Canyon Lake: (830) 964-2365
Bastrop: (512) 303-6922
 info@aerobicservices.com
 bastrop@aerobicservices.com
MP349 / OS24597
www.aerobicservices.com

To: Cheryl Blum
 974 Paradise Dr
 Canyon Lake, TX 78133
 Agency: Comal County Environmental Health
 County: Comal
 Permit No: 109342

Tech: Robert Salinas
 Phone: (210) 589-6224
 Alt Ph: _____
 Date: 2024-11-20
 Service _____
 Due: _____

Inspection Type: Scheduled

Item	Operational	Inoperative	Not Present
Aerator:	<input checked="" type="checkbox"/>	<input type="checkbox"/>	<input type="checkbox"/>
Irrigation Pump:	<input checked="" type="checkbox"/>	<input type="checkbox"/>	<input type="checkbox"/>
Air Compressor:	<input checked="" type="checkbox"/>	<input type="checkbox"/>	<input type="checkbox"/>
Pump Screen:	<input checked="" type="checkbox"/>	<input type="checkbox"/>	<input type="checkbox"/>
Chlorinator:	<input checked="" type="checkbox"/>	<input type="checkbox"/>	<input type="checkbox"/>
Spray Field Vegetation:	<input checked="" type="checkbox"/>	<input type="checkbox"/>	<input type="checkbox"/>
Filters:	<input checked="" type="checkbox"/>	<input type="checkbox"/>	<input type="checkbox"/>
Sprinkler / Drip Backwash:	<input checked="" type="checkbox"/>	<input type="checkbox"/>	<input type="checkbox"/>
Controls / Electric Circuits:	<input checked="" type="checkbox"/>	<input type="checkbox"/>	<input type="checkbox"/>

Air Pressure: 75

Test Results and Observations: (As Required)

Chlorine Residual (ppm): _____
 Test Method: Drip
 BOD: _____
 TSS: _____
 Tank Lids Secured: Yes / NO
 Pump Out Needed: Yes / NO
 Repairs Made: Yes / NO

Mixed Liquor: all measurements in inches

Aeration: 52

Sludge Levels

Clarifier: 24

Pump: 0

Repairs and Comments:

Filter clean & backwashed system. System in working order

Inspector: _____

Date: 2024-11-20

Tom Hampton, VP
 MP349/OS24597