



# COMAL COUNTY

ENGINEER'S OFFICE

## License to Operate On-Site Sewage Treatment and Disposal Facility

Issued This Date: 10/17/2019 Permit Number: 109537

Location Description: 2130 FRANCISCO PASS  
CANYON LAKE, TX 78133

Subdivision: Cordova Bend at Canyon Lake  
Unit: 1  
Lot: 7  
Block:  
Acreage:

Type of System: Aerobic  
Surface Irrigation

Issued to: Heather & Blake Dornburg

This license is authorization for the owner to operate and maintain a private facility at the location described in accordance to the rules and regulations for on-site sewerage facilities of Comal County, Texas, and the Texas Commission on Environmental Quality.

The license grants permission to operate the facility. It does not guarantee successful operation. It is the responsibility of the owner to maintain and operate the facility in a satisfactory manner.

Alterations to this permit including, but not limited to:

- Increase in the square feet of living area
- Increase in the number of bedrooms
- A change of use (i.e. residential to commercial)
- Relocation of system components (including the relocation of spray heads)
- Installation of landscaping
- Adding new structures to the system

may require a new permit. **It is the responsibility of the owner to apply for a new permit, if applicable.**

Inspection and licensing of a facility indicates only that the facility meets certain minimum requirements. It does not impede any governmental entity in taking the proper steps to prevent or control pollution, to abate nuisance, or to protect the public health.

This license to operate is valid for an indefinite period. The holder may transfer it to a succeeding owner, provided the facility has not been remodeled and is functioning properly.

Licensing Authority

Comal County Environmental Health

  
OS0034792

ENVIRONMENTAL HEALTH INSPECTOR

  
ENVIRONMENTAL HEALTH COORDINATOR

OS 0025599

Final

### Comal County Environmental Health OSSF Inspection Sheet

Installer Name: Scott Schneider OSSF Installer #: \_\_\_\_\_

1st Inspection Date: 10/15/19 2nd Inspection Date: \_\_\_\_\_ 3rd Inspection Date: 10-17-19

Inspector Name: Mike T. Inspector Name: \_\_\_\_\_ Inspector Name: B. Olvera

Permit#: 109537 Address: Cordova Bend / 2130 Francisco Pass

No.	Description	Answer	Citations	Notes	1st Insp.	2nd Insp.	3rd Insp.
1	SITE AND SOIL CONDITIONS & SETBACK DISTANCES Site and Soil Conditions Consistent with Submitted Planning Materials	/	285.31(a) 285.30(b)(1)(A)(iv) 285.30(b)(1)(A)(v) 285.30(b)(1)(A)(iii) 285.30(b)(1)(A)(ii) 285.30(b)(1)(A)(i)		10/15/19		10-17-19
2	SITE AND SOIL CONDITIONS & SETBACK DISTANCES Setback Distances Meet Minimum Standards	/	285.91(10) 285.30(b)(4) 285.31(d)				
3	SEWER PIPE Proper Type Pipe from Structure to Disposal System (Cast Iron, Ductile Iron, Sch. 40, SDR 26)	/	285.32(a)(1)				
4	SEWER PIPE Slope from the Sewer to the Tank at least 1/8 Inch Per Foot	/	285.32(a)(3)				
5	SEWER PIPE Two Way Sanitary - Type Cleanout Properly Installed (Add. C/O Every 100' &/or 90 degree bends)	/	285.32(a)(5)				
6	PRETREATMENT Installed (if required) TCEQ Approved List PRETREATMENT Septic Tank(s) Meet Minimum Requirements	/	285.32(b)(1)(G) 285.32(b)(1)(E)(iii) 285.32(b)(1)(E)(iv) 285.32(b)(1)(F) 285.32(b)(1)(B) 285.32(b)(1)(C)(i) 285.32(b)(1)(C)(ii) 285.32(b)(1)(D) 285.32(b)(1)(E) 285.32(b)(1)(A) 285.32(b)(1)(E)(ii)(II) 285.32(b)(1)(E)(i) 285.32(b)(1)(E)(ii)(I)				
7	PRETREATMENT Grease Interceptors if required for commercial		285.34(d)				

MT-10/15/19  
Tank set, leveled  
operational ✓  
Ready For Cover.

10-17-19 RUG  
covered

**Comal County Environmental Health  
OSSF Inspection Sheet**

No.	Description	Answer	Citations	Notes	1st Insp.	2nd Insp.	3rd Insp.
8	SEPTIC TANK Tank(s) Clearly Marked SEPTIC TANK if Single Tank, 2 Compartments Provided with Baffle SEPTIC TANK Inlet Flowline Greater than 3" and " T " Provided on Inlet and Outlet SEPTIC TANK Septic Tank(s) Meet Minimum Requirements		285.32(b)(1)(E) 285.91(2) 285.32(b)(1)(F) 285.32(b)(1)(E)(iii) 285.32(b)(1)(E)(ii)(II) 285.32(b)(1)(E)(ii)(I) 285.32(b)(1)(E)(i) 285.32(b)(1)(D) 285.32(b)(1)(C)(ii) 285.32(b)(1)(C)(i) 285.32(b)(1)(B) 285.32(b)(1)(A) 285.32(b)(1)(E)(iv)				
9	ALL TANKS Installed on 4" Sand Cushion/ Proper Backfill Used		285.32(b)(1)(F) 285.32(b)(1)(G) 285.34(b)				10-17-19
10	SEPTIC TANK Inspection / Clean Out Port & Risers Provided on Tanks Buried Greater than 12" Sealed and Capped		285.38(d)				
11	SEPTIC TANK Secondary restraint system provided SEPTIC TANK Riser permanently fastened to lid or cast into tank SEPTIC TANK Riser cap protected against unauthorized intrusions		285.38(d) 285.38(e)				
12	SEPTIC TANK Tank Volume Installed						
13	PUMP TANK Volume Installed						
14	AEROBIC TREATMENT UNIT Size Installed	✓		600 G.P.	10/15/19		
15	AEROBIC TREATMENT UNIT Manufacturer AEROBIC TREATMENT UNIT Model Number	✓		Solar Aire			
16	DISPOSAL SYSTEM Absorptive		285.33(a)(4) 285.33(a)(1) 285.33(a)(2) 285.33(a)(3)				
17	DISPOSAL SYSTEM Leaching Chamber		285.33(a)(1) 285.33(a)(3) 285.33(a)(4) 285.33(a)(2)				
18	DISPOSAL SYSTEM Evapo-transpirative		285.33(a)(3) 285.33(a)(4) 285.33(a)(1) 285.33(a)(2)				

**Comal County Environmental Health  
OSSF Inspection Sheet**

No.	Description	Answer	Citations	Notes	1st Insp.	2nd Insp.	3rd Insp.
19	DISPOSAL SYSTEM Drip Irrigation		285.33(c)(3)(A)-(F)				
20	DISPOSAL SYSTEM Soil Substitution		285.33(d)(4)				
21	DISPOSAL SYSTEM Pumped Effluent		285.33(a)(3) 285.33(a)(1) 285.33(a)(2)				
22	DISPOSAL SYSTEM Gravelless Pipe		285.33(a)(3) 285.33(a)(2) 285.33(a)(4) 285.33(a)(1)				
23	DISPOSAL SYSTEM Mound		285.33(a)(3) 285.33(a)(1) 285.33(a)(2) 285.33(a)(4)				
24	DISPOSAL SYSTEM Other (describe) (Approved Design)		285.33(d)(6) 285.33(c)(4)				
25	DRAINFIELD Absorptive Drainline 3" PVC or 4" PVC						
26	DRAINFIELD Area Installed						
27	DRAINFIELD Level to within 1 inch per 25 feet and within 3 inches over entire excavation		285.33(b)(1)(A)(v)				
28	DRAINFIELD Excavation Width DRAINFIELD Excavation Depth DRAINFIELD Excavation Separation DRAINFIELD Depth of Porous Media DRAINFIELD Type of Porous Media						
29	DRAINFIELD Pipe and Gravel - Geotextile Fabric in Place		285.33(b)(1)(E)				
30	DRAINFIELD Leaching Chambers DRAINFIELD Chambers - Open End Plates w/Splash Plate, Inspection Port & Closed End Plates in Place (per manufacturers spec.)		285.33(c)(2)				
31	LOW PRESSURE DISPOSAL SYSTEM Adequate Trench Length & Width, and Adequate Separation Distance between Trenches		285.33(d)(1)(C)(i)				

**Comal County Environmental Health  
OSSF Inspection Sheet**

No.	Description	Answer	Citations	Notes	1st Insp.	2nd Insp.	3rd Insp.
	<p>EFFLUENT DISPOSAL SYSTEM Utilized Only by Single Family Dwelling</p> <p>EFFLUENT DISPOSAL SYSTEM Topographic Slopes &lt; 2.0%</p> <p>EFFLUENT DISPOSAL SYSTEM Adequate Length of Drain Field ( 1000 Linear ft. for 2 bedrooms or Less &amp; an additional 400 ft. for each additional bedroom )</p> <p>EFFLUENT DISPOSAL SYSTEM Lateral Depth of 18 inches to 3 ft. &amp; Vertical Separation of 1ft on bottom and 2 ft. to restrictive horizon and ground water respectfully</p> <p>EFFLUENT DISPOSAL SYSTEM Lateral Drain Pipe (1.25 - 1.5" dia.) &amp; Pipe Holes ( 3/16 - 1/4" dia. Hole Size ) 5 ft. Apart</p>		<p>285.33(b)(3)(A)</p> <p>285.33(b)(3)(A)</p> <p>285.33(b)(3)(B)</p> <p>285.91(13)</p> <p>285.33(b)(3)(D)</p> <p>285.33(b)(3)(F)</p>				
32							
33	<p>AEROBIC TREATMENT UNIT Is Aerobic Unit Installed According to Approved Guidelines</p>	✓	285.32(c)(1)		10/15/19		10-17-19
34	<p>AEROBIC TREATMENT UNIT Inspection/Clean Out Port &amp; Risers Provided</p> <p>AEROBIC TREATMENT UNIT Secondary restraint system provided</p> <p>AEROBIC TREATMENT UNIT Riser permanently fastened to lid or cast into tank</p> <p>AEROBIC TREATMENT UNIT Riser cap protected against unauthorized intrusions</p>	✓					
35	<p>AEROBIC TREATMENT UNIT Chlorinator Properly Installed with Chlorine Tablets in Place</p>	✓					
36	<p>PUMP TANK Is the Pump Tank an approved concrete tank or other acceptable materials &amp; construction</p> <p>PUMP TANK Sampling Port Provided in the Treated Effluent Line</p> <p>PUMP TANK Check Valve and/or Anti- Siphon Device Present When Required</p> <p>PUMP TANK Audible and Visual High Water Alarm Installed on Separate Circuit From Pump</p>						
37	<p>PUMP TANK Inspection/Clean Out Port &amp; Risers Provided</p> <p>PUMP TANK Secondary restraint system provided</p> <p>PUMP TANK Riser permanently fastened to lid or cast into tank</p> <p>PUMP TANK Riser cap protected against unauthorized intrusions</p>						
38	<p>PUMP TANK Secondary restraint system provided</p>						
39	<p>PUMP TANK Electrical Connections in Approved Junction Boxes / Wiring Buried</p>						✓

**Comal County Environmental Health  
OSSF Inspection Sheet**

*Final*

No.	Description	Answer	Citations	Notes	1st Insp.	2nd Insp.	3rd Insp.
40	APPLICATION AREA Distribution Pipe, Fitting, Sprinkler Heads & Valve Covers Color Coded Purple?	✓	285.33(d)(2)(G)(iii)(II)285.33(d)(2)(G)(v) 285.33(d)(2)(G)(iii) 285.33(d)(2)(G)(iv) 285.33(d)(2)(G)(i) 285.33(d)(2)(G)(ii) 285.33(d)(2)(G)(iii)(I)		10/15/19		10-17-19
41	APPLICATION AREA Low Angle Nozzles Used / Pressure is as required APPLICATION AREA Acceptable Area, nothing within 10 ft of sprinkler heads? APPLICATION AREA The Landscape Plan is as Designed	✓	285.33(d)(2)(G)(i) 285.33(d)(2)(A) 285.33(d)(2)(F)		↓		↓
42	APPLICATION AREA Area Installed						↓
43	PUMP TANK Meets Minimum Reserve Capacity Requirements						
44	PUMP TANK Material Type & Manufacturer						
45	PUMP TANK Type/Size of Pump Installed						

## Comal County Environmental Health OSSF Inspection Sheet

Installer Name: Scott Schneider OSSF Installer #: \_\_\_\_\_

1st Inspection Date: 10/15/19 2nd Inspection Date: \_\_\_\_\_ 3rd Inspection Date: \_\_\_\_\_

Inspector Name: mike T. Inspector Name: \_\_\_\_\_ Inspector Name: \_\_\_\_\_

Permit#: 109537 Address: Cordova Bend / 2130 Francisco Pass

No.	Description	Answer	Citations	Notes	1st Insp.	2nd Insp.	3rd Insp.
1	SITE AND SOIL CONDITIONS & SETBACK DISTANCES Site and Soil Conditions Consistent with Submitted Planning Materials	/	285.31(a) 285.30(b)(1)(A)(iv) 285.30(b)(1)(A)(v) 285.30(b)(1)(A)(iii) 285.30(b)(1)(A)(ii) 285.30(b)(1)(A)(i)		10/15/19		
2	SITE AND SOIL CONDITIONS & SETBACK DISTANCES Setback Distances Meet Minimum Standards	/	285.91(10) 285.30(b)(4) 285.31(d)				
3	SEWER PIPE Proper Type Pipe from Structure to Disposal System (Cast Iron, Ductile Iron, Sch. 40, SDR 26)	/	285.32(a)(1)				
4	SEWER PIPE Slope from the Sewer to the Tank at least 1/8 Inch Per Foot	/	285.32(a)(3)				
5	SEWER PIPE Two Way Sanitary - Type Cleanout Properly Installed (Add. C/O Every 100' &/or 90 degree bends)	/	285.32(a)(5)				
6	PRETREATMENT Installed (if required) TCEQ Approved List PRETREATMENT Septic Tank(s) Meet Minimum Requirements		285.32(b)(1)(G)285.32(b)(1)(E)(iii) 285.32(b)(1)(E)(iv) 285.32(b)(1)(F) 285.32(b)(1)(B) 285.32(b)(1)(C)(i) 285.32(b)(1)(C)(ii) 285.32(b)(1)(D) 285.32(b)(1)(E) 285.32(b)(1)(A) 285.32(b)(1)(E)(ii)(II) 285.32(b)(1)(E)(i) 285.32(b)(1)(E)(ii)(I)				
7	PRETREATMENT Grease Interceptors if required for commercial		285.34(d)				

MT-10/15/19  
 Tank set, leveled  
 operational ✓  
 Ready For Cover.

**Comal County Environmental Health  
OSSF Inspection Sheet**

No.	Description	Answer	Citations	Notes	1st Insp.	2nd Insp.	3rd Insp.
8	SEPTIC TANK Tank(s) Clearly Marked SEPTIC TANK If Single Tank, 2 Compartments Provided with Baffle SEPTIC TANK Inlet Flowline Greater than 3" and " T " Provided on Inlet and Outlet SEPTIC TANK Septic Tank(s) Meet Minimum Requirements		285.32(b)(1)(E) 285.91(2) 285.32(b)(1)(F) 285.32(b)(1)(E)(iii) 285.32(b)(1)(E)(ii)(II) 285.32(b)(1)(E)(ii)(I) 285.32(b)(1)(E)(i) 285.32(b)(1)(D) 285.32(b)(1)(C)(ii) 285.32(b)(1)(C)(i) 285.32(b)(1)(B) 285.32(b)(1)(A) 285.32(b)(1)(E)(iv)				
9	ALL TANKS Installed on 4" Sand Cushion/ Proper Backfill Used		285.32(b)(1)(F) 285.32(b)(1)(G) 285.34(b)				
10	SEPTIC TANK Inspection / Clean Out Port & Risers Provided on Tanks Buried Greater than 12" Sealed and Capped		285.38(d)				
11	SEPTIC TANK Secondary restraint system provided SEPTIC TANK Riser permanently fastened to lid or cast into tank SEPTIC TANK Riser cap protected against unauthorized intrusions		285.38(d) 285.38(e)				
12	SEPTIC TANK Tank Volume Installed						
13	PUMP TANK Volume Installed						
14	AEROBIC TREATMENT UNIT Size Installed	✓		600 L.P.	10/15/19		
15	AEROBIC TREATMENT UNIT Manufacturer AEROBIC TREATMENT UNIT Model Number	✓		Soloraire			
16	DISPOSAL SYSTEM Absorptive		285.33(a)(4) 285.33(a)(1) 285.33(a)(2) 285.33(a)(3)				
17	DISPOSAL SYSTEM Leaching Chamber		285.33(a)(1) 285.33(a)(3) 285.33(a)(4) 285.33(a)(2)				
18	DISPOSAL SYSTEM Evapo-transpirative		285.33(a)(3) 285.33(a)(4) 285.33(a)(1) 285.33(a)(2)				



**Comal County Environmental Health  
OSSF Inspection Sheet**

No.	Description	Answer	Citations	Notes	1st Insp.	2nd Insp.	3rd Insp.
19	DISPOSAL SYSTEM Drip Irrigation		285.33(c)(3)(A)-(F)				
20	DISPOSAL SYSTEM Soil Substitution		285.33(d)(4)				
21	DISPOSAL SYSTEM Pumped Effluent		285.33(a)(3) 285.33(a)(1) 285.33(a)(2)				
22	DISPOSAL SYSTEM Gravelless Pipe		285.33(a)(3) 285.33(a)(2) 285.33(a)(4) 285.33(a)(1)				
23	DISPOSAL SYSTEM Mound		285.33(a)(3) 285.33(a)(1) 285.33(a)(2) 285.33(a)(4)				
24	DISPOSAL SYSTEM Other (describe) (Approved Design)		285.33(d)(6) 285.33(c)(4)				
25	DRAINFIELD Absorptive Drainline 3" PVC or 4" PVC						
26	DRAINFIELD Area Installed						
27	DRAINFIELD Level to within 1 inch per 25 feet and within 3 inches over entire excavation		285.33(b)(1)(A)(v)				
28	DRAINFIELD Excavation Width DRAINFIELD Excavation Depth DRAINFIELD Excavation Separation DRAINFIELD Depth of Porous Media DRAINFIELD Type of Porous Media						
29	DRAINFIELD Pipe and Gravel - Geotextile Fabric in Place		285.33(b)(1)(E)				
30	DRAINFIELD Leaching Chambers DRAINFIELD Chambers - Open End Plates w/Splash Plate, Inspection Port & Closed End Plates in Place (per manufacturers spec.)		285.33(c)(2)				
31	LOW PRESSURE DISPOSAL SYSTEM Adequate Trench Length & Width, and Adequate Separation Distance between Trenches		285.33(d)(1)(C)(i)				

**Comal County Environmental Health  
OSSF Inspection Sheet**

No.	Description	Answer	Citations	Notes	1st Insp.	2nd Insp.	3rd Insp.
32	EFFLUENT DISPOSAL SYSTEM Utilized Only by Single Family Dwelling EFFLUENT DISPOSAL SYSTEM Topographic Slopes < 2.0% EFFLUENT DISPOSAL SYSTEM Adequate Length of Drain Field ( 1000 Linear ft. for 2 bedrooms or Less & an additional 400 ft. for each additional bedroom ) EFFLUENT DISPOSAL SYSTEM Lateral Depth of 18 inches to 3 ft. & Vertical Separation of 1ft on bottom and 2 ft. to restrictive horizon and ground water respectfully EFFLUENT DISPOSAL SYSTEM Lateral Drain Pipe (1.25 - 1.5" dia.) & Pipe Holes ( 3/16 - 1/4" dia. Hole Size ) 5 ft. Apart		285.33(b)(3)(A) 285.33(b)(3)(A) 285.33(b)(3)(B) 285.91(13) 285.33(b)(3)(D) 285.33(b)(3)(F)				
33	AEROBIC TREATMENT UNIT Is Aerobic Unit Installed According to Approved Guidelines.	✓	285.32(c)(1)		10/15/19		
34	AEROBIC TREATMENT UNIT Inspection/Clean Out Port & Risers Provided AEROBIC TREATMENT UNIT Secondary restraint system provided AEROBIC TREATMENT UNIT Riser permanently fastened to lid or cast into tank AEROBIC TREATMENT UNIT Riser cap protected against unauthorized intrusions	✓					
35	AEROBIC TREATMENT UNIT Chlorinator Properly Installed with Chlorine Tablets in Place.	✓					
36	PUMP TANK Is the Pump Tank an approved concrete tank or other acceptable materials & construction PUMP TANK Sampling Port Provided in the Treated Effluent Line PUMP TANK Check Valve and/or Anti- Siphon Device Present When Required PUMP TANK Audible and Visual High Water Alarm Installed on Separate Circuit From Pump						
37	PUMP TANK Inspection/Clean Out Port & Risers Provided PUMP TANK Secondary restraint system provided PUMP TANK Riser permanently fastened to lid or cast into tank PUMP TANK Riser cap protected against unauthorized intrusions						
38	PUMP TANK Secondary restraint system provided						
39	PUMP TANK Electrical Connections in Approved Junction Boxes / Wiring Buried						

**Comal County Environmental Health  
OSSF Inspection Sheet**

No.	Description	Answer	Citations	Notes	1st Insp.	2nd Insp.	3rd Insp.
40	APPLICATION AREA Distribution Pipe, Fitting, Sprinkler Heads & Valve Covers Color Coded Purple?	✓	285.33(d)(2)(G)(iii)(II)285.33(d)(2)(G)(iii)(III)285.33(d)(2)(G)(v) 285.33(d)(2)(G)(iii) 285.33(d)(2)(G)(iv) 285.33(d)(2)(G)(I) 285.33(d)(2)(G)(II) 285.33(d)(2)(G)(iii)(I)		10/15/17		
41	APPLICATION AREA Low Angle Nozzles Used / Pressure is as required APPLICATION AREA Acceptable Area, nothing within 10 ft of sprinkler heads? APPLICATION AREA The Landscape Plan is as Designed	✓	285.33(d)(2)(G)(i) 285.33(d)(2)(A) 285.33(d)(2)(F)				
42	APPLICATION AREA Area Installed						
43	PUMP TANK Meets Minimum Reserve Capacity Requirements						
44	PUMP TANK Material Type & Manufacturer						
45	PUMP TANK Type/Size of Pump Installed						

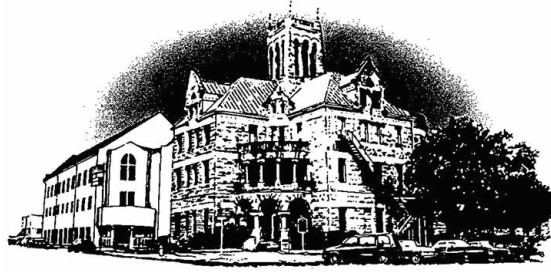

# Comal County

OFFICE OF COMAL COUNTY ENGINEER

## **Permit of Authorization to Construct an On-Site Sewage Facility Permit Valid For One Year From Date Issued**

Permit Number: 109537  
Issued This Date: 08/13/2019  
This permit is hereby given to: Heather & Blake Dornburg

To start construction of a private, on-site sewage facility located at:

2130 FRANCISCO PASS  
CANYON LAKE, TX 78133

Subdivision: Cordova Bend at Canyon Lake  
Unit: 1  
Lot: 7  
Block:  
Acreage:

APPROVED MINIMUM SIZES AS PER ATTACHED DESIGN

Type of System: Aerobic  
Surface Irrigation

This permit gives permission for the construction of the above referenced on-site facility to commence. Installation must be completed by an installer holding a valid registration card from the Texas Commission on Environmental Quality (TCEQ). Installation and inspection must comply with current TCEQ and Comal County requirements.

Call (830) 608-2090 to schedule inspections.

OSSF DEVELOPMENT APPLICATION CHECKLIST

Staff will complete shaded

<i>items Date Received</i>	<i>initials</i>

<i>Permit Number</i>

Instructions:

Place a check mark next to all items that apply. For items that do not apply, place "N/A". This OSSF Development Application Checklist **must** accompany the completed application.

OSSF Permit

Completed Application for Permit for Authorization to Construct an On-Site Sewage Facility and License to Operate

Site/Soil Evaluation Completed by a Certified Site Evaluator or a Professional Engineer

Planning Materials of the OSSF as Required by the TCEQ Rules for OSSF Chapter 285. Planning Materials shall consist of a scaled design and all system specifications.

Required Permit Fee

Copy of Recorded Deed

Surface Application/Aerobic Treatment System

Recorded Certification of OSSF Requiring Maintenance/Affidavit to the Public

Signed Maintenance Contract with Effective Date as Issuance of License to Operate

RECEIVED

AUG 06 2019

COUNTY ENGINEER

I affirm that I have provided all information required for my OSSF Development Application and that this application constitutes a completed OSSF Development Application.

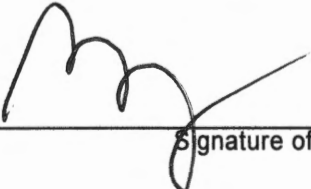
  
 \_\_\_\_\_  
 Signature of Applicant

08/06/19  
 \_\_\_\_\_  
 Date

___ COMPLETE APPLICATION	
Check No. _____	Receipt No. _____

___ INCOMPLETE APPLICATION
(Missing Items Circled, Application Refused)

APPLICATION FOR PERMIT FOR AUTHORIZATION TO CONSTRUCT AN ON-SITE SEWAGE FACILITY AND LICENSE TO OPERATE

Date July 17, 2019

Permit # 109537

Owner Name HEATHER & BLAKE DORNBURG Agent Name GREG W. JOHNSON, P.E.
Mailing Address c/o 6581 FM 306 Agent Address 170 HOLLOW OAK
City, State, Zip NEW BRAUNFELS, TEXAS 78132 City, State, Zip NEW BRAUNFELS, TX 78132
Phone# 830-629-4663 Phone # (830) 905-2778
Email tab@sohtx.com Email gregjohnsonpe@yahoo.com

All correspondence should be sent to: [ ] Owner [X] Agent [ ] Both Method: [ ] Mail [X] Email

Subdivision Name CORDOVA BEND AT CANYON LAKE Unit/Phase/Section 1 Lot 7 Block
Acreage/Legal
Street Name/Address 2130 FRANCISCO PASS City CANYON LAKE Zip 78133

Type of Development:

[X] Single Family Residential

Type of Construction (House, Mobile, RV, Etc.) HOUSE
Number of Bedrooms 4
Indicate Sq Ft of Living Area 2800

RECEIVED
AUG 06 2019
COUNTY ENGINEER

[ ] Non-Single Family Residential

(Planning materials must show adequate land area for doubling the required land needed for treatment units and disposal area)

Type of Facility
Offices, Factories, Churches, Schools, Parks, Etc. - Indicate Number Of Occupants
Restaurants, Lounges, Theaters - Indicate Number of Seats
Hotel, Motel, Hospital, Nursing Home - Indicate Number of Beds
Travel Trailer/RV Parks - Indicate Number of Spaces
Miscellaneous

Estimated Cost of Construction: \$ 350,000 (Structure Only)

Is any portion of the proposed OSSF located in the United States Army Corps of Engineers (USACE) flowage easement?

[ ] Yes [X] No (if yes, owner must provide approval from USACE for proposed OSSF improvements within the USACE flowage easement)

Source of Water [X] Public [ ] Private Well

Are Water Saving Devices Being Utilized Within the Residence? [X] Yes [ ] No

By signing this application, I certify that:

- The completed application and all additional information submitted does not contain any false information and does not conceal any material facts.
- Authorization is hereby given to the permitting authority and designated agents to enter upon the above described property for the purpose of site/soil evaluation and inspection of private sewage facilities.
- I also understand that a permit of authorization to construct will not be issued until the Floodplain Administrator has performed the reviews required by the Comal County Flood Damage Prevention Order.
- I affirmatively consent to the online posting/public release of my e-mail address associated with this permit application, as applicable.

Signature of Owner (Handwritten Signature)

Date 8-1-19

\*\*\* COMAL COUNTY OFFICE OF ENVIRONMENTAL HEALTH \*\*\*

APPLICATION FOR PERMIT FOR AUTHORIZATION TO CONSTRUCT AN ON-SITE SEWAGE FACILITY AND LICENSE TO OPERATE

Planning Materials & Site Evaluation as Required Completed By GREG W. JOHNSON, P.E.

System Description PROPRIETARY; AEROBIC TREATMENT AND SURFACE IRRIGATION

Size of Septic System Required Based on Planning Materials & Soil Evaluation

Tank Size(s) (Gallons) SOLAR AIR SA600LP Absorption/Application Area (Sq Ft) 5654

Gallons Per Day (As Per TCEQ Table III) 300

(Sites generating more than 5000 gallons per day are required to obtain a permit through TCEQ)

RECEIVED

Is the property located over the Edwards Recharge Zone? [ ] Yes [X] No

(If yes, the planning materials must be completed by a Registered Sanitarian (R.S.) or Professional Engineer (P.E.))

AUG 06 2019

Is there an existing TCEQ approved WPAP for the property? [ ] Yes [X] No

(if yes, the R. S. or P. E. shall certify that the OSSF design complies with all provisions of the existing WPAP.)

COUNTY ENGINEER

If there is no existing WPAP, does the proposed development activity require a TCEQ approved WPAP? [ ] Yes [ ] No

(If yes, the R.S. or P. E. shall certify that the OSSF design will comply with all provisions of the proposed WPAP. A Permit to Construct will not be issued for the proposed OSSF until the proposed WPAP has been approved by the appropriate regional office.)

Is the property located over the Edwards Contributing Zone? [X] Yes [ ] No

Is there an existing TCEQ approval CZP for the property? [X] Yes [ ] No

(if yes, the P.E. or R.S. shall certify that the OSSF design complies with all provisions of the existing CZP)

If there is no existing CZP, does the proposed development activity require a TCEQ approved CZP? [ ] Yes [ ] No

(if yes, the P.E. or R.S. shall certify that the OSSF design will comply with all provisions of the proposed CZP. A Permit to construct will not be issued for the proposed OSSF until the CZP has been approved by the appropriate regional office.)

Is this property within an incorporated city? [ ] Yes [X] No

If yes, indicate the city: \_\_\_\_\_

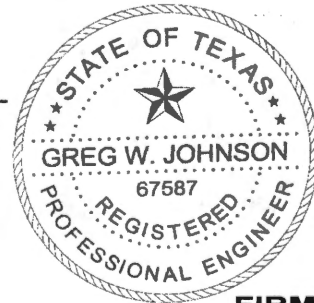

FIRM #2585

By signing this application, I certify that:

- The information provided above is true and correct to the best of my knowledge.
- I affirmatively consent to the online posting/public release of my e-mail address associated with this permit application, as applicable

Signature of Designer (Handwritten Signature)

Date July 18, 2019

AFFIDAVIT



201906027211 08/06/2019 02:02:16 PM 1/1

THE COUNTY OF COMAL  
STATE OF TEXAS

Yes

CERTIFICATION OF OSSF REQUIRING MAINTENANCE

According to Texas Commission on Environmental Quality Rules for On-Site Sewage Facilities (OSSF's), this document is filed in the Deed Records of Comal County, Texas.

I

The Texas Health and Safety Code, Chapter 366 authorizes the Texas Commission on Environmental Quality (TCEQ) to regulate on-site sewage facilities (OSSFs). Additionally, the Texas Water Code (TWC), § 5.012 and § 5.013, gives the commission primary responsibility for implementing the laws of the State of Texas relating to water and adopting rules necessary to carry out its powers and duties under the TWC. The commission, under the authority of the TWC and the Texas Health and Safety code, requires owner's to provide notice to the public that certain types of OSSFs are located on specific pieces of property. To achieve this notice, the commission requires a recorded affidavit. Additionally, the owner must provide proof of the recording to the OSSF permitting authority. This recorded affidavit is not a representation or warranty by the commission of the suitability of this OSSF, nor does it constitute any guarantee by the commission that the appropriate OSSF was installed.

RECEIVED

AUG 06 2019

II

An OSSF requiring a maintenance contract, according to 30 Texas Administrative Code §285.91(12) will be installed on the property described as (insert legal description):

COUNTY ENGINEER

1 UNIT/PHASE/SECTION \_\_\_\_\_ BLOCK 7 LOT CORDOVA BEND AT CANYON LAKE SUBDIVISION

IF NOT IN SUBDIVISION: \_\_\_\_\_ ACREAGE \_\_\_\_\_ SURVEY

The property is owned by (insert owner's full name): HEATHER DORNBURG & BLAKE DORNBURG

This OSSF must be covered by a continuous maintenance contract for the first two years. After the initial two-year service policy, the owner of an aerobic treatment system for a single family residence shall either obtain a maintenance contract within 30 days or maintain the system personally.

Upon sale or transfer of the above-described property, the permit for the OSSF shall be transferred to the buyer or new owner. A copy of the planning materials for the OSSF can be obtained from the Comal County Engineer's Office.

WITNESS BY HAND(S) ON THIS 1<sup>st</sup> DAY OF August, 2019

Owner(s) signature(s)

Blake Dornburg  
Heather Dornburg  
Owner (s) Printed name (s)

Heather & Blake Dornburg SWORN TO AND SUBSCRIBED BEFORE ME ON THIS 1<sup>st</sup> DAY OF August, 2019

Notary Public Signature

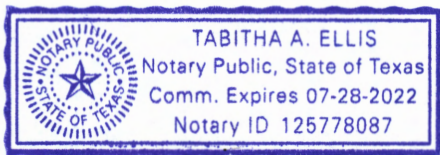

(Notary Seal Here)

THIS AREA FOR COMAL COUNTY CLERK RECORDING PURPOSES ONLY

Filed and Recorded  
Official Public Records  
Bobbie Koepf, County Clerk  
Comal County, Texas  
08/06/2019 02:02:16 PM  
TERRI 1 Page(s)  
201906027211



Bobbie Koepf



Koepf  
Johnson

8-5-19

15188 FM 306  
Canyon Lake, TX 78133  
Phone (830)964-2365 Fax (830) 964-2659

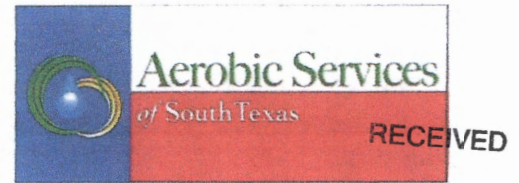

AUG 06 2019

## Routine Maintenance and Inspection Agreement

COUNTY ENGINEER

### General

This Work for Hire Agreement (hereinafter referred to as this "Agreement") is entered into by and between HEATHER & BLAKE DORNBURG (referred to as "Client") and Aerobic Services of South Texas (Thomas W. Hampton MP 349) (hereinafter referred to as "Contractor") located at 15188 FM 306, Texas 78133 (830) 964-2365. By this Agreement the Contractor agrees to render professional service, as described herein, and the Client agrees to fulfill the terms of this Agreement as described herein.

This contract will provide for all required inspections, testing and service for your Aerobic Treatment System. The policy will include the following:

1. 3 inspections a year/services calls (at least one every 4 months), for a total of 6 over the two year period including inspection, adjustment and servicing of the mechanical, electrical and other applicable component parts to ensure proper function. This includes inspecting control panel, air pumps, air filters, diffuser operation, Any alarm situation affecting the proper function of the Aerobic process will be address within a 48-hour time Frame. Repair work on non-warranty parts will include price for parts & labor. The prices will be quoted before work is performed.
2. An effluent quality inspection consisting of a visual check for color, turbidity, scum overflow and examination for odors. A test for chlorine residual and pH will be taken and reported as necessary.
3. If any improper operation is observed, which cannot be corrected at the time of the service visit, you will be notified immediately in writing of the conditions and estimated date of correction.
4. The customer is responsible for the chlorine tablets; they must be filled before or during the service visit.
5. Any additional visits, inspections or sample collection required by specific Municipalities, Water/River Authorities, and County Agencies the TCEQ or any other authorized regulatory agency in your jurisdiction will be covered by this policy.

The Homeowners Manual must be strictly followed or warranties are subject to invalidation. **Pumping of sludge build-up is not covered by this policy and will result in additional charges.**

### ACCESS BY CONTRACTOR

The Contractor or anyone authorized by the Contractor may enter the property at reasonable times without prior notice for the purpose of the above described Services. The contractor may access the System components including the tanks by means of excavation for the purpose of evaluations if necessary. Soil Is to be replaced with the excavated material as best as possible.

**Termination of Agreement**

Either party may terminate this agreement within ten days written notice in the event of substantial failure to perform in accordance with its terms by the other party without fault of the terminating party. If this Agreement is so terminated, the Contractor will immediately notify the appropriate health authority of the termination.

RECEIVED  
AUG 06 2019

**Limit of Liability**

In no event shall the Contractor be liable for indirect, consequential, incidental or punitive damages, whether in contract tort or any other theory. In no event shall the Contractor's liability for direct damages exceed the price for the services described in this Agreement.

COUNTY ENGINEER

**Dispute Resolution**

If a dispute between the Client and the Designer arises that cannot be settled in good faith negotiations then the parties shall choose a mutually acceptable arbitrator and shall share the cost of the arbitration services equally.

**Entire Agreement**

This Agreement contains the entire agreement of the parties, and there are no other promises or conditions in any other agreement either oral or written.

**Severability**

If any provision of this Agreement shall be held to be invalid or unenforceable for any reason, the remaining provisions shall continue to be valid and enforceable. If a court finds that any provision of this agreement is invalid or unenforceable, but that by limiting such provision it would become valid and enforceable, then such provision shall be deemed to be written, construed, and enforced as so limited.

Legal Description: CORDOVA BEND AT CANYON LAKE, UNIT 1, LOT

Property Address: 2130 FRANCISCO PASS

**HOME OWNER**

HEATHER & BLAKE DORNBURG

Name

2130 FRANCISCO PASS

Address

CANYON LAKE, TX 78133

City, State

Phone

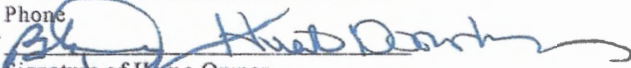
X   
Signature of Home Owner

**SERVICE PROVIDER**

Aerobic Services of South Texas Inc.

Name

15188 FM 306

Address

Canyon Lake, Texas 78133

City, State

(830) 964 - 2365

Phone

OS0024597/MP349

Thomas Hampton

Signature of Service Provider and License #

EFFECTIVE DATE \_\_\_\_\_ EXPIRED DATE \_\_\_\_\_ INSTALLED \_\_\_\_\_

Model # \_\_\_\_\_

Blower/Panel Serial # \_\_\_\_\_

The effective date of this initial maintenance contract shall be the date license to operate is issued.

Greg W. Johnson, P.E.  
170 Hollow Oak  
New Braunfels, Texas 78132  
830/905-2778

July 18, 2019

Comal County Office of Environmental Health  
195 David Jonas Drive  
New Braunfels, Texas 78132-3760

RE- SEPTIC DESIGN  
2130 FRANCISCO PASS  
CORDOVA BEND AT CANYON LAKE, UNIT 1, LOT 7  
CANYON LAKE, TX 78133  
DORNBURG RESIDENCE

RECEIVED

AUG 06 2019

Ms. Brenda Ritzen/Sandra Hernandez,

COUNTY ENGINEER

The referenced property is located within the Edwards Aquifer Contributing Zone. This OSSF design will comply with requirements in the CZP.

Temporary erosion and sedimentation controls should be utilized as necessary prior to construction. If any sensitive feature (caves, solution cavities, sink holes, etc.) is discovered during construction, activities must be suspended immediately and the applicant or his agent must immediately notify the TCEQ Regional Office. After that operations can only proceed after the Executive Director approves required additional engineered impact plans.

Designed in accordance with Chapter 285, Subchapter D, §285.40, 285.41, & 285.42, Texas Commission on Environmental Quality (Effective December 29, 2016).

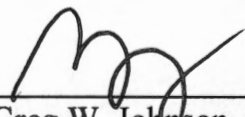
 07/18/19  
\_\_\_\_\_  
Greg W. Johnson, P.E. No. 67587 / F#2585  
170 Hollow Oak  
New Braunfels, Texas 78132 - 830/905-2778



**ON-SITE SEWERAGE FACILITY  
SOIL EVALUATION REPORT INFORMATION**

Date Soil Survey Performed: July 17, 2019

Site Location: CORDOVA BEND at CANYON LAKE, UNIT 1, LOT 7

Proposed Excavation Depth: N/A

**Requirements:**

At least two soil excavations must be performed on the site, at opposite ends of the proposed disposal area. Locations of soil boring or dug pits must be shown on the site drawing. For subsurface disposal, soil evaluations must be performed to a depth of at least two feet below the proposed excavation depth. For surface disposal, the surface horizon must be evaluated. Describe each soil horizon and identify any restrictive features on the form. Indicate depths where features appear.

RECEIVED  
AUG 06 2019

SOIL BORING NUMBER		SURFACE EVALUATION					COUNTY ENGINEER
Depth (Feet)	Texture Class	Soil Texture	Gravel Analysis	Drainage (Mottles/ Water Table)	Restrictive Horizon	Observations	
0	IV	CLAY	N/A	NONE OBSERVED	LIMESTONE @ 10"	BROWN	
1							
2							
3							
4							
5							

SOIL BORING NUMBER		SURFACE EVALUATION				
Depth (Feet)	Texture Class	Soil Texture	Gravel Analysis	Drainage (Mottles/ Water Table)	Restrictive Horizon	Observations
0	SAME		AS		ABOVE	
1						
2						
3						
4						
5						

I certify that the findings of this report are based on my field observations and are accurate to the best of my ability.

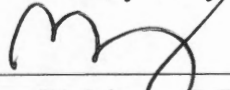
  
\_\_\_\_\_  
Greg W. Johnson, P.E. 67587-F2585, S.E. 11561

07/17/19  
\_\_\_\_\_  
Date

# OSSF SOIL EVALUATION REPORT INFORMATION

Date: July 18, 2019

## Applicant Information:

Name: HEATHER & BLAKE DORNBURG  
Address: c/o 6581 F.M. 306  
City: NEW BRAUNFELS State: TEXAS  
Zip Code: 78130 Phone: (830) 629-4663

## Site Evaluator Information:

Name: Greg W. Johnson, P.E., R.S., S.E. 11561  
Address: 170 Hollow Oak  
City: New Braunfels State: Texas  
Zip Code: 78132 Phone & Fax (830)905-2778

## Property Location:

Lot 7 Unit 1 Blk      Subd. CORDOVA BEND at CANYON LAKE  
Street Address: 2130 FRANCISCO PASS  
City: CANYON LAKE Zip Code: 78133  
Additional Info.:     

## Installer Information:

Name:       
Company:       
Address:       
City:      State:       
Zip Code:      Phone     

**Topography:** Slope within proposed disposal area: 3 %  
Presence of 100 yr. Flood Zone: YES      NO X  
Existing or proposed water well in nearby area: YES      NO X  
Presence of adjacent ponds, streams, water impoundments: YES      NO X  
Presence of upper water shed: YES      NO X  
Organized sewage service available to lot: YES      NO X

## Design Calculations for Aerobic Treatment with Spray Irrigation:

### Commercial

Q =      GPD

**Residential** Water conserving fixtures to be utilized? Yes X No     

Number of Bedrooms the septic system is sized for: 4 Total sq. ft. living area 2800

Q gal/day = (Bedrooms +1) \* 75 GPD - (20% reduction for water conserving fixtures)

Q = (4 +1)\*75-(20%)= 300

Trash Tank Size 376 Gal.

TCEQ Approved Aerobic Plant Size 600 G.P.D.

Req'd Application Area = Q/Ri = 300 / 0.064 = 4688 sq. ft.

Application Area Utilized = 5654 sq. ft.

Pump Requirement 12 Gpm @ 41 Psi (Redjacket 0.5 HP 18 G.P.M. series or equivalent)

Dosing Cycle:      ON DEMAND or X TIMED TO DOSE IN PREDAWN HOURS

Pump Tank Size = 778 Gal. 18.75 Gal/inch.

Reserve Requirement = 100 Gal. 1/3 day flow.

Alarms: Audible & Visual High Water Alarm & Visual Air Pump malfunction

With Chlorinator NSF/TCEQ APPROVED

SCH-40 or SDR-26 3" or 4" sewer line to tank

Two way cleanout

Pop-up rotary sprinkler heads w/ purple non-potable lids

1" Sch-40 PVC discharge manifold

APPLICATION AREA SHOULD BE SEEDED AND MAINTAINED WITH VEGETATION.

I HAVE PERFORMED A THOROUGH INVESTIGATION BEING A REGISTERED PROFESSIONAL ENGINEER AND SITE EVALUATOR IN ACCORDANCE WITH CHAPTER 285, SUBCHAPTER D, §285.30, & §285.40 (REGARDING RECHARGE FEATURES), TEXAS COMMISSION OF ENVIRONMENTAL QUALITY (EFFECTIVE DECEMBER 29, 2016)

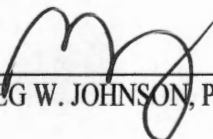
  
GREG W. JOHNSON, P.E. F#002585 - S.E. 11561

07/18/19  
DATE

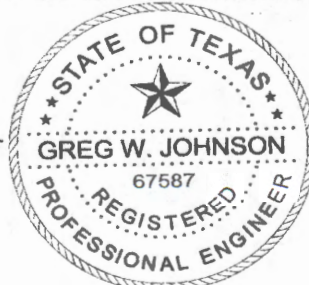

RECEIVED

AUG 06 2019

COUNTY ENGINEER

FIRM #2585



LOT 7

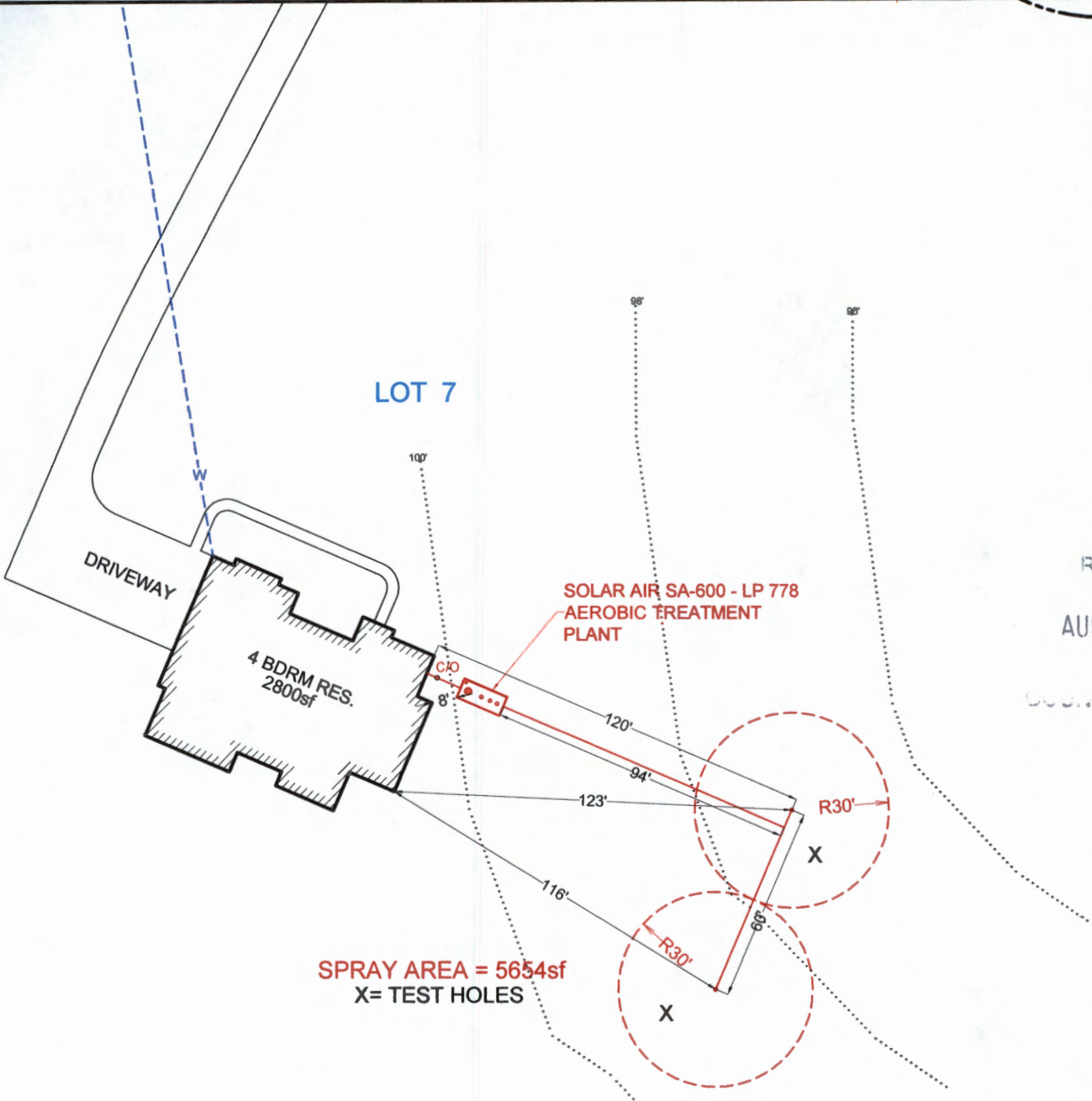

RECEIVED  
AUG 06 2019

SPRAY AREA = 5654sf  
X= TEST HOLES

517.06'



OWNER: HEATHER & BLAKE DORNBURG		DRAWN BY: EJS III	
STREET ADDRESS: 2130 FRANCISCO PASS			
LEGAL DESC: CORDOVA BEND at CANYON LAKE	UNIT/SECTION/PHASE: 1	BLOCK:	LOT: 7
PREPARED BY: GREG W. JOHNSON, P.E. F#002585	SCALE: 1"=50'	DATE: 7/18/2019	REVISED:

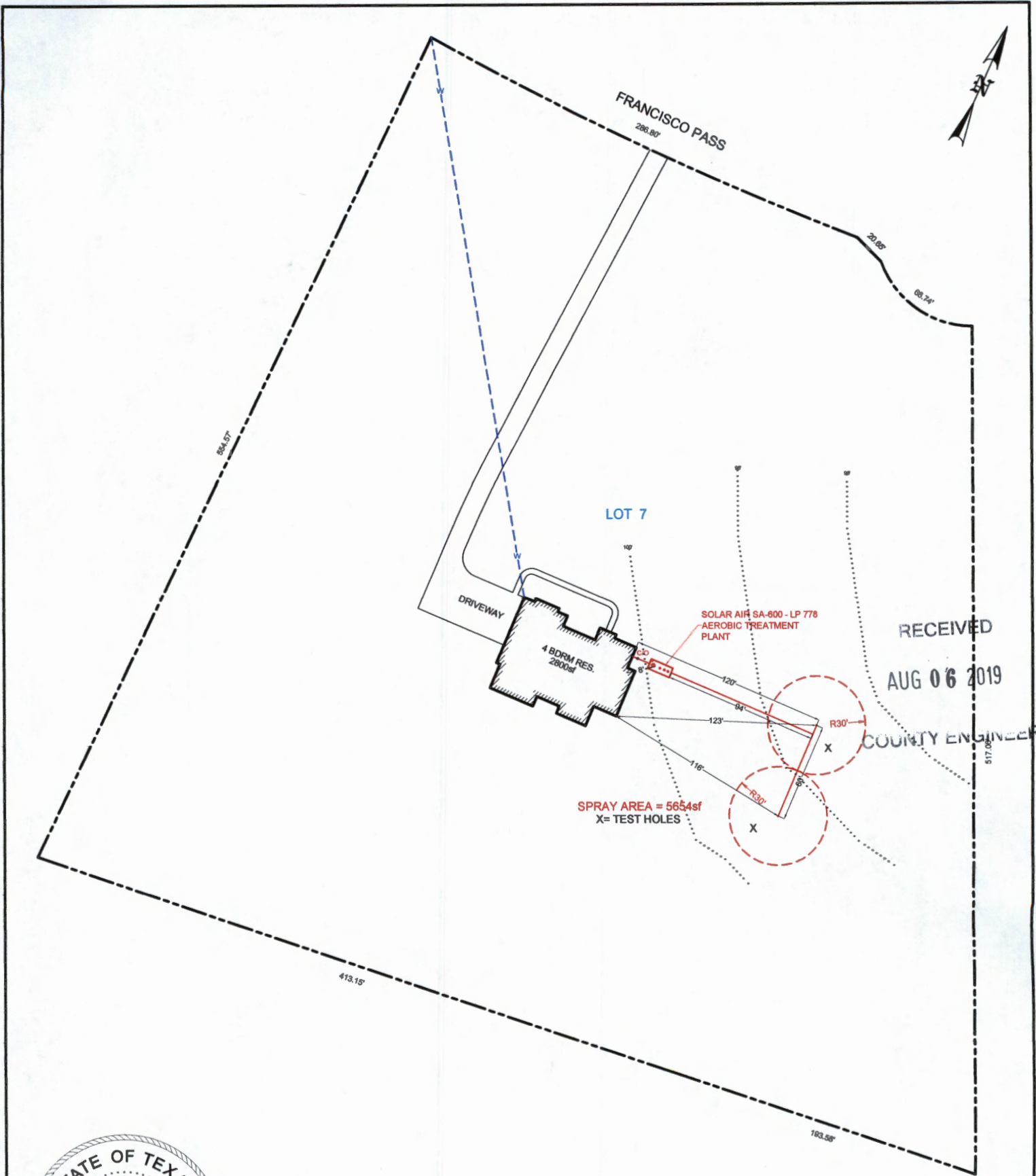

OWNER: HEATHER & BLAKE DORNBURG		DRAWN BY: EJS III	
STREET ADDRESS: 2130 FRANCISCO PASS			
LEGAL DESC: CORDOVA BEND at CANYON LAKE	UNIT/SECTION/PHASE: 1	BLOCK:	LOT: 7
PREPARED BY: GREG W. JOHNSON, P.E. F#002585	SCALE: 1"=80'	DATE: 7/18/2019	REVISED:

**TANK NOTES:**

Tanks must be set to allow a minimum of 1/8" per foot fall from the residence.

Tightlines to the tank shall be SCH-40 PVC.

A two way sanitary tee is required between residence and tank.

A minimum of 4" of sand, sandy loam, clay loam free of rock shall be placed under and around tanks

RECEIVED

AUG 06 2019

COUNTY ENGINEER

ALL WIRING MUST BE IN COMPLIANCE WITH THE MOST RECENT NATIONAL ELECTRIC CODE

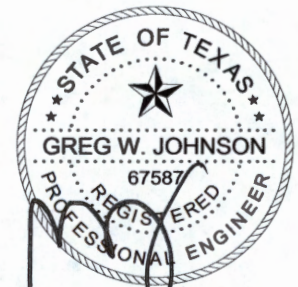
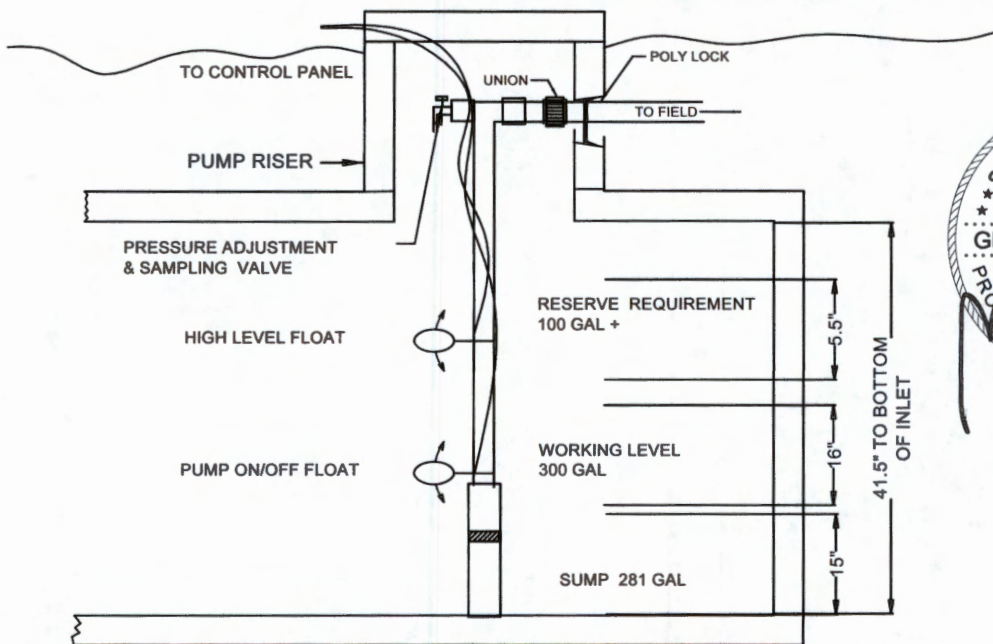

F#2585

07/18/19

**TYPICAL PUMP TANK CONFIGURATION  
SOLAR-AIR SA-600 LP 778 GAL PUMP TANK**





354



CONTINUED ON MAP 353

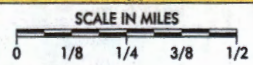

Alamo Title Co. GP# 400011800251

**NOTICE OF CONFIDENTIALITY RIGHTS.** IF YOU ARE A NATURAL PERSON, YOU MAY REMOVE OR STRIKE ANY OR ALL OF THE FOLLOWING INFORMATION FROM ANY INSTRUMENT THAT TRANSFERS AN INTEREST IN REAL PROPERTY BEFORE IT IS FILED FOR RECORD IN THE PUBLIC RECORDS: YOUR SOCIAL SECURITY NUMBER OR YOUR DRIVER'S LICENSE NUMBER.

**GENERAL WARRANTY DEED**

STATE OF TEXAS

§  
§  
§

KNOW ALL MEN BY THESE PRESENTS:

COUNTY OF COMAL

RECEIVED

Date: April 20, 2018

AUG 06 2019

Grantor: HUTCHEN MORGAN HAMMOND, III and MELISSA HAMMOND, husband and wife

COUNTY ENGINEER

Grantor's Mailing Address:

209 Enchanted View  
Gibola, TX 78108  
Guadalupe County

Grantee: HEATHER DORNBURG and BLAKE DORNBURG

Grantee's Mailing Address:

2425 OAK VALLEY  
New Braunfels TX 78132  
Comal County

Consideration:

TEN AND NO/100 DOLLARS (\$10.00) and other good and valuable consideration.

Property (including any improvements):

Lot 7, Cordova Bend a Canyon Lake, Unit One, a subdivision in Comal County, Texas, according to the plat thereof recorded in Document No. 200606023875, of the Map and Plat Records of Comal County, Texas.

Reservations from Conveyance: None.

Exceptions to Conveyance and Warranty:

This conveyance is made and accepted subject to conditions, restrictions, reservations, declarations, exceptions, easements grants, set-backs, assessments, maintenance and / or association charges and ordinances, affecting the property conveyed, if any, appearing in the public records; and all leases, grants, exceptions or reservations of coal, lignite, oil, gas and other minerals, together with all rights, privileges, and immunities relating thereto,

appearing in the Public Records; and standby fees, taxes, and assessments by any taxing authority for the 2018 tax year, and subsequent taxes and assessments by any taxing authority for prior years due to change in land usage or ownership.

Grantee, by its acceptance hereof, agrees to be solely responsible for payment of all ad valorem taxes pertaining to the Property for the calendar year 2018 and subsequent years.

Grantor, for the Consideration and subject to the Reservations from Conveyance and the Exceptions to Conveyance and Warranty, GRANTS, SELLS, and CONVEYS to Grantee the Property, together with all and singular the rights and appurtenances thereto in any way belonging, to have and to hold it to Grantee and Grantee's heirs, successors, and assigns forever. Grantor binds Grantor and Grantor's heirs and successors to WARRANT AND FOREVER DEFEND all and singular the Property to Grantee and Grantee's heirs, successors, and assigns against every person whomsoever lawfully claiming or to claim the same or any part thereof, except as to the Reservations from Conveyance and the Exceptions to Conveyance and Warranty.

When the context requires, singular nouns and pronouns include the plural.

[signature(s) on following page(s)]

RECEIVED

AUG 06 2019

COUNTY ENGINEER

UNOFFICIAL

Executed effective as of the date first set forth herein.

**GRANTOR:**

[Signature]  
HUTCHEN MORGAN HAMMOND, III

[Signature]  
MELISSA HAMMOND

STATE OF Brewster §  
COUNTY OF Normal §

This instrument was acknowledged before me on April 20, 2018, by HUTCHEN MORGAN HAMMOND, III, an individual.

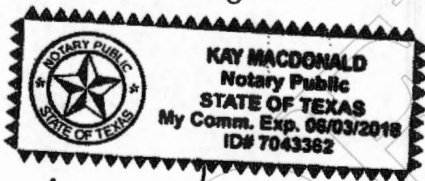

[Signature]  
Notary Public, State of \_\_\_\_\_

RECEIVED  
AUG 06 2019

COUNTY ENGINEER

STATE OF Brewster §  
COUNTY OF Normal §

This instrument was acknowledged before me on April 20, 2018, by MELISSA HAMMOND, an individual.

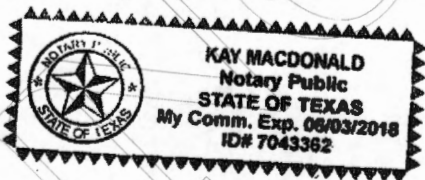

[Signature]  
Notary Public, State of \_\_\_\_\_

Filed and Recorded  
Official Public Records  
Bobbie Koepf, County Clerk  
Comal County, Texas  
04/20/2018 03:13:04 PM  
LAURA 3 Pages(s)  
201806015255

**AFTER RECORDING RETURN TO:**  
HEATHER DORNBURG and BLAKE DORNBURG

After Recording Return to:  
Alamo Title Company  
494 South Seguin St., Ste 100  
New Braunfels, TX 78130



Bobbie Koepf

**Aerobic Services of South Texas**  
**15188 FM 306**  
**Canyon Lake, TX 78133**



**MAILED**

**ENTERED**

(830) 964-2365  
 Fax: (830) 964-2659  
 www.aerobicsservices.com  
**Permit #: 109537**

**To: Heather & Blake Dornburg**  
**2130 Francisco Pass**  
**Canyon Lake, TX 78133**

Tech: Not Assigned  
 Brand/Mfg.: Solar Aerobic 600LP 444 -  
 System S/N:  
 Aerator and S/N:

Site: 2130 Francisco Pass, Canyon Lake  
 Agency: Comal County Environmental Health  
 County: Comal  
 Subdivision: Cordova Bend @ Canyon Lake

Installed: 10/14/2019  
 Phone: (210) 889-7202  
 Cell: (210) 215-6584  
 Work:

Contract: 10/17/2019 - 10/17/2021  
 Inspections per year: 3  
 Service Due: **2/17/2020**  
 Alt Phone:  
 Warranty Ending: 10/14/2021

Inspection Type: scheduled Insp

Item	Operational	Inoperative	N/A
Aerator:	<u>/</u>	<u>    </u>	<u>    </u>
Irrigation pump:	<u>/</u>	<u>    </u>	<u>    </u>
Air compressor:	<u>/</u>	<u>    </u>	<u>    </u>
Disinfection device:	<u>/</u>	<u>    </u>	<u>    </u>
Chlorine supply:	<u>/</u>	<u>    </u>	<u>    </u>
Spray field vegetation:	<u>/</u>	<u>    </u>	<u>    </u>
Sprinkler / Drip backwash:	<u>/</u>	<u>    </u>	<u>    </u>
Controls/ Electric Circuits	<u>    </u>	<u>    </u>	<u>    </u>

Air Pressure 40

Test Results and observations: (As Required)

Chlorine Residual: 0.40  
 Test Method: DPD  
 BOD:       
 TSS:       
 Access Ports Secured YES / NO  
 Repairs made: YES / NO

Mixed Liquor Aeration 0  
 Sludge Levels Clarifier 0  
 Pump 0

Repairs and Comments: set timer

**RECEIVED**

**DEC 30 2019**

Inspector: Seth  
 Tom Hampton VP  
 MP349/OS24597

Date: 12-19-19

**COUNTY ENGINEER**

Area: / 0  
 GPS:

ID = 61115393

Printed: 12/16/2019

2130 Francisco Pass, Canyon Lake

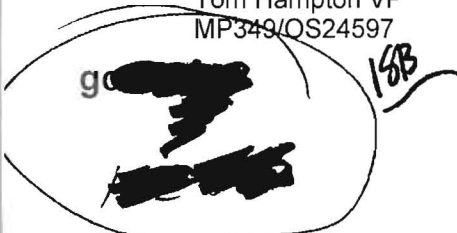

3100 S. 1st St. Suite 100  
Canyon Lake, TX 75825

ENTERED

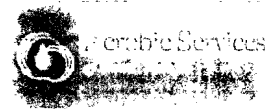

Phone: (830) 964-2336

Fax: (830) 964-2356

www.solaraerobicservices.com

Registration # 0000000000

Printed: 4/3/2020

3100 S. 1st St. Suite 100  
Canyon Lake, TX 75825

2130 Francisco Pass  
Canyon Lake, TX 75825

Tech: Not Assigned  
Brand/wfg.: Solar Aerobic 600LP 444 -  
System S/N:  
Aerator and S/N

Contract: 10/17/2019 - 10/17/202

Inspections per year 3

Service Due: 4/17/2020

Alt Phone:

(2)

Agency: Comal County Environmental Health

County: Comal

Subdivision: Cordova Bend @ Canyon Lake

Installed: 10/14/2019

Phone: (210) 889-7202

Cell: (210) 215-6584

Work:

Inspection Type: Scheduled

Item	Operational	Inoperative	N/A
Aerator:	<u>/</u>	<u>/</u>	<u>/</u>
Irrigation pump:	<u>/</u>	<u>/</u>	<u>/</u>
Air compressor:	<u>/</u>	<u>/</u>	<u>/</u>
Disinfection device:	<u>/</u>	<u>/</u>	<u>/</u>
Chlorine supply:	<u>/</u>	<u>/</u>	<u>/</u>
Spray field vegetation:	<u>/</u>	<u>/</u>	<u>/</u>
Sprinkler / Drip backwash:	<u>/</u>	<u>/</u>	<u>/</u>
Controls/ Electric Circuits	<u>/</u>	<u>/</u>	<u>/</u>

Air Pressure 60

Test Results and observations: (As Required)

Chlorine Residual: 0.72

Test Method: DW

BOD: /

TSS: /

Access Ports Secured YES / NO

Repairs made: YES / NO

Mixed Liquor 0  
Aeration 0  
Sludge Levels 0  
Clarifier /  
Pump /

Repairs and Comments:

Inspector: Ricky

Tom Hampton VP  
MP349/OS24597

Date: 4/25/20

Area: / 0

GPS:

ID = 61115393

2130 Francisco Pass, Canyon Lake

Aerobic Services of South Texas  
15188 FM 306  
Canyon Lake, TX 78133

ENTERED



MAILED

Phone: (830) 964-2365  
Fax: (830) 964-2659  
www.aerobicservices.com  
Permit #: 109537

Printed: 7/8/2020

To: Heather & Blake Dornburg  
2130 Francisco Pass  
Canyon Lake, TX 78133

Tech: Not Assigned  
Brand/Mfg.: Solar Aerobic 600LP 444 -  
System S/N:  
Aerator and S/N:

Installed: 10/14/2019  
Phone: (210) 889-7202  
Cell: (210) 215-6584  
Work:

Contract: 10/17/2019 - 10/17/2021  
Inspections per year: 3  
Service Due: 8/17/2020  
Alt Phone:

Agency: Comal County Environmental Health  
County: Comal  
Subdivision: Cordova Bend @ Canyon Lake

Inspection Type: Scheduled

Item	Operational	Inoperative	N/A
Aerator:	<input checked="" type="checkbox"/>	<input type="checkbox"/>	<input type="checkbox"/>
Irrigation pump:	<input checked="" type="checkbox"/>	<input type="checkbox"/>	<input type="checkbox"/>
Air compressor:	<input checked="" type="checkbox"/>	<input type="checkbox"/>	<input type="checkbox"/>
Disinfection device:	<input checked="" type="checkbox"/>	<input type="checkbox"/>	<input type="checkbox"/>
Chlorine supply:	<input checked="" type="checkbox"/>	<input type="checkbox"/>	<input type="checkbox"/>
Spray field vegetation:	<input checked="" type="checkbox"/>	<input type="checkbox"/>	<input type="checkbox"/>
Sprinkler / Drip backwash:	<input checked="" type="checkbox"/>	<input type="checkbox"/>	<input type="checkbox"/>
Controls/ Electric Circuits	<input checked="" type="checkbox"/>	<input type="checkbox"/>	<input type="checkbox"/>

Air Pressure 60

Test Results and observations: (As Required)  
Chlorine Residual: 0.50  
Test Method: DPD  
BOD: \_\_\_\_\_  
TSS: \_\_\_\_\_  
Access Ports Secured YES / NO  
Repairs made: YES / NO

Mixed Liquor 0  
Aeration 0  
Sludge Levels 0  
Clarifier 0  
Pump 1

Repairs and Comments:

Inspector: Tom Hampton  
Tom Hampton VP  
MP349/OS24597

Date: 8/28/20

GC 12345

Area: / 0  
GPS:

ID = 61115393

2130 Francisco Pass, Canyon Lake

**Aerobic Services of South Texas**  
**15188 FM 306**  
**Canyon Lake, TX 78133**

ENTERED

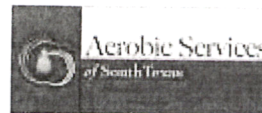

Phone: (830) 964-2365  
 Fax: (830) 964-2659  
 www.aerobicservices.com  
**Permit #: 109537**

Printed: 9/22/2020

MAILED

**To: Heather & Blake Dornburg**  
**2130 Francisco Pass**  
**Canyon Lake, TX 78133**

Tech: Not Assigned  
 Brand/Mfg.: Solar Aerobic 600LP 444 -  
 System S/N:  
 Aerator and S/N:

Agency: Comal County Environmental Health  
 County: Comal  
 Subdivision: Cordova Bend @ Canyon Lake

Installed: 10/14/2019  
 Phone: (210) 889-7202  
 Cell: (210) 215-6584  
 Work:

Contract: 10/17/2019 - 10/17/2021  
 Inspections per year: 3  
 Service Due: **12/17/2020**  
 Alt Phone: (4)

Inspection Type: Scheduled

Item	Operational	Inoperative	N/A
Aerator:	<u>/</u>	<u>    </u>	<u>    </u>
Irrigation pump:	<u>/</u>	<u>    </u>	<u>    </u>
Air compressor:	<u>/</u>	<u>    </u>	<u>    </u>
Disinfection device:	<u>/</u>	<u>    </u>	<u>    </u>
Chlorine supply:	<u>/</u>	<u>    </u>	<u>    </u>
Spray field vegetation:	<u>/</u>	<u>    </u>	<u>    </u>
Sprinkler / Drip backwash:	<u>/</u>	<u>    </u>	<u>    </u>
Controls/ Electric Circuits	<u>/</u>	<u>    </u>	<u>    </u>

Air Pressure 40

Test Results and observations: (As Required)  
 Chlorine Residual: 0.91  
 Test Method: DPD  
 BOD: \_\_\_\_\_  
 TSS: \_\_\_\_\_

Mixed Liquor Aeration 2  
 Sludge Levels Clarifier 18  
 Pump 2

Access Ports Secured YES / NO  
 Repairs made: YES / NO

Repairs and Comments:

Inspector: Mark  
 Tom Hampton VP  
 MP349/OS24597

Date: 12-14-20

GC ~~122816~~

Area: / 0  
 GPS: ID = 61115393

2130 Francisco Pass, Canyon Lake



**Aerobic Services of South Texas**  
**15188 FM 306**  
**Canyon Lake, TX 78133**

ENTERED

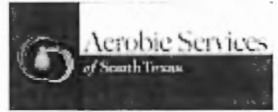

Phone: (830) 964-2365  
 Fax: (830) 964-2659  
 www.aerobicservices.com  
**Permit #: 109537**

Printed: 3/30/2021

**To: Heather & Blake Dornburg**  
**2130 Francisco Pass**  
**Canyon Lake, TX 78133**

Tech: Not Assigned  
 Brand/Mfg.: Solar Aerobic 600LP 444 -  
 System S/N:  
 Aerator and S/N:

Agency: Comal County Environmental Health  
 County: Comal  
 Subdivision: Cordova Bend @ Canyon Lake

Installed: 10/14/2019  
 Phone: (210) 889-7202  
 Cell: (210) 215-6584  
 Work:

Contract: 10/17/2019 - 10/17/2021  
 Inspections per year: 3  
 Service Due: 4/17/2021  
 Alt Phone: 5

Inspection Type: Scheduled

Item	Operational	Inoperative	N/A
Aerator:	<u>/</u>	<u>    </u>	<u>    </u>
Irrigation pump:	<u>/</u>	<u>    </u>	<u>    </u>
Air compressor:	<u>/</u>	<u>    </u>	<u>    </u>
Disinfection device:	<u>/</u>	<u>    </u>	<u>    </u>
Chlorine supply:	<u>/</u>	<u>    </u>	<u>    </u>
Spray field vegetation:	<u>/</u>	<u>    </u>	<u>    </u>
Sprinkler / Drip backwash:	<u>/</u>	<u>    </u>	<u>    </u>
Controls/ Electric Circuits	<u>/</u>	<u>    </u>	<u>    </u>

Air Pressure 50

Test Results and observations: (As Required)  
 Chlorine Residual: 1.42  
 Test Method: Rpd  
 BOD: \_\_\_\_\_  
 TSS: \_\_\_\_\_  
 Access Ports Secured YES / NO  
 Repairs made: YES / NO

Mixed Liquor  
 Aeration 0  
 Sludge Levels  
 Clarifier 14  
 Pump 6

Repairs and Comments:  
low on chlorine / please treat for ants around  
compressor

Inspector: nmvk  
 Tom Hampton VP  
 MP349/OS24597

Date: 5-3-21

GC 1 XXXXXXXXXX

Area: / 0  
 GPS: ID = 61115393

2130 Francisco Pass, Canyon Lake

**Aerobic Services of South Texas**  
**15188 FM 306**  
**Canyon Lake, TX 78133**

**ENTERED**

**ENTERED**

Phone: (830) 964-2365  
 Fax: (830) 964-2659  
 www.aerobicservices.com  
**Permit #: 109537**

Printed: 6/17/2021

**To: Heather & Blake Dornburg**  
**2130 Francisco Pass**  
**Canyon Lake, TX 78133**

Tech: Not Assigned  
 Brand/Mfg.: Solar Aerobic 600LP 444 -  
 System S/N:  
 Aerator and S/N:

Installed: 10/14/2019  
 Phone: (210) 889-7202  
 Cell: (210) 215-6584  
 Work:

Contract: 10/17/2019 - 10/17/2021  
 Inspections per year: 3  
 Service Due: 8/17/2021  
 Alt Phone:

Agency: Comal County Environmental Health  
 County: Comal  
 Subdivision: Cordova Bend @ Canyon Lake

Ⓢ ✓

Inspection Type: Scheduled

Item	Operational	Inoperative	N/A
Aerator:	<u>_____</u>	<u>_____</u>	<u>_____</u>
Irrigation pump:	<u>_____</u>	<u>_____</u>	<u>_____</u>
Air compressor:	<u>_____</u>	<u>_____</u>	<u>_____</u>
Disinfection device:	<u>_____</u>	<u>_____</u>	<u>_____</u>
Chlorine supply:	<u>_____</u>	<u>_____</u>	<u>_____</u>
Spray field vegetation:	<u>_____</u>	<u>_____</u>	<u>_____</u>
Sprinkler / Drip backwash:	<u>_____</u>	<u>_____</u>	<u>_____</u>
Controls/ Electric Circuits	<u>_____</u>	<u>_____</u>	<u>_____</u>

Air Pressure 60

Test Results and observations: (As Required)  
 Chlorine Residual: 0.53  
 Test Method: DO  
 BOD: \_\_\_\_\_  
 TSS: \_\_\_\_\_  
 Access Ports Secured YES / NO  
 Repairs made: YES / NO

Mixed Liquor  
 Aeration 0  
 Sludge Levels  
 Clarifier 12  
 Pump 5

Repairs and Comments:

Inspector: Tom Hampton  
 Tom Hampton VP  
 MP349/OS24597

Date: 6/18/21

GC ~~\_\_\_\_\_~~

Area: / 0  
 GPS:  
 ID = 61115393

2130 Francisco Pass, Canyon Lake