



COMAL COUNTY

ENGINEER'S OFFICE

License to Operate On-Site Sewage Treatment and Disposal Facility

Issued This Date: 12/31/2019 Permit Number: 109678

Location Description: 1052 EASTVIEW DR
CANYON LAKE, TX 78133

Subdivision: Canyon Lake Forest
Unit: 2
Lot: 780
Block:
Acreage:

Type of System: Aerobic
Drip Irrigation

Issued to: Roger Borremans / Eloina Guerrero

This license is authorization for the owner to operate and maintain a private facility at the location described in accordance to the rules and regulations for on-site sewerage facilities of Comal County, Texas, and the Texas Commission on Environmental Quality.

The license grants permission to operate the facility. It does not guarantee successful operation. It is the responsibility of the owner to maintain and operate the facility in a satisfactory manner.

Alterations to this permit including, but not limited to:

- Increase in the square feet of living area
- Increase in the number of bedrooms
- A change of use (i.e. residential to commercial)
- Relocation of system components (including the relocation of spray heads)
- Installation of landscaping
- Adding new structures to the system

may require a new permit. **It is the responsibility of the owner to apply for a new permit, if applicable.**

Inspection and licensing of a facility indicates only that the facility meets certain minimum requirements. It does not impede any governmental entity in taking the proper steps to prevent or control pollution, to abate nuisance, or to protect the public health.

This license to operate is valid for an indefinite period. The holder may transfer it to a succeeding owner, provided the facility has not been remodeled and is functioning properly.

Licensing Authority

Comal County Environmental Health

OS0034792
ENVIRONMENTAL HEALTH INSPECTOR

OS0007722
ENVIRONMENTAL HEALTH COORDINATOR

Comal County Environmental Health OSSF Inspection Sheet

Installer Name: Countryside OSSF Installer #: 050002929
 1st Inspection Date: 10/15/19 2nd Inspection Date: 10-17-19 3rd Inspection Date: 10 12-31-2019
 Inspector Name: Mike T. Inspector Name: Connor Inspector Name: B. Olvera
 Permit#: 109678 Address: C.L. Forest / 1052 Eastview Dr.

No.	Description	Answer	Citations	Notes	1st Insp.	2nd Insp.	3rd Insp.
1	SITE AND SOIL CONDITIONS & SETBACK DISTANCES Site and Soil Conditions Consistent with Submitted Planning Materials	/	285.31(a) 285.30(b)(1)(A)(iv) 285.30(b)(1)(A)(v) 285.30(b)(1)(A)(iii) 285.30(b)(1)(A)(ii) 285.30(b)(1)(A)(i)		10/15/19		12-31-19
2	SITE AND SOIL CONDITIONS & SETBACK DISTANCES Setback Distances Meet Minimum Standards	/	285.91(10) 285.30(b)(4) 285.31(d)				
3	SEWER PIPE Proper Type Pipe from Structure to Disposal System (Cast Iron, Ductile Iron, Sch. 40, SDR 26)	/	285.32(a)(1)				
4	SEWER PIPE Slope from the Sewer to the Tank at least 1/8 Inch Per Foot	/	285.32(a)(3)				
5	SEWER PIPE Two Way Sanitary - Type Cleanout Properly Installed (Add. C/O Every 100' &/or 90 degree bends)	/	285.32(a)(5)				
6	PRETREATMENT Installed (if required) TCEQ Approved List PRETREATMENT Septic Tank(s) Meet Minimum Requirements		285.32(b)(1)(G)285.32(b)(1)(E)(iii) 285.32(b)(1)(E)(iv) 285.32(b)(1)(F) 285.32(b)(1)(B) 285.32(b)(1)(C)(i) 285.32(b)(1)(C)(ii) 285.32(b)(1)(D) 285.32(b)(1)(E) 285.32(b)(1)(A) 285.32(b)(1)(E)(ii)(ii) 285.32(b)(1)(E)(i) 285.32(b)(1)(E)(ii)(i)				
7	PRETREATMENT Grease Interceptors if required for commercial		285.34(d)				

MT-10/15/19
Tank set, leveled

10-17-19 -JC
operational
cover field

12-31-2019 BMO
Covered

**Comal County Environmental Health
OSSF Inspection Sheet**

No.	Description	Answer	Citations	Notes	1st Insp.	2nd Insp.	3rd Insp.
8	SEPTIC TANK Tank(s) Clearly Marked SEPTIC TANK If Single Tank, 2 Compartments Provided with Baffle SEPTIC TANK Inlet Flowline Greater than 3" and " T " Provided on Inlet and Outlet SEPTIC TANK Septic Tank(s) Meet Minimum Requirements		285.32(b)(1)(E) 285.91(2) 285.32(b)(1)(F) 285.32(b)(1)(E)(iii) 285.32(b)(1)(E)(ii)(II) 285.32(b)(1)(E)(ii)(I) 285.32(b)(1)(E)(i) 285.32(b)(1)(D) 285.32(b)(1)(C)(ii) 285.32(b)(1)(C)(i) 285.32(b)(1)(B) 285.32(b)(1)(A) 285.32(b)(1)(E)(iv)				
9	ALL TANKS Installed on 4" Sand Cushion/ Proper Backfill Used		285.32(b)(1)(F) 285.32(b)(1)(G) 285.34(b)				12-31-19
10	SEPTIC TANK Inspection / Clean Out Port & Risers Provided on Tanks Buried Greater than 12" Sealed and Capped		285.38(d)				
11	SEPTIC TANK Secondary restraint system provided SEPTIC TANK Riser permanently fastened to lid or cast into tank SEPTIC TANK Riser cap protected against unauthorized intrusions		285.38(d) 285.38(e)				
12	SEPTIC TANK Tank Volume Installed						
13	PUMP TANK Volume Installed						
14	AEROBIC TREATMENT UNIT Size Installed	✓		600	10/15/19		
15	AEROBIC TREATMENT UNIT Manufacturer AEROBIC TREATMENT UNIT Model Number	✓		Clearstream	/		
16	DISPOSAL SYSTEM Absorptive		285.33(a)(4) 285.33(a)(1) 285.33(a)(2) 285.33(a)(3)				
17	DISPOSAL SYSTEM Leaching Chamber		285.33(a)(1) 285.33(a)(3) 285.33(a)(4) 285.33(a)(2)				
18	DISPOSAL SYSTEM Evapo-transpirative		285.33(a)(3) 285.33(a)(4) 285.33(a)(1) 285.33(a)(2)				

**Comal County Environmental Health
OSSF Inspection Sheet**

No.	Description	Answer	Citations	Notes	1st Insp.	2nd Insp.	3rd Insp.
19	DISPOSAL SYSTEM Drip Irrigation	/	285.33(c)(3)(A)-(F)			/	12-31-19
20	DISPOSAL SYSTEM Soil Substitution		285.33(d)(4)				
21	DISPOSAL SYSTEM Pumped Effluent		285.33(a)(3) 285.33(a)(1) 285.33(a)(2)				
22	DISPOSAL SYSTEM Gravelless Pipe		285.33(a)(3) 285.33(a)(2) 285.33(a)(4) 285.33(a)(1)				
23	DISPOSAL SYSTEM Mound		285.33(a)(3) 285.33(a)(1) 285.33(a)(2) 285.33(a)(4)				
24	DISPOSAL SYSTEM Other (describe) (Approved Design)		285.33(d)(6) 285.33(c)(4)				
25	DRAINFIELD Absorptive Drainline 3" PVC or 4" PVC						
26	DRAINFIELD Area Installed	/		<i>per plan</i>			
27	DRAINFIELD Level to within 1 inch per 25 feet and within 3 inches over entire excavation		285.33(b)(1)(A)(v)				
28	DRAINFIELD Excavation Width DRAINFIELD Excavation Depth DRAINFIELD Excavation Separation DRAINFIELD Depth of Porous Media DRAINFIELD Type of Porous Media						
29	DRAINFIELD Pipe and Gravel - Geotextile Fabric in Place		285.33(b)(1)(E)				
30	DRAINFIELD Leaching Chambers DRAINFIELD Chambers - Open End Plates w/Splash Plate, Inspection Port & Closed End Plates in Place (per manufacturers spec.)		285.33(c)(2)				
31	LOW PRESSURE DISPOSAL SYSTEM Adequate Trench Length & Width, and Adequate Separation Distance between Trenches		285.33(d)(1)(C)(i)				

**Comal County Environmental Health
OSSF Inspection Sheet**

No.	Description	Answer	Citations	Notes	1st Insp.	2nd Insp.	3rd Insp.
	<p>EFFLUENT DISPOSAL SYSTEM Utilized Only by Single Family Dwelling</p> <p>EFFLUENT DISPOSAL SYSTEM Topographic Slopes < 2.0%</p> <p>EFFLUENT DISPOSAL SYSTEM Adequate Length of Drain Field (1000 Linear ft. for 2 bedrooms or Less & an additional 400 ft. for each additional bedroom)</p> <p>EFFLUENT DISPOSAL SYSTEM Lateral Depth of 18 inches to 3 ft. & Vertical Separation of 1ft on bottom and 2 ft. to restrictive horizon and ground water respectfully</p> <p>EFFLUENT DISPOSAL SYSTEM Lateral Drain Pipe (1.25 - 1.5" dia.) & Pipe Holes (3/16 - 1/4" dia. Hole Size) 5 ft. Apart</p>		<p>285.33(b)(3)(A)</p> <p>285.33(b)(3)(A)</p> <p>285.33(b)(3)(B)</p> <p>285.91(13)</p> <p>285.33(b)(3)(D)</p> <p>285.33(b)(3)(F)</p>				
32	AEROBIC TREATMENT UNIT is Aerobic Unit Installed According to Approved Guidelines.	/	285.32(c)(1)		/		12-31-19
33	AEROBIC TREATMENT UNIT Inspection/Clean Out Port & Risers Provided	/			/		
	AEROBIC TREATMENT UNIT Secondary restraint system provided	/			/		
	AEROBIC TREATMENT UNIT Riser permanently fastened to lid or cast into tank	/			/		
	AEROBIC TREATMENT UNIT Riser cap protected against unauthorized intrusions	/			/		
34	AEROBIC TREATMENT UNIT Chlorinator Properly Installed with Chlorine Tablets in Place.						
35	PUMP TANK Is the Pump Tank an approved concrete tank or other acceptable materials & construction						
	PUMP TANK Sampling Port Provided in the Treated Effluent Line						
	PUMP TANK Check Valve and/or Anti-Siphon Device Present When Required						
	PUMP TANK Audible and Visual High Water Alarm Installed on Separate Circuit From Pump						
36	PUMP TANK Inspection/Clean Out Port & Risers Provided						
	PUMP TANK Secondary restraint system provided						
	PUMP TANK Riser permanently fastened to lid or cast into tank						
	PUMP TANK Riser cap protected against unauthorized intrusions						
37	PUMP TANK Secondary restraint system provided						
38	PUMP TANK Electrical Connections in Approved Junction Box / WIRING BU PEG	/			/		
39							

**Comal County Environmental Health
OSSF Inspection Sheet**

Final

No.	Description	Answer	Citations	Notes	1st Insp.	2nd Insp.	3rd Insp.
40	APPLICATION AREA Distribution Pipe, Fitting, Sprinkler Heads & Valve Covers Color Coded Purple?	/	285.33(d)(2)(G)(iii)(ii)285.33(d)(3)(d)(2)(G)(iii)(iii)285.33(d)(2)(G)(v) 285.33(d)(2)(G)(iii) 285.33(d)(2)(G)(iv) 285.33(d)(2)(G)(i) 285.33(d)(2)(G)(ii) 285.33(d)(2)(G)(iii)(i)			/	12-31-19
41	APPLICATION AREA Low Angle Nozzles Used / Pressure is as required APPLICATION AREA Acceptable Area, nothing within 10 ft of sprinkler heads? APPLICATION AREA The Landscape Plan is as Designed		285.33(d)(2)(G)(i) 285.33(d)(2)(A) 285.33(d)(2)(F)				
42	APPLICATION AREA Area Installed	/		<i>per plan</i>		/	
43	PUMP TANK Meets Minimum Reserve Capacity Requirements						
44	PUMP TANK Material Type & Manufacturer						
45	PUMP TANK Type/Size of Pump Installed						

Comal County Environmental Health OSSF Inspection Sheet

Installer Name: _____ OSSF Installer #: _____

1st Inspection Date: 10/15/19 2nd Inspection Date: _____ 3rd Inspection Date: _____

Inspector Name: Mike T. Inspector Name: _____ Inspector Name: _____

Permit#: 109678 Address: C.L. Forest / 1052 Eastview Dr.

No.	Description	Answer	Citations	Notes	1st Insp.	2nd Insp.	3rd Insp.
1	SITE AND SOIL CONDITIONS & SETBACK DISTANCES Site and Soil Conditions Consistent with Submitted Planning Materials	✓	285.31(a) 285.30(b)(1)(A)(iv) 285.30(b)(1)(A)(v) 285.30(b)(1)(A)(iii) 285.30(b)(1)(A)(ii) 285.30(b)(1)(A)(i)		10/15/19		
2	SITE AND SOIL CONDITIONS & SETBACK DISTANCES Setback Distances Meet Minimum Standards	✓	285.91(10) 285.30(b)(4) 285.31(d)				
3	SEWER PIPE Proper Type Pipe from Structure to Disposal System (Cast Iron, Ductile Iron, Sch. 40, SDR 26)	✓	285.32(a)(1)				
4	SEWER PIPE Slope from the Sewer to the Tank at least 1/8 Inch Per Foot	✓	285.32(a)(3)				
5	SEWER PIPE Two Way Sanitary - Type Cleanout Properly Installed (Add. C/O Every 100' &/or 90 degree bends)	✓	285.32(a)(5)				
6	PRETREATMENT Installed (if required) TCEQ Approved List PRETREATMENT Septic Tank(s) Meet Minimum Requirements		285.32(b)(1)(G) 285.32(b)(1)(E)(iii) 285.32(b)(1)(E)(iv) 285.32(b)(1)(F) 285.32(b)(1)(B) 285.32(b)(1)(C)(i) 285.32(b)(1)(C)(ii) 285.32(b)(1)(D) 285.32(b)(1)(E) 285.32(b)(1)(A) 285.32(b)(1)(E)(ii)(II) 285.32(b)(1)(E)(i) 285.32(b)(1)(E)(ii)(I)				
7	PRETREATMENT Grease Interceptors if required for commercial		285.34(d)				

MT- 10/15/19
Tank set, leveled

**Comal County Environmental Health
OSSF Inspection Sheet**

No.	Description	Answer	Citations	Notes	1st Insp.	2nd Insp.	3rd Insp.
8	SEPTIC TANK Tank(s) Clearly Marked SEPTIC TANK If Single Tank, 2 Compartments Provided with Baffle SEPTIC TANK Inlet Flowline Greater than 3" and " T " Provided on Inlet and Outlet SEPTIC TANK Septic Tank(s) Meet Minimum Requirements		285.32(b)(1)(E) 285.91(2) 285.32(b)(1)(F) 285.32(b)(1)(E)(iii) 285.32(b)(1)(E)(ii)(II) 285.32(b)(1)(E)(ii)(I) 285.32(b)(1)(E)(i) 285.32(b)(1)(D) 285.32(b)(1)(C)(ii) 285.32(b)(1)(C)(i) 285.32(b)(1)(B) 285.32(b)(1)(A) 285.32(b)(1)(E)(iv)				
9	ALL TANKS Installed on 4" Sand Cushion/ Proper Backfill Used		285.32(b)(1)(F) 285.32(b)(1)(G) 285.34(b)				
10	SEPTIC TANK Inspection / Clean Out Port & Risers Provided on Tanks Buried Greater than 12" Sealed and Capped		285.38(d)				
11	SEPTIC TANK Secondary restraint system provided SEPTIC TANK Riser permanently fastened to lid or cast into tank SEPTIC TANK Riser cap protected against unauthorized intrusions		285.38(d) 285.38(e)				
12	SEPTIC TANK Tank Volume Installed						
13	PUMP TANK Volume Installed						
14	AEROBIC TREATMENT UNIT Size Installed	✓		600	10/15/19		
15	AEROBIC TREATMENT UNIT Manufacturer AEROBIC TREATMENT UNIT Model Number	✓		Clearstream	/		
16	DISPOSAL SYSTEM Absorptive		285.33(a)(4) 285.33(a)(1) 285.33(a)(2) 285.33(a)(3)				
17	DISPOSAL SYSTEM Leaching Chamber		285.33(a)(1) 285.33(a)(3) 285.33(a)(4) 285.33(a)(2)				
18	DISPOSAL SYSTEM Evapo-transpirative		285.33(a)(3) 285.33(a)(4) 285.33(a)(1) 285.33(a)(2)				

**Comal County Environmental Health
OSSF Inspection Sheet**

No.	Description	Answer	Citations	Notes	1st Insp.	2nd Insp.	3rd Insp.
19	DISPOSAL SYSTEM Drip Irrigation		285.33(c)(3)(A)-(F)				
20	DISPOSAL SYSTEM Soil Substitution		285.33(d)(4)				
21	DISPOSAL SYSTEM Pumped Effluent		285.33(a)(3) 285.33(a)(1) 285.33(a)(2)				
22	DISPOSAL SYSTEM Gravelless Pipe		285.33(a)(3) 285.33(a)(2) 285.33(a)(4) 285.33(a)(1)				
23	DISPOSAL SYSTEM Mound		285.33(a)(3) 285.33(a)(1) 285.33(a)(2) 285.33(a)(4)				
24	DISPOSAL SYSTEM Other (describe) (Approved Design)		285.33(d)(6) 285.33(c)(4)				
25	DRAINFIELD Absorptive Drainline 3" PVC or 4" PVC						
26	DRAINFIELD Area Installed						
27	DRAINFIELD Level to within 1 inch per 25 feet and within 3 inches over entire excavation		285.33(b)(1)(A)(v)				
28	DRAINFIELD Excavation Width DRAINFIELD Excavation Depth DRAINFIELD Excavation Separation DRAINFIELD Depth of Porous Media DRAINFIELD Type of Porous Media						
29	DRAINFIELD Pipe and Gravel - Geotextile Fabric in Place		285.33(b)(1)(E)				
30	DRAINFIELD Leaching Chambers DRAINFIELD Chambers - Open End Plates w/Splash Plate, Inspection Port & Closed End Plates in Place (per manufacturers spec.)		285.33(c)(2)				
31	LOW PRESSURE DISPOSAL SYSTEM Adequate Trench Length & Width, and Adequate Separation Distance between Trenches		285.33(d)(1)(C)(i)				

**Comal County Environmental Health
OSSF Inspection Sheet**

No.	Description	Answer	Citations	Notes	1st Insp.	2nd Insp.	3rd Insp.
32	EFFLUENT DISPOSAL SYSTEM Utilized Only by Single Family Dwelling EFFLUENT DISPOSAL SYSTEM Topographic Slopes < 2.0% EFFLUENT DISPOSAL SYSTEM Adequate Length of Drain Field (1000 Linear ft. for 2 bedrooms or Less & an additional 400 ft. for each additional bedroom) EFFLUENT DISPOSAL SYSTEM Lateral Depth of 18 inches to 3 ft. & Vertical Separation of 1ft on bottom and 2 ft. to restrictive horizon and ground water respectfully EFFLUENT DISPOSAL SYSTEM Lateral Drain Pipe (1.25 - 1.5" dia.) & Pipe Holes (3/16 - 1/4" dia. Hole Size) 5 ft. Apart		285.33(b)(3)(A) 285.33(b)(3)(A) 285.33(b)(3)(B) 285.91(13) 285.33(b)(3)(D) 285.33(b)(3)(F)				
33	AEROBIC TREATMENT UNIT Is Aerobic Unit Installed According to Approved Guidelines.		285.32(c)(1)				
34	AEROBIC TREATMENT UNIT Inspection/Clean Out Port & Risers Provided AEROBIC TREATMENT UNIT Secondary restraint system provided AEROBIC TREATMENT UNIT Riser permanently fastened to lid or cast into tank AEROBIC TREATMENT UNIT Riser cap protected against unauthorized intrusions						
35	AEROBIC TREATMENT UNIT Chlorinator Properly Installed with Chlorine Tablets in Place.						
36	PUMP TANK Is the Pump Tank an approved concrete tank or other acceptable materials & construction PUMP TANK Sampling Port Provided in the Treated Effluent Line PUMP TANK Check Valve and/or Anti- Siphon Device Present When Required PUMP TANK Audible and Visual High Water Alarm Installed on Separate Circuit From Pump						
37	PUMP TANK Inspection/Clean Out Port & Risers Provided PUMP TANK Secondary restraint system provided PUMP TANK Riser permanently fastened to lid or cast into tank PUMP TANK Riser cap protected against unauthorized intrusions						
38	PUMP TANK Secondary restraint system provided						
39	PUMP TANK Electrical Connections in Approved Junction Boxes / Wiring Buried						

**Comal County Environmental Health
OSSF Inspection Sheet**

No.	Description	Answer	Citations	Notes	1st Insp.	2nd Insp.	3rd Insp.
40	APPLICATION AREA Distribution Pipe, Fitting, Sprinkler Heads & Valve Covers Color Coded Purple?		285.33(d)(2)(G)(iii)(II)285.33(d)(2)(G)(iii)(III)285.33(d)(2)(G)(v) 285.33(d)(2)(G)(iii) 285.33(d)(2)(G)(iv) 285.33(d)(2)(G)(i) 285.33(d)(2)(G)(ii) 285.33(d)(2)(G)(iii)(I)				
41	APPLICATION AREA Low Angle Nozzles Used / Pressure is as required APPLICATION AREA Acceptable Area, nothing within 10 ft of sprinkler heads? APPLICATION AREA The Landscape Plan is as Designed		285.33(d)(2)(G)(i) 285.33(d)(2)(A) 285.33(d)(2)(F)				
42	APPLICATION AREA Area Installed						
43	PUMP TANK Meets Minimum Reserve Capacity Requirements						
44	PUMP TANK Material Type & Manufacturer						
45	PUMP TANK Type/Size of Pump Installed						

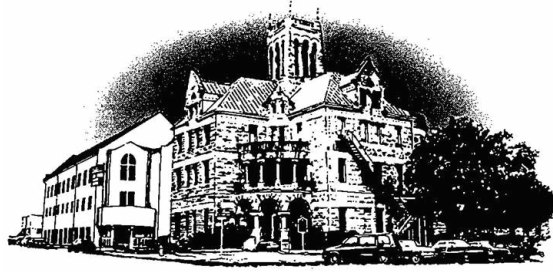

Comal County

OFFICE OF COMAL COUNTY ENGINEER

Permit of Authorization to Construct an On-Site Sewage Facility Permit Valid For One Year From Date Issued

Permit Number: 109678
Issued This Date: 09/11/2019
This permit is hereby given to: Roger Borremans / Eloina Guerrero

To start construction of a private, on-site sewage facility located at:

1052 EASTVIEW DR
CANYON LAKE, TX 78133

Subdivision: Canyon Lake Forest
Unit: 2
Lot: 780
Block:
Acreage:

APPROVED MINIMUM SIZES AS PER ATTACHED DESIGN

Type of System: Aerobic
Drip Irrigation

This permit gives permission for the construction of the above referenced on-site facility to commence. Installation must be completed by an installer holding a valid registration card from the Texas Commission on Environmental Quality (TCEQ). Installation and inspection must comply with current TCEQ and Comal County requirements.

Call (830) 608-2090 to schedule inspections.

OSSF DEVELOPMENT APPLICATION CHECKLIST

Staff will complete shaded

RECEIVED

SEP 10 2019

COUNTY ENGINEER

items Date Received	Initials

109678
Permit Number

Instructions:

Place a check mark next to all items that apply. For items that do not apply, place "N/A". This OSSF Development Application Checklist **must** accompany the completed application.

OSSF Permit

- Completed Application for Permit for Authorization to Construct an On-Site Sewage Facility and License to Operate
- Site/Soil Evaluation Completed by a Certified Site Evaluator or a Professional Engineer
- Planning Materials of the OSSF as Required by the TCEQ Rules for OSSF Chapter 285. Planning Materials shall consist of a scaled design and all system specifications.
- Required Permit Fee
- Copy of Recorded Deed
- Surface Application/Aerobic Treatment System
 - Recorded Certification of OSSF Requiring Maintenance/Affidavit to the Public
 - Signed Maintenance Contract with Effective Date as Issuance of License to Operate

I affirm that I have provided all information required for my OSSF Development Application and that this application constitutes a completed OSSF Development Application.

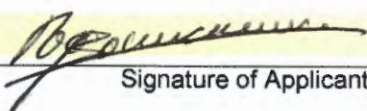
X  _____
Signature of Applicant

9/9/19 _____
Date

<input type="checkbox"/> COMPLETE APPLICATION	
Check No. _____	Receipt No. _____

<input type="checkbox"/> INCOMPLETE APPLICATION (Missing Items Circled, Application Refused)

*** COMAL COUNTY OFFICE OF ENVIRONMENTAL HEALTH ***
APPLICATION FOR PERMIT FOR AUTHORIZATION TO CONSTRUCT AN
ON-SITE SEWAGE FACILITY AND LICENSE TO OPERATE

Date 9-7-2019

Permit # 109678

Owner Name Roger Borremans/Eloina Guerrero
Mailing Address 228 Edge Hill Drive
City, State, Zip Canyon Lake, Texas 78133
Phone # 281-924-0447
Email roger@theborremans.com

Agent Name Brian Erxleben, R.S.
Agent Address 562 S. Hwy 123 Bypass #128
City, State, Zip Seguin, Texas 78155
Phone # 830-660-9133
Email bandverx@gmail.com

All correspondence should be sent to: Owner Agent Both Method: Mail Email

Subdivision Name Canyon Lake Forest Unit 2 Lot 780 Block NA

Acreage/Legal _____

Street Name/Address 1052 Eastview Drive City Canyon Lake Zip 78133

Type of Development:

Single Family Residential

Type of Construction (House, Mobile, RV, Etc.) House

Number of Bedrooms 3

Indicate Sq Ft of Living Area 1282

RECEIVED

SEP 10 2019

COUNTY ENGINEER

Non-Single Family Residential

(Planning materials must show adequate land area for doubling the required land needed for treatment units and disposal area)

Type of Facility _____

Offices, Factories, Churches, Schools, Parks, Etc. - Indicate Number Of Occupants _____

Restaurants, Lounges, Theaters - Indicate Number of Seats _____

Hotel, Motel, Hospital, Nursing Home - Indicate Number of Beds _____

Travel Trailer/RV Parks - Indicate Number of Spaces _____

Miscellaneous _____

Estimated Cost of Construction \$ 200,000 (Structure Only)

Is any portion of the proposed OSSF located in the United States Army Corps of Engineers (USACE) flowage easement?

Yes No (If yes, owner must provide approval from USACE for proposed OSSF improvements within the USACE flowage easement)

Source of Water Public Private Well

Are Water Saving Devices Being Utilized Within the Residence? Yes No

By signing this application, I certify that:

- The completed application and all additional information submitted does not contain any false information and does not conceal any material facts.
- Authorization is hereby given to the permitting authority and designated agents to enter upon the above described property for the purpose of site/soil evaluation and inspection of private sewage facilities..
- I understand that a permit of authorization to construct will not be issued until the Floodplain Administrator has performed the reviews required by the Comal County Flood Damage Prevention Order.
- I affirmatively consent to the online posting/public release of my e-mail address associated with this permit application, as applicable.

X Roger Borremans
Signature of Owner

9/9/19
Date

Page 1 of 2

* * * COMAL COUNTY OFFICE OF ENVIRONMENTAL HEALTH * * *
APPLICATION FOR PERMIT FOR AUTHORIZATION TO CONSTRUCT AN
ON-SITE SEWAGE FACILITY AND LICENSE TO OPERATE

Planning Materials & Site Evaluation as Required Completed By Brian Erxleben, R.S. 3637

System Description Aerobic Treatment/Mounded Drip Disposal

Size of Septic System Required Based on Planning Materials & Soil Evaluation

Tank Size(s) (Gallons) 500 gpd minimum Absorption/Application Area (Sq Ft) 2000

Gallons Per Day (As Per TCEQ Table III) 240

(Sites generating more than 5000 gallons per day are required to obtain a permit through TCEQ.)

Is the property located over the Edwards Recharge Zone? Yes No

(If yes, the planning materials must be completed by a Registered Sanitarian (R.S.) or Professional Engineer (P.E.))

Is there an existing TCEQ approved WPAP for the property? Yes No

(If yes, the R.S. or P.E. shall certify that the OSSF design complies with all provisions of the existing WPAP.)

If there is no existing WPAP, does the proposed development activity require a TCEQ approved WPAP? Yes No

(If yes, the R.S. or P.E. shall certify that the OSSF design will comply with all provisions of the proposed WPAP. A Permit to Construct will not be issued for the proposed OSSF until the proposed WPAP has been approved by the appropriate regional office.)

Is the property located over the Edwards Contributing Zone? Yes No

Is there an existing TCEQ approval CZP for the property? Yes No

(If yes, the P.E. or R.S. shall certify that the OSSF design complies with all provisions of the existing CZP.)

If there is no existing CZP, does the proposed development activity require a TCEQ approved CZP? Yes No

(If yes, the R.S. or P.E. shall certify that the OSSF design will comply with all provisions of the proposed CZP. A Permit to Construct will not be issued for the proposed OSSF until the CZP has been approved by the appropriate regional office.)

Is this property within an incorporated city? Yes No

If yes, indicate the city: _____

RECEIVED
SEP 10 2019
COUNTY ENGINEER

By signing this application, I certify that:

- The information provided above is true and correct to the best of my knowledge.
- I affirmatively consent to the online posting/public release of my e-mail address associated with this permit application, as applicable.

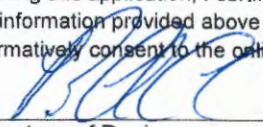

Signature of Designer

9-7-2019

Date

Page 2 of 2

2/05

RECEIVED

SEP 10 2019



201906032043 09/09/2019 03:53:13 PM 1/2

THE COUNTY OF COMAL *
STATE OF TEXAS

COUNTY ENGINEER

CERTIFICATION OF OSSF REQUIRING MAINTENANCE

According to Texas Commission on Environmental Quality Rules for On-Site Sewage Facilities, this document is filed in the Deed Records of COMAL COUNTY, TEXAS.

I

The Texas Health and Safety Code, Chapter 366, authorizes the Texas Commission on Environmental Quality (commission) to regulate on-site sewage facilities (OSSFs). Additionally, the Texas Water Code (TWC), § 5.012 and § 5.013, gives the TCEQ primary responsibility for implementing the laws of the State of Texas relating to water and adopting rules necessary to carry out its powers and duties under the TWC. The commission, under the authority of the TWC and the Texas Health and Safety Code, requires owners to provide notice to the public that certain types of OSSFs are located on specific pieces of property. To achieve this notice, the commission requires a recorded affidavit. Additionally, the owner must provide proof of the recording to the OSSF permitting authority. This recorded affidavit is not a representation or warranty by the commission that the appropriate OSSF was installed.

II

An OSSF requiring a maintenance contract, according to 30 Texas Administrative Code §285.91(12) will be installed on the property described as:

UNIT 2 BLOCK LOT 780 SUBDIVISION *Canyon Lake Forest*
IF NOT IN SUBDIVISION: ACRES SURVEY ABSTRACT

The property is owned by Roger Borremans & Eloina Guerrero.

This OSSF shall be covered by a continuous maintenance contract for the first two years. After the initial two-year service policy, the owner of an aerobic treatment system for a single family residence shall either obtain a maintenance contract within 30 days or maintain the system personally.

Upon sale or transfer of the above-described property, the permit for the OSSF shall be transferred to the buyer or new owner. A copy of the planning materials for the OSSF can be obtained from the **Comal County Environmental Health Department**.

WITNESS MY HAND ON THIS 9TH DAY OF September, 2019.

Roger Borremans
OWNER/AGENT NAME (SIGNATURE)

Eloina Guerrero
OWNER/AGENT NAME (PRINTED)

SWORN TO AND SUBSCRIBED BEFORE ME ON THIS 9TH DAY OF September, 2019

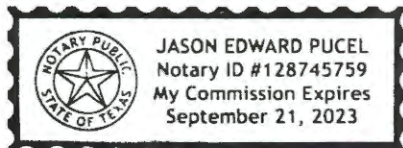

Jason Edward Pucel
Notary Public, State of Texas

Notary's Printed Name: Jason Edward Pucel

Commission Expires: 9/21/2023



RECEIVED
SEP 10 2019
COUNTY ENGINEER

This page has been added to comply with the statutory requirement that the clerk shall stamp the recording information at the bottom of the last page.

This page becomes part of the document identified by the file clerk number affixed on preceding pages.

Filed and Recorded
Official Public Records
Bobbie Koepf, County Clerk
Comal County, Texas
09/09/2019 03:53:13 PM
TERRI 2 Page(s)
201906032043



Bobbie Koepf

Countryside Construction, Inc.
300 Chapman Parkway, Canyon Lake, TX. 78133
Phone: 830-899-2615 or 1-888-379-3721 Fax: 830-899-6662
Septic System Service Agreement

In consideration of payment for this service contract, we will abide by and agree to its terms and conditions:

Name: Roger Borremans/Eloina Guerrero Address: 1052 Eastview Drive
 Sub-Div./County: Comal City, State-Zip: Canyon Lake, Texas 78133
 Permit #: _____ Model #: _____ Serial #: _____
 Phone #: 281-924-0447

Initial Two Year Service Agreement & Two Year Limited Warranty
 One Year Service Agreement

The effective date of this initial maintenance contract shall be the date the License to Operate is issued.

Legal Description: Lot 780, Canyon Lake Forest, Unit 2

RECEIVED

This contract will be in effect FROM LTO TO LTO + 2 YEARS and will provide the following:

SEP 10 2019

- A: An inspection/service call every (4) four months which will include: inspection, adjustments and servicing of the mechanical & electrical components as necessary to insure proper function of the system.
- B: An effluent quality inspection consisting of a visual check for color, turbidity, scum, overflow and odor.
- C: **The property owner is responsible for "purchasing and keeping chlorine"** in the chlorinator, (if applicable). If the chlorine test reveals "No Chlorine" in the system, the property owner may incur an additional cost.
- D: If any improper operation is observed (which cannot be corrected at that time) the property owner will be notified immediately of the conditions and the estimated cost.
- E: The response time to a complaint by the property owner regarding operation of the system, shall be within "48 hours," from the time of notification.
- F: **ANY PARTS, WARRANTY OR NON-WARRANTY, OR FREIGHT CHARGES, LABOR OR SERVICE CALLS DUE NOT PAID FOR REMAIN THE PROPERTY OF COUNTRYSIDE CONSTRUCTION AND COULD RESULT IN REPOSSION OF PARTS BY COUNTRYSIDE CONSTRUCTION.**
- G: **THE SIGNING OF THIS SERVICE AGREEMENT AUTHORIZES COUNTRYSIDE CONSTRUCTION TO ENTER THE PROPERTY TO EXECUTE ALL TERMS OF THIS CONTRACT.**

Countryside Construction, Inc., will warranty installation of the septic system to be according to state and county regulations and the designs approved by the county. **HOMEOWNER WILL BE RESPONSIBLE FOR SERVICE CALLS, LABOR AND SHIPPING COSTS ON ANY "WARRANTED PARTS" EXCHANGED DURING WARRANTY.** All other components will be according to manufacture's warranties.

Important: As Countryside Construction, Inc. **cannot control** what or how much effluent goes into this septic system, we **cannot warranty** how the system will function. Refer to manufacturers or installer's instructions, for suggestions on septic operation. This service agreement **does not** cover the cost of "Service Calls, Labor or Materials" that are required or **parts out of warranty**, the failure to maintain electrical power to the system, **sprinklers that are broken**, leaking, stopped-up or otherwise mal-functioning; or sewage flows exceeding the hydraulic/organic design capabilities and the input of non-biodegradable materials (solvents, grease, oil, paints, etc.), or any usage contrary to the requirements as advised by authorized service representative. Laboratory test work is available at an additional cost. Chlorine, filters, or parts that are out of warranty are available at a reasonable cost.

This contract **does not** include the **pumping of a tank** or of any **compartment of a tank, or settlement of soil on or around any part of the system regardless of reason:**

Violations of the warranty also include: Disconnecting the alarm, restricting ventilation to the aerator, over loading the system above its rated capacity; or flooding by external means. Rodent, insect or Fire Ant damage or any other form of unusual abuse is a violation.

A renewal service contract **should** be "**Activated**" (30) **thirty days** before **expiration** of existing contract. We will contact property owner prior to expiration of existing contract.

Serviced by: Countryside Construction Inc.
 Walker Chapman - Operator Licensee #2929

(X) [Signature] Print Name (X) ROGER BORREMANS Date: 9/9/19
 Property Owner Signature

(X) [Signature] Date: _____ Authorized Service Representative (revised 10/9/09)

**COMAL COUNTY ENVIRONMENTAL HEALTH DEPARTMENT
OSSF SOIL EVALUATION FORM**

Owners Name: Roger Borremans/Eloina Guerrero
 Physical Address: 1052 Eastview Drive Canyon Lake, Texas 78133
 Name of Site Evaluator: Brian Erxleben, S.E. #11458
 Date Performed: 9-6-19 Proposed Excavation Depth: Mounded Drip

Requirements:

At least two soil excavations must be performed on the site, at opposite ends of the proposed disposal area. Locations of soil evaluation must be shown on the application site drawing or designer's site drawing
 For subsurface disposal, soil evaluations must be performed to a depth of at least two feet below the proposed excavation depth. For surface disposal, the surface horizon must be evaluated.
 Please describe each soil horizon and identify any restrictive features in the space provided below. Draw lines at the appropriate depths.

SOIL BORING NUMBER <u>1 & 2</u>						
Depth (Feet)	Texture Class	Soil Texture	Structure (For Class III-blocky, platy or massive)	Drainage (Mottles/Water Table)	Restrictive Horizon	Observations
0 ↓ 6" 1	Type 3 Fractured rock	Clay loam	No gravel	None	None Yes	Mounded aerobic drip
2						
3						
4						
5						

SOIL BORING NUMBER _____						
Depth (Feet)	Texture Class	Soil Texture	Structure (For Class III-blocky, platy or massive)	Drainage (Mottles/Water Table)	Restrictive Horizon	Observations
0						
1						
2						
3						
4						
5						

FEATURES OF SITE AREA

Presence of 100 year flood zone YES ___ NO X
 Presence of adjacent ponds, streams, water impoundments YES ___ NO X
 Existing or proposed water well in nearby area YES ___ NO X
 Organized sewage available to lot or tract YES ___ NO X
 Recharge features within 150 feet YES ___ NO X

I certify that the above statements are true and are based on my own field observations.

Signature of Site Evaluator



Date

9-7-19

RECEIVED

SEP 10 2019

COUNTY ENGINEER

OSSF SOIL EVALUATION REPORT INFORMATION
COMAL COUNTY

RECEIVED

DATE: 9-7-19

SEP 10 2019

Applicant Information:

Name: Roger Borremans/Eloina Guerrero
Address: 228 Edge Hill Drive
City: Canyon Lake State: Texas Zip: 78133
Ph: (281) 924-0447 Fax:

Site Evaluator Information:

Name: Brian Erxleben
Address: 562 S. Hwy 123 Bypass COUNTY ENGINEER
City: Seguin State: Texas Zip: 78155
Ph: (830) 660-9133 email: bandverx@gmail.com

Property Location:

Lot: 780 Block:
Subdivision: Canyon Lake Forest, Unit 2
Street/Road Address: 1052 Eastview Drive
City: Canyon Lake State: TX Zip: 78133
Additional:

Installer Information:

Name: Walker Chapman OS0002929
Company: Countryside Construction
Address: 300 Chapman Parkway
City: Canyon Lake State: TX Zip: 78133
Ph: (830) 899-2615 Fax: (830) 899-6662

SCHEMATIC of LOT of TRACT

Show:

- North arrow, adjacent streets, property lines, dimensions, location of buildings, easements, swimming pools, water lines, and other structures where known.
- Location of existing or proposed water wells within 150 feet of property.
- Indicate slope or provide contour lines from the structure to the farthest location for the proposed soil absorption or irrigation area.
- Location of soil boring or dug pits (show with respect to a known reference point).
- Location of drainage ways, water impoundment areas, cut or fills bank, sharp slopes and breaks.

Lot Size: 0.1763 acres

SITE DRAWING

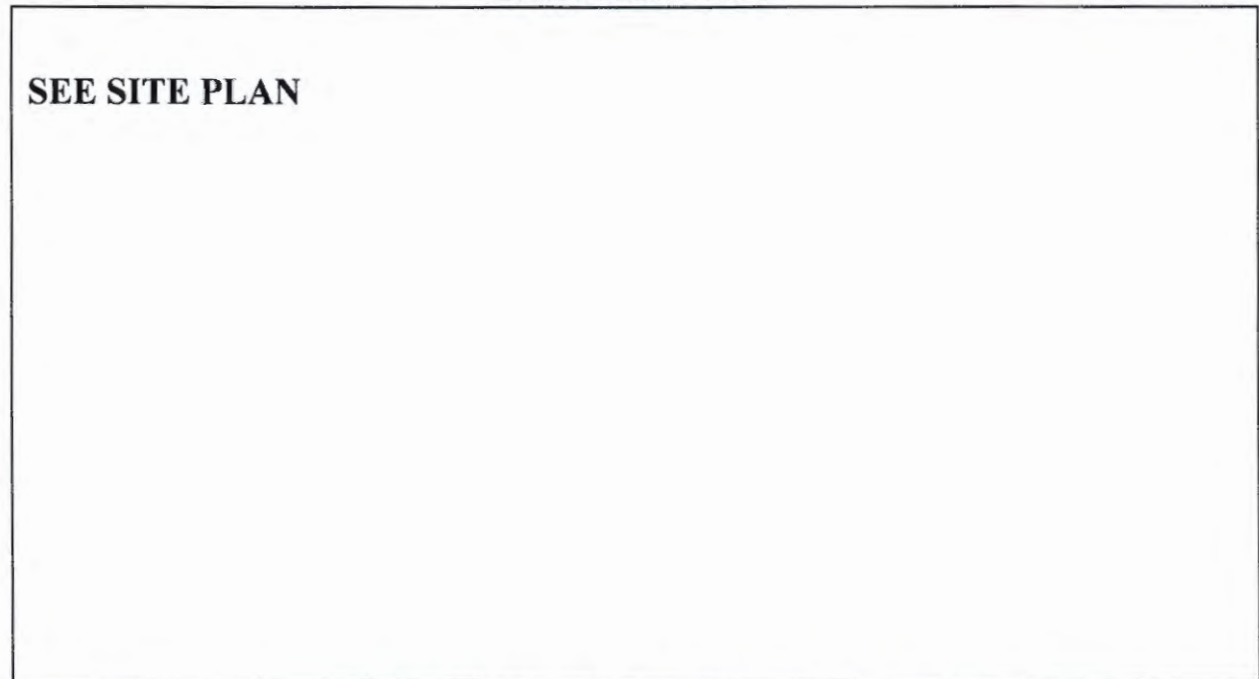

FEATURES OF SITE AREA

Presence of 100 year flood zone	YES ___ NO <u>X</u>	Presence of upper water shed	YES ___ NO <u>X</u>
Existing or proposed water well in nearby area	YES ___ NO <u>X</u>	Organized sewage service available to lot	YES ___ NO <u>X</u>
Presence of adjacent ponds, streams, water impoundments	YES ___ NO <u>X</u>		

Site Evaluator:

NAME: BRIAN ERXLEBEN Signature:  License No: 11458

RECEIVED

Brian Erxleben, R.S., S.E.
562 S. Hwy 123 Bypass #128
Seguin, Texas 78155
Mobile (830) 660-9133 Fax (830) 372-3778

SEP 10 2019

COUNTY ENGINEER

OSSF DESIGN

Owner: **Roger Borremans/Eloina Guerrero**
Location: **1052 Eastview Drive Canyon Lake, Texas 78133**
Phone: **(281) 924-0447**
Date: **9-7-19**

Development: **Residence with water saving devices** Bedrooms: **3** Sq. Ft: **1282**

Q: **240 gpd** Soil: **Type 3** R_a : **0.20 gall/ft²/day**

System Type: **Aerobic Treatment & Disinfection/Drip Disposal**

ATU: **Norweco 960-600 600 gpd** Dripline: **Netafim Bioline 0.62**

Dripline Spacing: **2'** Emitter Spacing: **24"** Emitter Flow Rate (F): **0.62 gph**

Total Absorption Area Required (A): **1200 ft²** (Q/ R_a) Total Length Dripline Required (L): **600 ft** (A/2)

Total Length Dripline Designed: **1000 ft** Total Absorption Area Designed: **2000 ft²** (L)(2 ft)

Total Number Emitters (E): **500** (L/2) Dripline Flow Rate: **5.17 gpm** (E)(F)/(60 min/hr)

Dosing Duration: **6 min** (6 -15 min) Dosing Volume: **31** (Duration)(Dripline Flow Rate)

Doses Per Day: **8** (Q/Dosing Volume) Dosing Interval: **2 hrs** (18/Doses per day + 1)

Supply Line: **Sch 40, 1" purple (~50')** Flush Line: **Sch 40, 1" purple (~50')**

Filter: **100-130 micron disc filter, manual flush** Flush Valve: **1" Ball Valve**

Disinfection: **Required**

Pump Used: **0.50 HP High Head Effluent Pump**



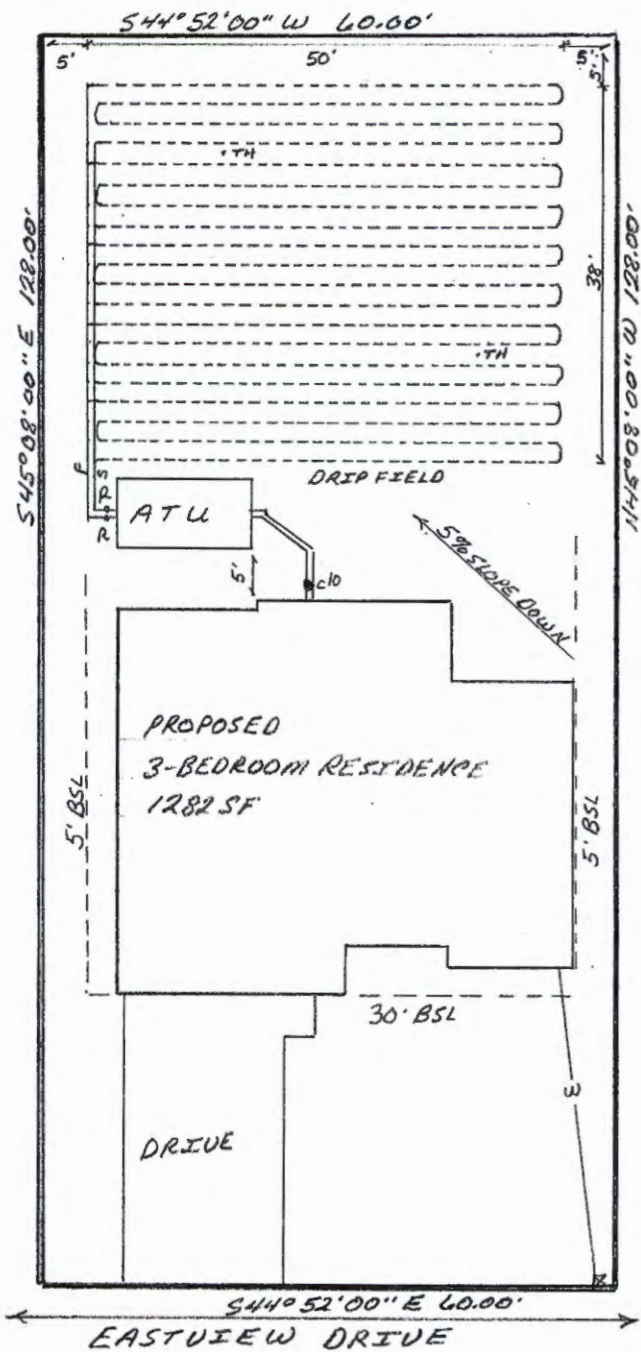

RECEIVED
 SEP 10 2019
 COUNTY ENGINEER



NOTES:

1. This system is designed for a maximum of 240 gall of wastewater per day. Exceeding this volume may result in system failure.
2. System designed as a mounded aerobic drip system with disinfection. Replacement soil shall be type 2 and the drainfield shall be sized on the absorption rate for the native type 3 soil.
3. Install a minimum 500 gpd ATU. Audible and visual high water alarms, external disconnect within site of the pump tank, pump and alarms on separate breakers and external wiring in conduit required.
4. Install a 2-way cleanout in a 3" or 4" sch 40 tightline from the house to the tank, minimum slope 1/8 in/ft. The native soil shall be scarified and a minimum of 12" of type 2 sandy loam soil shall be placed over the dripfield area and a minimum of 2' beyond the edges.
5. Install 1000' of Netafim 0.62 gph dripline on top of the imported soil, 2' apart. No single lateral shall exceed 300' in length. All loops in the dripline shall be flexible PVC.
6. Supply (S) and flush (F) lines shall be 1" purple sch 40. A 100-130 micron disc filter shall be installed in the supply line inside the pump chamber. A 1" ball valve shall be installed on the flush line and shall be located in the tank or in a valve box. This valve shall be used to open the flush line periodically to flush the drip lines.
7. Disinfection is required and the flush line shall terminate in the pump chamber.
8. A vacuum relief valve (R) shall be installed on both the supply and flush lines at their highest points. The valves shall be located in valve boxes filled with pea gravel.
9. Cover the dripfield with a minimum of 6" type 2 soil. Drainfield shall be sodded in grass.
10. The pump shall operate on a timer set to run for a 6 minute duration every 2 hours.
11. Vehicles should not be driven over the drainfield and impervious materials and irrigation systems shall not be installed over the drainfield.

LOT 780
 CANYON LAKE FOREST, UNIT 2
 0.1763 ACRES

LOT IS LOCATED OUTSIDE OF THE 100-YEAR FLOODPLAIN AND WITHIN THE CONTRIBUTING ZONE. THERE IS NO EXISTING CZP FOR THE SUBDIVISION. DEVELOPMENT IS A SINGLE FAMILY DWELLING WITH <20% IMPERVIOUS COVER AND A CZP IS NOT REQUIRED.

SITE PLAN & OSSF DESIGN:

ROGER BORREMANS/ELOINA GUERRERO 1052 EASTVIEW DRIVE CANYON LAKE, TEXAS 78133	
BRIAN C. ERXLEBEN, R.S. 562 S. HWY 123 BYPASS #128 SEGUIN, TEXAS 78155 (830) 660-9133	DATE: 9-7-18 SCALE: 1" = 20'

DRIP FIELD DETAIL SHEET

RECEIVED

SEP 10 2019

COUNTY ENGINEER

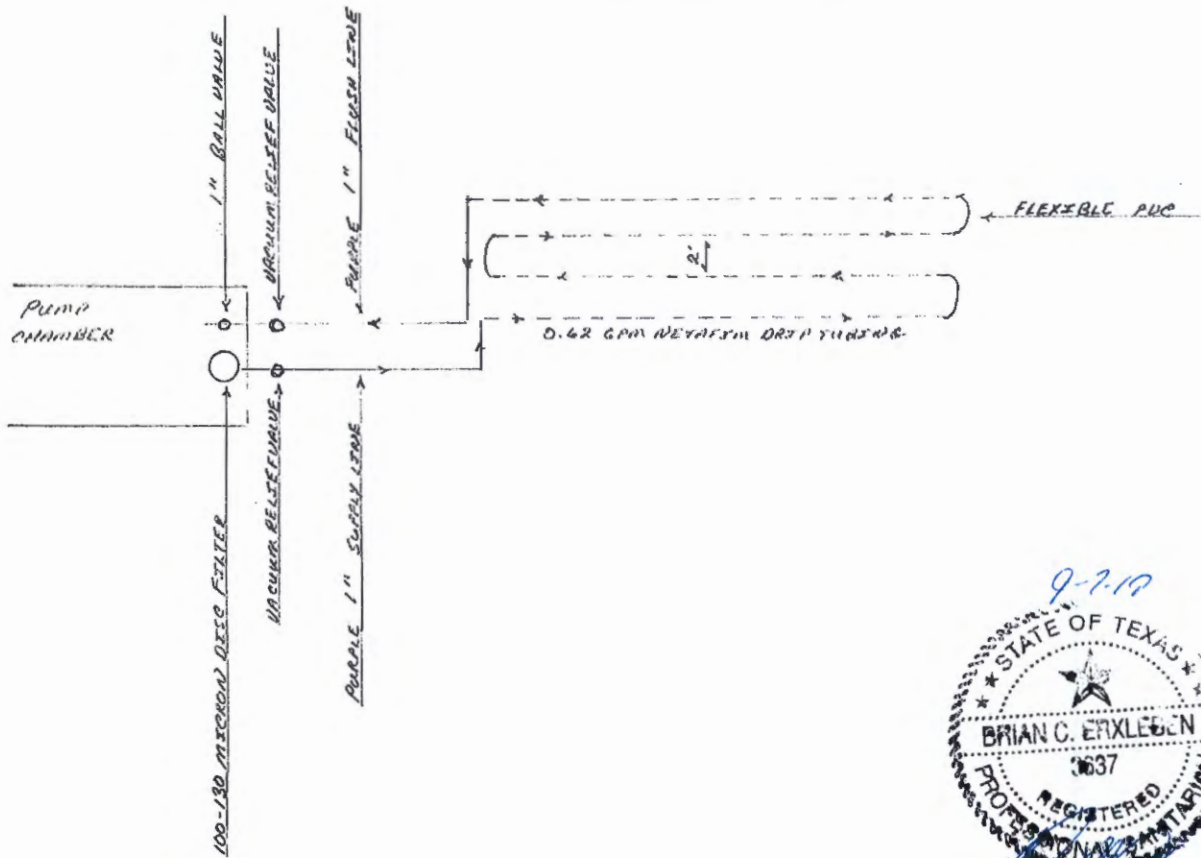
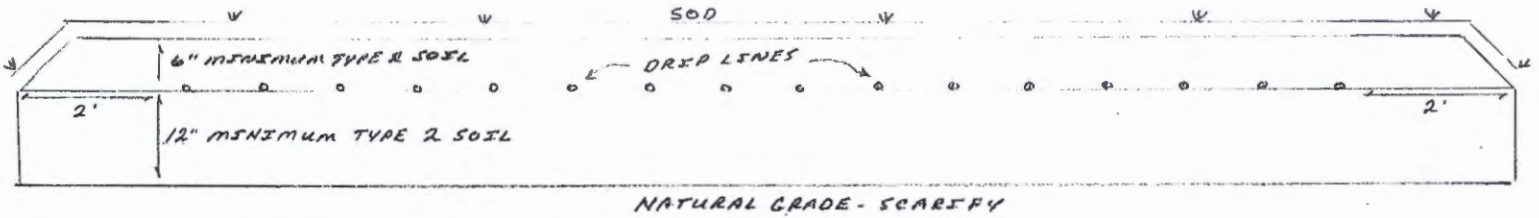

ROGER BORREMANS/ELOINA GUERRERO 1052 EASTVIEW DRIVE CANYON LAKE, TEXAS 78133	
BRIAN C. ERXLEBEN, R.S. 562 S. HWY 123 BYPASS #128 SEGUIN, TEXAS 78155 (830) 660-9133	DATE: 9-7-19 SCALE: 1" = 1'

TOTAL DYNAMIC HEAD (TDH) CALCULATIONS

RECEIVED
SEP 10 2019
COUNTY ENGINEER

Total Flow = 5.17 gpm

Operational Pressure = **25 psi**

Dripline Length = 1000 ft

Supply Line 1 in Sch 40 = 50'

Head Loss Friction – Laterals: $(0.78 \text{ ft}/100 \text{ ft})(1000 \text{ ft}) = \mathbf{8 \text{ psi}}$

Head Loss Friction – Supply: **2 psi**

Head Loss Friction – Filter = **1 psi**

Head Loss Friction – Fittings: **1 psi**

Operational Pressure: **25 psi**

Head Loss – Elevation: **5 ft**

TDH = $(2.31 \text{ ft}/\text{psi})(25 \text{ psi} + 8 \text{ psi} + 2 \text{ psi} + 1 \text{ psi} + 1 \text{ psi}) + 5 \text{ ft} = \mathbf{91 \text{ ft}}$

PUMP REQUIREMENT = 5.17 GPM @ 91 FT TDH



ROGER BORREMANS/ELOINA GUERRERO 1052 EASTVIEW DRIVE CANYON LAKE, TEXAS 78133	
BRIAN C. ERXLEBEN, R.S. 562 S. HWY 123 BYPASS #128 SEGUIN, TEXAS 78155 (830) 660-9133	DATE: 9-7-19 SCALE: 1" = '



RECEIVED

SEP 10 2019

COUNTY ENGINEER

NORWECO SINGULAR BIO-KINETIC WASTEWATER TREATMENT SYSTEM MODEL 960-600 GPD WITH PUMP CHAMBER

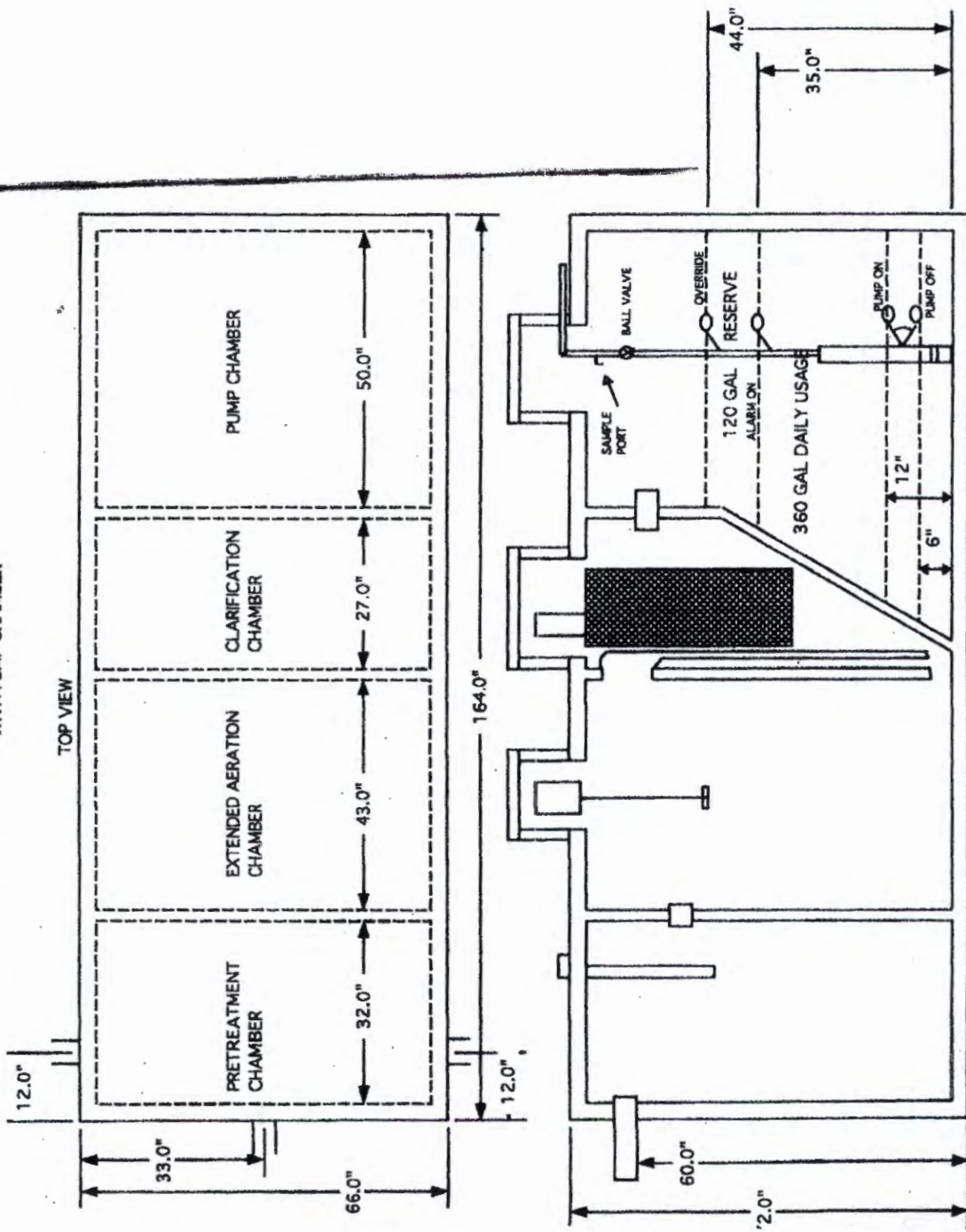

MODEL HB105 EFFLUENT PUMP

Designed specifically for pumping filtered effluent in high pressure applications, the Norweco Model HB105, 1/2 hp, 115 volt, single phase submersible pump delivers 15 gpm at 100' TDH.

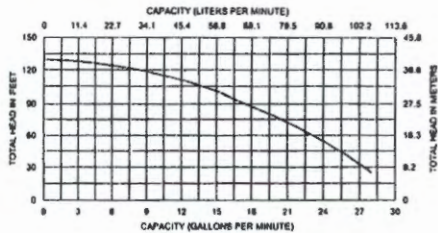

FEATURES

- UL & CSA listed
- 10' jacketed power cord
- Stainless steel construction
- Built-in overload protection
- 1 1/4" NPT discharge
- Continuous duty motor
- Built-in surge protection
- Hermetically-sealed windings
- Versatile and efficient
- Built-in check valve
- Capacities to 28 gpm
- Heads to 125'
- Screened bottom intake

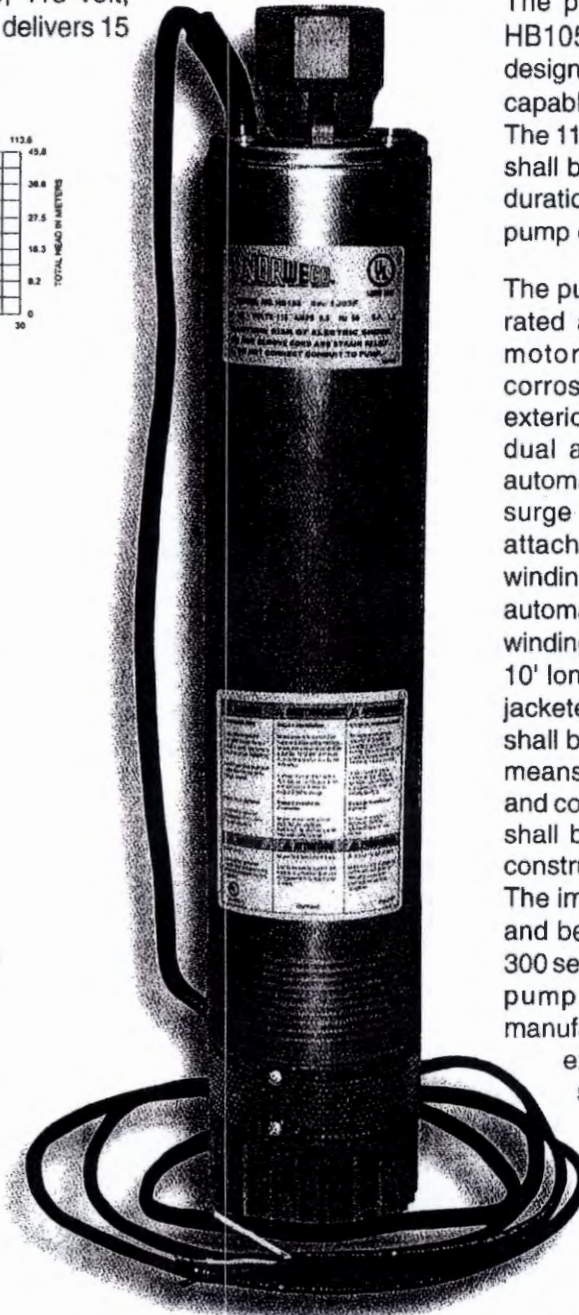

SPECIFICATIONS

The pump shall be a Norweco Model HB105 high head submersible pump, designed to handle filtered effluent and be capable of passing 1/16" spherical solids. The 115 volt, single phase, 60 cycle pump shall be capable of running dry for short durations without damage to the motor or pump end.

The pump motor shall be 1/2 horsepower rated and operate at 3450 RPM. The motor assembly shall consist of a corrosion resistant, all stainless steel exterior construction and incorporate a dual action starting switch to provide automatic torque reversal. An electrical surge and overload protector shall be attached to the top end of the motor windings and shall be wired in series to automatically cease operation when the winding temperature reaches 266° F. The 10' long motor power cord shall be 14-3 jacketed, type SJOW. The cable jacket shall be sealed at the motor entrance by means of a rubber compression washer and compression nut. The pump impeller shall be of the six vane enclosed type, constructed of engineered thermoplastic. The impeller shall have a hexagonal I.D. and be positively driven by a hexagonal 300 series stainless steel pump shaft. The pump shall be the product of a manufacturer having at least seven years experience in the construction of submersible pumps. The pump shall be warranted by the manufacturer against defects in material and workmanship for a period of one year under normal use and service.

DISTRIBUTED LOCALLY BY:

NORWECO
NORWALK WASTEWATER EQUIPMENT COMPANY

220 REPUBLIC STREET
NORWALK, OHIO, USA 44857-1196
TELEPHONE (419) 668-4471
FAX (419) 663-5440
www.norweco.com

RECEIVED

SEP 10 2019

COUNTY ENGINEER

POOR QUALITY

NOTICE OF CONFIDENTIALITY RIGHTS: IF YOU ARE A NATURAL PERSON, YOU MAY REMOVE OR STRIKE ANY OR ALL OF THE FOLLOWING INFORMATION FROM ANY INSTRUMENT THAT TRANSFERS AN INTEREST IN REAL PROPERTY BEFORE IT IS FILED FOR RECORD IN THE PUBLIC RECORDS: YOUR SOCIAL SECURITY NUMBER OR YOUR DRIVER'S LICENSE NUMBER.

RECEIVED
SEP 10 2019

COUNTY ENGINEER

GENERAL WARRANTY DEED

STATE OF TEXAS §
COUNTY OF COMAL § KNOW ALL MEN BY THESE PRESENTS:

THAT JON YOUNG a/k/a JONATHAN YOUNG, a married man, not joined herein by his spouse, because the herein conveyed property forms no part of any property claimed as homestead, hereinafter called Grantor, for and in consideration of the sum of TEN AND NO/100 DOLLARS (\$10.00) cash and other good and valuable consideration in hand paid by ROGER BORREMANS and ELOINA M. GUERRERO, hereinafter called Grantee, the receipt and sufficiency of which is hereby acknowledged;

HAS GRANTED, SOLD and CONVEYED, and by these presents does GRANT, SELL and CONVEY unto the said Grantee the following described property situated in Comal County, Texas, to-wit:

Lots 780 and 816, CANYON LAKE FOREST, UNIT 2, a subdivision in Comal County, Texas, according to the map or plat thereof recorded in Volume 1, Page 73, of the Map and Plat Records of Comal County, Texas.

This conveyance is made subject to, all and singular, the restrictions, conditions, easements and covenants, if any, applicable to and enforceable against the above described property as reflected by the records of the County Clerk of Comal County, Texas.

Taxes for the current year have been prorated and are thereafter assumed by Grantee.

POOR QUALITY.

RECEIVED

SEP 10 2019

COUNTY OF DALLAS

TO HAVE AND TO HOLD the above described premises, together with, all and singular, the rights and appurtenances thereto in anywise belonging unto the said Grantee, Grantee's heirs, executors, administrators, successors, or assigns forever.

Grantor does hereby bind Grantor, Grantor's heirs, executors, administrators, and successors to warrant and forever defend, all and singular, the said premises unto the said Grantee, Grantee's heirs, executors, administrators, successors, and assigns against any person whomsoever claiming or to claim the same or any part thereof.

DATED this the 18th day of December, 2018.

[Handwritten Signature]

JON YOUNG a/k/a JONATHAN YOUNG

STATE OF TEXAS §
COUNTY OF Dallas §

This instrument was acknowledged before me on this the 18th day of December, 2018 by JON YOUNG a/k/a JONATHAN YOUNG.

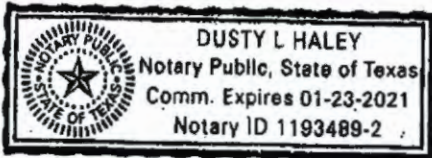

[Handwritten Signature]

Notary Public, State of Texas

GRANTEE'S MAILING ADDRESS:

2127 LBJ Freeway Suite 815
Dallas, TX 75234

9748.deeds
New Braunfels Title Co-CL (EA)
GF #87840

Filed and Recorded
Official Public Records
Bobbie Koepf, County Clerk
Comal County, Texas
12/21/2018 01:21:58 PM
TERRI 2 Pages(s)
201806048526



[Handwritten Signature]
Bobbie Koepf

COUNTRYSIDE CONSTRUCTION, INC.
 300 CHAPMAN PARKWAY
 CANYON LAKE, TX 78133

Phone: 830-899-2615
 Fax: 830-899-6662

TESTING AND REPORTING RECORD

This Testing and Reporting Record shall be completed, signed and dated after each inspection.

1. Inspection Date: AUGUST 19, 2020 Installed: 12/31/2019 Service Expires: 12/31/2021

BILLING ADDRESS:
 ROBERT MIRANDA
 1052 EASTVIEW
 CANYON LAKE, TX 78133

PHYSICAL ADDRESS:
 1052 EASTVIEW
 CANYON LAKE, TX 78133

TELEPHONE: 915-260-0253
 ALT. PHONE:

LOT: LT 780,

PERMIT#: 109678
 COUNTY: COMAL
 SN: 19060432
 MAPSCO: N/A

SUBDIVISION: CANYON LAKE FOREST MFG: CLEARSTREAM-600

NOTES: CLEAN EFFLUENT FILTER DURING DECEMBER INSPECTION
 TYPE OF SYSTEM: DRIP

Inspected Item:	Operational	Inoperative
Aerators		
SCFM/Compressors PSI (Record Pressure Reading)		
Filters		
Irrigation Pumps		
Recirculation Pumps		
Disinfection Device		
Chlorine Supply		
Electrical Circuits		
Distribution System		
Sprayfield Vegetation		
Back Flush Drip Field, if applicable		
Other as Noted		
Access Posts are Secured		

2. Action taken or Repairs or Needed repairs to system (list all components replaced):

CHECKED Alarms,
FLOATS, pump,
Compressor, MICRON FILTER,
FLUSHED FIELD

SYSTEM OPERATING AS DESIGNED? Y/N

Yes No

3. Tests required and results:

	Required		Results mg/l mpn/100ml or Trace	Test Method
	Yes	No		
BOD (Grab)				
TSS (Grab)				
Cl (Grab)				
Fecal Coliform				

Copies of this report have been forwarded to the following: COMAL county / homeowner.

Maintenance Technician: THOMAS

11

Date of completion: 8/17/20 Start Job Time: 3:05 Stop Job Time: 3:25

Maintenance Provider: Worshiper

COUNTRYSIDE CONSTRUCTION, INC.
 300 CHAPMAN PARKWAY
 CANYON LAKE, TX 78133

Phone: 830-899-2615
 Fax: 830-899-6562

TESTING AND REPORTING RECORD

All Tests and Reports Shall be completed, signed and dated prior to departure.

Form No. 100-AP-11 10-2021 Rev. 10/31/019 (replaces Form No. 100-1001)

PLANT ADDRESS:
 ROBERT MIRANDA
 1050 EASTVIEW
 CANYON LAKE, TX 78133

PHYSICAL ADDRESS:
 1050 EASTVIEW
 CANYON LAKE, TX 78133

TELEPHONE 910-240-0253
 ALT. PHONE

LT 789

FEEDBACK 0 678

COMM 1900 430

SYSTEM NAME: CANYON LAKE FOREST WWT CLEARSTREAM-600

DATE: N/A

TYPE OF SYSTEM: WWT CLEARSTREAM-600
 TYPE OF EFFLUENT: DEIR

Inspected Item	Operational	Inspection	Remarks
Relay			
Pressure Reading	1.5		
Valves	/		
Irrigator Pumps	/		Checked pump.
Recirculation Pumps	N/A		
Disinfection Device	/		Alarm, FLOATS.
Wastewater Supply	/		clean
Electrical Controls	/		DISC FILTER (CLOGGED)
Flowmeter	/		
Open Field Termination	N/A		FLUSHED FIELD
Back Flow Valve Field	/		checked Compressor
Control Room	/		
Access Points are tested			SYSTEM OPERATING DEFUNCT? <input checked="" type="radio"/> YES <input type="radio"/> NO

3 Tests required and results:

Test	Result	Remarks
Flowmeter		
Flowmeter		clear
Flowmeter		
Flowmeter		

Copies of this report have been forwarded to the following: COMAL County Government

Masterpiece Test: 6/15/21

Date of report: Thomas

Inspector: walsh chopin

COUNTRYSIDE CONSTRUCTION, INC.
300 CHAPMAN PARKWAY
CANYON LAKE, TX 78133

Phone: 830-899-2615
 Fax: 830-899-6662

TESTING AND REPORTING RECORD

This Testing and Reporting Record shall be completed, signed and dated after each inspection.

1. Inspection Date: AUGUST 19, 2021 Installed: 12/31/2019 Service Expires: 12/31/2021

BILLING ADDRESS:
 ROBERT MIRANDA
 1052 EASTVIEW
 CANYON LAKE, TX 78133

PHYSICAL ADDRESS:
 1052 EASTVIEW
 CANYON LAKE, TX 78133

TELEPHONE: 915-260-0253
 ALT. PHONE:

LOT: LT 780,

PERMIT#: 109678
 COUNTY: CUMAL
 SN: 19060432
 MAPSCO: E/A

SUBDIVISION: CANYON LAKE FOREST MFG: CLEARSTREAM-600

NOTES: CLEAR EFFLUENT FILTER DURING DECEMBER INSPECTION
 TYPE OF SYSTEM: DRIP

Inspected Item:	Operational	Inoperative
Aerators		
SCFM/Compressors PSI (Record Pressure Reading)	3.0	
Filters	/	
Irrigation Pumps	/	
Recirculation Pumps	N/A	
Disinfection Device	/	
Chlorine Supply	/	
Electrical Circuits	/	
Distribution System	/	
Sprayfield Vegetation	N/A	
Back Flush Drip Field, if applicable	/	
Other as Noted	/	
Access Posts are Secured		

2. Action taken or Repairs or Needed repairs to system (list all components replaced):

Checked pump

Alarms, Floats,

micron filter,

Compressor, flushed field

SYSTEM OPERATING AS DESIGNED? Yes No

3. Tests required and results:

	Required		Results mg/l mpn/100ml or Trace	Test Method
	Yes	No		
BOD (Grab)				
TSS (Grab)		/		
Cl (Grab)	/			
Fecal Coliform				

Copies of this report have been forwarded to the following: CUMAL county / homeowner.

Maintenance Technician: Thomas

11

Date of completion: 8.25.21 Start Job Time: _____ Stop Job Time: _____

Maintenance Provider: Walker Chapman

TESTING AND REPORTING RECORD

This Testing and Reporting Record shall be completed, signed and dated after each inspection.

1. Inspection Date: DECEMBER 19, 2021 Installed: 12/31/2019 Service Expires: 12/31/2021

BILLING ADDRESS:
 ROBERT MIRANDA
 1052 EASTVIEW
 CANYON LAKE, TX 78133

PHYSICAL ADDRESS:
 1052 EASTVIEW
 CANYON LAKE, TX 78133

TELEPHONE: 915-260-0253
 ALT. PHONE:

LOT: LT 780,

PERMIT#: 109678
 COUNTY: COMAL
 SN: 19060432
 MAPSCO: N/A

SUBDIVISION: CANYON LAKE FOREST MFG: CLEARSTREAM-600

NOTES: CLEAN EFFLUENT FILTER DURING DECEMBER INSPECTION
 TYPE OF SYSTEM: DRIP

Inspected Item:	Operational	Inoperative
Aerators		
SCFM/Compressors PSI (Record Pressure Reading)	1.75	
Filters	/	
Irrigation Pumps	/	
Recirculation Pumps	N/A	
Disinfection Device	/	
Chlorine Supply	/	
Electrical Circuits	/	
Distribution System	/	
Sprayfield Vegetation	N/A	
Back Flush Drip Field, if applicable	/	
Other as Noted		
Access Posts are Secured		

2. Action taken or Repairs or
 Needed repairs to system (list all
 components replaced):

CHECKED PUMP,
 Alarm, Floats,
 MICRON FILTER.
 Field, Compressor

SYSTEM OPERATING AS DESIGNED? Y / N

Yes No

3. Tests required and results:

	Required		Results mg/l mpn/100ml or Trace	Test Method
	Yes	No		
BOD (Grab)				
TSS (Grab)		/		
Cl (Grab)	/			
Fecal Coliform				

Copies of this report have been forwarded to the following: COMAL county / homeowner.

Maintenance Technician: Thomas 11

Date of completion: 1/11/21 Start Job Time: _____ Stop Job Time: _____

Maintenance Provider: Walker Chapman