



COMAL COUNTY

ENGINEER'S OFFICE

License to Operate On-Site Sewage Treatment and Disposal Facility

Issued This Date: **06/15/2020** Permit Number: **110790**

Location Description: 1530 FM 2673
CANYON LAKE, TX 78133

Subdivision: Daniel C. Hoover Srv. Abst. 219 Sur 322
Unit:
Lot:
Block:
Acreage: 3.8300

Type of System: Aerobic
Drip Irrigation

Issued to: Pedernales Electric Cooperative, Inc (CL)

This license is authorization for the owner to operate and maintain a private facility at the location described in accordance to the rules and regulations for on-site sewerage facilities of Comal County, Texas, and the Texas Commission on Environmental Quality.

The license grants permission to operate the facility. It does not guarantee successful operation. It is the responsibility of the owner to maintain and operate the facility in a satisfactory manner.

Alterations to this permit including, but not limited to:

- Increase in the square feet of living area
- Increase in the number of bedrooms
- A change of use (i.e. residential to commercial)
- Relocation of system components (including the relocation of spray heads)
- Installation of landscaping
- Adding new structures to the system

may require a new permit. **It is the responsibility of the owner to apply for a new permit, if applicable.**

Inspection and licensing of a facility indicates only that the facility meets certain minimum requirements. It does not impede any governmental entity in taking the proper steps to prevent or control pollution, to abate nuisance, or to protect the public health.

This license to operate is valid for an indefinite period. The holder may transfer it to a succeeding owner, provided the facility has not been remodeled and is functioning properly.

Licensing Authority

Comal County Environmental Health

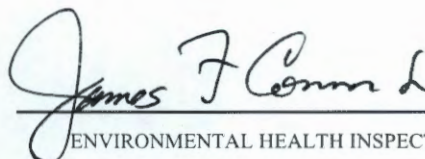
ENVIRONMENTAL HEALTH INSPECTOR

OS0032485

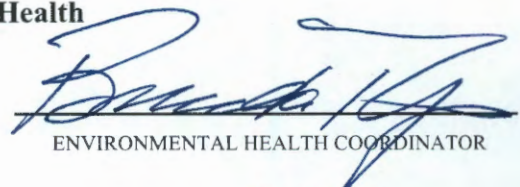
ENVIRONMENTAL HEALTH COORDINATOR

OS0007722

Comal County Environmental Health OSSF Inspection Sheet

Installer Name: Baker Septic OSSF Installer #: OS0032864

1st Inspection Date: 06-05-2020 2nd Inspection Date: 6/10/20 3rd Inspection Date: 6/15/20

Inspector Name: B.Olvera Inspector Name: Connor Inspector Name: Connor

Permit#: 110790 Address: 1530 FM 2673 (Perdenelas Electric Company)

No.	Description	Answer	Citations	Notes	1st Insp.	2nd Insp.	3rd Insp.
1	SITE AND SOIL CONDITIONS & SETBACK DISTANCES Site and Soil Conditions Consistent with Submitted Planning Materials	06-05-20	285.31(a) 285.30(b)(1)(A)(iv) 285.30(b)(1)(A)(v) 285.30(b)(1)(A)(iii) 285.30(b)(1)(A)(ii) 285.30(b)(1)(A)(i)		06-05-20		
2	SITE AND SOIL CONDITIONS & SETBACK DISTANCES Setback Distances Meet Minimum Standards		285.91(10) 285.30(b)(4) 285.31(d)				
3	SEWER PIPE Proper Type Pipe from Structure to Disposal System (Cast Iron, Ductile Iron, Sch. 40, SDR 26)		285.32(a)(1)				
4	SEWER PIPE Slope from the Sewer to the Tank at least 1/8 Inch Per Foot		285.32(a)(3)				
5	SEWER PIPE Two Way Sanitary - Type Cleanout Properly Installed (Add. C/O Every 100' &/or 90 degree bends)		285.32(a)(5)				
6	PRETREATMENT Installed (if required) TCEQ Approved List PRETREATMENT Septic Tank(s) Meet Minimum Requirements		285.32(b)(1)(G)285.32(b)(1)(E)(iii) 285.32(b)(1)(E)(iv) 285.32(b)(1)(F) 285.32(b)(1)(B) 285.32(b)(1)(C)(i) 285.32(b)(1)(C)(ii) 285.32(b)(1)(D) 285.32(b)(1)(E) 285.32(b)(1)(A) 285.32(b)(1)(E)(ii)(II) 285.32(b)(1)(E)(i) 285.32(b)(1)(E)(ii)(I)				
7	PRETREATMENT Grease Interceptors if required for commercial		285.34(d)				

06-05-2020 BMO 6/10/20 JC Drip installed. Operational. Cover.

Tank Set Level No Leaks
Ready for Cover 6/15/20 JC Covered

**Comal County Environmental Health
OSSF Inspection Sheet**

No.	Description	Answer	Citations	Notes	1st Insp.	2nd Insp.	3rd Insp.
8	SEPTIC TANK Tank(s) Clearly Marked SEPTIC TANK If Single Tank, 2 Compartments Provided with Baffle SEPTIC TANK Inlet Flowline Greater than 3" and " T " Provided on Inlet and Outlet SEPTIC TANK Septic Tank(s) Meet Minimum Requirements		285.32(b)(1)(E) 285.91(2) 285.32(b)(1)(F) 285.32(b)(1)(E)(iii) 285.32(b)(1)(E)(ii)(II) 285.32(b)(1)(E)(ii)(I) 285.32(b)(1)(E)(i) 285.32(b)(1)(D) 285.32(b)(1)(C)(ii) 285.32(b)(1)(C)(i) 285.32(b)(1)(B) 285.32(b)(1)(A) 285.32(b)(1)(E)(iv)				
9	ALL TANKS Installed on 4" Sand Cushion/ Proper Backfill Used	06-05-20	285.32(b)(1)(F) 285.32(b)(1)(G) 285.34(b)		06-05-20		
10	SEPTIC TANK Inspection / Clean Out Port & Risers Provided on Tanks Buried Greater than 12" Sealed and Capped		285.38(d)				
11	SEPTIC TANK Secondary restraint system provided SEPTIC TANK Riser permanently fastened to lid or cast into tank SEPTIC TANK Riser cap protected against unauthorized intrusions		285.38(d) 285.38(e)				
12	SEPTIC TANK Tank Volume Installed						
13	PUMP TANK Volume Installed						
14	AEROBIC TREATMENT UNIT Size Installed			SA-800			
15	AEROBIC TREATMENT UNIT Manufacturer AEROBIC TREATMENT UNIT Model Number			Solar Aerobic			
16	DISPOSAL SYSTEM Absorptive		285.33(a)(4) 285.33(a)(1) 285.33(a)(2) 285.33(a)(3)				
17	DISPOSAL SYSTEM Leaching Chamber		285.33(a)(1) 285.33(a)(3) 285.33(a)(4) 285.33(a)(2)				
18	DISPOSAL SYSTEM Evapo-transpirative		285.33(a)(3) 285.33(a)(4) 285.33(a)(1) 285.33(a)(2)				

**Comal County Environmental Health
OSSF Inspection Sheet**

No.	Description	Answer	Citations	Notes	1st Insp.	2nd Insp.	3rd Insp.
19	DISPOSAL SYSTEM Drip Irrigation	X	285.33(c)(3)(A)-(F)			X	
20	DISPOSAL SYSTEM Soil Substitution		285.33(d)(4)				
21	DISPOSAL SYSTEM Pumped Effluent		285.33(a)(3) 285.33(a)(1) 285.33(a)(2)				
22	DISPOSAL SYSTEM Gravelless Pipe		285.33(a)(3) 285.33(a)(2) 285.33(a)(4) 285.33(a)(1)				
23	DISPOSAL SYSTEM Mound		285.33(a)(3) 285.33(a)(1) 285.33(a)(2) 285.33(a)(4)				
24	DISPOSAL SYSTEM Other (describe) (Approved Design)		285.33(d)(6) 285.33(c)(4)				
25	DRAINFIELD Absorptive Drainline 3" PVC or 4" PVC						
26	DRAINFIELD Area Installed						
27	DRAINFIELD Level to within 1 inch per 25 feet and within 3 inches over entire excavation		285.33(b)(1)(A)(v)				
28	DRAINFIELD Excavation Width DRAINFIELD Excavation Depth DRAINFIELD Excavation Separation DRAINFIELD Depth of Porous Media DRAINFIELD Type of Porous Media						
29	DRAINFIELD Pipe and Gravel - Geotextile Fabric in Place		285.33(b)(1)(E)				
30	DRAINFIELD Leaching Chambers DRAINFIELD Chambers - Open End Plates w/Splash Plate, Inspection Port & Closed End Plates in Place (per manufacturers spec.)		285.33(c)(2)				
31	LOW PRESSURE DISPOSAL SYSTEM Adequate Trench Length & Width, and Adequate Separation Distance between Trenches		285.33(d)(1)(C)(i)				

Comal County Environmental Health OSSF Inspection Sheet

No.	Description	Answer	Citations	Notes	1st Insp.	2nd Insp.	3rd Insp.
32	EFFLUENT DISPOSAL SYSTEM Utilized Only by Single Family Dwelling EFFLUENT DISPOSAL SYSTEM Topographic Slopes < 2.0% EFFLUENT DISPOSAL SYSTEM Adequate Length of Drain Field (1000 Linear ft. for 2 bedrooms or Less & an additional 400 ft. for each additional bedroom) EFFLUENT DISPOSAL SYSTEM Lateral Depth of 18 inches to 3 ft. & Vertical Separation of 1ft on bottom and 2 ft. to restrictive horizon and ground water respectfully EFFLUENT DISPOSAL SYSTEM Lateral Drain Pipe (1.25 - 1.5" dia.) & Pipe Holes (3/16 - 1/4" dia. Hole Size) 5 ft. Apart		285.33(b)(3)(A) 285.33(b)(3)(A) 285.33(b)(3)(B) 285.91(13) 285.33(b)(3)(D) 285.33(b)(3)(F)				
33	AEROBIC TREATMENT UNIT Is Aerobic Unit Installed According to Approved Guidelines.	06-05-20	285.32(c)(1)		06-05-20		
34	AEROBIC TREATMENT UNIT Inspection/Clean Out Port & Risers Provided AEROBIC TREATMENT UNIT Secondary restraint system provided AEROBIC TREATMENT UNIT Riser permanently fastened to lid or cast into tank AEROBIC TREATMENT UNIT Riser cap protected against unauthorized intrusions						
35	AEROBIC TREATMENT UNIT Chlorinator Properly Installed with Chlorine Tablets in Place.						
36	PUMP TANK Is the Pump Tank an approved concrete tank or other acceptable materials & construction PUMP TANK Sampling Port Provided in the Treated Effluent Line PUMP TANK Check Valve and/or Anti- Siphon Device Present When Required PUMP TANK Audible and Visual High Water Alarm Installed on Separate Circuit From Pump						
37	PUMP TANK Inspection/Clean Out Port & Risers Provided PUMP TANK Secondary restraint system provided PUMP TANK Riser permanently fastened to lid or cast into tank PUMP TANK Riser cap protected against unauthorized intrusions						
38	PUMP TANK Secondary restraint system provided						
39	PUMP TANK Electrical Connections in Approved Junction Boxes / Wiring Buried	X				X	

**Comal County Environmental Health
OSSF Inspection Sheet**

Final

No.	Description	Answer	Citations	Notes	1st Insp.	2nd Insp.	3rd Insp.
40	APPLICATION AREA Distribution Pipe, Fitting, Sprinkler Heads & Valve Covers Color Coded Purple?	X	285.33(d)(2)(G)(iii)(II)285.33(d)(2)(G)(iii)(III)285.33(d)(2)(G)(v) 285.33(d)(2)(G)(iii) 285.33(d)(2)(G)(iv) 285.33(d)(2)(G)(i) 285.33(d)(2)(G)(ii) 285.33(d)(2)(G)(iii)(I)				
41	APPLICATION AREA Low Angle Nozzles Used / Pressure is as required APPLICATION AREA Acceptable Area, nothing within 10 ft of sprinkler heads? APPLICATION AREA The Landscape Plan is as Designed	X	285.33(d)(2)(G)(i) 285.33(d)(2)(A) 285.33(d)(2)(F)				X
42	APPLICATION AREA Area Installed	X				X	
43	PUMP TANK Meets Minimum Reserve Capacity Requirements						
44	PUMP TANK Material Type & Manufacturer						
45	PUMP TANK Type/Size of Pump Installed						



COMAL COUNTY

ENGINEER'S OFFICE

Permit of Authorization to Construct an On-Site Sewage Facility Permit Valid For One Year From Date Issued

Permit Number: 110790
Issued This Date: 05/18/2020
This permit is hereby given to: Pedernales Electric Cooperative, Inc (CL)

To start construction of a private, on-site sewage facility located at:

1530 FM 2673
CANYON LAKE, TX 78133

Subdivision: Daniel C. Hoover Srv. Abst. 219 Sur 322

Unit:

Lot:

Block:

Acreage: 3.8300

APPROVED MINIMUM SIZES AS PER ATTACHED DESIGN

Type of System: Aerobic
Drip Irrigation

This permit gives permission for the construction of the above referenced on-site facility to commence. Installation must be completed by an installer holding a valid registration card from the Texas Commission on Environmental Quality (TCEQ). Installation and inspection must comply with current TCEQ and Comal County requirements.

Call (830) 608-2090 to schedule inspections.

***** COMAL COUNTY OFFICE OF ENVIRONMENTAL HEALTH *****
APPLICATION FOR PERMIT FOR AUTHORIZATION TO CONSTRUCT AN
ON-SITE SEWAGE FACILITY AND LICENSE TO OPERATE

Date _____

Permit # 110790

Owner Name Pedernales Electric Co-Operative, Inc.
Mailing Address P. O. Box 1
City, State, Zip Johnson City, TX 78636
Phone # 830.868.6056 (Bud Collora)
Email bud.collora@peci.com

Agent Name Douglas R. Dowlearn
Agent Address 703 Oak Drive
City, State, Zip Blanco, TX 78606
Phone # 210.240.2101
Email txseptic@gmail.com

All correspondence should be sent to: Owner Agent Both Method: Mail Email

Subdivision Name _____ Unit _____ Lot _____ Block _____

Acreage/Legal 3.834 acres of the Daniel C. Hoover Survey

Street Name/Address 1530 FM 2673 City Canyon Lake Zip 78133

Type of Development:

Single Family Residential

Type of Construction (House, Mobile, RV, Etc.) _____

Number of Bedrooms _____

Indicate Sq Ft of Living Area _____

RECEIVED

MAY 15 2020

Non-Single Family Residential

COUNTY ENGINEER

(Planning materials must show adequate land area for doubling the required land needed for treatment units and disposal area)

Type of Facility Office

Offices, Factories, Churches, Schools, Parks, Etc. - Indicate Number Of Occupants 49

Restaurants, Lounges, Theaters - Indicate Number of Seats _____

Hotel, Motel, Hospital, Nursing Home - Indicate Number of Beds _____

Travel Trailer/RV Parks - Indicate Number of Spaces _____

Miscellaneous _____

Estimated Cost of Construction: \$ 225,000 (Structure Only)

Is any portion of the proposed OSSF located in the United States Army Corps of Engineers (USACE) flowage easement?

Yes No (If yes, owner must provide approval from USACE for proposed OSSF improvements within the USACE flowage easement)

Source of Water Public Private Well

Are Water Saving Devices Being Utilized Within the Residence? Yes No

By signing this application, I certify that:

- The completed application and all additional information submitted does not contain any false information and does not conceal any material facts. I certify that I am the property owner or I possess the appropriate land rights necessary to make the permitted improvements on said property.
- Authorization is hereby given to the permitting authority and designated agents to enter upon the above described property for the purpose of site/soil evaluation and inspection of private sewage facilities..
- I understand that a permit of authorization to construct will not be issued until the Floodplain Administrator has performed the reviews required by the Comal County Flood Damage Prevention Order.
- I affirmatively consent to the online posting/public release of my e-mail address associated with this permit application, as applicable.

Bud Collora
Signature of Owner

May 4, 2020
Date

***** COMAL COUNTY OFFICE OF ENVIRONMENTAL HEALTH *****
APPLICATION FOR PERMIT FOR AUTHORIZATION TO CONSTRUCT AN
ON-SITE SEWAGE FACILITY AND LICENSE TO OPERATE

Planning Materials & Site Evaluation as Required Completed By Douglas R. Dowlearn

System Description Aerobic Treatment with Drip Disposal

Size of Septic System Required Based on Planning Materials & Soil Evaluation

Tank Size(s) (Gallons) 800 gpd Absorption/Application Area (Sq Ft) 2560 Required

Gallons Per Day (As Per TCEQ Table III) 256

(Sites generating more than 5000 gallons per day are required to obtain a permit through TCEQ.)

Is the property located over the Edwards Recharge Zone? Yes No

(If yes, the planning materials must be completed by a Registered Sanitarian (R.S.) or Professional Engineer (P.E.))

RECEIVED

Is there an existing TCEQ approved WPAP for the property? Yes No

(If yes, the R.S. or P.E. shall certify that the OSSF design complies with all provisions of the existing WPAP.)

MAY 15 2020

If there is no existing WPAP, does the proposed development activity require a TCEQ approved WPAP? Yes No

(If yes, the R.S. or P.E. shall certify that the OSSF design will comply with all provisions of the proposed WPAP. A Permit to Construct will not be issued for the proposed OSSF until the proposed WPAP has been approved by the appropriate regional office.)

COUNTY ENGINEER

Is the property located over the Edwards Contributing Zone? Yes No

Is there an existing TCEQ approval CZP for the property? Yes No

(If yes, the P.E. or R.S. shall certify that the OSSF design complies with all provisions of the existing CZP.)

If there is no existing CZP, does the proposed development activity require a TCEQ approved CZP? Yes No

(If yes, the R.S. or P.E. shall certify that the OSSF design will comply with all provisions of the proposed CZP. A Permit to Construct will not be issued for the proposed OSSF until the CZP has been approved by the appropriate regional office.)

Is this property within an incorporated city? Yes No

If yes, indicate the city: _____

By signing this application, I certify that:

- The information provided above is true and correct to the best of my knowledge.
- I affirmatively consent to the online posting/public release of my e-mail address associated with this permit application, as applicable.

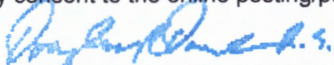

Signature of Designer

4/28/20
Date

Page 2 of 2

Yes



202006016328 05/04/2020 01:54:56 PM 1/1

COUNTY OF COMAL
STATE OF TEXAS

AFFIDAVIT TO THE PUBLIC

CERTIFICATION OF OSSF REQUIRING MAINTENANCE

RECEIVED

MAY 15 2020

COUNTY ENGINEER

According to Texas Commission on Environmental Quality (TCEQ) Rules for On-Site Sewage Facilities (OSSFs), this document is filed in the Deed Records of Comal County, Texas.

I

The Texas Health and Safety Code, Chapter 366 authorizes the Texas Commission on Environmental Quality (TCEQ) to regulate on-site sewage facilities (OSSFs). Additionally, the Texas Water Code (TWC), § 5.012 and § 5.013, give the commission primary responsibility for implementing the laws of the State of Texas relating to water and adopting rules necessary to carry out its powers and duties under the TWC. The commission, under the authority of the TWC and the Texas Health and Safety Code, requires owners to provide notice to the public that certain types of OSSFs are located on specific pieces of property. To achieve this notice, the commission requires a recorded affidavit. Additionally, the owner must provide proof of the recording to the OSSF permitting authority. This recorded affidavit is not a representation or warranty by the commission of the suitability of this OSSF, nor does it constitute any guarantee by the commission that the appropriate OSSF was installed.

II

An OSSF requiring a maintenance contract, according to 30 Texas Administrative Code § 285.91 (12) will be installed on the property described as (insert legal description):
A 3.834 tract of land out of a 32.88 acre tract, out of a 739.04 acre tract as conveyed to Julius Preusser by deed as recorded in Volume 38, Pages 276-278 of the deed records of Comal County, Texas and being also a portion of the Daniel C. Hoover Survey No. 322, in said Comal County, Texas.

The property is owned by (insert owner's full name):
Pedemales Electric Co-Operative, Inc

This OSSF must be covered by a continuous maintenance contract for the first two years. After the initial two-year service policy, the owner of an aerobic treatment system for a single family residence shall either obtain a maintenance contract within 30 days or maintain the system personally.

Upon sale or transfer of the above described property, the permit for the OSSF shall be transferred to the buyer or new owner. A copy of the planning materials for OSSF may be obtained from Comal County Engineer's Office.

WITNESS BY HAND(S) ON THIS 29th DAY OF April 2020

Anthony Callera
Owner(s) signature(s)

Anthony Callera
(PRINTED NAME)

SWORN TO AND SUBSCRIBED BEFORE ME ON THIS 29th DAY OF April 2020

Nelda Morales
Notary Public, State of Texas
Notary's Printed Name: Nelda Morales
My Commission Expires: 8/22/2022

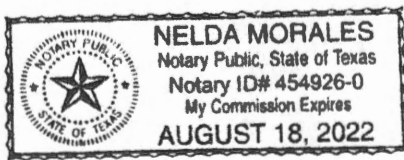

Filed and Recorded
Official Public Records
Bobbie Koepf, County Clerk
Comal County, Texas
05/04/2020 01:54:56 PM
TERRI 1 Page(s)
202006016328



Bobbie Koepf

Baker Septic Service, LLC
15375 Cranes Mill Rd., Canyon Lake, TX 78133
830-899-2971

Septic System Service Agreement

In consideration of payment for this service contract, we will abide by and agree to its terms and conditions:

Name: Pedernales Electric COOP, INC Address: 1530 FM 2673
Subdivision/ County: A-219 SUR322 DC Hoover / City, State, Zip: CANYON LAKE, TX 78133
Permit # _____ Model # _____ Serial # _____

Phone: _____

Initial Two Year Service Agreement & Two Year Limited Warranty
 One Year Service Agreement

RENEWAL _____ NAME TRANSFER _____ ANALYSIS _____

Legal Description:

The Effective date of this initial maintenance contract shall be the date the license to Operate is issued.

For \$ Install this contract will be in effect FROM LITIO - 2yrs and will provide the following:

1. An inspection/service call every (4) four months which will include: inspection, adjustments and servicing of the mechanical & electrical components as necessary to insure proper function of the system.
2. An effluent quality inspection consisting of a visual check for color, turbidity, scum, overflow and odor.
3. **THE PROPERTY OWNER IS RESPONSIBLE FOR PURCHASING AND KEEPING CHLORINE IN THE CHLORINATOR (IF APPLICABLE). IF THE CHLORINE TEST REVEALS "NO CHLORINE" IN THE SYSTEM, THE PROPERTY OWNER MAY INCURE AN ADDITIONAL COST.**
4. If any improper operation is observed (which cannot be corrected at that time) the property owner will be notified immediately of the conditions and the estimated cost.
5. The response time to a complaint by the property owner regarding operation of the system, shall be within **48 hours**, from the time of notification. **One service call a year, if needed, will be provided with no cost to property owner.**
6. **ANY PARTS, WARRANTY OR NON-WARRANTY, FREIGHT CHARGES, LABOR OR SERVICE CALLS DUE NOT PAID FOR REMAIN THE PROPERTY OF BAKER SEPTIC SERVICE, LLC AND COULD RESULT IN REPOSSESSION OF PARTS BY BAKER SEPTIC SERVICE, LLC.**
7. **THE SIGNING OF THIS SERVICE AGREEMENT AUTHORIZES BAKER SEPTIC SERVICE, LLC TO ENTER THE PROPERTY TO EXECUTE ALL TERMS OF THIS CONTRACT.**

BAKER SEPTIC SERVICE, LLC, WILL WARRANTY INSTALLATION of the septic system according to state and county regulations and the designs approved by the county. **HOMEOWNER WILL BE RESPONSIBLE FOR SERVICE CALL, LABOR, AND SHIPPING COSTS ON ANY "WARRANTED PARTS" EXCHANGED DURING WARRANTY.** All other component will be according to manufacturer's warranties.

IMPORTANT: As Baker Septic Service, LLC cannot control what or how much effluent goes into this septic system, we cannot warranty how the system will function. Refer to manufacturers or installers instructions for suggestions on septic operation. This service agreement does not cover the cost of service call, labor or materials that are required or **parts out of warranty**, the failure to maintain electrical power to the system, **sprinklers that are broken, leaking, stopped-up or otherwise mal-functioning**; or sewage flows exceeding the hydraulic/organic design capabilities and the input of non-biodegradable materials (solvent, grease, oil, paints, etc.), or any usage contrary to the requirements as advised by authorized service representative. Laboratory test work is available at an additional cost. Chlorine, filters, or parts that are out of warranty are available at a reasonable cost.

This contract does not include the pumping of a tank or of any compartment of a tank, or settlement of soil on or around any part of the system regardless of reason:

Violations of the warranty also include: Disconnecting the alarm, restricting ventilation to the aerator, over loading the system above its rated capacity; or flooding by external means. Rodent, insect or Fire Ant damage or any other form of unusual abuse is a violation.

A renewal service contract should be activated (30) thirty days before expiration of existing contract. We will contact property owner prior to expiration of existing contract.

Serviced by: Baker Septic Service, LLC

Maintenance Provider MP0002099

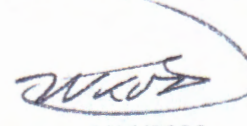

(x) Bud Collora

Print Name (x) Bud Collora - PM

Date: 5/11/2020

Property Owner Signature

(x) William Baker

Date: 5/11/2020 Authorized Service Representative

RECEIVED
MAY 15 2020
COUNTY ENGINEER

OSSF SOIL EVALUATION REPORT INFORMATION

REVISED

2:52 pm, May 21, 2020

Date: 5/21/20
Applicant Information:
Name: Pedernales Electric Co-Operative, Inc. c/o
Bud Collora
Address: P. O. Box 1
City, State & Zip Code: Johnson City, TX 78636
Phone: 830.868.6056 (Bud Collora)
Email: bud.collora@peci.com

Site Evaluator Information:
Name: Douglas R. Dowlearn
Company: D.A.D. Services, Inc.
Address: 703 Oak Drive
City, State & Zip: Blanco, TX 78606
Phone: (210)240-2101 **Fax:** (866)260-7687
Email: txseptic@gmail.com

Property Location:
Legal: 3.834 acres of the Daniel C. Hoover Survey
No. 322
Street/Road Address: 1530 FM 2673
City: Canyon Lake **Zip:** 78133
Additional Info: Comal County/3.834 Acres

Installer Information:
Name: William Baker
Company: Baker Septic
Address:
City, State & Zip:
Phone: **Fax:**

Depth	Texture Class	Soil Texture	Structure (For Class III - blocky, platy or massive)	Drainage (Mottles/Water Table)	Restrictive Horizon	Observation
Soil Boring #1 60"	IV	0-12" Silty Clay 12"+ Limestone		<30% Gravel	12"+ Limestone	None
Soil Boring #2 60"		Same as above				

DESIGN SPECIFICATIONS

Application Rate (RA): 0.1

OSSF is designed for: 34 employees (no food or shower)@4 gpd = 136 gpd and 15 employees (with food service)@8gpd = 120 gpd for a total of 256 gpd
256 Gallons per day required

An aerobic treatment/drip disposal system is to be utilized based on the site evaluation.

2560 sq. ft. disposal area required

800 gallon/day aerobic tank required

Calculations: Absorption Area: $Q/RA = 256 / 0.1 = 2560$ Sq. Ft.

FEATURES OF SITE AREA

Presence of 100-year flood zone: NO

Existing or proposed water well in nearby area: NO

Presence of adjacent ponds, streams, water impoundments: NO

Presence of upper water shed: NO

Organized sewage service available to lot: NO

I certify that the findings of this report are based on my field observations and are accurate to the best of my ability. The site evaluation and OSSF design are subject to approval by the TCEQ or the local authorized agent. The planning materials and the OSSF design should not be considered final until a permit to construct has been issued.

Site Evaluator:
NAME: Douglas R. Dowlearn, R.S.

License No. OS9902 - Exp. 6/30/2020
TDH: #2432 - Exp. 2/28/2021

Signature:



REVISED

2:52 pm, May 21, 2020

D.A.D SERVICES, INC.

DOUG DOWLEARN

703 OAK DRIVE, BLANCO, TX 78606

Designed for: Pedernales Electric Co-Operative, Inc. c/o Bud Collora

The installation site is on 3.834 acres of the Daniel C. Hoover Survey No. 322 in Comal County, TX. The proposed OSSF will treat the wastewater from a 49 employees office building. The proposed method of wastewater treatment is aerobic treatment with drip irrigation. This method was chosen because of unsuitable soil conditions.

PROPOSED SYSTEM:

A 4" PVC pipe will discharge from the office building to a pre-treatment tank, which flows into an 800 gpd aerobic treatment plant. The pump is activated by a time controller allowing the distribution 8 times per day with a 5 minute run time with float switches set to pump 256 gallons per day. A high level audible and visual alarm will activate should the pump fail. Distribution from the pump is through a self flushing 100 mesh spin filter then through a 1" SCH-40 manifold to a 1298 L.F. drip tubing field, with drip lines set approximately two feet apart with 0.61 emitters set every two feet, as per the attached schematic. A hose bib will be installed in the pump tank on the supply manifold to the drip field. A 1" SCH-40 return line with a pressure gauge is installed to periodically flush the system and will maintain pressure between 20 to 40 psi. Solids caught in the spin filter are flushed each cycle back to the pre-treatment tank. Vacuum breakers installed at the highest point on each manifold will prevent siphoning of effluent from higher to lower parts of the field. The placement of the drip tubing will be on soil that has been scarified. The tubing will be covered with 6" of Class II soil.

DESIGN SPECIFICATIONS:

Daily Waste Flow: 256 gpd
Application rate: 0.1
Application area required: $256/.1 = 2560$ ft. sq.
Application area utilized: 2596 sq. ft.
Pump tank reserve capacity: 128 gal minimum



Douglas R. Dowlearn

5/21/20

SYSTEM COMPONENTS:

SCH 40 PVC sewer line
1" purple PVC supply line
800 gpd aerobic treatment plant with timed controls
Liquid chlorinator
Pump tank
Pretreatment tank

REVISED

2:52 pm, May 21, 2020

LANDSCAPING:

The native vegetation in the distribution area should consist of low level shrubs, plains grass, bluestem or bermuda. The entire area of the drip disposal must be covered with a ground cover such as grass seed or sod prior to the final inspection. The placement of the drip tubing will be on soil that has been scarified. The tubing will be covered with 6" of Class II soil. In the event the natural cover is disturbed, a suitable ground cover must be installed on all excavated areas.

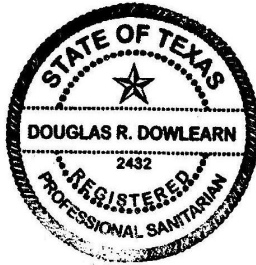

Douglas R. Dowlearn

5/21/20

REVISED

2:52 pm, May 21, 2020

PEDERNALES ELECTRIC CO-OPERATIVE, INC.
 C/O BUD COLLORA
 1530 FM 2673
 CANYON LAKE, TX 78133
 3.834 ACRES OF THE DANIEL C. HOOVER SURVEY
 NO.322
 COMAL COUNTY/3.834 ACRES
 * = TEST HOLES

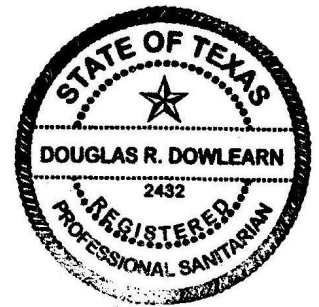

Douglas R. Dowlearn

5/21/20

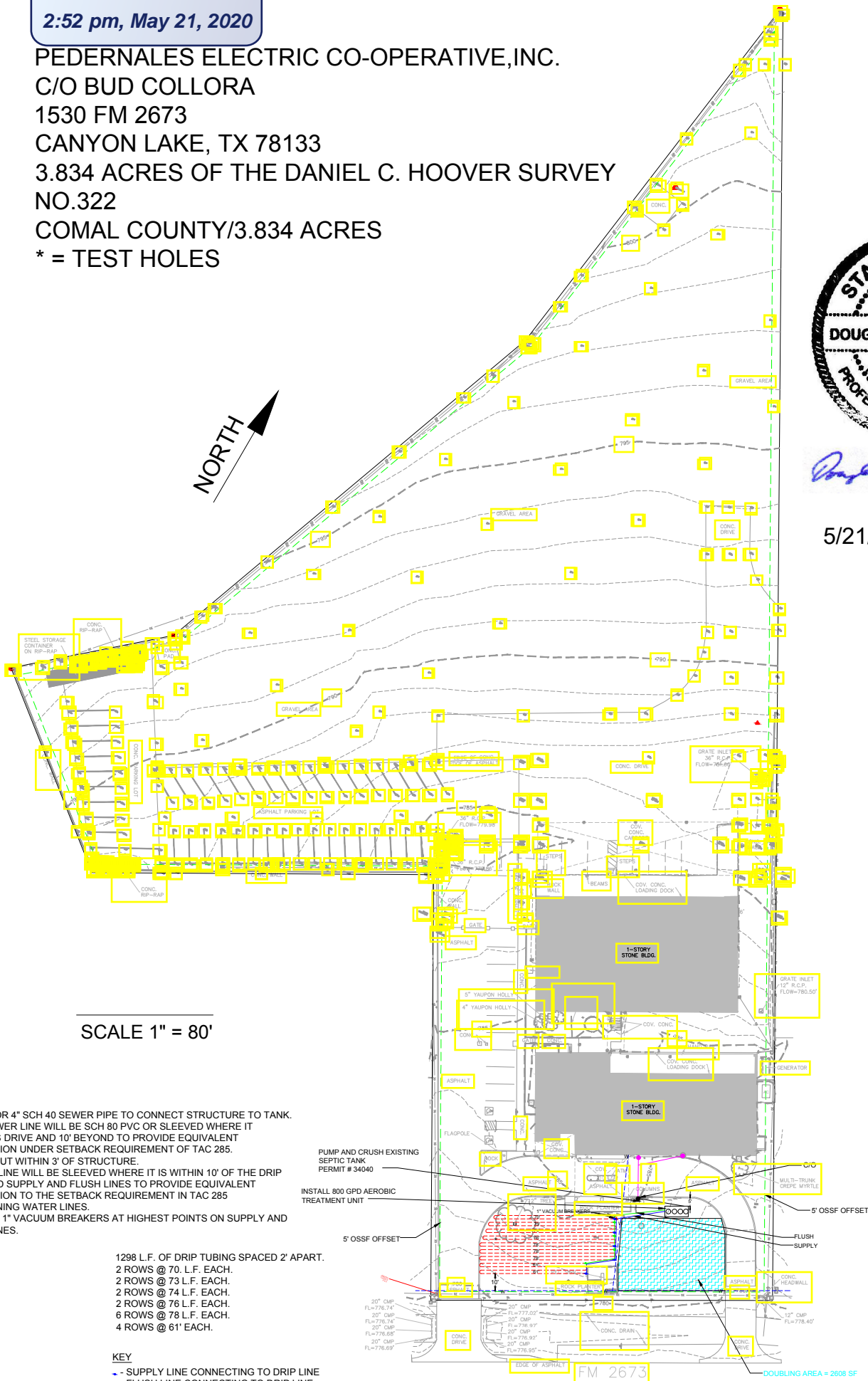

SCALE 1" = 80'

- NOTES:**
- USE 3" OR 4" SCH 40 SEWER PIPE TO CONNECT STRUCTURE TO TANK.
 - THE SEWER LINE WILL BE SCH 80 PVC OR SLEEVED WHERE IT CROSSES DRIVE AND 10' BEYOND TO PROVIDE EQUIVALENT PROTECTION UNDER SETBACK REQUIREMENT OF TAC 285.
 - CLEANOUT WITHIN 3' OF STRUCTURE.
 - WATER LINE WILL BE SLEEVED WHERE IT IS WITHIN 10' OF THE DRIP AREA AND SUPPLY AND FLUSH LINES TO PROVIDE EQUIVALENT PROTECTION TO THE SETBACK REQUIREMENT IN TAC 285 CONCERNING WATER LINES.
 - INSTALL 1" VACUUM BREAKERS AT HIGHEST POINTS ON SUPPLY AND FLUSH LINES.

- 1298 L.F. OF DRIP TUBING SPACED 2' APART.
- 2 ROWS @ 70. L.F. EACH.
- 2 ROWS @ 73 L.F. EACH.
- 2 ROWS @ 74 L.F. EACH.
- 2 ROWS @ 76 L.F. EACH.
- 6 ROWS @ 78 L.F. EACH.
- 4 ROWS @ 61' EACH.

KEY

- SUPPLY LINE CONNECTING TO DRIP LINE
- FLUSH LINE CONNECTING TO DRIP LINE
- 1" VACUUM BREAKER
- INSTALLED BY LICENSED PLUMBER
- DOUBLING AREA

REVISED

2:52 pm, May 21, 2020

1-STORY
STONE BLDG.

GRATE INLET
12" R.C.P.
FLOW=780.50'

5" YAUPON HOLLY
4" YAUPON HOLLY

COV. CONC.
LOADING DOCK

1-STORY
STONE BLDG.



Douglas R. Dowlearn
5/21/20

C/O
MULTI-TRUNK
CREPE MYRTLE

5' OSSF OFFSET

FLUSH
SUPPLY

CONC.
HEADWALL

12" CMP
FL=778.40'

FM 2673

DOUBLING AREA = 2608 SF

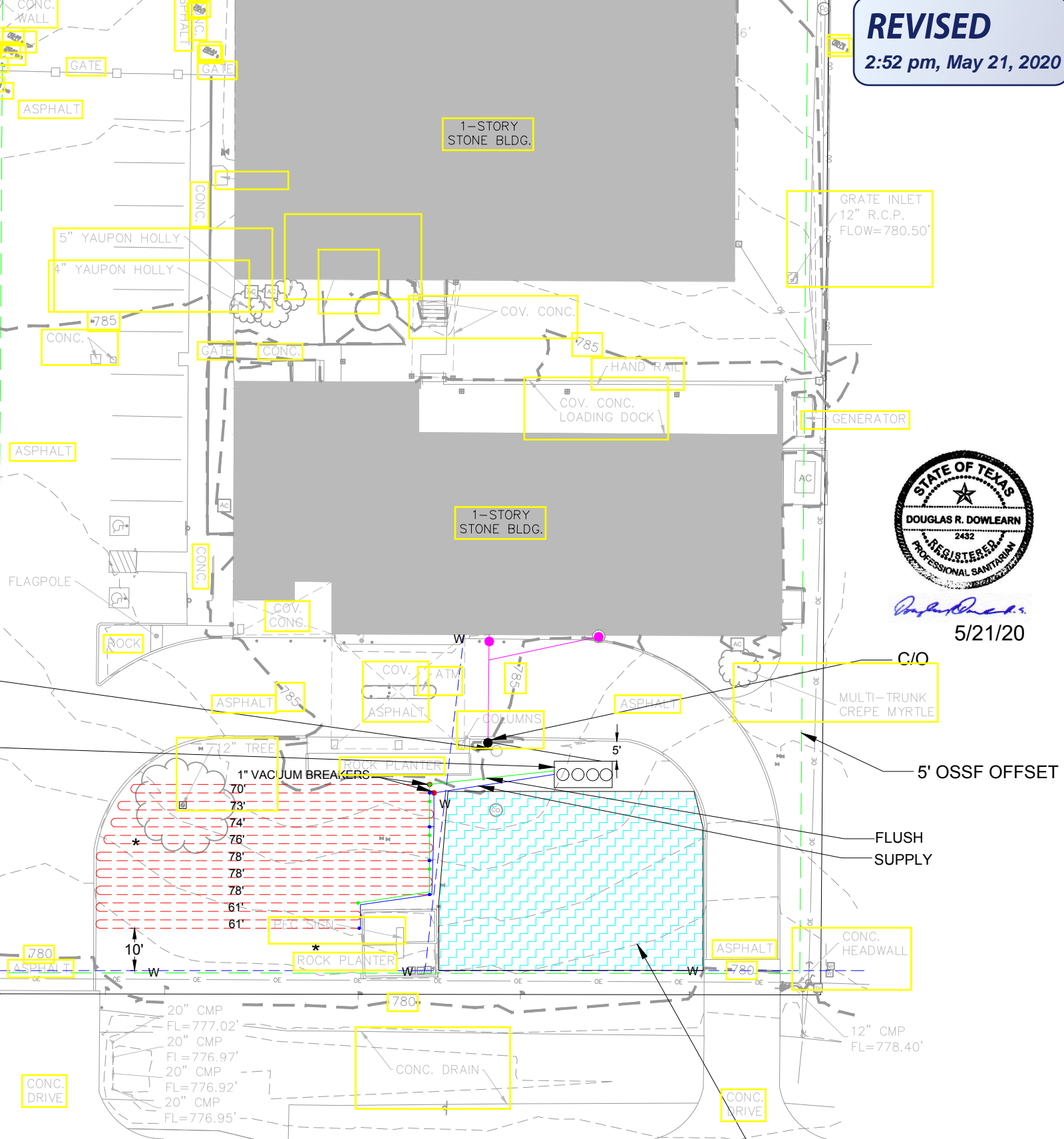
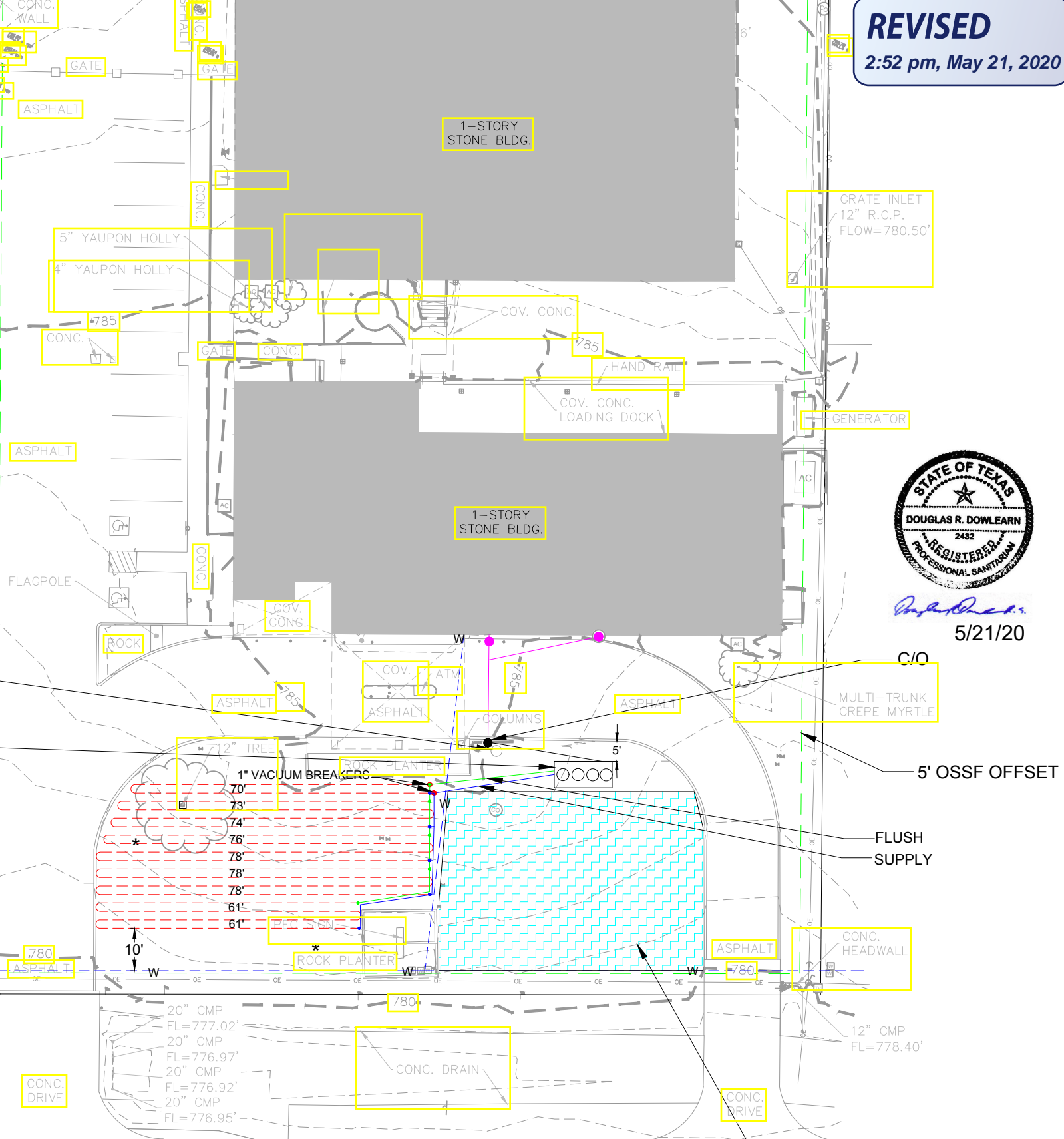

OSSF SOIL EVALUATION REPORT INFORMATION

VOID

Date: 4/29/20
Applicant Information:
Name: Pedernales Electric Co-Operative, Inc. c/o Bud Collora
Address: P. O. Box 1
City, State & Zip Code: Johnson City, TX 78636
Phone: 830.868.6056 (Bud Collora)
Email: bud.collora@peci.com

Site Evaluator Information:
Name: Douglas R. Dowlearn
Company: D.A.D. Services, Inc.
Address: 703 Oak Drive
City, State & Zip: Blanco, TX 78606
Phone: (210)240-2101 **Fax:** (866)260-7687
Email: txseptic@gmail.com

Property Location:
Legal: 3.834 acres of the Daniel C. Hoover Survey No. 322
Street/Road Address: 1530 FM 2673
City: Canyon Lake **Zip:** 78133
Additional Info: Comal County/3.834 Acres

Installer Information:
Name:
Company:
Address:
City, State & Zip:
Phone: **Fax:**

RECEIVED
MAY 15 2020
COUNTY ENGINEER

Depth	Texture Class	Soil Texture	Structure (For Class III - blocky, platy or massive)	Drainage (Mottles/Water Table)	Restrictive Horizon	Observation
Soil Boring #1 60"	IV	0-12" Silty Clay 12"+ Limestone	VOID	<30% Gravel	12"+ Limestone	None
Soil Boring #2 60"		Same as above				

DESIGN SPECIFICATIONS

Application Rate (RA): 0.1
OSSF is designed for: 34 employees (no food or shower)@4 gpd = 136 gpd and 15 employees (with food service)@8gpd = 120 gpd for a total of 256 gpd
256 Gallons per day required
An aerobic treatment/drip disposal system is to be utilized based on the site evaluation.
2560 sq. ft. disposal area required
800 gallon/day aerobic tank required
Calculations: Absorption Area: $Q/RA = 256 / 0.1 = 2560$ Sq. Ft.

FEATURES OF SITE AREA

Presence of 100-year flood zone: NO
Existing or proposed water well in nearby area: NO
Presence of adjacent ponds, streams, water impoundments: NO
Presence of upper water shed: NO
Organized sewage service available to lot: NO

I certify that the findings of this report are based on my field observations and are accurate to the best of my ability. The site evaluation and OSSF design are subject to approval by the TCEQ or the local authorized agent. The planning materials and the OSSF design should not be considered final until a permit to construct has been issued.

Site Evaluator:
NAME: Douglas R. Dowlearn, R.S.

License No. OS9902 - Exp. 6/30/2020
TDH: #2432 - Exp. 2/28/2021

Signature: 

VOID

VOID

D. A. SERVICES, INC.

DOUG DOWLEARN

703 OAK DRIVE, BLANCO, TX 78606

Designed for: Pedernales Electric Co-Operative, Inc. c/o Bud Collora

The installation site is on 3.834 acres of the Daniel C. Hoover Survey No. 322 in Comal County, TX. The proposed OSSF will treat the wastewater from a 49 employees office building. The proposed method of wastewater treatment is aerobic treatment with drip irrigation. This method was chosen because of unsuitable soil conditions.

RECEIVED

MAY 15 2020

COUNTY ENGINEER

PROPOSED SYSTEM:

A 4" PVC pipe will discharge from the office building to a pre-treatment tank, which flows into an 800 gpd aerobic treatment plant. The pump is activated by a time controller allowing the distribution 8 times per day with a 5 minute run time with float switches set to pump 256 gallons per day. A high level audible and visual alarm will activate should the pump fail. Distribution from the pump is through a self flushing 100 mesh spin filter through a 1" SCH-40 manifold to a 1280 L.F. drip tubing field, with drip lines set approximately two feet apart with 0.61 emitters set every two feet, as per the attached schematic. A hose bib will be installed in the pump tank on the supply manifold to the drip field. A 1" SCH-40 return line with a pressure guage is installed to periodically flush the system and will maintain pressure between 20 to 40 psi. Solids caught in the spin filter are flushed each cycle back to the pre-treatment tank. Vacuum breakers installed at the highest point on each manifold will prevent siphoning of effluent from higher to lower parts of the field. The placement of the drip tubing will be on soil that has been scarified. The tubing will be covered with 6" of Class II soil.

VOID

DESIGN SPECIFICATIONS:

- Daily Waste Flow: 256 gpd
- Application rate: 0.1
- Application area required: $256 / .1 = 2560$ ft. sq.
- Application area utilized: 2560 sq. ft.
- Pump tank reserve capacity: 128 gal minimum



Douglas R. Dowlearn
4/29/20

SYSTEM COMPONENTS:

- SCH 40 PVC sewer line
- 1" purple PVC supply line
- 800 gpd aerobic treatment plant with timed controls
- Liquid chlorinator
- Pump tank
- Pretreatment tank

VOID

VOID

The native vegetation in the distribution area should consist of low level shrubs, plains grass, bluestem or bermuda. The entire area of the drip disposal must be covered with a ground cover such as grass seed or sod prior to the final inspection. The placement of the drip tubing will be on soil that has been scarified. The tubing will be covered with 6" of Class II soil. In the event the natural cover is disturbed, a suitable ground cover must be installed on all excavated areas.

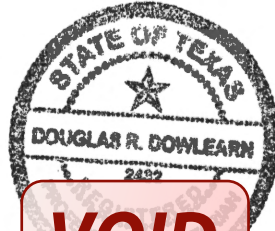

VOID

Douglas R. Dowlearn
4/29/20

RECEIVED
MAY 15 2020
COUNTY ENGINEER

VOID

VOID

PEDERNALES ELECTRIC CO-OPERATIVE, INC.
C/O BUD COLLORA
1530 FM 2673
CANYON LAKE, TX 78133
3.834 ACRES OF THE DANIEL C. HOOVER SURVEY
NO.322
COMAL COUNTY/3.834 ACRES
* = TEST HOLES



VOID

RECEIVED
MAY 15 2020
COUNTY ENGINEER

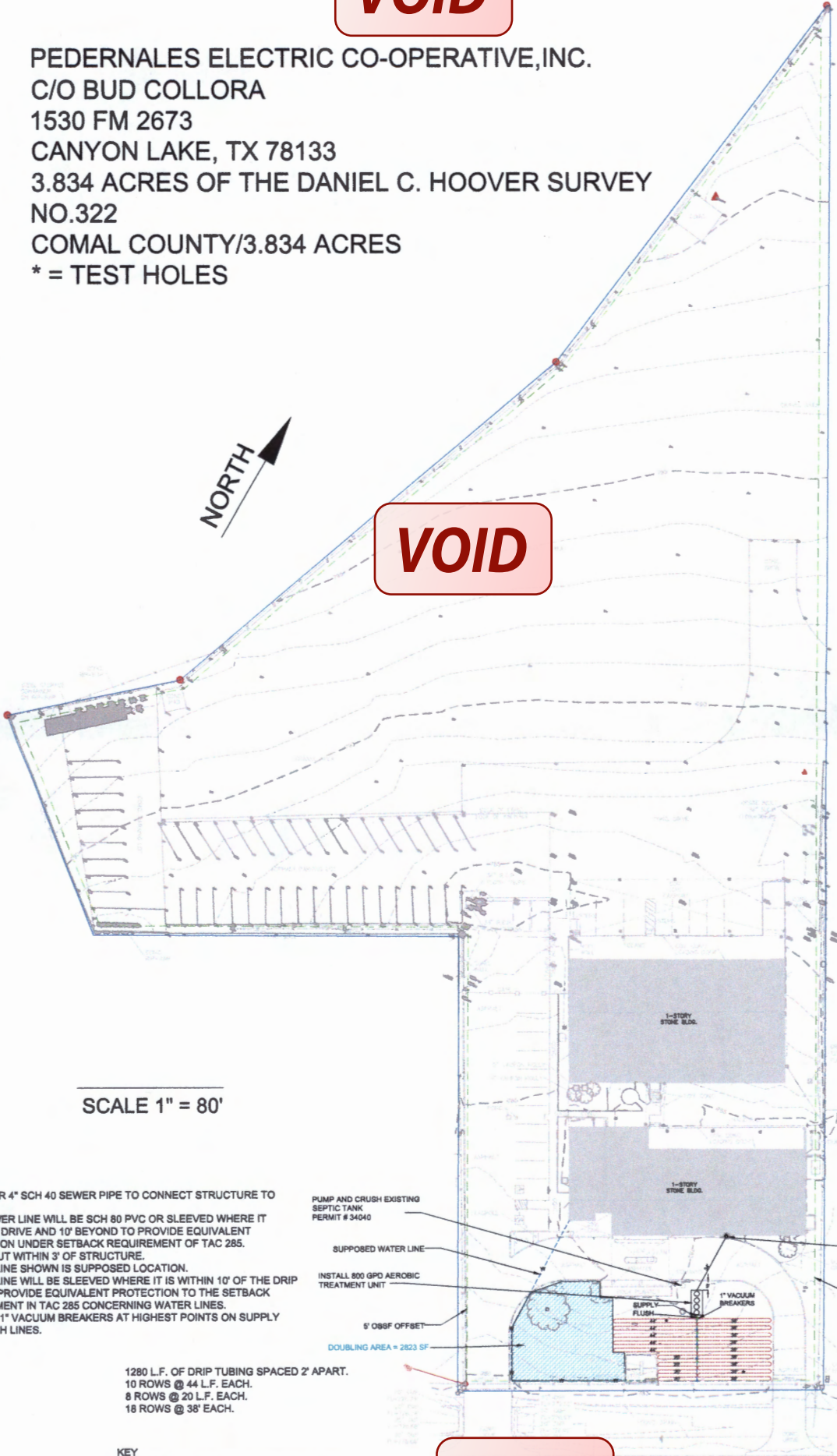

SCALE 1" = 80'

NOTES:

- USE 3" OR 4" SCH 40 SEWER PIPE TO CONNECT STRUCTURE TO TANK.
- THE SEWER LINE WILL BE SCH 80 PVC OR SLEEVED WHERE IT CROSSES DRIVE AND 10' BEYOND TO PROVIDE EQUIVALENT PROTECTION UNDER SETBACK REQUIREMENT OF TAC 285.
- CLEANOUT WITHIN 3' OF STRUCTURE.
- WATER LINE SHOWN IS SUPPOSED LOCATION.
- WATER LINE WILL BE SLEEVED WHERE IT IS WITHIN 10' OF THE DRIP AREA TO PROVIDE EQUIVALENT PROTECTION TO THE SETBACK REQUIREMENT IN TAC 285 CONCERNING WATER LINES.
- INSTALL 1" VACUUM BREAKERS AT HIGHEST POINTS ON SUPPLY AND FLUSH LINES.

PUMP AND CRUSH EXISTING SEPTIC TANK PERMIT # 34040

SUPPOSED WATER LINE

INSTALL 800 GPD AEROBIC TREATMENT UNIT

5' OBSF OFFSET

DOUBLING AREA = 2823 SF

C/O

5' OBSF OFFSET

1280 L.F. OF DRIP TUBING SPACED 2' APART.
10 ROWS @ 44 L.F. EACH.
8 ROWS @ 20 L.F. EACH.
18 ROWS @ 38' EACH.

KEY

- - SUPPLY LINE CONNECTING TO DRIP LINE
- - FLUSH LINE CONNECTING TO DRIP LINE
- - 1" VACUUM BREAKER

VOID



Douglas R. Dowlearn

4/29/20

VOID

1-STORY
STONE BLDG.

RECEIVED

MAY 15 2020

COUNTY ENGINEER

VOID

1-STORY
STONE BLDG.



Douglas R. Dowlearn

4/29/20

C/O

5' OSSF OFFSET

SUPPLY
FLUSH

1" VACUUM
BREAKERS

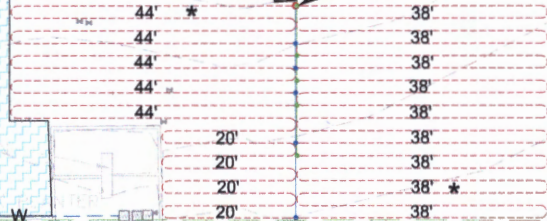

VOID

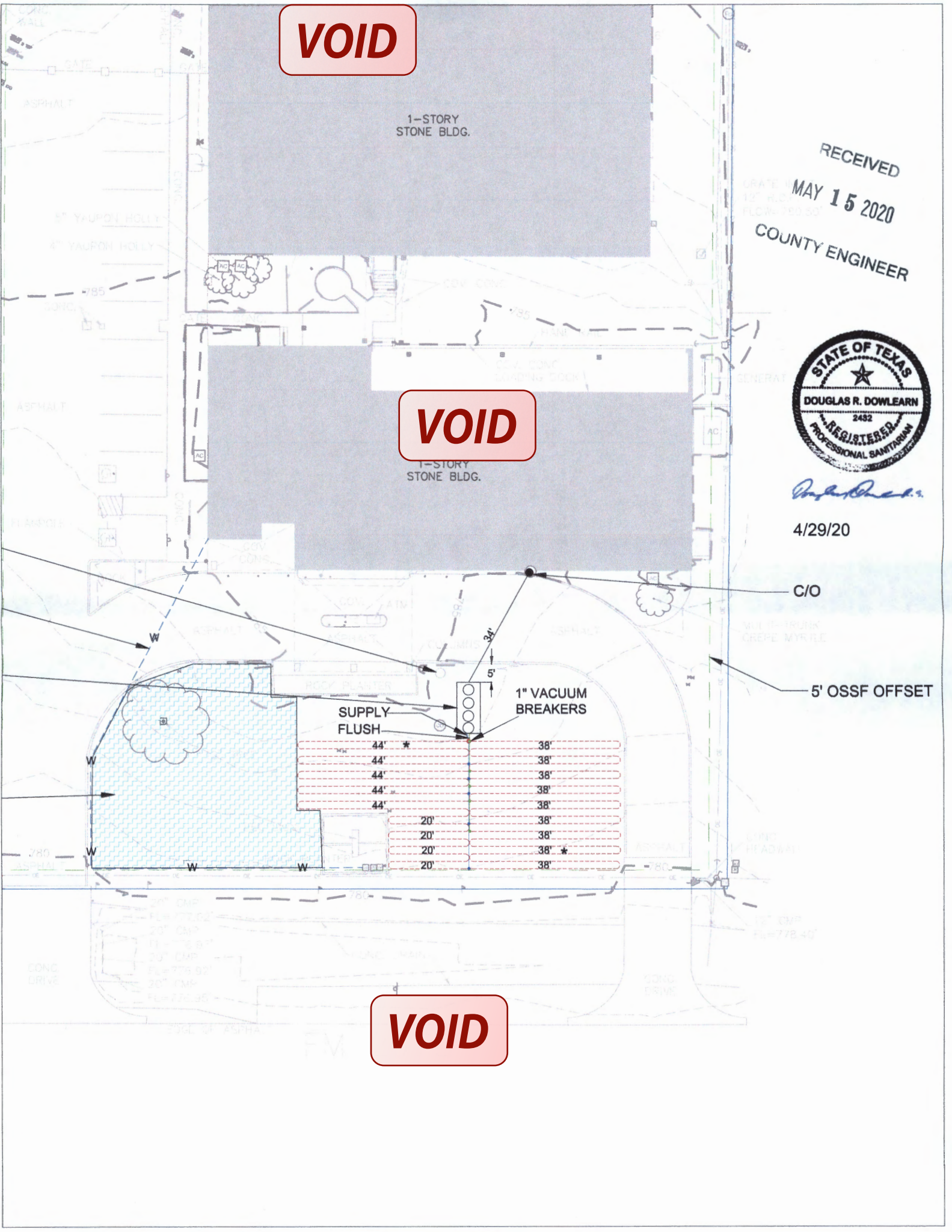

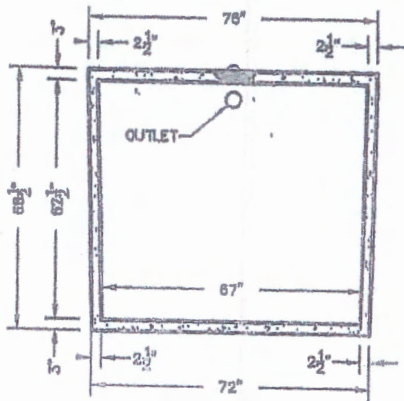

SECTION B-B

RECEIVED
MAY 15 2020
COUNTY ENGINEER

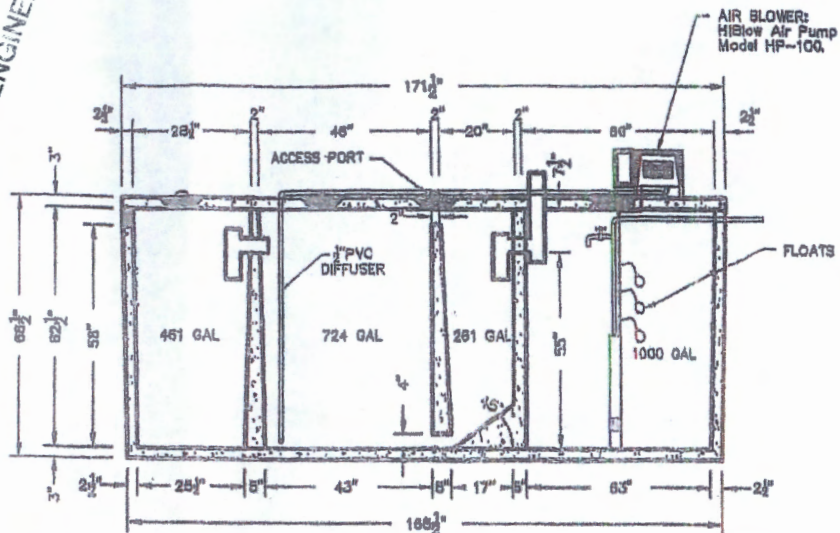

SECTION A-A

18.18 Gallons Per Inch

- 41"-55" - Reserve - 254 Gallons
- 41" - Alarm
- 14" - 41" - Working Level - 491 Gallons
- 11" - 14" - On/Off Tether - 55 Gallons
- 0-11" - Sump - 200 Gallons



Douglas R. Dowle
5/11/20

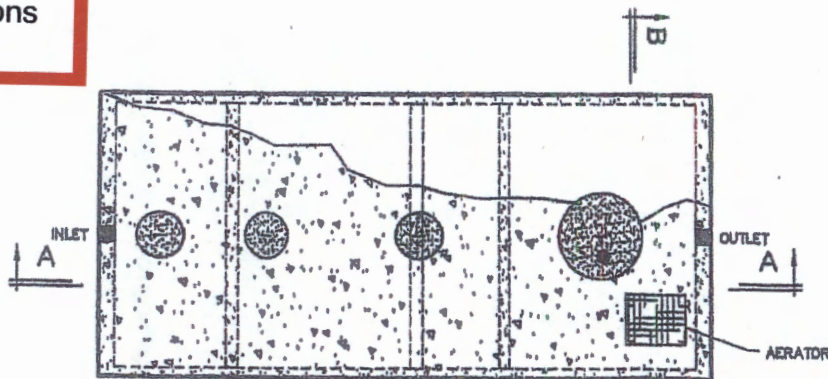

PLAN VIEW

REVISION:	DATE:

MODEL SA600-1000PT
SEWER TREATMENT SYSTEM

SOLAR AEROBIC
6754 HWY 90 EAST
LAKE CHARLES, LA 70615
PHONE: (337) 439-0680

TREATMENT PLANT
SA-5
JULY 2011
NONE

DATE 11/15/91

LICENSE NO. 71800

**CCEO
COPY**

REMODEL
Old Permit # 34040



Comal County

OFFICE OF ENVIRONMENTAL HEALTH

LICENSE TO OPERATE A PRIVATE SEWAGE FACILITY

OWNER PEDERNALES ELECTRIC

PROPERTY LOCATION FM 2673

STREET _____ UNIT _____ BLOCK _____ LOT _____

THIS LICENSE IS AUTHORIZATION FOR THE OWNER TO OPERATE AND MAINTAIN A PRIVATE FACILITY AT THE LOCATION DESCRIBED IN ACCORDANCE TO THE RULES OF COMAL COUNTY, TEXAS, FOR PRIVATE SEWAGE FACILITIES (RULES).

THE LICENSE GRANTS PERMISSION TO OPERATE THE FACILITY. IT DOES NOT GUARANTEE SUCCESSFUL OPERATION OR SATISFACTORY SERVICE. IT IS THE RESPONSIBILITY OF THE OWNER TO MAINTAIN AND OPERATE THE FACILITY IN A SATISFACTORY MANNER.

INSPECTION AND LICENSING OF A FACILITY INDICATES ONLY THAT THE FACILITY MEETS CERTAIN MINIMUM REQUIREMENTS. IT DOES NOT IMPEDE ANY GOVERNMENTAL ENTITY IN TAKING THE PROPER STEPS TO PREVENT OR CONTROL POLLUTION, TO ABATE A NUISANCE, OR TO PROTECT THE PUBLIC HEALTH.

THIS LICENSE TO OPERATE ISSUED UNDER THE AUTHORITY OF THESE RULES IS FOR AN INDEFINITE PERIOD. IT SHALL BE TRANSFERRED TO A SUCCEEDING OWNER. THE LICENSE SHALL BE TRANSFERRED UPON THE REQUEST OF THE NEW OWNER, PROVIDED THE FACILITY HAS NOT BEEN SUBSTANTIALLY MODIFIED.

THE FACILITY IS LICENSED FOR:

- _____ SINGLE FAMILY RESIDENCE WITH _____ BEDROOMS AND _____ SQUARE FEET.
- _____ INSTITUTION Office () Less than 500 gallons per day
- _____ INSTITUTION _____ () Greater than 500 gallons per day
- _____ OTHER ALTERNATIVE SYSTEMS _____

THE FACILITY CONSISTS OF:

Existing 1000 Gallon Tank Switching Valve _____ Yes _____ No

Drainfield Size _____ Sq. Ft. Trench _____ Bed _____

~~XXXXXX~~ _____ Replaced 2 fields @ 900 sq.ft.

[Signature]
Inspector

[Signature]
Sanitarian

CCEO
COPY

PEC

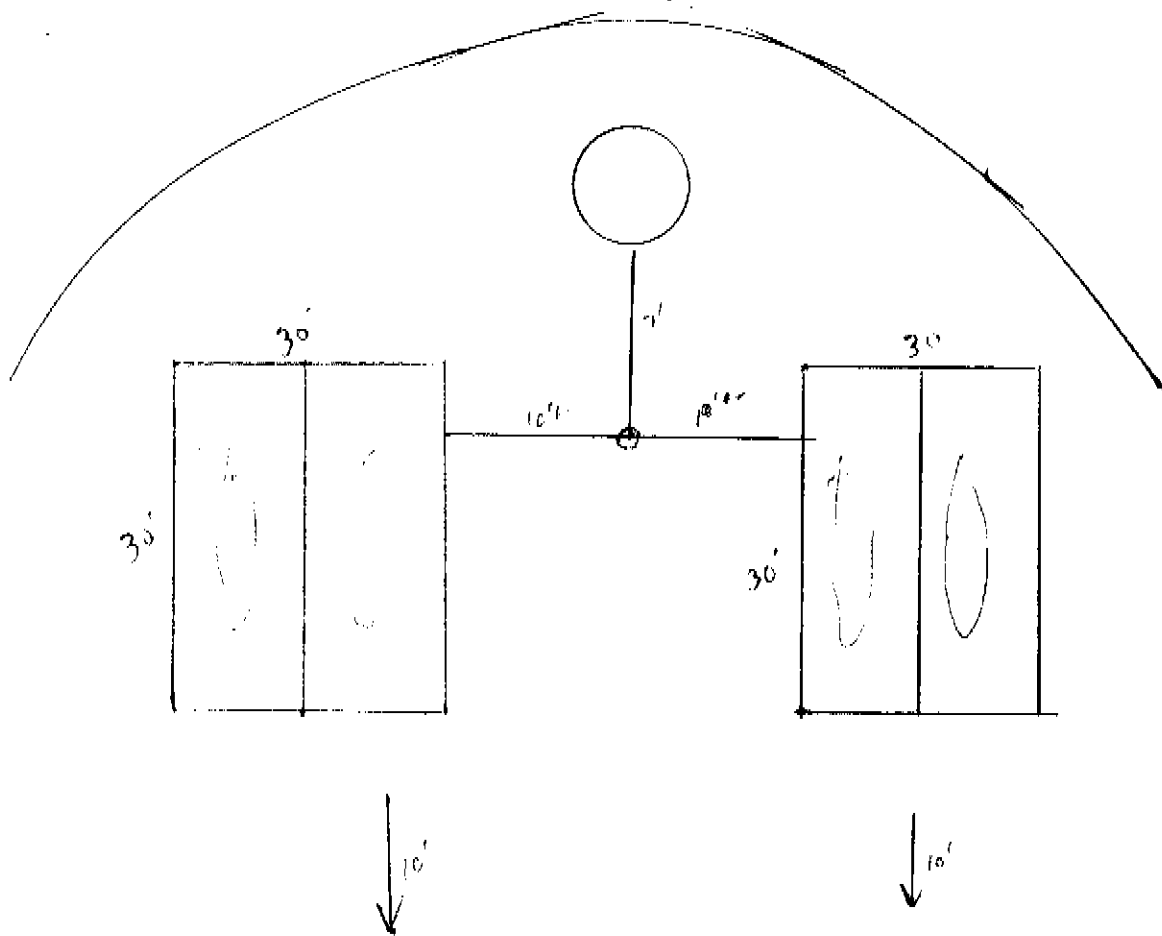

Ray Rodman

FM 2673

Posted
7/30/74

Permit No. 34040

APPLICATION FOR SEPTIC SYSTEM PERMIT
(To be submitted in Duplicates Only)

CCEO
COPY

NAME and LOCATION of PROPERTY where Septic System is to be installed:
PEDERNALES ELECTRIC F.M. 2673 A-SATTER

UNIT NO. _____ BLOCK NO. _____ LOT NO. BUSINESS
Dimension of Property 20,000 +

Description of Structure

No. Bedrooms _____ No. Bathrooms 2 Disposal - W, Machine -

Size of Septic System 1000 gal. NO. Feet Laterals 1800 sq. ft. PITS

Date 7/29/74

A&C CONST. CO.
Sanitary Facility Contractor

PEDERNALES ELECTRIC
OWNER

NEW BRAUNFELS
Address

JOHNSON CITY
Address

All recommendations are minimum requirements as prescribed by the
TEXAS HEALTH DEPARTMENT
Austin, Texas

NOTE: For the information to be submitted in connection with this application,
see the requirements outlined in the current TEXAS WATER QUALITY BOARD ORDER.

Comal County Sanitation Department
Room 114, Courthouse
New Braunfels, Texas 78130

SEATTLE
ENG. SPEC'S

The State of Texas,
County of COMAL

} Know All Men by These Presents:

That TOM J. SHERIDAN PROPERTIES, INC.,
a Corporation, duly organized and existing under the Laws of the State of Texas
for and in consideration of the sum of
and other valuable consideration
to it in hand paid by

TEN and NO/100 (\$10.00) DOLLARS

SECTION 5052

PEDERNALES ELECTRIC CO-OPERATIVE, INC.,

has Granted, Sold and Conveyed, and by these presents does Grant, Sell and Convey, unto the said
PEDERNALES ELECTRIC CO-OPERATIVE, INC.,
of the County of Comal State of Texas all that certain
tracts or parcels of land described as follows, to-wit:

TRACT #1: BEING known as LOTS 5 and 6 in SATTLE
VILLAGE UNIT #5, a subdivision in Comal
County, Texas, according to a map or
plat of said subdivision as recorded in
Vol. 3, page 32, Map and Plat Records of
Comal County, Texas; and

TRACT #2:

A 3.834 ACRE TRACT OF LAND OUT OF A 32.88 ACRE TRACT, OUT OF A 739.04 ACRE TRACT AS
CONVEYED TO JULIUS PREUSSER BY DEED AS RECORDED IN VOLUME 38, PAGES 276-278 OF THE DEED
RECORDS OF COMAL COUNTY, TEXAS AND BEING ALSO A PORTION OF THE DANIEL C. HOOVER SURVEY
NO. 322, IN SAID COMAL COUNTY, TEXAS AND BEING MORE PARTICULARLY DESCRIBED BY METES AND
BOUNDS AS FOLLOWS, TO WIT;

BEGINNING at an iron stake found in the northerly right-of-way line of State Highway No.
F.M. 2673, for the most southerly corner of a subdivision known as Sattler Village, Unit
No. 5, and for the most easterly corner of the tract herein described;

THENCE; along said right-of-way line, S 65° 23' W a distance of 200.0 feet to an iron
stake set for the mosterly corner of the tract herein described;

THENCE; leaving said right-of-way line and severing said 32.88 acre tract, N 24° 37' W a
distance of 250.0 feet to an iron stake set for a re-entrant corner of the tract
hersin described;

THENCE; S 65° 23' W a distance of 200.0 feet to an iron stake set;

THENCE; N 46° 18' W a distance of 129.38 feet to an iron stake found in a fence line
for an angle point in the northerly line of said 32.88 acre tract and for the
most westerly corner of the tract herein described;

THENCE; along the northerly line of said 32.88 acre tract and the northwesterly line of
the tract herein described, N 54° E a distance of 97.3 feet to an iron stake
found at an angle point of a fence;

THENCE; N 25° E a distance of 268.11 feet to an iron stake found at an angle point of
said fence;

THENCE; N 120 30' E a distance of 244.02 feet to an iron stake found in a fence for a
corner hereof;

THENCE; N 63° 40' E a distance of 1.90 feet to an iron stake found for the most westerly
corner of said Sattler Village Subdivision, Unit 5, and the most northerly corner
of the tract herein described;

THENCE; along the westerly line of said Subdivision, S 24° 19' E a distance of 755.7 feet
to the point of BEGINNING, as Surveyed Dec. 27th, 1972, By Woodrow Cash, Registered
Public Surveyor.

RECEIVED
MAY 15 2020
COUNTY ENGINEER

VOL 203 PAGE 519

RECEIVED
MAY 15 2020
COUNTY ENGINEER

This conveyance is subject, however, to the restrictions, covenants, easements, conditions and reservations, of record, which are a part of the consideration for the execution of this deed and which shall run with and burden the title to the property hereby conveyed and shall be binding upon Grantee, its successors and assigns.

TO HAVE AND TO HOLD the above described premises, together with all and singular the rights and appurtenances thereto in anywise belonging unto the said

FEDERNALES ELECTRIC CO-OPERATIVE, INC., its successors and assigns forever and the said Corporation does hereby bind itself, its successors and assigns, to Warrant and Forever Defend, all and singular the said premises unto the said

FEDERNALES ELECTRIC CO-OPERATIVE, INC., its successors and assigns, against every person whomsoever lawfully claiming, or to claim the same, or any part thereof.

IN WITNESS WHEREOF, the said Corporation has caused these presents to be signed by its duly authorized officers and to be sealed with the Seal of the Corporation, at New Braunfels, Texas,

this 29th day of December A. D. 19 72

TOM J. SHERIDAN PROPERTIES, INC.

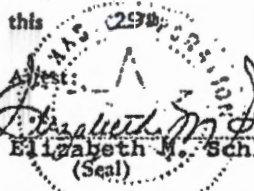
 Elizabeth M. Schlichter, Secretary.
(Seal)

By 
Tom J. Sheridan President.

CORPORATION ACKNOWLEDGMENT

THE STATE OF TEXAS,
COUNTY OF BEXAR

BEFORE ME, the undersigned, a Notary Public in and for said County and State, on this day personally appeared TOM J. SHERIDAN, known to me to be the person and officer whose name is subscribed to the foregoing instrument and acknowledged to me that the same was the act of the said TOM J. SHERIDAN PROPERTIES, INC., a corporation, and that he executed the same as the act of such corporation for the purposes and consideration therein expressed, and in the capacity therein stated.

GIVEN UNDER MY HAND AND SEAL OF OFFICE,
this the 29th day of December A. D. 19 72

Ivan J. Peyton
Notary Public in and for Bexar County, Texas

IVAN J. PEYTON
Notary Public, Bexar County, Texas

THE STATE OF TEXAS,
COUNTY OF

I HEREBY CERTIFY that the foregoing instrument of writing with its certificate of authentication, was filed for record in my office on the _____ day of _____, A. D. 19 _____ at _____ o'clock _____ M., and was duly recorded by me on the _____ day of _____, A. D. 19 _____ in Vol. _____, page _____, of the Records of said County.

WITNESS MY HAND and the Seal of the County Court of said County, at my office in the day and year last above written.

(L. S.)

County Clerk County, Texas

By _____ Deputy.

RECEIVED
MAY 15 2020
COUNTY ENGINEER

122114

187
Warranty deed
(BY CORPORATION)
FROM
TOM J. SHERIDAN PROPERTIES,
INC.,
TO
PEDERNALES ELECTRIC CO-OPERATIVE,
INC.
Box 9032, Victoria, Tx 77966
FILED FOR RECORD
This 23 day of Feb. A. D. 19 73
at 9:39 o'clock A. M.
By *Irene S. Nuhn*
IRENE S. NUHN
County Clerk
Deputy.
RECORDED
In _____ A. D. 19 _____
County Records
In Book _____ on Page _____
County Clerk.
By _____ Deputy.
Recording Fee \$ 3.50 - Paid
This instrument should be filed immediately with
the County Clerk for record.

The Odess Company, Publishers, Dallas

Filed for Record Feb. 23, A.D. 1973, at 9:39 o'clock A.M.
By Irene S. Nuhn
Deputy. IRENE S. NUHN
County Clerk, Comal County, Texas.



Honorable Bobbie Koepp, Comal County Clerk

Comal County TX
150 N. Seguin, Suite 101
New Braunfels, TX 78130
Phone: (830) 221-1230

Receipt for Services

Cashier TERRI Batch # 633428
Customer Name PEDERNALES ELECTRIC COOPERATIVE INC Date: 05/04/2020 Time: 01:54:56PM
PO BOX 2226
CANYON LAKE, TX 78133
Remarks anthony collora

Date	Instrument No	Document Type	Transaction Type	GF Number	Pg/Amt
5/4/2020 1:54:56PM	202006016328	AFFIDAVIT			1
Total:					\$26.00
Fee Total:					\$26.00
ACCOUNT	123	TR	Withdrawal	RECEIVED	26.00
Payment Total:					\$26.00

MAY 15 2020
COUNTY ENGINEER

Remaining Account Balance:

123 PEDERNALES ELECTRIC COOPERATIVE INC 270.00



COMAL COUNTY
ENGINEER'S OFFICE

OSSF DEVELOPMENT APPLICATION CHECKLIST

Staff will complete shaded items

<i>Date Received</i>	<i>Initials</i>	<i>Permit Number</i>

Instructions:

Place a check mark next to all items that apply. For items that do not apply, place "N/A". This OSSF Development Application Checklist **must** accompany the completed application.

OSSF Permit

- Completed Application for Permit for Authorization to Construct an On-Site Sewage Facility and License to Operate
- Site/Soil Evaluation Completed by a Certified Site Evaluator or a Professional Engineer
- Planning Materials of the OSSF as Required by the TCEQ Rules for OSSF Chapter 285. Planning Materials shall consist of a scaled design and all system specifications.
- Required Permit Fee - See Attached Fee Schedule
- Copy of Recorded Deed
- Surface Application/Aerobic Treatment System
 - Recorded Certification of OSSF Requiring Maintenance/Affidavit to the Public
 - Signed Maintenance Contract with Effective Date as Issuance of License to Operate

RECEIVED
MAY 15 2020
COUNTY ENGINEER

I affirm that I have provided all information required for my OSSF Development Application and that this application constitutes a completed OSSF Development Application.

Bud Collora

Signature of Applicant

May 4, 2020

Date

<input type="checkbox"/> COMPLETE APPLICATION Check No. _____ Receipt No. _____
--

<input type="checkbox"/> INCOMPLETE APPLICATION (Missing Items Circled, Application Refeused)
--

Baker Septic Service, LLC
15375 Cranes Mill Rd., Canyon Lake, TX 78133
830-899-2971

Testing and Reporting Record

This Testing and Reporting Record shall be completed, signed, and dated at time of inspection.

Inspection Due Date: 10-9-20 Installed: 6-15-20 Service expires: 6-15-22

Billing Address: SAME

Physical Address:
1530 FM 2673
CANYON LAKE TX 78133
PEC

Telephone:
 Alt. Phone:

Lot:

Permit # 110790
 County: COMAL
 SN:

Subdivision: DANIEL C HOOVER SUR. ABST. 219 SUR 322

NOTES:

TYPE OF SYSTEM: SOLAR AEROBIC DRIP SYSTEM

Inspected Item:

Operational

Inoperative

Aerators SCFM/ Compressors PSI (Record Pressure Reading)	✓	1.0
Filters	✓	
Irrigation Pumps	✓	
Disinfection Device	-	
Chlorine Supply	-	
Electrical Circuits	✓	
Distribution System	✓	
Sprayfield Vegetation	✓	
Back Flush Drip Field, if applicable	✓	
Other as Noted		

Action taken, Repairs or Needed repairs to system (list all components replaced):
CHECKED FLOATS, BACK FLUSHED SYSTEM, CLEANED DISC & COMPRESSOR FILTERS, CHECKED PSI ON COMPRESSOR, CHECKED ELEC.
SYSTEM OPERATIONAL

Access Lids are Secured

Yes

No

TESTS REQUIRED AND RESULTS:

	Required		Results Mg/1mpn/100ml or Trace	Test Method
	YES	NO		
BOD (Grab)				
TSS (Grab)	✓		1%	SLUDGE JUDGE
CI (Grab)		✓	DRIP	
Fecal Coliform				

Copies of this report have been forwarded to the following: CUSTOMER & COUNTY

Maintenance Technician: DAN NICHOLS MT 0001935

Date of Completion: 10-9-20 Start Job Time: 3:45 Stop Job Time: 4:20

Maintenance Provider: William Baker MT 0002099 

Baker Septic Service, LLC
 15375 Cranes Mill Rd., Canyon Lake, TX 78133
 830-899-2971

Testing and Reporting Record

This Testing and Reporting Record shall be completed, signed, and dated at time of inspection.

Inspection Due Date: 7.2.21 Installed: 6.15.20 Service expires: 6.15.22

Billing Address: SAME

Physical Address:
1530 FM 2673
CANYON LAKE, TX 78133
PEC

Telephone:
 Alt. Phone:

Lot:
 Permit # 110790
 County: COMAL
 SN:

Subdivision: DANIEL C. HOOVER SURV. ABST. 219 SUR 322

NOTES: REPLACED PUMP

TYPE OF SYSTEM: SOLAR AEROBIC DRIP SYSTEM

Inspected Item:

Operational Inoperative

Aerators SCFM/ Compressors PSI (Record Pressure Reading)	✓	2.0 PSI
Filters	✓	REPLACED
Irrigation Pumps	✓	
Disinfection Device	—	
Chlorine Supply	—	
Electrical Circuits	✓	
Distribution System	✓	
Sprayfield Vegetation	✓	
Back Flush Drip Field, if applicable	✓	
Other as Noted		

Action taken, Repairs or Needed repairs to system (list all components replaced):
CK FLOAT & ALARMS
CK PSI ON COMPRESSOR & CLEAN FILTER
CLEAN DISC FILTER & BACK FLUSH SYSTEM
CK ELEC

SYSTEM OPERATIONAL

Access Lids are Secured Yes No

TESTS REQUIRED AND RESULTS:

	Required		Results Mg/1mpn/100ml or Trace	Test Method
	YES	NO		
BOD (Grab)				
TSS (Grab)	✓		15%	SLUDGE
Cl (Grab)		✓	DRIP	JUDGE
Fecal Coliform				

Copies of this report have been forwarded to the following:

Maintenance Technician: MARTIN PASCARELLA MT 0002064

Date of Completion: 7.2.21 Start Job Time: 9:00 AM Stop Job Time: 11:10 AM

Maintenance Provider: William Baker MPO000099

System Pumped Truck/Pumped Tank

Baker Service and Maintenance OSSF Systems PS LLC

15375 Cranes Mill Rd., Canyon Lake, TX 78133

830-899-2971

Testing and Reporting Record

This Testing and Reporting Record shall be completed, signed, and dated at time of inspection.

Inspection Due Date: 10.11.21 Installed: 6.15.20 Service expires: 6.15.22

Billing Address: SAME

Physical Address:
1530 FM 2673
CANYON LAKE, TX 78133
PEC

Telephone:
 Alt. Phone:

Lot:

Permit # 110790
 County: COMAL
 SN:

Subdivision: DANIEL C. HOOVER SURV. ASTB. 219 SUR 322
 NOTES: PIKE PANS AROUND TANK & COMPRESSOR

TYPE OF SYSTEM: SOLAR AERIBIC DRIP SYSTEM

Inspected Item:

Operational

Inoperative

Aerators SCFM/ Compressors PSI (Record Pressure Reading)	✓	2.7 PSI
Filters	✓	
Irrigation Pumps	✓	30 PSI
Disinfection Device	—	
Chlorine Supply	—	
Electrical Circuits	✓	
Distribution System	✓	
Sprayfield Vegetation	✓	
Back Flush Drip Field, if applicable	✓	
Other as Noted	—	

Action taken, Repairs or Needed repairs to system (list all components replaced):

CK FLOATS & ALARMS
CK PSI ON COMPRESSOR & CLEAN
FILTER
CLEAN DISC FILTER & BACK FLUSH
CK ELEC

SYSTEM OPERATIONAL

Access Lids are Secured

Yes

No

TESTS REQUIRED AND RESULTS:

	Required		Results Mg/1mpn/100mi or Trace	Test Method
	YES	NO		
BOD (Grab)				<u>SLUDGE</u>
TSS (Grab)	✓		<u>5.90</u>	<u>JUDGE</u>
C1 (Grab)		✓	<u>DRIP</u>	
Fecal Coliform				

Copies of this report have been forwarded to the following: CUSTOMER & COUNTY

Maintenance Technician: MARTIN PASCARELLA MT 0002064

Date of Completion: 10.11.21 Start Job Time: 7:30 AM Stop Job Time: 8:15 AM

Maintenance Provider: William Baker MWO00000

Baker Service and Maintenance OSSF Systems PS LLC

15375 Cranes Mill Rd., Canyon Lake, TX 78133

830-899-2971

Testing and Reporting Record

This Testing and Reporting Record shall be completed, signed, and dated at time of inspection.

Inspection Due Date: 2-2-22 Installed: 6-15-20 Service expires: 6-15-22

Billing Address: SAME

Physical Address:
1530 FM 2673
CANYON LAKE TX 78133
PEC

Telephone:

Lot:

Permit # 110790

Alt. Phone:

County: COMAL

SN:

Subdivision: DANIEL C. HOOVER SURV. ASTR. 219 SVR 322

NOTES:

TYPE OF SYSTEM: SOLAR AEROBIC DRIP SYSTEM

Inspected Item:

Operational

Inoperative

Inspected Item:	<u>Operational</u>	Inoperative
Aerators SCFM/ Compressors PSI (Record Pressure Reading)	✓	1.7
Filters	✓	
Irrigation Pumps	✓	
Disinfection Device	~	
Chlorine Supply	—	
Electrical Circuits	✓	
Distribution System	✓	
Sprayfield Vegetation	✓	
Back Flush Drip Field, if applicable	✓	
Other as Noted	—	

Action taken, Repairs or Needed repairs to system (list all components replaced):
CHECKED FLOATS, BACKFLUSHED SYSTEM, CLEANED DISC & COMPRESSOR FILTERS
CHECKED PSI ON COMPRESSOR
CHECKED ELEC.

SYSTEM OPERATIONAL

Access Lids are Secured

Yes

No

TESTS REQUIRED AND RESULTS:

	Required		Results	Test Method
	YES	NO		
BOD (Grab)				
TSS (Grab)	✓		5%	SWPCR JUDGE
C1 (Grab)		✓	DRIP	
Fecal Coliform				

Copies of this report have been forwarded to the following: CUSTOMER & COUNTY

Maintenance Technician: DAN NICHOLS MT 0001435

Date of Completion: 2-2-22 Start Job Time: 1:15 Stop Job Time: 2:00

Maintenance Provider: William Baker WVET MTD 0002099

Baker Septic Service, LLC
15375 Cranes Mill Rd., Canyon Lake, TX 78133
830-899-2971

Septic System Service Agreement

In consideration of payment for this service contract, we will abide by and agree to its terms and conditions:

Name: Pebernades Electric coop
Subdivision/ County:
Permit # 1107 80 Model #
Phone:

Address: 1530 FM 2673
City, State, Zip: Canyon Lake, TX, 78133
Serial #

() Initial Two Year Service Agreement
& Two Year Limited Warranty

() One Year Service Agreement

RENEWAL

NAME TRANSFER _____

ANALYSIS _____

Legal Description:

The Effective date of this initial maintenance contract shall be the date the License to Operate is issued.

For \$500.00 this contract will be in effect FROM 6/15/22 - 6/15/23 and will provide the following:

1. An inspection/service call every (4) four months which will include: inspection, adjustments and servicing of the mechanical & electrical components as necessary to insure proper function of the system.
2. An effluent quality inspection consisting of a visual check for color, turbidity, scum, overflow and odor.
3. **THE PROPERTY OWNER IS RESPONSIBLE FOR PURCHASING AND KEEPING CHLORINE IN THE CHLORINATOR (IF APPLICABLE). IF THE CHLORINE TEST REVEALS "NO CHLORINE" IN THE SYSTEM, THE PROPERTY OWNER MAY INCURE AN ADDITIONAL COST.**
4. If any improper operation is observed (which cannot be corrected at that time) the property owner will be notified immediately of the conditions and the estimated cost.
5. The response time to a complaint by the property owner regarding operation of the system, shall be within 48 hours from the time of notification. **One service call a year, if needed, will be provided with no cost to property owner.**
6. **ANY PARTS, WARRANTY OR NON-WARRANTY, FREIGHT CHARGES, LABOR OR SERVICE CALLS DUE NOT PAID FOR REMAIN THE PROPERTY OF BAKER SEPTIC SERVICE, LLC AND COULD RESULT IN REPOSSESSION OF PARTS BY BAKER SEPTIC SERVICE, LLC.**
7. **THE SINGING OF THIS SERVICE AGREEMENT QUTHORIZES BAKER SEPTIC SERVICE, LLC TO ENTER THE PROPEY TO EXECUTE ALL TERMS OF THIS CONTRACT.**

BAKER SEPTIC SERVICE, LLC, WILL WARRANTY INSTALLAION of the septic system according to state and county regulations and the designs approved by the county. **HOMEOWNER WILL BE RESPONSIBLE FOR SERVICE CALL, LABOR, AND SHIPPING COSTS ON ANY "WARRANTED PARTS" EXCHANGED DURING WARRANTY.** All other component will be according to manufacturer's warranties.

IMPORTANT: As Baker Septic Service, LLC cannot control what or how much effluent goes into this septic system, we cannot warranty how the system will function. Refer to manufacturers or installers instructions for suggestions on septic operation. This service agreement does not cover the cost of service call, labor or materials that are required or parts out of warranty, the failure to maintain electrical power to the system, sprinklers that are broken, leaking, stopped-up or otherwise mal-functioning; or sewage flows exceeding the hydraulic/organic design capabilities and the input of non-biodegradable materials (solvent, grease, oil, paints, etc.), or any usage contrary to the requirements as advised by authorized service representative. Laboratory test work is available at an additional coast. Chlorine, filters, or parts that are out of warranty are available at a reasonable cost.

This contract does not include the pumping of a tank or of any compartment of a tank, or settlement of soil on or around any part of the system regardless of reason:

Violations of the warranty also include: Disconnecting the alarm, restricting ventilation to the aerator, over loading the system above its rated capacity; or flooding by external means. Rodent, insect or Fire Ant damage or any other form of unusual abuse is a violation.

A renewal service contract should be activated (30) thirty days before expiration of existing contract. We will contact property owner prior to expiration of existing contract.

Serviced by: Baker Septic Service, LLC

Maintenance Provider MDD 2099

(x) _____ Print Name (X)
Property Owner Signature

Date: _____

(x) [Signature] Date: 7-1-22 Authorized Service Representative

Customer by paying has agreed to terms of Contract

Baker Service and Maintenance OSSF Systems PS LLC
 15375 Cranes Mill Rd., Canyon Lake, TX 78133
 830-899-2971

Testing and Reporting Record

This Testing and Reporting Record shall be completed, signed, and dated at time of inspection.

Inspection Due Date: 6.29.22 Installed: 6.15.20 Service expires: 6.15.22

Billing Address: SAME

Physical Address:
1530 FM 2673
CANYON LAKE, TX 78133

PEC

Telephone:
 Alt. Phone:

Lot:

Permit # 110790
 County: COMAL

Subdivision: DANIEL C HOOVER SURV. ABST. 219 SVR 322 SN:

NOTES:

TYPE OF SYSTEM: SOLAR AEROBIC DRIP SYSTEM

Inspected Item:

Operational Inoperative

Aerators SCFM/ Compressors PSI (Record Pressure Reading)	✓	1.9 PSI
Filters	✓	
Irrigation Pumps	✓	REPLACED
Disinfection Device	—	
Chlorine Supply	—	
Electrical Circuits	✓	
Distribution System	✓	
Sprayfield Vegetation	✓	
Back Flush Drip Field, if applicable	✓	
Other as Noted	—	

Action taken, Repairs or Needed repairs to system (list all components replaced):
CHK FLOATS & ALARMS
CLEAN DISC FILTER
BACKFLUSH
CHK PSI ON COMPRESSOR &
CLEAN FILTER
CHK ELEC
REPLACED PUMP
(SYSTEM PUMPED - 6.30.22)
SYSTEM OPERATIONAL
FIRE ANTS AROUND COMPRESSOR

Access Lids are Secured Yes No

TESTS REQUIRED AND RESULTS:

	Required		Results Mg/1mpn/100mi or Trace	Test Method
	YES	NO		
BOD (Grab)				
TSS (Grab)	✓			SLUDGE JUDGE
C1 (Grab)		✓	DRIP	—
Fecal Coliform				

Copies of this report have been forwarded to the following: CUSTOMER & COUNTY

Maintenance Technician: MARTIN PASCARELLA MT 0002064

Date of Completion: 6.29.22 Start Job Time: 7:30 AM Stop Job Time: 9:30 PM

Maintenance Provider: William Baker MP 0002064

Baker Service and Maintenance OSSF Systems PS LLC
 15375 Cranes Mill Rd., Canyon Lake, TX 78133
 830-899-2971

Testing and Reporting Record

This Testing and Reporting Record shall be completed, signed, and dated at time of inspection.

Inspection Due Date: 9/20/22 Installed: 6/15/20 Service expires: 6/15/23

Billing Address: SAME

Physical Address:
1530 FM 2673
CANYON LAKE, TX 78133
PEC

Telephone:
 Alt. Phone:

Lot:

Permit # 110790
 County: COMAL
 SN:

Subdivision: DANIEL CHOOVER SURVEY ABST 219 SVR 322

NOTES:

TYPE OF SYSTEM: SOLAR AEROBIC DRIP SYSTEM

Inspected Item: Operational Inoperative

Aerators SCFM/ Compressors PSI (Record Pressure Reading)	✓	1.8 PSI
Filters	✓	
Irrigation Pumps	✓	29 PSI
Disinfection Device	—	
Chlorine Supply	—	
Electrical Circuits	✓	
Distribution System	✓	
Sprayfield Vegetation	✓	
Back Flush Drip Field, if applicable	✓	
Other as Noted	—	

Action taken, Repairs or Needed repairs to system (list all components replaced):
CK FLOATS & ALARMS
CLEAN DISC FILTER & PUMP SCREEN
BACKFLUSH
CK PSI ON COMPRESSOR & CLEAN FILTER
CK ELEC
SYSTEM OPERATIONAL

Access Lids are Secured Yes No

TESTS REQUIRED AND RESULTS:

	Required		Results	Test Method
	YES	NO		
BOD (Grab)				
TSS (Grab)	✓		1%	SLUDGE JUDGE
C1 (Grab)		✓	DKIP	
Fecal Coliform				

Copies of this report have been forwarded to the following: CUSTOMER & COUNTY

Maintenance Technician: MARTIN PASCARELLA MT 000 2064

Date of Completion: 9/20/22 Start Job Time: 7:00AM Stop Job Time: 8:00 AM

Maintenance Provider: William Baker MW000 2099

Baker Service and Maintenance OSSF Systems PS LLC

15375 Cranes Mill Rd., Canyon Lake, TX 78133

830-899-2971

Testing and Reporting Record

This Testing and Reporting Record shall be completed, signed, and dated at time of inspection.

Inspection Due Date: 4.4.23 Installed: 6.15.20 Service expires: 6.15.23

Billing Address: SAME

Physical Address:
1530 FM 2673
CANYON LAKE, TX, 78133
PEC

Telephone:

Lot:

Permit # 110790

Alt. Phone:

County: COMAL

SN:

Subdivision: DANIEL C. HOOVER SUR ABST 219 SUR 322

NOTES:

TYPE OF SYSTEM: SOLAR AIRE DRIP SYSTEM

Inspected Item: Operational Inoperative

Inspected Item:	<u>Operational</u>	Inoperative
Aerators SCFM/ Compressors PSI (Record Pressure Reading)	✓	2.9 PSI
Filters	✓	
Irrigation Pumps	✓	28
Disinfection Device	—	
Chlorine Supply	—	
Electrical Circuits	✓	
Distribution System	✓	
Sprayfield Vegetation	✓	
Back Flush Drip Field, if applicable	✓	
Other as Noted	—	

Action taken, Repairs or Needed repairs to system (list all components replaced):

CK FLOATS & ALARMS
CLEAN DISC FILTER & PUMP
SCREEN
BACKFLUSH
CK PSI DN COMPRESSOR &
CLEAN FILTER
CK ELEC
FIRE ANTS NEED TREATED AROUND LIDS
SYSTEM OPERATIONAL

Access Lids are Secured Yes No

TESTS REQUIRED AND RESULTS:

	Required		Results	Test
	YES	NO	Mg/1mpn/100mi or Trace	Method
BOD (Grab)				
TSS (Grab)	✓		3-5%	SLUDGE JUDGE
C1 (Grab)		✓	DRIP	
Fecal Coliform				

Copies of this report have been forwarded to the following: CUSTOMER & COUNTY

Maintenance Technician: MARTIN PASCIARELLA MT 0002064

Date of Completion: 4.4.23 Start Job Time: 7:15 AM Stop Job Time: 8:05 AM

Maintenance Provider: William Baker MD6002099

Baker Service and Maintenance OSSF Systems PS LLC
 15375 Cranes Mill Rd., Canyon Lake, TX 78133
 830-899-2971

Testing and Reporting Record

This Testing and Reporting Record shall be completed, signed, and dated at time of inspection.

Inspection Due Date: 8.17.23 Installed: 6.15.20 Service expires: 7.7.24

Billing Address: SAME

Physical Address:
1530 FM 2673
CANYON LAKE, TX 78133
PEC

Telephone:
 Alt. Phone:

Lot:

Permit # 110790
 County: COMAL
 SN:

DANIEL C. HOOVER SUR ABST 219 SUR 322

Subdivision:
 NOTES:

TYPE OF SYSTEM: SOLAR AIRE DRIP SYSTEMS

Inspected Item:

Operational Inoperative

Aerators SCFM/ Compressors PSI (Record Pressure Reading)	✓ 3.4 PSI	
Filters	✓	
Irrigation Pumps	✓ 26 PSI	
Disinfection Device	—	
Chlorine Supply	—	
Electrical Circuits	✓	
Distribution System	✓	
Sprayfield Vegetation	✓	
Back Flush Drip Field, if applicable	✓	
Other as Noted		

Action taken, Repairs or Needed repairs to system (list all components replaced):
CK FLOATS & ALARMS
CLEAN DISC FILTER &
PUMP SCREEN
BACKFLUSH
CK PSI ON COMPRESSOR &
CLEAN FILTER
CK ELEC
PRETREAT TANK NEEDS PUMPS
SYSTEM OPERATIONAL

Access Lids are Secured Yes No

TESTS REQUIRED AND RESULTS:

	Required		Results	Test Method
	YES	NO		
BOD (Grab)			PRETREAT 25 ⁰ / ₁₀	SLUDGE JUDGE
TSS (Grab)	✓			
C1 (Grab)		✓	DRIP	
Fecal Coliform				

Copies of this report have been forwarded to the following: CUSTOMER & COUNTY

Maintenance Technician: MARTIN PASCARELLA MT 00020/64
 Date of Completion: 8.17.23 Start Job Time: 7:15 AM Stop Job Time: 8:15 AM

Maintenance Provider: William Baker MP0002099

Baker Service and Maintenance OSSF Systems PS LLC
 15375 Cranes Mill Rd., Canyon Lake, TX 78133
 830-899-2971

Testing and Reporting Record

This Testing and Reporting Record shall be completed, signed, and dated at time of inspection.

Inspection Due Date: 2.7.23 Installed: 6.15.20 Service expires: 6.15.23

Billing Address: SAME

Physical Address:
1530 FM 2673
CANYON LAKE, TX 78133
PEC

Telephone:
 Alt. Phone:

Lot:

Permit # 110790
 County: COMAL
 SN:

Subdivision: DANIEL C HOOVER SUR. ABST 219 SURV 322

NOTES:

TYPE OF SYSTEM: SOLAR AIR DRIP SYSTEM

Inspected Item: Operational Inoperative

Aerators SCFM/ Compressors PSI (Record Pressure Reading)	✓	
Filters	✓	
Irrigation Pumps	✓	
Disinfection Device	—	
Chlorine Supply	—	
Electrical Circuits	✓	
Distribution System	✓	
Sprayfield Vegetation	✓	
Back Flush Drip Field, if applicable	—	
Other as Noted	—	

Action taken, Repairs or Needed repairs to system (list all components replaced):

CHECK SYSTEM
CLEAN DISC FILTER

SYSTEM OPERATIONAL

Access Lids are Secured Yes No

TESTS REQUIRED AND RESULTS:

	Required		Results Mg/1mpn/100mi or Trace	Test Method
	YES	NO		
BOD (Grab)				
TSS (Grab)		✓	0-1%	PUMPED 2.5.23
C1 (Grab)		✓	DRIP	
Fecal Coliform				

Copies of this report have been forwarded to the following: _____

Maintenance Technician: MARTIN PASCARELLA MT 0002064

Date of Completion: 2.7.23 Start Job Time: 7:00 AM Stop Job Time: 7:30 AM

Maintenance Provider: William Baker MDD002079 WB

Baker Service and Maintenance OSSF Systems PS LLC

15375 Cranes Mill Rd., Canyon Lake, TX 78133

830-899-2971

Testing and Reporting Record

This Testing and Reporting Record shall be completed, signed, and dated at time of inspection.

Inspection Due Date: 6.13.23 Installed: 6.15.20 Service expires: 6.23

Billing Address: SAME

Physical Address:
1530 FM 2673
CANYON LAKE, TX 78133
PEC

Telephone:

Lot:

Permit # 110790

Alt. Phone:

County: COMAL

Subdivision:

DANIEL C. HOOVER SRV. ABST. 219 SEC. 322

SN:

NOTES:

TYPE OF SYSTEM: SOLAR AEROBIC DRIP SYSTEM

Inspected Item: Operational Inoperative

Aerators SCFM/ Compressors PSI (Record Pressure Reading)	✓ 2.4 PSI	
Filters	✓	
Irrigation Pumps	✓ 28 PSI	
Disinfection Device	—	
Chlorine Supply	—	
Electrical Circuits	✓	
Distribution System	✓	
Sprayfield Vegetation	✓	
Back Flush Drip Field, if applicable	✓	
Other as Noted		

Action taken, Repairs or Needed repairs to system (list all components replaced):

CK FLOATS & ALARMS
CLEAN DISC FILTER & PUMP SCREEN
CK PSI ON COMPRESSOR & CLEAN FILTER
CK ELEC

SYSTEM OPERATIONAL

Access Lids are Secured Yes No

FIRE ANTS AROUND TANK LIDS

TESTS REQUIRED AND RESULTS:

	Required		Results Mg/1mpn/100mi or Trace	Test Method
	YES	NO		
BOD (Grab)				
TSS (Grab)	✓		10-15%	SLUDGE JUDGE
C1 (Grab)		✓	DRIP	
Fecal Coliform				

Copies of this report have been forwarded to the following: CUSTOMER & COUNTY

Maintenance Technician: MARTIN PASCARELLA MT 0002065

Date of Completion: 6.13.23 Start Job Time: 7:00 AM Stop Job Time: 7:50 AM

Maintenance Provider: William Baker INFO@WBSA.COM

Baker Service and Maintenance OSSF Systems PS LLC

15375 Cranes Mill Rd., Canyon Lake, TX 78133

830-899-2971

Testing and Reporting Record

This Testing and Reporting Record shall be completed, signed, and dated at time of inspection.

Inspection Due Date: 10-12-23 Installed: 6-15-20 Service expires: 7-7-24

Billing Address: SAME

Physical Address:
1530 FM 2673
CANYON LAKE, TX 78133
PEC

Telephone:

Lot:

Permit # 110790

Alt. Phone:

County: COMAL

SN:

Subdivision: DANIEL C HOOVER SUR ABST 219 SUR 322

NOTES:

TYPE OF SYSTEM: SOLAR AIRE DRIP SYSTEM

Inspected Item: Operational Inoperative

Aerators SCFM/ Compressors PSI (Record Pressure Reading)	<input checked="" type="checkbox"/> 3.3 PSI	
Filters	<input checked="" type="checkbox"/>	
Irrigation Pumps	<input checked="" type="checkbox"/> 26 PSI	
Disinfection Device	<input type="checkbox"/>	
Chlorine Supply	<input type="checkbox"/>	
Electrical Circuits	<input checked="" type="checkbox"/>	
Distribution System	<input checked="" type="checkbox"/>	
Sprayfield Vegetation	<input checked="" type="checkbox"/>	
Back Flush Drip Field, if applicable	<input checked="" type="checkbox"/>	
Other as Noted	<input type="checkbox"/>	

Action taken, Repairs or Needed repairs to system (list all components replaced):

CK FLOATS & ALARMS
CLEAN DISC FILTER &
PUMP SCREEN

BACKFLUSH
CK PSI ON COMPRESSOR &
CLEAN FILTER
CK ELEC.

SYSTEM OPERATIONAL

Access Lids are Secured Yes No

TESTS REQUIRED AND RESULTS:

	Required		Results	Test
	YES	NO	Mg/1mpn/100mi or Trace	Method
BOD (Grab)				
TSS (Grab)	<input checked="" type="checkbox"/>		<u>PRETREAT 25-30% AMP 2%</u>	<u>SLUDGE JUDGE</u>
C1 (Grab)		<input checked="" type="checkbox"/>	<u>DRIP</u>	
Fecal Coliform				

Copies of this report have been forwarded to the following: CUSTOMER & COUNTY

Maintenance Technician: MARTIN PASCARELLA

Date of Completion: 10-12-23 Start Job Time: 7:15 AM Stop Job Time: 8:15 AM

Maintenance Provider: William Baker MPOD 2097

Baker Service and Maintenance OSSF Systems PS LLC
 15375 Cranes Mill Rd., Canyon Lake, TX 78133
 830-899-2971

Testing and Reporting Record

This Testing and Reporting Record shall be completed, signed, and dated at time of inspection.

Inspection Due Date: 3.5.24 Installed: 6.15.20 Service expires: 2-18-27

Billing Address: E-MAIL

Physical Address:
1530 FM 2673
CANYON LAKE, TX 78133
PEC

Telephone:
 Alt. Phone:

Lot: Permit # 110790
 County: COMAL
 SN:

Subdivision: DANIEL C HOOVER SUR 110ST 219 SUR 322

NOTES:

TYPE OF SYSTEM: SOLAR AIR DRIP SYSTEM

Inspected Item:

Operational Inoperative

Aerators SCFM/ Compressors PSI (Record Pressure Reading)	✓ 3.0 PSI	
Filters	✓	
Irrigation Pumps	✓ 27 PSI	
Disinfection Device	—	
Chlorine Supply	—	
Electrical Circuits	✓	
Distribution System	✓	
Sprayfield Vegetation	✓	
Back Flush Drip Field, if applicable	✓	
Other as Noted		

Action taken, Repairs or Needed repairs to system (list all components replaced):

CK FLOATS & ALARMS
CLEAN DFC FILTER
BACK FLUSH
CK PSI ON COMPRESSOR &
CLEAN FILTER
CK ELEC

SYSTEM OPERATIONAL

Access Lids are Secured Yes No

TESTS REQUIRED AND RESULTS:

	Required		Results Mg/1mpn/100mi or Trace	Test Method
	YES	NO		
BOD (Grab)	✓		1-2 %	<u>SLUDGE</u> <u>SLUDGE</u>
TSS (Grab)		✓	DRIP	
C1 (Grab)				
Fecal Coliform				

Copies of this report have been forwarded to the following: CUSTOMER & COUNTY

Maintenance Technician: MARTIN PASCARELLA MT 0002064

Date of Completion: 3.5.24 Start Job Time: 7:10 AM Stop Job Time: 8:00 AM

Maintenance Provider: William Baker MPO002099

Baker Service and Maintenance OSSF Systems PS LLC
 15375 Cranes Mill Rd., Canyon Lake, TX 78133
 830-899-2971

Testing and Reporting Record

This Testing and Reporting Record shall be completed, signed, and dated at time of inspection.

Inspection Due Date: 4.26.24 Installed: 6.15.20 Service expires: 2.27

Billing Address: E-MAIL

Physical Address:
1530 FM 2673
CANYON LAKE, TX 78133
PEC

Telephone:
 Alt. Phone:

Lot:

Permit # 110790
 County: COMAL
 SN:

Subdivision: DANIEL C HOOVER SUR ABST 219 SUR 322

NOTES:

TYPE OF SYSTEM: ~~PE~~ SOLAR AIR DRIP SYSTEM

Inspected Item: Operational Inoperative

Aerators SCFM/ Compressors PSI (Record Pressure Reading)	<input checked="" type="checkbox"/>	<u>3.0 PSI</u>
Filters	<input checked="" type="checkbox"/>	
Irrigation Pumps	<input checked="" type="checkbox"/>	
Disinfection Device	<input type="checkbox"/>	<u>-</u>
Chlorine Supply	<input type="checkbox"/>	<u>-</u>
Electrical Circuits	<input checked="" type="checkbox"/>	
Distribution System	<input checked="" type="checkbox"/>	
Sprayfield Vegetation	<input checked="" type="checkbox"/>	
Back Flush Drip Field, if applicable	<input checked="" type="checkbox"/>	
Other as Noted	<input checked="" type="checkbox"/>	

Action taken, Repairs or Needed repairs to system (list all components replaced):

CK FLOATS & ALARMS
CLEAN DISC FILTER
BACKFLUSH
CK PSI ON COMPRESSOR &
CLEAN FILTER
CK ELEC

SYSTEM OPERATIONAL

Access Lids are Secured Yes No

TESTS REQUIRED AND RESULTS:

	Required		Results	Test Method
	YES	NO		
BOD (Grab)			<u>TRASH TANK 10% AER-1-2</u>	<u>SLUDGE</u>
TSS (Grab)	<input checked="" type="checkbox"/>		<u>CLARIFIER 10% PUMP 1-2</u>	<u>JUDGE</u>
C1 (Grab)		<input checked="" type="checkbox"/>	<u>DRIP</u>	
Fecal Coliform				

Copies of this report have been forwarded to the following: CUSTOMER & County

Maintenance Technician: MARTIN PASCARELLA MT 0002064
 Date of Completion: 4.26.24 Start Job Time: 7:15 AM Stop Job Time: 8:00 AM
 Maintenance Provider: William Baker MPO 2099

Baker Service and Maintenance OSSF Systems PS LLC
 15375 Cranes Mill Rd., Canyon Lake, TX 78133
 830-899-2971

Testing and Reporting Record

This Testing and Reporting Record shall be completed, signed, and dated at time of inspection.

Inspection Due Date: 6.17.24 Installed: ~~3.7.07~~ 6.15.20 Service expires: 2.27

Billing Address: E-MAIL Physical Address: 1530 FM 2673
CANYON LAKE, TX 78133
PEC

Telephone: _____ Lot: _____ Permit # 110790
 Alt. Phone: _____ County: COMAL
 SN: _____

Subdivision: DANIEL CHOOVER SUR ABST 219 SUR 322

NOTES:

TYPE OF SYSTEM: SOLAR AIRE DRIP SYSTEM

Inspected Item: Operational Inoperative

Aerators SCFM/ Compressors PSI (Record Pressure Reading)	✓ 3.2 PSI	
Filters	✓	
Irrigation Pumps	✓	
Disinfection Device	—	
Chlorine Supply	—	
Electrical Circuits	✓	
Distribution System	✓	
Sprayfield Vegetation	✓	
Back Flush Drip Field, if applicable	✓	
Other as Noted	—	

Action taken, Repairs or Needed repairs to system (list all components replaced):
CK FLOATS & ALARMS
CLEAN DISC FILTER
BACK FLUSH
CK PSI ON COMPRESSOR &
CLEAN FILTER
CK ELEC

SYSTEM OPERATIONAL

Access Lids are Secured Yes No

TESTS REQUIRED AND RESULTS:

	Required		Results	Test
	YES	NO	Mg/1mpn/100mi or Trace	Method
BOD (Grab)			TRASH 10+%	AEROBIC 1-2%
TSS (Grab)	✓		CLARIFIER 10+%	PUMP 1-2% SLUDGE JUDGE
C1 (Grab)		✓		
Fecal Coliform				

Copies of this report have been forwarded to the following: CUSTOMER & COUNTY

Maintenance Technician: MARTIN PASCARELLA MT 0002664
 Date of Completion: 6.17.24 Start Job Time: 7:30AM Stop Job Time: 8:15AM

Maintenance Provider: William Baker MDD002099

customer has paid in full and understands the agreement to the contract

Baker Septic Service, LLC
15375 Cranes Mill Rd., Canyon Lake, TX 78133
830-899-2971

Septic System Service Agreement

In consideration of payment for this service contract, we will abide by and agree to its terms and conditions:

Name: Pedernales Electric Coop Inc.
Subdivision/ County: comal
Permit # 110790 Model #
Phone:

Address: 1530 Fm 2673
City, State, Zip: Canyon Lake, TX, 78133
Serial #

() Initial Two Year Service Agreement
& Two Year Limited Warranty

() One Year Service Agreement

RENEWAL _____ NAME TRANSFER _____ ANALYSIS _____

Legal Description:

The Effective date of this initial maintenance contract shall be the date the License to Operate is issued.

For \$ 3,000 this contract will be in effect FROM 3/1/24 - 3/1/27 and will provide the following:

1. An inspection/service call every 2 months which will include: inspection, adjustments and servicing of the mechanical & electrical components as necessary to insure proper function of the system.
2. An effluent quality inspection consisting of a visual check for color, turbidity, scum, overflow an odor.
3. **THE PROPERTY OWNER IS RESPONSIBLE FOR PURCHASING AND KEEPING CHLORINE IN THE CHLORINATOR (IF APPLICABLE). IF THE CHLORINE TEST REVEALS "NO CHLORINE" IN THE SYSTEM, THE PROPERTY OWNER MAY INCURE AN ADDITIONAL COST.**
4. If any improper operation is observed (which cannot be corrected at that time) the property owner will be notified immediately of the conditions and the estimated cost.
5. The response time to a complaint by the property owner regarding operation of the system, shall be within 48 hours from the time of notification. **One service call a year, if needed, will be provided with no cost to property owner.**
6. **ANY PARTS, WARRANTY OR NON-WARRANTY, FREIGHT CHARGES, LABOR OR SERVICE CALLS DUE NOT PAID FOR REMAIN THE PROPERTY OF BAKER SEPTIC SERVICE, LLC AND COULD RESULT IN REPOSSESSION OF PARTS BY BAKER SEPTIC SERVICE, LLC.**
7. **THE SINGING OF THIS SERVICE AGREEMENT QUTHORIZES BAKER SEPTIC SERVICE, LLC TO ENTER THE PROPERTY TO EXECUTE ALL TERMS OF THIS CONTRACT.**

BAKER SEPTIC SERVICE, LLC, WILL WARRANTY INSTALLAION of the septic system according to state and county regulations and the designs approved by the county. **HOMEOWNER WILL BE RESPONSIBE FOR SERVICE CALL, LABOR, AND SHIPPING COSTS ON ANY "WARRANTED PARTS" EXCHANGED DURING WARRANTY.** All other component will be according to manufacturer's warranties.

IMPORTANT: As Baker Septic Service, LLC cannot control what or how much effluent goes into this septic system, we cannot warranty how the system will function. Refer to manufacturers or installers instructions for suggestions on septic operation. This service agreement does not cover the cost of **service call, labor or materials** that are required or **parts out of warranty**, the failure to maintain electrical power to the system, **sprinklers that are broken**, leaking, stopped-up or otherwise mal-functioning; or sewage flows exceeding the hydraulic/organic design capabilities and the input of non-biodegradable materials (solvent, grease, oil, paints, etc.), or any usage contrary to the requirements as advised by authorized service representative. Laboratory test work is available at an additional coast. Chlorine, filters, or parts that are out of warranty are available at a reasonable cost.

This contract does not include the pumping of a tank or of any compartment of a tank, or settlement of soil on or around any part of the system regardless of reason:

Violations of the warranty also include: Disconnecting the alarm, restricting ventilation to the aerator, over loading the system above its rated capacity; or flooding by external means. Rodent, insect or Fire Ant damage or any other form of unusual abuse is a violation.

A renewal service contract should be activated (30) thirty days before expiration of existing contract. We will contact property owner prior to expiration of existing contract.

Serviced by: Baker Septic Service, LLC
Maintenance Provider MA0012099

(x) _____
Property Owner Signature

Print Name (X)

Date: _____

(x) William B...

Date: 7-7-23

Authorized Service Representative

Baker Service and Maintenance OSSF Systems PS LLC
 15375 Cranes Mill Rd., Canyon Lake, TX 78133
 830-899-2971

Testing and Reporting Record

This Testing and Reporting Record shall be completed, signed, and dated at time of inspection.

Inspection Due Date: 10-11-24 Installed: 6-15-20 Service expires: 2-27

Billing Address: E-MAIL

Physical Address:
1530 FM 2673
CANYON LAKE, TX 78133
PEC

Telephone:
 Alt. Phone:

Lot:

Permit # 110790
 County: COMAL
 SN:

Subdivision: DANIEL C HOOVER SUR ABT 219 SUR 322

NOTES:

TYPE OF SYSTEM: SOLAR AGRIC DRIP

Inspected Item: Operational Inoperative

Aerators SCFM/ Compressors PSI (Record Pressure Reading)	✓ 2.8 PSI	
Filters	✓	
Irrigation Pumps	✓ 30 PSI	
Disinfection Device	—	
Chlorine Supply	—	
Electrical Circuits	✓	
Distribution System	✓	
Sprayfield Vegetation	✓	
Back Flush Drip Field, if applicable	✓	
Other as Noted		

Action taken, Repairs or Needed repairs to system (list all components replaced):

CK FLOAT & ALARMS
CLEAN DISC FILTER
BACKFLUSH
CK PSI ON COMPRESSOR, &
CLEAN FILTER
CK ELEC

SYSTEM OPERATIONAL

Access Lids are Secured Yes No

TESTS REQUIRED AND RESULTS:

	Required		Results	Test
	YES	NO	Mg/1mpn/100mi or Trace	Method
BOD (Grab)			TRASH 15% ACR 1-2%	SLUDGE
TSS (Grab)	✓		CLAR 15% PUMP 1-2%	JUDGE
C1 (Grab)		✓	DRIP	
Fecal Coliform				

Copies of this report have been forwarded to the following: CUSTOMER & COUNTY

Maintenance Technician: MARTIN PASCARELLA MT 0002064

Date of Completion: 10-11-24 Start Job Time: 7:30 AM Stop Job Time: 8:45 AM

Maintenance Provider: William Baker M00002099

Baker Service and Maintenance OSSF Systems PS LLC
 15375 Cranes Mill Rd., Canyon Lake, TX 78133
 830-899-2971

Testing and Reporting Record

This Testing and Reporting Record shall be completed, signed, and dated at time of inspection.

Inspection Due Date: 8-15-24 Installed: 6-15-20 Service expires: 2-27

Billing Address: E-MAIL

Physical Address:
1530 FM 2673
CANYON LAKE, TX 78133
PEC

Telephone:
 Alt. Phone:

Lot:

Permit # 110790
 County: COMAL
 SN:

Subdivision: DAVID C HEYNER SUR 1357 219 SUR 322

NOTES:

TYPE OF SYSTEM: SOLAR AIR DRIP SYSTEM

Inspected Item: Operational Inoperative

Aerators SCFM/ Compressors PSI (Record Pressure Reading)	<input checked="" type="checkbox"/>	<u>2.8 PSI</u>
Filters	<input checked="" type="checkbox"/>	
Irrigation Pumps	<input checked="" type="checkbox"/>	<u>30 PSI</u>
Disinfection Device	<input type="checkbox"/>	
Chlorine Supply	<input type="checkbox"/>	
Electrical Circuits	<input checked="" type="checkbox"/>	
Distribution System	<input checked="" type="checkbox"/>	
Sprayfield Vegetation	<input checked="" type="checkbox"/>	
Back Flush Drip Field, if applicable	<input checked="" type="checkbox"/>	
Other as Noted	<input type="checkbox"/>	

Action taken, Repairs or Needed repairs to system (list all components replaced):

CK FLOATS & ALARMS
CLEAN DISC FILTER
BACKFLUSH
CK PSI ON COMPRESSOR &
CLEAN FILTER
CK ELEC
SYSTEM OPERATIONAL

Access Lids are Secured (Yes) No

TESTS REQUIRED AND RESULTS:

	Required		Results	Test
	YES	NO	Mg/1mpn/100mi or Trace	Method
BOD (Grab)			<u>TRASH - 10% AER 1-2%</u>	
TSS (Grab)	<input checked="" type="checkbox"/>		<u>CLARIF - 15% PUMP 2%</u>	<u>SLUDGE</u> <u>JUDGE</u>
C1 (Grab)		<input checked="" type="checkbox"/>	<u>DRIP</u>	
Fecal Coliform				

Copies of this report have been forwarded to the following: CUSTOMER & COUNTY

Maintenance Technician: MARTIN PASCARELLA MT 0002064

Date of Completion: 8-15-24 Start Job Time: 7:30 AM Stop Job Time: 8:15 AM

Maintenance Provider: William Baker MW0002099

Baker Service and Maintenance OSSF Systems PS LLC
 15375 Cranes Mill Rd., Canyon Lake, TX 78133
 830-899-2971

Testing and Reporting Record

This Testing and Reporting Record shall be completed, signed, and dated at time of inspection.

Inspection Due Date: 12.16.24 Installed: 6.15.20 Service expires: 2.27

Billing Address: E-MAIL

Physical Address:
1530 FM 2673
CANYON LAKE, TX 78133
PEC

Telephone:
 Alt. Phone:

Lot:
 Permit # 110790
 County: COMAL
 SN:

Subdivision: DANIEL C HOOVER SUR 219 ARST SUR 322

NOTES:

TYPE OF SYSTEM: SOLAR AIRE DRIP

Inspected Item: Operational Inoperative

Aerators SCFM/ Compressors PSI (Record Pressure Reading)	<u>✓ 2.0 PSI</u>	
Filters	<u>✓</u>	
Irrigation Pumps	<u>✓ 30 PSI</u>	
Disinfection Device	<u>—</u>	
Chlorine Supply	<u>—</u>	
Electrical Circuits	<u>✓</u>	
Distribution System	<u>✓</u>	
Sprayfield Vegetation	<u>✓</u>	
Back Flush Drip Field, if applicable	<u>✓</u>	
Other as Noted		

Action taken, Repairs or Needed repairs to system (list all components replaced):
CK FLOATS & ALARMS
CLEAN DISC FILTER
BACKFLUSH IT
CK PSI ON COMPRESSOR
CLEAN FILTER
CK ELEC
SYSTEM OPERATIONAL

Access Lids are Secured Yes No

TESTS REQUIRED AND RESULTS:

	Required		Results	Test Method
	YES	NO	Mg/1mpn/100mi or Trace	
BOD (Grab)			<u>PRE TREAT 15-20% AER-238</u>	<u>SLUDGE</u>
TSS (Grab)	<u>✓</u>		<u>CLAR 15-20% PUMP 2-3%</u>	<u>JUDGE</u>
C1 (Grab)		<u>✓</u>	<u>DRIP</u>	
Fecal Coliform				

Copies of this report have been forwarded to the following: CUSTOMER & COUNTY

Maintenance Technician: MARTIN PASCARELLA MT 0002064

Date of Completion: 12.16.24 Start Job Time: 7:30AM Stop Job Time: 8:30AM

Maintenance Provider: William Butler