



COMAL COUNTY

ENGINEER'S OFFICE

License to Operate On-Site Sewage Treatment and Disposal Facility

Issued This Date: 12/02/2021 Permit Number: 111924

Location Description: 456 THUNDERHEAD DR
SPRING BRANCH, TX 78070

Subdivision: Comal Hills
Unit: 1
Lot: 264
Block: 4
Acreage:

Type of System: Aerobic
Drip Irrigation

Issued to: CR Phoenix Enterprises, LLC

This license is authorization for the owner to operate and maintain a private facility at the location described in accordance to the rules and regulations for on-site sewerage facilities of Comal County, Texas, and the Texas Commission on Environmental Quality.

The license grants permission to operate the facility. It does not guarantee successful operation. It is the responsibility of the owner to maintain and operate the facility in a satisfactory manner.

Alterations to this permit including, but not limited to:

- Increase in the square feet of living area
- Increase in the number of bedrooms
- A change of use (i.e. residential to commercial)
- Relocation of system components (including the relocation of spray heads)
- Installation of landscaping
- Adding new structures to the system

may require a new permit. **It is the responsibility of the owner to apply for a new permit, if applicable.**

Inspection and licensing of a facility indicates only that the facility meets certain minimum requirements. It does not impede any governmental entity in taking the proper steps to prevent or control pollution, to abate nuisance, or to protect the public health.

This license to operate is valid for an indefinite period. The holder may transfer it to a succeeding owner, provided the

Licensing Authority
Comal County Environmental Health

ENVIRONMENTAL HEALTH INSPECTOR

OS0032485

ENVIRONMENTAL HEALTH COORDINATOR

OS0035625i

Comal County Environmental Health OSSF Inspection Sheet

Installer Name: _____

OSSF Installer #: _____

1st Inspection Date: _____

2nd Inspection Date: _____

3rd Inspection Date: _____

Inspector Name: _____

Inspector Name: _____

Inspector Name: _____

Permit#: _____

Address: _____

No.	Description	Answer	Citations	Notes	1st Insp.	2nd Insp.	3rd Insp.
1	SITE AND SOIL CONDITIONS & SETBACK DISTANCES Site and Soil Conditions Consistent with Submitted Planning Materials		285.31(a) 285.30(b)(1)(A)(iv) 285.30(b)(1)(A)(v) 285.30(b)(1)(A)(iii) 285.30(b)(1)(A)(ii) 285.30(b)(1)(A)(i)				
2	SITE AND SOIL CONDITIONS & SETBACK DISTANCES Setback Distances Meet Minimum Standards		285.91(10) 285.30(b)(4) 285.31(d)				
3	SEWER PIPE Proper Type Pipe from Structure to Disposal System (Cast Iron, Ductile Iron, Sch. 40, SDR 26)		285.32(a)(1)				
4	SEWER PIPE Slope from the Sewer to the Tank at least 1/8 Inch Per Foot		285.32(a)(3)				
5	SEWER PIPE Two Way Sanitary - Type Cleanout Properly Installed (Add. C/O Every 100' &/or 90 degree bends)		285.32(a)(5)				
6	PRETREATMENT Installed (if required) TCEQ Approved List PRETREATMENT Septic Tank(s) Meet Minimum Requirements		285.32(b)(1)(G) 285.32(b)(1)(E)(iii) 285.32(b)(1)(E)(iv) 285.32(b)(1)(F) 285.32(b)(1)(B) 285.32(b)(1)(C)(i) 285.32(b)(1)(C)(ii) 285.32(b)(1)(D) 285.32(b)(1)(E) 285.32(b)(1)(A) 285.32(b)(1)(E)(ii)(II) 285.32(b)(1)(E)(i) 285.32(b)(1)(E)(ii)(I)				
7	PRETREATMENT Grease Interceptors if required for commercial		285.34(d)				

Inspector Notes:

**Comal County Environmental Health
OSSF Inspection Sheet**

No.	Description	Answer	Citations	Notes	1st Insp.	2nd Insp.	3rd Insp.
8	SEPTIC TANK Tank(s) Clearly Marked SEPTIC TANK If Single Tank, 2 Compartments Provided with Baffle SEPTIC TANK Inlet Flowline Greater than 3" and " T " Provided on Inlet and Outlet SEPTIC TANK Septic Tank(s) Meet Minimum Requirements		285.32(b)(1) (E)285.91(2)285.32(b)(1) (F)285.32(b)(1)(E) (iii)285.32(b)(1)(E)(ii) (II)285.32(b)(1)(E)(ii) (I)285.32(b)(1)(E) (i)285.32(b)(1) (D)285.32(b)(1)(C) (ii)285.32(b)(1)(C) (i)285.32(b)(1) (B)285.32(b)(1) (A)285.32(b)(1)(E)(iv)				
9	ALL TANKS Installed on 4" Sand Cushion/ Proper Backfill Used		285.32(b)(1)(F) 285.32(b)(1)(G) 285.34(b)				
10	SEPTIC TANK Inspection / Clean Out Port & Risers Provided on Tanks Buried Greater than 12" Sealed and Capped		285.38(d)				
11	SEPTIC TANK Secondary restraint system provided SEPTIC TANK Riser permanently fastened to lid or cast into tank SEPTIC TANK Riser cap protected against unauthorized intrusions		285.38(d) 285.38(e)				
12	SEPTIC TANK Tank Volume Installed						
13	PUMP TANK Volume Installed						
14	AEROBIC TREATMENT UNIT Size Installed						
15	AEROBIC TREATMENT UNIT Manufacturer AEROBIC TREATMENT UNIT Model Number						
16	DISPOSAL SYSTEM Absorptive		285.33(a)(4) 285.33(a)(1) 285.33(a)(2) 285.33(a)(3)				
17	DISPOSAL SYSTEM Leaching Chamber		285.33(a)(1) 285.33(a)(3) 285.33(a)(4) 285.33(a)(2)				
18	DISPOSAL SYSTEM Evapo-transpirative		285.33(a)(3) 285.33(a)(4) 285.33(a)(1) 285.33(a)(2)				

**Comal County Environmental Health
OSSF Inspection Sheet**

No.	Description	Answer	Citations	Notes	1st Insp.	2nd Insp.	3rd Insp.
19	DISPOSAL SYSTEM Drip Irrigation		285.33(c)(3)(A)-(F)				
20	DISPOSAL SYSTEM Soil Substitution		285.33(d)(4)				
21	DISPOSAL SYSTEM Pumped Effluent		285.33(a)(4) 285.33(a)(3) 285.33(a)(1) 285.33(a)(2)				
22	DISPOSAL SYSTEM Gravelless Pipe		285.33(a)(3) 285.33(a)(2) 285.33(a)(4) 285.33(a)(1)				
23	DISPOSAL SYSTEM Mound		285.33(a)(3) 285.33(a)(1) 285.33(a)(2) 285.33(a)(4)				
24	DISPOSAL SYSTEM Other (describe) (Approved Design)		285.33(d)(6) 285.33(c)(4)				
25	DRAINFIELD Absorptive Drainline 3" PVC or 4" PVC						
26	DRAINFIELD Area Installed						
27	DRAINFIELD Level to within 1 inch per 25 feet and within 3 inches over entire excavation		285.33(b)(1)(A)(v)				
28	DRAINFIELD Excavation Width DRAINFIELD Excavation Depth DRAINFIELD Excavation Separation DRAINFIELD Depth of Porous Media DRAINFIELD Type of Porous Media						
29	DRAINFIELD Pipe and Gravel - Geotextile Fabric in Place		285.33(b)(1)(E)				
30	DRAINFIELD Leaching Chambers DRAINFIELD Chambers - Open End Plates w/Splash Plate, Inspection Port & Closed End Plates in Place (per manufacturers spec.)		285.33(c)(2)				
31	LOW PRESSURE DISPOSAL SYSTEM Adequate Trench Length & Width, and Adequate Separation Distance between Trenches		285.33(d)(1)(C)(i)				

**Comal County Environmental Health
OSSF Inspection Sheet**

No.	Description	Answer	Citations	Notes	1st Insp.	2nd Insp.	3rd Insp.
32	EFFLUENT DISPOSAL SYSTEM Utilized Only by Single Family Dwelling EFFLUENT DISPOSAL SYSTEM Topographic Slopes < 2.0% EFFLUENT DISPOSAL SYSTEM Adequate Length of Drain Field (1000 Linear ft. for 2 bedrooms or Less & an additional 400 ft. for each additional bedroom) EFFLUENT DISPOSAL SYSTEM Lateral Depth of 18 inches to 3 ft. & Vertical Separation of 1ft on bottom and 2 ft. to restrictive horizon and ground water respectfully EFFLUENT DISPOSAL SYSTEM Lateral Drain Pipe (1.25 - 1.5" dia.) & Pipe Holes (3/16 - 1/4" dia. Hole Size) 5 ft. Apart		285.33(b)(3)(A) 285.33(b)(3)(A) 285.33(b)(3) (B)285.91(13) 285.33(b)(3)(D) 285.33(b)(3)(F)				
33	AEROBIC TREATMENT UNIT Is Aerobic Unit Installed According to Approved Guidelines.		285.32(c)(1)				
34	AEROBIC TREATMENT UNIT Inspection/Clean Out Port & Risers Provided AEROBIC TREATMENT UNIT Secondary restraint system provided AEROBIC TREATMENT UNIT Riser permanently fastened to lid or cast into tank AEROBIC TREATMENT UNIT Riser cap protected against unauthorized intrusions						
35	AEROBIC TREATMENT UNIT Chlorinator Properly Installed with Chlorine Tablets in Place.						
36	PUMP TANK Is the Pump Tank an approved concrete tank or other acceptable materials & construction PUMP TANK Sampling Port Provided in the Treated Effluent Line PUMP TANK Check Valve and/or Anti- Siphon Device Present When Required PUMP TANK Audible and Visual High Water Alarm Installed on Separate Circuit From Pump						
37	PUMP TANK Inspection/Clean Out Port & Risers Provided PUMP TANK Secondary restraint system provided PUMP TANK Riser permanently fastened to lid or cast into tank PUMP TANK Riser cap protected against unauthorized intrusions						
38	PUMP TANK Secondary restraint system provided						
39	PUMP TANK Electrical Connections in Approved Junction Boxes / Wiring Buried						

**Comal County Environmental Health
OSSF Inspection Sheet**

No.	Description	Answer	Citations	Notes	1st Insp.	2nd Insp.	3rd Insp.
40	APPLICATION AREA Distribution Pipe, Fitting, Sprinkler Heads & Valve Covers Color Coded Purple?		285.33(d)(2)(G)(iii)(II) 285.33(d)(2)(G)(iii)(III) 285.33(d)(2)(G)(v) 285.33(d)(2)(G)(iii) 285.33(d)(2)(G)(iv) 285.33(d)(2)(G)(i) 285.33(d)(2)(G)(ii) 285.33(d)(2)(G)(iii)(I)				
41	APPLICATION AREA Low Angle Nozzles Used / Pressure is as required APPLICATION AREA Acceptable Area, nothing within 10 ft of sprinkler heads? APPLICATION AREA The Landscape Plan is as Designed		285.33(d)(2)(G) (i)285.33(d)(2) (A)285.33(d)(2)(F)				
42	APPLICATION AREA Area Installed						
43	PUMP TANK Meets Minimum Reserve Capacity Requirements						
44	PUMP TANK Material Type & Manufacturer						
45	PUMP TANK Type/Size of Pump Installed						



COMAL COUNTY

ENGINEER'S OFFICE

Permit of Authorization to Construct an On-Site Sewage Facility Permit Valid For One Year From Date Issued

Permit Number: 111924
Issued This Date: 01/22/2021
This permit is hereby given to: CR Phoenix Enterprises, LLC

To start construction of a private, on-site sewage facility located at:

456 THUNDERHEAD DR
SPRING BRANCH, TX 78070

Subdivision: Comal Hills
Unit: 1
Lot: 264
Block: 4
Acreage:

APPROVED MINIMUM SIZES AS PER ATTACHED DESIGN

Type of System: Aerobic
Drip Irrigation

This permit gives permission for the construction of the above referenced on-site facility to commence. Installation must be completed by an installer holding a valid registration card from the Texas Commission on Environmental Quality (TCEQ). Installation and inspection must comply with current TCEQ and Comal County requirements.

Call (830) 608-2090 to schedule inspections.

APPLICATION FOR PERMIT FOR AUTHORIZATION TO CONSTRUCT AN ON-SITE SEWAGE FACILITY AND LICENSE TO OPERATE

Date January 11, 2021 Permit # 111924
CR PHOENIX ENTERPRISES, LLC dba
Owner Name HAVENBROOK HOMES Agent Name GREG W. JOHNSON, P.E.
Mailing Address 17310 FM 306 BOX 1 Agent Address 170 HOLLOW OAK
City, State, Zip CANYON LAKE TEXAS 78133 City, State, Zip NEW BRAUNFELS, TX 78132
Phone# 830-935-2098 Phone # (830) 905-2778
Email lars@havenbrooktx.com Email gregjohnsonpe@yahoo.com

All correspondence should be sent to: [] Owner [X] Agent [] Both Method: [] Mail [X] Email

Subdivision Name COMAL HILLS Unit/Phase/Section 1 Lot 264 Block 4
Acreage/Legal
Street Name/Address 456 THUNDERHEAD DRIVE City SPRING BRANCH Zip 78070

Type of Development:

[X] Single Family Residential
Type of Construction (House, Mobile, RV, Etc.) HOUSE
Number of Bedrooms 3
Indicate Sq Ft of Living Area 1289

RECEIVED
JAN 20 2021
COUNTY ENGINEER

[] Non-Single Family Residential
(Planning materials must show adequate land area for doubling the required land needed for treatment units and disposal area)
Type of Facility
Offices, Factories, Churches, Schools, Parks, Etc. - Indicate Number Of Occupants
Restaurants, Lounges, Theaters - Indicate Number of Seats
Hotel, Motel, Hospital, Nursing Home - Indicate Number of Beds
Travel Trailer/RV Parks - Indicate Number of Spaces
Miscellaneous

Estimated Cost of Construction: \$ 250,000 (Structure Only)

Is any portion of the proposed OSSF located in the United States Army Corps of Engineers (USACE) flowage easement?

[] Yes [X] No (if yes, owner must provide approval from USACE for proposed OSSF improvements within the USACE flowage easement)

Source of Water [X] Public [] Private Well [] Rainwater Collection
Are Water Saving Devices Being Utilized Within the Residence? [X] Yes [] No

By signing this application, I certify that:
- The completed application and all additional information submitted does not contain any false information and does not conceal any material facts.
- I certify that I am the property owner or I possess the appropriate land rights necessary to make the permitted improvements on said property.
- Authorization is hereby given to the permitting authority and designated agents to enter upon the above described property for the purpose of site/soil evaluation and inspection of private sewage facilities.
- I also understand that a permit of authorization to construct will not be issued until the Floodplain Administrator has performed the reviews required by the Comal County Flood Damage Prevention Order.
- I affirmatively consent to the online posting/public release of my e-mail address associated with this permit application, as applicable.

Signature of Owner

Date 1/18/2021

*** COMAL COUNTY OFFICE OF ENVIRONMENTAL HEALTH ***

APPLICATION FOR PERMIT FOR AUTHORIZATION TO CONSTRUCT AN ON-SITE SEWAGE FACILITY AND LICENSE TO OPERATE

Planning Materials & Site Evaluation as Required Completed By GREG W. JOHNSON, P.E.

System Description PROPRIETARY; AEROBIC TREATMENT AND DRIP TUBING

Size of Septic System Required Based on Planning Materials & Soil Evaluation

Tank Size(s) (Gallons) NUWATER B-550-PC Absorption/Application Area (Sq Ft) 2000

Gallons Per Day (As Per TCEQ Table III) 240

(Sites generating more than 5000 gallons per day are required to obtain a permit through TCEQ)

Is the property located over the Edwards Recharge Zone? [] Yes [X] No

(If yes, the planning materials must be completed by a Registered Sanitarian (R.S.) or Professional Engineer (P.E.))

RECEIVED

JAN 20 2021

Is there an existing TCEQ approved WPAP for the property? [] Yes [X] No

(if yes, the R. S. or P. E. shall certify that the OSSF design complies with all provisions of the existing WPAP.)

COUNTY ENGINEER

If there is no existing WPAP, does the proposed development activity require a TCEQ approved WPAP? [] Yes [] No

(If yes, the R.S. or P. E. shall certify that the OSSF design will comply with all provisions of the proposed WPAP. A Permit to Construct will not be issued for the proposed OSSF until the proposed WPAP has been approved by the appropriate regional office.)

Is the property located over the Edwards Contributing Zone? [X] Yes [] No

Is there an existing TCEQ approval CZP for the property? [] Yes [X] No

(if yes, the P.E. or R.S. shall certify that the OSSF design complies with all provisions of the existing CZP)

If there is no existing CZP, does the proposed development activity require a TCEQ approved CZP? [] Yes [X] No

(if yes, the P.E. or R.S. shall certify that the OSSF design will comply with all provisions of the proposed CZP. A Permit to construct will not be issued for the proposed OSSF until the CZP has been approved by the appropriate regional office.)

Is this property within an incorporated city? [] Yes [X] No

If yes, indicate the city: _____

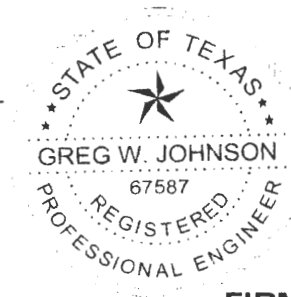

FIRM #2585

By signing this application, I certify that:

- The information provided above is true and correct to the best of my knowledge.
- I affirmatively consent to the online posting/public release of my e-mail address associated with this permit application, as applicable

Signature of Designer (Handwritten Signature)

Date January 19, 2021

1/c



202106003329 01/19/2021 01:27:55 PM 1/1

AFFIDAVIT

**THE COUNTY OF COMAL
STATE OF TEXAS**

CERTIFICATION OF OSSF REQUIRING MAINTENANCE

According to Texas Commission on Environmental Quality Rules for On-Site Sewage Facilities (OSSF's), this document is filed in the Deed Records of Comal County, Texas.

I

The Texas Health and Safety Code, Chapter 366 authorizes the Texas Commission on Environmental Quality (TCEQ) to regulate on-site sewage facilities (OSSFs). Additionally, the Texas Water Code (TWC), § 5.012 and § 5.013, gives the commission primary responsibility for implementing the laws of the State of Texas relating to water and adopting rules necessary to carry out its powers and duties under the TWC. The commission, under the authority of the TWC and the Texas Health and Safety code, requires owner's to provide notice to the public that certain types of OSSFs are located on specific pieces of property. To achieve this notice, the commission requires a recorded affidavit. Additionally, the owner must provide proof of the recording to the OSSF permitting authority. This recorded affidavit is not a representation or warranty by the commission of the suitability of this OSSF, nor does it constitute any guarantee by the commission that the appropriate OSSF was installed.

RECEIVED

JAN 20 2021

II

An OSSF requiring a maintenance contract, according to 30 Texas Administrative Code §285.91(12) will be installed on the property described as (insert legal description):

COUNTY ENGINEER

1 UNIT/PHASE/SECTION 4 BLOCK 264 LOT COMAL HILLS SUBDIVISION

IF NOT IN SUBDIVISION: _____ ACREAGE _____ SURVEY _____

The property is owned by (insert owner's full name): CR PHOENIX ENTERPRISES, LLC, dba Havenbrook Homes

This OSSF must be covered by a continuous maintenance contract for the first two years. After the initial two-year service policy, the owner of an aerobic treatment system for a single family residence shall either obtain a maintenance contract within 30 days or maintain the system personally.

Upon sale or transfer of the above-described property, the permit for the OSSF shall be transferred to the buyer or new owner. A copy of the planning materials for the OSSF can be obtained from the Comal County Engineer's Office.

WITNESS BY HAND(S) ON THIS 18 DAY OF JANUARY, 2021

[Signature]
Owner(s) signature(s)

CHAD RUTTEN - MANAGER
Owner (s) Printed name (s)

CHAD RUTTEN
January, 2021

SWORN TO AND SUBSCRIBED BEFORE ME ON THIS 18 DAY OF

THIS AREA FOR COMAL COUNTY CLERK RECORDING PURPOSES ONLY

[Signature]
Notary Public Signature

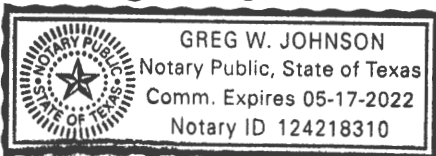

(Notary Seal Here)

Filed and Recorded
Official Public Records
Bobbie Koepf, County Clerk
Comal County, Texas
01/19/2021 01:27:55 PM
CHRISTY 1 Page(s)
202106003329



Bobbie Koepf

ON-SITE SEWERAGE FACILITY SOIL EVALUATION REPORT INFORMATION

Date Soil Survey Performed: January 14, 2021

Site Location: COMAL HILLS, UNIT 1, BLOCK 4, LOT 264

Proposed Excavation Depth: N/A

Requirements:

- At least two soil excavations must be performed on the site, at opposite ends of the proposed disposal area.
- Locations of soil boring or dug pits must be shown on the site drawing.
- For subsurface disposal, soil evaluations must be performed to a depth of at least two feet below the proposed excavation depth. For surface disposal, the surface horizon must be evaluated.
- Describe each soil horizon and identify any restrictive features on the form. Indicate depths where features appear.

SOIL BORING NUMBER _____ SURFACE EVALUATION _____						
Depth (Feet)	Texture Class	Soil Texture	Gravel Analysis	Drainage (Mottles/ Water Table)	Restrictive Horizon	Observations
0	III	CLAY LOAM	N/A	NONE OBSERVED	LIMESTONE @ 6"	BROWN
6"						
1						
2						
3						
4						
5						

SOIL BORING NUMBER _____ SURFACE EVALUATION _____						
Depth (Feet)	Texture Class	Soil Texture	Gravel Analysis	Drainage (Mottles/ Water Table)	Restrictive Horizon	Observations
0	SAME		AS		ABOVE	
0						
1						
2						
3						
4						
5						

I certify that the findings of this report are based on my field observations and are accurate to the best of my ability.

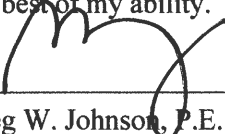

 Greg W. Johnson, P.E. 67587-F2585, S.E. 11561

01/14/2021

 Date

OSSF SOIL EVALUATION REPORT INFORMATION

Date: January 15, 2021

Applicant Information:

Name: CR PHOENIX ENTERPRISES, LLC. dba HAVENBROOK HOMES
Address: 17310 F.M. 306 BOX #1
City: CANYON LAKE State: TEXAS
Zip Code: 78133 Phone: (830) 935-2098

Site Evaluator Information:

Name: Greg W. Johnson, P.E., R.S. S.E. 11561
Address: 170 Hollow Oak
City: New Braunfels State: Texas
Zip Code: 78132 Phone & Fax (830)905-2778

Property Location:

Lot 264 Unit 1 Blk 4 Subd. COMAL HILLS
Street Address: 256 THUNDERHEAD DRIVE
City: SPRING BRANCH Zip Code: 78070
Additional Info.: _____

Installer Information:

Name: _____
Company: _____
Address: _____
City: _____ State: _____
Zip Code: _____ Phone _____

Topography: Slope within proposed disposal area: 3 %
Presence of 100 yr. Flood Zone: YES ___ NO X
Existing or proposed water well in nearby area. YES ___ NO X
Presence of adjacent ponds, streams, water impoundments YES ___ NO X
Presence of upper water shed YES ___ NO X
Organized sewage service available to lot YES ___ NO X

RECEIVED

JAN 20 2021

COUNTY ENGINEER

I HAVE PERFORMED A THOROUGH INVESTIGATION BEING A REGISTERED PROFESSIONAL ENGINEER AND SITE EVALUATOR IN ACCORDANCE WITH CHAPTER 285, SUBCHAPTER D, §285.30, & §285.40 (REGARDING RECHARGE FEATURES), TEXAS COMMISSION OF ENVIRONMENTAL QUALITY (EFFECTIVE DECEMBER 29, 2016).



GREG W. JOHNSON, P.E. 67587 - S.E. 11561

01/15/2021

DATE

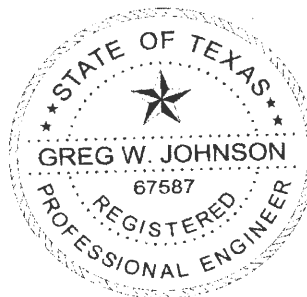

FIRM #2585

DRIP TUBING SYSTEM
DESIGNED FOR:
CR PHOENIX ENTERPRISES, LLC
17310 FM 306, BOX 1
CANYON LAKE, TX 78133

RECEIVED

JAN 20 2021

SITE DESCRIPTION:

Located in Comal Hills, Unit 1, Block 4, Lot 264, at 456 Thunderhead Drive, the proposed system will serve a three bedroom residence (1289 sf.) situated in an area with shallow Type-III soil as described in the Soil Evaluation Report. An aerobic treatment plant utilizing drip irrigation was chosen as the most appropriate system to serve the conditions on this lot.

COUNTY ENGINEER

PROPOSED SYSTEM:

A 3-inch SCH-40 pipe discharges from the residence into a NuWater B-550PC-400PT 600gpd aerobic plant containing a 353-gallon pretreatment tank, an aerobic treatment plant, and a 768-gallon pump chamber containing a submersible well pump. The well pump is activated by a time controller allowing the distribution ten times per day with an 8 minute run time with float setting at 300 gallons. A high level audible and visual alarm will activate should the pump fail. Distribution is through a self flushing 100 micron disc filter (Arkal) then through a 1" SCH-40 manifold to a 2000 sf. drip tubing field, with *Netifim Bioline* drip lines set approximately two feet apart with **0.61 gph** emitters set every two feet, as per the attached schematic. A pressure regulator PMR-MF 30psi installed in the pump tank on the manifold to the field will maintain pressure at 30 psi. A 1" SCH-40 return line is installed to periodically flush the system by cycling a 1" ball valve. Solids caught in the disk filter are flushed each cycle back to the trash tank. Vacuum breakers installed at the highest point on each manifold will prevent siphoning of effluent from higher to lower parts of the field. Field area will be scarified and built up with ~6" of Type II or Type III soil, then the drip tubing will be laid and capped with ~6" of Type II or Type III soil (**NOT SAND**). (Drip field over tank will have a minimum of 12" soil between tank and drip lines.) The field area will be sodded with grass prior to system startup. **Tank must have at grade risers on each opening with watertight caps that must be at least 65# or have a padlock or can only be removed with tools. A secondary plug, cap, or suitable restraint must be provided below riser cap to prevent tank entry should the cap be damaged or removed, in compliance with Chapter §285.38.**

DESIGN SPECIFICATIONS:

Daily waste flow: 240 GPD Table III
Pretreatment tank size: 353Gal
Plant Size: NuWater B-550 600 gpd (TCEQ Approved)
Pump tank size: 768Gal
Reserve capacity after High Level: 80 Gal (>1/3 day Req'd)

Application Rate: $R_a = 0.2 \text{ gal/sf}$
 Total absorption area: $Q/R_a = 240 \text{ GPD}/0.20 = 1200 \text{ sf.}$ (Actual 2000 sf.)
 Total linear feet drip tubing: 1000' *Netifim Bioline* drip tubing .61 GPH
 Pump requirement: 500 emitters @ .61 gph @ 30 psi = 5.0833 gpm
 Pump Requirement (cont.): Franklin C1 20XC1-05P4-W115 submersible well pump Dosing volume: 50-70 gal.
 Pump Tank Calculations: 768 Gal (14.5 gal/in.)
 Volume below working level = 12" = 218 gal
 Working level = 240 gal = 17"
 Reserve Requirement = >1/3 day = 80 gal. = 6"

RECEIVED

JAN 20 2021

MINIMUM SCOUR VELOCITY (MSV) > 2 FPS
 IN DRIP TUBING W/ NOM. DIA. 0.55" ID

$MSV = 2 \text{ FPS} (\pi d^2) / 4 * 7.48 \text{ gal/cf} * 60 \text{ sec/min}$
 $MSV = 2(3.14159((.55/12)^2) / 4) * 7.48 * 60$
 $MSV = 1.5 \text{ gpm MIN FLOW RATE} * 4 = 6.0 \text{ gpm}$

COUNTY ENGINEER

IN RETURN MANIFOLD W/ NOM. DIA 1.049" ID

$MSV = 2 \text{ FPS} (\pi d^2) / 4 * 7.48 \text{ gal/cf} * 60 \text{ sec/min}$
 $MSV = 2(3.14159((1.049/12)^2) / 4) * 7.48 * 60$
 $MSV = 5.4 \text{ GPM}$

PIPE AND FITTINGS:

All pipes and fittings in this drip tubing system shall be 1" schedule 40 PVC. All joints shall be sealed with approved solvent-type PVC cement. Clipper type cutters are recommended to prevent PVC burrs during cutting of pipes causing possible plugging. Drip tubing 0.61 gph drip tubing to be used in field.

Designed in accordance with Chapter 285, Subchapter D, §285.30 and §285.40 Texas Commission on Environmental Quality (Effective December 29, 2016)

 01/15/2021

 Greg W. Johnson, P.E. No. 67587 - F-2585
 170 Hollow Oak
 New Braunfels, Texas 78132
 830/905-2778

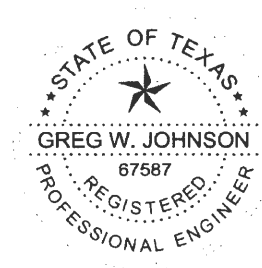

NUWATER B 550 PC AEROBIC TREATMENT PLANT

SLEEVE WATER LINE
WITH 2"-SCH-40
PVC PIPE WHEN
ENTERING CLOSER
THAN 10' FROM
SEPTIC SYSTEM OR
SEPTIC FIELD.

INSTALL 2000sf OF
FIELD USING 1000'
OF DRIP TUBING.
THERE SHALL BE
NO PARKING,
DRIVING OR
STORAGE ON THE
SEPTIC FIELD AT
ANY TIME FOR
ANY REASON.

*USE TWO WAY
CLEANOUT
**USE SCH-40 OR
SDR-26 TO TANK

X= TEST HOLE

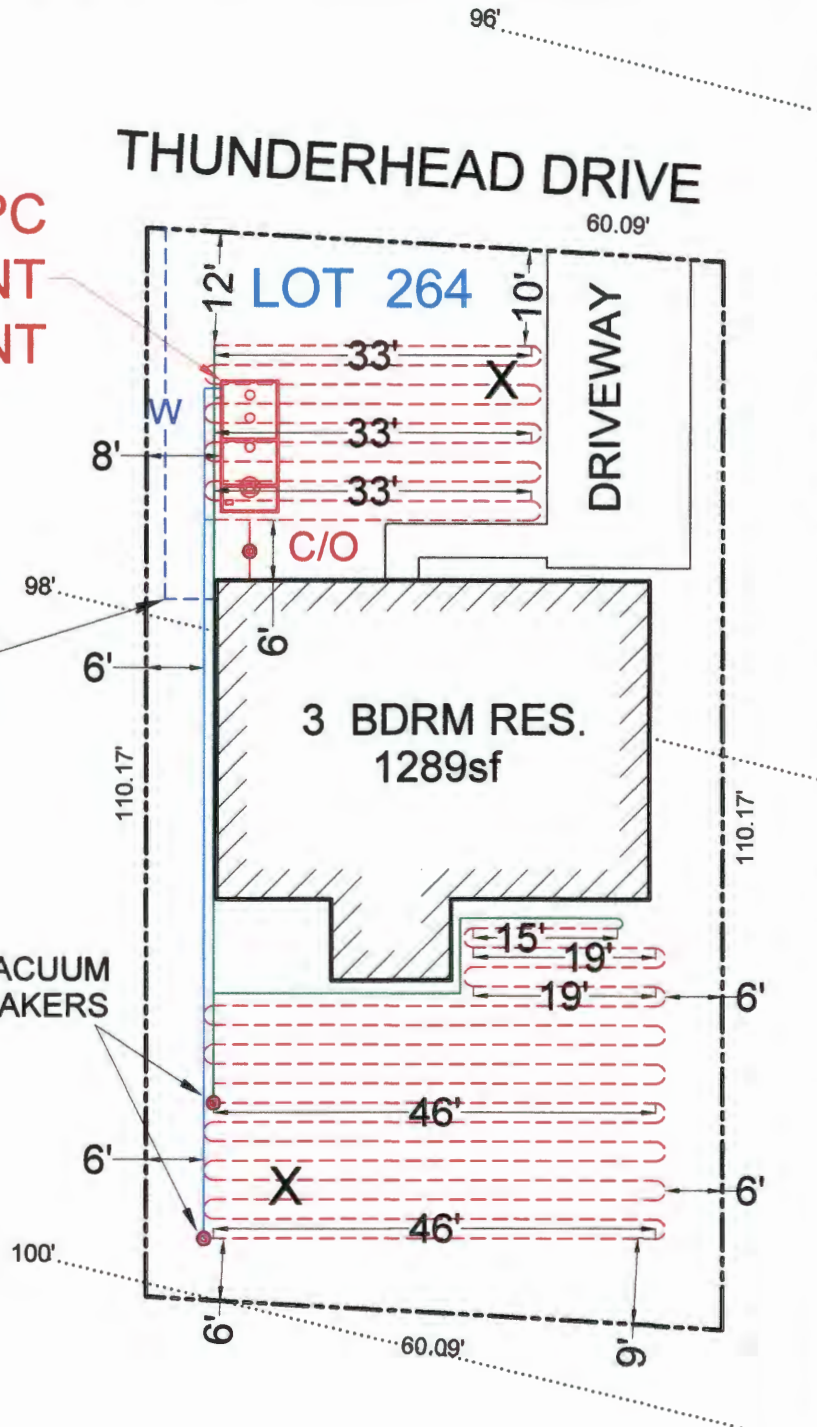

OWNER: CR PHOENIX ENTERPRISES, LLC. dba HAVENBROOK HOMES		DRAWN BY: EJS III	
STREET ADDRESS: 456 THUNDERHEAD DRIVE			
LEGAL DESC: COMAL HILLS	UNIT/SECTION/PHASE: 1	BLOCK: 4	LOT: 264
PREPARED BY: GREG W. JOHNSON, P.E. F#002585	SCALE: 1"=20'	DATE: 1/15/2021	REVISED:

TANK NOTES:

Tanks must be set to allow a minimum of 1/8" per foot fall from the residence.

Tightlines to the tank shall be SCH-40 PVC.

A two way sanitary tee is required between residence and tank.

A minimum of 4" of sand, sandy loam, clay loam free of rock shall be placed under and around tanks

RECEIVED

JAN 20 2021

COUNTY ENGINEER

ALL WIRING MUST BE IN COMPLIANCE WITH
THE MOST RECENT NATIONAL ELECTRIC CODE

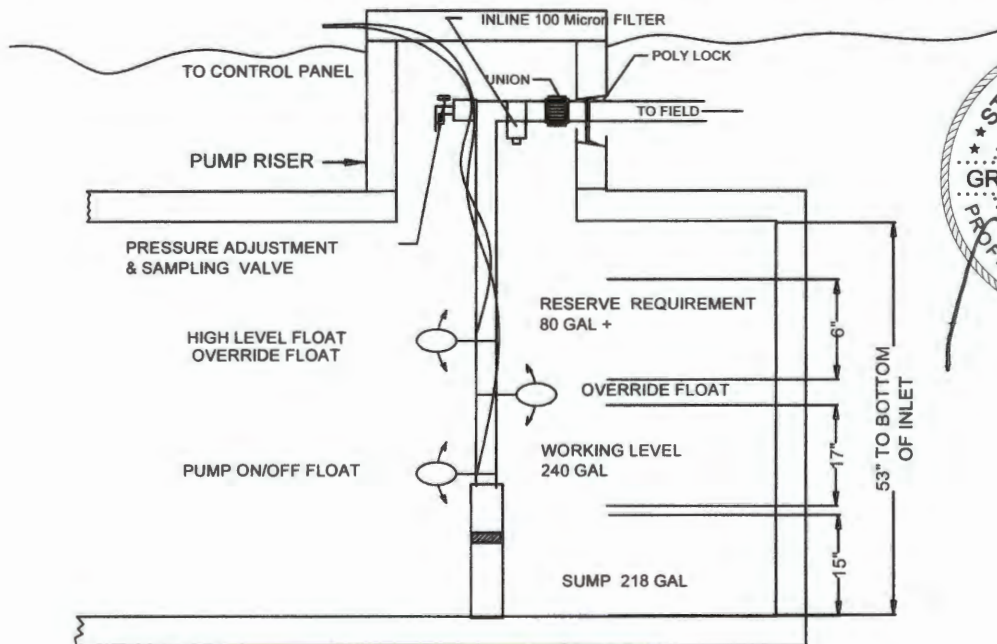

F-2585

01/15/2021

TYPICAL PUMP TANK CONFIGURATION
NU-WATER 550PC -400PT 768 GAL PUMP TANK

Arkal 1" Super Filter

Catalog No. 1102 0 _ _ _ _

Features

- ♦ A "T" shaped filter with two 1" male threads.
- ♦ A "T" volume filter for in-line installation on 1" pipelines.
- ♦ The filter prevents clogging due to its enlarged filtering area that collects sediments and particles.
- ♦ Manufactured entirely from fiber reinforced plastic.
- ♦ A cylindrical column of grooved discs constitutes the filter element.
- ♦ Spring keeps the discs compressed.
- ♦ Screw-on filter cover.
- ♦ Filter discs are available in various filtration grades.

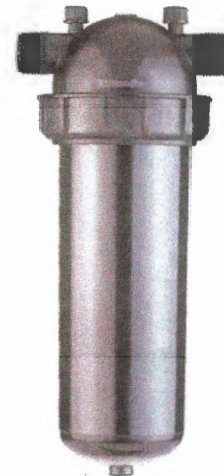

RECEIVED

JAN 20 2021

COUNTY ENGINEER

Technical Data

Inlet/outlet diameter	1" BSPT (male)	1" NPT (male)
	25.0 mm – nominal diameter	
	33.6 mm – pipe diameter (O. D.)	
Maximum pressure	10 atm	145 psi
Maximum flow rate	8 m ³ /h (1.7 l/sec)	35 gpm
General filtration area	500 cm ²	77.5 in ²
Filtration volume	600 cm ³	37 in ³
Filter length L	340 mm	13 13/32"
Filter width W	130 mm	5 3/32"
Distance between end connections A	158 mm	6 7/32"
Weight	1.420 kg	3.13 lbs.
Maximum temperature	70° C	158 °F
pH	5-11	5-11

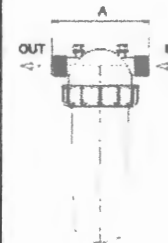

Filtration Grades

- Blue (400 micron / 40 mesh)
- Yellow (200 micron / 80 mesh)
- Red (130 micron / 120 mesh)
- Black (100 micron / 140 mesh)
- Green (55 micron)

Head Loss Chart

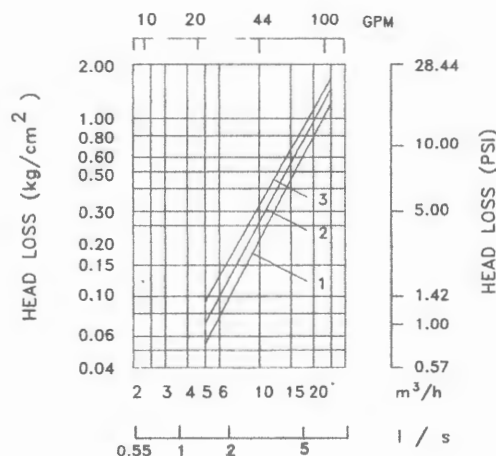



Bioline[®] Dripperline

Pressure Compensating Dripperline for Wastewater

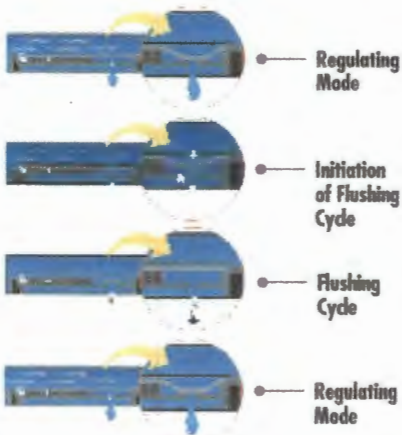

Bioline's Self-Cleaning, Pressure Compensating Dripper is a fully self-contained unit molded to the interior wall of the dripper tubing.

As shown at left, Bioline is continuously self-cleaning during operation, not just at the beginning and end of a cycle. The result is dependable, clog free operation, year after year.

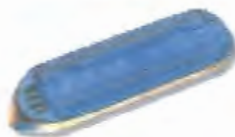

Product Advantages

The Proven Performer

- Tens of millions of feet used in wastewater today.
- Bioline is permitted in every state allowing drip disposal.
- Backed by the largest, most quality-driven manufacturer of drip products in the U.S.
- Preferred choice of major wastewater designers and regulators.
- Proven track record of success for many years of hard use in wastewater applications.

Quality Manufacturing with Specifications Designed to Meet Your Needs

- Pressure compensating drippers assure the highest application uniformity - even on sloped or rolling terrain.
- Excellent uniformity with runs of 400 feet or more - reducing installation costs.
- Highest quality-control standards in the industry: Cv of 0.25 (coefficient of manufacturer's variation).
- A selection of flows and spacings to satisfy the designer's demand for almost any application rate.

Long-Term Reliability

- Protection against plugging:
 - Dripper inlet raised 0.27" above wall of tubing to prevent sediment from entering dripper.
 - Drippers impregnated with Vinyzene to prevent buildup of microbial slime.
 - Unique self-flushing mechanism passes small particles before they can build up.



Root Safe

- A physical barrier on each Bioline dripper helps prevent root intrusion.
- Protection never wears out - never depletes - releases nothing to the environment.
- Working reliably for up to 15 years in subsurface wastewater installations.
- Additional security of chemical root inhibition with Techfilter - supplies Trifluralin to the entire system, effectively inhibiting root growth to the dripper outlets.



Applications

- For domestic strength wastewater disposal.
- Installed following a treatment process.
- Can be successfully used on straight septic effluent with proper design, filtration and operation.
- Suitable for reuse applications using municipally treated effluent designated for irrigation water.

Specifications

- Wall thickness (mil): 45*
- Nominal flow rates (GPH): .4, .6, .9*
- Common spacings: 12", 18", 24"*
- Recommended filtration: 120 mesh
- Inside diameter: .570"
- Color: Purple tubing indicates non-potable source

*Additional flows, spacings, and pipe sizes available by request. Please contact Netafim USA Customer Service for details.

RECEIVED

JAN 20 2021

COUNTY ENGINEER

BIOLINE Flow Rate vs. Pressure

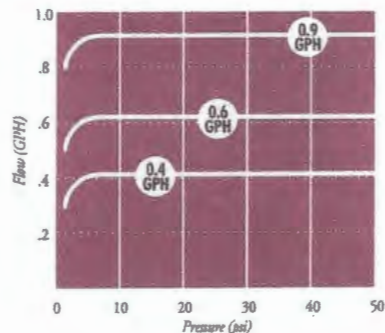

NETAFIM USA
5470 E. Home Ave. • Fresno, CA 93727
888.638.2346 • 559.453.6800
FAX 800.695.4753
www.netafimusa.com

NETAFIM WASTEWATER DISPERSAL SYSTEM DESIGN GUIDE

SAMPLE DESIGNS

SINGLE TRENCH LAYOUT

Rectangular field with supply and flush manifold on same side and in same trench;

- Locate supply and flush manifold in same trench
- Dripperlines are looped at the end opposite the supply and flush manifolds
- The longest Bioline length should not exceed 400 ft. Drip fields 200 ft. in length might loop the Bioline once; drip dispersal fields under 100 ft. might be looped twice, as illustrated

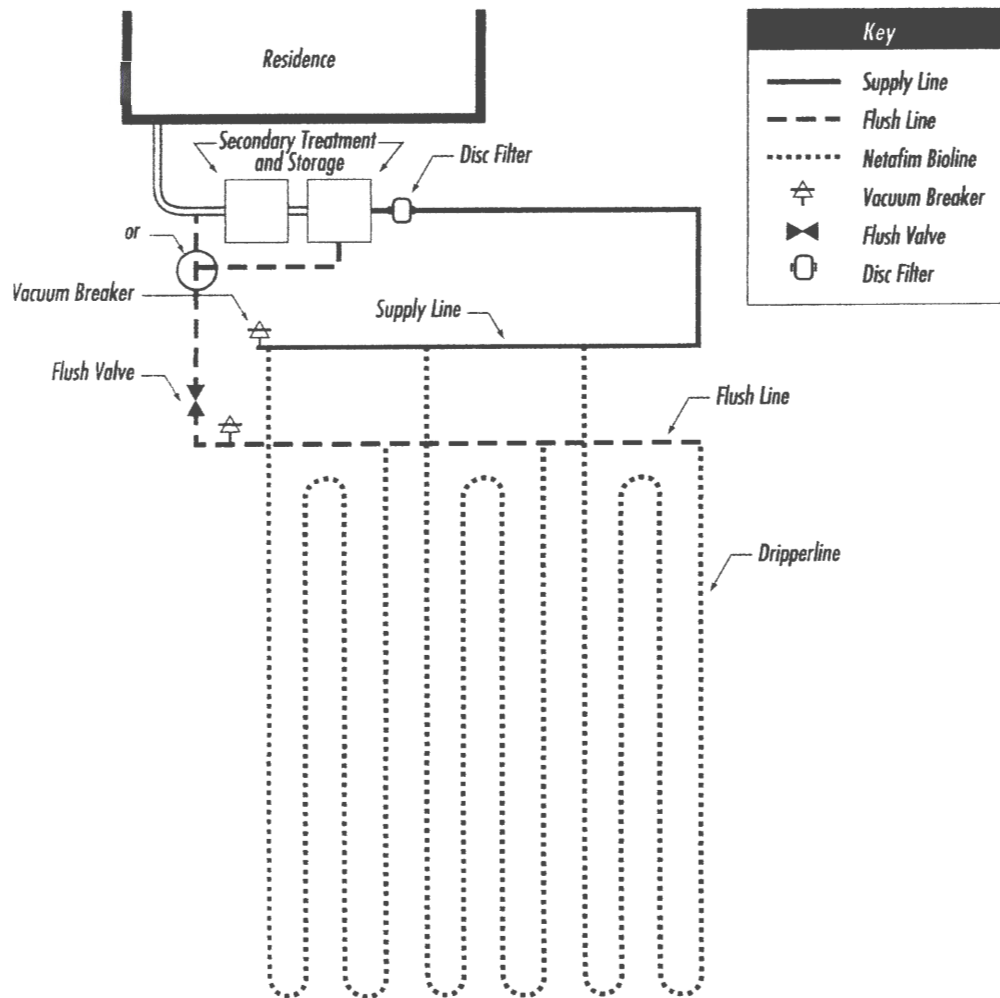

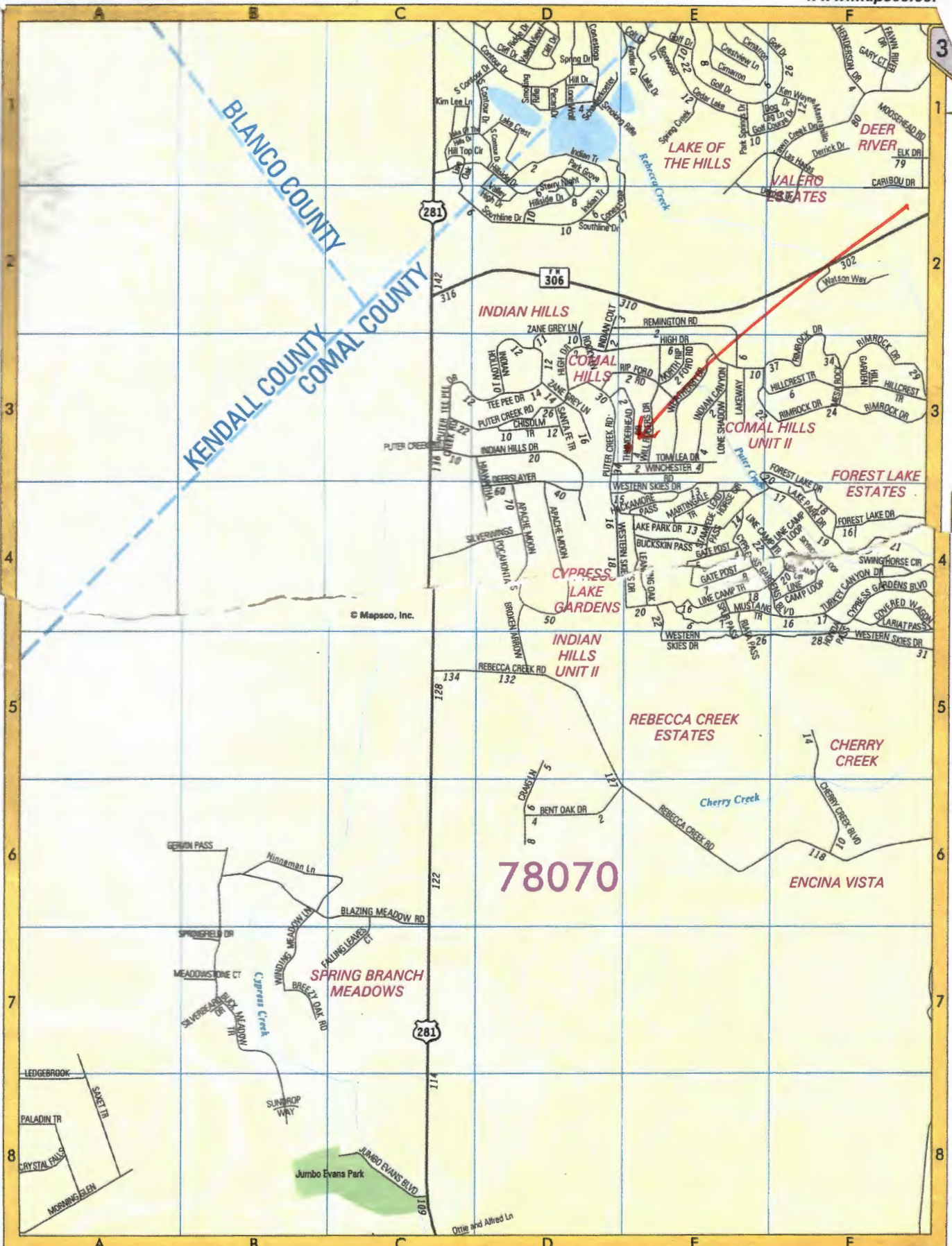

BLANCO COUNTY
KENDALL COUNTY
COMAL COUNTY

78070

© Mapsco, Inc.

CONTINUED ON MAP 319

WASTEWATER TREATMENT FACILITY MONITORING AGREEMENT

RECEIVED

JAN 20 2021

COUNTY ENGINEER

Regulatory Authority COMAL
Block Creek Aerobic Services, LLC
444 A Old Hwy #9
Comfort, TX 78013
Off. (830) 995-3189
Fax. (830) 995-4051

Permit/License Number _____
Customer CR PHOENIX ENTERPRISES, LLC
Site Address 456 THUNDERHEAD DRIVE
City SPRING BRANCH Zip 78070
Mailing Address 17310 FM 306, Box 1, Canyon Lake, TX 7813
County COMAL Map # 318 E3
Phone 830-935-2098
Email lars@havenbrooktx.com

2 YEAR CONTRACT
2 YEAR WARRANTY ON PARTS AND LABOR

SUBDIVISION/LEGAL: COMAL HILLS, UNIT 1, BLOCK 4, LOT 264.

I. General: This Work for Hire Agreement (hereinafter referred to as "Agreement") is entered into by and between CR PHOENIX ENTERPRISES, LLC (hereinafter referred to as "Customer") and Block Creek Aerobic Services, LLC. By this agreement, Block Creek Aerobic Services, LLC and its employees (hereinafter inclusively referred to as "Contractor") agree to render services at the site address stated above, as described herein, and the Customer agrees to fulfill his/her/their responsibilities, as described herein.

II. Effective Date:

This Agreement commences on _____ LTO _____ and ends on _____ for a total of two (2) years (initial agreement) or one (1) year (thereafter). If this is an initial agreement (new installation), the Customer shall notify the Contractor within two (2) business days of the system's first use to establish the date of commencement. If no notification is received by Contractor within ninety (90) day::s after completion of installation or where county authority mandates, the date of commencement will be the date the "License to operate" (Notice of Approval) was issued by the permitting authority. This agreement may or may not commence at the same time as any warranty period of installed equipment, but in no case shall it extend the specified warranty.

III. Termination of Agreement:

This Agreement may be terminated by either party for any reason, including for example, substantial failure of either party to perform in accordance with the terms of this Agreement, without fault or liability of the terminating party. The terminating party must provide written notice to the non-terminating party thirty (30) days prior to the termination of this Agreement. If this Agreement is terminated, Contractor will be paid at the rate of \$75.00 per hour for any work performed and for which compensation has not been received. After the deduction of all outstanding charges, any remaining monies from prepayment for services will be refunded to customer within thirty (30) days of termination of this Agreement. Either party terminating this Agreement for any reason, including non-renewal, shall notify in writing the equipment manufacturer and the appropriate regulatory agency a minimum of thirty (30) days prior to the date of such termination. Nonpayment of any kind shall be considered breach of contract and a termination of contract.

IV. Services:

Contractor will:

- a. Inspect and perform routine upkeep on the On-Site Sewage Facility (hereinafter referred to as OSSF) as recommended by the treatment system manufacturer, and required by state and/or local regulation, for a total of three visits to site per year. The list of items checked at each visit shall be the: control panel, Electrical circuits, timer, Aeration including compressor and diffusers, CFM/PSI measured, lids safety pans, pump, compressor, sludge levels, and anything else required as per the manufacturer.
- b. Provide a written record of visits to the site by means of an inspection tag attached to or contained in the control panel.
- c. Repair or replace, if Contractor has the necessary materials at site, any component of the OSSF found to be failing or inoperative during the course of a routine monitoring visit. If such services are not covered by warranty, and the service(s) cost less than \$100.00, Customer hereby authorizes Contractor to perform the service(s) and bill Customer for said service(s). When service costs are greater than \$100.00, or if contractor does not have the necessary supplies at the site, Contractor will notify Customer of the required service(s) and the associated cost(s). Customer must notify Contractor of arrangements to affect repair of system with in two (2) business days after said notification.
- d. Provide sample collection and laboratory testing of TSS and BOD on a yearly basis (commercial systems only).
- e. Forward copies of this Agreement and all reports to the regulatory agency and the Customer.

CR
Customer's Initials



BS

Contractor's Initials

f. Visit site in response to Customer's request for unscheduled services within forty-eight (48) hours of the date of notification (weekends and holidays excluded) of said request. Unless otherwise covered by warranty, costs for such unscheduled responses will be billed to Customer.

V. Disinfection:

Not required; _____ required. The responsibility to maintain the disinfection device(s) and provide any necessary chemicals is that of the Customer.

VI. Electronic Monitoring:

Electronic Monitoring is not included in this Agreement.

RECEIVED

VII. Performance of Agreement:

Commencement of performance by Contractor under this Agreement is contingent on the following conditions:

a. If this is an initial Agreement (new installation):

1. Contractor's receipt of a fully executed original copy or facsimile of this agreement and all documentation requested by Contractor.

If the above conditions are not met, Contractor is not obligated to perform any portion of this Agreement.

VIII. Customer's Responsibilities:

The customer is responsible for each and all of the following:

a. Provide all necessary yard or lawn maintenance and removal of all obstacles, including but not limited to dogs and other animals, vehicles, trees, brush, trash, or debris, as needed to allow the OSSF to function properly, and to allow Contractor safe and easy access to all parts of the OSSF.

b. Protect equipment from physical damage including but not limited to that damage caused by insects.

c. Maintain a current license to operate, and abide by the conditions and limitations of that license, and all requirements for and OSSF from the State and/or local regulatory agency, whichever requirements are more stringent, as well as the proprietary system's manufacturer recommendations.

d. Notify Contractor immediately of any and all alarms, and/or any and all problems with, including failure of, the OSSF.

e. Provide, upon request by Contractor, water usage records for the OSSF so that the Contractor can perform a proper evaluation of the performance of the OSSF.

f. Allow for samples at both the inlet and outlet of the OSSF to be obtained by Contractor for the purpose of evaluating the OSSF's performance. If these samples are taken to a laboratory for testing, with the exception of the service provided under Section IV (d) above, Customer agrees to pay Contractor for the sample collection and transportation, portal to portal, at a rate of \$35.00 per hour, plus the associated fees for laboratory testing.

g. Prevent the backwash or flushing of water treatment or conditioning equipment from entering the OSSF.

h. Prevent the condensation from air conditioning or refrigeration units, or the drains of icemakers, from hydraulically overloading the aerobic treatment units. Drain lines may discharge into the surface application pump tank if approved by system designer.

i. Provide for pumping and cleaning of tanks and treatment units, when and as recommended by Contractor, at Customer's expense.

j. Maintain site drainage to prevent adverse effects on the OSSF.

k. Pay promptly and fully, all Contractor's fees, bills, or invoices as described herein.

IX. Access by Contractor:

Contractor is hereby granted an easement to the OSSF for the purpose of performing services described herein. Contractor may enter the property during Contractor's normal business hours and/or other reasonable hours without prior notice to Customer to perform the Services and/or repairs described herein. Contractor shall have access to the OSSF electrical and physical components. Tanks and treatment units shall be accessible by means of man ways, or risers and removable covers, for the purpose of evaluation as required by State and/or local rules and the proprietary system manufacturer. It is Customer's responsibility to keep lids exposed and accessible at all times.

X. Limit of Liability:

Contractor shall not be held liable for any incidental, consequential, or special damages, or for economic loss due to expense, or for loss of profits or income, or loss of use to Customer, whether in contract tort or any other theory. In no event shall Contractor be liable in an amount exceeding the total Fee for Services amount paid by Customer under this Agreement.

XI. Indemnification:

Customer (whether one or more) shall and does hereby agree to indemnify, hold harmless and defend Contractor and each of its successors, assigns, heirs, legal representatives, devisees, employees, agents and/or counsel (collectively "Indemnitees") from and against any and all liabilities, claims, damages, losses, liens, causes of action, suits, fines, judgments and other expenses (including, but not limited to, attorneys' fees and expenses and costs of investigation), of any kind, nature or

CR

Customer's Initials



BS

Contractor's Initials

description, (hereinafter collectively referred to as "Liabilities") arising out of, caused by, or resulting, in whole or in part, from this Agreement.

THIS INDEMNIFICATION APPLIES EVEN IF SUCH LIABILITIES ARE CAUSED BY THE CONCURRENT OR CONTRIBUTORY NEGLIGENCE OR BY THE STRICT LIABILITY OF ANY INDEMNITEE.

Customer hereby waives its right of recourse as to any Indemnitee when Indemnification applies, and Customer shall require its insurer(s) to waive its/their right of subrogation to the extent such action is required to render such waiver of subrogation effective. Customer shall be subrogated to Indemnitees with respect to all rights Indemnitees may have against third parties with respect to matters as to which Customer provides indemnity and/or defense to Indemnitees. No Indemnification is provided to Indemnitees when the liability or loss results from (1) the sole responsibility of such Indemnitee; or, (2) the willful misconduct of such Indemnitee. Upon irrevocable acceptance of this Indemnification obligation. Customer, in its sole discretion, shall select and pay counsel to defend Indemnitees of and from any action that is subject to this Indemnification provision. Indemnitees hereby covenant not to compromise or settle any claim or cause of action for which Customer has provided Indemnification without the consent of Customer.

RECEIVED
JAN 20 2021
COUNTY ENGINEER

XII. Severability:

If any provision of the "Proposal and Contract" shall be held to be invalid or unenforceable for any reason, the remaining provisions shall continue to be valid and enforceable. If a court finds that any provision of the "Agreement" is invalid or unenforceable, but that by limiting such provision it would become valid and enforceable, then such provision shall be deemed to be written, construed, and enforced as so limited.

XIII. Fee for Services:

The Fee for Services does not include any fees for equipment, material, labor necessary for non-warranty repairs, unscheduled inspections, or Customer requested visits to the site.

XIV. Payment:

Full payment is due upon execution of this Agreement (Required of new Customer). For any other service(s) or repair(s) provided by Contractor the Customer shall pay the invoice(s) for said service(s) or repair(s) within thirty (30) days of the invoice date. The Contractor shall mail all invoices on the date of invoice. All payments not received within thirty (30) days from the invoice date will be subject to a \$29.00 late penalty and a 1.5% per month carrying charge, as well as any reasonable attorney's fees, and all collection and court costs incurred by Contractor in collection of unpaid debt(s). Contractor may terminate contract at any time for nonpayment for services. Any check returned to Contractor for any reason will be assessed a \$30.00 return check fee.

XV. Application or Transfer of payment:

The fees paid for this agreement may be transferred to subsequent property owner(s); however, this Agreement is not transferable. Customer shall advise the subsequent property owner(s) of the State requirement that they sign a replacement agreement authorizing Contractor to perform the herein described Services, and accepting Customer's Responsibilities. This replacement Agreement must be signed and received in Contractor's offices within ten (10) business days of date of transfer of property ownership. Contractor will apply all funds received from Customer first to any past due obligation arising from this Agreement including late fees or penalties, return check fees, and/or charges for services or repairs not paid within thirty (30) days of invoice date. Any remaining monies shall be applied to the funding of the replacement Agreement. The consumption of funds in this manner may cause a reduction in the termination date of effective coverage per this Agreement. See Section IV.

XVI. Entire Agreement:

This agreement contains the entire Agreement of the parties, and there are no other conditions in any other agreement, oral or written.

Burt S. Siderstick

Block Creek Aerobic Services, LLC,
Contractor
MC# 0000042 and MC#0000002

CR

Customer's Initials

[Handwritten Signature]

Customer Signature

1/18/2021

Date

BS

Contractor's Initials



NOTICE OF CONFIDENTIALITY RIGHTS: IF YOU ARE A NATURAL PERSON, YOU MAY REMOVE OR STRIKE ANY OR ALL OF THE FOLLOWING INFORMATION FROM ANY INSTRUMENT THAT TRANSFERS AN INTEREST IN REAL PROPERTY BEFORE IT IS FILED FOR RECORD IN THE PUBLIC RECORDS: YOUR SOCIAL SECURITY NUMBER OR YOUR DRIVER'S LICENSE NUMBER.

General Warranty Deed

Date: September 25, 2020

Grantor: Legacy Land Company, LLC, a Minnesota limited liability company

Grantor's Mailing Address:

Legacy Land Company, LLC
5115 Excelsior Blvd, #370
St Louise Prk, Minnesota 55416

Grantee: CR PhoenixEnterprises, LLC dba Havenbrook Homes, a Texas limited liability company

Grantee's Mailing Address:

CR PhoenixEnterprises, LLC dba Havenbrook Homes
P. O. Box 1554
Canyon Lake, Texas 78133

Consideration:

Cash and other good and valuable consideration, the receipt and sufficiency of which are hereby acknowledged.

Property (including any improvements):

Lot 264, Block 4, Comal Hills, Unit No. 1, an addition in Comal County, Texas, according to plat thereof recorded in Volume 2, Pages 53-54, Map and Plat Records of Comal County, Texas.

Reservations from Conveyance:

None

Exceptions to Conveyance and Warranty:

Validly existing easements, rights-of-way, and prescriptive rights, whether of record or not; all presently recorded and validly existing instruments, other than conveyances of the

RECEIVED

JAN 20 2021

COUNTY ENGINEER

surface fee estate, that affect the Property; and taxes for 2020, which Grantee assumes and agrees to pay, and subsequent assessments for that and prior years due to change in land usage, ownership, or both, the payment of which Grantee assumes.

Grantor, for the Consideration and subject to the Reservations from Conveyance and the Exceptions to Conveyance and Warranty, grants, sells, and conveys to Grantee the Property, together with all and singular the rights and appurtenances thereto in any way belonging, to have and to hold it to Grantee and Grantee's heirs, successors, and assigns forever. Grantor binds Grantor and Grantor's heirs and successors to warrant and forever defend all and singular the Property to Grantee and Grantee's heirs, successors, and assigns against every person whomsoever lawfully claiming or to claim the same or any part thereof, except as to the Reservations from Conveyance and the Exceptions to Conveyance and Warranty.

When the context requires, singular nouns and pronouns include the plural.

Legacy Land Company, LLC, a Minnesota limited liability company,

Peter Bonahoom, Manager

RECEIVED

SEP 20 2021

NOTARY ENGINEER

STATE OF MINNESOTA)

COUNTY OF CARVER)

This instrument was acknowledged before me on SEPTEMBER 25, 2020, by Peter Bonahoom, a Manager of Legacy Land Company, LLC, on behalf of Legacy Land Company, LLC, a limited liability company.

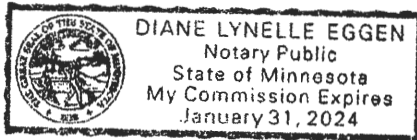

Notary Public, State of Minnesota
My commission expires: 1/31/2024

PREPARED IN THE OFFICE OF:

David L. Ricker
P. O. Box 1571
Boerne, Texas 78006
Tel: (210) 737-6097
Fax: (210) 690-3635

AFTER RECORDING RETURN TO:

Alamo Title Company
434 N. Loop 1604 West, #2208
San Antonio, Texas 78232

Filed and Recorded
Official Public Records
Bobbie Koeppe, County Clerk
Comal County, Texas
10/01/2020 08:54:07 AM
LAURA 2 Pages(s)
202006042768





Block Creek Concrete Products, LLC
444 A Old Hwy No 9
Comfort, TX 78013

Phone: (830) 995-3189
Fax: (830) 995-4051

To: Home Owner
456 Thunderhead Dr
Spring Branch, TX 78070

Printed: 4/11/2022
Site: 456 Thunderhead Dr
Spring Branch, TX 78070

Permit #: **111924**

Agency: Comal County
County: Comal Sub:
Mfg / Brand: Advantage Wastewater LLC - Nu Water
Treatment Type: Aerobic With Chlorine
Disposal: Drip Emitters

Customer ID: 7826
Contract Dates: 12/3/2021 - 12/3/2023
Scheduled Date: 4/3/2022 Inspection 3 of 6
Installed: 9/23/2021
Warranty End: 9/23/2023
GPS Coordinates - Latitude: 29.93078 Longitude: -98.39991

Service Type: Scheduled Inspection

This counts as a type of "Scheduled Inspection"

Visit Date: 4/11/2022

Time In: 335p

Out: 358p

Entered By: Jose Ramos

Method: Grab

Technician: Jose Ramos
Maint. Provider: Rudy Carson

Aerators: Operational
Filters: Operational
Irrigation Pumps: Operational
Disinfection Device: Operational

Sludge Levels
For Tank 1: 20"
For Tank 2: 0"
For Tank 3: 0"

CFM: 3.0

Air Filter: Good

Turbidity: Good
Tank Lid / Riser: Secured
Insp. Port / Plug: Secured

Electric Circuits: Operational
Distribution System: Operational
Sprayfield Veg: Operational

Color: Good
Odor: Good

Alarm: Operational

PSI Pressure: 3.0

Comments

Service Completed

- Technician Secured the Tank Lid and/or Riser prior to leaving location. - Inspection Port Plug was noted as Secured prior to leaving. - Cleaned compressor filter - Scum in pretreatment is 1". Cleaned dripper filter.

Insp ID #: 123528

Provider: **Rudy Carson**

Technician: Jose Ramos

License #: MP0002036

License #: MT0001770

Expires: 9/1/2022

Block Creek Aerobic Services, LLC
444 A Old Hwy No 9
Comfort, TX 78013

Phone: (830) 995-3189
Fax: (830) 995-4051

To: Home Owner
456 Thunderhead Dr
Spring Branch, TX 78070

Printed: 8/4/2022
Insp ID #: 128556

Main Phone:
Work:
Cell Phone:
Alt Cell:

Permit #: **111924**

Agency: Comal County
County: Comal
Mfg / Brand: Advantage Wastewater LLC - Nu Water
Treatment Type: Aerobic With Chlorine
Disposal: Drip Emitters

Customer ID: 7826
Contract Dates: 12/3/2021 - 12/3/2023
Scheduled Date: 8/3/2022 Inspection 4 of 6
Installed: 9/23/2021
Warranty End: 9/23/2023
GPS Coordinates: Latitude: 29.93078 Longitude: -98.39991

Service Type: Scheduled Inspection

This counts as a type of "Scheduled Inspection"
Entered By: Jose Ramos

Visit Date: 8/4/2022

Time In: 335p Out: 354

Method: Grab

Technician: Jose Ramos
Maint. Provider: Rudy Carson

Aerators: Operational
Filters: Operational
Irrigation Pumps: Operational
Disinfection Device: Operational

Sludge Levels
For Tank 1: 18"
For Tank 2: 6"
For Tank 3: 0"

Floats: OP
Timer: OP

CFM: 2.4

Electric Circuits: Operational
Distribution System: Operational
Sprayfield Veg: Operational

Tank Lid / Riser: Secured
Insp. Port / Plug: Secured

Alarm: Operational

Comments

Service Completed

- Technician Secured the Tank Lid and/or Riser prior to leaving location. - Inspection Port Plug was noted as Secured prior to leaving.
Cleaned compressor filter cleaned dripper filter. Tank 1 scum 2".

Site: 456 Thunderhead Dr, Spring Branch, TX 78070

Provider: Rudy Carson

Technician: Jose Ramos

License Info: MP0002036 Expires:

License Info: MT0001770 Expires: 9/1/2022

Block Creek Aerobic Services, LLC
444 A Old Hwy No 9
Comfort, TX 78013

Phone: (830) 995-3189
Fax: (830) 995-4051

To: Home Owner
456 Thunderhead Dr
Spring Branch, TX 78070

Printed: 5/6/2023
Insp ID #: 139616
Main Phone:
Work:
Cell Phone:
Alt Cell:

Permit #: **111924**
Agency: Comal County
County: Comal
Mfg / Brand: Advantage Wastewater LLC - Nu Water
Treatment Type: Aerobic With Chlorine
Disposal: Drip Emitters

Customer ID: 7826
Contract Dates: 12/3/2021 - 12/3/2023
Scheduled Date: 4/3/2023
Inspection 6 of 6
Installed: 9/23/2021
Warranty End: 9/23/2023
GPS Coordinates: Latitude: 29.93078 Longitude: -98.39991

Service Type: Scheduled Inspection

This counts as a type of "Scheduled Inspection"
Entered By: Noel J Aleman

Visit Date: 5/6/2023 Time In: 1023 Out: 1042

Method: Grab
Technician: Alejandro Gonzalez
Maint. Provider: Rudy Carson

Aerators: Operational
Filters: Operational
Irrigation Pumps: Operational
Disinfection Device: Operational

Sludge Levels
For Tank 1: 6"
For Tank 2: 10"
For Tank 3: 0"

Floats: OP
Timer: OP

Electric Circuits: Operational
Distribution System: Operational
Sprayfield Veg: Operational

Tank Lid / Riser: Secured

Alarm: Operational

Comments

- Technician Secured the Tank Lid and/or Riser prior to leaving location. - Cleaned compressor filter - Scum in pretreatment is 4" -
Cleaned drip filter and back flushed drip field.
We do not have your contact information on file. Please contact our office so that we can update your information to better assist you in
the future.
THANKS

Service Completed

Site: 456 Thunderhead Dr, Spring Branch, TX 78070

Provider: Rudy Carson

Technician: Alejandro Gonzalez

License Info: MP0002036 Expires: 11/30/2025

License Info: MT0000996 Expires: 1/31/2025

Block Creek Aerobic Services, LLC
444 A Old Hwy No 9
Comfort, TX 78013

Phone: (830) 995-3189
Fax: (830) 995-4051

To: James Chase
456 Thunderhead Dr
Spring Branch, TX 78070

Printed: 9/5/2023
Insp ID #: 144282

Main Phone: (210) 241-0920
Work:
Cell Phone:
Alt Cell:

Permit #: **111924**

Agency: Comal County
County: Comal
Mfg / Brand: Advantage Wastewater LLC - Nu Water
Treatment Type: Aerobic With Chlorine
Disposal: Drip Emitters

Customer ID: 7826

Contract Dates: 12/3/2021 - 12/3/2023

Scheduled Date: 8/3/2023

Inspection 7 of 6

Installed: 9/23/2021

Warranty End: 9/23/2023

GPS Coordinates: Latitude: 29.93078 Longitude: -98.39991

Service Type: Scheduled Inspection

This counts as a type of "Scheduled Inspection"
Entered By: Ronnie W Krampota

Visit Date: 9/5/2023

Time In: 1100am

Out: 1120am

Method: Grab

Technician: Ronnie W Krampota

Maint. Provider: Rudy Carson

Aerators: Operational

Filters: Operational

Irrigation Pumps: Operational

Disinfection Device: Operational

Sludge Levels

For Tank 1: 11

For Tank 2: 10

For Tank 3: 3

Floats: OP

Timer: OP

Air Filter: Good

Electric Circuits: Operational

Distribution System: Operational

Sprayfield Veg: Operational

Tank Lid / Riser: Secured

Color: Good

Odor: Good

Alarm: Operational

Comments

- Technician Secured the Tank Lid and/or Riser prior to leaving location. - Secured system in the on position with a lock bolt - Cleaned drip filter and back flushed drip filter - Closed valve - Cleaned compressor filter - Scum in pretreatment is 4" - Red light on due to clogged drip filter - Cleaned drip filter and pump screen - Alarm will go off when the water level returns to normal level - The drip filter should be cleaned once a month

Service Completed

Site: 456 Thunderhead Dr, Spring Branch, TX 78070

Provider: *Rudy Carson*

Technician: *Ronnie W Krampota*

License Info: MP0002036 Expires: 11/30/2025

License Info: MT0001175 Expires: 7/31/2023

Block Creek Aerobic Services, LLC
444 A Old Hwy No 9
Comfort, TX 78013

Phone: (830) 995-3189
Fax: (830) 995-4051

Customer ID: 7826

Contract Period

Start Date: 12/3/2023
End Date: 12/3/2025

Main Phone: (210) 241-0920
Cell Phones: (210) 382-1195

To: James Chase
456 Thunderhead Dr
Spring Branch, TX 78070

Permit #: 111924

Site: 456 Thunderhead Dr, Spring Branch, TX 78070
County: Comal
Installer: Varhol
Agency: Comal County
Mfg/Brand: Advantage Wastewater LLC-Nu Water-49135

Installed: 9/23/2021
Warranty End: 9/23/2023

Block Creek Aerobic Services, LLC
3 visits per year - one every 4 months
600 gallons per day

This is to Certify that the above RESIDENTIAL sewage system has an INITIAL inspections agreement per Texas Commission on Environmental Quality (TCEQ) standards for on site sewerage facilities as required.

Inspection reports by the above service company will be filed with the authorized agency as required by the TCEQ regulations. A weather proof tag or label will be attached to the controller showing the month that each inspection was made.

Items included on the Inspection Report generally include aerators, filters, irrigation pump, air compressor, disinfection device, chlorine supply, OK System light, spray field vegetation, probe, sprinkler or drip backwash.

We will visit your site within 48 hours of you notifying us of a problem

Certified Inspector: _____

Rudv

Date: _____

11-13-23

Date Printed: 11/13/2023

Block Creek Aerobic Services, LLC
444 A Old Hwy No 9
Comfort, TX 78013

Printed: 12/13/2023 Insp ID #: 149809

Phone: (830) 995-3189
Fax: (830) 995-4051

To: James Chase
456 Thunderhead Dr
Spring Branch, TX 78070

Permit #: **111924**

Main Phone: (210) 241-0920
Work:
Cell Phone: (210) 382-1195
Alt Cell:

Agency: Comal County
County: Comal
Mfg / Brand: Advantage Wastewater LLC - Nu Water
Treatment Type: Aerobic With Chlorine System S/N: 49135
Disposal: Drip Emitters

Customer ID: 7826
Contract Dates: 12/3/2023 - 12/3/2025
Scheduled Date: 12/3/2023 Inspection 1 of 6
Installed: 9/23/2021
Warranty End: 9/23/2023

GPS Coordinates: Latitude: 29.930542 Longitude: -98.399800

Service Type: Scheduled Inspection

This counts as a type of "Scheduled Inspection"
Entered By: Trenton L Soldan

Visit Date: 12/13/2023 Time In: 10:41 Out: 10:52

Method: Grab
Technician: Alejandro Gonzalez
Maint. Provider: Rudy Carson

Aerators: Operational
Filters: Operational
Irrigation Pumps: Operational
Disinfection Device: Operational

Sludge Levels
For Tank 1: 18"
For Tank 2: 6"
For Tank 3: 0"

Floats: OP
Timer: OP

Turbidity: Good

Electric Circuits: Operational
Distribution System: Operational
Sprayfield Veg: Operational

Tank Lid / Riser: Secured

Color: Good
Odor: Good

Alarm: Operational

Comments
- Technician Secured the Tank Lid and/or Riser prior to leaving location. - Cleaned compressor filter - Scum in pretreatment is 4" -
Cleaned drip filter and back flushed drip field

Service Completed

Site: 456 Thunderhead Dr, Spring Branch, TX 78070

Provider: Rudy Carson

Technician: Alejandro Gonzalez

License Info: MP0002036 Expires: 11/30/2025

License Info: MT0000996 Expires: 1/31/2025

Block Creek Aerobic Services, LLC

444 A Old Hwy No 9
Comfort, TX 78013

(830) 995-3189

Printed:3/27/2024

Permit: 111924

Site: 456 Thunderhead Dr, Spring Branch, TX 78070

Main Phone: 2102410920

Cell Phone: 2103821195

James Chase

456 Thunderhead Dr
Spring Branch, TX 78070

Agency: Comal County

County: Comal

System Info: MFG: Advantage Wastewater LLC Brand: Nu Water Customer ID: 7826
Treatment Type: Aerobic With Chlorine Disposal Type: Drip Emitters Insp ID: 156286
Installed: 9/23/2021 Warranty Expiration: 9/23/2023 System S/N: 49135
Visit Details

Visit Date: 3/27/2024 **Entered By:** Kaleb Hernandez <----->
Scheduled Date: 4/3/2024 Time In: 1220 Contract Starts: 12/3/2023 GPS Lat: 29.930542 GPS Long: -98.399800
Entered On: 3/27/2024 Time Out: 1237 Contract Ends: 12/3/2025

Visit Results

Service Type: Scheduled Inspection

Count: Inspection 2 of 6

Method: Grab

Technician: Kaleb Hernandez

Provider: Rudy Carson

License #

MT0002671

Expires

1/31/2027

MP0002036

11/30/2025

Service Completed

Aerators: Operational
Filters: Operational
Irrigation Pumps: Operational
Disinfection Device: Operational

Sludge Level Tank 1: 6"
Sludge Level Tank 2: 18"
Sludge Level Tank 3: 0"

Turbidity: Good

Air Filter: Good

Tank Lid / Riser: Secured

Electric Circuits: Operational
Distribution System: Operational
Drip/Sprayfield Veg: Operational

Color: Good

Odor: Good

Alarm: Operational

Comments

- Scum in pretreatment is 4" - Cleaned compressor filter - Cleaned drip filter and back flushed drip field - Technician Secured the Tank Lid and/or Riser prior to leaving location.

Provider: *Rudy Carson*

Technician: Kaleb Hernandez

License: Number: MP0002036 Exp: 11/30/2025

License: Number: MT0002671 Exp: 1/31/2027

Block Creek Aerobic Services, LLC

444 A Old Hwy No 9
Comfort, TX 78013

(830) 995-3189

Printed:9/10/2024

Permit: 111924

Site: 456 Thunderhead Dr, Spring Branch, TX 78070

Main Phone: 2102410920
Cell Phone: 2103821195

James Chase

456 Thunderhead Dr
Spring Branch, TX 78070

Agency: Comal County
County: Comal

System Info: MFG: Advantage Wastewater LLC Brand: Nu Water Customer ID: 7826
Treatment Type: Aerobic With Chlorine Disposal Type: Drip Emitters Insp ID: 163158
Installed: 9/23/2021 Warranty Expiration: 9/23/2023 System S/N: 49135

Visit Details
Visit Date: 9/10/2024 **Entered By:** Nicholas R Zigalo ←-----→
GPS Lat: 29.930542 GPS Long: -98.399800
Scheduled Date: 8/3/2024 Contract Starts: 12/3/2023
Entered On: 9/10/2024 Contract Ends: 12/3/2025

Visit Results
Service Type: Scheduled Inspection
Count: Inspection 3 of 6
Method: Grab
Technician: Nicholas R Zigalo License # MT0002016 Expires 12/31/2026
Provider: Rudy Carson License # MP0002036 Expires 11/30/2025 Service Completed

Aerators: Operational **Sludge Level Tank 1:** 6
Filters: Operational **Sludge Level Tank 2:** 15
Irrigation Pumps: Operational **Sludge Level Tank 3:** 1
Disinfection Device: Operational

Floats: OP
Timer: OP

Tank Lid / Riser: Secured

Electric Circuits: Operational
Distribution System: Operational
Drip/Sprayfield Veg: Operational

Alarm: Operational

Comments
- Scum in pretreatment is 4" - Technician Secured the Tank Lid and/or Riser prior to leaving location. - Cleaned compressor filter - Cleaned drip filter and back flushed drip field

Provider: *Rudy Carson*
License: Number: MP0002036 Exp: 11/30/2025

Technician: Nicholas R Zigalo
License: Number: MT0002016 Exp: 12/31/2026