



COMAL COUNTY

ENGINEER'S OFFICE

License to Operate On-Site Sewage Treatment and Disposal Facility

Issued This Date: 12/03/2021 Permit Number: 113114

Location Description: 665 TURKEY CANYON DR
SPRING BRANCH, TX 78070

Subdivision: CYPRESS LAKE GARDENS, WESTERN SKIES SECT
Unit: 0
Lot: 19
Block: 107
Acreage: 0.0000

Type of System: Aerobic
Surface Irrigation

Issued to: CONDOR CONSTRUCTION COMPANY, LLC

This license is authorization for the owner to operate and maintain a private facility at the location described in accordance to the rules and regulations for on-site sewerage facilities of Comal County, Texas, and the Texas Commission on Environmental Quality.

The license grants permission to operate the facility. It does not guarantee successful operation. It is the responsibility of the owner to maintain and operate the facility in a satisfactory manner.

Alterations to this permit including, but not limited to:

- Increase in the square feet of living area
- Increase in the number of bedrooms
- A change of use (i.e. residential to commercial)
- Relocation of system components (including the relocation of spray heads)
- Installation of landscaping
- Adding new structures to the system

may require a new permit. **It is the responsibility of the owner to apply for a new permit, if applicable.**

Inspection and licensing of a facility indicates only that the facility meets certain minimum requirements. It does not impede any governmental entity in taking the proper steps to prevent or control pollution, to abate nuisance, or to protect the public health.

This license to operate is valid for an indefinite period. The holder may transfer it to a succeeding owner, provided the

Licensing Authority
Comal County Environmental Health



ENVIRONMENTAL HEALTH INSPECTOR

OS0032485



ENVIRONMENTAL HEALTH COORDINATOR

OS0035625

Comal County Environmental Health OSSF Inspection Sheet

Installer Name: _____

OSSF Installer #: _____

1st Inspection Date: _____

2nd Inspection Date: _____

3rd Inspection Date: _____

Inspector Name: _____

Inspector Name: _____

Inspector Name: _____

Permit#:		Address:					
No.	Description	Answer	Citations	Notes	1st Insp.	2nd Insp.	3rd Insp.
1	SITE AND SOIL CONDITIONS & SETBACK DISTANCES Site and Soil Conditions Consistent with Submitted Planning Materials		285.31(a) 285.30(b)(1)(A)(iv) 285.30(b)(1)(A)(v) 285.30(b)(1)(A)(iii) 285.30(b)(1)(A)(ii) 285.30(b)(1)(A)(i)				
2	SITE AND SOIL CONDITIONS & SETBACK DISTANCES Setback Distances Meet Minimum Standards		285.91(10) 285.30(b)(4) 285.31(d)				
3	SEWER PIPE Proper Type Pipe from Structure to Disposal System (Cast Iron, Ductile Iron, Sch. 40, SDR 26)		285.32(a)(1)				
4	SEWER PIPE Slope from the Sewer to the Tank at least 1/8 Inch Per Foot		285.32(a)(3)				
5	SEWER PIPE Two Way Sanitary - Type Cleanout Properly Installed (Add. C/O Every 100' &/or 90 degree bends)		285.32(a)(5)				
6	PRETREATMENT Installed (if required) TCEQ Approved List PRETREATMENT Septic Tank(s) Meet Minimum Requirements		285.32(b)(1)(G) 285.32(b)(1)(E)(iii) 285.32(b)(1)(E)(iv) 285.32(b)(1)(F) 285.32(b)(1)(B) 285.32(b)(1)(C)(i) 285.32(b)(1)(C)(ii) 285.32(b)(1)(D) 285.32(b)(1)(E) 285.32(b)(1)(A) 285.32(b)(1)(E)(ii)(II) 285.32(b)(1)(E)(i) 285.32(b)(1)(E)(ii)(I)				
7	PRETREATMENT Grease Interceptors if required for commercial		285.34(d)				

Inspector Notes:

**Comal County Environmental Health
OSSF Inspection Sheet**

No.	Description	Answer	Citations	Notes	1st Insp.	2nd Insp.	3rd Insp.
8	SEPTIC TANK Tank(s) Clearly Marked SEPTIC TANK If Single Tank, 2 Compartments Provided with Baffle SEPTIC TANK Inlet Flowline Greater than 3" and " T " Provided on Inlet and Outlet SEPTIC TANK Septic Tank(s) Meet Minimum Requirements		285.32(b)(1) (E)285.91(2)285.32(b)(1) (F)285.32(b)(1)(E) (iii)285.32(b)(1)(E)(ii) (II)285.32(b)(1)(E)(ii) (I)285.32(b)(1)(E) (i)285.32(b)(1) (D)285.32(b)(1)(C) (ii)285.32(b)(1)(C) (i)285.32(b)(1) (B)285.32(b)(1) (A)285.32(b)(1)(E)(iv)				
9	ALL TANKS Installed on 4" Sand Cushion/ Proper Backfill Used		285.32(b)(1)(F) 285.32(b)(1)(G) 285.34(b)				
10	SEPTIC TANK Inspection / Clean Out Port & Risers Provided on Tanks Buried Greater than 12" Sealed and Capped		285.38(d)				
11	SEPTIC TANK Secondary restraint system provided SEPTIC TANK Riser permanently fastened to lid or cast into tank SEPTIC TANK Riser cap protected against unauthorized intrusions		285.38(d) 285.38(e)				
12	SEPTIC TANK Tank Volume Installed						
13	PUMP TANK Volume Installed						
14	AEROBIC TREATMENT UNIT Size Installed						
15	AEROBIC TREATMENT UNIT Manufacturer AEROBIC TREATMENT UNIT Model Number						
16	DISPOSAL SYSTEM Absorptive		285.33(a)(4) 285.33(a)(1) 285.33(a)(2) 285.33(a)(3)				
17	DISPOSAL SYSTEM Leaching Chamber		285.33(a)(1) 285.33(a)(3) 285.33(a)(4) 285.33(a)(2)				
18	DISPOSAL SYSTEM Evapo-transpirative		285.33(a)(3) 285.33(a)(4) 285.33(a)(1) 285.33(a)(2)				

**Comal County Environmental Health
OSSF Inspection Sheet**

No.	Description	Answer	Citations	Notes	1st Insp.	2nd Insp.	3rd Insp.
19	DISPOSAL SYSTEM Drip Irrigation		285.33(c)(3)(A)-(F)				
20	DISPOSAL SYSTEM Soil Substitution		285.33(d)(4)				
21	DISPOSAL SYSTEM Pumped Effluent		285.33(a)(4) 285.33(a)(3) 285.33(a)(1) 285.33(a)(2)				
22	DISPOSAL SYSTEM Gravelless Pipe		285.33(a)(3) 285.33(a)(2) 285.33(a)(4) 285.33(a)(1)				
23	DISPOSAL SYSTEM Mound		285.33(a)(3) 285.33(a)(1) 285.33(a)(2) 285.33(a)(4)				
24	DISPOSAL SYSTEM Other (describe) (Approved Design)		285.33(d)(6) 285.33(c)(4)				
25	DRAINFIELD Absorptive Drainline 3" PVC or 4" PVC						
26	DRAINFIELD Area Installed						
27	DRAINFIELD Level to within 1 inch per 25 feet and within 3 inches over entire excavation		285.33(b)(1)(A)(v)				
28	DRAINFIELD Excavation Width DRAINFIELD Excavation Depth DRAINFIELD Excavation Separation DRAINFIELD Depth of Porous Media DRAINFIELD Type of Porous Media						
29	DRAINFIELD Pipe and Gravel - Geotextile Fabric in Place		285.33(b)(1)(E)				
30	DRAINFIELD Leaching Chambers DRAINFIELD Chambers - Open End Plates w/Splash Plate, Inspection Port & Closed End Plates in Place (per manufacturers spec.)		285.33(c)(2)				
31	LOW PRESSURE DISPOSAL SYSTEM Adequate Trench Length & Width, and Adequate Separation Distance between Trenches		285.33(d)(1)(C)(i)				

**Comal County Environmental Health
OSSF Inspection Sheet**

No.	Description	Answer	Citations	Notes	1st Insp.	2nd Insp.	3rd Insp.
32	EFFLUENT DISPOSAL SYSTEM Utilized Only by Single Family Dwelling EFFLUENT DISPOSAL SYSTEM Topographic Slopes < 2.0% EFFLUENT DISPOSAL SYSTEM Adequate Length of Drain Field (1000 Linear ft. for 2 bedrooms or Less & an additional 400 ft. for each additional bedroom) EFFLUENT DISPOSAL SYSTEM Lateral Depth of 18 inches to 3 ft. & Vertical Separation of 1ft on bottom and 2 ft. to restrictive horizon and ground water respectfully EFFLUENT DISPOSAL SYSTEM Lateral Drain Pipe (1.25 - 1.5" dia.) & Pipe Holes (3/16 - 1/4" dia. Hole Size) 5 ft. Apart		285.33(b)(3)(A) 285.33(b)(3)(A) 285.33(b)(3) (B)285.91(13) 285.33(b)(3)(D) 285.33(b)(3)(F)				
33	AEROBIC TREATMENT UNIT Is Aerobic Unit Installed According to Approved Guidelines.		285.32(c)(1)				
34	AEROBIC TREATMENT UNIT Inspection/Clean Out Port & Risers Provided AEROBIC TREATMENT UNIT Secondary restraint system provided AEROBIC TREATMENT UNIT Riser permanently fastened to lid or cast into tank AEROBIC TREATMENT UNIT Riser cap protected against unauthorized intrusions						
35	AEROBIC TREATMENT UNIT Chlorinator Properly Installed with Chlorine Tablets in Place.						
36	PUMP TANK Is the Pump Tank an approved concrete tank or other acceptable materials & construction PUMP TANK Sampling Port Provided in the Treated Effluent Line PUMP TANK Check Valve and/or Anti- Siphon Device Present When Required PUMP TANK Audible and Visual High Water Alarm Installed on Separate Circuit From Pump						
37	PUMP TANK Inspection/Clean Out Port & Risers Provided PUMP TANK Secondary restraint system provided PUMP TANK Riser permanently fastened to lid or cast into tank PUMP TANK Riser cap protected against unauthorized intrusions						
38	PUMP TANK Secondary restraint system provided						
39	PUMP TANK Electrical Connections in Approved Junction Boxes / Wiring Buried						

**Comal County Environmental Health
OSSF Inspection Sheet**

No.	Description	Answer	Citations	Notes	1st Insp.	2nd Insp.	3rd Insp.
40	APPLICATION AREA Distribution Pipe, Fitting, Sprinkler Heads & Valve Covers Color Coded Purple?		285.33(d)(2)(G)(iii)(II) 285.33(d)(2)(G)(iii)(III) 285.33(d)(2)(G)(v) 285.33(d)(2)(G)(iii) 285.33(d)(2)(G)(iv) 285.33(d)(2)(G)(i) 285.33(d)(2)(G)(ii) 285.33(d)(2)(G)(iii)(I)				
41	APPLICATION AREA Low Angle Nozzles Used / Pressure is as required APPLICATION AREA Acceptable Area, nothing within 10 ft of sprinkler heads? APPLICATION AREA The Landscape Plan is as Designed		285.33(d)(2)(G) (i)285.33(d)(2) (A)285.33(d)(2)(F)				
42	APPLICATION AREA Area Installed						
43	PUMP TANK Meets Minimum Reserve Capacity Requirements						
44	PUMP TANK Material Type & Manufacturer						
45	PUMP TANK Type/Size of Pump Installed						



COMAL COUNTY

ENGINEER'S OFFICE

Permit of Authorization to Construct an On-Site Sewage Facility Permit Valid For One Year From Date Issued

Permit Number: 113114
Issued This Date: 08/26/2021
This permit is hereby given to: CONDOR CONSTRUCTION COMPANY, LLC

To start construction of a private, on-site sewage facility located at:

665 TURKEY CANYON DR
SPRING BRANCH, TX 78070

Subdivision: CYPRESS LAKE GARDENS, WESTERN SKIES SECT
Unit: 0
Lot: 19
Block: 107
Acreage: 0.0000

APPROVED MINIMUM SIZES AS PER ATTACHED DESIGN

Type of System: Aerobic
Surface Irrigation

This permit gives permission for the construction of the above referenced on-site facility to commence. Installation must be completed by an installer holding a valid registration card from the Texas Commission on Environmental Quality (TCEQ). Installation and inspection must comply with current TCEQ and Comal County requirements.

Call (830) 608-2090 to schedule inspections.

RECEIVED

By KG at 2:24 pm, Aug 19, 2021



COMAL COUNTY
ENGINEER'S OFFICE

**OSSF DEVELOPMENT APPLICATION
CHECKLIST**

Staff will complete shaded items

		113114
<i>Date Received</i>	<i>Initials</i>	<i>Permit Number</i>

Instructions:

Place a check mark next to all items that apply. For items that do not apply, place "N/A". This OSSF Development Application Checklist **must** accompany the completed application.

OSSF Permit

- Completed Application for Permit for Authorization to Construct an On-Site Sewage Facility and License to Operate
- Site/Soil Evaluation Completed by a Certified Site Evaluator or a Professional Engineer
- Planning Materials of the OSSF as Required by the TCEQ Rules for OSSF Chapter 285. Planning Materials shall consist of a scaled design and all system specifications.
- Required Permit Fee - See Attached Fee Schedule
- Copy of Recorded Deed
- Surface Application/Aerobic Treatment System
- Recorded Certification of OSSF Requiring Maintenance/Affidavit to the Public
- Signed Maintenance Contract with Effective Date as Issuance of License to Operate

I affirm that I have provided all information required for my OSSF Development Application and that this application constitutes a completed OSSF Development Application.

Signature of Applicant

Date

___ COMPLETE APPLICATION Check No. _____ Receipt No. _____

INCOMPLETE APPLICATION (Missing Items Circled, Application Refused)
--

RECEIVED

By KG at 2:24 pm, Aug 19, 2021



COMAL COUNTY
ENGINEER'S OFFICE

ON-SITE SEWAGE FACILITY APPLICATION

195 DAVID JONAS DR
NEW BRAUNFELS, TX 78132
(830) 608-2090
WWW.CCEO.ORG

Date July 15, 2021

Permit Number 113114

1. APPLICANT / AGENT INFORMATION

Owner Name CONDOR CONSTRUCTION COMPANY, LLC
Mailing Address PO BOX 1905
City, State, Zip SAN MARCOS TEXAS 78667
Phone # 956-792-6845
Email sophie@hccastitas.com

Agent Name GREG JOHNSON, P.E.
Agent Address 170 HOLLOW OAK
City, State, Zip NEW BRAUNFELS TEXAS 78132
Phone # 830-905-2778
Email gregjohnsonpe@yahoo.com

2. LOCATION

Subdivision Name CYPRESS LAKE GARDENS WESTERN SKIES SECTION Unit _____ Lot 19 Block 107
Survey Name / Abstract Number _____ Acreage _____
Address 665 TURKEY CANYON DRIVE City SPRING BRANCH State TX Zip 78070

3. TYPE OF DEVELOPMENT

Single Family Residential

Type of Construction (House, Mobile, RV, Etc.) HOUSE

Number of Bedrooms 3

Indicate Sq Ft of Living Area 1320

Non-Single Family Residential

(Planning materials must show adequate land area for doubling the required land needed for treatment units and disposal area)

Type of Facility _____

Offices, Factories, Churches, Schools, Parks, Etc. - Indicate Number Of Occupants _____

Restaurants, Lounges, Theaters - Indicate Number of Seats _____

Hotel, Motel, Hospital, Nursing Home - Indicate Number of Beds _____

Travel Trailer/RV Parks - Indicate Number of Spaces _____

Miscellaneous _____

Estimated Cost of Construction: \$ 250,000 (Structure Only)

Is any portion of the proposed OSSF located in the United States Army Corps of Engineers (USACE) flowage easement?

Yes No (If yes, owner must provide approval from USACE for proposed OSSF improvements within the USACE flowage easement)

Source of Water Public Private Well Rainwater Collection

4. SIGNATURE OF OWNER

By signing this application, I certify that:

- The completed application and all additional information submitted does not contain any false information and does not conceal any material facts. I certify that I am the property owner or I possess the appropriate land rights necessary to make the permitted improvements on said property.
- Authorization is hereby given to the permitting authority and designated agents to enter upon the above described property for the purpose of site/soil evaluation and inspection of private sewage facilities..
- I understand that a permit of authorization to construct will not be issued until the Floodplain Administrator has performed the reviews required by the Comal County Flood Damage Prevention Order.
- I affirmatively consent to the online posting/public release of my e-mail address associated with this permit application, as applicable.

Signature of Owner

Date 8.9.2021

COMAL COUNTY OFFICE OF ENVIRONMENTAL HEALTH * * *

APPLICATION FOR PERMIT FOR AUTHORIZATION TO CONSTRUCT AN ON-SITE SEWAGE FACILITY AND LICENSE TO OPERATE

Planning Materials & Site Evaluation as Required Completed By GREG W. JOHNSON, P.E.

System Description PROPRIETARY; AEROBIC TREATMENT AND SURFACE IRRIGATION

Size of Septic System Required Based on Planning Materials & Soil Evaluation

Tank Size(s) (Gallons) NUWATER B-550-PC Absorption/Application Area (Sq Ft) 4061

Gallons Per Day (As Per TCEQ Table III) 240

(Sites generating more than 5000 gallons per day are required to obtain a permit through TCEQ)

Is the property located over the Edwards Recharge Zone? [] Yes [X] No

(If yes, the planning materials must be completed by a Registered Sanitarian (R.S.) or Professional Engineer (P.E.))

Is there an existing TCEQ approved WPAP for the property? [] Yes [X] No

(if yes, the R. S. or P. E. shall certify that the OSSF design complies with all provisions of the existing WPAP.)

If there is no existing WPAP, does the proposed development activity require a TCEQ approved WPAP? [] Yes [] No

(If yes, the R.S. or P. E. shall certify that the OSSF design will comply with all provisions of the proposed WPAP. A Permit to Construct will not be issued for the proposed OSSF until the proposed WPAP has been approved by the appropriate regional office.)

Is the property located over the Edwards Contributing Zone? [X] Yes [] No

Is there an existing TCEQ approval CZP for the property? [] Yes [X] No

(if yes, the P.E. or R.S. shall certify that the OSSF design complies with all provisions of the existing CZP)

If there is no existing CZP, does the proposed development activity require a TCEQ approved CZP? [] Yes [X] No

(if yes, the P.E. or R.S. shall certify that the OSSF design will comply with all provisions of the proposed CZP. A Permit to construct will not be issued for the proposed OSSF until the CZP has been approved by the appropriate regional office.)

Is this property within an incorporated city? [] Yes [X] No

If yes, indicate the city:

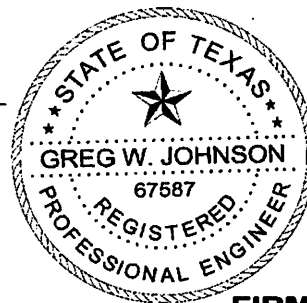

FIRM #2585

By signing this application, I certify that:

- The information provided above is true and correct to the best of my knowledge.
- I affirmatively consent to the online posting/public release of my e-mail address associated with this permit application, as applicable

Signature of Designer (handwritten signature)

Date August 5, 2021

AFFIDAVIT

**THE COUNTY OF COMAL
STATE OF TEXAS**

CERTIFICATION OF OSSF REQUIRING MAINTENANCE

According to Texas Commission on Environmental Quality Rules for On-Site Sewage Facilities (OSSF's), this document is filed in the Deed Records of Comal County, Texas.

I

The Texas Health and Safety Code, Chapter 366 authorizes the Texas Commission on Environmental Quality (TCEQ) to regulate on-site sewage facilities (OSSFs). Additionally, the Texas Water Code (TWC), § 5.012 and § 5.013, gives the commission primary responsibility for implementing the laws of the State of Texas relating to water and adopting rules necessary to carry out its powers and duties under the TWC. The commission, under the authority of the TWC and the Texas Health and Safety code, requires owner's to provide notice to the public that certain types of OSSFs are located on specific pieces of property. To achieve this notice, the commission requires a recorded affidavit. Additionally, the owner must provide proof of the recording to the OSSF permitting authority. This recorded affidavit is not a representation or warranty by the commission of the suitability of this OSSF, nor does it constitute any guarantee by the commission that the appropriate OSSF was installed.

II

An OSSF requiring a maintenance contract, according to 30 Texas Administrative Code §285.91(12) will be installed on the property described as (insert legal description):

UNIT/PHASE/SECTION 107 BLOCK 19 LOT CYPRESS LAKE GARDENS, WESTERN SKIES SECTION SUBDIVISION

IF NOT IN SUBDIVISION: _____ ACREAGE _____ SURVEY

The property is owned by (insert owner's full name): CONDOR CONSTRUCTION COMPANY, LLC,
a Texas limited liability company

This OSSF must be covered by a continuous maintenance contract for the first two years. After the initial two-year service policy, the owner of an aerobic treatment system for a single family residence shall either obtain a maintenance contract within 30 days or maintain the system personally.

Upon sale or transfer of the above-described property, the permit for the OSSF shall be transferred to the buyer or new owner. A copy of the planning materials for the OSSF can be obtained from the Comal County Engineer's Office.

WITNESS BY HAND(S) ON THIS 9 DAY OF AUGUST, 2021

X [Signature]
Owner(s) signature(s)

Sophie Campbell Manager
Owner (s) Printed name (s)

SOPHIE CAMPBELL SWORN TO AND SUBSCRIBED BEFORE ME ON THIS 9 DAY OF AUGUST, 2021

[Signature]
Notary Public Signature

Filed and Recorded
Official Public Records
Bobbie Koepf, County Clerk
Comal County, Texas
08/19/2021 11:33:42 AM
CSCHUL 1 Pages(s)
202106043870

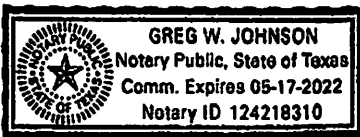

 Bobbie Koepf

WASTEWATER TREATMENT FACILITY MONITORING AGREEMENT

Regulatory Authority COMAL
Block Creek Aerobic Services, LLC
444 A Old Hwy #9
Comfort, TX 78013
Off. (830) 995-3189
Fax. (830) 995-4051

Permit/License Number _____
Customer CONDOR CONSTRUCTION COMPANY, LLC
Site Address 665 TURKEY CANYON
City SPRING BRANCH Zip 78070
Mailing Address P.O. BOX 1905, SAN MARCOS, TX 78667
County COMAL Map # CCEO PG15 F4
Phone 956-792-6845
Email sophie@hccasitas.com

2 YEAR CONTRACT
2 YEAR WARRANTY ON PARTS AND LABOR

SUBDIVISION/LEGAL: CYPRESS LAKE GARDENS -
WESTERN SKIES SECTION, BLOCK 107, LOT 19

I. General: This Work for Hire Agreement (hereinafter referred to as "Agreement") is entered into by and between CONDOR CONSTRUCTION COMPANY, LLC (hereinafter referred to as "Customer") and Block Creek Aerobic Services, LLC. By this agreement, Block Creek Aerobic Services, LLC and its employees (hereinafter inclusively referred to as "Contractor") agree to render services at the site address stated above, as described herein, and the Customer agrees to fulfill his/her/their responsibilities, as described herein.

II. Effective Date:

This Agreement commences on LTO and ends on _____ for a total of two (2) years (initial agreement) or one (1) year (thereafter). If this is an initial agreement (new installation), the Customer shall notify the Contractor within two (2) business days of the system's first use to establish the date of commencement. If no notification is received by Contractor within ninety (90) days after completion of installation or where county authority mandates, the date of commencement will be the date the "License to operate" (Notice of Approval) was issued by the permitting authority. This agreement may or may not commence at the same time as any warranty period of installed equipment, but in no case shall it extend the specified warranty.

III. Termination of Agreement:

This Agreement may be terminated by either party for any reason, including for example, substantial failure of either party to perform in accordance with the terms of this Agreement, without fault or liability of the terminating party. The terminating party must provide written notice to the non-terminating party thirty (30) days prior to the termination of this Agreement. If this Agreement is terminated, Contractor will be paid at the rate of \$75.00 per hour for any work performed and for which compensation has not been received. After the deduction of all outstanding charges, any remaining monies from prepayment for services will be refunded to customer within thirty (30) days of termination of this Agreement. Either party terminating this Agreement for any reason, including non-renewal, shall notify in writing the equipment manufacturer and the appropriate regulatory agency a minimum of thirty (30) days prior to the date of such termination. Nonpayment of any kind shall be considered breach of contract and a termination of contract.

IV. Services:

Contractor will:

- a. Inspect and perform routine upkeep on the On-Site Sewage Facility (hereinafter referred to as OSSF) as recommended by the treatment system manufacturer, and required by state and/or local regulation, for a total of three visits to site per year. The list of items checked at each visit shall be the: control panel, Electrical circuits, timer, Aeration including compressor and diffusers, CFM/PSI measured, lids safety pans, pump, compressor, sludge levels, and anything else required as per the manufacturer.
- b. Provide a written record of visits to the site by means of an inspection tag attached to or contained in the control panel.
- c. Repair or replace, if Contractor has the necessary materials at site, any component of the OSSF found to be failing or inoperative during the course of a routine monitoring visit. If such services are not covered by warranty, and the service(s) cost less than \$100.00, Customer hereby authorizes Contractor to perform the service(s) and bill Customer for said service(s). When service costs are greater than \$100.00, or if contractor does not have the necessary supplies at the site, Contractor will notify Customer of the required service(s) and the associated cost(s). Customer must notify Contractor of arrangements to affect repair of system with in two (2) business days after said notification.
- d. Provide sample collection and laboratory testing of TSS and BOD on a yearly basis (commercial systems only).
- e. Forward copies of this Agreement and all reports to the regulatory agency and the Customer.

Customer's Initials



BS

Contractor's Initials

f. Visit site in response to Customer's request for unscheduled services within forty-eight (48) hours of the date of notification (weekends and holidays excluded) of said request. Unless otherwise covered by warranty, costs for such unscheduled responses will be billed to Customer.

V. Disinfection:

Not required; _____ required. The responsibility to maintain the disinfection device(s) and provide any necessary chemicals is that of the Customer.

VI. Electronic Monitoring:

Electronic Monitoring is not included in this Agreement.

VII. Performance of Agreement:

Commencement of performance by Contractor under this Agreement is contingent on the following conditions:

a. If this is an initial Agreement (new installation):

1. Contractor's receipt of a fully executed original copy or facsimile of this agreement and all documentation requested by Contractor.

If the above conditions are not met, Contractor is not obligated to perform any portion of this Agreement.

VIII. Customer's Responsibilities:

The customer is responsible for each and all of the following:

a. Provide all necessary yard or lawn maintenance and removal of all obstacles, including but not limited to dogs and other animals, vehicles, trees, brush, trash, or debris, as needed to allow the OSSF to function properly, and to allow Contractor safe and easy access to all parts of the OSSF.

b. Protect equipment from physical damage including but not limited to that damage caused by insects.

c. Maintain a current license to operate, and abide by the conditions and limitations of that license, and all requirements for and OSSF from the State and/or local regulatory agency, whichever requirements are more stringent, as well as the proprietary system's manufacturer recommendations.

d. Notify Contractor immediately of any and all alarms, and/or any and all problems with, including failure of, the OSSF.

e. Provide, upon request by Contractor, water usage records for the OSSF so that the Contractor can perform a proper evaluation of the performance of the OSSF.

f. Allow for samples at both the inlet and outlet of the OSSF to be obtained by Contractor for the purpose of evaluating the OSSF's performance. If these samples are taken to a laboratory for testing, with the exception of the service provided under Section IV (d) above, Customer agrees to pay Contractor for the sample collection and transportation, portal to portal, at a rate of \$35.00 per hour, plus the associated fees for laboratory testing.

g. Prevent the backwash or flushing of water treatment or conditioning equipment from entering the OSSF.

h. Prevent the condensation from air conditioning or refrigeration units, or the drains of icemakers, from hydraulically overloading the aerobic treatment units. Drain lines may discharge into the surface application pump tank if approved by system designer.

i. Provide for pumping and cleaning of tanks and treatment units, when and as recommended by Contractor, at Customer's expense.

j. Maintain site drainage to prevent adverse effects on the OSSF.

k. Pay promptly and fully, all Contractor's fees, bills, or invoices as described herein.

IX. Access by Contractor:

Contractor is hereby granted an easement to the OSSF for the purpose of performing services described herein. Contractor may enter the property during Contractor's normal business hours and/or other reasonable hours without prior notice to Customer to perform the Services and/or repairs described herein. Contractor shall have access to the OSSF electrical and physical components. Tanks and treatment units shall be accessible by means of man ways, or risers and removable covers, for the purpose of evaluation as required by State and/or local rules and the proprietary system manufacturer. It is Customers responsibility to keep lids exposed and accessible at all times.

X. Limit of Liability:

Contractor shall not be held liable for any incidental, consequential, or special damages, or for economic loss due to expense, or for loss of profits or income, or loss of use to Customer, whether in contract tort or any other theory. In no event shall Contractor be liable in an amount exceeding the total Fee for Services amount paid by Customer under this Agreement.

XI. Indemnification:

Customer (whether one or more) shall and does hereby agree to indemnify, hold harmless and defend Contractor and each of its successors, assigns, heirs, legal representatives, devisees, employees, agents and/or counsel (collectively "Indemnitees") from and against any and all liabilities, claims, damages, losses, liens, causes of action, suits, fines, judgments and other expenses (including, but not limited to, attorneys' fees and expenses and costs of investigation), of any kind, nature or

_____ 

Customer's Initials



BS

Contractor's Initials

description, (hereinafter collectively referred to as "Liabilities") arising out of, caused by, or resulting, in whole or in part, from this Agreement.

THIS INDEMNIFICATION APPLIES EVEN IF SUCH LIABILITIES ARE CAUSED BY THE CONCURRENT OR CONTRIBUTORY NEGLIGENCE OR BY THE STRICT LIABILITY OF ANY INDEMNITEE.

Customer hereby waives its right of recourse as to any Indemnitee when Indemnification applies, and Customer shall require its insurer(s) to waive its/their right of subrogation to the extent such action is required to render such waiver of subrogation effective. Customer shall be subrogated to Indemnitees with respect to all rights Indemnitees may have against third parties with respect to matters as to which Customer provides indemnity and/or defense to Indemnitees. No Indemnification is provided to Indemnitees when the liability or loss results from (1) the sole responsibility of such Indemnitee; or, (2) the willful misconduct of such Indemnitee. Upon irrevocable acceptance of this Indemnification obligation, Customer, in its sole discretion, shall select and pay counsel to defend Indemnitees of and from any action that is subject to this Indemnification provision. Indemnitees hereby covenant not to compromise or settle any claim or cause of action for which Customer has provided Indemnification without the consent of Customer.

XII. Severability:

If any provision of the "Proposal and Contract" shall be held to be invalid or unenforceable for any reason, the remaining provisions shall continue to be valid and enforceable. If a court finds that any provision of the "Agreement" is invalid or unenforceable, but that by limiting such provision it would become valid and enforceable, then such provision shall be deemed to be written, construed, and enforced as so limited.

XIII. Fee for Services:

The Fee for Services does not include any fees for equipment, material, labor necessary for non-warranty repairs, unscheduled inspections, or Customer requested visits to the site.

XIV. Payment:

Full payment is due upon execution of this Agreement (Required of new Customer). For any other service(s) or repair(s) provided by Contractor the Customer shall pay the invoice(s) for said service(s) or repair(s) within thirty (30) days of the invoice date. The Contractor shall mail all invoices on the date of invoice. All payments not received within thirty (30) days from the invoice date will be subject to a \$29.00 late penalty and a 1.5% per month carrying charge, as well as any reasonable attorney's fees, and all collection and court costs incurred by Contractor in collection of unpaid debt(s). Contractor may terminate contract at any time for nonpayment for services. Any check returned to Contractor for any reason will be assessed a \$30.00 return check fee.

XV. Application or Transfer of payment:

The fees paid for this agreement may be transferred to subsequent property owner(s); however, this Agreement is not transferable. Customer shall advise the subsequent property owner(s) of the State requirement that they sign a replacement agreement authorizing Contractor to perform the herein described Services, and accepting Customer's Responsibilities. This replacement Agreement must be signed and received in Contractor's offices within ten (10) business days of date of transfer of property ownership. Contractor will apply all funds received from Customer first to any past due obligation arising from this Agreement including late fees or penalties, return check fees, and/or charges for services or repairs not paid within thirty (30) days of invoice date. Any remaining monies shall be applied to the funding of the replacement Agreement. The consumption of funds in this manner may cause a reduction in the termination date of effective coverage per this Agreement. See Section IV.

XVI. Entire Agreement:

This agreement contains the entire Agreement of the parties, and there are no other conditions in any other agreement, oral or written.

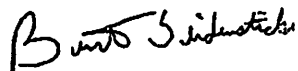
Block Creek Aerobic Services, LLC,
Contractor
MC# 0000042 and MC#0000002

Customer's Initials

Customer Signature

8.9.2024
Date



BS

Contractor's Initials

Greg W. Johnson, P.E.
170 Hollow Oak
New Braunfels, Texas 78132
830/905-2778

August 5, 2021

Comal County Office of Environmental Health
195 David Jonas Drive
New Braunfels, Texas 78132-3760

RE- Septic Design
665 TURKEY CANYON DRIVE
CYPRESS LAKE GARDENS - WESTERN SKIES
SECTION, BLK 107, LOT 19
SPRING BRANCH, TX 78070
CONDOR CONSTRUCTION COMPANY, LLC

Ms. Ritzen/Gros,

Due to the lack of available application area it is necessary to have the setback from the property line to the spray at ten feet as required by TCEQ Chapter 285 rules Table X. I hereby request a variance to the twenty foot setback to property lines as required by Comal County Order and equivalent protection will be maintained by including a battery backup to the timer clock to assure sprayers to only spray during the predawn hours. In my professional opinion this variance will not pose a threat to the environment or public health.

If I can be of further assistance please contact me.

Respectfully yours,

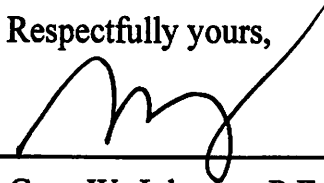

Greg W. Johnson, P.E., F#2585

August 5, 2021

Date

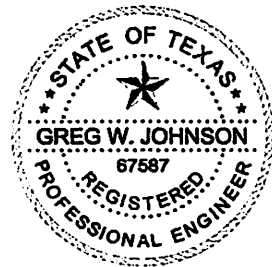

**ON-SITE SEWERAGE FACILITY
SOIL EVALUATION REPORT INFORMATION**

Date Soil Survey Performed: August 04, 2021

Site Location: CYPRESS LAKE GARDENS-WESTERN SKIES SECTION, BLOCK 107, LOT 19

Proposed Excavation Depth: N/A

Requirements:

- At least two soil excavations must be performed on the site, at opposite ends of the proposed disposal area.
- Locations of soil boring or dug pits must be shown on the site drawing.
- For subsurface disposal, soil evaluations must be performed to a depth of at least two feet below the proposed excavation depth. For surface disposal, the surface horizon must be evaluated.
- Describe each soil horizon and identify any restrictive features on the form. Indicate depths where features appear.

SOIL BORING NUMBER <u> </u> SURFACE EVALUATION <u> </u>						
Depth (Feet)	Texture Class	Soil Texture	Gravel Analysis	Drainage (Mottles/ Water Table)	Restrictive Horizon	Observations
0	IV	CLAY	N/A	NONE OBSERVED	LIMESTONE @ 6"	DRK. BROWN
1						
2						
3						
4						
5						

SOIL BORING NUMBER <u> </u> SURFACE EVALUATION <u> </u>						
Depth (Feet)	Texture Class	Soil Texture	Gravel Analysis	Drainage (Mottles/ Water Table)	Restrictive Horizon	Observations
0	SAME		AS		ABOVE	
1						
2						
3						
4						
5						

I certify that the findings of this report are based on my field observations and are accurate to the best of my ability.

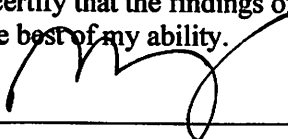

Greg W. Johnson, P.E. 67587-F2585, S.E. 11561

08/04/2021
Date

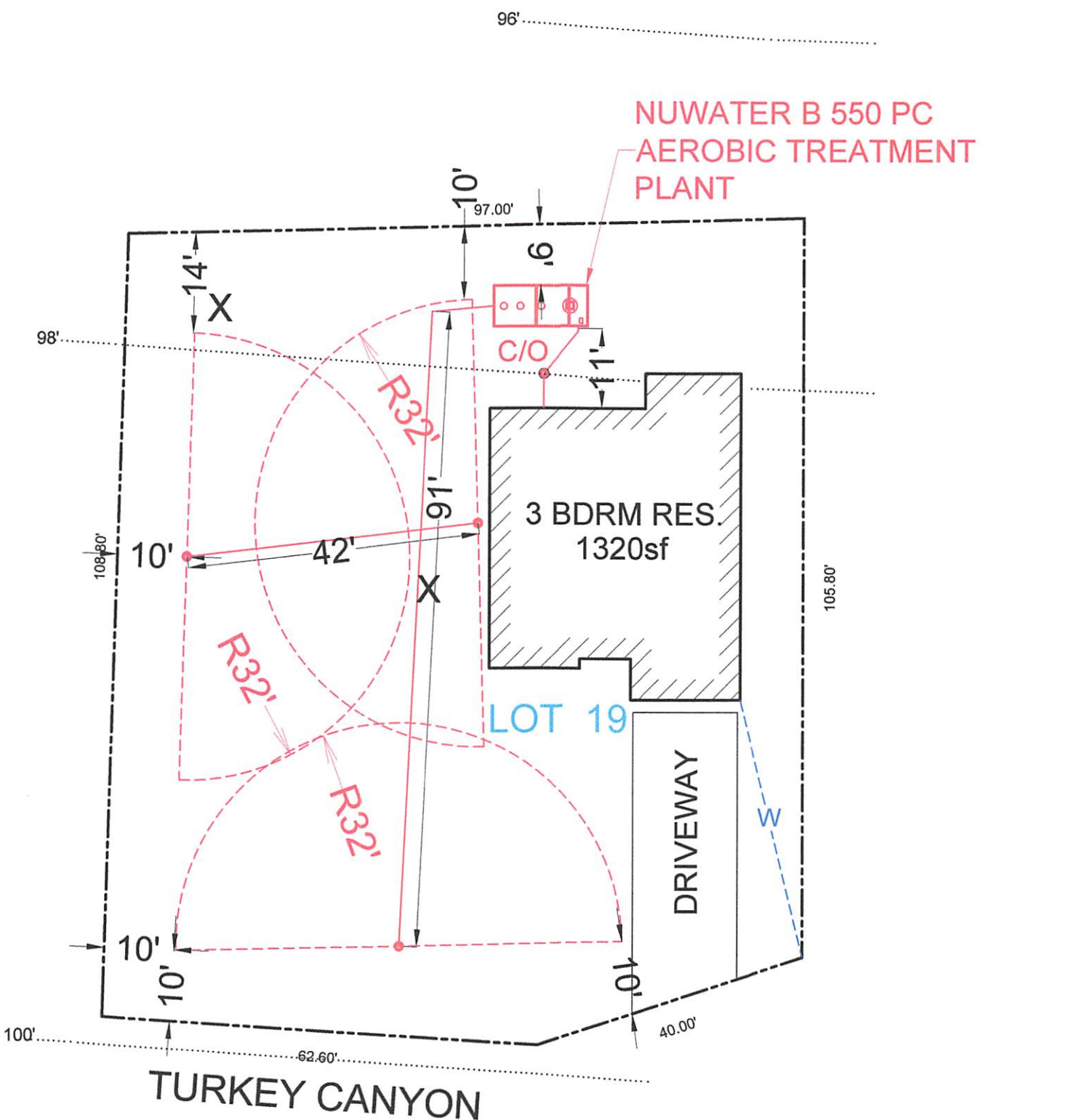

SPRAY AREA = 4061 SF
 X = TEST HOLE



OWNER: CONDOR CONSTRUCTION COMPANY, LLC.		DRAWN BY: EJS III/GWJ	
STREET ADDRESS: 665 TURKEY CANYON DRIVE			
LEGAL DESC: CYPRESS LAKE GARDENS -WESTERN SKIES SECTION	BLOCK: 107	LOT: 19	
PREPARED BY: GREG W. JOHNSON, P.E. F#002585	SCALE: 1"=20'	DATE: 8/5/2021	REVISED:

TANK NOTES:

Tanks must be set to allow a minimum of 1/8" per foot fall from the residence.

Tightlines to the tank shall be SCH-40 PVC.

A two way sanitary tee is required between residence and tank.

A minimum of 4" of sand, sandy loam, clay loam free of rock shall be placed under and around tanks

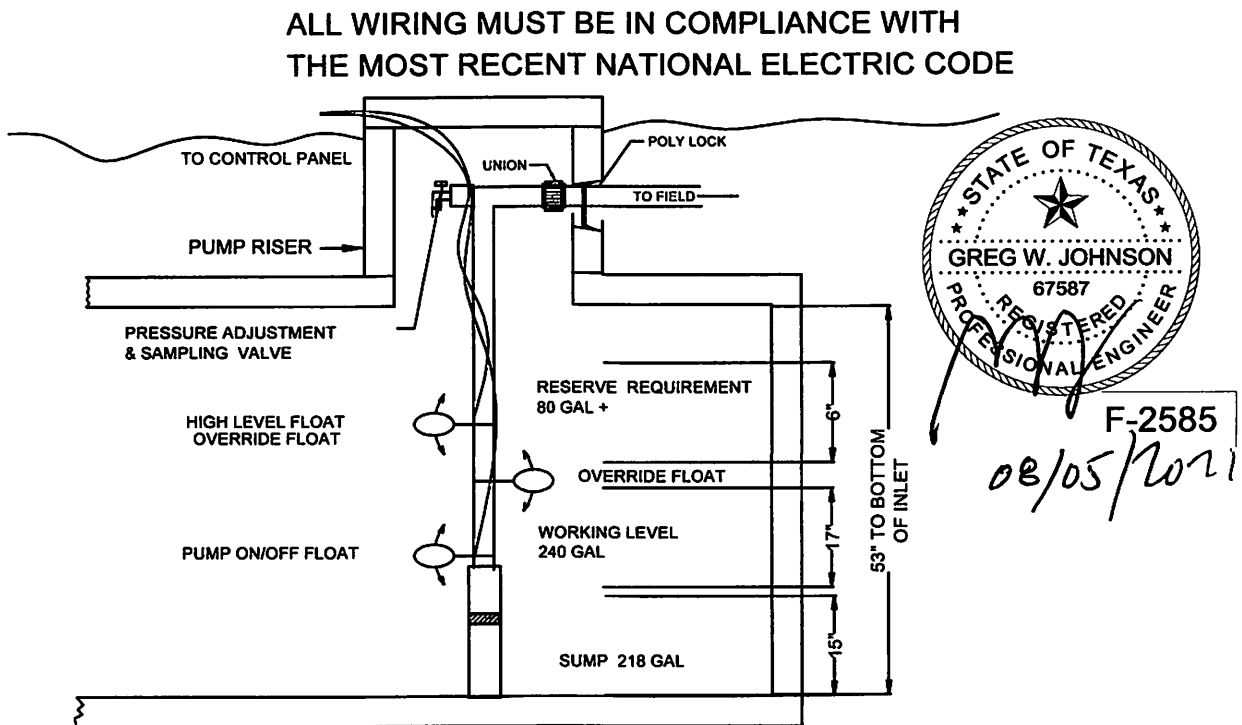

TYPICAL PUMP TANK CONFIGURATION
NU-WATER 550PC -400PT 768 GAL PUMP TANK

From: Gros,Allyse
To: ["sophie@hccasitas.com"](mailto:sophie@hccasitas.com)
Cc: ["Greg Johnson"](#)
Subject: Permit 113114 Deficiency Comment
Date: Tuesday, August 24, 2021 8:41:00 AM

RE: 665 Turkey Canyon Drive, Cypress Lake Gardens Western Skies Block 107, Lot 19

Property Owner & Agent,

We received planning materials for the referenced permit application on August 19, 2021 and found those planning materials to be deficient. In order to continue processing this permit, we need the following:

1.  The application requires the signature of the designer.
2. Revise accordingly and resubmit.

If you have any questions, you can email me or call the office.

Thank you,



Allyse N. Gros, OS0035605

Environmental Health Asst.

Comal County Engineer's Office

195 David Jonas Dr New Braunfels, TX 78132

830-608-2090 www.cceo.org

*** COMAL COUNTY OFFICE OF ENVIRONMENTAL HEALTH ***

APPLICATION FOR PERMIT FOR AUTHORIZATION TO CONSTRUCT AN ON-SITE SEWAGE FACILITY AND LICENSE TO OPERATE

Planning Materials & Site Evaluation as Required Completed By GREG W. JOHNSON, P.E.

System Description PROPRIETARY ON-SITE TREATMENT AND SURFACE IRRIGATION



Size of Septic System Required Based on Planning Materials & Soil Evaluation

Tank Size(s) (Gallons) NUWATER B-550-PC Absorption/Application Area (Sq Ft) 4061

Gallons Per Day (As Per TCEQ Table III) 240

(Sites generating more than 5000 gallons per day are required to obtain a permit through TCEQ)

Is the property located over the Edwards Recharge Zone? [] Yes [X] No

(If yes, the planning materials must be completed by a Registered Sanitarian (R.S.) or Professional Engineer (P.E.))

Is there an existing TCEQ approved WPAP for the property? [] Yes [X] No

(if yes, the R. S. or P. E. shall certify that the OSSF design complies with all provisions of the existing WPAP.)

If there is no existing WPAP, does the proposed development activity require a TCEQ approved WPAP? [] Yes [] No

(If yes, the R.S. or P. E. shall certify that the OSSF design will comply with all provisions of the proposed WPAP. A Permit to Construct will not be issued for the proposed OSSF until the proposed WPAP is approved by the appropriate regional office.)



Is the property located over the Edwards Contributing Zone? [X] Yes [] No

Is there an existing TCEQ approval CZP for the property? [] Yes [X] No

(if yes, the P.E. or R.S. shall certify that the OSSF design complies with all provisions of the existing CZP)

If there is no existing CZP, does the proposed development activity require a TCEQ approved CZP? [] Yes [X] No

(if yes, the P.E. or R.S. shall certify that the OSSF design will comply with all provisions of the proposed CZP. A Permit to construct will not be issued for the proposed OSSF until the CZP has been approved by the appropriate regional office.)

Is this property within an incorporated city? [] Yes [X] No

If yes, indicate the city: _____

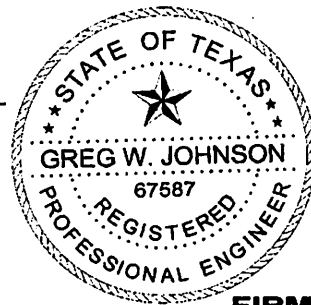

FIRM #2585



By signing this application, I certify that:

- The information provided above is true and correct to the best of my knowledge.
- I affirmatively consent to the online posting/public release of my e-mail address associated with this permit application, as applicable

Signature of Designer

Date August 5, 2021

NOTICE OF CONFIDENTIALITY RIGHTS: IF YOU ARE A NATURAL PERSON, YOU MAY REMOVE OR STRIKE ANY OR ALL OF THE FOLLOWING INFORMATION FROM ANY INSTRUMENT THAT TRANSFERS AN INTEREST IN REAL PROPERTY BEFORE IT IS FILED FOR RECORD IN THE PUBLIC RECORDS: YOUR SOCIAL SECURITY NUMBER OR YOUR DRIVER'S LICENSE NUMBER.

GENERAL WARRANTY DEED

Date: March 30, 2021

Grantor: ALIANA M. ROOD, an unmarried person

Grantor's Mailing Address: 600 William Street, Oakland, CA 94612

Grantee: CONDOR CONSTRUCTION COMPANY LLC, a Texas limited liability company

Grantee's Return Mailing Address: P.O. Box 1905, San Marcos, TX 78667

Consideration: Cash and other good and valuable consideration, the receipt and sufficiency of which are hereby acknowledged.

Property (including any improvements):

Lots 18, 19[✓] and 20[✓], Block 107, CYPRESS LAKE GARDENS WESTERN SKIES SECTION, a subdivision in Comal County, Texas, according to the map or plat thereof recorded in Volume 3, Page 18 of the Map and Plat Records, Comal County, Texas

Reservations from Conveyance: None

Exceptions to Conveyance and Warranty: This conveyance is made and accepted subject to the following matters (the "Permitted Exceptions"): (i) all easements, building set-back lines, reservations, royalties, mineral reservations, leases, restrictions, zoning ordinances and conditions as recorded with the county clerk of the county where the Property is located, to the extent applicable to and enforceable against the Property; and (ii) all matters that a correct survey of the Property would show. Ad valorem taxes with respect to the property are prorated as of this date (based on estimates, if necessary) and are not subject to readjustment. Grantee expressly assumes payment of all ad valorem taxes and special and general assessments of whatever nature applicable to the property for the year 2021 and subsequent years, as well as all special and general assessments of whatever nature applicable to the property.

Grantor, for the Consideration and subject to the Reservations from Conveyance and the Permitted Exceptions, grants, sells, and conveys to Grantee the Property, together with all and singular the rights and appurtenances thereto in any way belonging, to have and to hold it to Grantee and Grantee's heirs, successors, and assigns forever. Grantor binds Grantor and Grantor's

heirs and successors to warrant and forever defend all and singular the Property to Grantee and Grantee's heirs, successors, and assigns against every person whomsoever lawfully claiming or to claim the same or any part thereof, except as to the Reservations from Conveyance and the Exceptions to Conveyance and Warranty.

The Contract between Grantor as the Seller and Grantee as the Buyer, if any, may contain limitations as to warranty or other agreed matters; to the extent that such Contract provides for limitations or other agreed matters that will survive the closing and this conveyance, then such limitations or other agreed matters are hereby deemed incorporated by reference. The warranty of title contained in this Deed is hereby expressly excluded from the limitations or other agreed matters referenced in this paragraph.

When the context requires, singular nouns and pronouns include the plural.

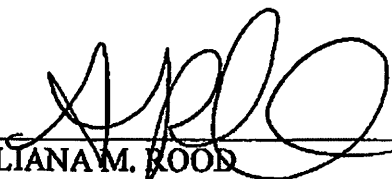
 ALIANA M. ROOD

A notary public or other officer completing this certificate verifies only the identity of the individual who signed the document, to which this certificate is attached, and not the truthfulness, accuracy, or validity of that document.

STATE OF CALIFORNIA)
) SS
 COUNTY OF ALAMEDA)

On March 30, 2021, before me, Sunil Jaswal, a Notary Public, personally appeared ALIANA M. ROOD, who proved to me on the basis of satisfactory evidence to be the person(s) whose name(s) is/are subscribed to the within instrument and acknowledged to me that he/she/they executed the same in his/her/their authorized capacity(ies), and that by his/her/their signature(s) on the instrument the person(s) or the entity upon behalf of which the person(s) acted, executed the instrument.

I certify under PENALTY OF PERJURY under the laws of the State of California that the foregoing paragraph is true and correct.

WITNESS MY HAND AND OFFICIAL SEAL.

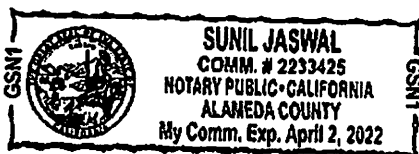

Sunil

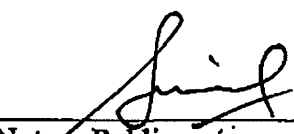
 Signature of Notary Public

Filed and Recorded
Official Public Records
Bobbie Koepf, County Clerk
Comal County, Texas
04/01/2021 09:03:41 AM
TERRI 3 Pages(s)
202106017010



Bobbie Koepf

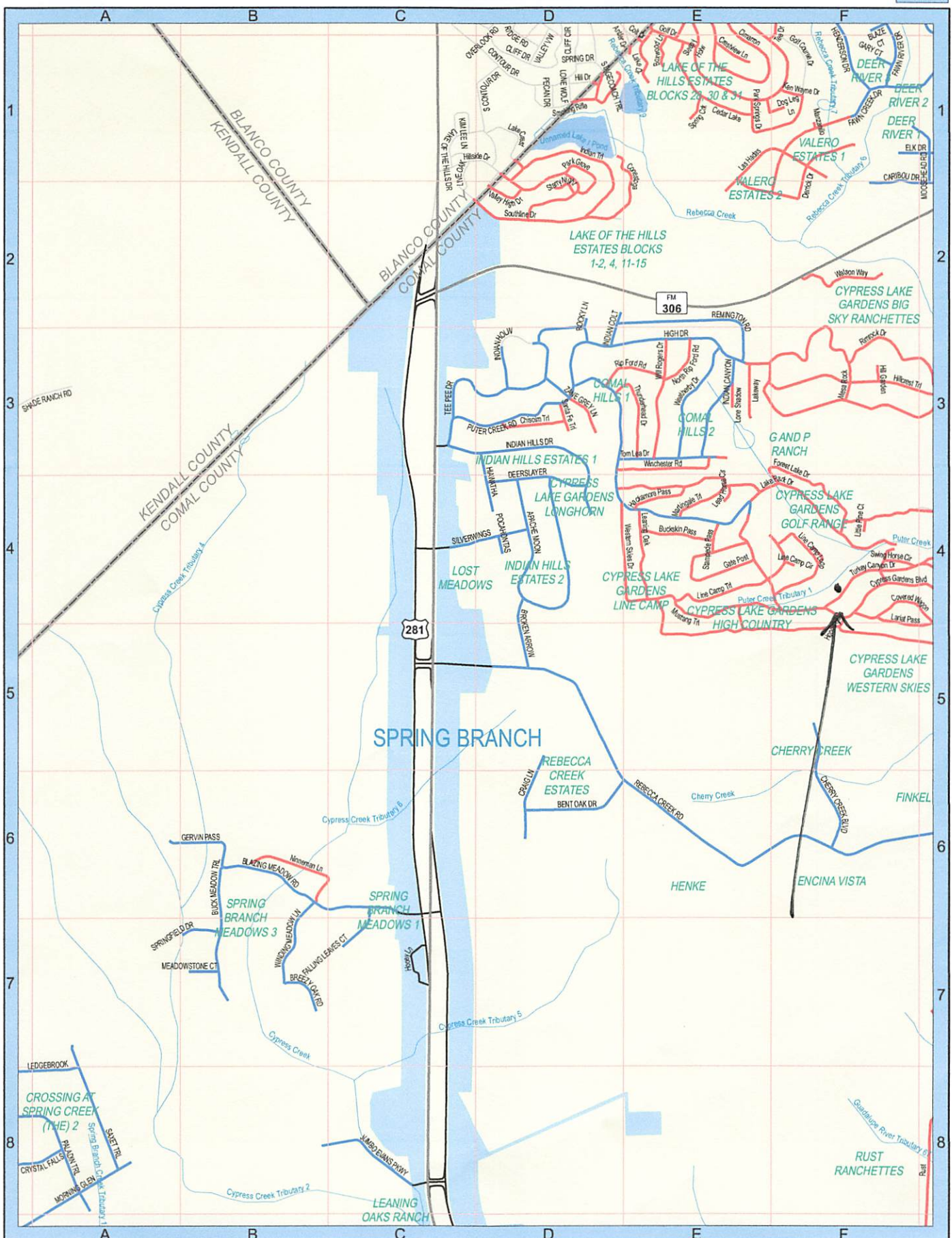

SEE PAGE 14

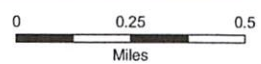
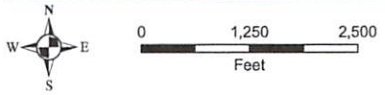

Block Creek Aerobic Services, LLC
444 A Old Hwy No 9
Comfort, TX 78013

Phone: (830) 995-3189
Fax: (830) 995-4051

To: Gustavo Gonzales
665 Turkey Canyon
Spring Branch, TX 78070

Printed: 8/15/2022
Insp ID #: 129303
Main Phone: (210) 291-5583
Work:
Cell Phone:
Alt Cell:

Permit #: **113114**
Agency: Comal County
County: Comal
Mfg / Brand: Advantage Wastewater LLC - Nu Water
Treatment Type: Aerobic With Chlorine System S/N: B50292
Disposal: Surface Application

Customer ID: 7827
Contract Dates: 12/6/2021 - 12/6/2023
Scheduled Date: 8/6/2022
Inspection 2 of 6
Installed: 10/25/2021
Warranty End: 10/25/2023
GPS Coordinates: Latitude: 29.92389 Longitude: -98.38938

Service Type: Scheduled Inspection

This counts as a type of "Scheduled Inspection"
Entered By: Trenton L Soldan

Visit Date: 8/15/2022 Time In: 1225 Out: 1245p

Method: Grab
Technician: Jose Ramos
Maint. Provider: Rudy Carson

Aerators: Operational
Filters: Operational
Irrigation Pumps: Operational
Disinfection Device: Operational
Chlorine Supply: Operational
Chlorine Residual: 0.6

Sludge Levels
For Tank 1: 15"
For Tank 2: 0"
For Tank 3: 0"

Floats: OP CFM: 3.0
Timer: OP

Electric Circuits: Operational
Distribution System: Operational
Sprayfield Veg: Operational

Tank Lid / Riser: Secured
Insp. Port / Plug: Secured

Alarm: Operational

Comments

- Technician Secured the Tank Lid and/or Riser prior to leaving location. - Inspection Port Plug was noted as Secured prior to leaving.
Cleaned compressor filter. Tank 1 scum 0.5".

Service Completed

Site: 665 Turkey Canyon, Spring Branch, TX 78070

Provider: **Rudy Carson**

Technician: Jose Ramos

License Info: MP0002036 Expires:

License Info: MT0001770 Expires: 9/1/2022

Block Creek Aerobic Services, LLC
444 A Old Hwy No 9
Comfort, TX 78013

Phone: (830) 995-3189
Fax: (830) 995-4051

To: Gustavo Gonzales
665 Turkey Canyon
Spring Branch, TX 78070

Printed: 5/6/2023
Insp ID #: 139622

Main Phone: (210) 291-5583
Work:
Cell Phone:
Alt Cell:

Permit #: **113114**

Agency: Comal County
County: Comal
Mfg / Brand: Advantage Wastewater LLC - Nu Water
Treatment Type: Aerobic With Chlorine System S/N: B50292
Disposal: Surface Application

Customer ID: 7827
Contract Dates: 12/6/2021 - 12/6/2023
Scheduled Date: 4/6/2023 Inspection 4 of 6
Installed: 10/25/2021
Warranty End: 10/25/2023
GPS Coordinates: Latitude: 29.92389 Longitude: -98.38938

Service Type: Scheduled Inspection

This counts as a type of "Scheduled Inspection"
Entered By: Noel J Aleman

Visit Date: 5/6/2023

Time In: 1237

Out: 1250

Method: Grab

Technician: Alejandro Gonzalez

Maint. Provider: Rudy Carson

Aerators: Operational

Filters: Operational

Irrigation Pumps: Operational

Disinfection Device: Operational

Chlorine Supply: Operational

Chlorine Residual: .2

Sludge Levels

For Tank 1: 6"

For Tank 2: 12"

For Tank 3: 0"

Floats: OP

Timer: OP

Electric Circuits: Operational

Distribution System: Operational

Sprayfield Veg: Operational

Tank Lid / Riser: Secured

Alarm: Operational

Comments

- Technician Secured the Tank Lid and/or Riser prior to leaving location. - Cleaned compressor filter - Scum in pretreatment is 0" bleach container is completely empty. Please add bleach.

Service Completed

Site: 665 Turkey Canyon, Spring Branch, TX 78070

Provider: **Rudy Carson**

Technician: **Alejandro Gonzalez**

License Info: MP0002036 Expires: 11/30/2025

License Info: MT0000996 Expires: 1/31/2025

Block Creek Aerobic Services, LLC
444 A Old Hwy No 9
Comfort, TX 78013

Phone: (830) 995-3189
Fax: (830) 995-4051

To: Gustavo Gonzales
665 Turkey Canyon
Spring Branch, TX 78070

Printed: 9/19/2023
Insp ID #: 145767
Main Phone: (210) 291-5583
Work:
Cell Phone:
Alt Cell:

Permit #: **113114**

Agency: Comal County

County: Comal

Mfg / Brand: Advantage Wastewater LLC - Nu Water

Treatment Type: Aerobic With Chlorine System S/N: B50292

Disposal: Surface Application

Customer ID: 7827

Contract Dates: 12/6/2021 - 12/6/2023

Scheduled Date: 8/6/2023

Inspection 5 of 6

Installed: 10/25/2021

Warranty End: 10/25/2023

GPS Coordinates: Latitude: 29.92389 Longitude: -98.38938

Service Type: Scheduled Inspection

This counts as a type of "Scheduled Inspection"

Visit Date: 9/18/2023

Time In: 2:23

Out: 2:30

Entered By: Landon Gronvold

Method: Grab

Technician: Landon Gronvold

Maint. Provider: Rudy Carson

Aerators: Operational

Filters: Operational

Irrigation Pumps: Operational

Disinfection Device: Operational

Chlorine Supply: Operational

Chlorine Residual: .7

Sludge Levels

For Tank 1: 15

For Tank 2: 0"

For Tank 3: 0"

Floats: OP

Timer: OP

Electric Circuits: Operational

Distribution System: Operational

Sprayfield Veg: Operational

Tank Lid / Riser: Secured

Alarm: Operational

Comments

- Technician Secured the Tank Lid and/or Riser prior to leaving location. - Cleaned compressor filter - Scum in pretreatment is 0" system is working good

Service Completed

Site: 665 Turkey Canyon, Spring Branch, TX 78070

Provider: Rudy Carson

Technician: Landon Gronvold

License Info: MP0002036 Expires: 11/30/2025

License Info: MT0001995 Expires: 10/31/2023

Block Creek Aerobic Services, LLC
444 A Old Hwy No 9
Comfort, TX 78013

Printed: 12/13/2023 Insp ID #: 149815

Phone: (830) 995-3189

Fax: (830) 995-4051

To: Gustavo Gonzales
665 Turkey Canyon
Spring Branch, TX 78070

Permit #: **113114**

Main Phone: (210) 291-5583

Work:

Cell Phone:

Alt Cell:

Customer ID: 7827

Contract Dates: 12/6/2021 - 12/6/2023

Scheduled Date: 12/6/2023

Inspection 5 of 6

Installed: 10/25/2021

Warranty End: 10/25/2023

Agency: Comal County

County: Comal

Mfg / Brand: Advantage Wastewater LLC - Nu Water

Treatment Type: Aerobic With Chlorine System S/N: B50292

Disposal: Surface Application

GPS Coordinates: Latitude: 29.92389 Longitude: -98.38938

Service Type: Scheduled Inspection

This counts as a type of "Scheduled Inspection"

Entered By: Trenton L Soldan

Visit Date: 12/13/2023

Time In: 12:58

Out: 1:07

Method: Grab

Technician: Alejandro Gonzalez

Maint. Provider: Rudy Carson

Aerators: Operational

Filters: Operational

Irrigation Pumps: Operational

Disinfection Device: Operational

Chlorine Supply: Operational

Chlorine Residual: .29

Sludge Levels

For Tank 1: 18"

For Tank 2: 22"

For Tank 3: 0"

Floats: OP

Timer: OP

Turbidity: Good

Electric Circuits: Operational

Distribution System: Operational

Sprayfield Veg: Operational

Tank Lid / Riser: Secured

Color: Good

Odor: Good

Alarm: Operational

Comments

- Technician Secured the Tank Lid and/or Riser prior to leaving location. - Cleaned compressor filter - Scum in pretreatment is 0"

Service Completed

Site: 665 Turkey Canyon, Spring Branch, TX 78070

Provider: **Rudy Carson**

Technician: **Alejandro Gonzalez**

License Info: MP0002036 Expires: 11/30/2025

License Info: MT0000996 Expires: 1/31/2025