

Comal County Environmental Health OSSF Inspection Sheet

Installer Name: _____

OSSF Installer #: _____

1st Inspection Date: _____

2nd Inspection Date: _____

3rd Inspection Date: _____

Inspector Name: _____

Inspector Name: _____

Inspector Name: _____

Permit#:		Address:					
No.	Description	Answer	Citations	Notes	1st Insp.	2nd Insp.	3rd Insp.
1	SITE AND SOIL CONDITIONS & SETBACK DISTANCES Site and Soil Conditions Consistent with Submitted Planning Materials		285.31(a) 285.30(b)(1)(A)(iv) 285.30(b)(1)(A)(v) 285.30(b)(1)(A)(iii) 285.30(b)(1)(A)(ii) 285.30(b)(1)(A)(i)				
2	SITE AND SOIL CONDITIONS & SETBACK DISTANCES Setback Distances Meet Minimum Standards		285.91(10) 285.30(b)(4) 285.31(d)				
3	SEWER PIPE Proper Type Pipe from Structure to Disposal System (Cast Iron, Ductile Iron, Sch. 40, SDR 26)		285.32(a)(1)				
4	SEWER PIPE Slope from the Sewer to the Tank at least 1/8 Inch Per Foot		285.32(a)(3)				
5	SEWER PIPE Two Way Sanitary - Type Cleanout Properly Installed (Add. C/O Every 100' &/or 90 degree bends)		285.32(a)(5)				
6	PRETREATMENT Installed (if required) TCEQ Approved List PRETREATMENT Septic Tank(s) Meet Minimum Requirements		285.32(b)(1)(G) 285.32(b)(1)(E)(iii) 285.32(b)(1)(E)(iv) 285.32(b)(1)(F) 285.32(b)(1)(B) 285.32(b)(1)(C)(i) 285.32(b)(1)(C)(ii) 285.32(b)(1)(D) 285.32(b)(1)(E) 285.32(b)(1)(A) 285.32(b)(1)(E)(ii)(II) 285.32(b)(1)(E)(i) 285.32(b)(1)(E)(ii)(I)				
7	PRETREATMENT Grease Interceptors if required for commercial		285.34(d)				

Inspector Notes:

**Comal County Environmental Health
OSSF Inspection Sheet**

No.	Description	Answer	Citations	Notes	1st Insp.	2nd Insp.	3rd Insp.
8	SEPTIC TANK Tank(s) Clearly Marked SEPTIC TANK If Single Tank, 2 Compartments Provided with Baffle SEPTIC TANK Inlet Flowline Greater than 3" and " T " Provided on Inlet and Outlet SEPTIC TANK Septic Tank(s) Meet Minimum Requirements		285.32(b)(1) (E)285.91(2)285.32(b)(1) (F)285.32(b)(1)(E) (iii)285.32(b)(1)(E)(ii) (II)285.32(b)(1)(E)(ii) (I)285.32(b)(1)(E) (i)285.32(b)(1) (D)285.32(b)(1)(C) (ii)285.32(b)(1)(C) (i)285.32(b)(1) (B)285.32(b)(1) (A)285.32(b)(1)(E)(iv)				
9	ALL TANKS Installed on 4" Sand Cushion/ Proper Backfill Used		285.32(b)(1)(F) 285.32(b)(1)(G) 285.34(b)				
10	SEPTIC TANK Inspection / Clean Out Port & Risers Provided on Tanks Buried Greater than 12" Sealed and Capped		285.38(d)				
11	SEPTIC TANK Secondary restraint system provided SEPTIC TANK Riser permanently fastened to lid or cast into tank SEPTIC TANK Riser cap protected against unauthorized intrusions		285.38(d) 285.38(e)				
12	SEPTIC TANK Tank Volume Installed						
13	PUMP TANK Volume Installed						
14	AEROBIC TREATMENT UNIT Size Installed						
15	AEROBIC TREATMENT UNIT Manufacturer AEROBIC TREATMENT UNIT Model Number						
16	DISPOSAL SYSTEM Absorptive		285.33(a)(4) 285.33(a)(1) 285.33(a)(2) 285.33(a)(3)				
17	DISPOSAL SYSTEM Leaching Chamber		285.33(a)(1) 285.33(a)(3) 285.33(a)(4) 285.33(a)(2)				
18	DISPOSAL SYSTEM Drip Irrigation		285.33(c)(3)(A)-(F)				

**Comal County Environmental Health
OSSF Inspection Sheet**

No.	Description	Answer	Citations	Notes	1st Insp.	2nd Insp.	3rd Insp.
32	EFFLUENT DISPOSAL SYSTEM Utilized Only by Single Family Dwelling EFFLUENT DISPOSAL SYSTEM Topographic Slopes < 2.0% EFFLUENT DISPOSAL SYSTEM Adequate Length of Drain Field (1000 Linear ft. for 2 bedrooms or Less & an additional 400 ft. for each additional bedroom) EFFLUENT DISPOSAL SYSTEM Lateral Depth of 18 inches to 3 ft. & Vertical Separation of 1ft on bottom and 2 ft. to restrictive horizon and ground water respectfully EFFLUENT DISPOSAL SYSTEM Lateral Drain Pipe (1.25 - 1.5" dia.) & Pipe Holes (3/16 - 1/4" dia. Hole Size) 5 ft. Apart		285.33(b)(3)(A) 285.33(b)(3)(A) 285.33(b)(3) (B)285.91(13) 285.33(b)(3)(D) 285.33(b)(3)(F)				
33	AEROBIC TREATMENT UNIT Is Aerobic Unit Installed According to Approved Guidelines.		285.32(c)(1)				
34	AEROBIC TREATMENT UNIT Inspection/Clean Out Port & Risers Provided AEROBIC TREATMENT UNIT Secondary restraint system provided AEROBIC TREATMENT UNIT Riser permanently fastened to lid or cast into tank AEROBIC TREATMENT UNIT Riser cap protected against unauthorized intrusions						
35	AEROBIC TREATMENT UNIT Chlorinator Properly Installed with Chlorine Tablets in Place.						
36	PUMP TANK Is the Pump Tank an approved concrete tank or other acceptable materials & construction PUMP TANK Sampling Port Provided in the Treated Effluent Line PUMP TANK Check Valve and/or Anti- Siphon Device Present When Required PUMP TANK Audible and Visual High Water Alarm Installed on Separate Circuit From Pump						
37	PUMP TANK Inspection/Clean Out Port & Risers Provided PUMP TANK Secondary restraint system provided PUMP TANK Riser permanently fastened to lid or cast into tank PUMP TANK Riser cap protected against unauthorized intrusions						
38	PUMP TANK Secondary restraint system provided						
39	PUMP TANK Electrical Connections in Approved Junction Boxes / Wiring Buried						

**Comal County Environmental Health
OSSF Inspection Sheet**

No.	Description	Answer	Citations	Notes	1st Insp.	2nd Insp.	3rd Insp.
40	APPLICATION AREA Distribution Pipe, Fitting, Sprinkler Heads & Valve Covers Color Coded Purple?		285.33(d)(2)(G)(iii)(II) 285.33(d)(2)(G)(iii)(III) 285.33(d)(2)(G)(v) 285.33(d)(2)(G)(iii) 285.33(d)(2)(G)(iv) 285.33(d)(2)(G)(i) 285.33(d)(2)(G)(ii) 285.33(d)(2)(G)(iii)(I)				
41	APPLICATION AREA Low Angle Nozzles Used / Pressure is as required APPLICATION AREA Acceptable Area, nothing within 10 ft of sprinkler heads? APPLICATION AREA The Landscape Plan is as Designed		285.33(d)(2)(G) (i)285.33(d)(2) (A)285.33(d)(2)(F)				
42	APPLICATION AREA Area Installed						
43	PUMP TANK Meets Minimum Reserve Capacity Requirements						
44	PUMP TANK Material Type & Manufacturer						
45	PUMP TANK Type/Size of Pump Installed						



COMAL COUNTY

ENGINEER'S OFFICE

Permit of Authorization to Construct an On-Site Sewage Facility Permit Valid For One Year From Date Issued

Permit Number: 113741
Issued This Date: 12/09/2021
This permit is hereby given to: NORRIS J. DEVOLL

To start construction of a private, on-site sewage facility located at:

552 CLOUD TOP
CANYON LAKE, TX 78133

Subdivision: SCENIC HEIGHTS
Unit: 2
Lot: 531R
Block: 0
Acreage: 0.0000

APPROVED MINIMUM SIZES AS PER ATTACHED DESIGN

Type of System: Aerobic
Drip Irrigation

This permit gives permission for the construction of the above referenced on-site facility to commence. Installation must be completed by an installer holding a valid registration card from the Texas Commission on Environmental Quality (TCEQ). Installation and inspection must comply with current TCEQ and Comal County requirements.

Call (830) 608-2090 to schedule inspections.

RECEIVED

By KG at 9:59 am, Dec 08, 2021



COMAL COUNTY
ENGINEER'S OFFICE

**OSSF DEVELOPMENT APPLICATION
CHECKLIST**

Staff will complete shaded items

--	--

Date Received

Initials

113741

Permit Number

Instructions:

Place a check mark next to all items that apply. For items that do not apply, place "N/A". This OSSF Development Application Checklist **must** accompany the completed application.

OSSF Permit

- Completed Application for Permit for Authorization to Construct an On-Site Sewage Facility and License to Operate
- Site/Soil Evaluation Completed by a Certified Site Evaluator or a Professional Engineer
- Planning Materials of the OSSF as Required by the TCEQ Rules for OSSF Chapter 285. Planning Materials shall consist of a scaled design and all system specifications.
- Required Permit Fee - See Attached Fee Schedule
- Copy of Recorded Deed
- Surface Application/Aerobic Treatment System
- Recorded Certification of OSSF Requiring Maintenance/Affidavit to the Public
- Signed Maintenance Contract with Effective Date as Issuance of License to Operate

I affirm that I have provided all information required for my OSSF Development Application and that this application constitutes a completed OSSF Development Application.

Signature of Applicant

12/07/2021

Date

___ COMPLETE APPLICATION
Check No. _____ Receipt No. _____

INCOMPLETE APPLICATION
(Missing Items Circled, Application Refused)



REVISED 8:30 am, Mar 04, 2024

Date June 18, 2021

Permit Number 113741

1. APPLICANT / AGENT INFORMATION

Owner Name NORRIS J. DEVOLL
Mailing Address 1118 HIGH HILLS DRIVE
City, State, Zip CANYON LAKE TEXAS 78133
Phone # 210-710-0939
Email norris74@devoll.com

Agent Name GREG JOHNSON, P.E.
Agent Address 170 HOLLOW OAK
City, State, Zip NEW BRAUNFELS TEXAS 78132
Phone # 830-905-2778
Email gregjohnsonpe@yahoo.com

2. LOCATION

Subdivision Name SCENIC HEIGHTS Unit 2 Lot 531R Block
Survey Name / Abstract Number Acreage
Address 552 CLOUD TOP City CANYON LAKE State TX Zip 78133

3. TYPE OF DEVELOPMENT

[X] Single Family Residential
Type of Construction (House, Mobile, RV, Etc.) HOUSE + Personal RV - intermittent use
Number of Bedrooms 4
Indicate Sq Ft of Living Area 2546

[] Non-Single Family Residential
(Planning materials must show adequate land area for doubling the required land needed for treatment units and disposal area)
Type of Facility
Offices, Factories, Churches, Schools, Parks, Etc. - Indicate Number Of Occupants
Restaurants, Lounges, Theaters - Indicate Number of Seats
Hotel, Motel, Hospital, Nursing Home - Indicate Number of Beds
Travel Trailer/RV Parks - Indicate Number of Spaces
Miscellaneous

Estimated Cost of Construction: \$ 350,000 (Structure Only)

Is any portion of the proposed OSSF located in the United States Army Corps of Engineers (USACE) flowage easement?

[] Yes [X] No (If yes, owner must provide approval from USACE for proposed OSSF improvements within the USACE flowage easement)

Source of Water [X] Public [] Private Well [] Rainwater Collection

4. SIGNATURE OF OWNER

By signing this application, I certify that:

- The completed application and all additional information submitted does not contain any false information and does not conceal any material facts.
- Authorization is hereby given to the permitting authority and designated agents to enter upon the above described property for the purpose of site/soil evaluation and inspection of private sewage facilities.
- I understand that a permit of authorization to construct will not be issued until the Floodplain Administrator has performed the reviews required by the Comal County Flood Damage Prevention Order.
- I affirmatively consent to the online posting/public release of my e-mail address associated with this permit application, as applicable.

Signature of Owner Norris J. Devoll

Date Oct 29, 2021

#113741

*** COMAL COUNTY OFFICE OF ENVIRONMENTAL HEALTH ***
APPLICATION FOR PERMIT FOR AUTHORIZATION TO CONSTRUCT AN
ON-SITE SEWAGE FACILITY AND LICENSE TO OPERATE

REVISED
1:56 pm, Dec 15, 2023

Planning Materials & Site Evaluation as Required Completed By GREG W. JOHNSON, P.E.

System Description PROPRIETARY; AEROBIC TREATMENT AND DRIP TUBING

Size of Septic System Required Based on Planning Materials & Soil Evaluation

Tank Size(s) (Gallons) CLEARSTREAM 600NU/ 540 GREYWATER/ 540 PUMP Absorption/Application Area (Sq Ft) 2004

Gallons Per Day (As Per TCEQ Table III) 340

(Sites generating more than 5000 gallons per day are required to obtain a permit through TCEQ)

Is the property located over the Edwards Recharge Zone? Yes No

(If yes, the planning materials must be completed by a Registered Sanitarian (R.S.) or Professional Engineer (P.E.))

Is there an existing TCEQ approved WPAP for the property? Yes No

(if yes, the R. S. or P. E. shall certify that the OSSF design complies with all provisions of the existing WPAP.)

If there is no existing WPAP, does the proposed development activity require a TCEQ approved WPAP? Yes No

(If yes, the R.S. or P. E. shall certify that the OSSF design will comply with all provisions of the proposed WPAP. A Permit to Construct will not be issued for the proposed OSSF until the proposed WPAP has been approved by the appropriate regional office.)

Is the property located over the Edwards Contributing Zone? Yes No

Is there an existing TCEQ approval CZP for the property? Yes No

(if yes, the P.E. or R.S. shall certify that the OSSF design complies with all provisions of the existing CZP)

If there is no existing CZP, does the proposed development activity require a TCEQ approved CZP? Yes No

(if yes, the P.E. or R.S. shall certify that the OSSF design will comply with all provisions of the proposed CZP. A Permit to construct will not be issued for the proposed OSSF until the CZP has been approved by the appropriate regional office.)

Is this property within an incorporated city? Yes No

If yes, indicate the city: _____

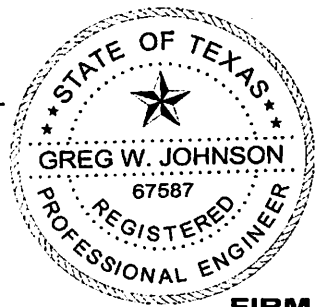

FIRM #2585

By signing this application, I certify that:

- The information provided above is true and correct to the best of my knowledge.
- I affirmatively consent to the online posting/public release of my e-mail address associated with this permit application, as applicable

[Signature]
Signature of Designer

December 7, 2021
Date

AFFIDAVIT

**THE COUNTY OF COMAL
STATE OF TEXAS**

CERTIFICATION OF OSSF REQUIRING MAINTENANCE

According to Texas Commission on Environmental Quality Rules for On-Site Sewage Facilities (OSSF's), this document is filed in the Deed Records of Comal County, Texas.

I

The Texas Health and Safety Code, Chapter 366 authorizes the Texas Commission on Environmental Quality (TCEQ) to regulate on-site sewage facilities (OSSFs). Additionally, the Texas Water Code (TWC), § 5.012 and § 5.013, gives the commission primary responsibility for implementing the laws of the State of Texas relating to water and adopting rules necessary to carry out its powers and duties under the TWC. The commission, under the authority of the TWC and the Texas Health and Safety code, requires owner's to provide notice to the public that certain types of OSSFs are located on specific pieces of property. To achieve this notice, the commission requires a recorded affidavit. Additionally, the owner must provide proof of the recording to the OSSF permitting authority. This recorded affidavit is not a representation or warranty by the commission of the suitability of this OSSF, nor does it constitute any guarantee by the commission that the appropriate OSSF was installed.

II

An OSSF requiring a maintenance contract, according to 30 Texas Administrative Code §285.91(12) will be installed on the property described as (insert legal description):

2 UNIT/PHASE/SECTION _____ BLOCK S31R LOT _____ SCENIC HEIGHTS _____ SUBDIVISION _____

IF NOT IN SUBDIVISION: _____ ACREAGE _____ SURVEY _____

The property is owned by (insert owner's full name): NORRIS J. DEVOLL

This OSSF must be covered by a continuous maintenance contract for the first two years. After the initial two-year service policy, the owner of an aerobic treatment system for a single family residence shall either obtain a maintenance contract within 30 days or maintain the system personally.

Upon sale or transfer of the above-described property, the permit for the OSSF shall be transferred to the buyer or new owner. A copy of the planning materials for the OSSF can be obtained from the Comal County Engineer's Office.

WITNESS BY HAND(S) ON THIS 29th DAY OF October, 2021

Norris J. Devoll
Owner(s) signature(s)

NORRIS J. DEVOLL
Owner (s) Printed name (s)

NORRIS J. DEVOLL SWORN TO AND SUBSCRIBED BEFORE ME ON THIS 29th DAY OF

October, 2021

Brandi L. Lamance
Notary Public Signature

Filed and Recorded
Official Public Records
Bobbie Koepf, County Clerk
Comal County, Texas
11/02/2021 11:10:44 AM
CHRISTY 1 Pages(s)
202106057027

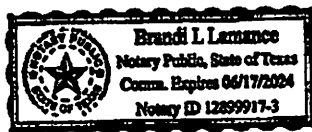

Bobbie Koepf

Countryside Construction, Inc.
300 Chapman Parkway, Canyon Lake, TX. 78133
Phone: 830-899-2615 or 1-888-379-3721 Fax: 830-899-6662
Septic System Service Agreement

In consideration of payment for this service contract, we will abide by and agree to its terms and conditions:

Name: NORRIS J. DEVOLL Address: 552 CLOUD TOP
Sub-Div./County: SCENIC HEIGHTS / COMAL City, State-Zip: CANYON LAKE TX 78133
Permit #: _____ Model #: NORWECO 960 600 Serial #: _____
Phone #: 210-710-0939

(X) Initial Two Year Service Agreement & Two Year Limited Warranty () One Year Service Agreement

The effective date of this initial maintenance contract shall be the date the License to Operate is issued.

Legal Description: SCENIC HEIGHTS UNIT 2 LOT 531R

This contract will be in effect FROM LTO TO _____ and will provide the following:

- A: An inspection/service call every (4) four months which will include: inspection, adjustments and servicing of the mechanical & electrical components as necessary to insure proper function of the system.
- B: An effluent quality inspection consisting of a visual check for color, turbidity, scum, overflow and odor.
- C: **The property owner is responsible for "purchasing and keeping chlorine" in the chlorinator, (if applicable). If the chlorine test reveals "No Chlorine" in the system, the property owner may incur an additional cost.**
- D: If any improper operation is observed (which cannot be corrected at that time) the property owner will be notified immediately of the conditions and the estimated cost.
- E: The response time to a complaint by the property owner regarding operation of the system, shall be within "48 hours," from the time of notification.
- F: **ANY PARTS, WARRANTY OR NON-WARRANTY, OR FREIGHT CHARGES, LABOR OR SERVICE CALLS DUE NOT PAID FOR REMAIN THE PROPERTY OF COUNTRYSIDE CONSTRUCTION AND COULD RESULT IN REPOSSION OF PARTS BY COUNTRYSIDE CONSTRUCTION.**
- G: **THE SIGNING OF THIS SERVICE AGREEMENT AUTHORIZES COUNTRYSIDE CONSTRUCTION TO ENTER THE PROPERTY TO EXECUTE ALL TERMS OF THIS CONTRACT.**

Countryside Construction, Inc., will warranty installation of the septic system to be according to state and county regulations and the designs approved by the county. **HOMEOWNER WILL BE RESPONSIBLE FOR SERVICE CALLS, LABOR AND SHIPPING COSTS ON ANY "WARRANTED PARTS" EXCHANGED DURING WARRANTY.** All other components will be according to manufacture's warranties.

Important: As Countryside Construction, Inc. **cannot control** what or how much effluent goes into this septic system, we **cannot warranty** how the system will function. Refer to manufacturers or installer's instructions, for suggestions on septic operation. This service agreement **does not** cover the cost of "**Service Calls, Labor or Materials** that are required or **parts out of warranty**, the failure to maintain electrical power to the system, **sprinklers that are broken**, leaking, stopped-up or otherwise mal-functioning; or sewage flows exceeding the hydraulic/organic design capabilities and the input of non-biodegradable materials (solvents, grease, oil, paints, etc.), or any usage contrary to the requirements as advised by authorized service representative. Laboratory test work is available at an additional cost. Chlorine, filters, or parts that are out of warranty are available at a reasonable cost.

This contract **does not** include the **pumping of a tank** or of any **compartment of a tank, or settlement of soil on or around any part of the system regardless of reason:**

Violations of the warranty also include: Disconnecting the alarm, restricting ventilation to the aerator, over loading the system above its rated capacity; or flooding by external means. Rodent, insect or Fire Ant damage or any other form of unusual abuse is a violation.

A renewal service contract **should** be "**Activated**" **(30) thirty days** before **expiration** of existing contract. We will contact property owner prior to expiration of existing contract.

Serviced by: *Countryside Construction Inc.*
Walker Chapman - Operator Licensee #2929

(X)  Print Name (X) NORRIS J DEVOLL Date: 12/7/2021
Property Owner Signature

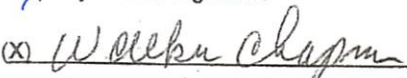
(X)  Date: 12/7/2021 Authorized Service Representative (revised 10/9/09)

**ON-SITE SEWERAGE FACILITY
SOIL EVALUATION REPORT INFORMATION**

Date Soil Survey Performed: June 18, 2021

Site Location: SCENIC HEIGHTS, UNIT 2, LOT 531R

Proposed Excavation Depth: N/A

Requirements:

At least two soil excavations must be performed on the site, at opposite ends of the proposed disposal area. Locations of soil boring or dug pits must be shown on the site drawing. For subsurface disposal, soil evaluations must be performed to a depth of at least two feet below the proposed excavation depth. For surface disposal, the surface horizon must be evaluated. Describe each soil horizon and identify any restrictive features on the form. Indicate depths where features appear.

SOIL BORING NUMBER <u> </u> SURFACE EVALUATION						
Depth (Feet)	Texture Class	Soil Texture	Gravel Analysis	Drainage (Mottles/ Water Table)	Restrictive Horizon	Observations
0	III	CLAY LOAM	N/A	NONE OBSERVED	LIMESTONE @ 10"	BROWN
10"						
1						
2						
3						
4						
5						

SOIL BORING NUMBER <u> </u> SURFACE EVALUATION						
Depth (Feet)	Texture Class	Soil Texture	Gravel Analysis	Drainage (Mottles/ Water Table)	Restrictive Horizon	Observations
0	SAME		AS		ABOVE	
1						
2						
3						
4						
5						

I certify that the findings of this report are based on my field observations and are accurate to the best of my ability.

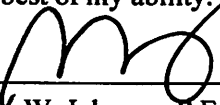

Greg W. Johnson, P.E. 67587-F2585, S.E. 11561

06/18/2021

Date

OSSF SOIL EVALUATION REPORT INFORMATION

Date: June 21, 2021

Applicant Information:

Name: NORRIS J. DEVOLL
Address: 1118 HIGH HILLS DRIVE
City: CANYON LAKE State: TEXAS
Zip Code: 78133 Phone: (210) 710-0939

Site Evaluator Information:

Name: Greg W. Johnson, P.E., R.S., S.E. 11561
Address: 170 Hollow Oak
City: New Braunfels State: Texas
Zip Code: 78132 Phone & Fax (830)905-2778

Property Location:

Lot 531R Unit 2 Blk ___ Subd. SCENIC HEIGHTS
Street Address: 552 CLOUD TOP
City: CANYON LAKE Zip Code: 78133
Additional Info.: _____

Installer Information:

Name: _____
Company: _____
Address: _____
City: _____ State: _____
Zip Code: _____ Phone _____

Topography: Slope within proposed disposal area: 20 %
Presence of 100 yr. Flood Zone: YES ___ NO X
Existing or proposed water well in nearby area. YES ___ NO X
Presence of adjacent ponds, streams, water impoundments YES ___ NO X
Presence of upper water shed YES ___ NO X
Organized sewage service available to lot YES ___ NO X

I HAVE PERFORMED A THOROUGH INVESTIGATION BEING A REGISTERED PROFESSIONAL ENGINEER AND SITE EVALUATOR IN ACCORDANCE WITH CHAPTER 285, SUBCHAPTER D, §285.30, & §285.40 (REGARDING RECHARGE FEATURES), TEXAS COMMISSION OF ENVIRONMENTAL QUALITY (EFFECTIVE DECEMBER 29, 2016).

GREG W. JOHNSON, P.E. 67587 - S.E. 11561

06/21/2021
DATE

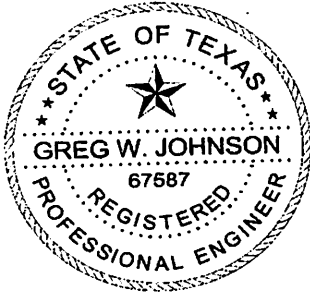

FIRM #2585

#113741

REVISED

2:24 pm, Mar 01, 2024

**DRIP TUBING SYSTEM
DESIGNED FOR:
NORRIS J. DEVOLL
1118 HIGH HILLS DRIVE
CANYON LAKE, TX 78133**

SITE DESCRIPTION:

Located in Scenic Heights, Unit 2, Lot 531R, at 552 Cloud Top, the proposed system will serve a four bedroom residence (2546 sf.) & personal RV (intermittent use) situated in an area with shallow Type-III soil as described in the Soil Evaluation Report. An aerobic treatment plant utilizing drip irrigation was chosen as the most appropriate system to serve the conditions on this lot.

PROPOSED SYSTEM:

A 3 or 4-inch SCH-40 pipe discharges greywater from the residence to a Clearstream 600NU. A 3 inch SCH-40 pipe discharges from the Personal RV to a Infiltrator IM540 fitted with a 0.5 hp Liberty LE50 pump. Flow is pumped to the ATU through a 2" SCH-40 PVC pipe. A high level audible and visual alarm will activate should the pump fail. Graywater from the residence enters a Infiltrator IM540 gallon graywater tank. Unused graywater flows through two backflow valves prior to joining flow into the aerobic plant. into a Clearstream 600NU 600gpd aerobic plant containing a 400-gallon pretreatment tank, an aerobic treatment plant, and a 750-gallon pump chamber containing a submersible well pump. The well pump in the ATU is activated by a time controller allowing the distribution ten times per day with an 8 minute run time with float setting at 340 gallons. A high level audible and visual alarm will activate should the pump fail. Distribution is through a self flushing 100 micron disc filter (Arkal) then through a 1" SCH-40 manifold to a 2004sf. drip tubing field, with *Netifm* drip lines set approximately two feet apart with *0.61 gph* emitters set every two feet, as per the attached schematic. A pressure regulator PMR-MF 30psi installed in the pump tank on the manifold to the field will maintain pressure at 30 psi. A 1" SCH-40 return line is installed to periodically flush the system by cycling a 1" ball valve. Solids caught in the disc filter are flushed each cycle back to the trash tank. Vacuum breakers installed at the highest point on each manifold will prevent siphoning of effluent from higher to lower parts of the field. Field area will be scarified and built up with 4" of Type II or Type III soil, then the drip tubing will be laid and capped with 6" of Type II or Type III soil (*NOT SAND*). The field area will be covered in curlex and heavily seeded or sodded with grass prior to system startup. Risers are required on tank inspection ports as per 30 TAC 285.38 (9/1/2023). This includes access limitation (<65lbs lid or hardware secured lid), inspection and cleanout ports shall have risers over the port openings which extend to a minimum of two inches above grade. A secondary plug, cap, or other suitable restraint system shall be provided below the riser cap to prevent tank entry if the cap is unknowingly damaged or removed.

REVISED

2:24 pm, Mar 01, 2024

DESIGN SPECIFICATIONS:

Daily waste flow: 300 gpd + 40 gpd Personal RV Table III (Intermittent Use)

Pretreatment tank size: 400 Gal

Plant Size: Clearstream 600NU 600 gpd (TCEQ Approved)

Pump tank size: 750Gal

Reserve capacity after High Level: 120 Gal (>1/3 day Req'd)

Application Rate: Ra = 0.2 gal/sf

Total absorption area: $Q/Ra = 340 \text{ GPD}/0.20 = 1700 \text{ sf. (Actual 2004 sf.)}$

Total linear feet drip tubing: 1002' *Netifim* drip tubing .61 GPH

Pump requirement: 501 emitters @ .61 gph @ 30 psi = 5.0935 gpm

Pump Requirement (cont.): Dominator submersible well pump Dosing volume: 50-70 gal.

Pump Tank Calculations: 750 Gal (13.15 gal/in.)

Volume below working level = 12" = 158 gal

Working level = 340 gal = 26"

Reserve Requirement = >1/3 day = 120 gal. = 9.25"

MINIMUM SCOUR VELOCITY (MSV) > 2 FPS

IN DRIP TUBING W/ NOM. DIA. 0.55" ID

$MSV = 2 \text{ FPS } (\pi d^2/4 * 7.48 \text{ gal/cf} * 60 \text{ sec/min})$

$MSV = 2(3.14159((.55/12)^2)/4) * 7.48 * 60$

$MSV = 1.5 \text{ gpm MIN FLOW RATE } * 3 = 4.5 \text{ gpm}$

IN RETURN MANIFOLD W/ NOM. DIA 1.049" ID

$MSV = 2 \text{ FPS } (\pi d^2/4 * 7.48 \text{ gal/cf} * 60 \text{ sec/min})$

$MSV = 2(3.14159((1.049/12)^2)/4) * 7.48 * 60$

$MSV = 5.4 \text{ GPM}$

PIPE AND FITTINGS:

All pipes and fittings in this drip tubing system shall be 1" schedule 40 PVC. All joints shall be sealed with approved solvent-type PVC cement. Clipper type cutters are recommended to prevent PVC burrs during cutting of pipes causing possible plugging. Drip tubing 0.61 gph drip tubing to be used in field.

Designed in accordance with Chapter 285, Subchapter D, §285.30 and §285.40 Texas Commission on Environmental Quality (Effective December 29, 2016)

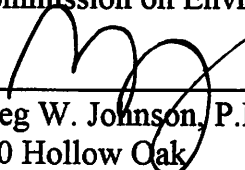
 02/29/24
Greg W. Johnson, P.E. No. 67587 - F-2585

170 Hollow Oak

New Braunfels, Texas 78132 830/905-2778

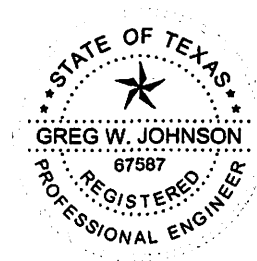

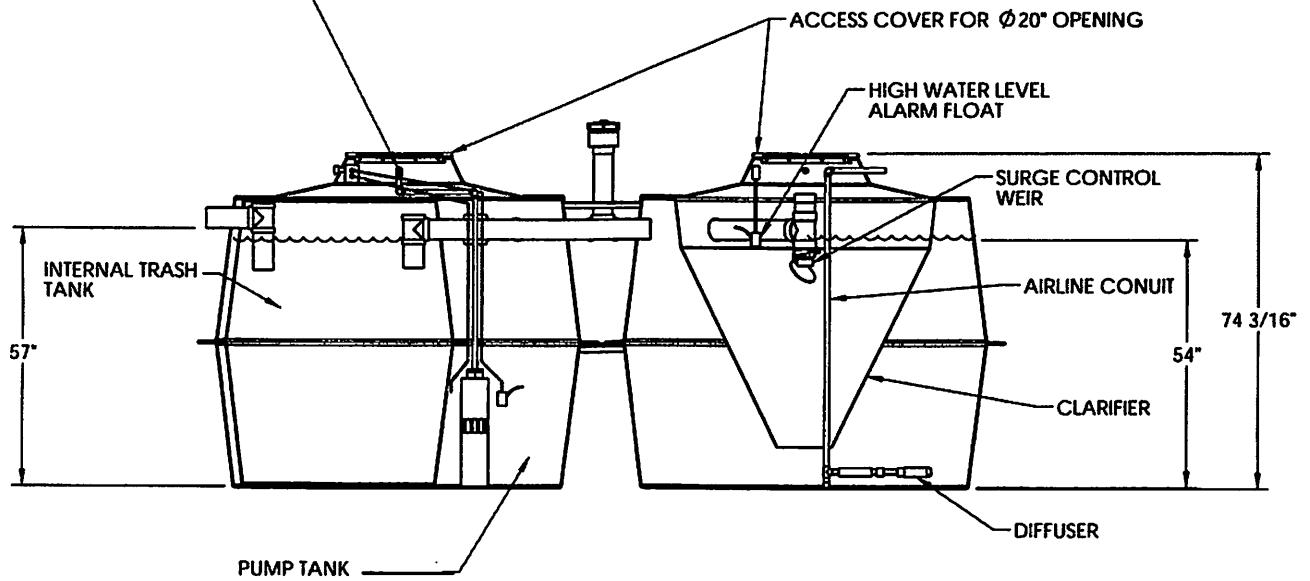
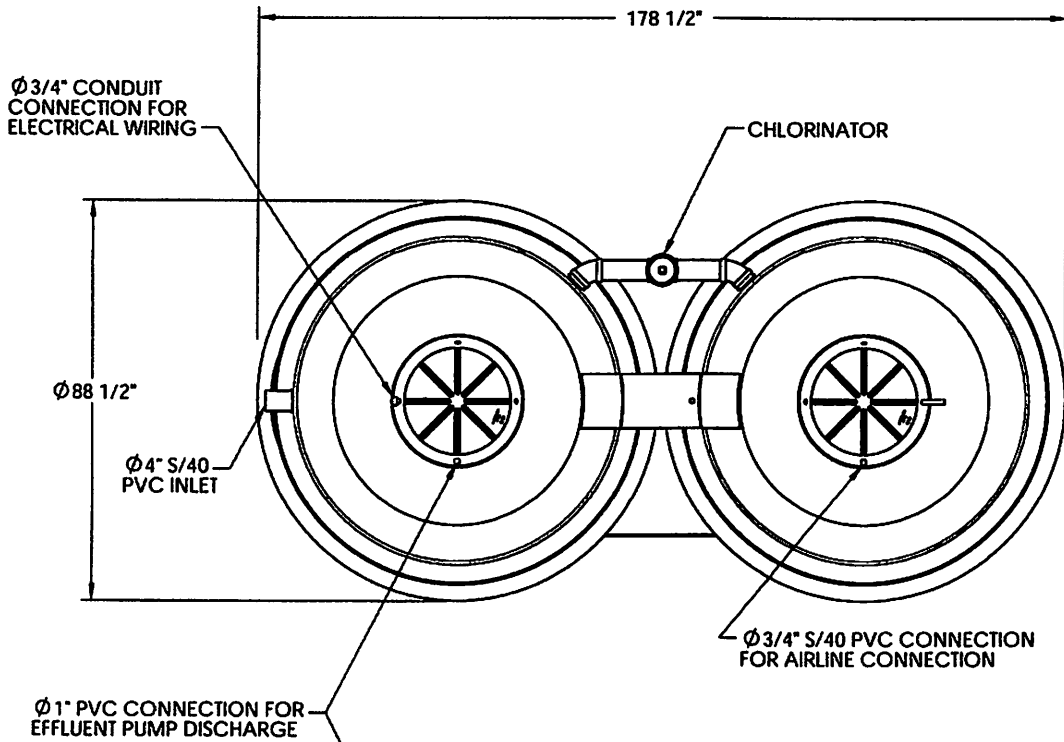

600NU WASTEWATER TREATMENT SYSTEM

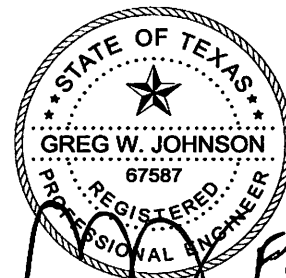

MW
 F2585
 12/7/2021

TANK NOTES:

Tanks must be set to allow a minimum of 1/8" per foot fall from the residence.

Tightlines to the tank shall be SCH-40 PVC.

A two way sanitary tee is required between residence and tank.

A minimum of 4" of sand, sandy loam, clay loam free of rock shall be placed under and around tanks

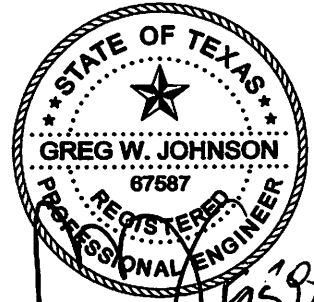

Handwritten: 12/5/85
12/6/2021

ALL WIRING MUST BE IN COMPLIANCE WITH
THE MOST RECENT NATIONAL ELECTRIC CODE

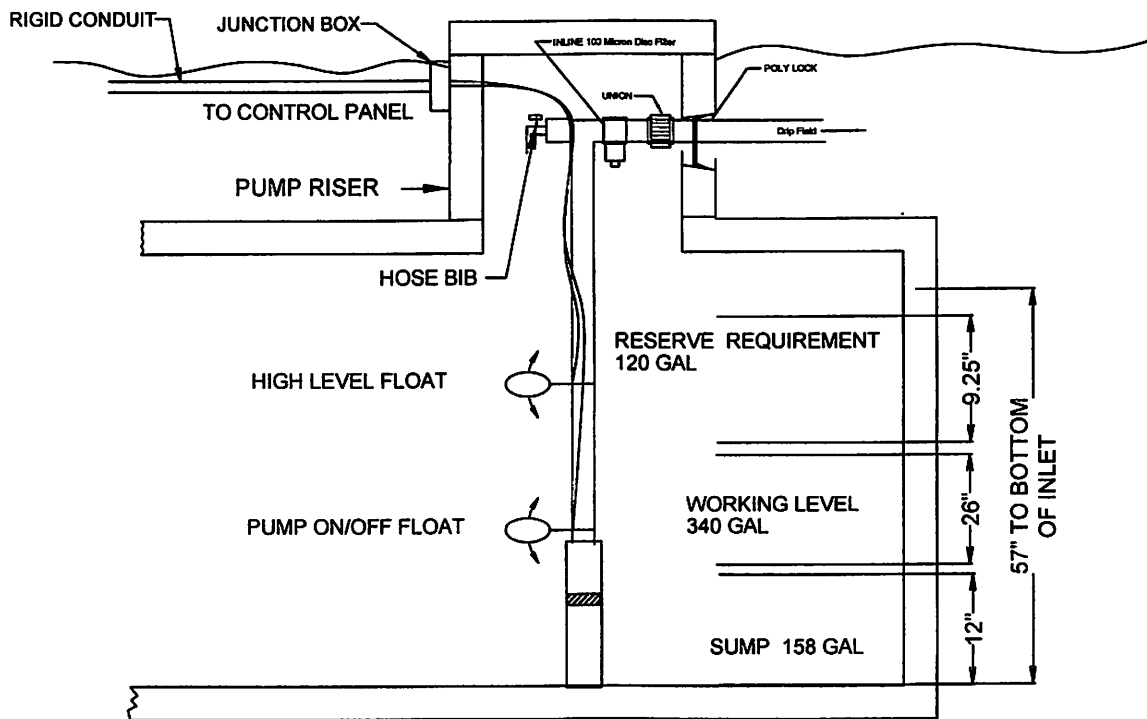

TYPICAL PUMP TANK CONFIGURATION
CLEARSTREAM 600NU W/ 750 GAL PUMP TANK

Arkal 1" Super Filter

Catalog No. 1102 0 _ _ _

Features

- ♦ A "T" shaped filter with two 1" male threads.
- ♦ A "T" volume filter for in-line installation on 1" pipelines.
- ♦ The filter prevents clogging due to its enlarged filtering area that collects sediments and particles.
- ♦ Manufactured entirely from fiber reinforced plastic.
- ♦ A cylindrical column of grooved discs constitutes the filter element.
- ♦ Spring keeps the discs compressed.
- ♦ Screw-on filter cover.
- ♦ Filter discs are available in various filtration grades.



Technical Data

Inlet/outlet diameter	1" BSPT (male)	1" NPT (male)
	25.0 mm – nominal diameter	
	33.6 mm – pipe diameter (O. D.)	
Maximum pressure	10 atm	145 psi
Maximum flow rate	8 m ³ /h (1.7 l/sec)	35 gpm
General filtration area	500 cm ²	77.5 in ²
Filtration volume	600 cm ³	37 in ³
Filter length L	340 mm	13 13/32"
Filter width W	130 mm	5 3/32"
Distance between end connections A	158 mm	6 7/32"
Weight	1.420 kg	3.13 lbs.
Maximum temperature	70° C	158 °F
pH	5-11	5-11

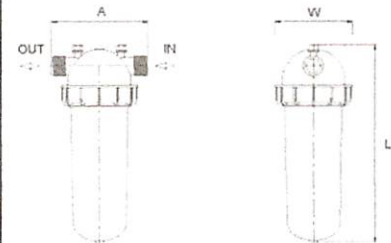

Filtration Grades

- Blue (400 micron / 40 mesh)
- Yellow (200 micron / 80 mesh)
- Red (130 micron / 120 mesh)
- Black (100 micron / 140 mesh)
- Green (55 micron)

Head Loss Chart

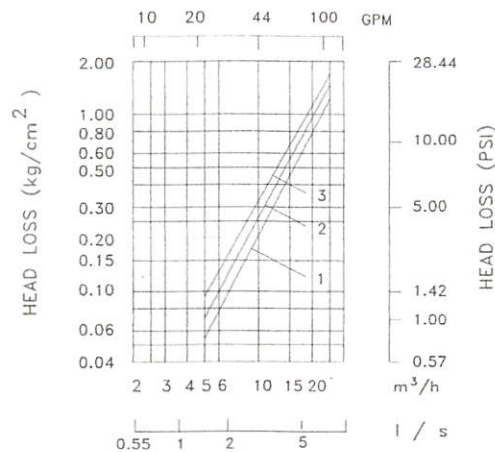



Bioline® Driperline

Pressure Compensating Driperline for Wastewater

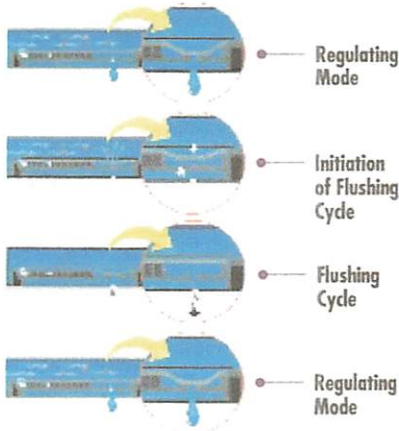

BioLine's Self-Cleaning, Pressure Compensating Dripper is a fully self-contained unit molded to the interior wall of the dripper tubing.

As shown at left, BioLine is continuously self-cleaning during operation, not just at the beginning and end of a cycle. The result is dependable, clog free operation, year after year.

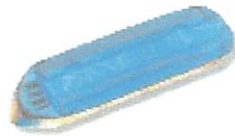

Product Advantages

The Proven Performer

- Tens of millions of feet used in wastewater today.
- Bioline is permitted in every state allowing drip disposal.
- Backed by the largest, most quality-driven manufacturer of drip products in the U.S.
- Preferred choice of major wastewater designers and regulators.
- Proven track record of success for many years of hard use in wastewater applications.

Quality Manufacturing with Specifications Designed to Meet Your Needs

- Pressure compensating drippers assure the highest application uniformity - even on sloped or rolling terrain.
- Excellent uniformity with runs of 400 feet or more - reducing installation costs.
- Highest quality-control standards in the industry: Cv of 0.25 (coefficient of manufacturer's variation).
- A selection of flows and spacings to satisfy the designer's demand for almost any application rate.

Long-Term Reliability

- Protection against plugging:
 - Dripper inlet raised 0.27" above wall of tubing to prevent sediment from entering dripper.
 - Drippers impregnated with Vinyzene to prevent buildup of microbial slime.
 - Unique self-flushing mechanism passes small particles before they can build up.

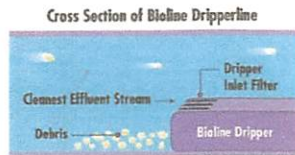

Root Safe

- A physical barrier on each BioLine dripper helps prevent root intrusion.
- Protection never wears out - never depletes - releases nothing to the environment.
- Working reliably for up to 15 years in subsurface wastewater installations.
- Additional security of chemical root inhibition with Techfilter - supplies Trifluralin to the entire system, effectively inhibiting root growth to the dripper outlets.



Applications

- For domestic strength wastewater disposal.
- Installed following a treatment process.
- Can be successfully used on straight septic effluent with proper design, filtration and operation.
- Suitable for reuse applications using municipally treated effluent designated for irrigation water.

Specifications

Wall thickness (mil): 45*

Nominal flow rates (GPH): .4, .6, .9*

Common spacings: 12", 18", 24"*

Recommended filtration: 120 mesh

Inside diameter: .570"

Color: Purple tubing indicates non-potable source

*Additional flows, spacings, and pipe sizes available by request. Please contact Netafim USA Customer Service for details.

BIOLINE Flow Rate vs. Pressure

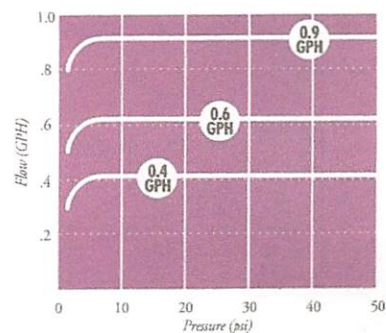

NETAFIM USA
 5470 E. Home Ave. • Fresno, CA 93727
 888.638.2346 • 559.453.6800
 FAX 800.695.4753
www.netafimusa.com

NETAFIM WASTEWATER DISPERSAL SYSTEM DESIGN GUIDE

SAMPLE DESIGNS

SINGLE TRENCH LAYOUT

Rectangular field with supply and flush manifold on same side and in same trench;

- Locate supply and flush manifold in same trench
- Dripperlines are looped at the end opposite the supply and flush manifolds
- The longest Bioline length should not exceed 400 ft. Drip fields 200 ft. in length might loop the Bioline once; drip dispersal fields under 100 ft. might be looped twice, as illustrated

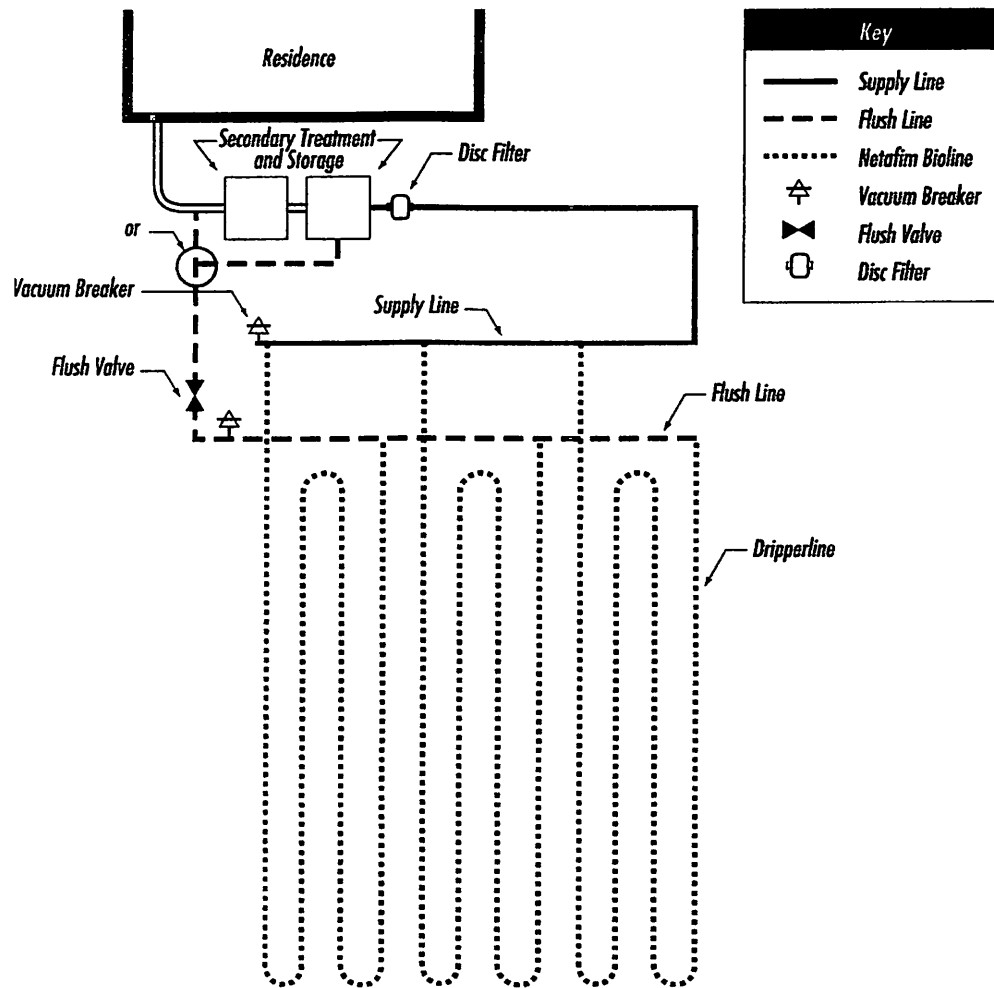

TANK NOTES:

Tanks must be set to allow a minimum of 1/8" per foot fall from the residence.

Tightlines to the tank shall be SCH-40 PVC.

A two way sanitary tee is required between residence and tank.

A minimum of 4" of sand, sandy loam, clay loam free of rock shall be placed under and around tanks

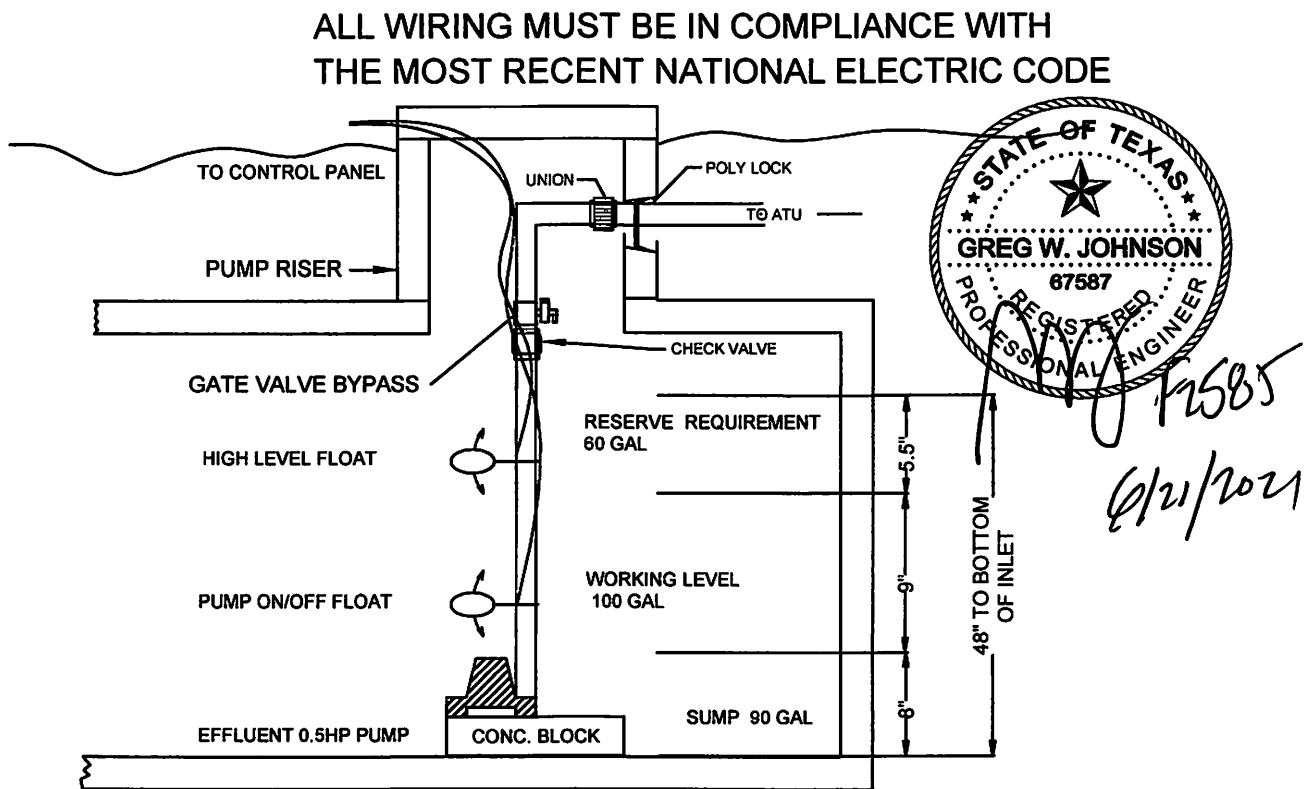

TYPICAL PUMP TANK CONFIGURATION IM-540 GAL PUMP TANK

PMR-MF

PRESSURE-MASTER REGULATOR - MEDIUM FLOW

Specifications

The pressure regulator shall be capable of operating at a constant, factory preset, non-adjustable outlet pressure of 6, 10, 12, 15, 20, 25, 30, 35, 40, 50, or 60 PSI (0.41, 0.69, 0.83, 1.03, 1.38, 1.72, 2.07, 2.41, 2.76, 3.45, or 4.14 bar) with a flow range between:

- 4 - 16 GPM (909 - 3634 L/hr) for 6 - 10 PSI models or
- 2 - 20 GPM (454 - 4542 L/hr) for 12 - 60 PSI models.

The pressure regulator shall maintain the nominal pressure at a minimum of 5 PSI (0.34 bar) above model inlet pressure and a maximum of 80 PSI (5.52 bar) above nominal model pressure*. Refer to the PRU performance curve to establish specific outlet pressures based on relative inlet pressure and flow rate. Always install downstream from all shut off valves. Recommended for outdoor use only. Not NSF certified.

All pressure regulator models shall be equipped with one of these inlet-x-outlet configurations:

Inlet

- ¾-inch Female National Pipe Thread (FNPT)
- 1-inch Female National Pipe Thread (FNPT)
- 1-inch Female British Standard Pipe Thread (FBSPT)

Outlet

- ¾-inch Female National Pipe Thread (FNPT)
- 1-inch Female National Pipe Thread (FNPT)
- 1-inch Female British Standard Pipe Thread (FBSPT)

The upper housing, lower housing, and internal molded parts shall be of engineering-grade thermoplastics with internal elastomeric seals and a reinforced elastomeric diaphragm. Regulation shall be accomplished by a fixed stainless steel compression spring, which shall be enclosed in a chamber isolated from the normal water passage.

Outlet pressure and flow shall be clearly marked on each regulator.

The pressure regulator shall carry a two-year manufacturer's warranty on materials, workmanship, and performance. Each pressure regulator shall be water tested for accuracy before departing the manufacturing facility.

The pressure regulator shall be manufactured by Senninger Irrigation in Clermont, Florida. Senninger is a Hunter Industries Company.

Physical

¾" FNPT x ¾" FNPT model (shown on right)

Overall Length 5.2 inches (13.1 cm)

Overall Width 2.5 inches (6.4 cm)

1" FNPT x 1" FNPT model

1" FBSPT x 1" FBSPT model

Overall Length 5.8 inches (14.6 cm)

Overall Width 2.5 inches (6.4 cm)

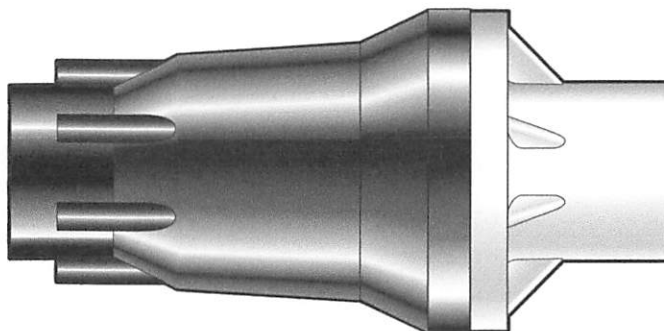

* Please consult factory for applications outside of recommended guidelines.



PMR-MF

PRESSURE-MASTER REGULATOR - MEDIUM FLOW

Model Numbers

Model #	Flow Range	Preset Operating Pressure	Maximum Inlet Pressure
PMR-6 MF	4 - 16 GPM (909 - 3634 L/hr)	6 PSI (0.41 bar)	80 psi (5.51 bar)
PMR-10 MF	4 - 16 GPM (909 - 3634 L/hr)	10 PSI (0.69 bar)	90 psi (6.20 bar)
PMR-12 MF	2 - 20 GPM (454 - 4542 L/hr)	12 PSI (0.83 bar)	90 psi (6.20 bar)
PMR-15 MF	2 - 20 GPM (454 - 4542 L/hr)	15 PSI (1.03 bar)	95 psi (6.55 bar)
PMR-20 MF	2 - 20 GPM (454 - 4542 L/hr)	20 PSI (1.38 bar)	100 psi (6.89 bar)
PMR-25 MF	2 - 20 GPM (454 - 4542 L/hr)	25 PSI (1.72 bar)	105 psi (7.24 bar)
PMR-30 MF	2 - 20 GPM (454 - 4542 L/hr)	30 PSI (2.07 bar)	110 psi (7.58 bar)
PMR-35 MF	2 - 20 GPM (454 - 4542 L/hr)	35 PSI (2.41 bar)	115 psi (7.93 bar)
PMR-40 MF	2 - 20 GPM (454 - 4542 L/hr)	40 PSI (2.76 bar)	120 psi (8.27 bar)
PMR-50 MF	2 - 20 GPM (454 - 4542 L/hr)	50 PSI (3.45 bar)	130 psi (8.96 bar)
PMR-60 MF	2 - 20 GPM (454 - 4542 L/hr)	60 PSI (4.14 bar)	140 psi (9.65 bar)

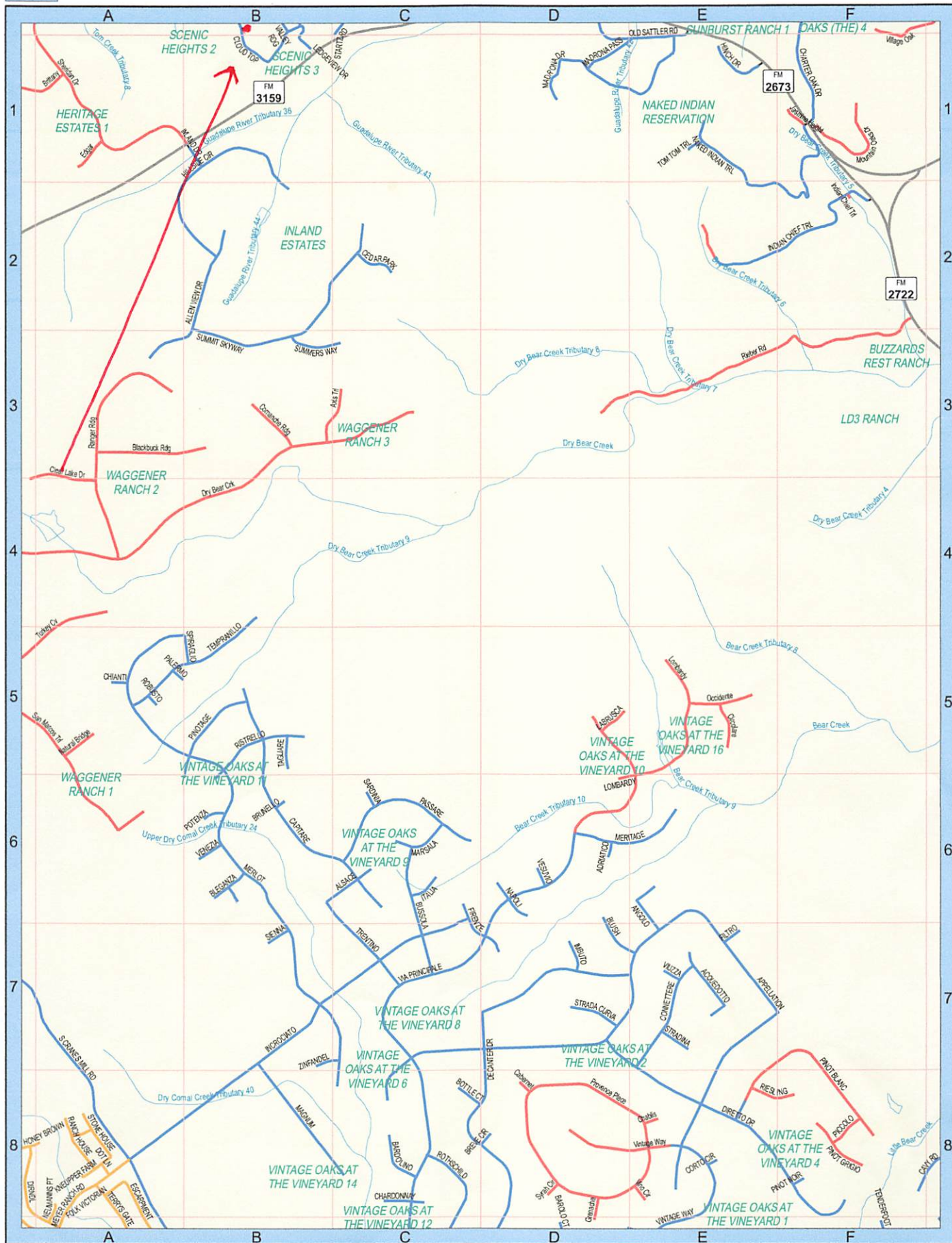

SEE PAGE 43

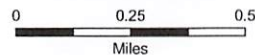
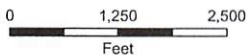

From: [Ritzen, Brenda](#)
To: [Greg Johnson](#)
Cc: [Robert Keltner](#)
Subject: RE: 552 CLOUD TOP - DEVOLL #113741
Date: Monday, March 4, 2024 8:31:00 AM
Attachments: [image001.png](#)

Steve,

The permit file has been updated.

Thank you,



Brenda Ritzen
Environmental Health Coordinator
195 David Jonas Dr.
New Braunfels, TX 78132
DR:OS00007722
830-608-2090
www.cceo.org

From: Greg Johnson <gregjohnsonpe@yahoo.com>
Sent: Saturday, March 2, 2024 9:48 AM
To: Ritzen, Brenda <rabbjr@co.comal.tx.us>
Cc: Robert Keltner <rwkeltner@hotmail.com>
Subject: Re: 552 CLOUD TOP - DEVOLL #113741

This email originated from outside of the organization.
Do not click links or open attachments unless you recognize the sender and know the content is safe.

- Comal IT

See attached

Steve

Send for Greg W. Johnson, P.E., R.S.)

170 Hollow Oak

New Braunfels, TX 78132

From: [Ritzen, Brenda](#)
To: [Greg Johnson](#)
Cc: [Robert Keltner](#)
Subject: RE: 552 CLOUD TOP - DEVOLL #113741
Date: Friday, March 1, 2024 2:28:00 PM
Attachments: [image001.png](#)

Greg,

Include  on the permit application that the RV is for intermittent use only.

Thank you,



Brenda Ritzen
Environmental Health Coordinator
195 David Jonas Dr.
New Braunfels, TX 78132
DR:OS00007722
830-608-2090
www.cceo.org

From: Greg Johnson <gregjohnsonpe@yahoo.com>
Sent: Friday, March 1, 2024 10:50 AM
To: Ritzen, Brenda <rabbjr@co.comal.tx.us>
Cc: Robert Keltner <rwkeltner@hotmail.com>
Subject: Fw: 552 CLOUD TOP - DEVOLL #113741

This email originated from outside of the organization.
Do not click links or open attachments unless you recognize the sender and know the content is safe.

- Comal IT

Attached is the revised to show Curlex and Intermittent use of RV.

Thanks,
Greg

Send for Greg W. Johnson, P.E., R.S.)
170 Hollow Oak
New Braunfels, TX 78132

From: [Ritzen, Brenda](#)
To: [Greg Johnson](#)
Cc: [Robert Keltner](#)
Subject: RE: 552 CLOUD TOP - DEVOLL #113741
Date: Thursday, February 29, 2024 12:46:00 PM
Attachments: [image001.png](#)

Greg,

Will this RV be for intermittent use only? If so, add the intermittent use information to the permit application, design and planning materials.

Thank you,



Brenda Ritzen
Environmental Health Coordinator
195 David Jonas Dr.
New Braunfels, TX 78132
DR:OS00007722
830-608-2090
www.cceo.org

From: Greg Johnson <gregjohnsonpe@yahoo.com>
Sent: Thursday, February 29, 2024 11:36 AM
To: Ritzen, Brenda <rabbjr@co.comal.tx.us>
Cc: Robert Keltner <rwkeltner@hotmail.com>
Subject: 552 CLOUD TOP - DEVOLL #113741

This email originated from outside of the organization.
Do not click links or open attachments unless you recognize the sender and know the content is safe.

- Comal IT

REVISED.
THX,
GREG

Send for Greg W. Johnson, P.E., R.S.)
170 Hollow Oak
New Braunfels, TX 78132

RECEIVED

By KG at 9:59 am, Dec 08, 2021



COMAL COUNTY
ENGINEER'S OFFICE

ON-SITE SEWERAGE APPLICATION

VOID

195 DAVID JONAS DR
NEW BRAUNFELS, TX 78132
(830) 608-2090
WWW.CCEO.ORG

Date June 18, 2021

Permit Number 113741

1. APPLICANT / AGENT INFORMATION

Owner Name NORRIS J. DEVOLL
Mailing Address 1118 HIGH HILLS DRIVE
City, State, Zip CANYON LAKE TEXAS 78133
Phone # 210-710-0939
Email norris74@devoll.com

Agent Name GREG JOHNSON, P.E.
Agent Address 170 HOLLOW OAK
City, State, Zip NEW BRAUNFELS TEXAS 78132
Phone # 830-905-2778
Email gregjohnsonpe@yahoo.com

2. LOCATION

Subdivision Name SCENIC HEIGHTS Unit 2 Lot 531R Block
Survey Name / Abstract Number Acreage
Address 552 CLOUD TOP City CANYON LAKE State TX Zip 78133

3. TYPE OF DEVELOPMENT

Single Family Residential

Type of Construction (House, Mobile, RV, Etc.) HOUSE + Personal RV

Number of Bedrooms 4

Indicate Sq Ft of Living Area 2546

Non-Single Family Residential

(Planning materials must show adequate land area for doubling the required land needed for treatment units and disposal area)

Type of Facility

Offices, Factories, Churches, Schools, Parks, Etc. - Indicate Number of Occupants

Restaurants, Lounges, Theaters - Indicate Number of Seats

Hotel, Motel, Hospital, Nursing Home - Indicate Number of Beds

Travel Trailer/RV Parks - Indicate Number of Spaces

Miscellaneous

VOID

Estimated Cost of Construction: \$ 350,000 (Structure Only)

Is any portion of the proposed OSSF located in the United States Army Corps of Engineers (USACE) flowage easement?

Yes No (If yes, owner must provide approval from USACE for proposed OSSF improvements within the USACE flowage easement)

Source of Water Public Private Well Rainwater Collection

4. SIGNATURE OF OWNER

By signing this application, I certify that:

- The completed application and all additional information submitted does not contain any false information and does not conceal any material facts. I certify that I am the property owner or I possess the appropriate land rights necessary to make the permitted improvements on said property.
- Authorization is hereby given to the permitting authority and designated agents to enter upon the above described property for the purpose of site/soil evaluation and inspection of private sewage facilities..
- I understand that a permit of authorization to construct will not be issued until the Floodplain Administrator has performed the reviews required by the Comal County Flood Damage Prevention Order.
- I affirmatively consent to the online posting/public release of my e-mail address associated with this permit application, as applicable.

Norris J Devoll
Signature of Owner

Oct 29, 2021
Date

VOID

REVISED

1:56 pm, Dec 15, 2023

**DRIP TUBING SYSTEM
DESIGNED FOR:
NORRIS J. DEVOLL
1118 HIGH HILLS DRIVE
CANYON LAKE, TX 78133**

SITE DESCRIPTION:

Located in Scenic Heights, Unit 2, Lot 531R, at 552 Cloud Top, the proposed system will serve a four bedroom residence (2546 sf.) & personal RV situated in an area with shallow Type-III soil as described in the Soil Evaluation Report. An aerobic treatment plant utilizing drip irrigation was chosen as the most appropriate system to serve the conditions on this lot.

PROPOSED SYSTEM:

A 3 or 4-inch SCH-40 pipe discharges greywater from the residence to a Clearstream 600NU. A 3 inch SCH-40 pipe discharges from the Personal RV to a Infiltrator IM540 fitted with a 0.5 hp Liberty LE50 pump. Flow is pumped to the ATU through a 2" SCH-40 PVC pipe. A high level audible and visual alarm will activate should the pump fail. Graywater from the residence enters a Infiltrator IM540 gallon graywater tank. Unused graywater flows through two backflow valves prior to joining flow into the aerobic plant. into a Clearstream 600NU 600gpd aerobic plant containing a 400-gallon pretreatment tank, an aerobic treatment plant, and a 750-gallon pump chamber containing a submersible well pump. The well pump in the ATU is activated by a time controller at 3:00 pm. Distribution is through a self flushing 100 micron disc filter (Arkal) then through a 1" SCH-40 manifold to a 2004sf. drip tubing field, with *Netifm* drip lines set approximately two feet apart with *0.61 gph* emitters set every two feet, as per the attached schematic. A pressure regulator PMR-MF 30psi installed in the pump tank on the manifold to the field will maintain pressure at 30 psi. A 1" SCH-40 return line is installed to periodically flush the system by cycling a 1" ball valve. Solids caught in the disc filter are flushed each cycle back to the trash tank. Vacuum breakers installed at the highest point on each manifold will prevent siphoning of effluent from higher to lower parts of the field. Field area will be scarified and built up with 4" of Type II or Type III soil, then the drip tubing will be laid and capped with 6" of Type II or Type III soil (*NOT SAND*). The field area will be sodded with grass prior to system startup. Tank must have at grade risers on each opening with watertight caps that must be at least 65# or have a padlock or can only be removed with tools. A secondary plug, cap, or suitable restraint must be provided below riser cap to prevent tank entry should the cap be damaged or removed, in compliance with Chapter §285.38.

VOID

REVISED

1:56 pm, Dec 15, 2023

DESIGN SPECIFICATIONS:

Daily waste flow: 300 gpd + 40 gpd Personal RV Table III
 Pretreatment tank size: 400 Gal
 Plant Size: Clearstrem 600NU 600 gpd (TCEQ Approved)
 Pump tank size: 750Gal
 Reserve capacity after High Level: 120 Gal (>1/3 day Req'd)
 Application Rate: Ra = 0.2 gal/sf
 Total absorption area: Q/Ra = 340 GPD/0.20 = 1700 sf. (Actual 2004 sf.)
 Total linear feet drip tubing: 1002' *Netifim* drip tubing .61 GPH
 Pump requirement: 501 emitters @ .61 gph @ 30 psi = 5.0935 gpm
 Pump Requirement (cont.): Dominator submersible well pump Dosing volume: 50-70 gal.
 Pump Tank Calculations: 750 Gal (13.15 gal/in.)
 Volume below working level = 12"= 158 gal
 Working level = 340 gal = 26"
 Reserve Requirement = >1/3 day = 120 gal. = 9.25"

MINIMUM SCOUR VELOCITY (MSV) > 2 FPS

IN DRIP TUBING W/ NOM. DIA. 0.55" ID

$MSV = 2 \text{ FPS } (\pi d^2) / 4 * 7.48 \text{ gal/cf} * 60 \text{ sec/min}$
 $MSV = 2(3.14159((.55/12)^2) / 4) * 7.48 * 60$
 $MSV = 1.5 \text{ gpm MIN FLOW RATE } * 3 = 4.5 \text{ gpm}$

IN RETURN MANIFOLD W/ NOM. DIA. 1.049" ID

$MSV = 2 \text{ FPS } (\pi d^2) / 4 * 7.48 \text{ gal/cf} * 60 \text{ sec/min}$
 $MSV = 2(3.14159((1.049/12)^2) / 4) * 7.48 * 60$
 $MSV = 5.4 \text{ GPM}$

VOID

PIPE AND FITTINGS:

All pipes and fittings in this drip tubing system shall be 1" schedule 40 PVC. All joints shall be sealed with approved solvent-type PVC cement. Clipper type cutters are recommended to prevent PVC burrs during cutting of pipes causing possible plugging. Drip tubing 0.61 gph drip tubing to be used in field.

Designed in accordance with Chapter 285, Subchapter D, §285.30 and §285.40 Texas Commission on Environmental Quality (Effective December 29, 2016)

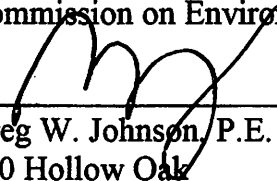
 12/14/23
 Greg W. Johnson, P.E. No. 67587 - F-2585
 170 Hollow Oak
 New Braunfels, Texas 78132 830/905-2778

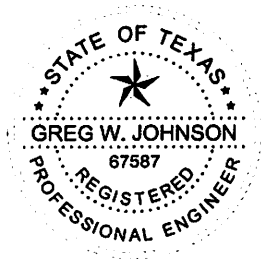

INSTALL 2004sf OF FIELD USING 1002' OF DRIP TUBING. THERE SHALL BE NO PARKING, DRIVING OR STORAGE ON THE SEPTIC FIELD AT ANY TIME FOR ANY REASON.

REVISED
1:56 pm, Dec 15, 2023

*USE TWO WAY CLEAN OUTS
**USE SCH-40 OR SDR-26 TO TANK

X= TEST HOLE

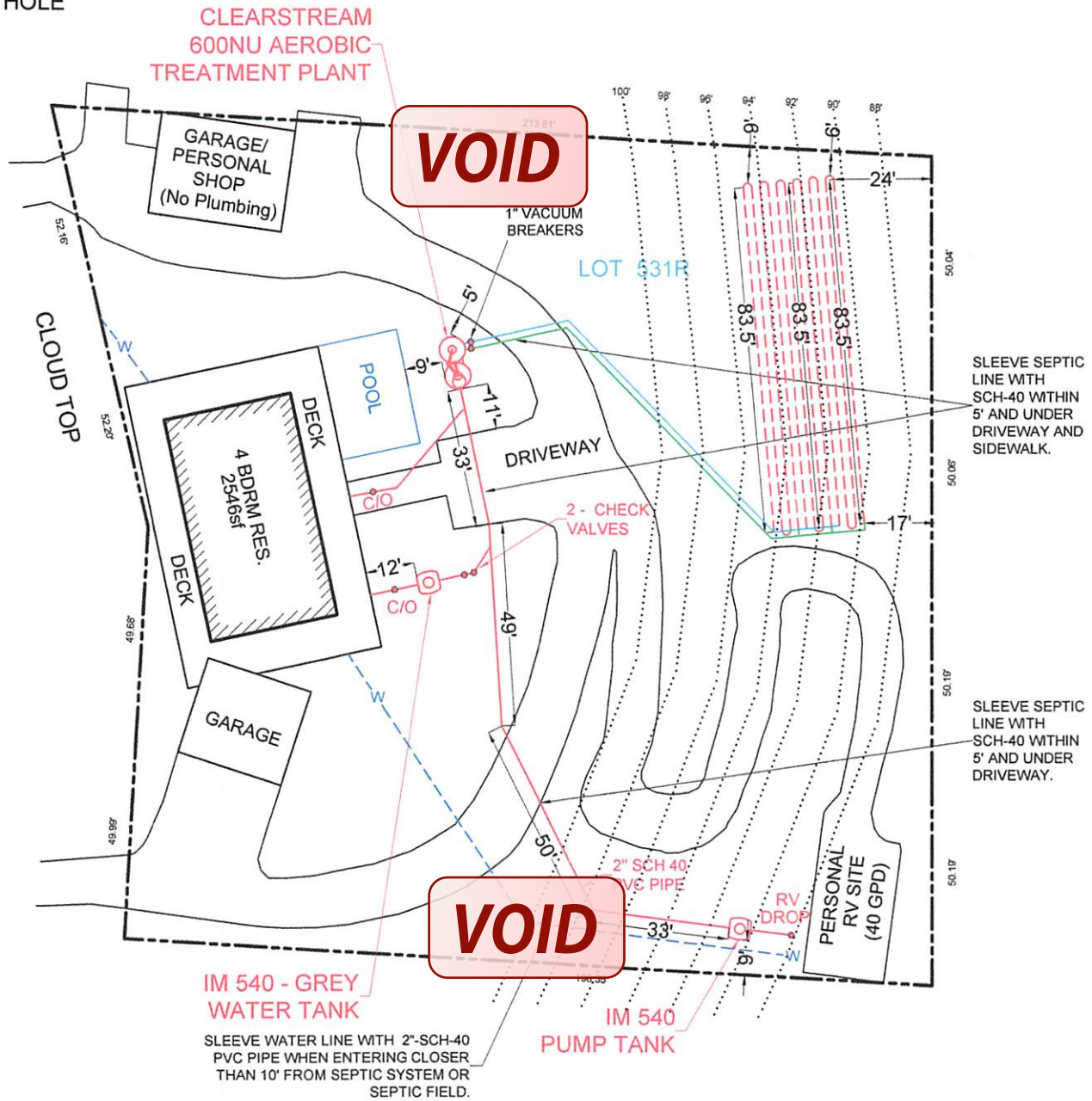

OWNER:	NORRIS J. DEVOLL			DRAWN BY:	EJS III
STREET ADDRESS:	552 CLOUD TOP				
LEGAL DESC:	SCENIC HEIGHTS	UNIT/SECTION/PHASE:	2	BLOCK:	LOT: 531R
PREPARED BY:	GREG W. JOHNSON, P.E. F#002585	SCALE:	1"=40'	DATE:	6/21/2021
				3rd REVISION:	12/13/2023



From: [Ritzen, Brenda](#)
To: ["Greg Johnson"](#)
Cc: [Robert Keltner](#)
Subject: RE: 552 CLOUD TOP - DEVOLL #113741
Date: Friday, December 15, 2023 2:00:00 PM
Attachments: [image001.png](#)

Greg,

The permit file has been updated.

Thank you,



Brenda Ritzen
Environmental Health Coordinator
195 David Jonas Dr.
New Braunfels, TX 78132
DR:OS00007722
830-608-2090
www.cceo.org

From: Greg Johnson <gregjohnsonpe@yahoo.com>
Sent: Friday, December 15, 2023 12:23 PM
To: Ritzen, Brenda <rabbjr@co.comal.tx.us>
Cc: Robert Keltner <rwkeltner@hotmail.com>
Subject: 552 CLOUD TOP - DEVOLL #113741

This email originated from outside of the organization.

Do not click links or open attachments unless you recognize the sender and know the content is safe.

- Comal IT

REVISED.
THX,
GREG

Send for Greg W. Johnson, P.E., R.S.)
170 Hollow Oak
New Braunfels, TX 78132

*** COMAL COUNTY OFFICE OF ENVIRONMENTAL HEALTH ***

APPLICATION FOR PERMIT FOR AUTHORIZATION TO CONSTRUCT AN ON-SITE SEWAGE FACILITY AND LICENSE TO OPERATE



Planning Materials & Site Evaluation as Required Completed By GREG W. JOHNSON, P.E.

System Description PROPRIETARY; AEROBIC TREATMENT AND DRIP TUBING

Size of Septic System Required Based on Planning Materials & Soil Evaluation

Tank Size(s) (Gallons) CLEARSTREAM 600NU/ 540 GREYWATER/ 540 PUMP Absorption/Application Area (Sq Ft) 2000

Gallons Per Day (As Per TCEQ Table III) 340

(Sites generating more than 5000 gallons per day are required to obtain a permit through TCEQ)

Is the property located over the Edwards Recharge Zone? [] Yes [X] No

(If yes, the planning materials must be completed by a Registered Sanitarian (R.S.) or Professional Engineer (P.E.))

Is there an existing TCEQ approved WPAP for the property? [] Yes [X] No

(if yes, the R. S. or P. E. shall certify that the OSSF design complies with all provisions of the existing WPAP.)

If there is no existing WPAP, does the proposed development activity require a TCEQ approved WPAP? [] Yes [] No

(If yes, the R.S. or P. E. shall certify that the OSSF design will comply with all provisions of the proposed WPAP. A Permit to Construct will not be issued for the proposed OSSF until the proposed WPAP has been approved by the appropriate regional office.)

Is the property located over the Edwards Contributing Zone? [X] Yes [] No

Is there an existing TCEQ approval CZP for the property?



(if yes, the P.E. or R.S. shall certify that the OSSF design complies with all provisions of the existing CZP)

If there is no existing CZP, does the proposed development activity require a TCEQ approved CZP? [] Yes [X] No

(if yes, the P.E. or R.S. shall certify that the OSSF design will comply with all provisions of the proposed CZP. A Permit to construct will not be issued for the proposed OSSF until the CZP has been approved by the appropriate regional office.)

Is this property within an incorporated city? [] Yes [X] No

If yes, indicate the city:

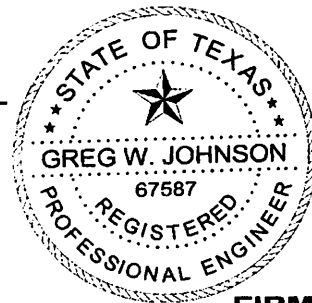

FIRM #2585

By signing this application, I certify that:

- The information provided above is true and correct to the best of my knowledge.
- I affirmatively consent to the online posting/public release of my e-mail address associated with this permit application, as applicable

Signature of Designer (Handwritten Signature)

Date December 7, 2021

VOID

**DRIP TUBING SYSTEM
DESIGNED FOR:
NORRIS J. DEVOLL
1118 HIGH HILLS DRIVE
CANYON LAKE, TX 78133**

SITE DESCRIPTION:

Located in Scenic Heights, Unit 2, Lot 531R, at 552 Cloud Top, the proposed system will serve a four bedroom residence (2546 sf.) & personal RV situated in an area with shallow Type-III soil as described in the Soil Evaluation Report. An aerobic treatment plant utilizing drip irrigation was chosen as the most appropriate system to serve the conditions on this lot.

PROPOSED SYSTEM:

A 3 or 4-inch SCH-40 pipe discharges greywater from the residence to a Clearstream 600NU. A 3 inch SCH-40 pipe discharges from the Personal RV to a Infiltrator IM540 fitted with a 0.5 hp Liberty LE50 pump. Flow is pumped to the ATU through a 2" SCH-40 PVC pipe. A high level audible and visual alarm will activate should the pump fail. Graywater from the residence enters a Infiltrator IM540 gallon graywater tank. Unused graywater flows through two backflow valves prior to joining flow into the aerobic plant into a Clearstream 600NU 600gpd aerobic plant containing a 400-gallon pretreatment tank, an aerobic treatment plant, and a 750-gallon pump chamber containing a submersible well pump. The well pump in the ATU is activated by a time controller allowing the distribution ten times per day with an 8 minute run time with float setting at 340 gallons. A high level audible and visual alarm will activate should the pump fail. Distribution is through a self flushing 100 micron disc filter (Arkal) then through a 1" SCH-40 manifold to a 2000sf. drip tubing field, with *Netifm* drip lines set approximately two feet apart with **0.61 gph** emitters set every two feet, as per the attached schematic. A pressure regulator PMR-MF 30psi installed in the pump tank on the manifold to the field will maintain pressure at 30 psi. A 1" SCH-40 return line is installed to periodically flush the system by cycling a 1" ball valve. Solids caught in the disc filter are flushed each cycle back to the trash tank. Vacuum breakers installed at the highest point on each manifold will prevent siphoning of effluent from higher to lower parts of the field. Field area will be scarified and built up with 4" of Type II or Type III soil, then the drip tubing will be laid and capped with 6" of Type II or Type III soil (**NOT SAND**). The field area will be sodded with grass prior to system startup. **Tank must have at grade risers on each opening with watertight caps that must be at least 65# or have a padlock or can only be removed with tools. A secondary plug, cap, or suitable restraint must be provided below riser cap to prevent tank entry should the cap be damaged or removed, in compliance with Chapter §285.38.**

VOID

DESIGN SPECIFICATIONS:

Daily waste flow: 300 gpd + 40 gpd Personal RV Table III
 Pretreatment tank size: 400 Gal
 Plant Size: Clearstrem 600NU 600 gpd (TCEQ Approved)
 Pump tank size: 750Gal
 Reserve capacity after High Level: 120 Gal (>1/3 day Req'd)
 Application Rate: Ra = 0.2 gal/sf
 Total absorption area: Q/Ra = 340 GPD/0.20 = 1700 sf. (Actual 2000 sf.)
 Total linear feet drip tubing: 1000' *Netifim* drip tubing .61 GPH
 Pump requirement: 500 emitters @ .61 gph @ 30 psi = 5.0833 gpm
 Pump Requirement (cont.): Dominator submersible well pump Dosing volume: 50-70 gal.
 Pump Tank Calculations: 750 Gal (13.15 gal/in.)
 Volume below working level = 12" = 158 gal
 Working level = 340 gal = 26"
 Reserve Requirement = >1/3 day = 120 gal. = 9.25"

**MINIMUM SCOUR VELOCITY (MSV) > 2 FPS
 IN DRIP TUBING W/ NOM. DIA. 0.55" ID**

MSV = 2 FPS $(\pi d^2) / 4 * 7.48 \text{ gal/cf} * 60 \text{ sec/min}$
 MSV = $2(3.14159((.55/12)^2) / 4) * 7.48 * 60$
 MSV = 1.5 gpm MIN FLOW RATE x 3 = 4.5 gpm

VOID

IN RETURN MANIFOLD W/ NOM. DIA 1.049" ID

MSV = 2 FPS $(\pi d^2) / 4 * 7.48 \text{ gal/cf} * 60 \text{ sec/min}$
 MSV = $2(3.14159((1.049/12)^2) / 4) * 7.48 * 60$
 MSV = 5.4 GPM

PIPE AND FITTINGS:

All pipes and fittings in this drip tubing system shall be 1" schedule 40 PVC. All joints shall be sealed with approved solvent-type PVC cement. Clipper type cutters are recommended to prevent PVC burrs during cutting of pipes causing possible plugging. Drip tubing 0.61 gph drip tubing to be used in field.

Designed in accordance with Chapter 285, Subchapter D, §285.30 and §285.40 Texas Commission on Environmental Quality (Effective December 29, 2016)

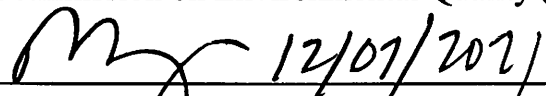
 Greg W. Johnson, P.E. No. 67587 - F-2585
 170 Hollow Oak
 New Braunfels, Texas 78132 830/905-2778

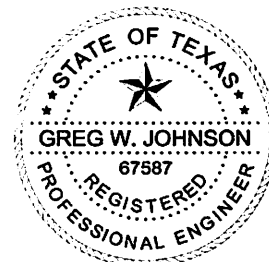

VOID

INSTALL 2000sf OF FIELD USING 1000' OF DRIP TUBING. THERE SHALL BE NO PARKING, DRIVING OR STORAGE ON THE SEPTIC FIELD AT ANY TIME FOR ANY REASON.

*USE TWO WAY CLEANOUTS

**USE SCH-40 OR SDR-26 TO TANK

X= TEST HOLE

CLEARSTREAM
600NU AEROBIC
TREATMENT PLANT

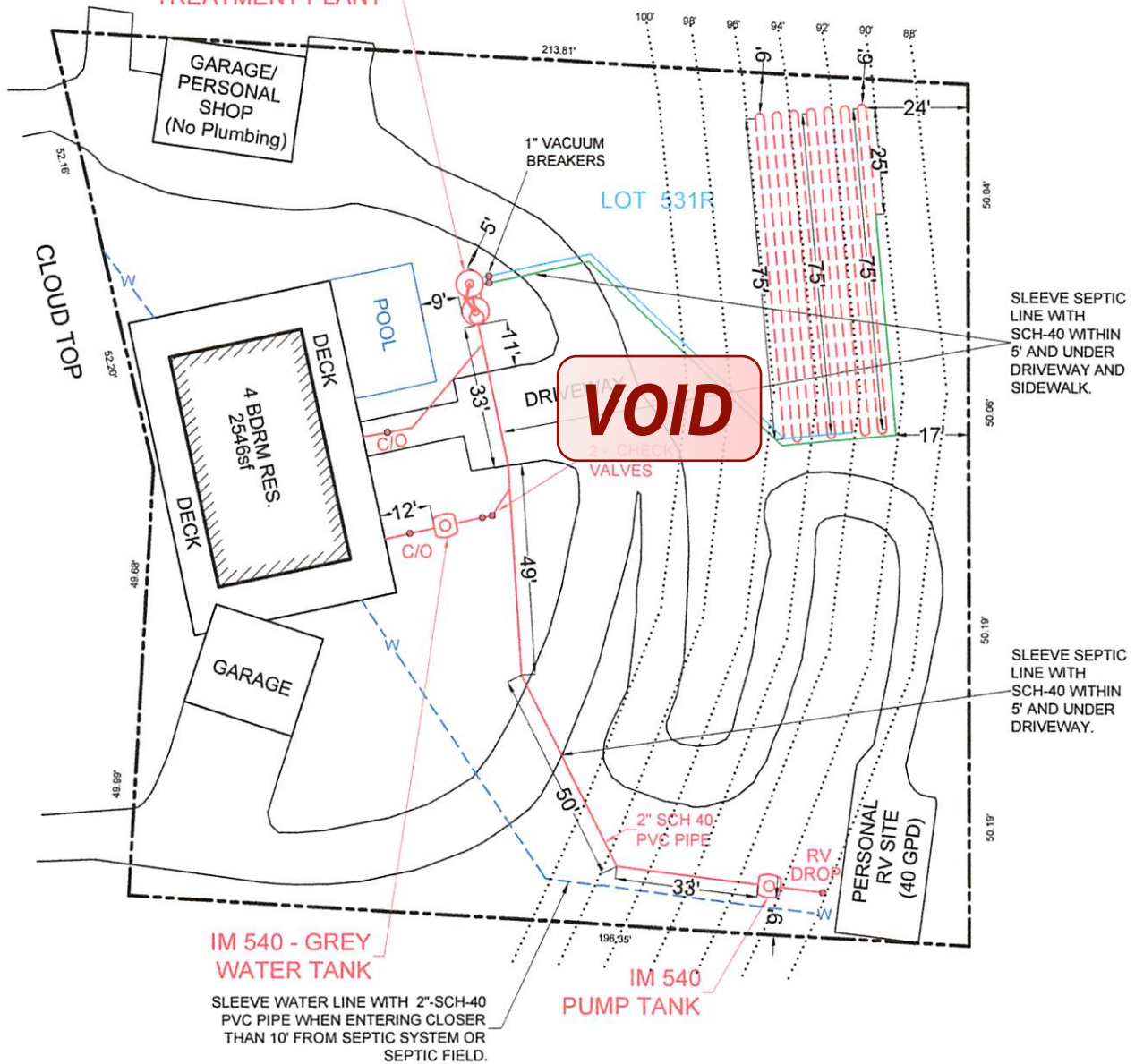

SLEEVE SEPTIC LINE WITH SCH-40 WITHIN 5' AND UNDER DRIVEWAY AND SIDEWALK.

SLEEVE SEPTIC LINE WITH SCH-40 WITHIN 5' AND UNDER DRIVEWAY.

IM 540 - GREY
WATER TANK

SLEEVE WATER LINE WITH 2"-SCH-40 PVC PIPE WHEN ENTERING CLOSER THAN 10' FROM SEPTIC SYSTEM OR SEPTIC FIELD.

IM 540
PUMP TANK



OWNER: NORRIS J. DEVOLL		DRAWN BY: EJS III	
STREET ADDRESS: 552 CLOUD TOP			
LEGAL DESC: SCENIC HEIGHTS	UNIT/SECTION/PHASE: 2	BLOCK:	LOT: 531R
PREPARED BY: GREG W. JOHNSON, P.E. F#002585	SCALE: 1"=40'	DATE: 6/21/2021	2nd REVISION: 12/7/2021





202106023170 04/30/2021 08:32:25 AM 1/5

AMENDMENT TO PLAT

OWNER(S) (as shown on deed(s)): Norris J. DeVoll

MAILING ADDRESS: 13823 Landmark Hill
San Antonio, Texas 78217

LEGAL DESCRIPTION OF PROPERTY:

NAME OF RECORDED SUBDIVISION PLAT (& UNIT NUMBER, if any): Scenic Heights

Subdivision, Lots 531, 532, 533, 534, Unit 2 Comal County

COMAL COUNTY MAP & PLAT RECORDS VOLUME 2 PAGE 3/6 (or) DOC#

LOTS OR TRACTS TO BE COMBINED: 531, 532, 533, 534 RESULTING LOT #: 531R

The signatures affixed below will certify that the owner of the described property hereby amends the plat of the property so as to combine the referenced lots or tracts into a single lot or tract. The property owner acknowledges that this Amendment to Plat may not dissolve or alter any existing easements or other property interests that may exist within the boundaries of this property, and that obtaining release or permission from any owner or beneficiary of easement(s) or other property interest(s) affected by this process shall be the responsibility of the property owner. The owner also certifies that any and all lienholders have acknowledged this Amendment to Plat as per the attached Lienholder Acknowledgment(s), if applicable.

Norris J. DeVoll
OWNER SIGNATURE

OWNER SIGNATURE

Norris J. DeVoll
NAME PRINTED (& title, if applicable)

NAME PRINTED (& title, if applicable)

STATE OF Texas

COUNTY OF Comal

SWORN TO AND SUBSCRIBED before me by Stephanie Lee Huth ~~Stephanie Lee Huth~~ Norris J. DeVoll

on the 6th day of April, 2021



Stephanie Huth
NOTARY PUBLIC

APPROVED BY COMMISSIONERS COURT on the 29th day
of APRIL, 2021

[Signature]
COUNTY JUDGE

ATTEST: Bobbie Koepf
COUNTY CLERK



Filed and Recorded
Official Public Records
Bobbie Koepf, County Clerk
Comal County, Texas
04/30/2021 08:32:25 AM
JESSICA 5 Page(s)
202106023170

Bobbie Koepf

3/c



201806021092 05/31/2018 11:00:23 AM 1/3

NOTICE OF CONFIDENTIALITY RIGHTS: IF YOU ARE A NATURAL PERSON, YOU MAY REMOVE OR STRIKE OUT ANY OF THE FOLLOWING INFORMATION FROM THIS INSTRUMENT BEFORE IT IS FILED FOR RECORD IN THE PUBLIC RECORDS: YOUR SOCIAL SECURITY NUMBER OR YOUR DRIVERS LICENSE NUMBER.

SPECIAL WARRANTY DEED

STATE OF TEXAS §
 § KNOW ALL MEN BY THESE PRESENTS:
COUNTY OF COMAL §

THAT THOMAS J SANDRIDGE, JR TR, hereinafter referred to as 'Grantor', by and through its successor in interest and Successor Trustee, for and in consideration of the sum of TEN AND NO/100 DOLLARS (\$10.00), in cash paid, and other good and valuable consideration paid by the Grantee named below, the receipt in hand and legal sufficiency of which is hereby accepted and acknowledged, has GRANTED, SOLD, and CONVEYED, and by these presents does GRANT, SELL, and CONVEY unto NORRIS J. DEVOLL, hereinafter referred to as Grantee the following described real property, to-wit:

Lot(s) Five Hundred Thirty-one (531) and Five Hundred Thirty-two (532), SCENIC HEIGHTS SUBDIVISION, UNIT # 2, Comal County, Texas, according to plat thereof recorded in Volume 2, Page 36, Map and Plat Records of Comal County, Texas:
being that same parcel and title thereto conveyed to Grantor herein in a certain deed and attached Rider, made a part thereof, as recorded March 13, 1989 in instrument 340816, Volume 0669 page 112, Office of the County Clerk of Comal County, Texas.

This conveyance is made and accepted subject to all those accrued and unpaid taxes against the Property for the current and prior years, resulting court costs that have accrued in a tax suit in one certain cause numbered T-8730A, 22nd District Court, Comal County, Texas, all accrued and unpaid mandatory association dues and transfer fees, which sums shall be assumed and paid by Grantee, and all and singular, those reservations, restrictions, conditions, exceptions, easements, and covenants, applicable to and enforceable against the above described Property as reflected by the records of the County Clerk of Comal County, Texas.

TO HAVE AND TO HOLD the above described Property, together with all and singular the rights and appurtenances thereto in anywise belonging to the Property, subject to the exceptions to conveyance stated above, unto the said Grantee, Grantee's heirs, personal representatives,

RECORDER'S MEMORANDUM
THIS DOCUMENT WAS OF POOR
QUALITY AT THE TIME OF RECORDING
AND MAY NOT REPRODUCE

Handwritten initials

executors, administrators, successors, or assigns; and Grantor hereby binds Grantor's heirs, personal representatives, executors, administrators, successors and assigns to **WARRANT AND FOREVER DEFEND** all and singular the Property unto the Grantee, Grantee's heirs, personal representatives, executors, administrators, successors, and assigns, against every person whomsoever comes lawfully claiming or to claim all or any part of the Property, by or through Grantor herein, but no other, except as to the reservations from and exceptions to conveyance and warranty herein specified.

When the context requires, singular nouns and pronouns include the plural.

Executed this 23rd day of May, 2018 A.D.

THOMAS J SANDRIDGE, JR TR

By: [Signature]
Thomas J. Sandridge III, Successor Trustee

By authority and pursuant to terms of the Uniform Declaration of Trust for the Thomas J Sandridge Jr. Trust, dated November 1st, 1988, with full power and authority set forth in that one certain Rider referenced above and attached hereto as Exhibit "A".

THE STATE OF FLORIDA)
COUNTY OF Hillsborough)

ACKNOWLEDGMENT

Before me, the undersigned authority, on this day personally appeared Thomas J. Sandridge III, known to me to be the person whose name is subscribed to the foregoing instrument, on the basis of Drivers License for true identification, and acknowledged to me that he executed the same in the capacity stated, for the purposes and consideration therein expressed.

Given under my hand and seal of office this 23rd day of May, 2018 AD.

SEAL



[Signature]
Notary Public, State of Florida

After recording, return to:

Norris J. DeVoll
13823 Landmark Hill
San Antonio, TX 78217-1310

Exhibit "A"

0669 0114

RIDER

- (1) The TRUSTEE shall have the power and authority to protect, conserve, sell, lease, encumber or otherwise manage and/or dispose of the real estate, including the authority to accept mortgages on the sale and disposition of the property.
- (2) THOMAS J. SANDRIDGE, JR., is the INITIAL TRUSTEE.
- (3) THOMAS J. SANDRIDGE, III, is the FIRST SUCCESSOR TRUSTEE.
- (4) If THOMAS J. SANDRIDGE, III, be unable so to serve, or to continue to serve, then WENDY S. ALLEN shall serve as SECOND SUCCESSOR TRUSTEE.
- (5) Upon the death or adjudication of incompetency of the INITIAL TRUSTEE, and the recording of a death certificate or adjudication of incompetency in the Public Records of Comal County, Texas, the authority of such person to act as TRUSTEE, and his title to the Trust assets, shall terminate. Title to ALL Trust assets shall automatically and immediately vest in the FIRST SUCCESSOR TRUSTEE, who shall thereafter exercise all of the powers of the TRUSTEE.
- (6) The Resignation of the INITIAL TRUSTEE, executed with the formalities of a deed, and recorded in the Public Records of Comal County, Texas, shall terminate his title to ALL Trust assets, and also his authority to act as TRUSTEE. Title to ALL Trust assets shall automatically and immediately vest in the FIRST SUCCESSOR TRUSTEE, who shall thereafter exercise all of the powers of the TRUSTEE.
- (7) The same procedure and result shall be followed and apply as to the death, incompetency or resignation of the FIRST SUCCESSOR TRUSTEE, once he has so served or is eligible so to serve as TRUSTEE.
- (8) No party dealing with the TRUSTEE in relation to the Trust assets in any manner whatsoever, shall be:
 - (A) obliged to see that the terms of this Declaration of Trust have been complied with;
 - (B) obliged to inquire into the authority, necessity or expediency of any act of the TRUSTEE;
 - (C) privileged to inquire into any of the terms of this Declaration of Trust;
 - (D) privileged to inquire into the authority, necessity or jurisdiction of any Court adjudicating the person serving as TRUSTEE to be incompetent; OR
 - (E) privileged to inquire into the sufficiency of any written, recorded resignation or statement of any person serving as TRUSTEE.
- (9) Every instrument executed or accepted by the TRUSTEE, in relation to Trust property, shall be conclusive evidence in favor of every person claiming any right, title or interest under the Trust, that:
 - (A) at the time of its delivery, the Trust created under this Declaration of Trust was in full force and effect;
 - (B) such instrument was executed or accepted in accordance with the terms and conditions of this Declaration of Trust and its amendments, if any, and is binding upon all beneficiaries under it;
 - (C) the TRUSTEE was duly authorized and empowered to execute, deliver or accept every such instrument; and
 - (D) if a transfer has been made to a successor in trust, such successor has been appointed properly and is vested fully with all the title, estate, powers, duties and obligations of the predecessor in trust.

Thomas J. Sandridge

THIS INSTRUMENT PREPARED BY WILLIAM H. GRACELY, LAWYER
POST OFFICE BOX 1798, NAPLES, FLORIDA 33929

RECORDER'S MEMORANDUM
THIS DOCUMENT WAS OF POOR
QUALITY AT THE TIME OF RECORDING
AND MAY NOT REPRODUCE

Filed and Recorded
Official Public Records
Bobbie Koepf, County Clerk
Comal County, Texas
05/31/2018 11:00:23 AM
JESSICA 3 Page(s)
201806021092



Bobbie Koepf

76

2/e



201806044237 11/14/2018 12:08:17 PM 1/2

NOTICE OF CONFIDENTIALITY RIGHTS: IF YOU ARE A NATURAL PERSON, YOU MAY REMOVE OR STRIKE OUT ANY OF THE FOLLOWING INFORMATION FROM THIS INSTRUMENT BEFORE IT IS FILED FOR RECORD IN THE PUBLIC RECORDS: YOUR SOCIAL SECURITY NUMBER OR YOUR DRIVERS LICENSE NUMBER.

CASH WARRANTY DEED

STATE OF TEXAS §
 § KNOW ALL MEN BY THESE PRESENTS:
COUNTY OF COMAL §

THAT, **DONNYE M. BARNETT REVOCABLE TRUST**, by and through its Trustee **DONNYE M BARNETT TR**, hereinafter referred to as 'Grantor', for and in consideration of the sum of TEN AND NO/100 DOLLARS (\$10.00), in cash paid, and other and further good and valuable consideration given by the Grantee named below, the receipt in hand and sufficiency of which is hereby acknowledged, has GRANTED, SOLD, and CONVEYED, and by these presents does GRANT, SELL, and CONVEY all its right title and interest unto **NORRIS J. DEVOLL**, hereinafter referred to as Grantee, the following described real property, to-wit:

Lot(s) Five Hundred Thirty-three (533) and Five Hundred Thirty-four (534), SCENIC HEIGHTS, UNIT # 2, Comal County, Texas, according to plat thereof recorded in Volume 2, Page 36, Map and Plat Records of Comal County, Texas, being that same parcel of land conveyed by deed dated the 26th day of July, 1984 recorded in Volume 402, Page 294 in the Official Public Record, Comal County, Texas.

RESERVATIONS AND EXCEPTIONS TO CONVEYANCE. This conveyance is made and accepted subject to those accrued and unpaid taxes against the Property for the current year, any prior year and all accrued and unpaid mandatory association dues and transfer fees, which sum(s) shall be assumed and paid by Grantee, and all and singular, those reservations, restrictions, conditions, exceptions, easements, and covenants running with the land that are applicable to and enforceable against the above described Property as reflected by the records of the County Clerk of Comal County, Texas.

TO HAVE AND TO HOLD the above described Property, together with all and singular the rights and appurtenances thereto in anywise belonging to the Property, subject to the exceptions to conveyance stated above, unto the said Grantee, Grantee's heirs, personal representatives, executors, administrators, successors, or assigns; and Grantor hereby binds Grantor's heirs, personal

representatives, executors, administrators, successors and assigns to WARRANT AND FOREVER DEFEND all and singular the Property unto the Grantee, Grantee's heirs, personal representatives, executors, administrators, successors, and assigns, against every person whomsoever comes lawfully claiming or to claim all or any part of the Property except as to the reservations from and exceptions to conveyance and warranty herein specified.

When the context requires, singular nouns and pronouns include the plural.

Executed this 8 day of Nov., 2018 A.D.

DONNYE M BARNETT REVOCABLE TRUST

By authority and pursuant to terms of contract and declaration of trust for the Donnye M Barnett trust, dated March 3, 2008, and amendments thereto.

By:

Donnye M. Barnett
Donnye M. Barnett, Trustee

THE STATE OF GEORGIA)
COUNTY OF Glynn)

ACKNOWLEDGMENT

Before me, the undersigned authority, on this day personally appeared Donnye M. Barnett, known to me to be the person whose name is subscribed to the foregoing instrument, on the basis of GA DRIVERS License for true identification, and acknowledged to me that she executed the this instrument in the true capacity stated and for the purposes and consideration therein expressed.

Given under my hand and seal of office this 8th day of November, 2018 AD.

SEAL

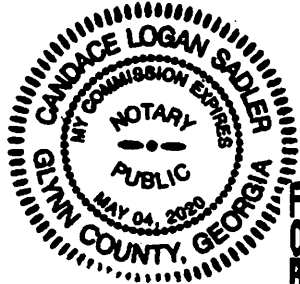

Candace Logan Sadler
Notary Public, State of Georgia

After recording, return to:

Norris J. DeVoll
13823 Landmark Hill
San Antonio, TX 78217-1310

Filed and Recorded
Official Public Records
Bobbie Koepf, County Clerk
Comal County, Texas
11/14/2018 12:08:17 PM
CHRISTY 2 Page(s)
201806044237



Bobbie Koepf