



COMAL COUNTY

ENGINEER'S OFFICE

License to Operate On-Site Sewage Treatment and Disposal Facility

Issued This Date: **03/22/2023** Permit Number: **114782**

Location Description: **109 BOGI ST
CANYON LAKE, TX 78133**

Subdivision: **ROCKY CREEK RANCH**
Unit: **12**
Lot: **403**
Block: **0**
Acreage: **0.0000**

Type of System: **Aerobic
Surface Irrigation**

Issued to: **JESUS & ANTURO BARCENAS**

This license is authorization for the owner to operate and maintain a private facility at the location described in accordance to the rules and regulations for on-site sewerage facilities of Comal County, Texas, and the Texas Commission on Environmental Quality.

The license grants permission to operate the facility. It does not guarantee successful operation. It is the responsibility of the owner to maintain and operate the facility in a satisfactory manner.

Alterations to this permit including, but not limited to:

- Increase in the square feet of living area
- Increase in the number of bedrooms
- A change of use (i.e. residential to commercial)
- Relocation of system components (including the relocation of spray heads)
- Installation of landscaping
- Adding new structures to the system

may require a new permit. **It is the responsibility of the owner to apply for a new permit, if applicable.**

Inspection and licensing of a facility indicates only that the facility meets certain minimum requirements. It does not impede any governmental entity in taking the proper steps to prevent or control pollution, to abate nuisance, or to protect the public health.

This license to operate is valid for an indefinite period. The holder may transfer it to a succeeding owner, provided the facility has not been remodeled and is functioning properly.

Licensing Authority
Comal County Environmental Health

ENVIRONMENTAL HEALTH INSPECTOR

OS0032485

ENVIRONMENTAL HEALTH COORDINATOR

OS0007722

Comal County Environmental Health OSSF Inspection Sheet

Installer Name: _____

OSSF Installer #: _____

1st Inspection Date: _____

2nd Inspection Date: _____

3rd Inspection Date: _____

Inspector Name: _____

Inspector Name: _____

Inspector Name: _____

Permit#:		Address:					
No.	Description	Answer	Citations	Notes	1st Insp.	2nd Insp.	3rd Insp.
1	SITE AND SOIL CONDITIONS & SETBACK DISTANCES Site and Soil Conditions Consistent with Submitted Planning Materials		285.31(a) 285.30(b)(1)(A)(iv) 285.30(b)(1)(A)(v) 285.30(b)(1)(A)(iii) 285.30(b)(1)(A)(ii) 285.30(b)(1)(A)(i)				
2	SITE AND SOIL CONDITIONS & SETBACK DISTANCES Setback Distances Meet Minimum Standards		285.91(10) 285.30(b)(4) 285.31(d)				
3	SEWER PIPE Proper Type Pipe from Structure to Disposal System (Cast Iron, Ductile Iron, Sch. 40, SDR 26)		285.32(a)(1)				
4	SEWER PIPE Slope from the Sewer to the Tank at least 1/8 Inch Per Foot		285.32(a)(3)				
5	SEWER PIPE Two Way Sanitary - Type Cleanout Properly Installed (Add. C/O Every 100' &/or 90 degree bends)		285.32(a)(5)				
6	PRETREATMENT Installed (if required) TCEQ Approved List PRETREATMENT Septic Tank(s) Meet Minimum Requirements		285.32(b)(1)(G) 285.32(b)(1)(E)(iii) 285.32(b)(1)(E)(iv) 285.32(b)(1)(F) 285.32(b)(1)(B) 285.32(b)(1)(C)(i) 285.32(b)(1)(C)(ii) 285.32(b)(1)(D) 285.32(b)(1)(E) 285.32(b)(1)(A) 285.32(b)(1)(E)(ii)(II) 285.32(b)(1)(E)(i) 285.32(b)(1)(E)(ii)(I)				
7	PRETREATMENT Grease Interceptors if required for commercial		285.34(d)				

Inspector Notes:

**Comal County Environmental Health
OSSF Inspection Sheet**

No.	Description	Answer	Citations	Notes	1st Insp.	2nd Insp.	3rd Insp.
8	SEPTIC TANK Tank(s) Clearly Marked SEPTIC TANK If Single Tank, 2 Compartments Provided with Baffle SEPTIC TANK Inlet Flowline Greater than 3" and " T " Provided on Inlet and Outlet SEPTIC TANK Septic Tank(s) Meet Minimum Requirements		285.32(b)(1) (E)285.91(2)285.32(b)(1) (F)285.32(b)(1)(E) (iii)285.32(b)(1)(E)(ii) (II)285.32(b)(1)(E)(ii) (I)285.32(b)(1)(E) (i)285.32(b)(1) (D)285.32(b)(1)(C) (ii)285.32(b)(1)(C) (i)285.32(b)(1) (B)285.32(b)(1) (A)285.32(b)(1)(E)(iv)				
9	ALL TANKS Installed on 4" Sand Cushion/ Proper Backfill Used		285.32(b)(1)(F) 285.32(b)(1)(G) 285.34(b)				
10	SEPTIC TANK Inspection / Clean Out Port & Risers Provided on Tanks Buried Greater than 12" Sealed and Capped		285.38(d)				
11	SEPTIC TANK Secondary restraint system provided SEPTIC TANK Riser permanently fastened to lid or cast into tank SEPTIC TANK Riser cap protected against unauthorized intrusions		285.38(d) 285.38(e)				
12	SEPTIC TANK Tank Volume Installed						
13	PUMP TANK Volume Installed						
14	AEROBIC TREATMENT UNIT Size Installed						
15	AEROBIC TREATMENT UNIT Manufacturer AEROBIC TREATMENT UNIT Model Number						
16	DISPOSAL SYSTEM Absorptive		285.33(a)(4) 285.33(a)(1) 285.33(a)(2) 285.33(a)(3)				
17	DISPOSAL SYSTEM Leaching Chamber		285.33(a)(1) 285.33(a)(3) 285.33(a)(4) 285.33(a)(2)				
18	DISPOSAL SYSTEM Evapo-transpirative		285.33(a)(3) 285.33(a)(4) 285.33(a)(1) 285.33(a)(2)				

**Comal County Environmental Health
OSSF Inspection Sheet**

No.	Description	Answer	Citations	Notes	1st Insp.	2nd Insp.	3rd Insp.
19	DISPOSAL SYSTEM Drip Irrigation		285.33(c)(3)(A)-(F)				
20	DISPOSAL SYSTEM Soil Substitution		285.33(d)(4)				
21	DISPOSAL SYSTEM Pumped Effluent		285.33(a)(4) 285.33(a)(3) 285.33(a)(1) 285.33(a)(2)				
22	DISPOSAL SYSTEM Gravelless Pipe		285.33(a)(3) 285.33(a)(2) 285.33(a)(4) 285.33(a)(1)				
23	DISPOSAL SYSTEM Mound		285.33(a)(3) 285.33(a)(1) 285.33(a)(2) 285.33(a)(4)				
24	DISPOSAL SYSTEM Other (describe) (Approved Design)		285.33(d)(6) 285.33(c)(4)				
25	DRAINFIELD Absorptive Drainline 3" PVC or 4" PVC						
26	DRAINFIELD Area Installed						
27	DRAINFIELD Level to within 1 inch per 25 feet and within 3 inches over entire excavation		285.33(b)(1)(A)(v)				
28	DRAINFIELD Excavation Width DRAINFIELD Excavation Depth DRAINFIELD Excavation Separation DRAINFIELD Depth of Porous Media DRAINFIELD Type of Porous Media						
29	DRAINFIELD Pipe and Gravel - Geotextile Fabric in Place		285.33(b)(1)(E)				
30	DRAINFIELD Leaching Chambers DRAINFIELD Chambers - Open End Plates w/Splash Plate, Inspection Port & Closed End Plates in Place (per manufacturers spec.)		285.33(c)(2)				
31	LOW PRESSURE DISPOSAL SYSTEM Adequate Trench Length & Width, and Adequate Separation Distance between Trenches		285.33(d)(1)(C)(i)				

**Comal County Environmental Health
OSSF Inspection Sheet**

No.	Description	Answer	Citations	Notes	1st Insp.	2nd Insp.	3rd Insp.
32	EFFLUENT DISPOSAL SYSTEM Utilized Only by Single Family Dwelling EFFLUENT DISPOSAL SYSTEM Topographic Slopes < 2.0% EFFLUENT DISPOSAL SYSTEM Adequate Length of Drain Field (1000 Linear ft. for 2 bedrooms or Less & an additional 400 ft. for each additional bedroom) EFFLUENT DISPOSAL SYSTEM Lateral Depth of 18 inches to 3 ft. & Vertical Separation of 1ft on bottom and 2 ft. to restrictive horizon and ground water respectfully EFFLUENT DISPOSAL SYSTEM Lateral Drain Pipe (1.25 - 1.5" dia.) & Pipe Holes (3/16 - 1/4" dia. Hole Size) 5 ft. Apart		285.33(b)(3)(A) 285.33(b)(3)(A) 285.33(b)(3)(B) 285.91(13) 285.33(b)(3)(D) 285.33(b)(3)(F)				
33	AEROBIC TREATMENT UNIT Is Aerobic Unit Installed According to Approved Guidelines.		285.32(c)(1)				
34	AEROBIC TREATMENT UNIT Inspection/Clean Out Port & Risers Provided AEROBIC TREATMENT UNIT Secondary restraint system provided AEROBIC TREATMENT UNIT Riser permanently fastened to lid or cast into tank AEROBIC TREATMENT UNIT Riser cap protected against unauthorized intrusions						
35	AEROBIC TREATMENT UNIT Chlorinator Properly Installed with Chlorine Tablets in Place.						
36	PUMP TANK Is the Pump Tank an approved concrete tank or other acceptable materials & construction PUMP TANK Sampling Port Provided in the Treated Effluent Line PUMP TANK Check Valve and/or Anti- Siphon Device Present When Required PUMP TANK Audible and Visual High Water Alarm Installed on Separate Circuit From Pump						
37	PUMP TANK Inspection/Clean Out Port & Risers Provided PUMP TANK Secondary restraint system provided PUMP TANK Riser permanently fastened to lid or cast into tank PUMP TANK Riser cap protected against unauthorized intrusions						
38	PUMP TANK Secondary restraint system provided						
39	PUMP TANK Electrical Connections in Approved Junction Boxes / Wiring Buried						

**Comal County Environmental Health
OSSF Inspection Sheet**

No.	Description	Answer	Citations	Notes	1st Insp.	2nd Insp.	3rd Insp.
40	APPLICATION AREA Distribution Pipe, Fitting, Sprinkler Heads & Valve Covers Color Coded Purple?		285.33(d)(2)(G)(iii)(II) 285.33(d)(2)(G)(iii)(III) 285.33(d)(2)(G)(v) 285.33(d)(2)(G)(iii) 285.33(d)(2)(G)(iv) 285.33(d)(2)(G)(i) 285.33(d)(2)(G)(ii) 285.33(d)(2)(G)(iii)(I)				
41	APPLICATION AREA Low Angle Nozzles Used / Pressure is as required APPLICATION AREA Acceptable Area, nothing within 10 ft of sprinkler heads? APPLICATION AREA The Landscape Plan is as Designed		285.33(d)(2)(G) (i)285.33(d)(2) (A)285.33(d)(2)(F)				
42	APPLICATION AREA Area Installed						
43	PUMP TANK Meets Minimum Reserve Capacity Requirements						
44	PUMP TANK Material Type & Manufacturer						
45	PUMP TANK Type/Size of Pump Installed						



COMAL COUNTY

ENGINEER'S OFFICE

Permit of Authorization to Construct an On-Site Sewage Facility Permit Valid For One Year From Date Issued

Permit Number: 114782
Issued This Date: 06/30/2022
This permit is hereby given to: JESUS & ANTURO BARCENAS

To start construction of a private, on-site sewage facility located at:

109 BOGI ST
CANYON LAKE, TX 78133

Subdivision: ROCKY CREEK RANCH
Unit: 12
Lot: 403
Block: 0
Acreage: 0.0000

APPROVED MINIMUM SIZES AS PER ATTACHED DESIGN

Type of System: Aerobic
Surface Irrigation

This permit gives permission for the construction of the above referenced on-site facility to commence. Installation must be completed by an installer holding a valid registration card from the Texas Commission on Environmental Quality (TCEQ). Installation and inspection must comply with current TCEQ and Comal County requirements.

Call (830) 608-2090 to schedule inspections.



COMAL COUNTY
ENGINEER'S OFFICE

**OSSF DEVELOPMENT APPLICATION
CHECKLIST**

Staff will complete shaded items

--	--

Date Received

Initials

114782

Permit Number

Instructions:

Place a check mark next to all items that apply. For items that do not apply, place "N/A". This OSSF Development Application Checklist must accompany the completed application.

OSSF Permit

- Completed Application for Permit for Authorization to Construct an On-Site Sewage Facility and License to Operate
- Site/Soil Evaluation Completed by a Certified Site Evaluator or a Professional Engineer
- Planning Materials of the OSSF as Required by the TCEQ Rules for OSSF Chapter 285. Planning Materials shall consist of a scaled design and all system specifications.
- Required Permit Fee - See Attached Fee Schedule
- Copy of Recorded Deed
- Surface Application/Aerobic Treatment System
- Recorded Certification of OSSF Requiring Maintenance/Affidavit to the Public
- Signed Maintenance Contract with Effective Date as Issuance of License to Operate

I affirm that I have provided all information required for my OSSF Development Application and that this application constitutes a completed OSSF Development Application.

Signature of Applicant

6/24/2022

Date

___ COMPLETE APPLICATION
Check No. _____ Receipt No. _____

INCOMPLETE APPLICATION ___ (Missing Items Circled, Application Refeused)

RECEIVED

By Kathy Griffin at 12:50 pm, Jun 24, 2022



COMAL COUNTY ENGINEER'S OFFICE

ON-SITE SEWAGE FACILITY APPLICATION

195 DAVID JONAS DR NEW BRAUNFELS, TX 78132 (830) 608-2090 WWW.CCEO.ORG

Date JUNE 8, 2022

Permit Number 114782

1. APPLICANT / AGENT INFORMATION

Owner Name JESUS BARCENAS & ARTURO BARCENAS Agent Name GREG W. JOHNSON, P.E. Mailing Address c/o 23011 FM 306 Agent Address 170 Hollow Oak City, State, Zip Canyon Lake, TX 78133 New Braunfels, TX 78132 Phone # 830-935-4936 830-905-2778 Email katelyn@psseptics.com gregjohnsonpe@yahoo.com

2. LOCATION

Subdivision Name ROCKY CREEK RANCH Unit PHASE 12 Lot 403 Block Survey Name / Abstract Number Address 109 BOGI City CANYON LAKE State TX Zip 78133

3. TYPE OF DEVELOPMENT

[X] Single Family Residential Type of Construction (House, Mobile, RV, Etc.) HOUSE Number of Bedrooms 3 Indicate Sq Ft of Living Area 1987

[] Non-Single Family Residential (Planning materials must show adequate land area for doubling the required land needed for treatment units and disposal area) Type of Facility Offices, Factories, Churches, Schools, Parks, Etc. - Indicate Number Of Occupants Restaurants, Lounges, Theaters - Indicate Number of Seats Hotel, Motel, Hospital, Nursing Home - Indicate Number of Beds Travel Trailer/RV Parks - Indicate Number of Spaces Miscellaneous

Estimated Cost of Construction: \$ 315,000 (Structure Only)

Is any portion of the proposed OSSF located in the United States Army Corps of Engineers (USACE) flowage easement?

[] Yes [X] No (If yes, owner must provide approval from USACE for proposed OSSF improvements within the USACE flowage easement)

Source of Water [X] Public [] Private Well

4. SIGNATURE OF OWNER

By signing this application, I certify that:

- The completed application and all additional information submitted does not contain any false information and does not conceal any material facts. I certify that I am the property owner or I possess the appropriate land rights necessary to make the permitted improvements on said property.
- Authorization is hereby given to the permitting authority and designated agents to enter upon the above described property for the purpose of site/soil evaluation and inspection of private sewage facilities..
- I understand that a permit of authorization to construct will not be issued until the Floodplain Administrator has performed the reviews required by the Comal County Flood Damage Prevention Order.
- I affirmatively consent to the online posting/public release of my e-mail address associated with this permit application, as applicable.

Signature of Owner Arturo Barcenas

Date JUNE 8, 2022

*** COMAL COUNTY OFFICE OF ENVIRONMENTAL HEALTH ***

APPLICATION FOR PERMIT FOR AUTHORIZATION TO CONSTRUCT AN ON-SITE SEWAGE FACILITY AND LICENSE TO OPERATE

Planning Materials & Site Evaluation as Required Completed By GREG W. JOHNSON, P.E.

System Description PROPRIETARY; AEROBIC TREATMENT AND SURFACE IRRIGATION

Size of Septic System Required Based on Planning Materials & Soil Evaluation

Tank Size(s) (Gallons) MAXX AIR M600 Absorption/Application Area (Sq Ft) 4241

Gallons Per Day (As Per TCEQ Table III) 240

(Sites generating more than 5000 gallons per day are required to obtain a permit through TCEQ)

Is the property located over the Edwards Recharge Zone? [] Yes [X] No

(If yes, the planning materials must be completed by a Registered Sanitarian (R.S.) or Professional Engineer (P.E.))

Is there an existing TCEQ approved WPAP for the property? [] Yes [X] No

(if yes, the R. S. or P. E. shall certify that the OSSF design complies with all provisions of the existing WPAP.)

If there is no existing WPAP, does the proposed development activity require a TCEQ approved WPAP? [] Yes [] No

(If yes, the R.S. or P. E. shall certify that the OSSF design will comply with all provisions of the proposed WPAP. A Permit to Construct will not be issued for the proposed OSSF until the proposed WPAP has been approved by the appropriate regional office.)

Is the property located over the Edwards Contributing Zone? [X] Yes [] No

Is there an existing TCEQ approval CZP for the property? [] Yes [X] No

(if yes, the P.E. or R.S. shall certify that the OSSF design complies with all provisions of the existing CZP)

If there is no existing CZP, does the proposed development activity require a TCEQ approved CZP? [] Yes [X] No

(if yes, the P.E. or R.S. shall certify that the OSSF design will comply with all provisions of the proposed CZP. A Permit to construct will not be issued for the proposed OSSF until the CZP has been approved by the appropriate regional office.)

Is this property within an incorporated city? [] Yes [X] No

If yes, indicate the city: _____

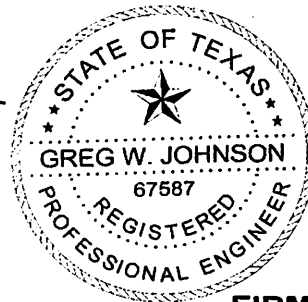

FIRM #2585

By signing this application, I certify that:

- The information provided above is true and correct to the best of my knowledge.
- I affirmatively consent to the online posting/public release of my e-mail address associated with this permit application, as applicable

Signature of Designer (Handwritten Signature)

Date June 21, 2022

AFFIDAVIT

**THE COUNTY OF COMAL
STATE OF TEXAS**

CERTIFICATION OF OSSF REQUIRING MAINTENANCE

According to Texas Commission on Environmental Quality Rules for On-Site Sewage Facilities (OSSF's), this document is filed in the Deed Records of Comal County, Texas.

I

The Texas Health and Safety Code, Chapter 366 authorizes the Texas Commission on Environmental Quality (TCEQ) to regulate on-site sewage facilities (OSSFs). Additionally, the Texas Water Code (TWC), § 5.012 and § 5.013, gives the commission primary responsibility for implementing the laws of the State of Texas relating to water and adopting rules necessary to carry out its powers and duties under the TWC. The commission, under the authority of the TWC and the Texas Health and Safety code, requires owner's to provide notice to the public that certain types of OSSFs are located on specific pieces of property. To achieve this notice, the commission requires a recorded affidavit. Additionally, the owner must provide proof of the recording to the OSSF permitting authority. This recorded affidavit is not a representation or warranty by the commission of the suitability of this OSSF, nor does it constitute any guarantee by the commission that the appropriate OSSF was installed.

II

An OSSF requiring a maintenance contract, according to 30 Texas Administrative Code §285.91(12) will be installed on the property described as (insert legal description):

12 UNIT/PHASE/SECTION BLOCK 403 LOT ROCKY CREEK RANCH SUBDIVISION

IF NOT IN SUBDIVISION: ACREAGE SURVEY

The property is owned by (insert owner's full name): JESUS BARCENAS & ARTURO BARCENAS

This OSSF must be covered by a continuous maintenance contract for the first two years. After the initial two-year service policy, the owner of an aerobic treatment system for a single family residence shall either obtain a maintenance contract within 30 days or maintain the system personally.

Upon sale or transfer of the above-described property, the permit for the OSSF shall be transferred to the buyer or new owner. A copy of the planning materials for the OSSF can be obtained from the Comal County Engineer's Office.

WITNESS BY HAND(S) ON THIS 8 DAY OF June, 2022

ARTURO BARCENAS

JESUS BARCENAS

ARTURO BARCENAS

ARTURO BARCENAS

Owner(s) Signature(s)

Owner (s) Printed name (s)

Jesus + Arturo Barcenas SWORN TO AND SUBSCRIBED BEFORE ME ON THIS 8 DAY OF June, 2022

Katelyn Neumann
Notary Public Signature

THIS AREA FOR COMAL COUNTY CLERK RECORDING PURPOSES ONLY

Filed and Recorded
Official Public Records
Bobbie Koepf, County Clerk
Comal County, Texas
06/23/2022 09:55:12 AM
TERRI 1 Pages(s)
202206028978

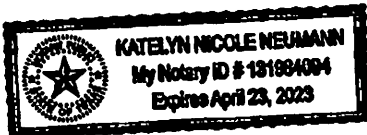

(Notary Seal Here)



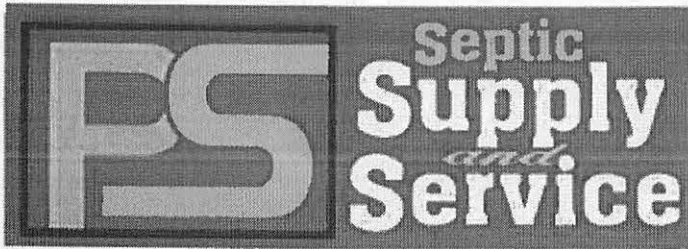

PAUL SWOYER SEPTIC SUPPLY & SERVICE
23011 FM 306
CANYON LAKE, TX 78133

MP#0001708
CHRISTOPHER RYAN SEIDENSTICKER

PROPERTY LEGAL DESCRIPTION:

LOT 403, ROCKY CREEK RANCH, PHASE 12

Customer: JESUS BARCENAS & ARTURO BARCENAS

Site Address: 109 BOGI

City/State: CANYON LAKE, TEXAS Zip: 78133

County: COMAL Permit#:

Phone Number:

E-mail:

I. General: This On-Site Sewage Facility Service Agreement (hereinafter referred to as "Agreement") is entered into by and between JESUS BARCENAS & ARTURO BARCENAS, (hereinafter referred to as "Client") and PS Supply & Service LLC. (hereinafter referred to as "Contractor"). By this agreement, Contractor agrees to render services, as described herein (the "Services"), and the client agrees to fulfill his/her/their responsibilities under this agreement herein.

II. Effective Dates: This agreement commences on the date of License to Operate is issued for Three (3) years.

Date of License to Operate: LTO Last Date of Service: 3 yrs from LTO

III. Services by Contractor: Contractor will provide the following Services:

- 1. Inspect and perform routine maintenance on the On-Site Sewage Facility ("OSSF") in compliance with the code, regulations, and/or rules of the Texas Commission on Environmental Quality ("TCEQ") and county in which the OSSF is located (the "County") and the manufacturer's requirements, at a frequency of approximately once every four (4) months.
2. Report to the appropriate regulatory authority and to Client, as required by the State of Texas' on-site rules and, if required, TCEQ or County rules. All findings must be reported to the appropriate regulatory authority within 14 days.
3. Notify Client and repair any components of the OSSF that are found to be in need of repair during the inspection. If warranty, you just do it. If not, Client will be responsible. Repairs will be made so brought up to compliance and bill forward.
4. Visit site in response to Client's request for unscheduled service within two business days from the date of Contractor's actual receipt of Client's request. Unscheduled service visits are not included in the fee agreement herein and will be billed to the client in addition to fees under this Agreement.
5. Provide notification of arrival to site to the Client or to site personnel. Additionally, Contractor will leave written notification of the visit at the site or with site personnel upon completion of inspection, and forward such notice to the appropriate regulatory authority within fourteen (14) days.

IV. Payment(s): Client shall pay to Contractor included w/ septic, for the Services describe herein (the "Inspection and Routine Maintenance Fee"), excepting those described in Section III (4), or Section IX, herein. The Fee does not include equipment, parts or labor supplied for anything beyond routine inspection and routine maintenance. Payments for such additional services are due at the time services are provided or rendered. Payments not received within thirty (30) days from the due date will be subject the greater of a \$20.00 late penalty or 1.5% carrying charge on the original balance for each month or portion thereof a balance in past due. If for any reason such charges are found to be usurious by a court of competent jurisdiction, such charges shall be reduced to the maximum allowable by law. By signing this contract, Client authorizes Contractor to remove any parts installed, but not paid in full at the end of the thirty (30) days. Client agrees to pay for any labor cost associated with the installation and the reasonable cost of removal of said parts.

Client: [Signature]

Contractor: [Signature]

V. Client's Responsibilities: Client is responsible for each and all of the following:

1. To maintain chlorinator and provide proper chlorine supply, if OSSF is so equipped.
2. To provide all necessary yard or lawn maintenance and removal of obstacles as needed to allow the OSSF to function properly, and to allow Contractor ready access to all parts of the OSSF.
3. To maintain a current license to operate, and abide by the conditions and limitations of that license and all requirements for on-site sewage facilities from the State and local regulatory agency.
4. To maintain the OSSF in accordance with manufacturer's recommendations.
5. To immediately notify Contractor and Agency of any and all problems with, the OSSF, including failure thereof.
6. Upon receipt of any written notification of required services from Contractor, to contact Contractor and authorize the required service. If Client elects a different contractor to perform the required service, Client is responsible for ensuring the substitute contractor holds the proper license (Installer II) and is certified by the manufacturer. Additionally, Client shall be responsible for ensuring proper notification is given to the appropriate regulatory authority, as required by the State and/or local regulatory authority rules.
7. To provide Contractor with water usage records, upon request, for evaluation by Contractor of the OSSF performance.
8. To pay required sampling charges for samples collected for testing (e.g. Biological Oxygen Demand/Total Suspended Solids ("BOD/TSS")) that may be required on the OSSF.
9. To prevent backwash from water treatment or water conditioning equipment to enter the OSSF.
10. To provide, at Client's expense, for pumping of tanks as needed.
11. To maintain site drainage sufficient to prevent adverse effects on the OSSF.
12. To promptly and fully pay Contractor's bills, fees, or invoices as described herein.

VI. Access by Contractor: Client agrees to allow Contractor, or personnel authorized by the Contractor, to enter the property at reasonable times without prior notice for the purpose of performing the Services described herein. Such entry shall include access to the OSSF electrical and physical components, including tanks, by means of manways or risers for the purpose of evaluations required by the manufacturer, and/or regulatory authority rules. If such manways or risers are not in place, Client shall allow and be responsible for payment of required excavation, including labor and materials, necessary to allow access to the OSSF or any required components. Such excavation shall be billed at the rate of \$75.00 per hour for labor, plus materials billed at list price. Contractor shall make only those efforts reasonable under the circumstances to replace excavated soil.

VII. Application or Transfer of Payment: The fees paid for this agreement may transfer to any subsequent owner(s) of the property on which the OSSF is located. The subsequent owner(s) must sign a similar agreement authorizing Contractor to perform the above-described Services, and accepting Client's responsibilities. The replacement Agreement must be signed and received within 30 days of transfer of ownership. Contractor will apply all funds received from Client first to any past due obligations arising from this Agreement including late charges, return check charges, and charges for repairs or services not paid within 30 days of invoicing. The consumption of the payment in this manner may lead to termination of the agreement by Contractor

VIII. Termination of Agreement: This agreement may be terminated by either party with 30 days written notice. If this agreement is so terminated by Client, Contractor shall be paid at the rate of \$75.00 per hour for any worked performed or required, but not yet paid. If terminated by Contractor, all amounts outstanding shall be due within thirty days of termination. The party terminating will immediately notify the other party, the equipment manufacturer, and the regulatory agency of the termination.

IX. Limitation of Liability: In no event shall Contractor be liable for indirect, consequential, incidental or punitive damages, whether in contract, tort, or any other theory of liability. In no event shall the Contractor's liability for direct damages exceed payments by the Client under this Agreement.

X. Severability and Reformation: If any provision in this Agreement shall be held to be invalid or unenforceable for any reason, it shall be reformed to the minimum extent necessary to effect the intent of the Parties. If any provision is such that it cannot reasonably be reformed, it shall be struck from this Agreement and the remaining provisions shall continue to be valid and enforceable.

XI. Performance of Agreement: Commencement of performance by Contractor under this agreement is contingent on the following conditions: (1) Contractor receiving a fully executed original copy of this agreement. (2) Contractor receiving payment in full of the fee(s) described herein. If the above conditions are not met, then Contractor is from any obligation to perform any portion of this agreement.

XII. Modification. This Agreement may not be changed or modified except by an instrument in writing, signed by both Contractor and Client.

XIII. Waiver. Except as otherwise noted in this Agreement, the waiver by other party of a breach of any provision of this Agreement shall not operate or be construed as a continuing waiver or as a consent to or waiver of any subsequent breach hereof.

Client: A.B

Contractor: KS

XIV. Headings. The Article and Section headings in this Agreement are for the convenience of reference only and do not constitute a part of this Agreement and shall not be deemed to limit or affect any of the provisions hereof.

XV. GOVERNING LAW AND CHOICE OF VENUE. EACH OF THE PARTIES HERETO HEREBY CONSENTS TO THE EXCLUSIVE JURISDICTION OF THE COURTS OF THE STATE OF TEXAS, COUNTY OF COMAL, AND TO THE UNITED STATES DISTRICT COURT FOR THE WESTERN DISTRICT OF TEXAS – SAN ANTONIO DIVISION, AS WELL AS TO THE JURISDICTION OF ALL COURTS TO WHICH AN APPEAL MAY BE TAKEN FROM SUCH COURTS, FOR THE PURPOSE OF ANY SUIT, ACTION, OR OTHER PROCEEDING ARISING OUT OF, OR IN CONNECTION WITH, THIS AGREEMENT OR ANY OF THE TRANSACTIONS CONTEMPLATED HEREBY, INCLUDING, WITHOUT LIMITATION, ANY PROCEEDING RELATING TO ANCILLARY MEASURES IN AID OF ARBITRATION, PROVISIONAL REMEDIES AND INTERIM RELIEF, OR ANY PROCEEDING TO ENFORCE ANY ARBITRAL DECISION OR AWARD. EACH PARTY HERETO EXPRESSLY WAIVES ANY AND ALL RIGHTS TO BRING ANY SUIT, ACTION, OR OTHER PROCEEDING IN OR BEFORE ANY COURT OR TRIBUNAL OTHER THAN COURTS OF THE STATE OF TEXAS, COUNTY OF COMAL, AND COVENANTS THAT IT SHALL NOT SEEK IN ANY MANNER TO PROSECUTE OR DEFEND ANY DISPUTE OTHER THAN AS SET FORTH IN THIS ARTICLE XVI OR TO CHALLENGE OR SET ASIDE ANY DECISION, AWARD, OR JUDGMENT OBTAINED IN ACCORDANCE WITH THE PROVISIONS HEREOF. EACH OF THE PARTIES HERETO HEREBY EXPRESSLY WAIVES ANY AND ALL OBJECTIONS IT MAY HAVE TO VENUE, INCLUDING, WITHOUT LIMITATION, THE INCONVENIENCE OF SUCH FORUM, IN ANY OF SUCH COURTS.

XVI. JURY TRIAL WAIVER. THE PARTIES HEREBY UNCONDITIONALLY WAIVE THEIR RIGHT TO A JURY TRIAL OF ANY AND ALL CLAIMS OR CAUSES OF ACTION ARISING FROM OR RELATING TO THEIR RELATIONSHIP. THE PARTIES ACKNOWLEDGE THAT A RIGHT TO A JURY IS A CONSTITUTIONAL RIGHT. THAT THEY HAVE HAD AN OPPORTUNITY TO CONSULT WITH INDEPENDENT COUNSEL. AND THAT THIS JURY WAIVER HAS BEEN ENTERED INTO KNOWINGLY AND VOLUNTARILY BY ALL PARTIES TO THIS AGREEMENT. IN THE EVENT OF LITIGATION, THIS AGREEMENT MAY BE FILED AS A WRITTEN CONSENT TO A TRIAL BY THE COURT.

Approved by Contractor: 

MP#0001708
CHRISTOPHER RYAN SEIDENSTICKER

Approved by Client: 

XVII. Reservation of Rights. Contractor reserves all rights not specifically granted herein.

XVIII. Counterparts. This Agreement may be executed in one or more counterparts, each of which shall be deemed to be an original but all of which together will constitute one and the same instrument.

XIX. Counsel. Contractor has previously recommended that Client engage counsel to assist him/her/it in reviewing this Agreement and all other matters relating to it. Contractor and Client shall each bear his/her/its own costs and expenses in connection with the negotiation and documentation of this Agreement.

XX. Entire Agreement: This agreement contains the entire agreement of the parties, and there are no promises or conditions in any other agreement, oral or written. The Parties expressly disclaim reliance on any prior statements, oral or written, by either party not expressly provided for herein.



Client: 

Contractor: 

Greg W. Johnson, P.E.
170 Hollow Oak
New Braunfels, Texas 78132
830/905-2778

June 21, 2022

Comal County Office of Environmental Health
195 David Jonas Drive
New Braunfels, Texas 78132-3760

RE- Septic Design
109 BOGI STREET
ROCKY CREEK RANCH, PHASE 12, LOT 403
CANYON LAKE, TX 78133
BARCENAS RESIDENCE

Brandon/Brenda,

Due to the lack of available application area it is necessary to have the setback from the property line to the spray at ten feet as required by TCEQ Chapter 285 rules Table X. I hereby request a variance to the twenty foot setback to property lines as required by Comal County Order and equivalent protection will be maintained by including a battery backup to the timer clock to assure sprayers to only spray during the predawn hours. In my professional opinion this variance will not pose a threat to the environment or public health.

If I can be of further assistance please contact me.

Respectfully yours,

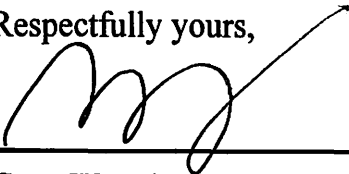

Greg W. Johnson, P.E., F#2585

June 21, 2022

Date

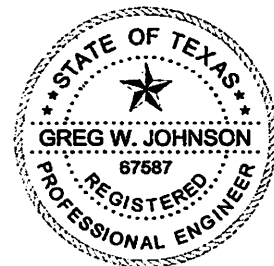

**ON-SITE SEWERAGE FACILITY
SOIL EVALUATION REPORT INFORMATION**

Date Soil Survey Performed: June 20, 2022

Site Location: ROCKY CREEK RANCH, PHASE 12, LOT 403

Proposed Excavation Depth: N/A

Requirements:

At least two soil excavations must be performed on the site, at opposite ends of the proposed disposal area. Locations of soil boring or dug pits must be shown on the site drawing. For subsurface disposal, soil evaluations must be performed to a depth of at least two feet below the proposed excavation depth. For surface disposal, the surface horizon must be evaluated. Describe each soil horizon and identify any restrictive features on the form. Indicate depths where features appear.

SOIL BORING NUMBER <u> </u> SURFACE EVALUATION <u> </u>						
Depth (Feet)	Texture Class	Soil Texture	Gravel Analysis	Drainage (Mottles/ Water Table)	Restrictive Horizon	Observations
0	III	CLAY LOAM	N/A	NONE OBSERVED	LIMESTONE @ 12"	BROWN
1						
2						
3						
4						
5						

SOIL BORING NUMBER <u> </u> SURFACE EVALUATION <u> </u>						
Depth (Feet)	Texture Class	Soil Texture	Gravel Analysis	Drainage (Mottles/ Water Table)	Restrictive Horizon	Observations
0	SAME		AS		ABOVE	
1						
2						
3						
4						
5						

I certify that the findings of this report are based on my field observations and are accurate to the best of my ability.

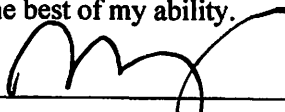

Greg W. Johnson, P.E. 67587-F2585, S.E. 11561

06/20/2022
Date

OSSF SOIL EVALUATION REPORT INFORMATION

Date: June 21, 2022

Applicant Information:

Name: JESUS & ARTURO BARCENAS
Address: c/o 23011 F.M. 306
City: CANYON LAKE State: TEXAS
Zip Code: 78133 Phone: (830) 935-4936

Site Evaluator Information:

Name: Greg W. Johnson, P.E., R.S., S.E. 11561
Address: 170 Hollow Oak
City: New Braunfels State: Texas
Zip Code: 78132 Phone & Fax (830)905-2778

Property Location:

Lot 403 Unit 12 Blk Subd. ROCKY CREEK RANCH
Street Address: 109 BOGI STREET
City: CANYON LAKE Zip Code: 78133
Additional Info.:

Installer Information:

Name:
Company:
Address:
City: State:
Zip Code: Phone

Topography: Slope within proposed disposal area: 6 to 15 %

Presence of 100 yr. Flood Zone: YES NO X
Existing or proposed water well in nearby area. YES NO X
Presence of adjacent ponds, streams, water impoundments YES NO X
Presence of upper water shed YES NO X
Organized sewage service available to lot YES NO X

Design Calculations for Aerobic Treatment with Spray Irrigation:

Commercial

Q = GPD

Residential Water conserving fixtures to be utilized? Yes X No

Number of Bedrooms the septic system is sized for: 3 Total sq. ft. living area 1987

Q gal/day = (Bedrooms +1) * 75 GPD - (20% reduction for water conserving fixtures)

Q = (3 +1)*75-(20%)= 240

Trash Tank Size 353 Gal.

TCEQ Approved Aerobic Plant Size 600 G.P.D.

Req'd Application Area = Q/Ri = 240 / 0.064 = 3750 sq. ft.

Application Area Utilized = 4241 sq. ft.

Pump Requirement 12 Gpm @ 41 Psi (Redjacket 0.5 HP 18 G.P.M. series or equivalent)

Dosing Cycle: ON DEMAND or X TIMED TO DOSE IN PREDAWN HOURS

Pump Tank Size = 768 Gal. 14.5 Gal/inch.

Reserve Requirement = 80 Gal. 1/3 day flow.

Alarms: Audible & Visual High Water Alarm & Visual Air Pump malfunction

With Chlorinator NSF/TCEQ APPROVED

SCH-40 or SDR-26 3" or 4" sewer line to tank

Two way cleanout

Pop-up rotary sprinkler heads w/ purple non-potable lids

1" Sch-40 PVC discharge manifold

APPLICATION AREA SHOULD BE SEEDED AND MAINTAINED WITH VEGETATION.

EXPOSED ROCK WILL BE COVERED WITH SOIL OR MULCH.

I HAVE PERFORMED A THOROUGH INVESTIGATION BEING A REGISTERED PROFESSIONAL ENGINEER AND SITE EVALUATOR IN ACCORDANCE WITH CHAPTER 285, SUBCHAPTER D, §285.30, & §285.40 (REGARDING RECHARGE FEATURES), TEXAS COMMISSION OF ENVIRONMENTAL QUALITY (EFFECTIVE DECEMBER 29, 2016)

Signature of Greg W. Johnson
GREG W. JOHNSON, P.E. F#002585 - S.E. 11561

06/21/2022
DATE

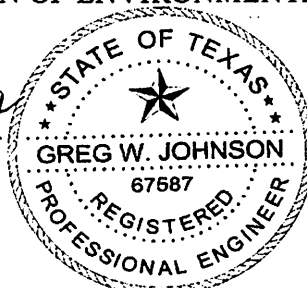

FIRM #2585

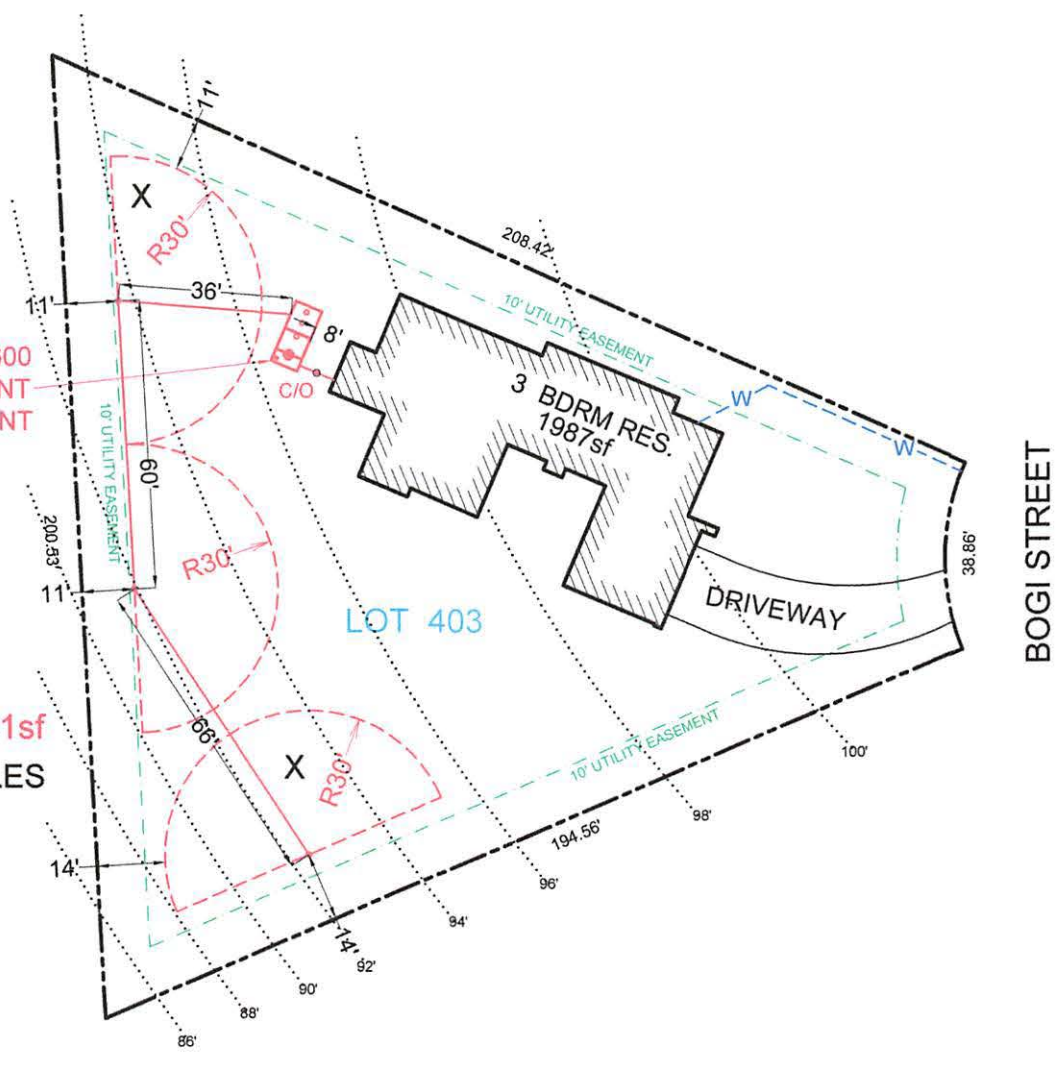

MAXX AIR M-600
AEROBIC TREATMENT
PLANT

SPRAY AREA = 4241sf
X= TEST HOLES

LOT 403

3 BDRM RES.
1987sf

DRIVEWAY

BOGI STREET



OWNER: JESUS & ARTURO BARCENAS		DRAWN BY: EJS III	
STREET ADDRESS: 109 BOGI STREET			
LEGAL DESC: ROCKY CREEK RANCH	UNIT/SECTION/PHASE: 12	BLOCK: 12	LOT: 403
PREPARED BY: GREG W. JOHNSON, P.E. F#002585	SCALE: 1"=40'	DATE: 6/21/2022	REVISED:

GENERAL NOTES:

1. Plant structure material to be precast concrete and steel.
2. Weight = 14,900 lbs.
3. Treatment capacity is 600 GPD. BOD Loading = 1.62 lbs. per day.
4. Standard tablet chlorinator or Optional Liquid chlorinator. NSF approved chlorinators (tablet & liquid) available.
5. Control Center w/ Timer for night spray application.
7. 20" Ø access riser w/ lid (Typical 4). Optional extension risers available.
8. 20 GPM 1/2 HP, high head effluent pump.
9. Air Compressor w/ concrete housing.
10. 1/2" Sch. 40 PVC Air Line (Max. 50 Lft from Plant).
11. 1" Sch. 40 PVC pipe to distribution system provided by contractor.

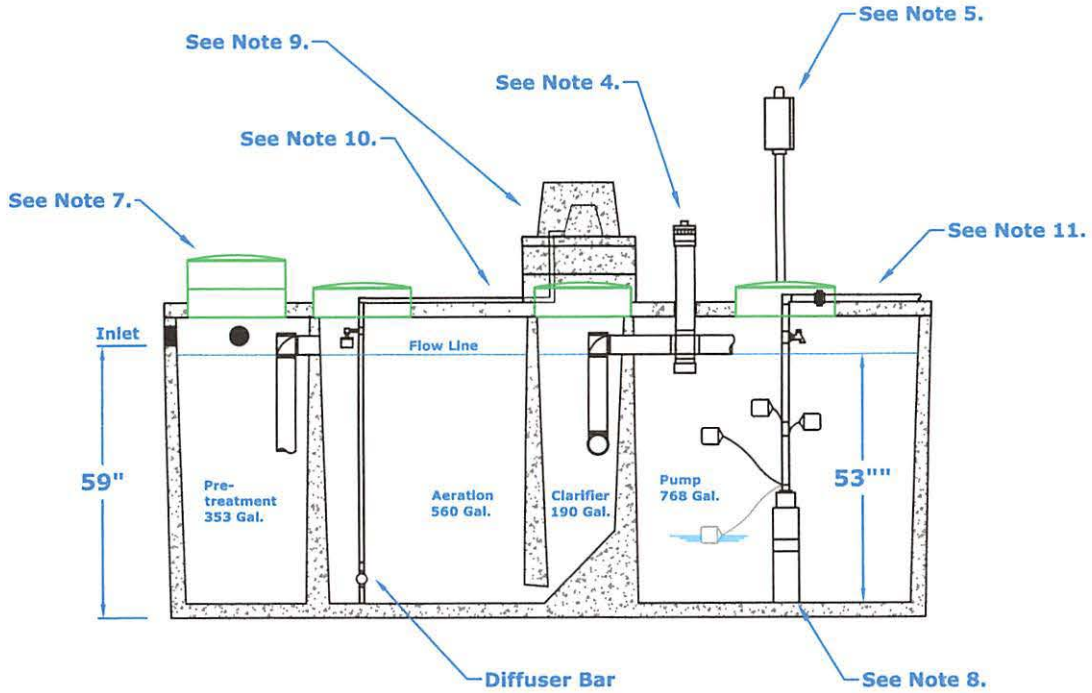

DIMENSIONS:
 Outside Height: 67"
 Outside Width: 63"
 Outside Length: 164"

MINIMUM EXCAVATION DIMENSIONS:
 Width: 76"
 Length: 176"



Handwritten signature and date:
 P2585
 06/26/2022

**Maxx Air M-600 (600 GPD)
 Aerobic Treatment Plant (Assembled)**

Dec, 2013
 By: A.S.

Scale:
 • All Dimensions subject to allowable specification tolerances.

Dwg. #: ADV-B550-3



Advantage Wastewater Solutions llc.
 444 A Old Hwy No 9
 Comfort, TX 78013
 830-995-3189
 fax 830-995-4051

TANK NOTES:

Tanks must be set to allow a minimum of 1/8" per foot fall from the residence.

Tightlines to the tank shall be SCH-40 PVC.

A two way sanitary tee is required between residence and tank.

A minimum of 4" of sand, sandy loam, clay loam free of rock shall be placed under and around tanks

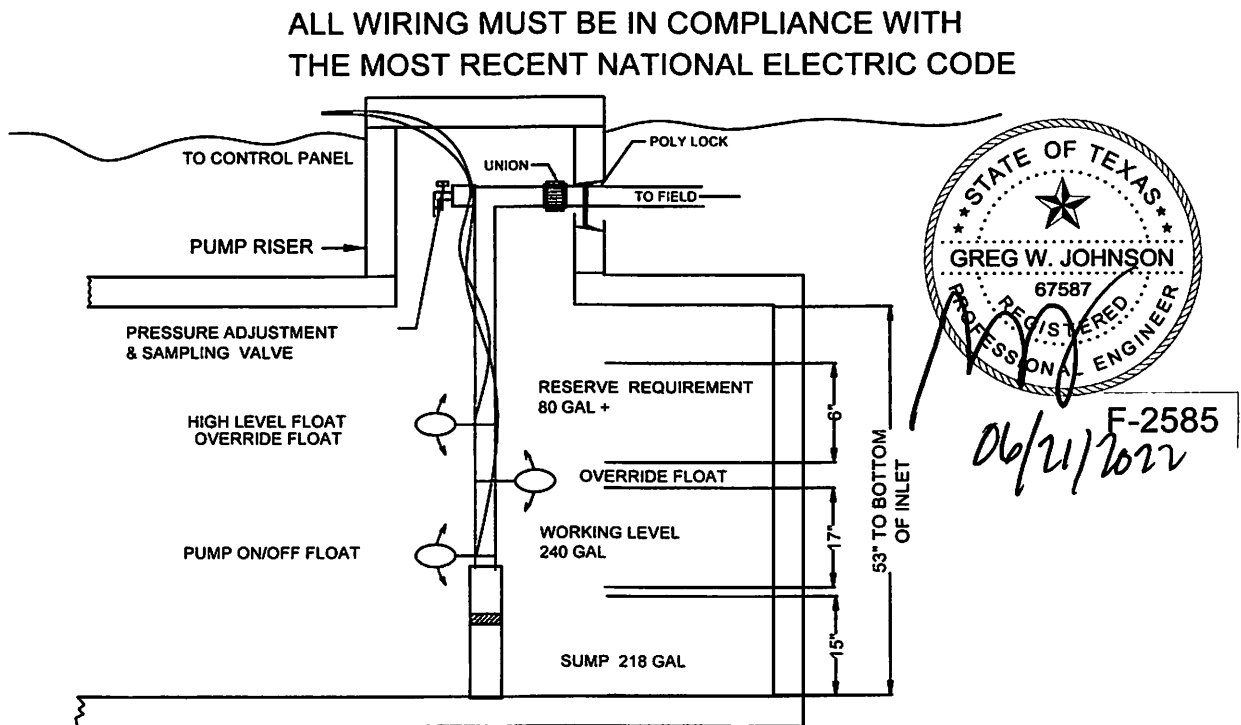

**TYPICAL PUMP TANK CONFIGURATION
MAXX AIR M600 768 GAL PUMP TANK**

Alamo Title GF# 4000082201098 NU; \$30

NOTICE OF CONFIDENTIALITY RIGHTS: IF YOU ARE A NATURAL PERSON, YOU MAY REMOVE OR STRIKE ANY OR ALL OF THE FOLLOWING INFORMATION FROM ANY INSTRUMENT THAT TRANSFERS AN INTEREST IN REAL PROPERTY BEFORE IT IS FILED FOR RECORD IN THE PUBLIC RECORDS: YOUR SOCIAL SECURITY NUMBER OR YOUR DRIVER'S LICENSE NUMBER.

GENERAL WARRANTY DEED

Date: April 5, 2022

Grantor: LIQUID PROPERTY GROUP LLC, a Delaware limited liability company

Grantor's Mailing Address: 8374 Market St #153, Bradenton, FL 34202

Grantee: JESUS BARCENAS and ARTURO BARCENAS

Grantee's Mailing Address, Arturo Barcenas
and after Recording, Return to: 410 schumanns Beach rd
New Braunfels tx 78130

Consideration: Cash and other good and valuable consideration, the receipt and sufficiency of which are hereby acknowledged.

Property (including any improvements):

Lot 403, ROCKY CREEK RANCH, PHASE 12, a Subdivision in Comal County, Texas, according to the map or plat thereof recorded in Volume 11, Pages 78-79, Map and Plat Records of Comal County, Texas

Reservations from Conveyance: None

Exceptions to Conveyance and Warranty: Validly existing easements, rights-of-way, and prescriptive rights, whether of record or not; all presently recorded and validly existing instruments, other than conveyances of the surface fee estate, that affect the Property; and taxes for 2022, which Grantee assumes and agrees to pay, but not subsequent assessments for that and prior years due to change in land usage, ownership, or both, the payment of which Grantor assumes.

Grantor, for the Consideration and subject to the Reservations from Conveyance and the Exceptions to Conveyance and Warranty, grants, sells, and conveys to Grantee the Property, together with all and singular the rights and appurtenances thereto in any way belonging, to have and to hold it to Grantee and Grantee's heirs, successors, and assigns forever. Grantor binds Grantor and Grantor's heirs and successors to warrant and forever defend all and singular the Property to Grantee and Grantee's heirs, successors, and assigns against every person whomsoever lawfully claiming or to claim the same or any part thereof, except as to the Reservations from Conveyance and the Exceptions to Conveyance and Warranty.

The Contract between Grantor as the Seller and Grantee as the Buyer, if any, may contain limitations as to warranty or other agreed matters; to the extent that such Contract provides for limitations or other agreed matters that will survive the closing and this conveyance, then such limitations or other agreed matters are hereby deemed incorporated by reference. The warranty of title contained in this Deed is hereby expressly excluded from the limitations or other agreed matters referenced in this paragraph.

When the context requires, singular nouns and pronouns include the plural.

LIQUID PROPERTY GROUP LLC,
a Delaware limited liability company

By: 
John Tiffin, Member

STATE OF FLORIDA)

COUNTY OF Manatee)

This instrument was acknowledged before me on April 5, 2022 by John Tiffin, Member of LIQUID PROPERTY GROUP LLC, a Delaware limited liability company, on behalf of said company.



Notary Public, State of Florida



Filed and Recorded
Official Public Records
Bobbie Koepf, County Clerk
Comal County, Texas
05/09/2022 11:13:19 AM
CASHONE 2 Pages(s)
202206021669

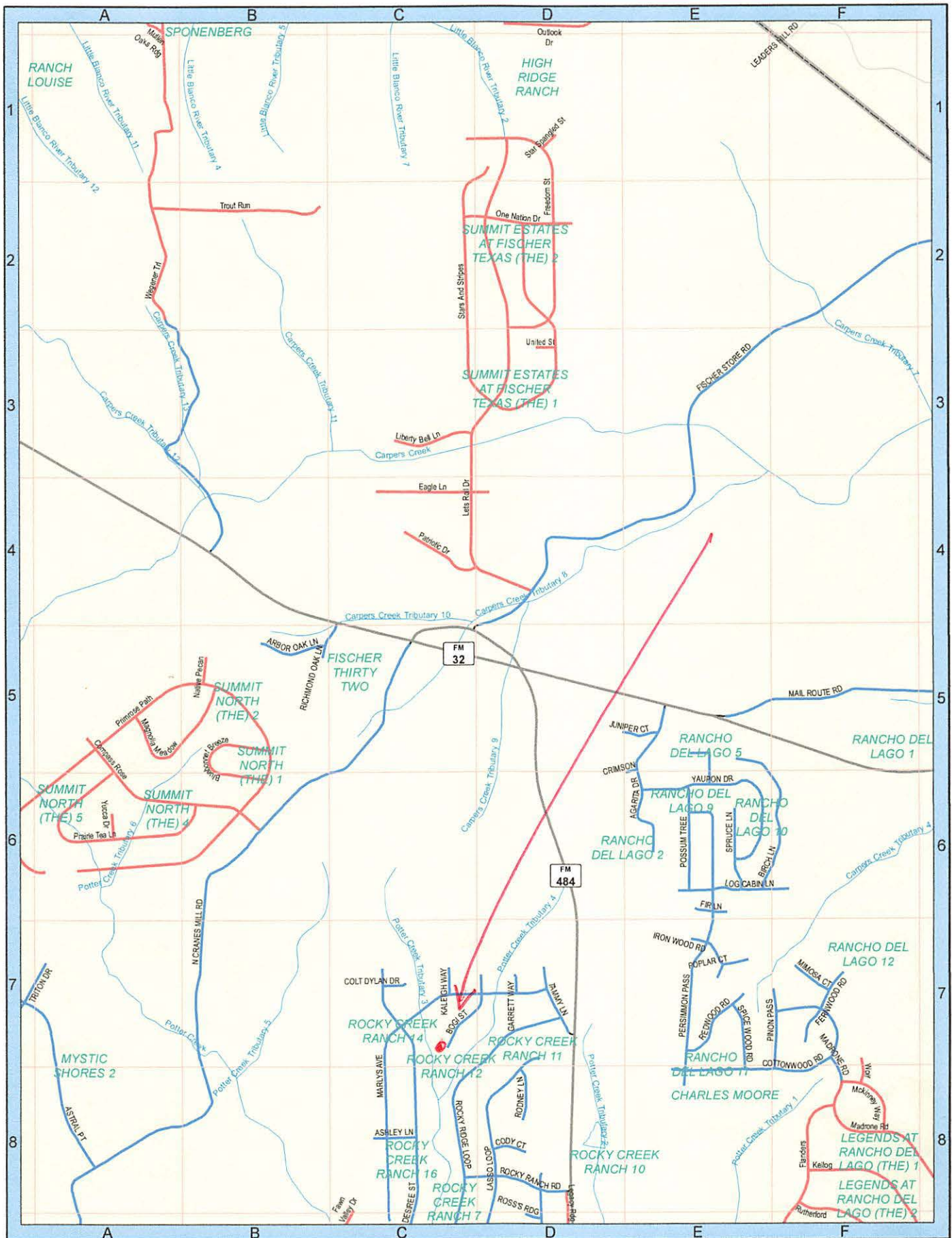

Bobbie Koepf



SEE PAGE 10

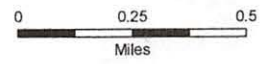

Luna Environmental

4222 FM 482
New Braunfels, TX 78132

(830) 312-8776

sherrie@lunaenvironmental.com

Printed:7/17/2023

Permit: 114782

Site: 109 Bogi Street, Canyon Lake, TX 78133

Main Phone: 5593491262

Bradley & Jennifer Blackmon

109 Bogi Street
Canyon Lake, TX 78133

Alt Cell: 5597797041

Agency: Comal County

Subdivision: Rocky Creek Ranch

System Info: MFG: Brand: MAXX AIR Customer ID: 7156
Treatment Type: Aerobic Disposal Type: Surface Application Insp ID: 30135
Installed: 3/22/2023 Warranty Expiration: 3/22/2026
Visit Details <----->
Visit Date: 7/17/2023 Entered By: Ryan Seidensticker GPS Lat: 29.95753 GPS Long: -98.26806
Scheduled Date: 7/22/2023 Contract Starts: 3/22/2023 Customer Emailed: 7/17/2023
Entered On: 7/17/2023 Contract Ends: 3/22/2026

Visit Results
Service Type: Scheduled Inspection
Count: Inspection 1 of 9
Method: Grab License # Expires
Technician: Not Assigned
Provider: Luna Environmental, LLC Service Completed

Aerators: Operational
Filters: Operational Sludge Level Tank 2: NA
Irrigation Pumps: Operational
Disinfection Device: Operational
Chlorine Supply: Operational
Chlorine Residual: .01

Electric Circuits: Operational Tank Lid / Riser: Secured
Distribution System: Operational Insp. Port / Plug: Secured
Drip/Sprayfield Veg: Operational

Alarm: Operational PSI Pressure: 2.2

Comments
Scum on pretreatment 0" - Technician Secured the Tank Lid and/or Riser prior to leaving location. - Inspection Port Plug was noted as Secured prior to leaving. - Copy emailed to the customer on 7/17/2023.