



COMAL COUNTY

ENGINEER'S OFFICE

License to Operate On-Site Sewage Treatment and Disposal Facility

Issued This Date: 04/01/2024 Permit Number: 116786

Location Description: 537 CHOCK RD
NEW BRAUNFELS, TX 78132

Subdivision: Vintage Oaks @ The Vineyard
Unit: 21
Lot: 1809
Block: 0
Acreage: 0.0000

Type of System: Aerobic
Surface Irrigation

Issued to: Robert & Peggy Morse

This license is authorization for the owner to operate and maintain a private facility at the location described in accordance to the rules and regulations for on-site sewerage facilities of Comal County, Texas, and the Texas Commission on Environmental Quality.

The license grants permission to operate the facility. It does not guarantee successful operation. It is the responsibility of the owner to maintain and operate the facility in a satisfactory manner.

Alterations to this permit including, but not limited to:

- Increase in the square feet of living area
- Increase in the number of bedrooms
- A change of use (i.e. residential to commercial)
- Relocation of system components (including the relocation of spray heads)
- Installation of landscaping
- Adding new structures to the system

may require a new permit. **It is the responsibility of the owner to apply for a new permit, if applicable.**

Inspection and licensing of a facility indicates only that the facility meets certain minimum requirements. It does not impede any governmental entity in taking the proper steps to prevent or control pollution, to abate nuisance, or to protect the public health.

This license to operate is valid for an indefinite period. The holder may transfer it to a succeeding owner, provided the facility has not been remodeled and is functioning properly.

ENVIRONMENTAL HEALTH INSPECTOR

Licensing Authority
Comal County Environmental Health
OS0036769

ENVIRONMENTAL HEALTH COORDINATOR

OS0007722

Comal County Environmental Health

OSSF Inspection Sheet

Installer Name: _____

OSSF Installer #: _____

1st Inspection Date: _____

2nd Inspection Date: _____

3rd Inspection Date: _____

Inspector Name: _____

Inspector Name: _____

Inspector Name: _____

Permit#:

Address:

No.	Description	Answer	Citations	Notes	1st Insp.	2nd Insp.	3rd Insp.
1	SITE AND SOIL CONDITIONS & SETBACK DISTANCES Site and Soil Conditions Consistent with Submitted Planning Materials		285.31(a) 285.30(b)(1)(A)(iv) 285.30(b)(1)(A)(v) 285.30(b)(1)(A)(iii) 285.30(b)(1)(A)(ii) 285.30(b)(1)(A)(i)				
2	SITE AND SOIL CONDITIONS & SETBACK DISTANCES Setback Distances Meet Minimum Standards		285.91(10) 285.30(b)(4) 285.31(d)				
3	SEWER PIPE Proper Type Pipe from Structure to Disposal System (Cast Iron, Ductile Iron, Sch. 40, SDR 26)		285.32(a)(1)				
4	SEWER PIPE Slope from the Sewer to the Tank at least 1/8 Inch Per Foot		285.32(a)(3)				
5	SEWER PIPE Two Way Sanitary - Type Cleanout Properly Installed (Add. C/O Every 100' &/or 90 degree bends)		285.32(a)(5)				
6	PRETREATMENT Installed (if required) TCEQ Approved List PRETREATMENT Septic Tank(s) Meet Minimum Requirements		285.32(b)(1)(G) 285.32(b)(1)(E)(iii) 285.32(b)(1)(E)(iv) 285.32(b)(1)(F) 285.32(b)(1)(B) 285.32(b)(1)(C)(i) 285.32(b)(1)(C)(ii) 285.32(b)(1)(D) 285.32(b)(1)(E) 285.32(b)(1)(A) 285.32(b)(1)(E)(ii)(II) 285.32(b)(1)(E)(i) 285.32(b)(1)(E)(ii)(I)				
7	PRETREATMENT Grease Interceptors if required for commercial		285.34(d)				

Inspector Notes:

**Comal County Environmental Health
OSSF Inspection Sheet**

No.	Description	Answer	Citations	Notes	1st Insp.	2nd Insp.	3rd Insp.
8	SEPTIC TANK Tank(s) Clearly Marked SEPTIC TANK If Single Tank, 2 Compartments Provided with Baffle SEPTIC TANK Inlet Flowline Greater than 3" and " T " Provided on Inlet and Outlet SEPTIC TANK Septic Tank(s) Meet Minimum Requirements		285.32(b)(1) (E) 285.91(2) 285.32(b)(1) (F) 285.32(b)(1)(E) (iii) 285.32(b)(1)(E)(ii) (II) 285.32(b)(1)(E)(ii) (I) 285.32(b)(1)(E) (i) 285.32(b)(1) (D) 285.32(b)(1)(C) (ii) 285.32(b)(1)(C) (i) 285.32(b)(1) (B) 285.32(b)(1) (A) 285.32(b)(1)(E)(iv)				
9	ALL TANKS Installed on 4" Sand Cushion/ Proper Backfill Used		285.32(b)(1)(F) 285.32(b)(1)(G) 285.34(b)				
10	SEPTIC TANK Inspection / Clean Out Port & Risers Provided on Tanks Buried Greater than 12" Sealed and Capped		285.38(d)				
11	SEPTIC TANK Secondary restraint system provided SEPTIC TANK Riser permanently fastened to lid or cast into tank SEPTIC TANK Riser cap protected against unauthorized intrusions		285.38(d) 285.38(e)				
12	SEPTIC TANK Tank Volume Installed						
13	PUMP TANK Volume Installed						
14	AEROBIC TREATMENT UNIT Size Installed						
15	AEROBIC TREATMENT UNIT Manufacturer AEROBIC TREATMENT UNIT Model Number						
16	DISPOSAL SYSTEM Absorptive		285.33(a)(4) 285.33(a)(1) 285.33(a)(2) 285.33(a)(3)				
17	DISPOSAL SYSTEM Leaching Chamber		285.33(a)(1) 285.33(a)(3) 285.33(a)(4) 285.33(a)(2)				
18	DISPOSAL SYSTEM Evapo-transpirative		285.33(a)(3) 285.33(a)(4) 285.33(a)(1) 285.33(a)(2)				

**Comal County Environmental Health
OSSF Inspection Sheet**

No.	Description	Answer	Citations	Notes	1st Insp.	2nd Insp.	3rd Insp.
19	DISPOSAL SYSTEM Drip Irrigation		285.33(c)(3)(A)-(F)				
20	DISPOSAL SYSTEM Soil Substitution		285.33(d)(4)				
21	DISPOSAL SYSTEM Pumped Effluent		285.33(a)(4) 285.33(a)(3) 285.33(a)(1) 285.33(a)(2)				
22	DISPOSAL SYSTEM Gravelless Pipe		285.33(a)(3) 285.33(a)(2) 285.33(a)(4) 285.33(a)(1)				
23	DISPOSAL SYSTEM Mound		285.33(a)(3) 285.33(a)(1) 285.33(a)(2) 285.33(a)(4)				
24	DISPOSAL SYSTEM Other (describe) (Approved Design)		285.33(d)(6) 285.33(c)(4)				
25	DRAINFIELD Absorptive Drainline 3" PVC or 4" PVC						
26	DRAINFIELD Area Installed						
27	DRAINFIELD Level to within 1 inch per 25 feet and within 3 inches over entire excavation		285.33(b)(1)(A)(v)				
28	DRAINFIELD Excavation Width DRAINFIELD Excavation Depth DRAINFIELD Excavation Separation DRAINFIELD Depth of Porous Media DRAINFIELD Type of Porous Media						
29	DRAINFIELD Pipe and Gravel - Geotextile Fabric in Place		285.33(b)(1)(E)				
30	DRAINFIELD Leaching Chambers DRAINFIELD Chambers - Open End Plates w/Splash Plate, Inspection Port & Closed End Plates in Place (per manufacturers spec.)		285.33(c)(2)				
31	LOW PRESSURE DISPOSAL SYSTEM Adequate Trench Length & Width, and Adequate Separation Distance between Trenches		285.33(d)(1)(C)(i)				

**Comal County Environmental Health
OSSF Inspection Sheet**

No.	Description	Answer	Citations	Notes	1st Insp.	2nd Insp.	3rd Insp.
32	EFFLUENT DISPOSAL SYSTEM Utilized Only by Single Family Dwelling EFFLUENT DISPOSAL SYSTEM Topographic Slopes < 2.0% EFFLUENT DISPOSAL SYSTEM Adequate Length of Drain Field (1000 Linear ft. for 2 bedrooms or Less & an additional 400 ft. for each additional bedroom) EFFLUENT DISPOSAL SYSTEM Lateral Depth of 18 inches to 3 ft. & Vertical Separation of 1ft on bottom and 2 ft. to restrictive horizon and ground water respectfully EFFLUENT DISPOSAL SYSTEM Lateral Drain Pipe (1.25 - 1.5" dia.) & Pipe Holes (3/16 - 1/4" dia. Hole Size) 5 ft. Apart		285.33(b)(3)(A) 285.33(b)(3)(A) 285.33(b)(3)(B) 285.91(13) 285.33(b)(3)(D) 285.33(b)(3)(F)				
33	AEROBIC TREATMENT UNIT Is Aerobic Unit Installed According to Approved Guidelines.		285.32(c)(1)				
34	AEROBIC TREATMENT UNIT Inspection/Clean Out Port & Risers Provided AEROBIC TREATMENT UNIT Secondary restraint system provided AEROBIC TREATMENT UNIT Riser permanently fastened to lid or cast into tank AEROBIC TREATMENT UNIT Riser cap protected against unauthorized intrusions						
35	AEROBIC TREATMENT UNIT Chlorinator Properly Installed with Chlorine Tablets in Place.						
36	PUMP TANK Is the Pump Tank an approved concrete tank or other acceptable materials & construction PUMP TANK Sampling Port Provided in the Treated Effluent Line PUMP TANK Check Valve and/or Anti- Siphon Device Present When Required PUMP TANK Audible and Visual High Water Alarm Installed on Separate Circuit From Pump						
37	PUMP TANK Inspection/Clean Out Port & Risers Provided PUMP TANK Secondary restraint system provided PUMP TANK Riser permanently fastened to lid or cast into tank PUMP TANK Riser cap protected against unauthorized intrusions						
38	PUMP TANK Secondary restraint system provided						
39	PUMP TANK Electrical Connections in Approved Junction Boxes / Wiring Buried						

**Comal County Environmental Health
OSSF Inspection Sheet**

No.	Description	Answer	Citations	Notes	1st Insp.	2nd Insp.	3rd Insp.
40	APPLICATION AREA Distribution Pipe, Fitting, Sprinkler Heads & Valve Covers Color Coded Purple?		285.33(d)(2)(G)(iii)(II) 285.33(d)(2)(G)(iii)(III) 285.33(d)(2)(G)(v) 285.33(d)(2)(G)(iii) 285.33(d)(2)(G)(iv) 285.33(d)(2)(G)(i) 285.33(d)(2)(G)(ii) 285.33(d)(2)(G)(iii)(I)				
41	APPLICATION AREA Low Angle Nozzles Used / Pressure is as required APPLICATION AREA Acceptable Area, nothing within 10 ft of sprinkler heads? APPLICATION AREA The Landscape Plan is as Designed		285.33(d)(2)(G) (i)285.33(d)(2) (A)285.33(d)(2)(F)				
42	APPLICATION AREA Area Installed						
43	PUMP TANK Meets Minimum Reserve Capacity Requirements						
44	PUMP TANK Material Type & Manufacturer						
45	PUMP TANK Type/Size of Pump Installed						



COMAL COUNTY

ENGINEER'S OFFICE

Permit of Authorization to Construct an On-Site Sewage Facility Permit Valid For One Year From Date Issued

Permit Number: 116786
Issued This Date: 12/12/2023
This permit is hereby given to: Robert & Peggy Morse

To start construction of a private, on-site sewage facility located at:

537 CHOCK RD
NEW BRAUNFELS, TX 78132

Subdivision: Vintage Oaks @ The Vineyard
Unit: 21
Lot: 1809
Block: 0
Acreage: 0.0000

APPROVED MINIMUM SIZES AS PER ATTACHED DESIGN

Type of System: Aerobic
Surface Irrigation

This permit gives permission for the construction of the above referenced on-site facility to commence. Installation must be completed by an installer holding a valid registration card from the Texas Commission on Environmental Quality (TCEQ). Installation and inspection must comply with current TCEQ and Comal County requirements.

Call (830) 608-2090 to schedule inspections.



COMAL COUNTY

ENGINEER'S OFFICE

OSSF DEVELOPMENT APPLICATION CHECKLIST

Staff will complete shaded items

		116786
Date Received	Initials	Permit Number

Instructions:

Place a check mark next to all items that apply. For items that do not apply, place "N/A". This OSSF Development Application Checklist **must** accompany the completed application.

OSSF Permit

- ☒ Completed Application for Permit for Authorization to Construct an On-Site Sewage Facility and License to Operate
- ☒ Site/Soil Evaluation Completed by a Certified Site Evaluator or a Professional Engineer
- ☒ Planning Materials of the OSSF as Required by the TCEQ Rules for OSSF Chapter 285. Planning Materials shall consist of a scaled design and all system specifications.
- ☒ Required Permit Fee - See Attached Fee Schedule
- ☒ Copy of Recorded Deed
- ☒ Surface Application/Aerobic Treatment System
 - ☒ Recorded Certification of OSSF Requiring Maintenance/Affidavit to the Public
 - ☒ Signed Maintenance Contract with Effective Date as Issuance of License to Operate

I affirm that I have provided all information required for my OSSF Development Application and that this application constitutes a completed OSSF Development Application.

Signature of Applicant

10/14/23

Date

___ COMPLETE APPLICATION	
Check No. _____	Receipt No. _____

INCOMPLETE APPLICATION
___ (Missing Items Circled, Application Refused)

RECEIVED

By Kathy Griffin at 1:26 pm, Oct 20, 2023

*** COMAL COUNTY OFFICE OF ENVIRONMENTAL HEALTH ***
**APPLICATION FOR PERMIT FOR AUTHORIZATION TO CONSTRUCT AN
 ON-SITE SEWAGE FACILITY AND LICENSE TO OPERATE**

Date 05/31/23 Permit # 116786

Owner Name <u>Robert & Peggy Morse</u>	Agent Name <u>South Texas Wastewater Treatment</u>
Mailing Address <u>503 Idlewood Court</u>	Agent Address <u>PO Box 1284</u>
City, State, Zip <u>Friendswood, TX 78132</u>	City, State, Zip <u>Boerne, TX 78006</u>
Phone # _____	Phone # <u>830-249-8098</u>
Email _____	Email <u>diandra@stwastewater.com</u>

All correspondence should be sent to: ☐ Owner ☒ Agent ☐ Both Method: ☐ Mail ☒ Email

Subdivision Name Vintage Oaks @ The Vineyard Unit 21 Lot 1809 Block _____

Acreage/Legal _____

Street Name/Address 537 Chock Road City New Braunfels Zip 78132

Type of Development:

☒ Single Family Residential

Type of Construction (House, Mobile, RV, Etc.) Single Family Home

Number of Bedrooms 3

Indicate Sq Ft of Living Area 3027

☐ Non-Single Family Residential

(Planning materials must show adequate land area for doubling the required land needed for treatment units and disposal area)

Type of Facility _____

Offices, Factories, Churches, Schools, Parks, Etc. - Indicate Number Of Occupants _____

Restaurants, Lounges, Theaters - Indicate Number of Seats _____

Hotel, Motel, Hospital, Nursing Home - Indicate Number of Beds _____

Travel Trailer/RV Parks - Indicate Number of Spaces _____

Miscellaneous _____

Estimated Cost of Construction: \$ 893,313.00 (Structure Only)

Is any portion of the proposed OSSF located in the United States Army Corps of Engineers (USACE) flowage easement?

☐ Yes ☒ No (If yes, owner must provide approval from USACE for proposed OSSF improvements within the USACE flowage easement)

Source of Water ☒ Public ☐ Private Well

Are Water Saving Devices Being Utilized Within the Residence? ☒ Yes ☐ No

By signing this application, I certify that:

- The completed application and all additional information submitted does not contain any false information and does not conceal any material facts. I certify that I am the property owner or I possess the appropriate land rights necessary to make the permitted improvements on said property.
- Authorization is hereby given to the permitting authority and designated agents to enter upon the above described property for the purpose of site/soil evaluation and inspection of private sewage facilities..
- I understand that a permit of authorization to construct will not be issued until the Floodplain Administrator has performed the reviews required by the Comal County Flood Damage Prevention Order.
- I affirmatively consent to the online posting/public release of my e-mail address associated with this permit application, as applicable.

Peggy Morse
 Signature of Owner

10-22-23
 Date

Page 1 of 2

* * * **COMAL COUNTY OFFICE OF ENVIRONMENTAL HEALTH** * * *
APPLICATION FOR PERMIT FOR AUTHORIZATION TO CONSTRUCT AN
ON-SITE SEWAGE FACILITY AND LICENSE TO OPERATE

Planning Materials & Site Evaluation as Required Completed By South Texas Wastewater Treatment

System Description Aerobic Surface Spray

Size of Septic System Required Based on Planning Materials & Soil Evaluation

Tank Size(s) (Gallons) 750/550 Absorption/Application Area (Sq Ft) 5054

Gallons Per Day (As Per TCEQ Table III) 300

(Sites generating more than 5000 gallons per day are required to obtain a permit through TCEQ.)

Is the property located over the Edwards Recharge Zone? ☒ Yes ☐ No

(If yes, the planning materials must be completed by a Registered Sanitarian (R.S.) or Professional Engineer (P.E.))

Is there an existing TCEQ approved WPAP for the property? ☐ Yes ☒ No

(If yes, the R.S. or P.E. shall certify that the OSSF design complies with all provisions of the existing WPAP.)

If there is no existing WPAP, does the proposed development activity require a TCEQ approved WPAP? ☐ Yes ☒ No

(If yes, the R.S. or P.E. shall certify that the OSSF design will comply with all provisions of the proposed WPAP. A Permit to Construct will not be issued for the proposed OSSF until the proposed WPAP has been approved by the appropriate regional office.)

Is the property located over the Edwards Contributing Zone? ☐ Yes ☒ No

Is there an existing TCEQ approval CZP for the property? ☐ Yes ☒ No

(If yes, the P.E. or R.S. shall certify that the OSSF design complies with all provisions of the existing CZP.)

If there is no existing CZP, does the proposed development activity require a TCEQ approved CZP? ☐ Yes ☒ No

(If yes, the R.S. or P.E. shall certify that the OSSF design will comply with all provisions of the proposed CZP. A Permit to Construct will not be issued for the proposed OSSF until the CZP has been approved by the appropriate regional office.)

Is this property within an incorporated city? ☐ Yes ☒ No

If yes, indicate the city: _____

By signing this application, I certify that:

- The information provided above is true and correct to the best of my knowledge.

- I affirmatively consent to the online posting/public release of my e-mail address associated with this permit application, as applicable.

Signature of Designer

6-6-23
Date

Page 2 of 2

AFFIDAVIT TO THE PUBLIC

THE COUNTY OF COMAL
STATE OF TEXAS

CERTIFICATION OF OSSF REQUIRING MAINTENANCE

According to Texas Commission on Environmental Quality Rules for On-Site Sewage Facilities, this document is filed in the Deed Records of Comal County, Texas. The Texas Health and Safety Code, Chapter 366 authorizes the Texas Commission on Environmental Quality (TCEQ) to regulate on-site sewage facilities (OSSFs). Additionally, the Texas Water Code (TVVC), 5.012 and 5.013, gives the TCEQ primary responsibility for implementing the laws of the State of Texas relating to water and adopting rules necessary to carry out its powers and duties under the TVVC. The TCEQ, under the authority of the TWC and the Texas Health and Safety Code, requires owners to provide notice to the public that certain types of OSSFs are located on specific pieces of property. To achieve this notice, the TCEQ requires a deed recording. Additionally, the owner must provide proof of the recording to the OSSF permitting authority. This deed certification is not a representation or warranty by the TCEQ of the suitability of this OSSF, nor does it constitute any guarantee by the TCEQ that the appropriate OSSF was installed.

II

An OSSF requiring a maintenance contract, according to 30 Texas Administrative Code 285.91(12) will be installed on the property described as (insert legal description):

Lot 1809 Block Subdivision Vintage Oaks @ The Vineyard Unit 21
not in Subdivision: Acres Survey

The property is owned by Robert & Peggy Morse

This OSSF must be covered by a continuous maintenance contract for the first two years. After the initial two-year service policy, the owner of an aerobic treatment system for a single family residence shall either obtain a maintenance contract within 30 days or maintain the system personally.

Upon sale or transfer of the above-described property, the permit for the OSSF shall be transferred to the buyer or new owner. A copy of the planning materials for the OSSF can be obtained from the Comal County Engineer's Office.

Robert Morse Owner Name [Signature] Owner Signature ●
Peggy Morse Owners Name [Signature] Owners Signature ●

This instrument was acknowledged before me on: 13 Day of October, 20 23

Amber Nicole Robson Notary's Printed Name

[Signature] Notary Public, State of Texas ●

Commission Expires: 03-03-2024

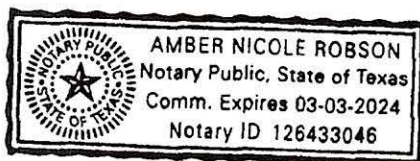

Affix Notary Stamp Above

Filed and Recorded
Official Public Records
Bobbie Koepp, County Clerk
Comal County, Texas
10/16/2023 08:58:46 AM
TERRI 1 Pages(s)
202306032883



Bobbie Koepp

SCANNED

South Texas Wastewater Treatment
PO Box 1284
Boerne, TX 78006

Phone: (830) 249-8098

Customer ID
7975

Contract Period
Start Date:
End Date:

To: Robert & Peggy Morse
503 Idlewood Court
Friendswood, TX 77546

Site: 537 Chock Road, New Braunfels, TX 78132
County: Comal
Installer: Ronald R Graham
Agency: Comal County Environmental
Mfg/Brand: Jet, Inc.-J-750- 2 yr-

South Texas Wastewater Treatment
3 visits per year - one every 4 months
300 gallons per day

I. General: This Work for Hire Agreement (hereinafter referred to as "Agreement") is entered into by and between South Texas Wastewater Treatment and the above referenced name (referred to as Customer). By this agreement, South Texas Wastewater Treatment and its' employees (hereinafter referred to as "Contractor") agree to render services at the site address stated above, as described herein, and the Customer agrees to fulfill his/her/their responsibilities, as described herein.

II. Effective Dates: This agreement commences and ends as noted above. The date of commencement will be the date the "License to Operate" was issued by the permitting authority. The agreement may or may not commence at the same time as any warranty period of installed equipment, but in no case shall it extend the specified warranty as stated in our PROPOSAL AND CONTRACT FOR SERVICES.

III. Renewal: This Agreement shall automatically renew for an additional period of two (2) years at the same terms and conditions unless either party gives notice of termination a minimum of thirty (30) days prior to end of first agreement period. See Section IV.

IV Termination of Agreement: This Agreement may be terminated by either party with thirty (30) days written notice for any reason, including for example, substantial failure to perform in accordance with its terms, without fault or liability of the terminating party. NO REFUNDS. If this Agreement is so terminated, Contractor will be paid at the rate of \$95.00 per hour for any work performed and for which compensation has not been received. Either party terminating this agreement for any reason, including non-renewal, shall notify in writing the appropriate regulatory agency a minimum of thirty (30) days prior to the date of such termination.

V. Services: Contractor will:

- A. Inspect and perform routine upkeep on the On-Site Sewage Facility (hereinafter referred to as OSSF) as recommended by the treatment system manufacturer, and required by state and/or local regulations approximately every four months.
- B. Provide a written record of visits to the site by means of an inspection tag attached to or contained in or near the control panel.
- C. Repair or replace: if repairs or replacement of parts is necessary during a routine service visit, the repair or replacement of parts will be made at that time, if the charges for parts do not exceed \$100.00. If the charges for parts exceed \$100.00, the homeowner will be contacted for approval at the number(s) provided by the homeowner below. If the homeowner cannot be reached for approval while the technician is at the property, the repairs will not be made if they exceed \$100.00. **If the technician receives approval after he leaves the property, a service call charge of \$95.00 to return to the property will be added to the final bill.** If warranted items are required to be replaced within 30 days of installation, labor will not be charged. After 30 days, labor will be charged according to the service agreement.
- D. Provide sample collection and laboratory testing of TSS and BOD on a yearly basis as required by permit. An additional charge will be incurred by the Customer for this service. (Only required for other than single family residence.).
- E. Forward copies of this Agreement and all reports to the regulatory agency and the customer within 14 days.
- F. Visit site in response to Customer's request for unscheduled service within forty-eight (48) hours of the date of notification of said request.

Unless otherwise covered by warranty, costs for such unscheduled responses will be billed to Customer.

VI. Disinfection: Not Required. X Required. The responsibility to maintain the disinfection device (s) and provide any necessary chemicals is that of the Customer. If the Customer pays for it, Contractor will add 6 tablets of chlorine at routine services (See Section V Sub-section A) INITIAL

VII. Electronic Monitoring is X is not included in this Agreement.

VIII. Performance of Agreement: Commencement of performance by Contractor under this agreement is contingent on the following conditions:

A. **If this is an initial agreement (new installation):**

1. Contractor's receipt of a fully executed original copy or email of this agreement and all documentation requested by Contractor.
2. Contractor providing the equipment and installation for this OSSF.
3. Contractor's receipt of payment in full for the equipment and installation.
4. Contractor's receipt of payment of the wastewater monitoring fee in accordance with the terms as described in section XIV of this Agreement.

B. If this is not an initial agreement (existing system):

1. Contractor's receipt of a fully executed original copy of this agreement and all documentation requested by Contractor.
2. Contractor's receipt of payment of the wastewater monitoring fee in accordance with the terms as described in Section XIV of this agreement

C. If the above conditions are not met, Contractor is not obligated to perform any portion of this agreement.

IX. Customer's Responsibilities: The Customer is responsible for each and all of the following :

A. **DO NOT ALLOW ALTERATION TO ANY PART OF THE SYSTEM OR SPRINKLER HEAD LOCATIONS. ALTERATIONS WOULD PUT THE SYSTEM OUT OF COMPLIANCE AND WOULD CAUSE THE PROPERTY OWNER ADDITIONAL EXPENSES TO BRING THE SYSTEM BACK INTO COMPLIANCE.**

B. Provide all necessary yard or lawn maintenance and the removal of all obstacles, including but not limited to dogs and other animals, vehicles, trees, brush, trash, or debris, as needed to allow the OSSF to function properly, and to allow Contractor safe and easy access to

all parts of the OSSF.

- C. Protect equipment from physical damage including but not limited to that damage caused by insects.
- D. Maintain a current license to operate, and abide by the conditions and limitations of that license, and all requirements for an on-site sewage facility (OSSF) from the State and/or local regulatory agency, whichever are more stringent, as well as proprietary system's
- E. Notify Contractor immediately of any and all alarms, and/or any and all problems with, including failure of, the OSSF.
- F. Provide, upon request by Contractor, water usage records for evaluation by Contractor as to the performance of the OSSF.
- G. Allow for samples at both the inlet and outlet of the OSSF to be obtained by Contractor for the purpose of evaluating the OSSF's performance. If these samples are taken to a laboratory for testing, with the exception of the service provided under Section. Sub-section D above, Customer agrees to pay Contractor for sample collection and transportation, portal to portal, at a rate of \$95.00 per hour plus the associated fees for laboratory testing.
- H. Prevent the backwash or flushing of water treatment of conditioning equipment from entering the OSSF.
- I. Prevent the condensate from air conditioning or refrigeration units, or the drains of icemakers, from hydraulically overloading the aerobic treatment units. Drain lines may discharge into the surface application pump tank if approved by system designer.
- J. Provide for pumping and cleaning of tanks and treatment units, when and as recommended by Contractor, at Customer's expense.
- K. Maintain site drainage to prevent adverse effects on the OSSF.
- L. Pay promptly and fully, all Contractor's fees, bills, or invoices as described herein.

X. **Access by Contractor:** Contractor is hereby granted an easement to the OSSF for the purpose of performing services described herein. Contractor may enter the property during Contractor's normal business hours and/or other reasonable hours without prior notice to Customer to perform the Services and/or repairs described herein. Contractor shall have access to the OSSF electrical and physical components. **IF SPECIAL ARRANGEMENTS ARE REQUESTED (any advance or prior notice or contacting of owner/resident in order to enter property to perform routine service visit, (locked gates, biting dogs, appointment to enter, to call on the way, etc.) or if any part of the system is located behind a locked door (garage, etc.) -THERE IS AN ADDITIONAL CHARGE.** Tanks and treatment units shall be accessible by means of man ways, or risers and removable covers, for the purpose of evaluation as required by State and/or local rules and proprietary system manufacturer. If not an initial agreement (new installation) and this access is not in place or provided for by the customer, the costs for the labor of excavation, and possibly other labor and materials costs, will be required. These costs shall be billed to Customer as an additional service at a rate of \$95.00 per hour, plus materials at list price. Excavated soil shall be replaced as best as Contractor can at the time such service is performed and under no circumstances is Contractor responsible for damages to sod, grass, roots, landscaping, or any unmarked underground items (telephone, television, or electric cables, water air or gas lines, etc.), or for the uneven settling of the soil.

XI. **Limit of Liability:** Contractor shall not be held liable for any incidental, consequential, or special damages, or for economic loss due to expense, or for loss of profits or income, or loss of use to Customer, whether in contract tort or any other theory. In no event shall Contractor be liable in an amount exceeding the total Fee for Services amount paid by Customer under this Agreement.

XII. **Severability:** If any provision of this "Proposal and Contract" shall be held to be invalid or unenforceable for any reason, the remaining provisions shall continue to be valid and enforceable. If a court finds that any provision of this "Agreement" is invalid or unenforceable, but that by limiting such provision it would become valid and enforceable, then such provision shall be deemed to be written, construed, and enforced as so limited.

XIII. **Fee for Services:** The fee for the basic Services described in this Agreement is _____. This fee does not include any equipment, materials, or labor necessary for non-warranty repairs and/or any other on-site visit, other than required regularly Scheduled Inspections (see Section V, item A), and will incur a service call fee of 95.00, plus parts and labor.

XIV. **Payment:** Payment of Fee for Services for the original term as stated above is to be made as follows:

☒ X Included in PROPOSAL AND CONTRACT

_____ Full amount due upon signature (Required of new Customer)

_____ Payments of \$ _____ due upon receipt of invoice. (Payment terms for renewal of agreement.)

Payment of invoice(s) for any other service or repair provided by contractor is due upon receipt of invoice. Invoices are mailed on the date of invoice. All payments not received within thirty (30) days from the invoice date will be subject to a late penalty and a 1.5% per month carrying charge, as well as any reasonable attorney's fees, and all collection and court costs incurred by Contractor in collection of unpaid debt(s). Any check returned to Contractor for any reason will be assessed a \$30.00 returned check fee.

XV. **Application of Transfer of payment:** The fees paid for this agreement are not refundable, however, the agreement is transferable. Customer will advise subsequent property owner(s) of the state requirement that they sign a replacement agreement authorizing Contractor to perform the herein described Services, and accepting Customer's Responsibilities. This replacement Agreement must be received from Customer first to any past due obligations arising from this Agreement including late fees or penalties, returned check fees, and/or charges for services or repairs not paid within thirty (30) days of invoice date. Any remaining monies shall be applied to the funding of the replacement Agreement. The consumption of funds in this manner may cause a reduction in the termination date of effective coverage per this agreement. See Section IV.

XVI. **Entire Agreement:** This agreement contains the entire agreement of the parties, and there are no other promises or conditions in any other agreement, oral or written.

R. Bruce Cobabe

OSSF Installer II, Lic OS0004815, and, OSSF Site Evaluator, Lic OS0012360

Name

Date

exp 1/31/2024

exp 12/31/2023

Certified Service Provider for: Jet Inc. Member: Texas On-Site Wastewater Association and National On-site Wastewater Recycling

Acceptance of Agreement: The above prices, specifications, and conditions are satisfactory and are hereby accepted. You are authorized to perform the Services as specified. It is understood and agreed that this work is not provided for in any other agreement and no contractual rights arise until this "Agreement" is accepted in writing AND payment is made as outlined above.

[Signature]
Customer

10-12-23
Date

pmorisc007@gmail.com
E-Mail

CONTACT PHONE NUMBERS:

Gate Codes for:

#1 _____

SubDivision _____

#2 _____

Property _____

Date Printed: 5/31/2023

SOUTH TEXAS WASTEWATER TREATMENT

Authorized JET Distributor - Home and Commercial - Engineering Services
P O Box 1284 Boerne, Texas 78006 * 830-249-8098 or 1-800-86 WASTE

SITE EVALUATION INFORMATION SHEET

TA French Custom Builder
4571 FM 1102
New Braunfels, TX 78132

SITE: 537 Chock Road
Vintage Oaks @ The Vineyard
Lot 1809
Comal County, Texas

Date Site Evaluation Performed 29 May 2023

Within 100 year Flood zone No, FIR Map 48091C0245F

Edwards Recharge Zone: No, USGS map Index map

Profile Holes: 12" class IV clay with limestone at 12".

Soil Texture Analysis: Class suitable NO

Soil Structure Analysis: suitable X unsuitable for conventional septic

Structureless

Weak Moderate Strong

Blocky

Platy (unsuitable)

Massive (unsuitable)

Restrictive Horizon: None found: Depth: surface

Rock or Fractured Rock: x

Clay 40% or more x

Ground Water N/A

Brief Description: No sensitive features noted at time of site evaluation. No physical drainage features on lot.

This site evaluated by:

South Texas Wastewater Treatment

Ronald R. Graham, Site Evaluator

Registration Number 19772, State of Texas

PO Box 1284, Boerne, Texas



Ronald R. Graham, SE

6-6-23

Date

SOUTH TEXAS WASTEWATER TREATMENT

Authorized JET Distributor - Home and Commercial - Engineering Services
P O Box 1284 Boerne, Texas 78006 * 830-249-8098 or 1-800-86-WASTE

5 June 2023

JET HOME WASTEWATER TREATMENT SYSTEM DESIGN SPRINKLER SYSTEM

TA French Custom Builder
4571 FM 1102
New Braunfels, TX 78132

SITE: 537 Chock Road
Vintage Oaks @ The Vineyard
Lot 1809
Comal County, Texas

This design includes an attached drawing No. 7975R0 dated 5 JUNE 2023

Design Specifications:

Estimated average daily wastewater flow: 3 Bedroom 3,027sf home
(300 GPD) Treatment of 480 GPD

Pump tank/chlorine contact chamber capacity: 550 gallons

Design application rate: 0.064 gal./sq.ft./day

Dosing cycle quantity: 100-110 gallons

Number of dosing cycles per day: three (3)

Type of float switch: mercury float switch

Design pressure head: 25-40 psi at sprinkler head

Dosing pump capacity: Little Giant WE20G05P4-20 20.0 GPM

NSF Certified Tablet Chlorinator: installed at inlet of pump tank

Maximum slope of the field: <15 percent

Means of preventing syphoning: gravity

Diameter of supply pipe: 1 inch

Pressure adjusting valves to be installed: hose bib

Safety Lid installed on Clarifier

Offsets: property lines, wells, easements, water lines, structures, swimming pools, ponds, etc shall be strictly adhered to as required by latest Texas Commission on Environmental Quality OSSF Regulations.

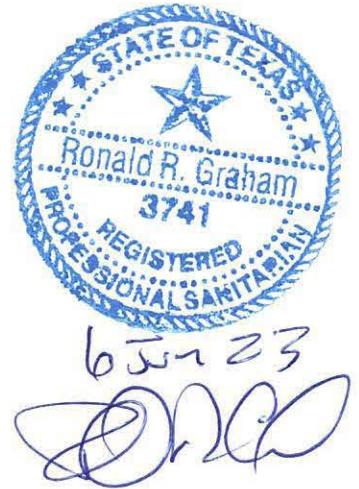

Pump controls must have NEMA (National Manufacturing Association) approval. A PVC union shall be placed above the pump to allow for easy pump removal.

Calculation of field Size

Three bedroom house 3,027sf home – allow 300 GPD effluent flow
Assume an application rate of 15.6 square feet per gallon per day.

$$300 \div 0.064 = 4,688 \text{ sq ft}$$

We are installing 2 sprinkler heads, capable of 2gpm each, both with a 30' radius, both spraying a full circle. The area as measured by autocad is:

$$A = 5,654 \text{ sq ft}$$

Pipe and fittings

All pipes and fittings in this system shall be schedule 40 PVC. All joints shall be sealed with an approved solvent-type PVC cement. The forced main shall be 1 inch in diameter. A Little Giant WE20G05P4-22 or equivalent high head submersible pump capable of providing at least 20gpm and providing a 25-40 psi head shall be utilized for pumping effluent.

Site Preparation

The area selected for irrigation shall be cleared of cedar and brush. Some preparation is required. Sprayed area shall be provided with grass or other suitable ground cover.

Provisions for Emergencies

A warning system shall be added to the pump tank on a separate circuit from the pump circuit to provide warning of a failure of the system. This aerobic system has a 24 month service agreement which includes emergency service.

Flood Prone Areas

The subject lot is not in a flood prone area according to National Flood Insurance Program FIR Map community-panel Number 48091C0245F. No physical drainage feature on property which would require special protective measures. No slope where seeps may occur, no flows with velocity that would damage components. This lot is located over the Contributing Zone of the Edwards Aquifer. CZP 3063.00 has been reviewed.

Tank Sizes

The system shall have a JET Model J-750 extended aeration plant with external NSF Certified tablet chlorinator. The pump tank shall have a capacity of 550 gal. This tank will not need tees on inlet. Safety Lid installed on clarifier.



This system designed by:

South Texas Wastewater Treatment
Ronald R. Graham, Registered Sanitarian
Registration Number 3741, State of Texas
PO Box 1284, Boerne, TX



Ronald R. Graham, RS

June 6, 2023

Date

Attachments:

Drawing No. 7975R0 dated 5 June 2023

RECEIVED

By Brandon Olvera at 4:29 pm, Dec 27, 2023

19 DEC 23
*[Signature]***NOTES:**

1. THIS DESIGN MEETS ALL OF THE REQUIREMENTS OF THE TEXAS COMMISSION ON ENVIRONMENTAL QUALITY OSSF REGULATIONS AND THE ORDERS OF COMAL COUNTY AND WILL NOT CAUSE A NUISANCE OR HEALTH HAZARD
2. ALL SPRINKLERS ARE HUNTER PGP-ARV-LA OR K-RAIN PROPLUS
3. ANY CROSSING OF WATER LINE & SPRAY LINE WILL BE SLEEVED 10 ft ON EACH SIDE OF WATER LINE
4. NO PHYSICAL DRAINAGE FEATURE ON PROPERTY WHICH WOULD REQUIRE SPECIAL PROTECTIVE MEASURES
5. NO TEST HOLES DUG DUE TO EXTENSIVE SURFACE ROCK

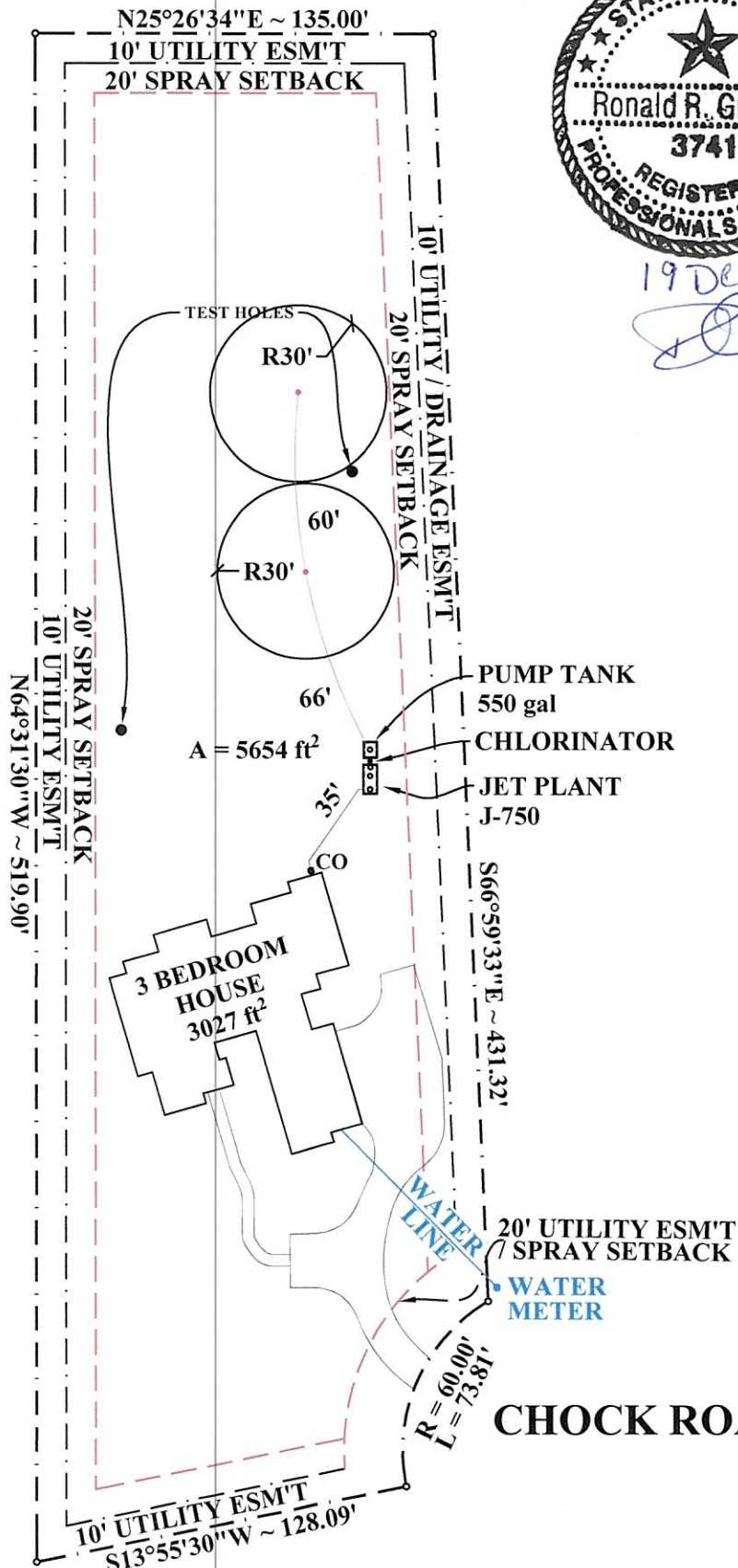
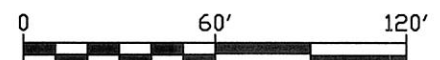
AS BUILT**CHOCK ROAD**

South Texas Wastewater Treatment
PO Box 1284
Boerne, TX 78006
830-249-8098

4 December 2023

537 Chock Rd
Vintage Oaks @ The Vineyard 21
Lot 1809
Comal Co. Texas

I, Ronald R. Graham have reviewed the **WPAP** for this location and certify that this design meets all the requirements of the Texas Commission of Environmental Quality OSSF regulations, all provisions of the existing WPAP and the orders of Comal County.



Ronald R. Graham, RS 3741

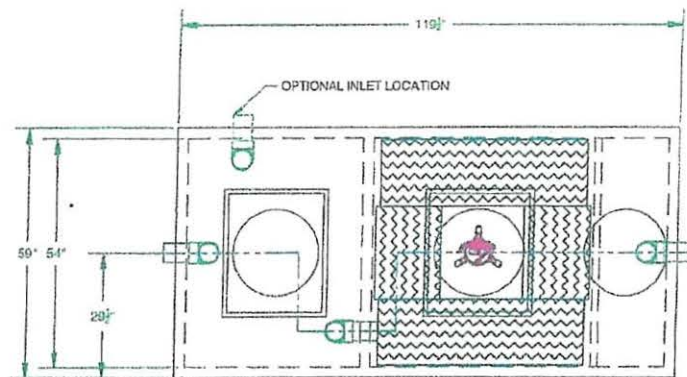

NOTES:

1. AERATOR MODEL 700LL MUST BE USED IN CONTINUOUS OPERATION
2. DEVELOP RISERS TO GRADE OR WITHIN 12" BELOW GRADE
3. PLASTIC RISERS CAST INTO THE TANK LID MAY BE USED IN PLACE OF CONCRETE RISERS

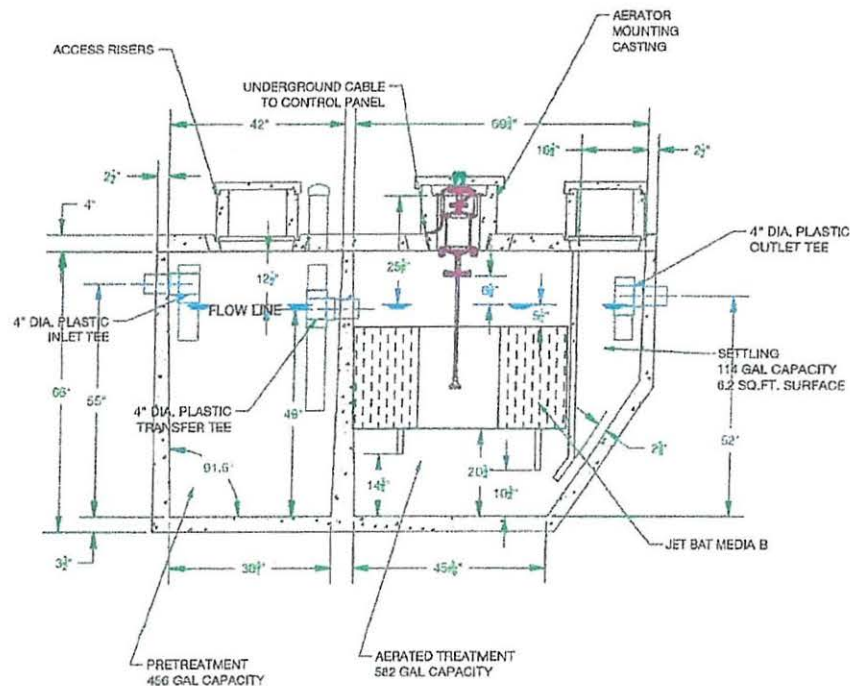

- 140708/14/14 REDRAWN		N J K	
REVIEW DATE	DESCRIPTION	DRAWN BY:	DATE
		N J K	08/14/14
		APPROVED BY:	DATE
TITLE:		MATERIAL:	
J-750 RESIDENTIAL WWTP			
ONE PIECE TANK CASTING			
USED ON:		SCALE:	SIZE:
		1 : 20	C
UNLESS OTHERWISE SPECIFIED:		ALL DIMENSIONS ARE IN INCHES	
DECIMAL:		± .005	
FRACTIONAL:		± 1/64	
DEC REE:		± 1"	
PROPRIETARY PROPERTY: THIS DRAWING IS THE PROPERTY OF JET INC. AND MAY NOT BE REPRODUCED, COPIED OR USED WITHOUT WRITTEN PERMISSION.		DRAWING NUMBER:	
		J-750	
		REV: -	

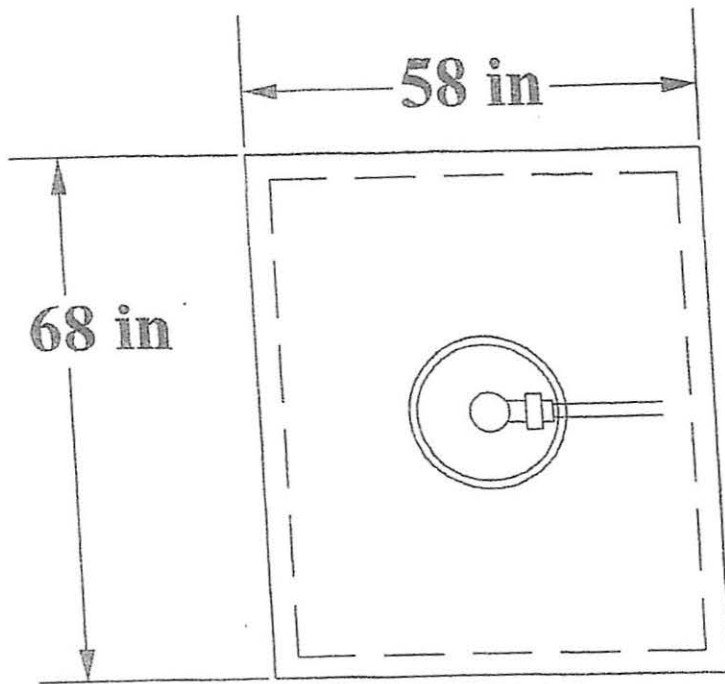

PUMP. TANK **550 gal.**

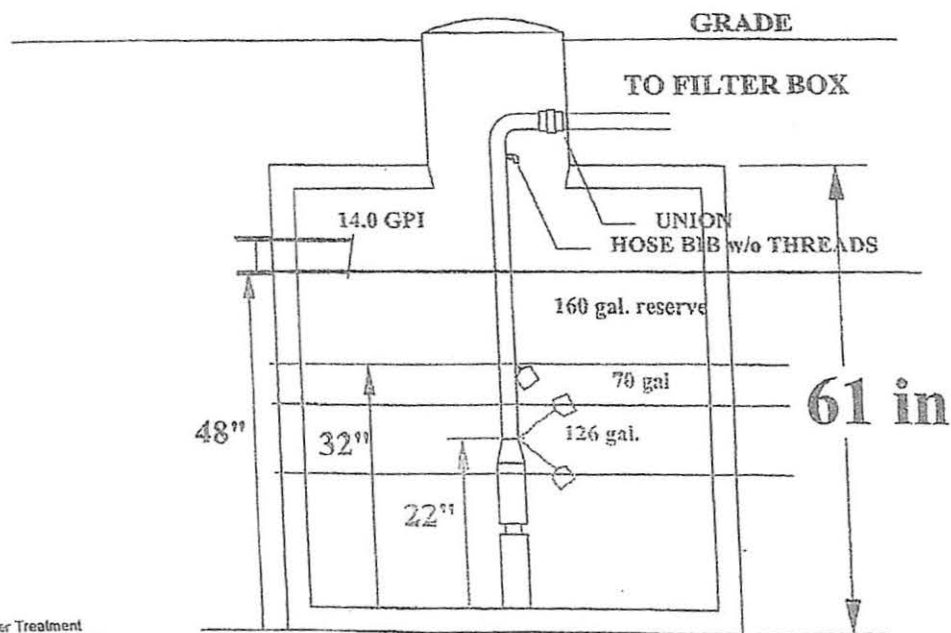

Olvera,Brandon

From: Olvera,Brandon
Sent: Monday, November 6, 2023 3:00 PM
To: Diandra Linares
Subject: 116786

RE: 537 Chock Road

Vintage Oaks at the Vineyard 21

Lot 1809

Property Owner & Agent,

We received planning materials for the referenced permit application and found those planning materials to be deficient. To continue processing this permit, we need the following:



- There is a TCEQ Approved WPAP.
2. Revise accordingly and resubmit.

If you have any questions, you can email me or call the office.

Thank You,

Note: Beginning January 1, 2024 our reinspection fees will be changing to \$150.00. Permit fee includes 3 inspections, \$150 each additional inspection

Brandon Olvera | Designated Representative OS0034792 | Comal County | www.cceo.org

195 David Jonas Dr, New Braunfels, TX-78132 | t: 830-608-2090 | f: 830-608-2078 | e: olverb@co.comal.tx.us



VOID

NOTES.

1. THIS DESIGN MEETS ALL OF THE REQUIREMENTS OF THE TEXAS COMMISSION ON ENVIRONMENTAL QUALITY OSSF REGULATIONS AND THE ORDINANCES OF COMAL COUNTY AND DOES NOT CAUSE A NUISANCE OR HEALTH HAZARD.
2. SPRINKLERS ARE HUNG AT 5' ON ARV-LA-RAIN PROPLIES.
3. ANY CROSSING OF WATER LINE & SPRAY LINE WILL BE SLEEVED TO 10 ft.
4. NO PHYSICAL DRAINAGE FEATURES ON PROPERTY WHICH WOULD REQUIRE SPECIAL PROTECTIVE MEASURES.
5. NO TEST HOLES DUG DUE TO EXTENSIVE SURFACE ROCK.



6 JUN 23
RCC

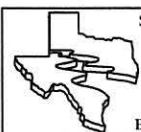
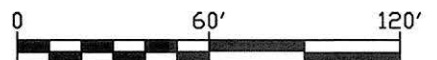

SOUTH TEXAS WASTEWATER TREATMENT
P.O. BOX 1284
BOERNE, TX 78006
830-249-8098
BY RONALD R. GRAHAM R.S. 3741

537 Chock Road
Lot 1809
Vintage Oaks at the Vineyard 21
COMAL COUNTY, TEXAS

Rev	Date	By	DRAWING NO.	
0	JUN 05 2023	RCC		7975R0
			DATE	JUN 05 2023
			SCALE	1" = 60'

ORT/GR#1291310101 NE
ND

NOTICE OF CONFIDENTIALITY RIGHTS: IF YOU ARE A NATURAL PERSON, YOU MAY REMOVE OR STRIKE ANY OR ALL OF THE FOLLOWING INFORMATION FROM ANY INSTRUMENT THAT TRANSFERS AN INTEREST IN REAL PROPERTY BEFORE IT IS FILED FOR RECORD IN THE PUBLIC RECORDS: YOUR SOCIAL SECURITY NUMBER OR YOUR DRIVER'S LICENSE NUMBER.

**GENERAL WARRANTY DEED RESERVING VENDOR'S
LIEN IN FAVOR OF THIRD PARTY**

THE STATE OF TEXAS
COUNTY OF COMAL

§
§
KNOW ALL MEN BY THESE PRESENTS:

THAT EDUARDO GARCIA-FLORES and wife, KATELYN JOY PRICE, hereinafter called Grantor, for and in consideration of the sum of TEN AND NO/100 DOLLARS (\$10.00) cash and other good and valuable consideration in hand paid by ROBERT E. MORSE and wife, PEGGY T. MORSE, hereinafter called Grantee, the receipt and sufficiency of which is hereby acknowledged and confessed, and the further consideration of the execution and delivery by Grantee of one certain Promissory Note of even date herewith in the principal sum of ONE HUNDRED SIXTY-FIVE THOUSAND, SEVEN HUNDRED FIFTY AND NO/100 (\$165,750.00) DOLLARS, payable to the order of FIRST UNITED BANK & TRUST COMPANY, hereinafter called Mortgagee, said Note being payable as therein provided, bearing interest at the rate therein specified, providing for attorney's fees and acceleration of maturity at the rate and in the events therein set forth, and payment of said Note being secured by a vendor's lien and superior title retained herein in favor of said Mortgagee and by Deed of Trust of even date herewith from Grantee to GREG MASSEY, Trustee, to which reference is hereby made for all purposes; and,

WHEREAS, Mortgagee has, at the special instance and request of said Grantee herein, paid to Grantor herein \$165,750.00 of the purchase money for the property hereinafter described as represented by the above described Note, said Note, together

with the vendor's lien and Deed of Trust Lien against said property securing the payment of said Note is, without recourse upon the Grantor herein, hereby assigned, transferred and delivered to Mortgagee, the Grantor hereby conveying to the said Mortgagee the said superior title to said property, and subrogating the said Mortgagee unto all the rights and remedies of Grantor in the premises by virtue of said Note and liens; the indebtedness evidenced by said Note being due and payable as therein provided, both principal and interest being due and payable at the office of FIRST UNITED BANK & TRUST COMPANY;

HAS GRANTED, SOLD and CONVEYED, and by these presents does GRANT, SELL and CONVEY unto the said Grantee, the following described property, to-wit:

Lot 1809, VINTAGE OAKS AT THE VINEYARD, UNIT 21, a subdivision in Comal County, Texas, according to the map or plat thereof recorded in Document No. 201806030248, Map and Plat Records of Comal County, Texas.

This conveyance is made subject to, all and singular, the restrictions, easements and covenants, if any, applicable to and enforceable against the above described property as reflected by the records of the County Clerk of Comal County, Texas..

It is expressly agreed and stipulated that a vendor's lien is retained in favor of the payee in said Note against the above described property, premises and improvements, until said Note, and all interest thereon, is fully paid according to the face and tenor, effect and reading thereof, when this deed shall become absolute.

Taxes for the current year have been prorated and are thereafter assumed by Grantee.

TO HAVE AND TO HOLD the above described premises, together with, all and singular, the rights and appurtenances thereto in anywise belonging unto the said Grantee, Grantee's heirs and assigns forever.

Grantor does hereby bind Grantor, Grantor's heirs, executors, administrators and successors to warrant and forever defend, all and singular, the said premises unto the said Grantee, Grantee's heirs, executors, administrators, successors and assigns, against every person whomsoever claiming or to claim the same or any part thereof.

DATED this the 15 day of November, 2021.

EDUARDO GARCIA FLORES

KATELYN JOY PRICE by EDUARDO
GARCIA-FLORES, AGENT AND ATTORNEY-
IN-FACT

WITH THE ARMED FORCES
OF THE UNITED STATES
ON OKINAWA JAPAN

STATE OF TEXAS _____
COUNTY OF _____

§
§

This instrument was acknowledged before me on this the 15th day of November, 2021, by EDUARDO GARCIA-FLORES, individually and as agent for wife, KATELYN JOY PRICE.

Grantor's Mailing Address:
537 Chock Rd
New Braunfels, TX 78132

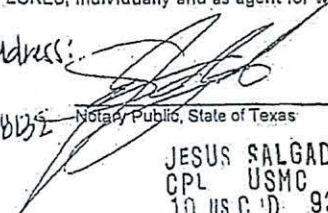
Notary Public, State of Texas

JESUS SALGADO
CPL USMC
10 USC 1D 936 AND
US CODE 1,44A
EXP. INDEFINITE

7363g, DEEDS
Old Republic Title Co. (NF)
GF #12923nb

3

Filed and Recorded
Official Public Records
Bobbie Koepp, County Clerk
Comal County, Texas
11/24/2021 11:42:36 AM
CHRISTY 3 Pages(s)
202106060672



Bobbie Koepp

South Texas Waste Water Treatment, LLC

PO Box 1284
Boerne, TX 78006

(830) 249-8098

Printed:2/12/2025

Permit: 116786

Site: 537 Chock Road, New Braunfels, TX 78132

Main Phone: 2812244030

Cell Phone: 2812244032

Robert & Peggy Morse

537 Chock Road
New Braunfels, TX 78132

Agency: Comal County Environmental

County: Comal

Subdivision: Vintage Oaks @ The Vineyard 21

System Info: MFG: Jet, Inc. Brand: J-750- 2 yr

Customer ID: 7975

Treatment Type: Aerobic

Disposal Type: Surface Application

Aerator S/N: JAN2400198

Insp ID: 543399

Installed: 2/28/2024

Warranty Expiration: 2/28/2025

Visit Details

<----->

Visit Date: 2/6/2025

Entered By: Diandra

Scheduled Date: 2/28/2025

Time In: 9:40

Contract Starts: 2/28/2024

Customer Emailed: 2/11/2025

Entered On: 2/11/2025

Time Out: 10:25

Contract Ends: 2/28/2026

Visit Results

Service Type: Scheduled Inspection

☒ Added Chlorine

Count: Inspection 3 of 6

Method: Grab

License #

Expires

Technician: Andrew Dykes - MT0001810

MT0001810

10/31/2025

Provider: R. Bruce Cobabe

MP0000572

11/30/2026

☒ Service Completed

Aerators: Operational

Filters: Operational

Irrigation Pumps: Operational

Sludge Level Tank 3: 0-1

Disinfection Device: Operational

Chlorine Supply: Operational

Chlorine Residual: 1.2

Chloring Amount Added: 6

Tank Lid / Riser: Secured

Electric Circuits: Operational

Distribution System: Operational

Drip/Sprayfield Veg: Operational

Alarm: Operational

Comments

Serviced.

Technician blew BAT media.

Minimal amount of sludge measured . - Technician Secured the Tank Lid and/or Riser prior to leaving location. - Copy emailed to the customer on 2/11/2025.

Provider: *R. Bruce Cobabe*

R. Bruce Cobabe

License: Number: MP0000572 Exp: 11/30/2026

South Texas Waste Water Treatment, LLC

(830) 249-8098

PO Box 1284
Boerne, TX 78006

Printed:6/27/2025

Permit: 116786

Site: 537 Chock Road, New Braunfels, TX 78132

Main Phone: 2812244030
Cell Phone: 2812244032

Robert & Peggy Morse
537 Chock Road
New Braunfels, TX 78132

Agency: Comal County Environmental
County: Comal
Subdivision: Vintage Oaks @ The Vineyard 21

System Info: MFG: <u>Jet, Inc.</u> Brand: <u>J-750- 2 yr</u>		Customer ID: <u>7975</u>	
Treatment Type: <u>Aerobic</u>	Disposal Type: <u>Surface Application</u>	Aerator S/N: <u>JAN2400198</u>	Insp ID: <u>546302</u>
Installed: <u>2/28/2024</u>	Warranty Expiration: <u>2/28/2025</u>		
Visit Details <----->			

Visit Date: 6/20/2025 Entered By: Johanna Monroe

Scheduled Date: <u>6/28/2025</u>	Time In: <u>2:05</u>	Contract Starts: <u>2/28/2024</u>	Customer Emailed: <u>6/23/2025</u>
Entered On: <u>6/23/2025</u>	Time Out: <u>2:27</u>	Contract Ends: <u>2/28/2026</u>	

Visit Results			<input checked="" type="checkbox"/> Added Chlorine
Service Type: <u>Scheduled Inspection</u>			
Count: <u>Inspection 4 of 6</u>			
Method: <u>Grab</u>	License #	Expires	
Technician: <u>Todd Caron - MT0001158</u>	<u>MT0001158</u>	<u>4/30/2025</u>	
Provider: <u>R. Bruce Cobabe</u>	<u>MP0000572</u>	<u>11/30/2026</u>	<input checked="" type="checkbox"/> Service Completed

Aerators: Operational
Filters: Operational
Irrigation Pumps: Operational
Disinfection Device: Operational
Chlorine Supply: Operational
Chlorine Residual: 1.3
Chloring Amount Added: 6

Tank Lid / Riser: Secured

Electric Circuits: Operational
Distribution System: Operational
Drip/Sprayfield Veg: Operational

Alarm: Operational

Comments
Serviced
- Technician Secured the Tank Lid and/or Riser prior to leaving location. - Copy emailed to the customer on 6/23/2025.

Provider: R. Bruce Cobabe
R. Bruce Cobabe
License: Number: MP0000572 Exp: 11/30/2026