



COMAL COUNTY

ENGINEER'S OFFICE

License to Operate On-Site Sewage Treatment and Disposal Facility

Issued This Date: 04/29/2024

Permit Number: 116857

Location Description: 1084 CYPRESS PASS RD
SPRING BRANCH, TX 78070

Subdivision: RIVERMONT
Unit: 2
Lot: 26
Block: 9
Acreage: 0.0000

Type of System: Aerobic
Surface Irrigation

Issued to: CODY W. WILLEY

This license is authorization for the owner to operate and maintain a private facility at the location described in accordance to the rules and regulations for on-site sewerage facilities of Comal County, Texas, and the Texas Commission on Environmental Quality.

The license grants permission to operate the facility. It does not guarantee successful operation. It is the responsibility of the owner to maintain and operate the facility in a satisfactory manner.

Alterations to this permit including, but not limited to:

- Increase in the square feet of living area
- Increase in the number of bedrooms
- A change of use (i.e. residential to commercial)
- Relocation of system components (including the relocation of spray heads)
- Installation of landscaping
- Adding new structures to the system

may require a new permit. **It is the responsibility of the owner to apply for a new permit, if applicable.**

Inspection and licensing of a facility indicates only that the facility meets certain minimum requirements. It does not impede any governmental entity in taking the proper steps to prevent or control pollution, to abate nuisance, or to protect the public health.

This license to operate is valid for an indefinite period. The holder may transfer it to a succeeding owner, provided the facility has not been remodeled and is functioning properly.

Licensing Authority
Comal County Environmental Health

ENVIRONMENTAL HEALTH INSPECTOR

OS0038255

ENVIRONMENTAL HEALTH COORDINATOR

Assistant: OS0034792

Comal County Environmental Health

OSSF Inspection Sheet

Installer Name: _____

OSSF Installer #: _____

1st Inspection Date: _____

2nd Inspection Date: _____

3rd Inspection Date: _____

Inspector Name: _____

Inspector Name: _____

Inspector Name: _____

Permit#:

Address:

No.	Description	Answer	Citations	Notes	1st Insp.	2nd Insp.	3rd Insp.
1	SITE AND SOIL CONDITIONS & SETBACK DISTANCES Site and Soil Conditions Consistent with Submitted Planning Materials		285.31(a) 285.30(b)(1)(A)(iv) 285.30(b)(1)(A)(v) 285.30(b)(1)(A)(iii) 285.30(b)(1)(A)(ii) 285.30(b)(1)(A)(i)				
2	SITE AND SOIL CONDITIONS & SETBACK DISTANCES Setback Distances Meet Minimum Standards		285.91(10) 285.30(b)(4) 285.31(d)				
3	SEWER PIPE Proper Type Pipe from Structure to Disposal System (Cast Iron, Ductile Iron, Sch. 40, SDR 26)		285.32(a)(1)				
4	SEWER PIPE Slope from the Sewer to the Tank at least 1/8 Inch Per Foot		285.32(a)(3)				
5	SEWER PIPE Two Way Sanitary - Type Cleanout Properly Installed (Add. C/O Every 100' &/or 90 degree bends)		285.32(a)(5)				
6	PRETREATMENT Installed (if required) TCEQ Approved List PRETREATMENT Septic Tank(s) Meet Minimum Requirements		285.32(b)(1)(G) 285.32(b)(1)(E)(iii) 285.32(b)(1)(E)(iv) 285.32(b)(1)(F) 285.32(b)(1)(B) 285.32(b)(1)(C)(i) 285.32(b)(1)(C)(ii) 285.32(b)(1)(D) 285.32(b)(1)(E) 285.32(b)(1)(A) 285.32(b)(1)(E)(ii)(II) 285.32(b)(1)(E)(i) 285.32(b)(1)(E)(ii)(I)				
7	PRETREATMENT Grease Interceptors if required for commercial		285.34(d)				

Inspector Notes:

**Comal County Environmental Health
OSSF Inspection Sheet**

No.	Description	Answer	Citations	Notes	1st Insp.	2nd Insp.	3rd Insp.
8	SEPTIC TANK Tank(s) Clearly Marked SEPTIC TANK If Single Tank, 2 Compartments Provided with Baffle SEPTIC TANK Inlet Flowline Greater than 3" and " T " Provided on Inlet and Outlet SEPTIC TANK Septic Tank(s) Meet Minimum Requirements		285.32(b)(1) (E) 285.91(2) 285.32(b)(1) (F) 285.32(b)(1)(E) (iii) 285.32(b)(1)(E)(ii) (II) 285.32(b)(1)(E)(ii) (I) 285.32(b)(1)(E) (i) 285.32(b)(1) (D) 285.32(b)(1)(C) (ii) 285.32(b)(1)(C) (i) 285.32(b)(1) (B) 285.32(b)(1) (A) 285.32(b)(1)(E)(iv)				
9	ALL TANKS Installed on 4" Sand Cushion/ Proper Backfill Used		285.32(b)(1)(F) 285.32(b)(1)(G) 285.34(b)				
10	SEPTIC TANK Inspection / Clean Out Port & Risers Provided on Tanks Buried Greater than 12" Sealed and Capped		285.38(d)				
11	SEPTIC TANK Secondary restraint system provided SEPTIC TANK Riser permanently fastened to lid or cast into tank SEPTIC TANK Riser cap protected against unauthorized intrusions		285.38(d) 285.38(e)				
12	SEPTIC TANK Tank Volume Installed						
13	PUMP TANK Volume Installed						
14	AEROBIC TREATMENT UNIT Size Installed						
15	AEROBIC TREATMENT UNIT Manufacturer AEROBIC TREATMENT UNIT Model Number						
16	DISPOSAL SYSTEM Absorptive		285.33(a)(4) 285.33(a)(1) 285.33(a)(2) 285.33(a)(3)				
17	DISPOSAL SYSTEM Leaching Chamber		285.33(a)(1) 285.33(a)(3) 285.33(a)(4) 285.33(a)(2)				
18	DISPOSAL SYSTEM Evapo-transpirative		285.33(a)(3) 285.33(a)(4) 285.33(a)(1) 285.33(a)(2)				

**Comal County Environmental Health
OSSF Inspection Sheet**

No.	Description	Answer	Citations	Notes	1st Insp.	2nd Insp.	3rd Insp.
19	DISPOSAL SYSTEM Drip Irrigation		285.33(c)(3)(A)-(F)				
20	DISPOSAL SYSTEM Soil Substitution		285.33(d)(4)				
21	DISPOSAL SYSTEM Pumped Effluent		285.33(a)(4) 285.33(a)(3) 285.33(a)(1) 285.33(a)(2)				
22	DISPOSAL SYSTEM Gravelless Pipe		285.33(a)(3) 285.33(a)(2) 285.33(a)(4) 285.33(a)(1)				
23	DISPOSAL SYSTEM Mound		285.33(a)(3) 285.33(a)(1) 285.33(a)(2) 285.33(a)(4)				
24	DISPOSAL SYSTEM Other (describe) (Approved Design)		285.33(d)(6) 285.33(c)(4)				
25	DRAINFIELD Absorptive Drainline 3" PVC or 4" PVC						
26	DRAINFIELD Area Installed						
27	DRAINFIELD Level to within 1 inch per 25 feet and within 3 inches over entire excavation		285.33(b)(1)(A)(v)				
28	DRAINFIELD Excavation Width DRAINFIELD Excavation Depth DRAINFIELD Excavation Separation DRAINFIELD Depth of Porous Media DRAINFIELD Type of Porous Media						
29	DRAINFIELD Pipe and Gravel - Geotextile Fabric in Place		285.33(b)(1)(E)				
30	DRAINFIELD Leaching Chambers DRAINFIELD Chambers - Open End Plates w/Splash Plate, Inspection Port & Closed End Plates in Place (per manufacturers spec.)		285.33(c)(2)				
31	LOW PRESSURE DISPOSAL SYSTEM Adequate Trench Length & Width, and Adequate Separation Distance between Trenches		285.33(d)(1)(C)(i)				

**Comal County Environmental Health
OSSF Inspection Sheet**

No.	Description	Answer	Citations	Notes	1st Insp.	2nd Insp.	3rd Insp.
32	EFFLUENT DISPOSAL SYSTEM Utilized Only by Single Family Dwelling EFFLUENT DISPOSAL SYSTEM Topographic Slopes < 2.0% EFFLUENT DISPOSAL SYSTEM Adequate Length of Drain Field (1000 Linear ft. for 2 bedrooms or Less & an additional 400 ft. for each additional bedroom) EFFLUENT DISPOSAL SYSTEM Lateral Depth of 18 inches to 3 ft. & Vertical Separation of 1ft on bottom and 2 ft. to restrictive horizon and ground water respectfully EFFLUENT DISPOSAL SYSTEM Lateral Drain Pipe (1.25 - 1.5" dia.) & Pipe Holes (3/16 - 1/4" dia. Hole Size) 5 ft. Apart		285.33(b)(3)(A) 285.33(b)(3)(A) 285.33(b)(3)(B) 285.91(13) 285.33(b)(3)(D) 285.33(b)(3)(F)				
33	AEROBIC TREATMENT UNIT Is Aerobic Unit Installed According to Approved Guidelines.		285.32(c)(1)				
34	AEROBIC TREATMENT UNIT Inspection/Clean Out Port & Risers Provided AEROBIC TREATMENT UNIT Secondary restraint system provided AEROBIC TREATMENT UNIT Riser permanently fastened to lid or cast into tank AEROBIC TREATMENT UNIT Riser cap protected against unauthorized intrusions						
35	AEROBIC TREATMENT UNIT Chlorinator Properly Installed with Chlorine Tablets in Place.						
36	PUMP TANK Is the Pump Tank an approved concrete tank or other acceptable materials & construction PUMP TANK Sampling Port Provided in the Treated Effluent Line PUMP TANK Check Valve and/or Anti- Siphon Device Present When Required PUMP TANK Audible and Visual High Water Alarm Installed on Separate Circuit From Pump						
37	PUMP TANK Inspection/Clean Out Port & Risers Provided PUMP TANK Secondary restraint system provided PUMP TANK Riser permanently fastened to lid or cast into tank PUMP TANK Riser cap protected against unauthorized intrusions						
38	PUMP TANK Secondary restraint system provided						
39	PUMP TANK Electrical Connections in Approved Junction Boxes / Wiring Buried						

**Comal County Environmental Health
OSSF Inspection Sheet**

No.	Description	Answer	Citations	Notes	1st Insp.	2nd Insp.	3rd Insp.
40	APPLICATION AREA Distribution Pipe, Fitting, Sprinkler Heads & Valve Covers Color Coded Purple?		285.33(d)(2)(G)(iii)(II) 285.33(d)(2)(G)(iii)(III) 285.33(d)(2)(G)(v) 285.33(d)(2)(G)(iii) 285.33(d)(2)(G)(iv) 285.33(d)(2)(G)(i) 285.33(d)(2)(G)(ii) 285.33(d)(2)(G)(iii)(I)				
41	APPLICATION AREA Low Angle Nozzles Used / Pressure is as required APPLICATION AREA Acceptable Area, nothing within 10 ft of sprinkler heads? APPLICATION AREA The Landscape Plan is as Designed		285.33(d)(2)(G) (i)285.33(d)(2) (A)285.33(d)(2)(F)				
42	APPLICATION AREA Area Installed						
43	PUMP TANK Meets Minimum Reserve Capacity Requirements						
44	PUMP TANK Material Type & Manufacturer						
45	PUMP TANK Type/Size of Pump Installed						



COMAL COUNTY

ENGINEER'S OFFICE

Permit of Authorization to Construct an On-Site Sewage Facility Permit Valid For One Year From Date Issued

Permit Number: 116857
Issued This Date: 11/14/2023
This permit is hereby given to: CODY W. WILLEY

To start construction of a private, on-site sewage facility located at:

1084 CYPRESS PASS RD
SPRING BRANCH, TX 78070

Subdivision: RIVERMONT
Unit: 2
Lot: 26
Block: 9
Acreage: 0.0000

APPROVED MINIMUM SIZES AS PER ATTACHED DESIGN

Type of System: Aerobic
Surface Irrigation

This permit gives permission for the construction of the above referenced on-site facility to commence. Installation must be completed by an installer holding a valid registration card from the Texas Commission on Environmental Quality (TCEQ). Installation and inspection must comply with current TCEQ and Comal County requirements.

Call (830) 608-2090 to schedule inspections.



COMAL COUNTY
ENGINEER'S OFFICE

ON-SITE SEWAGE FACILITY APPLICATION

195 DAVID JONAS DR
NEW BRAUNFELS, TX 78132
(830) 608-2090
WWW.CCEO.ORG

Date October 3, 2023 Permit Number 116857

1. APPLICANT / AGENT INFORMATION

Owner Name	<u>CODY W. WILLEY</u>	Agent Name	<u>GREG JOHNSON, P.E.</u>
Mailing Address	<u>1922 BRAND ROAD</u>	Agent Address	<u>170 HOLLOW OAK</u>
City, State, Zip	<u>BULVERDE TEXAS 78163</u>	City, State, Zip	<u>NEW BRAUNFELS TEXAS 78132</u>
Phone #	<u>210-204-2528</u>	Phone #	<u>830-905-2778</u>
Email	<u>courtneywilleyrealtor@outlook.com</u>	Email	<u>gregjohnsonpe@yahoo.com</u>

2. LOCATION

Subdivision Name RIVERMONT Unit 2 Lot 26 Block 9
Survey Name / Abstract Number _____ Acreage _____
Address 1084 CYPRESS PASS ROAD City SPRING BRANCH State TX Zip 78070

3. TYPE OF DEVELOPMENT

☒ Single Family Residential

Type of Construction (House, Mobile, RV, Etc.) HOUSE

Number of Bedrooms 4

Indicate Sq Ft of Living Area 2645

☐ Non-Single Family Residential

(Planning materials must show adequate land area for double the required and needed for treatment units and disposal area)

Type of Facility _____

Offices, Factories, Churches, Schools, Parks, Etc. - Indicate Number Of Occupants _____

Restaurants, Lounges, Theaters - Indicate Number of Seats _____

Hotel, Motel, Hospital, Nursing Home - Indicate Number of Beds _____

Travel Trailer/RV Parks - Indicate Number of Spaces _____

Miscellaneous _____

Estimated Cost of Construction: \$ 550,000 (Structure Only)

Is any portion of the proposed OSSF located in the United States Army Corps of Engineers (USACE) flowage easement?

☐ Yes ☒ No (If yes, owner must provide approval from USACE for proposed OSSF improvements within the USACE flowage easement)

Source of Water ☐ Public ☒ Private Well ☐ Rainwater Collection

4. SIGNATURE OF OWNER

By signing this application, I certify that:

- The completed application and all additional information submitted does not contain any false information and does not conceal any material facts. I certify that I am the property owner or I possess the appropriate land rights necessary to make the permitted improvements on said property.
- Authorization is hereby given to the permitting authority and designated agents to enter upon the above described property for the purpose of site/soil evaluation and inspection of private sewage facilities..
- I understand that a permit of authorization to construct will not be issued until the Floodplain Administrator has performed the reviews required by the Comal County Flood Damage Prevention Order.
- I affirmatively consent to the online posting/public release of my e-mail address associated with this permit application, as applicable.

10/24/23

[Signature]
Signature of Owner

Date

* * * COMAL COUNTY OFFICE OF ENVIRONMENTAL HEALTH * * *

APPLICATION FOR PERMIT FOR AUTHORIZATION TO CONSTRUCT AN
ON-SITE SEWAGE FACILITY AND LICENSE TO OPERATEPlanning Materials & Site Evaluation as Required Completed By GREG W. JOHNSON, P.E.System Description PROPRIETARY; AEROBIC TREATMENT AND SURFACE IRRIGATION

Size of Septic System Required Based on Planning Materials & Soil Evaluation

Tank Size(s) (Gallons) PRO-FLO MODEL 5060 Absorption/Application Area (Sq Ft) 4763Gallons Per Day (As Per TCEQ Table III) 300

(Sites generating more than 5000 gallons per day are required to obtain a permit through TCEQ)

Is the property located over the Edwards Recharge Zone? ☐ Yes ☒ No

(If yes, the planning materials must be completed by a Registered Sanitarian (R.S.) or Professional Engineer (P.E.))

Is there an existing TCEQ approved WPAP for the property? ☐ Yes ☒ No

(if yes, the R. S. or P. E. shall certify that the OSSF design complies with all provisions of the existing WPAP.)

If there is no existing WPAP, does the proposed development activity require a TCEQ approved WPAP? ☐ Yes ☒ No

(If yes, the R.S. or P. E. shall certify that the OSSF design will comply with all provisions of the proposed WPAP. A Permit to Construct will not be issued for the proposed OSSF until the proposed WPAP has been approved by the appropriate regional office.)

Is the property located over the Edwards Contributing Zone? ☒ Yes ☐ NoIs there an existing TCEQ approval CZP for the property? ☐ Yes ☒ No

(if yes, the P.E. or R.S. shall certify that the OSSF design complies with all provisions of the existing CZP)

If there is no existing CZP, does the proposed development activity require a TCEQ approved CZP? ☐ Yes ☒ No

(if yes, the P.E. or R.S. shall certify that the OSSF design will comply with all provisions of the proposed CZP. A Permit to construct will not be issued for the proposed OSSF until the CZP has been approved by the appropriate regional office.)

Is this property within an incorporated city? ☐ Yes ☒ No

If yes, indicate the city: _____

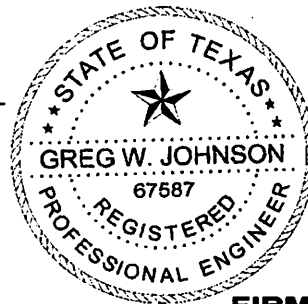
**FIRM #2585**

By signing this application, I certify that:

- The information provided above is true and correct to the best of my knowledge.
- I affirmatively consent to the online posting/public release of my e-mail address associated with this permit application, as applicable

Signature of Designer

Date October 4, 2023

AFFIDAVIT**THE COUNTY OF COMAL
STATE OF TEXAS****CERTIFICATION OF OSSF REQUIRING MAINTENANCE**

According to Texas Commission on Environmental Quality Rules for On-Site Sewage Facilities (OSSF's), this document is filed in the Deed Records of Comal County, Texas.

I

The Texas Health and Safety Code, Chapter 366 authorizes the Texas Commission on Environmental Quality (TCEQ) to regulate on-site sewage facilities (OSSFs). Additionally, the Texas Water Code (TWC), § 5.012 and § 5.013, gives the commission primary responsibility for implementing the laws of the State of Texas relating to water and adopting rules necessary to carry out its powers and duties under the TWC. The commission, under the authority of the TWC and the Texas Health and Safety code, requires owner's to provide notice to the public that certain types of OSSFs are located on specific pieces of property. To achieve this notice, the commission requires a recorded affidavit. Additionally, the owner must provide proof of the recording to the OSSF permitting authority. This recorded affidavit is not a representation or warranty by the commission of the suitability of this OSSF, nor does it constitute any guarantee by the commission that the appropriate OSSF was installed.

II

An OSSF requiring a maintenance contract, according to 30 Texas Administrative Code §285.91(12) will be installed on the property described as (insert legal description):

2 UNIT/PHASE/SECTION 9 BLOCK 26 LOT RIVERMONT SUBDIVISION

IF NOT IN SUBDIVISION: _____ ACREAGE _____ SURVEY

The property is owned by (insert owner's full name): CODY W. WILLEY

This OSSF must be covered by a continuous maintenance contract for the first two years. After the initial two-year service policy, the owner of an aerobic treatment system for a single family residence shall either obtain a maintenance contract within 30 days or maintain the system personally.

Upon sale or transfer of the above-described property, the permit for the OSSF shall be transferred to the buyer or new owner. A copy of the planning materials for the OSSF can be obtained from the Comal County Engineer's Office.

WITNESS BY HAND(S) ON THIS 24 DAY OF OCTOBER, 2023

Cody W. Willey
Owner(s) signature(s)

CODY W. WILLEY
Owner (s) Printed name (s)

CODY W. WILLEY SWORN TO AND SUBSCRIBED BEFORE ME ON THIS 24 DAY OF
OCTOBER, 2023

Greg W. Johnson
Notary Public Signature

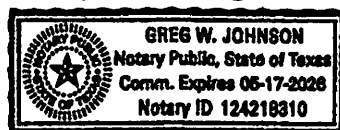

Filed and Recorded
Official Public Records
Bobbie Koepf, County Clerk
Comal County, Texas
10/30/2023 08:24:55 AM
LAURA 1 Pages(s)
202306034475



Bobbie Koepf



MJ Central Texas Septic, LLC - DBA MJ SEPTIC

27552 Old Blanco Road
San Antonio, Texas 78260
(210) 875-3625

mjseptic@mjseptic.com (email)
www.mjseptic.com (website)

Residential Aerobic Maintenance Contract

Licensed by T.C.E.Q. Michael J. Long, MP 0001294

PROPERTY ADDRESS: 1084 CYPRESS PASS ROAD - RIVERMONT, UNIT 2, BLOCK 9, LOT 26

TERMS OF PAYMENT: *Payment is due in full for the maintenance contract at time of signing. A credit card will be required at time of booking any service for parts, repairs, cleaning/pumping, service calls, red lights, etc. unless otherwise specifically noted. MJ will not perform any repairs or pumping unless we have a credit card on file.* MJ Septic no longer accepts payment onsite, whether it be a check or credit card and we no longer offer billing/invoicing for future payments; this is a strict office policy, no exceptions.

1 YEAR	2 YEAR	3 YEAR	2 YEAR INITIAL	Additional Information
\$285	\$530	\$675	Included with Installation	Homeowner(s) are NOT required to be present at inspections. Please note, clients will receive an emailed notice 5-7 business days prior to your scheduled inspection, this is your only notification we will send. A door hanger will be left if no one is home. Inspection reports are emailed/mailed within a few business days to the email/mailling address of record, please check your spam folder. If you have not received it after 72 hours please email or call our office.

- MAINTENANCE TIPS/SEPTIC GUIDE:** Please retain the attached Maintenance Tips/Septic Guide for future reference. Please note our business hours are Monday - Friday 8am to 5pm, should you have an emergency during non-business hours, please look this over and follow the necessary steps until you can reach us during normal business hours!
- If you are unable to reach us during business hours, you can leave a voicemail or send an email (we attempt to respond to emails during weekends and holidays as best as we can!)

Acceptance of Maintenance Contract: The above prices, specifications, and conditions are satisfactory and are hereby accepted. MJ Septic is authorized to enter property to perform routine maintenance inspections as agreed. I have read and agreed to the maintenance contract guidelines stated above and have also read and agreed to comply with the Maintenance Tips/Septic Guide. MJ Septic reserves the right to make amendments to this document at any time and the homeowner will be responsible for signing an updated version for office and county records.

Please note, clients will receive an emailed notice 5-7 business days prior to your scheduled inspection, this is your only notification we will send. (MJ Septic will assess a \$75 re inspection/missed inspection fee if we are not granted access to complete your inspection on the date assigned, aggressive dogs, etc)

Property Address: 1084 CYPRESS PASS ROAD City: SPRING BRANCH, TX Zip Code: 78070

Client Name: CODY W. WILLEY

Contract Start Date: _____ Contract End Date: _____ Total Fee Paid: _____

Permitting Authority: COMAL Subdivision Gate Code: _____ Property Gate Code: _____

Subdivision: RIVERMONT Number in Household: _____ Aggressive Dogs: _____

Email Address: courtneywilleyrealtor@outlook.com Email Address: _____

Cell Phone (his/hers): 210-204-2528 Cell Phone (his/hers): _____ Home Phone: _____

Client Approval Signature:  Date of Client Acceptance: _____

MJ Central Texas Septic, LLC Authorized Signature: Stephanie E. Perez Date of MJ Approval: _____



MJ Central Texas Septic, LLC - DBA MJ SEPTIC

27552 Old Blanco Road
San Antonio, Texas 78260
(210) 875-3625

mjseptic@mjseptic.com (email)
www.mjseptic.com (website)

Residential Aerobic Maintenance Contract

Licensed by T.C.E.Q. Michael J. Long, MP 0001294

PROPERTY ADDRESS: 1084 CYPRESS PASS ROAD - RIVERMONT, UNIT 2, BLOCK 9, LOT 26

The Texas Commission on Environmental Quality (TCEQ) requires all ATU's to be checked and maintained every four months for the life of the unit (*some permitting authorities may stipulate this requirement, after the first two years after installation; call your county to inquire*). Upon expiration of this contract, MJ Septic will offer a continuation of your maintenance contract to cover labor and routine maintenance/reports. Lab testing, if required, for coliform, TSS, BOD etc. are NOT included in this policy and applicable fees are the owner's responsibility. MJ Septic will inspect and service your ATU once every 4 months for the duration of your 2-year initial contract. For a new single-family dwelling, this is the date of installation, required by state guidelines dated June 13, 2001. For an existing single-family dwelling, this is the date the notice of approval is issued by your permitting authority. The effective date of this maintenance contract shall be the date the LTO (license to operate) is issued.

MJ Septic will address all major concerns/complaints (excluding weekends & holidays) within 72 hours from the initial point of contact with the homeowner(s). Please note our business hours are Monday - Friday 8am to 5pm

- **INSPECTIONS:** an inspection every four months (three times annually) which includes inspecting/servicing the mechanical, electrical, and other applicable components to ensure proper function. The annual fee does not include any parts, cleaning/pumping, chlorine/bleach (tablets or liquid), additional service calls or additional testing that may be required by any regulating authority. If for any reason, we are unable to obtain access to your property or system to perform a service check, you may be charged a **\$75 service call for re-scheduling**. It is very important that we always have full access to your system, including all gate codes, combination locks etc. to inspect your system.
- **SERVICE CALLS:** If a service call is required by homeowner/renter between regular inspections, **a service call fee of \$75 (not including parts and/or cleaning/pumping) will be assessed**. We may waive this fee at our discretion. These calls include but are not limited to the following: red light alarms, high water alarms, chlorinator checks, disconnected airlines, timer adjustments, spray head adjustments and system power failure.
- **REPAIRS:** If repairs or replacement of parts are needed during routine inspection, we will attempt to contact the homeowner for approval to make onsite repairs. If we are unable to repair/replace parts onsite, the client will be notified via email and/or USPS that repairs/replacement of parts is needed. All MAJOR part replacements come with a 2-year warranty (see notes below). **There will be a \$75 warranty credit fee assessed on all parts. Warranted items will only be honored when a valid maintenance contract is in effect with MJ Septic. If the contract has a lapse in time, ALL WARRANTED items are VOIDED.**
For ATU's under initial installation warranty (2 years from initial installation date) if warranted items are required to be replaced within 30 days of installation, part will be replaced with no fees, **after 30 days there will be a \$75 warranty credit fee assessed on all parts. Warranted items will only be honored when a valid maintenance contract is in place with MJ Septic.**
- **CLEANING/PUMPING:** The cleaning/pumping of your ATU is not included in your maintenance contract. We always recommend pumping between 10-12" of sludge. We determine this by gathering 3-4 different readings out of your pump tank with a sludge judge. A few other factors that *may* determine pumping is necessary even if your sludge reading is less than 10-12". **A typical/average household will need to have their system pumped every 2-5 years; this all depends on usage and will vary per household**



MJ Central Texas Septic, LLC - DBA MJ SEPTIC

27552 Old Blanco Road
San Antonio, Texas 78260
(210) 875-3625

mjseptic@mjseptic.com (email)
www.mjseptic.com (website)

Residential Aerobic Maintenance Contract
Licensed by T.C.E.Q. Michael J. Long, MP 0001294

PROPERTY ADDRESS: 1084 CYPRESS PASS ROAD - RIVERMONT, UNIT 2, BLOCK 9, LOT 26

- **CHLORINE SUPPLY:** *The property owner is responsible for maintaining their own chlorine supply.* TCEQ regulation requires proper chlorination. For liquid chlorinators, homeowners are to add 2-3 gallons of liquid chlorine/bleach per month. (if the chlorinator is completely empty, DO NOT add more than 3 ½-4 gallons of liquid chlorine/bleach at a time) For tablet chlorinators, homeowners can purchase Calcium Hypochlorite tablets typically purchased at a local Home Depot or Lowe's. **DO NOT USE POOL TABLETS** (this can cause a dangerous volatile chemical reaction)
- **TRANSFER OF MAINTENANCE CONTRACT/PROPERTY OWNERSHIP:** The fee of this maintenance contract is non-refundable, however is fully transferable to the new owner(s). If this policy is sold within the contract period, the signing party is responsible for all repairs unless the new homeowner(s) information is provided before repairs are made and the transfer contract is signed (by the new homeowner) and returned to us. The new homeowner(s) will be emailed a copy of the powerpoint orientation, if it was an MJ Septic installation, once the signed contract is received on file with our office.
RENTAL HOMES: The PROPERTY OWNER is responsible for all fees associated with this contract. Renters will be required to have a walk-through orientation during their first visit to ensure proper usage, etc.
- **ALTERATIONS/MODIFICATIONS TO THE SYSTEM:** Do not allow alteration to any part of the system or sprinkler head locations. Alterations would put the system out of county/code compliance and would cause the property owner additional expense to bring the system back into compliance. Any use of another company to make repairs to the system will void any warranties and be considered as a breach of this maintenance contract. If a client chooses to purchase and use their own parts, MJ Septic will not install nor work on these parts. Adding pools, decks, sport courts, outdoor kitchens, sheds etc. without proper septic design and county permitting is not acceptable. You must have a septic designer redesign your septic system and have permitting authority's approval prior to any additions being made. MJ Septic is not liable for any fines you may incur from illegal modifications.
- **WARRANTY VIOLATIONS:** Violations of the warranty include but are not limited to the following: turning off your system at any time, disconnecting the alarm; restricting airflow to the air compressor, overloading the system above its daily rated capacity, introducing excessive amounts of harmful matter (including harsh chemicals, cleaners, antibiotics, etc.) into the system or any other harmful usage of your OSSF/ATU. Refusing to clean/pump out septic when recommended and/or replacing necessary parts as needed. Necessary treatment of ants. Homeowners must keep grass, weeds and plants trimmed and clear of tank access points, control panel, air compressor, etc. Moving sprinkler lines without proper documentation, etc. Building over septic tanks, lids, etc. Adding pools, decks, sport courts, outdoor kitchens, sheds etc. without proper septic design and county permitting is not acceptable. You must have a septic designer redesign your septic system and have permitting authority's approval prior to any additions being made. MJ Septic is not liable for any fines you may incur from illegal modifications.



Maintenance Tips/Septic Guide

27552 Old Blanco Road
San Antonio, Texas 78260
(210) 875-3625
mjseptic@mjseptic.com
www.mjseptic.com

To keep your system functioning properly, regular maintenance is required. No matter how well the system is maintained or how well your aerobic system is designed and household usage, there will be parts that need to be replaced. Some are less expensive (and more common) like diffuser bars (if required, not all brands use diffusers), filters, sprinkler heads, airline, float switches, timers, audio and visual alarms, etc. Some are more expensive like sprinkler pumps, air compressors and septic tank cleanings, etc. With owning an aerobic system, you should expect to have parts replaced and it needing to be cleaned/pumped out. The life span of each part of your system will vary depending upon how many people use your system, how much water is used, what types of food you eat, what medicines are taken, the type of cleaning chemicals being used in the household, what you flush down the commode and of course the regular life expectancy for each functioning part, etc.

Some of the items checked during routine inspections that may need to be replaced or repaired according to their life span. These items include, but are not limited to: air compressor (aerator), a/c filters, filter pads, diffuser bars, sprinkler pumps (irrigation pumps), control panels, electrical circuit boards, float switches, timers, audio alarms, visual alarms, airline, photocell, toggle switches, wires, junction boxes, risers and/or lids, sprinkler heads, chlorinators, etc.

Below are some recommendations that will help you keep maintenance costs down and will help your aerobic system function properly.

- **RED LIGHT ALARMS:** If your alarm turns on, don't be alarmed (it usually isn't an emergency) Please call our office and schedule a service call with our office. If we are closed (after hours, weekends or holidays), please leave (1) voicemail at (210) 875-3625. You may also send a text to this number. You may email us to leave a request at mjseptic@mjseptic.com if you are unable to call or text. We will make a work order for the next available business day. During this time, you as the homeowner need to reduce all non-essential water usage. Don't wait days to report red light alarms! Please note, in extreme weather conditions, excessive heavy rains can and will cause your septic alarm and sprinkler heads to discharge, this is normal, the water is being relieved from the tank. If your alarm light stays on well after the rains have ceased, please call us to get a technician out to your property.
- **POWER:** In the event of a red-light alarm or at any other time NEVER shut off the power to your system!
- **IRRIGATION SYSTEMS (lawn care) & ALTERATIONS TO THE SYSTEM:** Avoid spraying your irrigation system in the same areas as your septic spray areas. This will cause over saturation to the lawn. Homeowners, landscapers, irrigation and pool companies should NEVER replace or tamper with your aerobic system, including the spray heads. Doing so will void any warranties (if applicable) and may result in additional costs to the homeowner for necessary repairs to bring the system back into compliance. For any changes wanted or needed for swimming pools, decks, sport courts, patios or irrigation systems, it is the homeowner's responsibility to call MJ Septic, LLC at (210) 875-3625 to assist in taking the necessary measures to have alterations made. This usually requires the system to be redesigned by one of our septic designers and re-permitted with your respective county. Do not build over any part of the aerobic system (the sprinklers can only be applied to natural vegetation surfaces!) Do not landscape over any part of the aerobic system (trees, plants, flowers, etc.) Do not allow ants to mound by any part of the aerobic system. Ant killers can be used to treat if mounds occur. (Ants will ruin electrical components and void any warranties if applicable) Keep all vegetation mowed and trimmed around the entire system, including the spray heads & spray area. If the technician cannot access the system due to overgrown grass, weeds, bushes, etc. there will be a service call charge assessed to return for inspection.
- **CHLORINE (tablets & liquid):** Never store your tablets near water heaters or in your water heater closet. Keep chlorine away from gas and electricity. It is always best to store it in a cool, dry and well-ventilated area.
**** For tablet chlorinators:** use only chlorine that is designed to treat wastewater! Calcium Hypochlorite tablets are available at your local Home Depot or Lowe's. We do not sell them. **NEVER USE SWIMMING POOL TABLETS!** (mixing pool tablets with wastewater tablets could cause a dangerous volatile reaction. When the chlorinator is completely empty, do not add more than 4-5 tablets at a time to prevent the chlorinator from clogging.
**** For liquid chlorinators:** you may use liquid chlorine/bleach (same bleach used to wash whites) When the chlorinator is completely empty, add no more than 3 ½ gallons of liquid chlorine bleach at a time. We recommend 2-3 gallons monthly (this will vary depending on how much water is used in the home per month) Do not tamper with chlorinators! This will void any warranties (if applicable).
- **MISC INFO I:** An aerobic system should not be treated as a city sewer. Economy in the use of water helps prevent overloading the system. Leaky faucets, running commodes, etc. should be guarded against as well. Avoid doing all your laundry in the same day (you must space out 1-2 loads daily); surges of water entering the system can and will hydraulically overload the system and throw off the balance of bacteria, which will not allow your waste to break down properly.
- **MISC INFO II:** Items flushed down commodes and/or poured down the drains DO NOT disappear; they must be treated by the system! Aerobic systems are designed to treat domestic wastewater and most toilet paper (read labels). Things that can harm your system include, but are not limited to are: excessive use of garbage disposal (very light use is okay, only if necessary, otherwise it is strongly recommended against!) fat, grease, oils, too many harsh cleaners, excessive use of fabric softener, excessive use of bleach, cigarette butts, feminine wipes, baby wipes, facial wipes, cleaning wipes, any type of wipes, feminine products, paper towels, condoms, q-tips, paint and/or paint thinners, varnishes, drain cleaners, automatic toilet bowl cleaners, hair combings, pet hair, coffee grounds, fruit, fruit peels, dental floss, any type of diapers, kitty litter, gauze bandages, unused medications, etc. Items such as these even though they may say "flushable" or "septic safe" still may not be ultimately safe for your aerobic treatment unit and cannot potentially cause the homeowner additional expenses for repairs and pumping.
- **MISC INFO III:** We take sludge level readings at every routine inspection (every four months) unless the system has been shut off/power failure or the system is overflowing. We always recommend cleaning/pumping of the system when levels reach 10-12" of sludge. *A typical/average household will need to have their system cleaned/pumped every 2-5 years; this all depends on usage and WILL VARY per HOUSEHOLD! This fee is NOT included in your annual maintenance contract agreement.

Greg W. Johnson, P.E.
170 Hollow Oak
New Braunfels, Texas 78132
830/905-2778

October 5, 2023

Comal County Office of Environmental Health
195 David Jonas Drive
New Braunfels, Texas 78132-3760

RE- Septic Design
1084 CYPRESS PASS ROAD
RIVERMONT UNIT 2, BLOCK 9, LOT 26
SPRING BRANCH, TX 78070
WILLEY RESIDENCE

Brandon/Brenda,

Due to the lack of available application area it is necessary to have the setback from the property line to the spray at ten feet as required by TCEQ Chapter 285 rules Table X. I hereby request a variance to the twenty foot setback to property lines as required by Comal County Order and equivalent protection will be maintained by including a battery backup to the timer clock to assure sprayers to only spray during the predawn hours. In my professional opinion this variance will not pose a threat to the environment or public health.

If I can be of further assistance please contact me.

Respectfully yours,

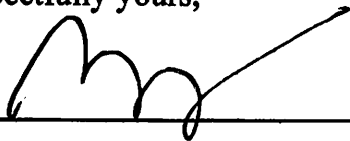

Greg W. Johnson, P.E., F#2585

October 5, 2023

Date

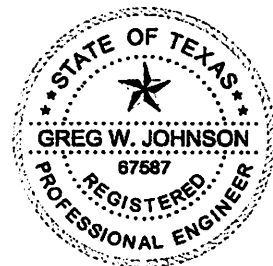

ON-SITE SEWERAGE FACILITY SOIL EVALUATION REPORT INFORMATION

Date Soil Survey Performed: October 03, 2023

Site Location: RIVERMONT, UNIT 2, BLOCK 9, LOT 26

Proposed Excavation Depth: N/A

Requirements:

At least two soil excavations must be performed on the site, at opposite ends of the proposed disposal area.
Locations of soil boring or dug pits must be shown on the site drawing.
For subsurface disposal, soil evaluations must be performed to a depth of at least two feet below the proposed excavation depth. For surface disposal, the surface horizon must be evaluated.
Describe each soil horizon and identify any restrictive features on the form. Indicate depths where features appear.

SOIL BORING NUMBER <u> </u> SURFACE EVALUATION <u> </u>						
Depth (Feet)	Texture Class	Soil Texture	Gravel Analysis	Drainage (Mottles/ Water Table)	Restrictive Horizon	Observations
0	IV	CLAY	N/A	NONE OBSERVED	LIMESTONE @ 4"	DRK. BROWN STONY
1						
2						
3						
4						
5						

SOIL BORING NUMBER <u> </u> SURFACE EVALUATION <u> </u>						
Depth (Feet)	Texture Class	Soil Texture	Gravel Analysis	Drainage (Mottles/ Water Table)	Restrictive Horizon	Observations
0	SAME		AS		ABOVE	
1						
2						
3						
4						
5						

I certify that the findings of this report are based on my field observations and are accurate to the best of my ability.

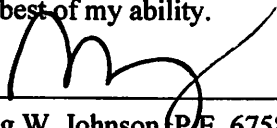

Greg W. Johnson, P.E. 67587-F2585, S.E. 11561

10/03/2023
Date

OSSF SOIL EVALUATION REPORT INFORMATION

Date: October 05, 2023

Applicant Information:

Name: CODY W. WILLEY
Address: 1922 BRAND ROAD
City: BULVERDE State: TEXAS
Zip Code: 78163 Phone: (210) 204-2528

Site Evaluator Information:

Name: Greg W. Johnson, P.E., R.S., S.E. 11561
Address: 170 Hollow Oak
City: New Braunfels State: Texas
Zip Code: 78132 Phone & Fax (830)905-2778

Property Location:

Lot 26 Unit 2 Blk 9 Subd. RIVERMONT
Street Address: 1084 CYPRESS PASS ROAD
City: SPRING BRANCH Zip Code: 78070
Additional Info.: _____

Installer Information:

Name: _____
Company: _____
Address: _____
City: _____ State: _____
Zip Code: _____ Phone _____

Topography: Slope within proposed disposal area: 2 %

Presence of 100 yr. Flood Zone: YES _____ NO X
Existing or proposed water well in nearby area: YES X NO _____ >100'
Presence of adjacent ponds, streams, water impoundments: YES _____ NO X
Presence of upper water shed: YES _____ NO X
Organized sewage service available to lot: YES _____ NO X

Design Calculations for Aerobic Treatment with Spray Irrigation:

Commercial

Q = _____ GPD

Residential Water conserving fixtures to be utilized? Yes X No _____

Number of Bedrooms the septic system is sized for: 4 Total sq. ft. living area 2645

Q gal/day = (Bedrooms +1) * 75 GPD - (20% reduction for water conserving fixtures)

Q = (4 +1)*75-(20%)= 300

Trash Tank Size 397 Gal.

TCEQ Approved Aerobic Plant Size 600 G.P.D.

Req'd Application Area = Q/Ri = 300 / 0.064 = 4688 sq. ft.

Application Area Utilized = 4763 sq. ft.

Pump Requirement 12 Gpm @ 41 Psi (Redjacket 0.5 HP 18 G.P.M. series or equivalent)

Dosing Cycle: _____ ON DEMAND or X TIMED TO DOSE IN PREDAWN HOURS

Pump Tank Size = 768 Gal. 13.3 Gal/inch.

Reserve Requirement = 100 Gal. 1/3 day flow.

Alarms: Audible & Visual High Water Alarm & Visual Air Pump malfunction

With Chlorinator NSF/TCEQ APPROVED

SCH-40 or SDR-26 3" or 4" sewer line to tank

Two way cleanout

Pop-up rotary sprinkler heads w/ purple non-potable lids

1" Sch-40 PVC discharge manifold

APPLICATION AREA SHOULD BE SEEDED AND MAINTAINED WITH VEGETATION.

EXPOSED ROCK WILL BE COVERED WITH SOIL .

I HAVE PERFORMED A THOROUGH INVESTIGATION BEING A REGISTERED PROFESSIONAL ENGINEER AND SITE EVALUATOR IN ACCORDANCE WITH CHAPTER 285, SUBCHAPTER D, §285.30, & §285.40 (REGARDING RECHARGE FEATURES), TEXAS COMMISSION OF ENVIRONMENTAL QUALITY (EFFECTIVE DECEMBER 29, 2016)

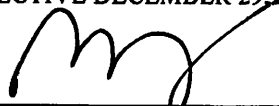
GREG W. JOHNSON, P.E. F#002585 - S.E. 11561

10/05/23
DATE

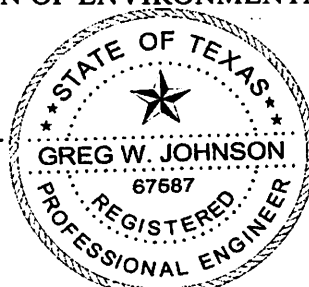

FIRM #2585

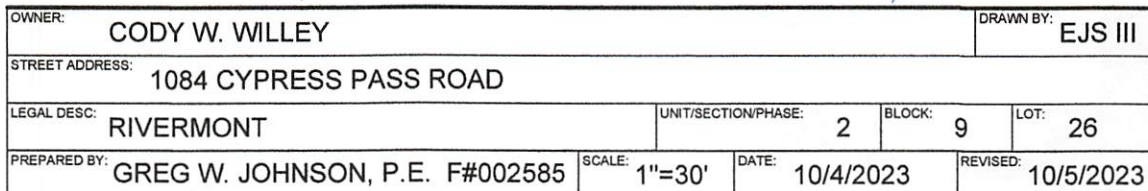

TANK NOTES:

Tanks must be set to allow a minimum of 1/8" per foot fall from the residence.

Tightlines to the tank shall be SCH-40 PVC.

A two way sanitary tee is required between residence and tank.

A minimum of 4" of sand, sandy loam, clay loam free of rock shall be placed under and around tanks

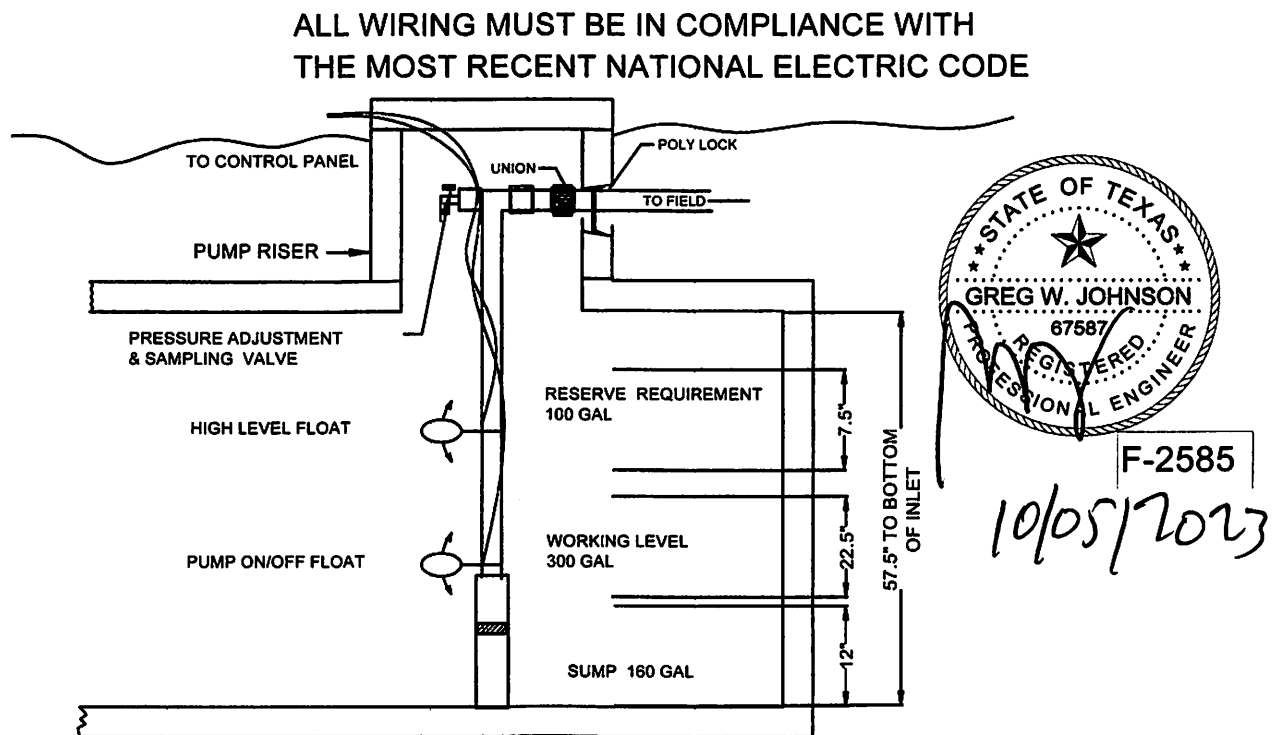

TYPICAL PUMP TANK CONFIGURATION
PRO-FLO 768 GAL PUMP TANK

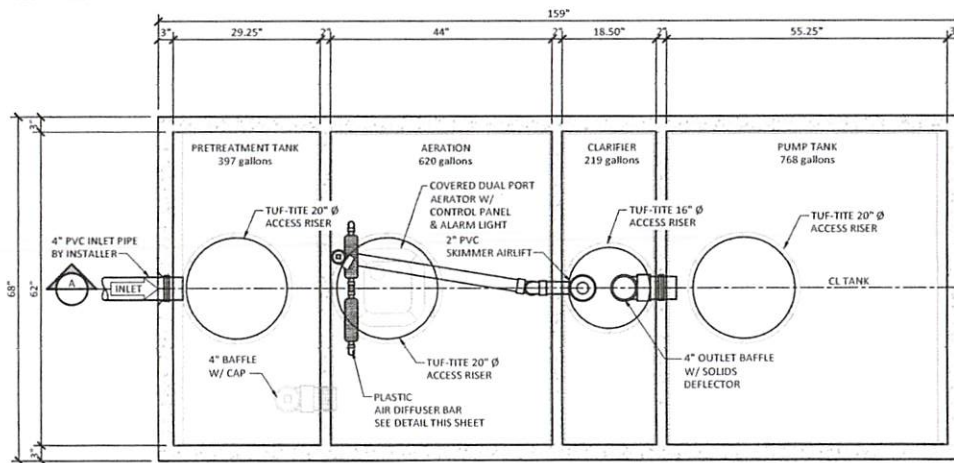

PLAN

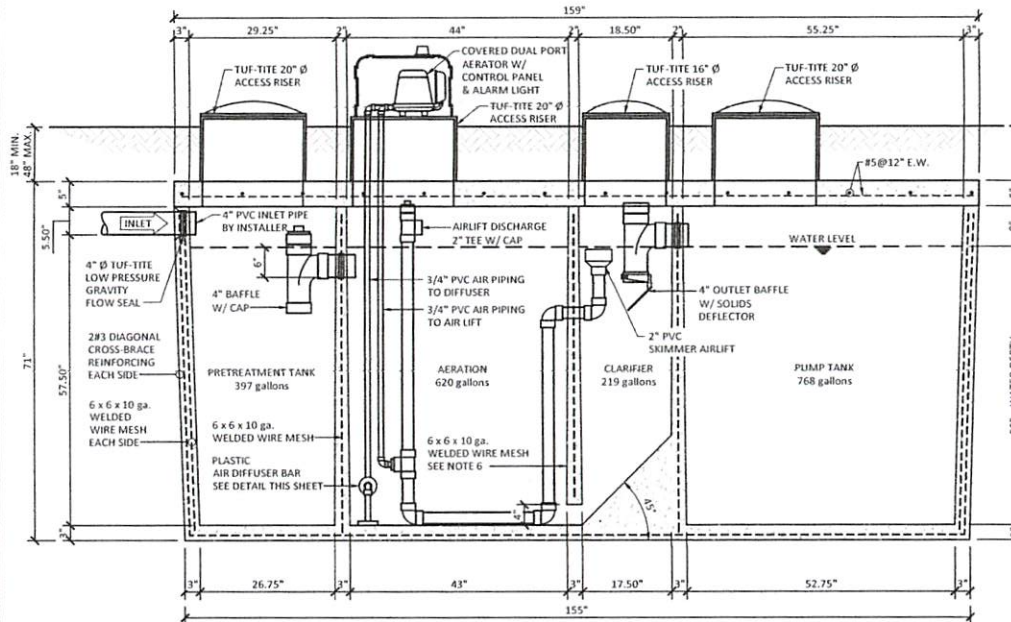

SECTION A-A

*NOTE:
2" AIRLIFT RISER TO BE STRAPPED TO WALL. SECTION
DRAWING SHOWS IT IN FRONT OF DIFFUSER FOR CLARITY

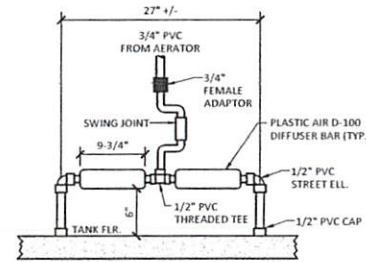

AIR DIFFUSER DETAIL

GENERAL NOTES:

1. ALL CONCRETE TO BE 4000 PSI, WITH A AGGREGATE SIZE OF 3/4".
2. ALL INSPECTION HOLES AND TOPS ARE TO BE SEALED WITH A NEOPRENE SEALER.
3. THE SUB GRADE IS TO BE WITHIN 1/2" AND FREE OF FOREIGN OBJECTS.
4. PRETREATMENT TANK & CLARIFIER RISERS MAY BE BELOW GRADE.
5. TANK LID TO BE SEALED WITH ASPHALTIC SEALANT.
6. A 2-1/2" THICK WALL MAY BE USED IN LIEU OF THE CAST IN PLACE INTERNAL WALL BETWEEN THE AERATION & CLARIFIER.
7. THE MANUFACTURER IS REQUIRED TO DEMONSTRATE THAT FAILURE WILL NOT OCCUR BY PHYSICALLY APPLYING LOADS TO THE TANK. THE LOAD APPLIED SHALL BE 1.5 TIMES THE DESIGN DEAD LOAD. SUCH TESTING SHALL BE WITNESSED & CERTIFIED BY A REGISTERED PROFESSIONAL ENGINEER.

TANK DIMENSIONS		
TANK LENGTH (TOP)	159.00	in.
TANK LENGTH (BOTTOM)	155.00	in.
TANK WIDTH (TOP)	68.00	in.
TANK WIDTH (BOTTOM)	64.00	in.
TANK HEIGHT	71.00	in.
WALL THICKNESS	3.00	in.
FLOOR THICKNESS	3.00	in.
LID THICKNESS	5.00	in.
BOTTOM TO INLET	60.50	in.

TANK VOLUMES		
PRETREATMENT CAPACITY	397	gal.
AERATION CAPACITY	620	gal.
CLARIFIER CAPACITY	219	gal.
PUMP TANK CAPACITY	768	gal.
WATER DEPTH	55	in.
TANK CONCRETE VOLUME	86.11	FT ³
TANK LID CONCRETE VOLUME	27.97	FT ³
TANK WEIGHT (EMPTY)	12917	lbs.
LID WEIGHT	4196	lbs.
TOTAL TANK WEIGHT (EMPTY)	17112	lbs.

TANK BUOYANCY CALCULATIONS				
TANK DIMENSIONS:				
Length =	159.0	inches =	13.3	FT
Width =	68	inches =	5.7	FT
Height =	71	inches =	5.9	FT
Tank Displacement Volume =			444.2	Cu Ft
Uplift Force @ 62.4 lb/cu ft =			27720.5	Lbs
RESISTING FORCES				
Concrete Tank Deadweight (Empty) =			17112	Lbs
Weight of Insulated Equipment & Hatches =			150	Lbs
Total Tank Weight =			17262	Lbs
WEIGHT OF SOIL OVER TANK				
Length =		13.3	FT	
Width =		5.7	FT	
X-Section Area =		75.1	Sq Ft	
LESS ACCESS HATCH AREAS				
1	36	inches =	-1.05	Sq Ft
3	20	inches =	-3.93	Sq Ft
Net Area for Soil Cover =			70.3091	Sq Ft
Height of Soil Cover =			18.0	inches
Soil Cover Volume =			105.2	Cu Ft
Compacted Weight of Soil Cover =			100.00	Lbs/Cu Ft
Weight of Soil Cover =			10516.37	Lbs
Total Downward Force =			27778.37	Lbs
Net Uplift Force =			-57.61	Lbs
Since uplift force is negative, tank will not float when empty with indicated cover.				
Soil skin friction has been neglected.				
Actual resistance to flotation is greater.				

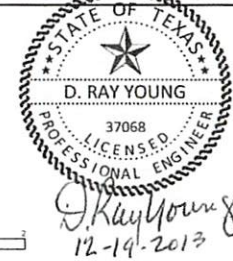

WATER ENGINEERS, INC.
 Water & Wastewater Treatment Consultants
 TEXAS BOARD OF PROFESSIONAL ENGINEERS FIRM No. 2066
 17230 HUMPHREY ROAD
 CYPRESS, TEXAS 77429
 TEL: 281-371-0500
 FAX: 281-371-1111

PRO FLO AEROBIC SYSTEMS, LP
 WASTEWATER TREATMENT SYSTEMS
 20222 FM 362
 WALLER, TEXAS 77484
AEROBIC WASTEWATER TREATMENT UNIT
 FOR USE IN HARRIS COUNTY, TEXAS

MODEL No.:
 5060 HCSP
 DRAWN BY: JLY
 DATE: 12/1/2013
 JOB No.: 4604.12
 SHEET No.:
 04 of 04

Thermoplastic Performance

LOW ANGLE NOZZLE PERFORMANCE CHART

Nozzle	PSI	Radius	GPM
#1	30	22'	1.5
	40	24'	1.7
	50	26'	1.8
	60	28'	2.0
#3	30	29'	3.0
	40	32'	3.1
	50	35'	3.5
	60	37'	3.8
#4	30	31'	3.4
	40	34'	3.9
	50	37'	4.4
	60	38'	4.7
#6	40	38'	6.5
	50	40'	7.3
	60	42'	8.0
	70	44'	8.6

KRAIN
Pro-Plus

X

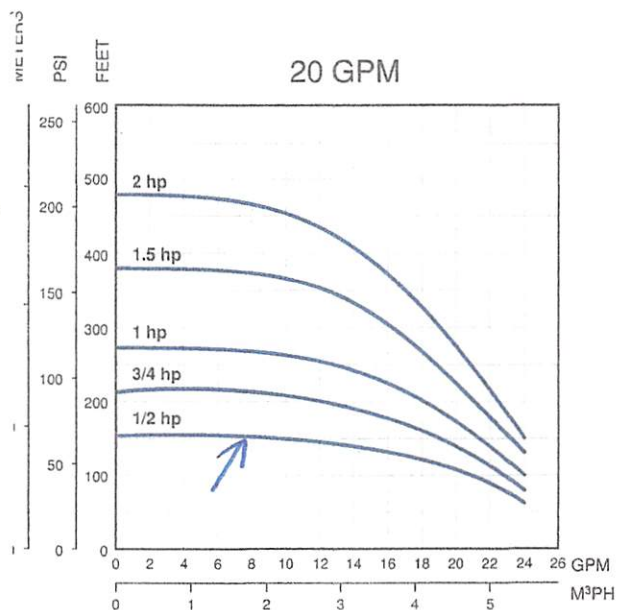

Thermoplastic Units Ordering Information

1/2 - 1.5 HP Single-Phase Units

Order No.	Model	GPM	HP	Volt	Wire	Wt.
94741005	10FE05P4-2W115	10	1/2	115	2	24
94741010	10FE05P4-2W230	10	1/2	230	2	24
94741015	10FE07P4-2W230	10	3/4	230	2	28
94741020	10FE1P4-2W230	10	1	230	2	31
94741025	10FE15P4-2W230	10	1.5	230	2	46
94742005	20FE05P4-2W115	20	1/2	115	2	25
94742010	20FE05P4-2W230	20	1/2	230	2	25
94742015	20FE07P4-2W230	20	3/4	230	2	28
94742020	20FE1P4-2W230	20	1	230	2	31
94742025	20FE15P4-2W230	20	1.5	230	2	40

Thermoplastic 1/2 - 2 HP Pump Ends

Order No.	Model	GPM	HP	Volt	Wire	Wt.
94751005	10FE05P4-PE	10	1/2	N/A	N/A	6
94751010	10FE07P4-PE	10	3/4	N/A	N/A	7
94751015	10FE1P4-PE	10	1	N/A	N/A	8
94751020	10FE15P4-PE	10	1.5	N/A	N/A	12
94752005	20FE05P4-PE	20	1/2	N/A	N/A	6
94752010	20FE07P4-PE	20	3/4	N/A	N/A	7
94752015	20FE1P4-PE	20	1	N/A	N/A	8
94752020	20FE15P4-PE	20	1.5	N/A	N/A	10
94752025	20FE2P4-PE	20	2	N/A	N/A	11

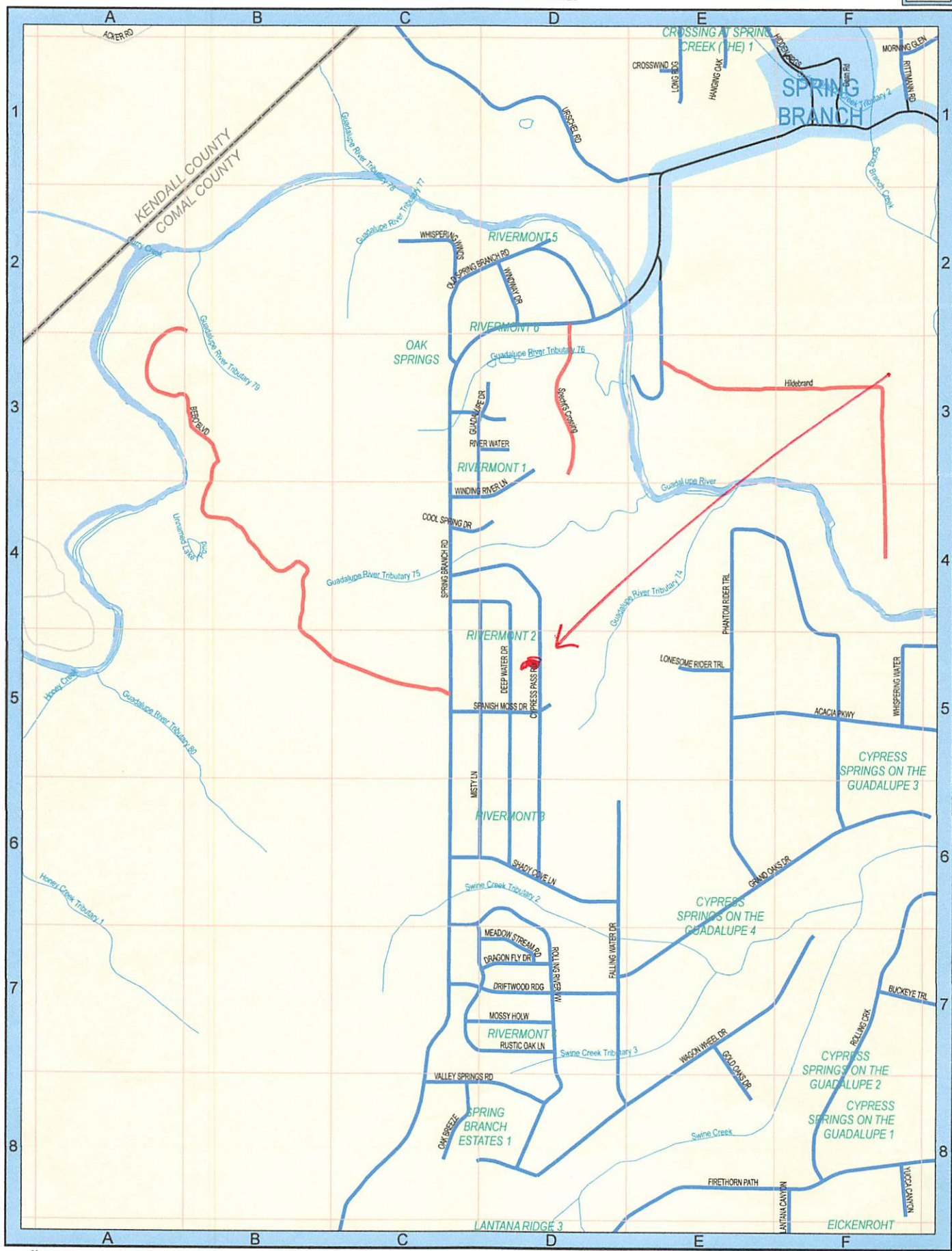

SEE PAGE 26

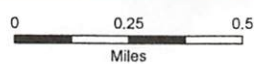
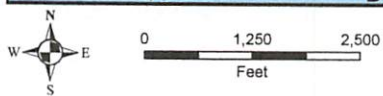

202306012922 04/28/2023 08:47:54 AM 1/2

Alamo Title GF# 4000132300100 BB; \$30

NOTICE OF CONFIDENTIALITY RIGHTS: IF YOU ARE A NATURAL PERSON, YOU MAY REMOVE OR STRIKE ANY OR ALL OF THE FOLLOWING INFORMATION FROM ANY INSTRUMENT THAT TRANSFERS AN INTEREST IN REAL PROPERTY BEFORE IT IS FILED FOR RECORD IN THE PUBLIC RECORDS: YOUR SOCIAL SECURITY NUMBER OR YOUR DRIVER'S LICENSE NUMBER.

GENERAL WARRANTY DEED

Date: April 22, 2023

Grantor: JEFFREY BERGMAN

Grantor's Mailing Address: 31 Kuikahi St Hilo, HI 96720

Grantee: CODY W. WILLEY

Grantee's Mailing Address, 1922 Brand Rd. Bulverde TX 78163
and after Recording, Return to: _____

Consideration: Cash and other good and valuable consideration, the receipt and sufficiency of which are hereby acknowledged.

Property (including any improvements):

Lot 26, Block 9, Rivermont, Unit No. 2, Comal County, Texas, according to the map or plat thereof recorded in Volume 5, Pages 21-24, Map and Plat Records, Comal County, Texas.

Reservations from Conveyance: None

Exceptions to Conveyance and Warranty: Validly existing easements, rights-of-way, and prescriptive rights, whether of record or not; all presently recorded and validly existing instruments, other than conveyances of the surface fee estate, that affect the Property; and taxes for 2023, which Grantee assumes and agrees to pay, but not subsequent assessments for that and prior years due to change in land usage, ownership, or both, the payment of which Grantor assumes.

Grantor, for the Consideration and subject to the Reservations from Conveyance and the Exceptions to Conveyance and Warranty, grants, sells, and conveys to Grantee the Property, together with all and singular the rights and appurtenances thereto in any way belonging, to have and to hold it to Grantee and Grantee's heirs, successors, and assigns forever. Grantor binds Grantor and Grantor's heirs and successors to warrant and forever defend all and singular the Property to Grantee and Grantee's heirs, successors, and assigns against every person whomsoever lawfully claiming or to claim the same or any part thereof, except as to the Reservations from Conveyance and the Exceptions to Conveyance and Warranty.

The Contract between Grantor as the Seller and Grantee as the Buyer, if any, may contain limitations as to warranty or other agreed matters; to the extent that such Contract provides for limitations or other agreed matters that will survive the closing and this conveyance, then such limitations or other agreed matters are hereby deemed incorporated by reference. The warranty of title contained in this Deed is hereby expressly excluded from the limitations or other agreed matters referenced in this paragraph.

When the context requires, singular nouns and pronouns include the plural.

Jeffrey Bergman



JEFFREY BERGMAN

STATE OF Texas)

COUNTY OF Bexar)

This instrument was acknowledged before me on April 22, 2023 by JEFFREY BERGMAN.

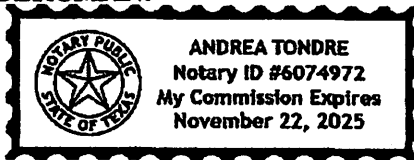

Andrea Tondre



Notary Public, State of Texas

Online Notary Public. This notarial act involved the use of online audio/video communication technology.

Filed and Recorded
Official Public Records
Bobbie Koepp, County Clerk
Comal County, Texas
04/28/2023 08:47:54 AM
TERRI 2 Pages(s)
202306012922



Bobbie Koepp



COMAL COUNTY
ENGINEER'S OFFICE

**OSSF DEVELOPMENT APPLICATION
CHECKLIST**

Staff will complete shaded items

		116857
<i>Date Received</i>	<i>Initials</i>	<i>Permit Number</i>

Instructions:

Place a check mark next to all items that apply. For items that do not apply, place "N/A". This OSSF Development Application Checklist **must** accompany the completed application.

OSSF Permit

- ☒ Completed Application for Permit for Authorization to Construct an On-Site Sewage Facility and License to Operate
- ☒ Site/Soil Evaluation Completed by a Certified Site Evaluator or a Professional Engineer
- ☒ Planning Materials of the OSSF as Required by the TCEQ Rules for OSSF Chapter 285. Planning Materials shall consist of a scaled design and all system specifications.
- ☒ Required Permit Fee - See Attached Fee Schedule
- ☒ Copy of Recorded Deed
- ☒ Surface Application/Aerobic Treatment System
 - ☒ Recorded Certification of OSSF Requiring Maintenance/Affidavit to the Public
 - ☒ Signed Maintenance Contract with Effective Date as Issuance of License to Operate

I affirm that I have provided all information required for my OSSF Development Application and that this application constitutes a completed OSSF Development Application.

Signature of Applicant

10/30/2023

Date

___ COMPLETE APPLICATION	
Check No. _____	Receipt No. _____

INCOMPLETE APPLICATION
___ (Missing Items Circled, Application Refused)