

Comal County Environmental Health OSSF Inspection Sheet

Installer Name: _____

OSSF Installer #: _____

1st Inspection Date: _____

2nd Inspection Date: _____

3rd Inspection Date: _____

Inspector Name: _____

Inspector Name: _____

Inspector Name: _____

Permit#:		Address:					
No.	Description	Answer	Citations	Notes	1st Insp.	2nd Insp.	3rd Insp.
1	SITE AND SOIL CONDITIONS & SETBACK DISTANCES Site and Soil Conditions Consistent with Submitted Planning Materials		285.31(a) 285.30(b)(1)(A)(iv) 285.30(b)(1)(A)(v) 285.30(b)(1)(A)(iii) 285.30(b)(1)(A)(ii) 285.30(b)(1)(A)(i)				
2	SITE AND SOIL CONDITIONS & SETBACK DISTANCES Setback Distances Meet Minimum Standards		285.91(10) 285.30(b)(4) 285.31(d)				
3	SEWER PIPE Proper Type Pipe from Structure to Disposal System (Cast Iron, Ductile Iron, Sch. 40, SDR 26)		285.32(a)(1)				
4	SEWER PIPE Slope from the Sewer to the Tank at least 1/8 Inch Per Foot		285.32(a)(3)				
5	SEWER PIPE Two Way Sanitary - Type Cleanout Properly Installed (Add. C/O Every 100' &/or 90 degree bends)		285.32(a)(5)				
6	PRETREATMENT Installed (if required) TCEQ Approved List PRETREATMENT Septic Tank(s) Meet Minimum Requirements		285.32(b)(1)(G) 285.32(b)(1)(E)(iii) 285.32(b)(1)(E)(iv) 285.32(b)(1)(F) 285.32(b)(1)(B) 285.32(b)(1)(C)(i) 285.32(b)(1)(C)(ii) 285.32(b)(1)(D) 285.32(b)(1)(E) 285.32(b)(1)(A) 285.32(b)(1)(E)(ii)(II) 285.32(b)(1)(E)(i) 285.32(b)(1)(E)(ii)(I)				
7	PRETREATMENT Grease Interceptors if required for commercial		285.34(d)				

Inspector Notes:

**Comal County Environmental Health
OSSF Inspection Sheet**

No.	Description	Answer	Citations	Notes	1st Insp.	2nd Insp.	3rd Insp.
8	SEPTIC TANK Tank(s) Clearly Marked SEPTIC TANK If Single Tank, 2 Compartments Provided with Baffle SEPTIC TANK Inlet Flowline Greater than 3" and " T " Provided on Inlet and Outlet SEPTIC TANK Septic Tank(s) Meet Minimum Requirements		285.32(b)(1) (E)285.91(2)285.32(b)(1) (F)285.32(b)(1)(E) (iii)285.32(b)(1)(E)(ii) (II)285.32(b)(1)(E)(ii) (I)285.32(b)(1)(E) (i)285.32(b)(1) (D)285.32(b)(1)(C) (ii)285.32(b)(1)(C) (i)285.32(b)(1) (B)285.32(b)(1) (A)285.32(b)(1)(E)(iv)				
9	ALL TANKS Installed on 4" Sand Cushion/ Proper Backfill Used		285.32(b)(1)(F) 285.32(b)(1)(G) 285.34(b)				
10	SEPTIC TANK Inspection / Clean Out Port & Risers Provided on Tanks Buried Greater than 12" Sealed and Capped		285.38(d)				
11	SEPTIC TANK Secondary restraint system provided SEPTIC TANK Riser permanently fastened to lid or cast into tank SEPTIC TANK Riser cap protected against unauthorized intrusions		285.38(d) 285.38(e)				
12	SEPTIC TANK Tank Volume Installed						
13	PUMP TANK Volume Installed						
14	AEROBIC TREATMENT UNIT Size Installed						
15	AEROBIC TREATMENT UNIT Manufacturer AEROBIC TREATMENT UNIT Model Number						
16	DISPOSAL SYSTEM Absorptive		285.33(a)(4) 285.33(a)(1) 285.33(a)(2) 285.33(a)(3)				
17	DISPOSAL SYSTEM Leaching Chamber		285.33(a)(1) 285.33(a)(3) 285.33(a)(4) 285.33(a)(2)				
18	DISPOSAL SYSTEM Evapo-transpirative		285.33(a)(3) 285.33(a)(4) 285.33(a)(1) 285.33(a)(2)				

**Comal County Environmental Health
OSSF Inspection Sheet**

No.	Description	Answer	Citations	Notes	1st Insp.	2nd Insp.	3rd Insp.
19	DISPOSAL SYSTEM Drip Irrigation		285.33(c)(3)(A)-(F)				
20	DISPOSAL SYSTEM Soil Substitution		285.33(d)(4)				
21	DISPOSAL SYSTEM Pumped Effluent		285.33(a)(4) 285.33(a)(3) 285.33(a)(1) 285.33(a)(2)				
22	DISPOSAL SYSTEM Gravelless Pipe		285.33(a)(3) 285.33(a)(2) 285.33(a)(4) 285.33(a)(1)				
23	DISPOSAL SYSTEM Mound		285.33(a)(3) 285.33(a)(1) 285.33(a)(2) 285.33(a)(4)				
24	DISPOSAL SYSTEM Other (describe) (Approved Design)		285.33(d)(6) 285.33(c)(4)				
25	DRAINFIELD Absorptive Drainline 3" PVC or 4" PVC						
26	DRAINFIELD Area Installed						
27	DRAINFIELD Level to within 1 inch per 25 feet and within 3 inches over entire excavation		285.33(b)(1)(A)(v)				
28	DRAINFIELD Excavation Width DRAINFIELD Excavation Depth DRAINFIELD Excavation Separation DRAINFIELD Depth of Porous Media DRAINFIELD Type of Porous Media						
29	DRAINFIELD Pipe and Gravel - Geotextile Fabric in Place		285.33(b)(1)(E)				
30	DRAINFIELD Leaching Chambers DRAINFIELD Chambers - Open End Plates w/Splash Plate, Inspection Port & Closed End Plates in Place (per manufacturers spec.)		285.33(c)(2)				
31	LOW PRESSURE DISPOSAL SYSTEM Adequate Trench Length & Width, and Adequate Separation Distance between Trenches		285.33(d)(1)(C)(i)				

**Comal County Environmental Health
OSSF Inspection Sheet**

No.	Description	Answer	Citations	Notes	1st Insp.	2nd Insp.	3rd Insp.
32	EFFLUENT DISPOSAL SYSTEM Utilized Only by Single Family Dwelling EFFLUENT DISPOSAL SYSTEM Topographic Slopes < 2.0% EFFLUENT DISPOSAL SYSTEM Adequate Length of Drain Field (1000 Linear ft. for 2 bedrooms or Less & an additional 400 ft. for each additional bedroom) EFFLUENT DISPOSAL SYSTEM Lateral Depth of 18 inches to 3 ft. & Vertical Separation of 1ft on bottom and 2 ft. to restrictive horizon and ground water respectfully EFFLUENT DISPOSAL SYSTEM Lateral Drain Pipe (1.25 - 1.5" dia.) & Pipe Holes (3/16 - 1/4" dia. Hole Size) 5 ft. Apart		285.33(b)(3)(A) 285.33(b)(3)(A) 285.33(b)(3) (B)285.91(13) 285.33(b)(3)(D) 285.33(b)(3)(F)				
33	AEROBIC TREATMENT UNIT Is Aerobic Unit Installed According to Approved Guidelines.		285.32(c)(1)				
34	AEROBIC TREATMENT UNIT Inspection/Clean Out Port & Risers Provided AEROBIC TREATMENT UNIT Secondary restraint system provided AEROBIC TREATMENT UNIT Riser permanently fastened to lid or cast into tank AEROBIC TREATMENT UNIT Riser cap protected against unauthorized intrusions						
35	AEROBIC TREATMENT UNIT Chlorinator Properly Installed with Chlorine Tablets in Place.						
36	PUMP TANK Is the Pump Tank an approved concrete tank or other acceptable materials & construction PUMP TANK Sampling Port Provided in the Treated Effluent Line PUMP TANK Check Valve and/or Anti- Siphon Device Present When Required PUMP TANK Audible and Visual High Water Alarm Installed on Separate Circuit From Pump						
37	PUMP TANK Inspection/Clean Out Port & Risers Provided PUMP TANK Secondary restraint system provided PUMP TANK Riser permanently fastened to lid or cast into tank PUMP TANK Riser cap protected against unauthorized intrusions						
38	PUMP TANK Secondary restraint system provided						
39	PUMP TANK Electrical Connections in Approved Junction Boxes / Wiring Buried						

**Comal County Environmental Health
OSSF Inspection Sheet**

No.	Description	Answer	Citations	Notes	1st Insp.	2nd Insp.	3rd Insp.
40	APPLICATION AREA Distribution Pipe, Fitting, Sprinkler Heads & Valve Covers Color Coded Purple?		285.33(d)(2)(G)(iii)(II) 285.33(d)(2)(G)(iii)(III) 285.33(d)(2)(G)(v) 285.33(d)(2)(G)(iii) 285.33(d)(2)(G)(iv) 285.33(d)(2)(G)(i) 285.33(d)(2)(G)(ii) 285.33(d)(2)(G)(iii)(I)				
41	APPLICATION AREA Low Angle Nozzles Used / Pressure is as required APPLICATION AREA Acceptable Area, nothing within 10 ft of sprinkler heads? APPLICATION AREA The Landscape Plan is as Designed		285.33(d)(2)(G) (i)285.33(d)(2) (A)285.33(d)(2)(F)				
42	APPLICATION AREA Area Installed						
43	PUMP TANK Meets Minimum Reserve Capacity Requirements						
44	PUMP TANK Material Type & Manufacturer						
45	PUMP TANK Type/Size of Pump Installed						



COMAL COUNTY

ENGINEER'S OFFICE

Permit of Authorization to Construct an On-Site Sewage Facility Permit Valid For One Year From Date Issued

Permit Number: 117333
Issued This Date: 04/17/2024
This permit is hereby given to: Tony and Ronda Schwartz

To start construction of a private, on-site sewage facility located at:

2056 DRY CRK
CANYON LAKE, TX 78133

Subdivision: Canyon Lake Shores
Unit: 5
Lot: 617
Block: -
Acreage: 0.1100

APPROVED MINIMUM SIZES AS PER ATTACHED DESIGN

Type of System: Aerobic
Drip Irrigation

This permit gives permission for the construction of the above referenced on-site facility to commence. Installation must be completed by an installer holding a valid registration card from the Texas Commission on Environmental Quality (TCEQ). Installation and inspection must comply with current TCEQ and Comal County requirements.

Call (830) 608-2090 to schedule inspections.

Preliminary Field Check For Drip Systems



ON-SITE SEWAGE FACILITY APPLICATION

Date _____

Permit Number 117333

1. APPLICANT / AGENT INFORMATION

Owner Name RONDA SCHWARTZ & TONY SCHWARTZ

Agent Name Doug Dowlearn R.S.

Mailing Address PO BOX 625

Agent Address 703 Oak Dr.

City, State, Zip Bandera, TX 78003

City, State, Zip Blanco, TX 78606

Phone # _____

Phone # 210-878-8100

Email rondaleschwartz@gmail.com

Email TXSEPTIC@GMAIL.COM

2. LOCATION

Subdivision Name Canyon Lake Shores Unit 5 Lot 617 Block _____

Survey Name / Abstract Number _____ Acreage .1148

Address 2056 Dry Crk City Canyon Lake State TX Zip 78133

3. TYPE OF DEVELOPMENT

Single Family Residential

Type of Construction (House, Mobile, RV, Etc.) RV

Number of Bedrooms _____

Indicate Sq Ft of Living Area _____

Non-Single Family Residential

(Planning materials must show adequate land area for doubling the required land needed for treatment units and disposal area)

Type of Facility _____

Offices, Factories, Churches, Schools, Parks, Etc. - Indicate Number Of Occupants _____

Restaurants, Lounges, Theaters - Indicate Number of Seats _____

Hotel, Motel, Hospital, Nursing Home - Indicate Number of Beds _____

Travel Trailer/RV Parks - Indicate Number of Spaces _____

Miscellaneous _____

Estimated Cost of Construction: \$ 50,000 (Structure Only)

Is any portion of the proposed OSSF located in the United States Army Corps of Engineers (USACE) flowage easement?

Yes No (If yes, owner must provide approval from USACE for proposed OSSF improvements within the USACE flowage easement)

Source of Water Public Private Well Rainwater

4. SIGNATURE OF OWNER

By signing this application, I certify that:

- The completed application and all additional information submitted does not contain any false information and does not conceal any material facts. I certify that I am the property owner or I possess the appropriate land rights necessary to make the permitted improvements on said property.
- Authorization is hereby given to the permitting authority and designated agents to enter upon the above described property for the purpose of site/soil evaluation and inspection of private sewage facilities..
- I understand that a permit of authorization to construct will not be issued until the Floodplain Administrator has performed the reviews required by the Comal County Flood Damage Prevention Order.
- I affirmatively consent to the online posting/public release of my e-mail address associated with this permit application, as applicable.

[Signature]
Signature of Owner

3-8-24
Date

[Signature] 3-8-24

***** COMAL COUNTY OFFICE OF ENVIRONMENTAL HEALTH *****
APPLICATION FOR PERMIT FOR AUTHORIZATION TO CONSTRUCT AN
ON-SITE SEWAGE FACILITY AND LICENSE TO OPERATE

Planning Materials & Site Evaluation as Required Completed By _____

System Description _____

Size of Septic System Required Based on Planning Materials & Soil Evaluation

Tank Size(s) (Gallons) _____ Absorption/Application Area (Sq Ft) _____

Gallons Per Day (As Per TCEQ Table III) _____

(Sites generating more than 5000 gallons per day are required to obtain a permit through TCEQ.)

Is the property located over the Edwards Recharge Zone? Yes No

(If yes, the planning materials must be completed by a Registered Sanitarian (R.S.) or Professional Engineer (P.E.))

Is there an existing TCEQ approved WPAP for the property? Yes No

(If yes, the R.S. or P.E. shall certify that the OSSF design complies with all provisions of the existing WPAP.)

If there is no existing WPAP, does the proposed development activity require a TCEQ approved WPAP? Yes No

(If yes, the R.S. or P.E. shall certify that the OSSF design will comply with all provisions of the proposed WPAP. A Permit to Construct will not be issued for the proposed OSSF until the proposed WPAP has been approved by the appropriate regional office.)

Is the property located over the Edwards Contributing Zone? Yes No

Is there an existing TCEQ approval CZP for the property? Yes No

(If yes, the P.E. or R.S. shall certify that the OSSF design complies with all provisions of the existing CZP.)

If there is no existing CZP, does the proposed development activity require a TCEQ approved CZP? Yes No

(If yes, the R.S. or P.E. shall certify that the OSSF design will comply with all provisions of the proposed CZP. A Permit to Construct will not be issued for the proposed OSSF until the CZP has been approved by the appropriate regional office.)

Is this property within an incorporated city? Yes No

If yes, indicate the city: _____

By signing this application, I certify that:

- The information provided above is true and correct to the best of my knowledge.

- I affirmatively consent to the online posting/public release of my e-mail address associated with this permit application, as applicable.



Signature of Designer

Date

1
CS



202406007512 03/12/2024 02:12:33 PM 1/1

COUNTY OF COMAL
STATE OF TEXAS

AFFIDAVIT TO THE PUBLIC

CERTIFICATION OF OSSF REQUIRING MAINTENANCE

According to Texas Commission on Environmental Quality (TCEQ) Rules for On-Site Sewage Facilities (OSSFs), this document is filed in the Deed Records of Comal County, Texas.

The Texas Health and Safety Code, Chapter 366 authorizes the Texas Commission on Environmental Quality (TCEQ) to regulate on-site sewage facilities (OSSFs). Additionally, the Texas Water Code (TWC), § 5.012 and § 5.013, give the commission primary responsibility for implementing the laws of the State of Texas relating to water and adopting rules necessary to carry out its powers and duties under the TWC. The commission, under the authority of the TWC and the Texas Health and Safety Code, requires owners to provide notice to the public that certain types of OSSFs are located on specific pieces of property. To achieve this notice, the commission requires a recorded affidavit. Additionally, the owner must provide proof of the recording to the OSSF permitting authority. This recorded affidavit is not a representation or warranty by the commission of the suitability of this OSSF, nor does it constitute any guarantee by the commission that the appropriate OSSF was installed.

An OSSF requiring a maintenance contract, according to 30 Texas Administrative Code § 285.91 (12) will be installed on the property described as (insert legal description):

CANYON LAKE SHORES, UNIT 5, LOT 617

The property is owned by (Insert owner's full name):

RONDA SCHWARTZ AND TONY SCHWARTZ

This OSSF must be covered by a continuous maintenance contract for the first two years. After the initial two-year service policy, the owner of an aerobic treatment system for a single family residence shall either obtain a maintenance contract within 30 days or maintain the system personally.

Upon sale or transfer of the above described property, the permit for the OSSF shall be transferred to the buyer or new owner. A copy of the planning materials for OSSF may be obtained from Comal County Engineer's Office.

WITNESS BY HAND(S) ON THIS 9 DAY OF March, 2024

[Signature]
owner(s) signature(s)

[Signature]
Ronda Schwartz
(PRINTED NAME) / TITLE

SWORN TO AND SUBSCRIBED BEFORE ME ON THIS 9 DAY OF March, 2024

Notary Public, State of Texas
Notary's Printed Name: Leandra Valero
My Commission Expires: 1-27-26

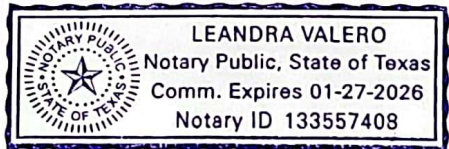

Filed and Recorded
Official Public Records
Bobbie Koepf, County Clerk
Comal County, Texas
03/12/2024 02:12:33 PM
TERRI 1 Page(s)
202406007512
Bobbie Koepf

Luna Environmental Service Agreement

(Formerly AMS & PS Septic Supply)

Agreement

I. General: This work for Hire Agreement (hereinafter referred to as "Agreement") is entered into by and between the Client and Luna Environmental, LLC (hereinafter referred to as Contractor), located at 4222 FM 482 New Braunfels, Texas 78132, (830-312-8776) or (830-850-0080). By this agreement, Contractor agrees to render services, as described herein, and Client agrees to fulfill his/her/ their responsibilities under the agreement as described herein.

II. Effective Dates: If this is an Initial Install Contract, the contract will be for three years and BEGINS when the License To Operate (LTO) has been issued. A 30-day written notice is required if there is a cancellation before the year of the agreement is up. The written notice will be sent to the local regulatory Agency and any of the agreement unused funds is non-refundable.

III. Contractor or Client, if choosing to terminate the contract, must give the other party and the local regulatory Agency written notice Thirty (30) Days prior to the ending of the Contract.

IV. Services by Contractor: Contractor will provide the following services (Referred to as the "Services").

1. In compliance with the Local Regulatory Agency and Manufacture's requirements, inspect and perform routine maintenance and upkeep on all parts within the On-Site Sewage Facility (hereafter referred to as the "OSSF") three times per year. The contractor does not provide chlorine. Client is solely responsible for maintaining the chlorine in the chlorinator at all times.
2. Contractor will provide a weatherproof tag on the control panel containing company name, phone number and inspection dates.
3. Contractor will do inspections 3 times a year, every 4 months.
4. Contractor will report all findings to the appropriate regulatory and authority and to the Client, as required by both the State's On-Site rules and the local Agency's rules. All findings must be reported to local Agency's within 14 days, email is acceptable.
5. The contractor's inspection will include the following: Effluent Quality (Color, Turbidity, overflow and Odor), Alarm Function Filters, Operation of Effluent Pump and Chlorine Availability in the

Chlorinator, (BOD and TSS Annually on Commercial Accounts, Client is responsible for charges for test)

6. Contractor will respond to client calls and complaints, regarding visual or audible alarms, suspicious conditions and or problems that might confront the Client within 48 hours, excluding weekend and holidays. The Contractor will maintain a 24-hour answering service at 830-312-8776. The unscheduled responses may be billed to the client at a going rate.

V. Clients Responsibilities:

1. Maintain Chlorinator and Proper Chlorine supply, if OSSF is equipped with.
2. Provide all necessary lawn or yard maintenance and remove all obstacles, including dogs and other animals as needed to allow the OSSF to function properly and to allow the Contractor easy and safe access to all parts of the OSSF.
3. Immediately notify the Contractor of any alarms or problems with, including failure of the OSSF.
4. Provide for pumping of the tanks, generally every 3 years or as suggested by the Contractor at Clients own expense.
5. Upon receiving a written notification of services needed from the Contractor, it becomes the Client's responsibility to contact the Contractor to authorize the service.
6. Contractor will not be responsible for any warranty work; Client must contact the Installer for Warranty Problems.
7. Not allow the backwash from water treatment of water conditioning equipment to enter the OSSF.
8. Maintain site drainage to prevent adverse effects on OSSF.
9. Promptly and fully pay Contractor's Bills, Fees or invoices as described herein.

VI. Contractor will schedule with client, dates to perform the above-described Services of repairs. If Contractor is not able to access the site on the date of appointment, a charge of \$75.00 will be billed if the inspection for repairs is not able to be completed and are required to be scheduled on another date. The contractor requires access to the OSSF electrical and physical components, including tanks, by means of man ways or risers for the purpose of evaluation of system and equipment as required by the manufacturer and /or rules. If such man ways or risers are not in place, excavation together with other labor and materials will be required and be billed to the Client an additional service at a rate of \$75.00 per hour plus materials billed at list process. Excavated soil is to be replaced as best as reasonably possible.

VII. Payments: The fee for this agreement only covers the Services described herein. This fee does not cover equipment or labor supplied for non-warranty repairs or for charges for unscheduled Client request trips to the Client's site of pumping of the OSSF. Payments not received within 30 days from the date will be subject to a \$30.00 late penalty and or a 1.5% carrying charge, whichever is greater, in addition to reasonable attorney's fees. All cost of collection incurred by contractor in collection of any unpaid debt. By signing this contract, the Client is authorizing the Contractor to remove any parts which were installed but not paid for at the end of 30 days. The Client is still responsible for any labor costs associated with the installation and removal of said parts. Invoice due when service is completed. The contract fee is \$ INCLUDED WITH SEPTIC.

VIII. Severability: If any provision of this agreement shall be considered to be invalid or unenforceable for any reason the remaining provisions shall continue to be held valid and enforceable. If a court finds that any provision of the agreement is invalid or unenforceable, by limiting such provision it would become valid and enforceable, then such provision shall be deemed to be written, construed and enforced as so limited.

Client

Print Name: Ronda Schwartz

Signature: *Ronda Schwartz*

Client Address: 2056 Dry Creek, Canyon Lake

Client Phone Number: 830-431-8005

Email Address: RondaLeeSchwartz@gmail.com

Contractor Luna Environmental LLC:

MP Signature: Ryan Seidensticker

MP NUMBER: 0001708

Contract Date: LTO to 2 YEARS FROM LTO County: _____

Permit #: _____

OSSF SOIL EVALUATION REPORT INFORMATION

Date: 3/29/2024

Applicant Information:

Name: Ronda and Tony Schwartz

Address: PO BOX 625

City, State & Zip Code: Bandera, TX 78003

Phone:

Email:

Site Evaluator Information:

Name: Douglas R. Dowlearn

Company: D.A.D. Services, Inc.

Address: 703 Oak Drive

City, State & Zip: Blanco, TX 78606

Phone: (210)240-2101 **Fax:** (866)260-7687

Email: txseptic@gmail.com

Subdivision: Canyon Lake Shores **Unit:** 5 **Lot:** 617

Street/Road Address: 2056 Dry Crk

City : Canyon Lake **Zip:** 78133

Additional Info: Comal

Installer Information:

Name:

Company:

Address:

City, State & Zip:

Phone:

Depth	Texture Class	Soil Texture	Structure (For Class III - blocky, platy or massive)	Drainage (Mottles/Water Table)	Restrictive Horizon	Observation
Soil Boring #1 60"	III	0-12" Clay Loam 12" + Limestone	Blocky	<30% gravel	12"+ Limestone	None
Soil Boring #2 60"		Same as above				

DESIGN SPECIFICATIONS

Application Rate (RA): .2

OSSF is designed for: RV Pad

114 gallons per day

An aerobic treatment/drip irrigation disposal system is to be utilized based on the site evaluation.

570 sq. ft. disposal area required

600 gallon/day aerobic tank required

Calculations: Absorption Area: $Q/RA = 114/0.2 = 570$ Sq. Ft.

FEATURES OF SITE AREA

Presence of 100-year flood zone: NO

Existing or proposed water well in nearby area: NO

Presence of adjacent ponds, streams, water impoundments: NO

Presence of upper water shed: NO

Organized sewage service available to lot: NO

I certify that the findings of this report are based on my field observations and are accurate to the best of my ability. The site evaluation and OSSF design are subject to approval by the TCEQ or the local authorized agent. The planning materials and the OSSF design should not be considered final until a permit to construct has been issued.

Site Evaluator:

NAME: Douglas Dowlearn

Signature:



License No. OS9902 Exp. 6/30/2026

TDH: #2432 Exp. 2/28/2025

D.A.D SERVICES, INC.
DOUG DOWLEARN
PO BOX 212, BULVERDE, TX 78163
Designed for:
Ronda & Tony Schwartz

The installation site is in Unit 5 Lot 617 of the Canyon Lake Shores Subdivision in Comal County, TX. The proposed OSSF will treat the wastewater from an RV (114gpd) The proposed method of wastewater treatment is aerobic treatment with drip irrigation. This method was chosen because of unsuitable soil conditions.

PROPOSED SYSTEM:

A 3" or 4" PVC pipe will discharge from the RV pad to a NuWater B-550 aerobic treatment plant, containing a 353 gallon pre-treatment tank, a 600 gpd aerobic treatment plant, and a 768 gallon pump tank equipped with a 20 gpm submersible pump. The pump is activated by a time controller allowing the distribution 5 times per day with a 10 minute run time per dose, with float switches set to pump 114 gallons per day. A high level audible and visual alarm will activate should the pump fail. Distribution from the pump is through a self flushing 100 micron, 140 mesh disc filter, then through a 1" SCH-40 manifold to a 456 L.F. drip tubing field, with drip lines set approximately two feet apart with 0.61 gph emitters set every two feet, as per the attached schematic. A threaded union will be installed in the pump tank on the supply manifold to the drip field, and a pressure regulator will be installed on the supply manifold to maintain a pressure of 30 psi. A 1" SCH-40 return line is installed to continuously flush the system back to the pump tank. Vacuum breakers installed at the highest point on each manifold will prevent siphoning of effluent from higher to lower parts of the field. The placement of the drip tubing will be on soil that has been scarified, and enough class II soil will be added so that there is 12" of soil under the drip tubing. The tubing will be covered with 6" of Class II soil.

DESIGN SPECIFICATIONS:

Daily Waste Flow: 114 gpd
Application rate: 0.2
Application area required: $114 / .2 = 570$ ft. sq.
Application area utilized: 912 sq. ft.
Pump tank reserve capacity: 38 gal minimum

SYSTEM COMPONENTS:

SCH 40 PVC sewer line
NuWater B-550
 353 gallon pre treatment tank
 600 gpd aerobic treatment plant
 768 gallon pump tank with timed controls
 C1 Series, 20Xgpm - 0.5hp/115V, Model No. 20C1X-05P4-2W115 (or equivalent)
1" purple PVC supply line
30 PSI pressure regulator - Model PMR30MF
Netafim Bioline Drip tubing

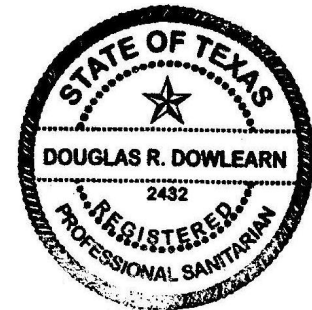

Douglas R. Dowlearn

LANDSCAPING:

The native vegetation in the distribution area should consist of low level shrubs, plains grass, bluestem or bermuda. The entire area of the drip disposal must be covered with a ground cover such as grass seed or sod prior to the final inspection.

456 L.F. OF DRIP TUBING
 SPACED 2' APART.
 8 ROWS @ 57'

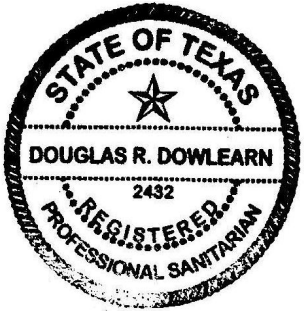

Douglas R. Dowlearn



SCALE 1" = 20'

RONDA AND TONY SCHWARTZ
 2056 DRY CREEK
 CANYON LAKE, TX 78133
 CANYON LAKE SHORES
 UNIT 5
 LOT 617

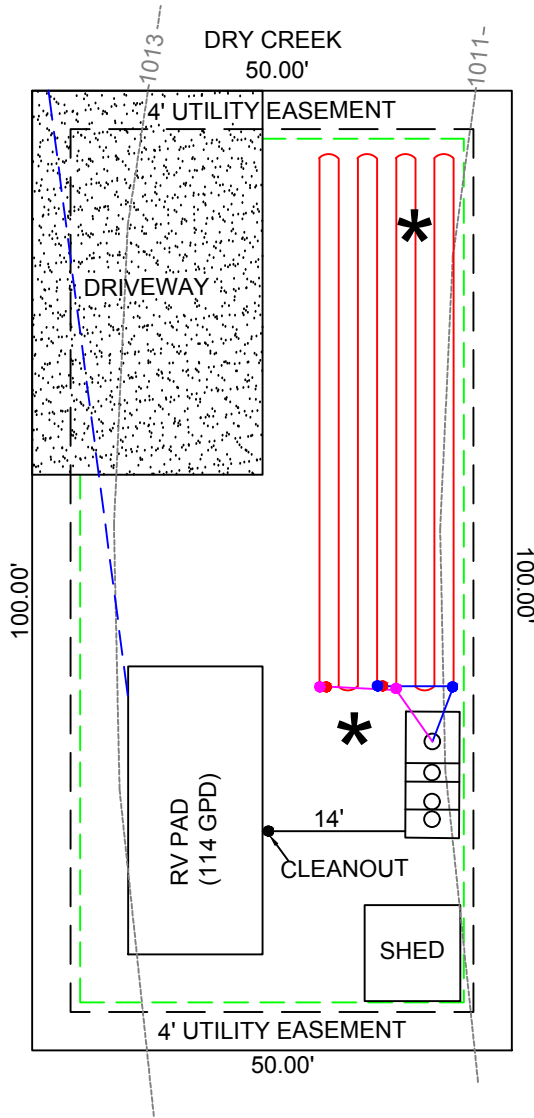

NOTES:

- USE 3" OR 4" SCH 40 SEWER PIPE TO CONNECT RV PAD TO TANK.
- CLEANOUT WITHIN 3' OF RV PAD.
- SEWER PIPE CONNECTING THE RV PAD TO THE TANK MUST HAVE AT MINIMUM 1/8" FALL PER 1'.
- INSTALL 1" VACUUM BREAKERS AT HIGHEST POINTS ON SUPPLY AND FLUSH LINES.
- TANK TO BE > 5' FROM STRUCTURES. THIS WILL PROVIDE EQUIVALENT PROTECTION FOR THE SETBACK REQUIREMENTS OF TAC 285.
- TANK WILL BE WATER TIGHT AND MANUFACTURED ACCORDING TO ASTM DESIGNATION: C 1227.
- DRAINFIELD SHALL BE GREATER THAN 100' FROM PRIVATE WELLS, AND GREATER THAN 150' FROM PUBLIC WELLS. VERIFY WELL LOCATION(S) ON SITE.
- CLEAR SURFACE ROCK AND BOULDERS FROM DRAINFIELD AREA, AND ENSURE THAT THERE IS AT MINIMUM 12" OF SUITABLE SOIL BETWEEN THE BOTTOM OF THE DRIP LINES, AND THE RESTRICTIVE HORIZON. CLASS II SOIL MAY NEED TO BE IMPORTED IN ORDER TO MAINTAIN THE MINIMUM 12" OF SOIL BETWEEN THE BOTTOM OF THE DRIP LINES AND RESTRICTIVE HORIZON.

KEY

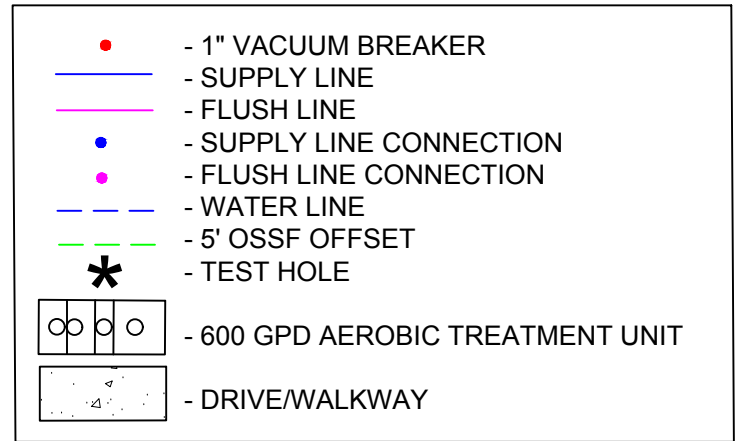

Assembly Details

OSSF

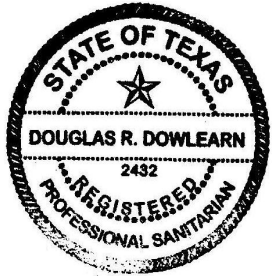

14.49 Gallons per Inch

GENERAL NOTES:

1. Plant structure material to be precast concrete and steel.
2. Maximum burial depth is 30" from slab top to grade.
3. Weight = 14,900 lbs.
4. Treatment capacity is 600 GPD. Pump compartment set-up for a 360 GPD Flow Rate (4 bedroom, < 4,000 sq/ft living area). Please specify for additional set-up requirements. BOD Loading = 1.62 lbs. per day.
5. Standard tablet chlorinator or Optional Liquid chlorinator. NSF approved chlorinators (tablet & liquid) available.
6. Bio-Robix B-550 Control Center w/ Timer for night spray application. Optional Micro Dose (min/sec) timer available for drip applications. Electrical Requirement to be 115 Volts, 60 Hz, Single Phase, 30 AMP, Grounded Receptacle.
7. 20" Ø access riser w/ lid (Typical 4). Optional extension risers available.
8. 20 GPM 1/2 HP, high head effluent pump.
9. HIBLOW Air Compressor w/ concrete housing.
10. 1/2" Sch. 40 PVC Air Line (Max. 50 Lft from Plant).
11. 1" Sch. 40 PVC pipe to distribution system provided by contractor.
12. 4" min. compacted sand or gravel pad by Contractor

**40"-53" - Reserve - 188 Gallons
 17"-40" - Working Level - 334 Gallons
 14"-17" - On/Off Tether - 43 Gallons
 0-14" - Sump - 203 Gallons**

DIMENSIONS:

Outside Height: 67"
 Outside Width: 63"
 Outside Length: 164"

MINIMUM EXCAVATION DIMENSIONS:

Width: 76"
 Length: 176"

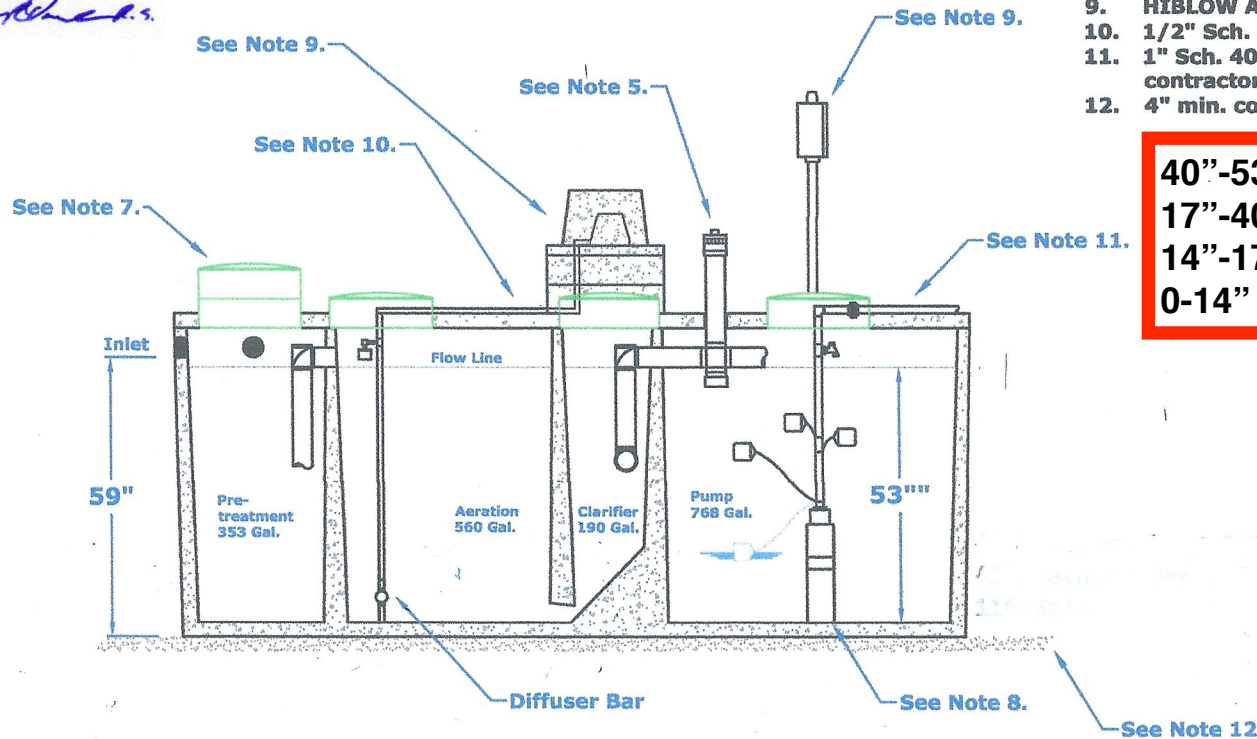

**NuWater B-550 (600 GPD)
 Aerobic Treatment Plant (Assembled)**

Model: B-550-PC-400PT

March, 2012 - Rev 1
 By: A.S.

Scale:
 * All Dimensions subject to allowable specification tolerances.

Dwg. #: ADV-B550-3

Advantage
 Wastewater Solutions llc.

Advantage Wastewater Solutions llc.
 444 A Old Hwy No 9
 Comfort, TX 78013
 830-995-3189
 fax 830-995-4051

Providence Title
166000018-Am

202406006767 03/06/2024 08:25:03 AM 1/3

GENERAL WARRANTY DEED

PROVIDENCE TITLE COMPANY
GF NO. 166000018

NOTICE OF CONFIDENTIALITY RIGHTS: IF YOU ARE A NATURAL PERSON, YOU MAY REMOVE OR STRIKE ANY OR ALL OF THE FOLLOWING INFORMATION FROM ANY INSTRUMENT THAT TRANSFERS AN INTEREST IN REAL PROPERTY BEFORE IT IS FILED FOR RECORD IN THE PUBLIC RECORDS: YOUR SOCIAL SECURITY NUMBER OR YOUR DRIVER'S LICENSE NUMBER.

Date: February 28, 2024

Grantor: Sirous Monjezi, A married Person

Grantor's Address (including County):

2036 Dry Creek
Canyon Lake, TX 78133
Comal County

Grantee: Ronda Schwartz and Tony Schwartz, A Married Couple

Grantee's Address (including County):

P.O. Box 625
Bandera, TX 78003
Bandera County

Consideration: TEN AND NO/100 ~~(\$10.00)~~ DOLLARS;
and other good and valuable considerations in hand paid by the GRANTEE herein named, the receipt of which is hereby acknowledged;

Property (including any improvements):

2056 Dry Creek, Canyon Lake, TX 78133, also known as:

Lot 617, Canyon Lake Shores Unit No. 5, an addition in Comal County, Texas, according to the plat thereof recorded in Volume 1, Page 49, Map and Plat Records, Comal County, Texas.

Reservations from Conveyance:

None.

Exceptions to Conveyance and Warranty:

Liens described as part of the Consideration and any other liens described in this deed as being either assumed or subject to which title is taken; validly existing easements, rights-of-way, and prescriptive rights, whether of record or not; all presently recorded and validly existing instruments, other than conveyances of the surface fee estate, that affect the Property; and taxes for current year, which Grantee assumes and agrees to pay.

Grantor, for the Consideration and subject to the Reservations from Conveyance and the Exceptions to Conveyance and Warranty, grants, sells, and conveys to Grantee the Property, together with all and singular the rights and appurtenances thereto in any way belonging, to have and to hold it to Grantee and Grantee's heirs, successors, and assigns forever. Grantor binds Grantor and Grantor's heirs and successors to warrant and forever defend all and singular the Property to Grantee and Grantee's heirs, successors, and assigns against every person whomsoever lawfully claiming or to claim the same or any part thereof, except as to the Reservations from Conveyance and the Exceptions to Conveyance and Warranty.

Current ad valorem taxes on said property having been prorated, the payment thereof is assumed by Grantee.

When the context requires, singular nouns and pronouns include the plural.

MADE EFFECTIVE THE DATE FIRST HEREIN ABOVE SPECIFIED.

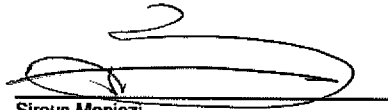

Sirous Monjezi

ACKNOWLEDGMENT

State of Texas §
County of Comal §
§

Before me, the undersigned, on this day personally appeared Sirous Monjezi known to me (or proved to me on the oath of _____ or through TX Driver's License) to be the person(s) whose name(s) is/are subscribed to the foregoing instrument and acknowledged to me that he/she/they executed the same for the purposes and consideration therein expressed.

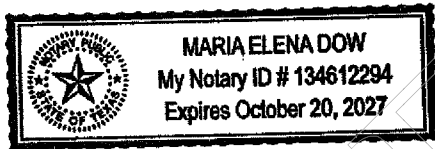
Given under my hand and seal of office this 28th day of February, 2024.

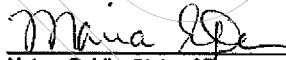

Notary Public, State of Texas
My Commission Expires:
10-20-2027

AFTER RECORDING RETURN TO:
Ronda Schwartz and Tony Schwartz
P.O. Box 625
Bandera, TX 78003

PREPARED IN THE LAW OFFICE OF:
Ramsey & Foster, PC
615 SW Johnson Avenue
Burleson, TX 76028

**Filed and Recorded
Official Public Records
Bobbie Koepf, County Clerk
Comal County, Texas
03/06/2024 08:25:03 AM
LAURA 3 Pages(s)
202406006767**





RECEIVED

By Kathy Griffin at 11:48 am, Apr 01, 2024



COMAL COUNTY
ENGINEER'S OFFICE

**OSSF DEVELOPMENT APPLICATION
CHECKLIST**

Staff will complete shaded items

		117333
Date Received	Initials	Permit Number

Instructions:

Place a check mark next to all items that apply. For items that do not apply, place "N/A". This OSSF Development Application Checklist must accompany the completed application.

OSSF Permit

- Completed Application for Permit for Authorization to Construct an On-Site Sewage Facility and License to Operate
- Site/Soil Evaluation Completed by a Certified Site Evaluator or a Professional Engineer
- Planning Materials of the OSSF as Required by the TCEQ Rules for OSSF Chapter 285. Planning Materials shall consist of a scaled design and all system specifications.
- Required Permit Fee - See Attached Fee Schedule
- Copy of Recorded Deed
- Surface Application/Aerobic Treatment System
 - Recorded Certification of OSSF Requiring Maintenance/Affidavit to the Public
 - Signed Maintenance Contract with Effective Date as Issuance of License to Operate

I affirm that I have provided all information required for my OSSF Development Application and that this application constitutes a completed OSSF Development Application.

[Signature]
Signature of Applicant

3-8-24
3-8-24 Date

<input type="checkbox"/> COMPLETE APPLICATION Check No. _____ Receipt No. _____
--

<input type="checkbox"/> INCOMPLETE APPLICATION (Missing Items Circled, Application Refused)
