



COMAL COUNTY

ENGINEER'S OFFICE

License to Operate On-Site Sewage Treatment and Disposal Facility

Issued This Date: 11/22/2024 Permit Number: 117537

Location Description: 1008 GREENBRIAR DR
CANYON LAKE, TX 78133

Subdivision: TANGLEWOOD SHORES
Unit: 0
Lot: 309
Block: 0
Acreage: 0.0000

Type of System: Aerobic
Drip Irrigation

Issued to: BAY AREA CONCRETE CONSTRUCTION, LLC

This license is authorization for the owner to operate and maintain a private facility at the location described in accordance to the rules and regulations for on-site sewerage facilities of Comal County, Texas, and the Texas Commission on Environmental Quality.

The license grants permission to operate the facility. It does not guarantee successful operation. It is the responsibility of the owner to maintain and operate the facility in a satisfactory manner.

Alterations to this permit including, but not limited to:

- Increase in the square feet of living area
- Increase in the number of bedrooms
- A change of use (i.e. residential to commercial)
- Relocation of system components (including the relocation of spray heads)
- Installation of landscaping
- Adding new structures to the system

may require a new permit. **It is the responsibility of the owner to apply for a new permit, if applicable.**

Inspection and licensing of a facility indicates only that the facility meets certain minimum requirements. It does not impede any governmental entity in taking the proper steps to prevent or control pollution, to abate nuisance, or to protect the public health.

This license to operate is valid for an indefinite period. The holder may transfer it to a succeeding owner, provided the facility has not been remodeled and is functioning properly.

Licensing Authority
Comal County Environmental Health

ENVIRONMENTAL HEALTH INSPECTOR
OS0032485

ENVIRONMENTAL HEALTH COORDINATOR
Assistant: OS0034792

Comal County Environmental Health OSSF Inspection Sheet

Installer Name: _____

OSSF Installer #: _____

1st Inspection Date: _____

2nd Inspection Date: _____

3rd Inspection Date: _____

Inspector Name: _____

Inspector Name: _____

Inspector Name: _____

Permit#:		Address:					
No.	Description	Answer	Citations	Notes	1st Insp.	2nd Insp.	3rd Insp.
1	SITE AND SOIL CONDITIONS & SETBACK DISTANCES Site and Soil Conditions Consistent with Submitted Planning Materials		285.31(a) 285.30(b)(1)(A)(iv) 285.30(b)(1)(A)(v) 285.30(b)(1)(A)(iii) 285.30(b)(1)(A)(ii) 285.30(b)(1)(A)(i)				
2	SITE AND SOIL CONDITIONS & SETBACK DISTANCES Setback Distances Meet Minimum Standards		285.91(10) 285.30(b)(4) 285.31(d)				
3	SEWER PIPE Proper Type Pipe from Structure to Disposal System (Cast Iron, Ductile Iron, Sch. 40, SDR 26)		285.32(a)(1)				
4	SEWER PIPE Slope from the Sewer to the Tank at least 1/8 Inch Per Foot		285.32(a)(3)				
5	SEWER PIPE Two Way Sanitary - Type Cleanout Properly Installed (Add. C/O Every 100' &/or 90 degree bends)		285.32(a)(5)				
6	PRETREATMENT Installed (if required) TCEQ Approved List PRETREATMENT Septic Tank(s) Meet Minimum Requirements		285.32(b)(1)(G) 285.32(b)(1)(E)(iii) 285.32(b)(1)(E)(iv) 285.32(b)(1)(F) 285.32(b)(1)(B) 285.32(b)(1)(C)(i) 285.32(b)(1)(C)(ii) 285.32(b)(1)(D) 285.32(b)(1)(E) 285.32(b)(1)(A) 285.32(b)(1)(E)(ii)(II) 285.32(b)(1)(E)(i) 285.32(b)(1)(E)(ii)(I)				
7	PRETREATMENT Grease Interceptors if required for commercial		285.34(d)				

Inspector Notes:

**Comal County Environmental Health
OSSF Inspection Sheet**

No.	Description	Answer	Citations	Notes	1st Insp.	2nd Insp.	3rd Insp.
8	SEPTIC TANK Tank(s) Clearly Marked SEPTIC TANK If Single Tank, 2 Compartments Provided with Baffle SEPTIC TANK Inlet Flowline Greater than 3" and " T " Provided on Inlet and Outlet SEPTIC TANK Septic Tank(s) Meet Minimum Requirements		285.32(b)(1) (E)285.91(2)285.32(b)(1) (F)285.32(b)(1)(E) (iii)285.32(b)(1)(E)(ii) (II)285.32(b)(1)(E)(ii) (I)285.32(b)(1)(E) (i)285.32(b)(1) (D)285.32(b)(1)(C) (ii)285.32(b)(1)(C) (i)285.32(b)(1) (B)285.32(b)(1) (A)285.32(b)(1)(E)(iv)				
9	ALL TANKS Installed on 4" Sand Cushion/ Proper Backfill Used		285.32(b)(1)(F) 285.32(b)(1)(G) 285.34(b)				
10	SEPTIC TANK Inspection / Clean Out Port & Risers Provided on Tanks Buried Greater than 12" Sealed and Capped		285.38(d)				
11	SEPTIC TANK Secondary restraint system provided SEPTIC TANK Riser permanently fastened to lid or cast into tank SEPTIC TANK Riser cap protected against unauthorized intrusions		285.38(d) 285.38(e)				
12	SEPTIC TANK Tank Volume Installed						
13	PUMP TANK Volume Installed						
14	AEROBIC TREATMENT UNIT Size Installed						
15	AEROBIC TREATMENT UNIT Manufacturer AEROBIC TREATMENT UNIT Model Number						
16	DISPOSAL SYSTEM Absorptive		285.33(a)(4) 285.33(a)(1) 285.33(a)(2) 285.33(a)(3)				
17	DISPOSAL SYSTEM Leaching Chamber		285.33(a)(1) 285.33(a)(3) 285.33(a)(4) 285.33(a)(2)				
18	DISPOSAL SYSTEM Evapo-transpirative		285.33(a)(3) 285.33(a)(4) 285.33(a)(1) 285.33(a)(2)				

**Comal County Environmental Health
OSSF Inspection Sheet**

No.	Description	Answer	Citations	Notes	1st Insp.	2nd Insp.	3rd Insp.
19	DISPOSAL SYSTEM Drip Irrigation		285.33(c)(3)(A)-(F)				
20	DISPOSAL SYSTEM Soil Substitution		285.33(d)(4)				
21	DISPOSAL SYSTEM Pumped Effluent		285.33(a)(4) 285.33(a)(3) 285.33(a)(1) 285.33(a)(2)				
22	DISPOSAL SYSTEM Gravelless Pipe		285.33(a)(3) 285.33(a)(2) 285.33(a)(4) 285.33(a)(1)				
23	DISPOSAL SYSTEM Mound		285.33(a)(3) 285.33(a)(1) 285.33(a)(2) 285.33(a)(4)				
24	DISPOSAL SYSTEM Other (describe) (Approved Design)		285.33(d)(6) 285.33(c)(4)				
25	DRAINFIELD Absorptive Drainline 3" PVC or 4" PVC						
26	DRAINFIELD Area Installed						
27	DRAINFIELD Level to within 1 inch per 25 feet and within 3 inches over entire excavation		285.33(b)(1)(A)(v)				
28	DRAINFIELD Excavation Width DRAINFIELD Excavation Depth DRAINFIELD Excavation Separation DRAINFIELD Depth of Porous Media DRAINFIELD Type of Porous Media						
29	DRAINFIELD Pipe and Gravel - Geotextile Fabric in Place		285.33(b)(1)(E)				
30	DRAINFIELD Leaching Chambers DRAINFIELD Chambers - Open End Plates w/Splash Plate, Inspection Port & Closed End Plates in Place (per manufacturers spec.)		285.33(c)(2)				
31	LOW PRESSURE DISPOSAL SYSTEM Adequate Trench Length & Width, and Adequate Separation Distance between Trenches		285.33(d)(1)(C)(i)				

**Comal County Environmental Health
OSSF Inspection Sheet**

No.	Description	Answer	Citations	Notes	1st Insp.	2nd Insp.	3rd Insp.
32	EFFLUENT DISPOSAL SYSTEM Utilized Only by Single Family Dwelling EFFLUENT DISPOSAL SYSTEM Topographic Slopes < 2.0% EFFLUENT DISPOSAL SYSTEM Adequate Length of Drain Field (1000 Linear ft. for 2 bedrooms or Less & an additional 400 ft. for each additional bedroom) EFFLUENT DISPOSAL SYSTEM Lateral Depth of 18 inches to 3 ft. & Vertical Separation of 1ft on bottom and 2 ft. to restrictive horizon and ground water respectfully EFFLUENT DISPOSAL SYSTEM Lateral Drain Pipe (1.25 - 1.5" dia.) & Pipe Holes (3/16 - 1/4" dia. Hole Size) 5 ft. Apart		285.33(b)(3)(A) 285.33(b)(3)(A) 285.33(b)(3) (B)285.91(13) 285.33(b)(3)(D) 285.33(b)(3)(F)				
33	AEROBIC TREATMENT UNIT Is Aerobic Unit Installed According to Approved Guidelines.		285.32(c)(1)				
34	AEROBIC TREATMENT UNIT Inspection/Clean Out Port & Risers Provided AEROBIC TREATMENT UNIT Secondary restraint system provided AEROBIC TREATMENT UNIT Riser permanently fastened to lid or cast into tank AEROBIC TREATMENT UNIT Riser cap protected against unauthorized intrusions						
35	AEROBIC TREATMENT UNIT Chlorinator Properly Installed with Chlorine Tablets in Place.						
36	PUMP TANK Is the Pump Tank an approved concrete tank or other acceptable materials & construction PUMP TANK Sampling Port Provided in the Treated Effluent Line PUMP TANK Check Valve and/or Anti- Siphon Device Present When Required PUMP TANK Audible and Visual High Water Alarm Installed on Separate Circuit From Pump						
37	PUMP TANK Inspection/Clean Out Port & Risers Provided PUMP TANK Secondary restraint system provided PUMP TANK Riser permanently fastened to lid or cast into tank PUMP TANK Riser cap protected against unauthorized intrusions						
38	PUMP TANK Secondary restraint system provided						
39	PUMP TANK Electrical Connections in Approved Junction Boxes / Wiring Buried						

**Comal County Environmental Health
OSSF Inspection Sheet**

No.	Description	Answer	Citations	Notes	1st Insp.	2nd Insp.	3rd Insp.
40	APPLICATION AREA Distribution Pipe, Fitting, Sprinkler Heads & Valve Covers Color Coded Purple?		285.33(d)(2)(G)(iii)(II) 285.33(d)(2)(G)(iii)(III) 285.33(d)(2)(G)(v) 285.33(d)(2)(G)(iii) 285.33(d)(2)(G)(iv) 285.33(d)(2)(G)(i) 285.33(d)(2)(G)(ii) 285.33(d)(2)(G)(iii)(I)				
41	APPLICATION AREA Low Angle Nozzles Used / Pressure is as required APPLICATION AREA Acceptable Area, nothing within 10 ft of sprinkler heads? APPLICATION AREA The Landscape Plan is as Designed		285.33(d)(2)(G) (i)285.33(d)(2) (A)285.33(d)(2)(F)				
42	APPLICATION AREA Area Installed						
43	PUMP TANK Meets Minimum Reserve Capacity Requirements						
44	PUMP TANK Material Type & Manufacturer						
45	PUMP TANK Type/Size of Pump Installed						



COMAL COUNTY

ENGINEER'S OFFICE

Permit of Authorization to Construct an On-Site Sewage Facility Permit Valid For One Year From Date Issued

Permit Number: 117537
Issued This Date: 06/18/2024
This permit is hereby given to: BAY AREA CONCRETE CONSTRUCTION, LLC

To start construction of a private, on-site sewage facility located at:

1008 GREENBRIAR DR
CANYON LAKE, TX 78133

Subdivision: TANGLEWOOD SHORES
Unit: 0
Lot: 309
Block: 0
Acreage: 0.0000

APPROVED MINIMUM SIZES AS PER ATTACHED DESIGN

Type of System: Aerobic
Drip Irrigation

This permit gives permission for the construction of the above referenced on-site facility to commence. Installation must be completed by an installer holding a valid registration card from the Texas Commission on Environmental Quality (TCEQ). Installation and inspection must comply with current TCEQ and Comal County requirements.

Call (830) 608-2090 to schedule inspections.



COMAL COUNTY
ENGINEER'S OFFICE

ON-SITE SEWAGE FACILITY APPLICATION

195 DAVID JONAS DR
NEW BRAUNFELS, TX 78132
(830) 608-2090
WWW.CCEO.ORG

Date May 20, 2024

Permit Number 117537

1. APPLICANT / AGENT INFORMATION

Owner Name BAY AREA CONCRETE CONSTRUCTION, LLC
Mailing Address 2828 LAKESHORE DRIVE
City, State, Zip CANYON LAKE TEXAS 78133
Phone # 210-326-0661
Email mimiiian@gvtc.com

Agent Name GREG JOHNSON, P.E.
Agent Address 170 HOLLOW OAK
City, State, Zip NEW BRAUNFELS TEXAS 78132
Phone # 830-905-2778
Email gregjohnsonpe@yahoo.com

2. LOCATION

Subdivision Name TANGLEWOOD SHORES Unit Lot 309 Block
Survey Name / Abstract Number Acreage
Address 1008 GREENBRIAR DRIVE City CANYON LAKE State TX Zip 78133

3. TYPE OF DEVELOPMENT

Single Family Residential

Type of Construction (House, Mobile, RV, Etc.) HOUSE

Number of Bedrooms 3

Indicate Sq Ft of Living Area 1404

Non-Single Family Residential

(Planning materials must show adequate land area for doubling the required land needed for treatment units and disposal area)

Type of Facility

Offices, Factories, Churches, Schools, Parks, Etc. - Indicate Number Of Occupants

Restaurants, Lounges, Theaters - Indicate Number of Seats

Hotel, Motel, Hospital, Nursing Home - Indicate Number of Beds

Travel Trailer/RV Parks - Indicate Number of Spaces

Miscellaneous

Estimated Cost of Construction: \$ 280,000 (Structure Only)

Is any portion of the proposed OSSF located in the United States Army Corps of Engineers (USACE) flowage easement?

Yes No (If yes, owner must provide approval from USACE for proposed OSSF improvements within the USACE flowage easement)

Source of Water Public Private Well Rainwater Collection

4. SIGNATURE OF OWNER

By signing this application, I certify that:

- The completed application and all additional information submitted does not contain any false information and does not conceal any material facts. I certify that I am the property owner or I possess the appropriate land rights necessary to make the permitted improvements on said property.
- Authorization is hereby given to the permitting authority and designated agents to enter upon the above described property for the purpose of site/soil evaluation and inspection of private sewage facilities..
- I understand that a permit of authorization to construct will not be issued until the Floodplain Administrator has performed the reviews required by the Comal County Flood Damage Prevention Order.
- I affirmatively consent to the online posting/public release of my e-mail address associated with this permit application, as applicable.

[Signature]
Signature of Owner

5-20-24
Date



ON-SITE SEWAGE FACILITY APPLICATION

Planning Materials & Site Evaluation as Required Completed By GREG W. JOHNSON, P.E.

System Description PROPRIETARY; AEROBIC TREATMENT AND DRIP TUBING

Size of Septic System Required Based on Planning Materials & Soil Evaluation

Tank Size(s) (Gallons) SOLAR AIR SA600LP Absorption/Application Area (Sq Ft) 1992

Gallons Per Day (As Per TCEQ Table 111) 240

(Sites generating more than 5000 gallons per day are required to obtain a permit through TCEQ.)

Is the property located over the Edwards Recharge Zone? Yes No

(if yes, the planning materials must be completed by a Registered Sanitarian (R.S.) or Professional Engineer (P.E.))

Is there an existing TCEQ approved WPAP for the property? Yes No

(if yes, the R.S. or P.E. shall certify that the OSSF design complies with all provisions of the existing WPAP.)

Is there at least one acre per single family dwelling as per 285.40(c)(1)? Yes No

If there is no existing WPAP, does the proposed development activity require a TCEQ approved WPAP? Yes No

(if yes, the R.S or P.E. shall certify that the OSSF design will comply with all-provisions of the proposed WPAP. A Permit to Construct will not be issued for the proposed OSSF until the proposed WPAP has been approved by the appropriate regional office.)

Is the property located over the Edwards Contributing Zone? Yes No

Is there an existing TCEQ approval CZP for the property? Yes No

(if yes, the P.E. or R.S. shall certify that the OSSF design complies with all provisions of the existing CZP.)

If there is no existing CZP, does the proposed development activity require a TCEQ approved CZP? Yes No

(if yes, the R.S. or P.E. shall certify that the OSSF design will comply with all provisions of the proposed CZP. A Permit to Construct will not be issued for the proposed OSSF until the UP has been approved by the appropriate reg

Is this property within an incorporated city? Yes No

If yes, indicate the city:

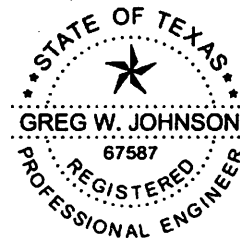

FIRM #2585

By signing this application, I certify that:

- The information provided above is true and correct to the best of my knowledge.
- I affirmatively consent to the online posting/public release of my e-mail address associated with this permit application, as applicable.

Signature of Designer

Date May 24, 2024

**REVISED**

9:25 am, Jun 18, 2024

WASTEWATER TREATMENT SYSTEM MAINTENANCE CONTRACT

Customer	Residential	Initial Contract
Bay Area Concrete Construction LLC	<input checked="" type="checkbox"/>	<input checked="" type="checkbox"/>
Site Address	Agency	
1008 Greenbriar Drive, Canyon Lake, TX 78133	Comal County	
Email	Phone	Permit Number
mimiian@gvtc.com	(210) 326-0661	
System Details		
Treatment: Aerobic Drip Emitters / System: Solar Air - National Wastewater Systems 600 Max GPD		

AGREEMENT

I. General:

This work for hire agreement (hereinafter referred to as "Agreement") is entered into by and between the Client and Luna Environmental, LLC (hereinafter referred to as "Contractor"), located at 4222 FM 482 New Braunfels, Texas 78132. By this agreement, Contractor agrees to render services, as described herein, and Client agrees to fulfill his/her/their responsibilities under the agreement as described herein.

II. Dates:

This agreement is for an initial 2-year maintenance contract and begins once the License to Operate (LTO) has been issued.

III. Services by Contractor:

1. Inspect and perform routine maintenance on the On-Site Sewage Facility ("OSSF") in compliance with code, regulations, and/or rules of the Texas Commission on Environmental Quality ("TCEQ") and county in which the OSSF is located and the manufacturer's requirements, at a frequency of approximately once every four (4) months for residential properties, or once every one (1) month for commercial properties.
2. Inspection, adjustment, and servicing of the mechanical, electrical, and other components to ensure proper functioning. This includes inspecting control panels, air pumps, air filters, diffusers, floats, and spray heads.
3. Effluent Inspection will include the following: effluent quality (color, turbidity, overflow, and odor), testing effluent chlorine and pH levels, when necessary, alarm function, filters, operation of effluent pump and chlorinator. Unless otherwise agreed to, Contractor does not provide chlorine. BOD and TSS annually on commercial accounts, additional charges apply.
4. Notify Client of any repairs needed to keep OSSF in proper working condition and up to regulatory standards. Items under warranty may be repaired while the technician is on-site. Additional charges may apply for labor and service calls. Repair quotes of non-warranty items must be approved by Client before work is performed.
5. Report to the appropriate regulatory authority and to Client, as required by the State of Texas' on-site rules and, if required, TCEQ or County rules. All findings must be reported to the appropriate regulatory authority within 14 days.
6. Visit site within 48 hours of a service request.
7. Provide Customer Support line at 855-560-9909.

REVISED
9:25 am, Jun 18, 2024

IV. Client Responsibilities:

1. Maintain Chlorinator and proper chlorine supply, unless otherwise specified.
2. Provide all necessary lawn or yard maintenance and remove all obstructions, including dogs and other animals as needed to allow the OSSF to function properly and the Contractor easy and safe access to all parts of
3. Immediately notify Contractor of any alarms or system problems.
4. Have tanks pumped out as directed by manufacturer, typically every 3 years.
5. Be available by text, phone, or in person when the Contractor is on site in case of required repair approvals or questions.
6. Maintain site drainage to prevent adverse effects on OSSF.
7. Promptly pay Contractor's bills, fees, and invoices in full.

V. Access By Contractor:

Access By Contractor: The contractor or anyone authorized by the contractor may enter the property at reasonable times without prior notice for the purpose of repairs and services described herein.

VI. Termination of This Agreement:

Either party may terminate this agreement with 30 days' written notice in the event of the other party's substantive failure to perform in accordance with this agreement without fault of the terminating party. Is this agreement is terminated, the Contractor will notify the appropriate regulatory authority.

VII. Limitation of Liability:

In no event shall the Contractor be liable for indirect, consequential, incidental, or punitive damages, whether in contract, tort, or any other theory of liability. In no event shall the Contractor's liability for the direct damages exceed payments by the Client under this agreement.

VIII. Payment Terms:

The fee for this agreement only covers the services described herein. This fee does not cover equipment or labor for non-warranty repairs, labor for warranty repairs, or service charges resulting from unscheduled, Client requested trips to the Client's OSSF. Payments not received within 30 days from the date of invoicing will be subject to a \$30.00 late penalty and or a 1.5% monthly carrying charge, whichever is greater. By signing this contract, the Client authorizes the Contractor to remove any parts which were installed but not paid for at the end of 30 days. The Client is still responsible for any labor costs associated with the installation and removal of said parts. All invoices are due upon receipt by Client.

IX. Severability:

If any provision of this agreement shall be held to be invalid or unenforceable for any reason the remaining provisions shall continue to be held valid and enforceable. If a court finds that any provision of this agreement is invalid or unenforceable, by limiting such provision it would become valid and enforceable, then such provision shall be deemed to be written, construed, and enforced as so limited.

Bay Area Concrete Construction LLC

Luna Environmental / Ryan Seidensticker

DocuSigned by: Customer Name

Maintenance Provider Name

Bay Area Concrete Construction LLC

Ryan Seidensticker

License # MP0001708

086492340EF6418...

Customer Signature

Ian Whitehead - owner

Maintenance Provider Signature

Additional Comments / Special Terms

ON-SITE SEWERAGE FACILITY SOIL EVALUATION REPORT INFORMATION

Date Soil Survey Performed: May 23, 2024

Site Location: TANGLEWOOD SHORES, LOT 309

Proposed Excavation Depth: N/A

Requirements:

At least two soil excavations must be performed on the site, at opposite ends of the proposed disposal area. Locations of soil boring or dug pits must be shown on the site drawing. For subsurface disposal, soil evaluations must be performed to a depth of at least two feet below the proposed excavation depth. For surface disposal, the surface horizon must be evaluated. Describe each soil horizon and identify any restrictive features on the form. Indicate depths where features appear.

SOIL BORING NUMBER <u> </u> SURFACE EVALUATION						
Depth (Feet)	Texture Class	Soil Texture	Gravel Analysis	Drainage (Mottles/ Water Table)	Restrictive Horizon	Observations
0	III	CLAY LOAM	N/A	NONE OBSERVED	LIMESTONE @ 2"	BROWN
2"						
1						
2						
3						
4						
5						

SOIL BORING NUMBER <u> </u> SURFACE EVALUATION						
Depth (Feet)	Texture Class	Soil Texture	Gravel Analysis	Drainage (Mottles/ Water Table)	Restrictive Horizon	Observations
0	SAME		AS		ABOVE	
1						
2						
3						
4						
5						

I certify that the findings of this report are based on my field observations and are accurate to the best of my ability.



Greg W. Johnson, P.E. 67587-F2585, S.E. 11561

05/23/24

Date

DRIP TUBING SYSTEM
DESIGNED FOR:
BAY AREA CONCRETE & CONSTRUCTION, LLC
c/o 2828 LAKESHORE DRIVE
CANYON LAKE, TEXAS 78133

SITE DESCRIPTION:

Located in Tanglewood Shores, Lot 309 at 1008 Greenbriar Drive, the proposed system will serve a , the proposed system will serve a three bedroom residence (1404sf.) situated in an area with shallow Type-III soil as described in the Soil Evaluation Report. An aerobic treatment plant utilizing drip irrigation was chosen as the most appropriate system to serve the conditions on this lot.

PROPOSED SYSTEM:

A 3-inch SCH-40 pipe discharges from the residence into a Solar SA600 LP 600gpd aerobic plant containing a 376-gallon pretreatment tank, an aerobic treatment plant, and a 778-gallon pump chamber containing a submersible well pump. The well pump is activated by a time controller allowing the distribution ten times per day with an 8 minute run time with float setting at 240 gallons. A high level audible and visual alarm will activate should the pump fail. Distribution is through a self flushing 100 micron disc filter (Arkal) then through a 1" SCH-40 manifold to a 1992sf. drip tubing field, with *Netifim Bioline* drip lines set approximately two feet apart with **0.61 gph** emitters set every two feet, as per the attached schematic. A pressure regulator PMR-MF 30psi installed in the pump tank on the manifold to the field will maintain pressure at 30 psi. A 1" SCH-40 return line is installed to periodically flush the system by cycling a 1" ball valve. Solids caught in the disc filter are flushed each cycle back to the trash tank. Vacuum breakers installed at the highest point on each manifold will prevent siphoning of effluent from higher to lower parts of the field. Field area will be scarified and built up with 10" of Type II or Type III soil, then the drip tubing will be laid and capped with 6" of Type II or Type III soil (**NOT SAND**). (**A minimum of twelve inches required between rock and drip tubing.**) The field area will be sodded with grass prior to system startup. **Risers are required on tank inspection ports as per 30 TAC 285.38 (9/1/2023). This includes access limitation (<65lbs lid or hardware secured lid), inspection and cleanout ports shall have risers over the port openings which extend to a minimum of two inches above grade. A secondary plug, cap, or other suitable restraint system shall be provided below the riser cap to prevent tank entry if the cap is unknowingly damaged or removed.**

DESIGN SPECIFICATIONS:

Daily waste flow: 240 GPD Table III

Pretreatment tank size: 376 Gal

Plant Size: Solar 600LP 600 gpd (TCEQ Approved)
Pump tank size: 778Gal
Reserve capacity after High Level: 80 Gal (>1/3 day Req'd)
Application Rate: Ra = 0.2 gal/sf
Total absorption area: Q/Ra = 240 GPD/0.20 = 1200 sf. (Actual 1992 sf.)
Total linear feet drip tubing: 996' *Netifim Bioline* drip tubing .61 GPH
Pump requirement: 498 emitters @ .61 gph @ 30 psi = 5.063 gpm
Pump Requirement (cont.): Franklin C1 20XC1-05P4-W115 submersible well pump
Dosing volume: 50-70 gal.

MINIMUM SCOUR VELOCITY (MSV) > 2 FPS
IN DRIP TUBING W/ NOM. DIA. 0.55" ID

$$\text{MSV} = 2 \text{ FPS } (\pi d^2) / 4 * 7.48 \text{ gal/cf} * 60 \text{ sec/min}$$

$$\text{MSV} = 2(3.14159((.55/12)^2)/4) * 7.48 * 60$$

$$\text{MSV} = 1.5 \text{ gpm MIN FLOW RATE} \times 3 = 4.5 \text{ gpm}$$

IN RETURN MANIFOLD W/ NOM. DIA 1.049" ID

$$\text{MSV} = 2 \text{ FPS } (\pi d^2) / 4 * 7.48 \text{ gal/cf} * 60 \text{ sec/min}$$

$$\text{MSV} = 2(3.14159((1.049/12)^2)/4) * 7.48 * 60$$

$$\text{MSV} = 5.4 \text{ GPM}$$

PIPE AND FITTINGS:

All pipes and fittings in this drip tubing system shall be 1" schedule 40 PVC. All joints shall be sealed with approved solvent-type PVC cement. Clipper type cutters are recommended to prevent PVC burrs during cutting of pipes causing possible plugging. Drip tubing 0.61 gph drip tubing to be used in field.

Designed in accordance with Chapter 285, Subchapter D, §285.30 and §285.40 Texas Commission on Environmental Quality (Effective December 29, 2016)

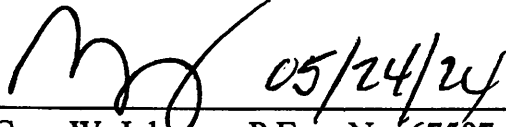

Greg W. Johnson, P.E. No. 67587 - F-2585
170 Hollow Oak
New Braunfels, Texas 78132
830/905-2778

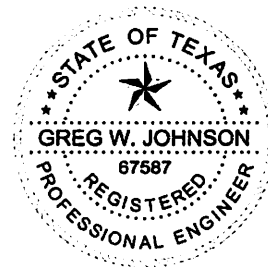

RECEIVED

By Brenda Ritzen at 1:02 pm, Nov 22, 2024

Greg W. Johnson, P.E.
170 Hollow Oak
New Braunfels, Texas 78132
830/905-2778

November 22, 2024

Comal County Office of Environmental Health
195 David Jonas Drive
New Braunfels, Texas 78132-3760

RE: Permit #117537
1008 GREENBRIAR DR
TANGLEWOOD SHORES, LOT 309
CANYON LAKE, TX 78133
BAY AREA CONCRETE CONSTRUCTION, LLC

Brenda,

Sidewalk was installed three feet from the aerobic tank after the tank was intalled. This sidewalk will not impact the structural integrity of the septic tank.

I hereby request a variance for placement of tank less than five feet from sidewalks/foundations.

This variance will not pose a threat to the public health or environment.

Respectfully yours,

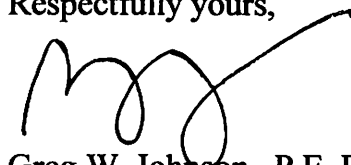

Greg W. Johnson, P.E. F#2585

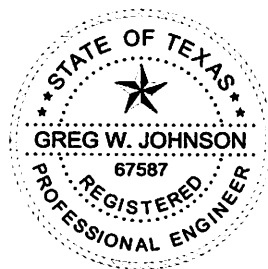

REVISED

1:02 pm, Nov 22, 2024

GREENBRIAR DRIVE

GLEN OAKS DRIVE

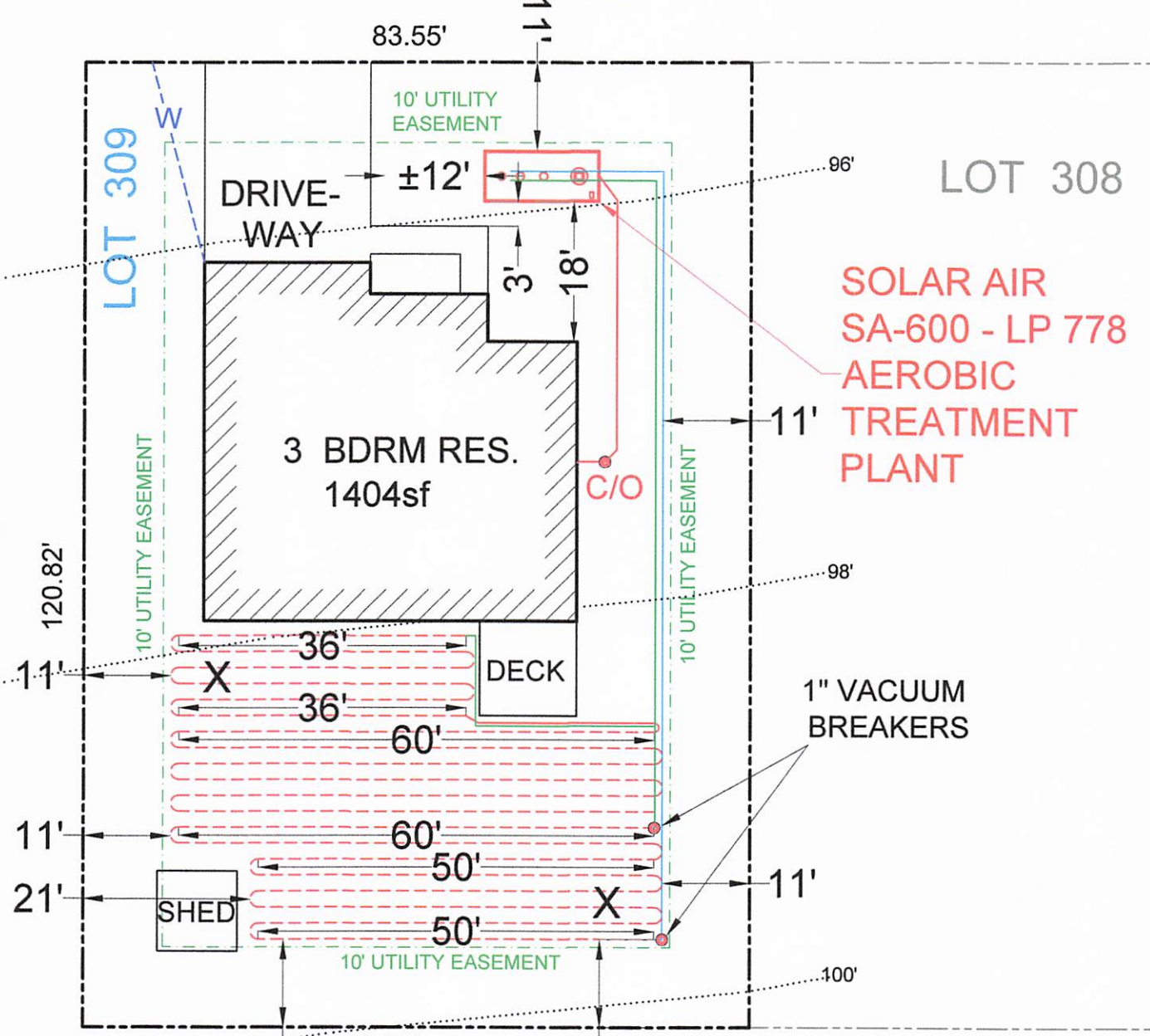

**SOLAR AIR
SA-600 - LP 778
AEROBIC
TREATMENT
PLANT**

**1" VACUUM
BREAKERS**

INSTALL 1992sf OF FIELD USING 996' OF DRIP TUBING. THERE SHALL BE NO PARKING, DRIVING OR STORAGE ON THE SEPTIC FIELD AT ANY TIME FOR ANY REASON.

*USE TWO WAY CLEAN OUT
**USE SCH-40 OR SDR-26 TO TANK

X= TEST HOLE



OWNER: BAY AREA CONCRETE CONSTRUCTION, LLC.		DRAWN BY: EJS III	
STREET ADDRESS: 1008 GREENBRIAR DRIVE			
LEGAL DESC: TANGLEWOOD SHORES	UNIT/SECTION/PHASE:	BLOCK:	LOT: 309
PREPARED BY: GREG W. JOHNSON, P.E. F#002585	SCALE: 1"=20'	DATE: 5/24/2024	2nd REVISION: 11/21/2024

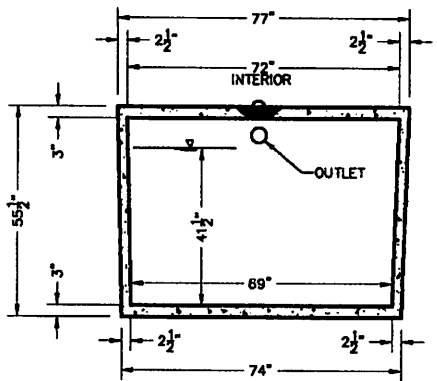

SECTION B-B

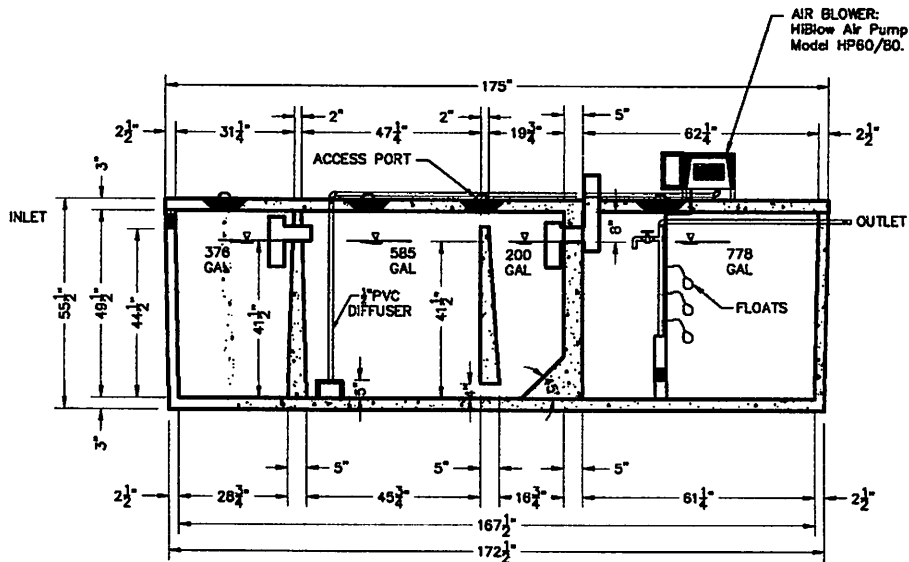

SECTION A-A

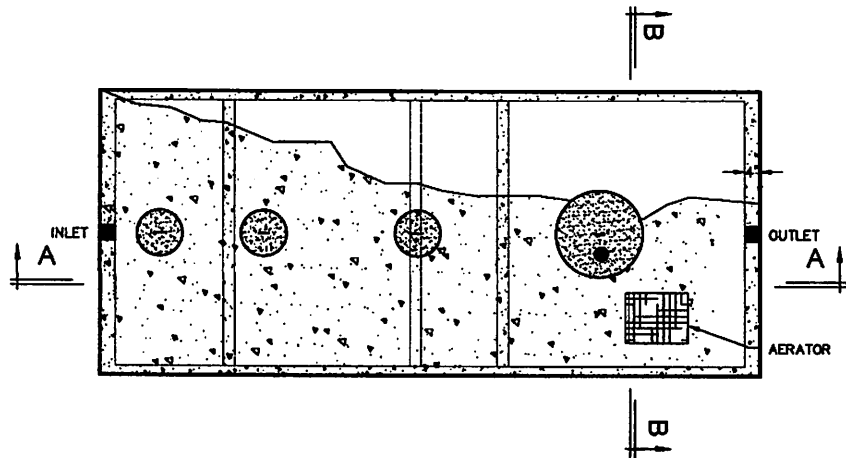

PLAN VIEW

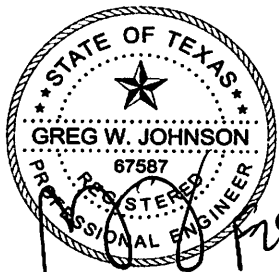

67587
05/24/24

DATE:	DEC-2016
PROJECT NO:	
SCALE:	3/8" = 1'-0"
INSET:	SA-3
REVISIONS:	
BY:	
SOLAR AEROBIC 6754 HWY 90 EAST LAKE CHARLES, LA 70815 PHONE: (337) 438-0880	
MODEL SA 600LP RESIDENTIAL WASTEWATER TREATMENT SYSTEM	
DESIGNED BY:	
DRAWN BY:	
CHECKED BY:	

TANK NOTES:

Tanks must be set to allow a minimum of 1/8" per foot fall from the residence.

Tightlines to the tank shall be SCH-40 PVC.

A two way sanitary tee is required between residence and tank.

A minimum of 4" of sand, sandy loam, clay loam free of rock shall be placed under and around tanks

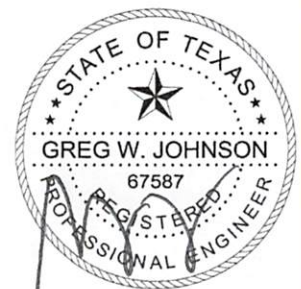
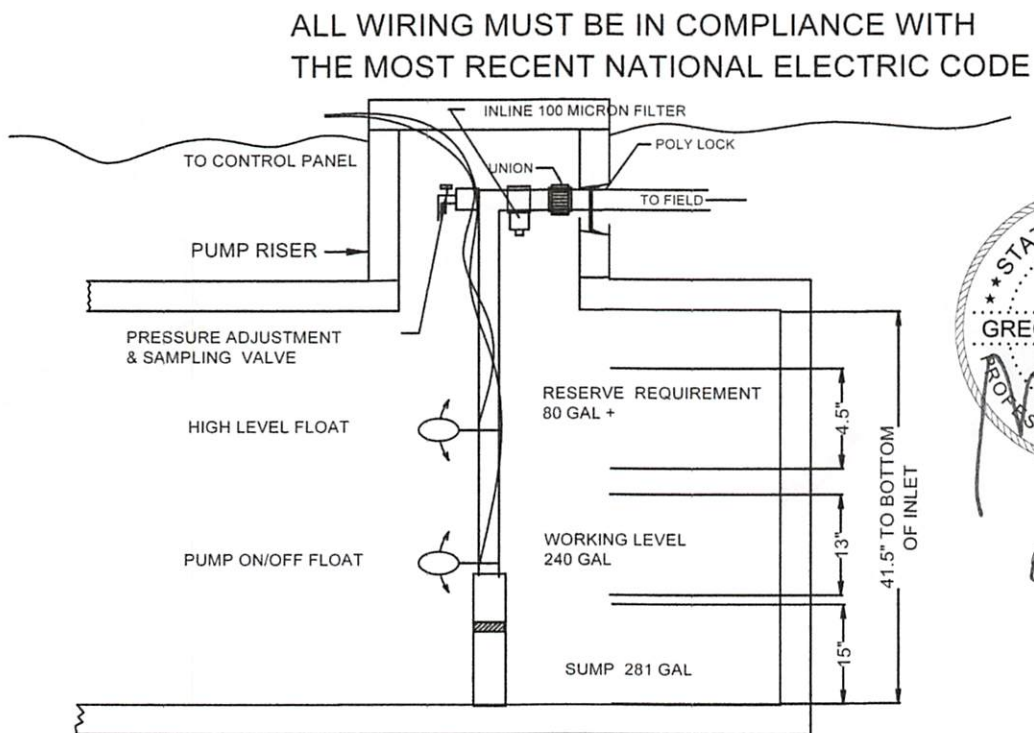

F#2585

05/24/25

TYPICAL PUMP TANK CONFIGURATION
SOLAR-AIR SA-600 LP 778 GAL PUMP TANK

Thermoplastic Performance

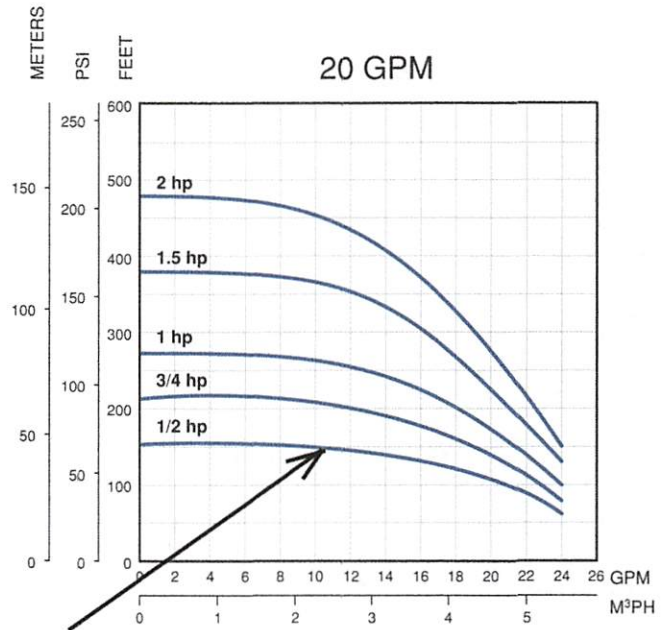
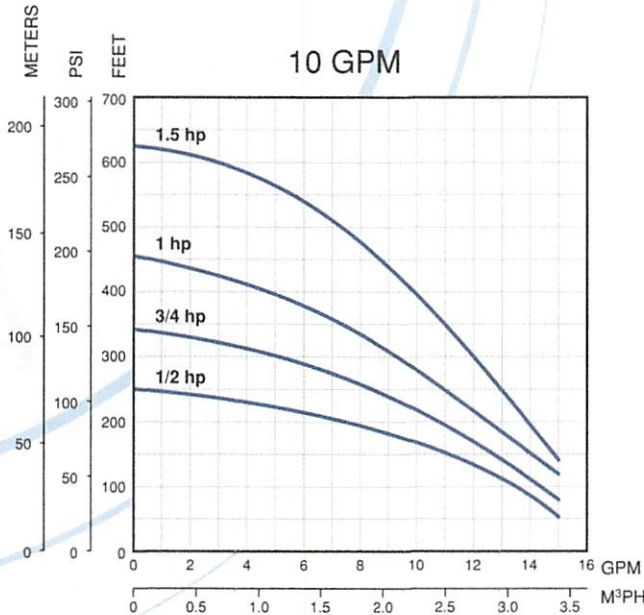

Thermoplastic Units Ordering Information

1/2 - 1.5 HP Single-Phase Units

Order No.	Model	GPM	HP	Volt	Wire	Wt.
94741005	10FE05P4-2W115	10	1/2	115	2	24
94741010	10FE05P4-2W230	10	1/2	230	2	24
94741015	10FE07P4-2W230	10	3/4	230	2	28
94741020	10FE1P4-2W230	10	1	230	2	31
94741025	10FE15P4-2W230	10	1.5	230	2	46
94742005	20FE05P4-2W115	20	1/2	115	2	25
94742010	20FE05P4-2W230	20	1/2	230	2	25
94742015	20FE07P4-2W230	20	3/4	230	2	28
94742020	20FE1P4-2W230	20	1	230	2	31
94742025	20FE15P4-2W230	20	1.5	230	2	40

Thermoplastic 1/2 - 2 HP Pump Ends

Order No.	Model	GPM	HP	Volt	Wire	Wt.
94751005	10FE05P4-PE	10	1/2	N/A	N/A	6
94751010	10FE07P4-PE	10	3/4	N/A	N/A	7
94751015	10FE1P4-PE	10	1	N/A	N/A	8
94751020	10FE15P4-PE	10	1.5	N/A	N/A	12
94752005	20FE05P4-PE	20	1/2	N/A	N/A	6
94752010	20FE07P4-PE	20	3/4	N/A	N/A	7
94752015	20FE1P4-PE	20	1	N/A	N/A	8
94752020	20FE15P4-PE	20	1.5	N/A	N/A	10
94752025	20FE2P4-PE	20	2	N/A	N/A	11

Arkal 1" Super Filter

Catalog No. 1102 0 _ _ _

Features

- ◆ A "T" shaped filter with two 1" male threads.
- ◆ A "T" volume filter for in-line installation on 1" pipelines.
- ◆ The filter prevents clogging due to its enlarged filtering area that collects sediments and particles.
- ◆ Manufactured entirely from fiber reinforced plastic.
- ◆ A cylindrical column of grooved discs constitutes the filter element.
- ◆ Spring keeps the discs compressed.
- ◆ Screw-on filter cover.
- ◆ Filter discs are available in various filtration grades.

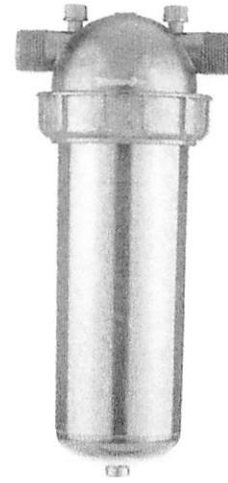

Technical Data

Inlet/outlet diameter	1" BSPT (male)	1" NPT (male)
	25.0 mm – nominal diameter	
	33.6 mm – pipe diameter (O. D.)	
Maximum pressure	10 atm	145 psi
Maximum flow rate	8 m ³ /h (1.7 l/sec)	35 gpm
General filtration area	500 cm ²	77.5 in ²
Filtration volume	600 cm ³	37 in ³
Filter length L	340 mm	13 13/32"
Filter width W	130 mm	5 3/32"
Distance between end connections A	158 mm	6 7/32"
Weight	1.420 kg	3.13 lbs.
Maximum temperature	70° C	158 °F
pH	5-11	5-11

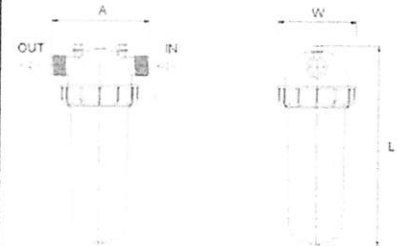

Filtration Grades

- Blue (400 micron / 40 mesh)
- Yellow (200 micron / 80 mesh)
- Red (130 micron / 120 mesh)
- Black (100 micron / 140 mesh)
- Green (55 micron)

Head Loss Chart

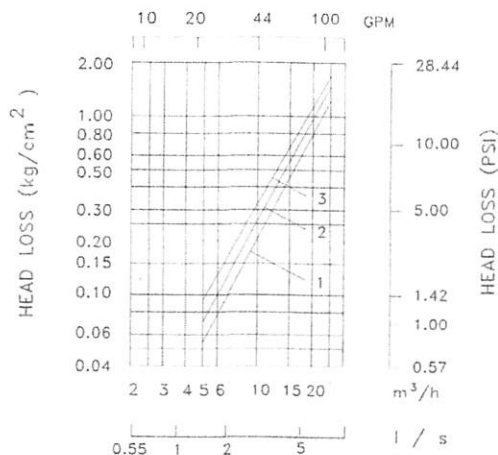



PMR-MF

PRESSURE-MASTER REGULATOR - MEDIUM FLOW

Specifications

The pressure regulator shall be capable of operating at a constant, factory preset, non-adjustable outlet pressure of 6, 10, 12, 15, 20, 25, 30, 35, 40, 50, or 60 PSI (0.41, 0.69, 0.83, 1.03, 1.38, 1.72, 2.07, 2.41, 2.76, 3.45, or 4.14 bar) with a flow range between:

- 4 - 16 GPM (909 - 3634 L/hr) for 6 - 10 PSI models or
- 2 - 20 GPM (454 - 4542 L/hr) for 12 - 60 PSI models.

The pressure regulator shall maintain the nominal pressure at a minimum of 5 PSI (0.34 bar) above model inlet pressure and a maximum of 80 PSI (5.52 bar) above nominal model pressure*. Refer to the PRU performance curve to establish specific outlet pressures based on relative inlet pressure and flow rate. Always install downstream from all shut off valves. Recommended for outdoor use only. Not NSF certified.

All pressure regulator models shall be equipped with one of these inlet-x-outlet configurations:

Inlet	Outlet
¾-inch Female National Pipe Thread (FNPT)	¾-inch Female National Pipe Thread (FNPT)
1-inch Female National Pipe Thread (FNPT)	1-inch Female National Pipe Thread (FNPT)
1-inch Female British Standard Pipe Thread (FBSPT)	1-inch Female British Standard Pipe Thread (FBSPT)

The upper housing, lower housing, and internal molded parts shall be of engineering-grade thermoplastics with internal elastomeric seals and a reinforced elastomeric diaphragm. Regulation shall be accomplished by a fixed stainless steel compression spring, which shall be enclosed in a chamber isolated from the normal water passage.

Outlet pressure and flow shall be clearly marked on each regulator.

The pressure regulator shall carry a two-year manufacturer’s warranty on materials, workmanship, and performance. Each pressure regulator shall be water tested for accuracy before departing the manufacturing facility.

The pressure regulator shall be manufactured by Senninger Irrigation in Clermont, Florida. Senninger is a Hunter Industries Company.

Physical

3/4" FNPT x 3/4" FNPT model (shown on right)

- Overall Length* 5.2 inches (13.1 cm)
- Overall Width* 2.5 inches (6.4 cm)

1" FNPT x 1" FNPT model

1" FBSPT x 1" FBSPT model

- Overall Length* 5.8 inches (14.6 cm)
- Overall Width* 2.5 inches (6.4 cm)

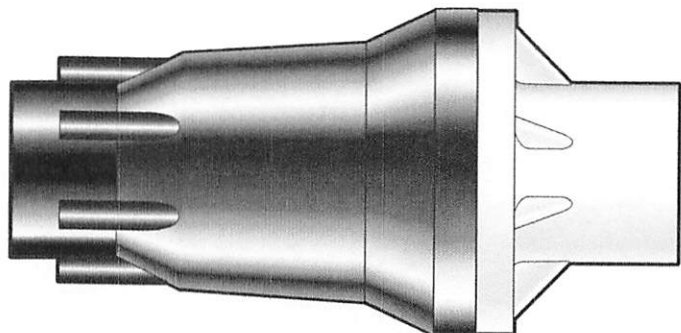

* Please consult factory for applications outside of recommended guidelines.



PMR-MF

PRESSURE-MASTER REGULATOR - MEDIUM FLOW

Model Numbers

Model #	Flow Range	Preset Operating Pressure	Maximum Inlet Pressure
PMR-6 MF	4 - 16 GPM (909 - 3634 L/hr)	6 PSI (0.41 bar)	80 psi (5.51 bar)
PMR-10 MF	4 - 16 GPM (909 - 3634 L/hr)	10 PSI (0.69 bar)	90 psi (6.20 bar)
PMR-12 MF	2 - 20 GPM (454 - 4542 L/hr)	12 PSI (0.83 bar)	90 psi (6.20 bar)
PMR-15 MF	2 - 20 GPM (454 - 4542 L/hr)	15 PSI (1.03 bar)	95 psi (6.55 bar)
PMR-20 MF	2 - 20 GPM (454 - 4542 L/hr)	20 PSI (1.38 bar)	100 psi (6.89 bar)
PMR-25 MF	2 - 20 GPM (454 - 4542 L/hr)	25 PSI (1.72 bar)	105 psi (7.24 bar)
PMR-30 MF	2 - 20 GPM (454 - 4542 L/hr)	30 PSI (2.07 bar)	110 psi (7.58 bar)
PMR-35 MF	2 - 20 GPM (454 - 4542 L/hr)	35 PSI (2.41 bar)	115 psi (7.93 bar)
PMR-40 MF	2 - 20 GPM (454 - 4542 L/hr)	40 PSI (2.76 bar)	120 psi (8.27 bar)
PMR-50 MF	2 - 20 GPM (454 - 4542 L/hr)	50 PSI (3.45 bar)	130 psi (8.96 bar)
PMR-60 MF	2 - 20 GPM (454 - 4542 L/hr)	60 PSI (4.14 bar)	140 psi (9.65 bar)



Bioline® Dripperline

Pressure Compensating Dripperline for Wastewater

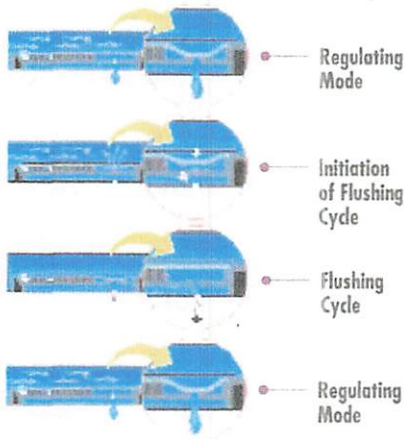

BioLine's Self-Cleaning, Pressure Compensating Dripper is a fully self-contained unit molded to the interior wall of the dripper tubing.

As shown at left, BioLine is continuously self-cleaning during operation, not just at the beginning and end of a cycle. The result is dependable, clog free operation, year after year.



Product Advantages

The Proven Performer

- Tens of millions of feet used in wastewater today.
- Bioline is permitted in every state allowing drip disposal.
- Backed by the largest, most quality-driven manufacturer of drip products in the U.S.
- Preferred choice of major wastewater designers and regulators.
- Proven track record of success for many years of hard use in wastewater applications.

Quality Manufacturing with Specifications Designed to Meet Your Needs

- Pressure compensating drippers assure the highest application uniformity - even on sloped or rolling terrain.
- Excellent uniformity with runs of 400 feet or more - reducing installation costs.
- Highest quality-control standards in the industry: Cv of 0.25 (coefficient of manufacturer's variation).
- A selection of flows and spacings to satisfy the designer's demand for almost any application rate.

Long-Term Reliability

- Protection against plugging:
 - Dripper inlet raised 0.27" above wall of tubing to prevent sediment from entering dripper.
 - Drippers impregnated with Vinyzene to prevent buildup of microbial slime.
 - Unique self-flushing mechanism passes small particles before they can build up.

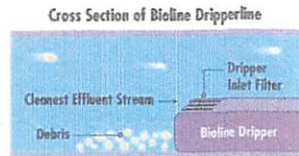

Root Safe

- A physical barrier on each BioLine dripper helps prevent root intrusion.
- Protection never wears out - never depletes - releases nothing to the environment.
- Working reliably for up to 15 years in subsurface wastewater installations.
- Additional security of chemical root inhibition with Techfilter - supplies Trifluralin to the entire system, effectively inhibiting root growth to the dripper outlets.



Applications

- For domestic strength wastewater disposal.
- Installed following a treatment process.
- Can be successfully used on straight septic effluent with proper design, filtration and operation.
- Suitable for reuse applications using municipally treated effluent designated for irrigation water.

Specifications

Wall thickness (mil): 45*

Nominal flow rates (GPH): .4, .6, .9*

Common spacings: 12", 18", 24"*

Recommended filtration: 120 mesh

Inside diameter: .570*

Color: Purple tubing indicates non-potable source

*Additional flows, spacings, and pipe sizes available by request. Please contact Netafim USA Customer Service for details.

BIOLINE Flow Rate vs. Pressure

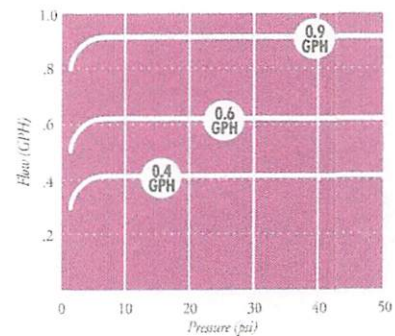

NETAFIM USA
5470 E. Home Ave. • Fresno, CA 93727
888.638.2346 • 559.453.6800
FAX 800.695.4753
www.netafimusa.com

SAMPLE DESIGNS

SINGLE TRENCH LAYOUT

Rectangular field with supply and flush manifold on same side and in same trench;

- Locate supply and flush manifold in same trench
- Dripperlines are looped at the end opposite the supply and flush manifolds
- The longest Bioline length should not exceed 400 ft. Drip fields 200 ft. in length might loop the Bioline once; drip dispersal fields under 100 ft. might be looped twice, as illustrated

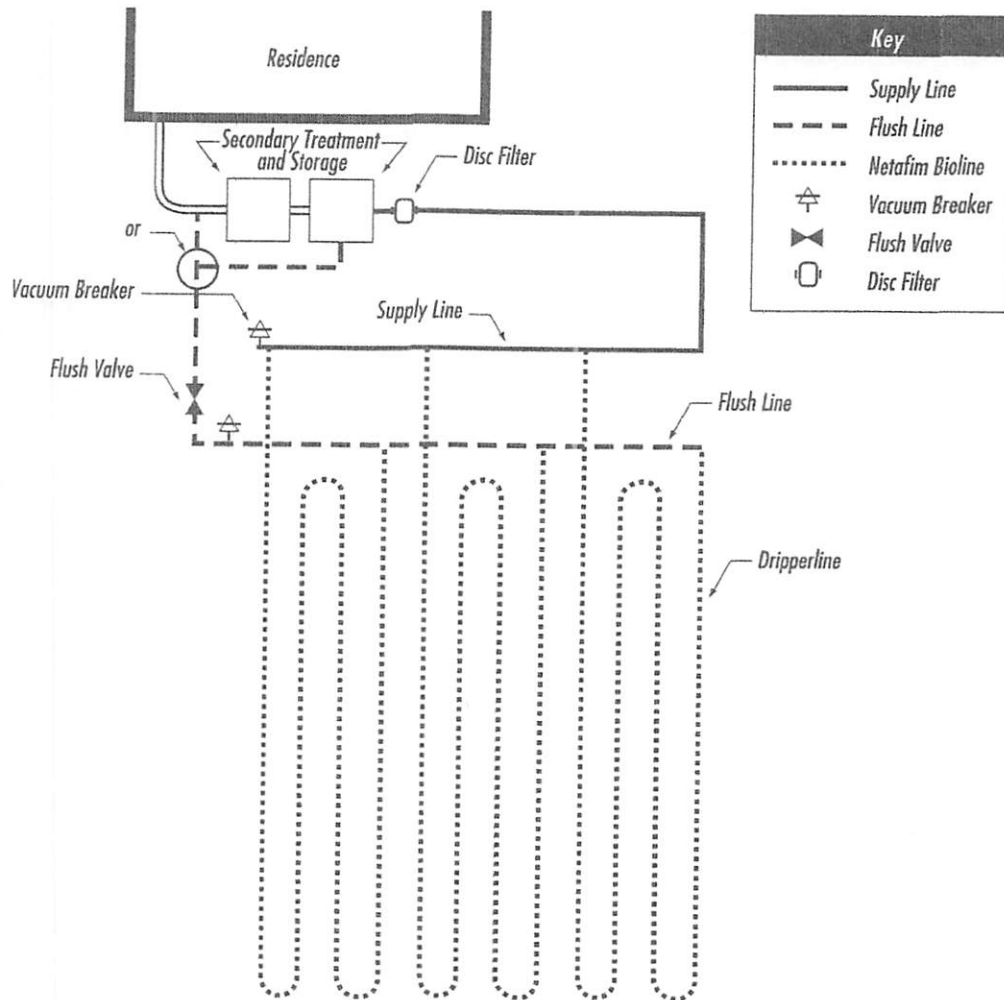

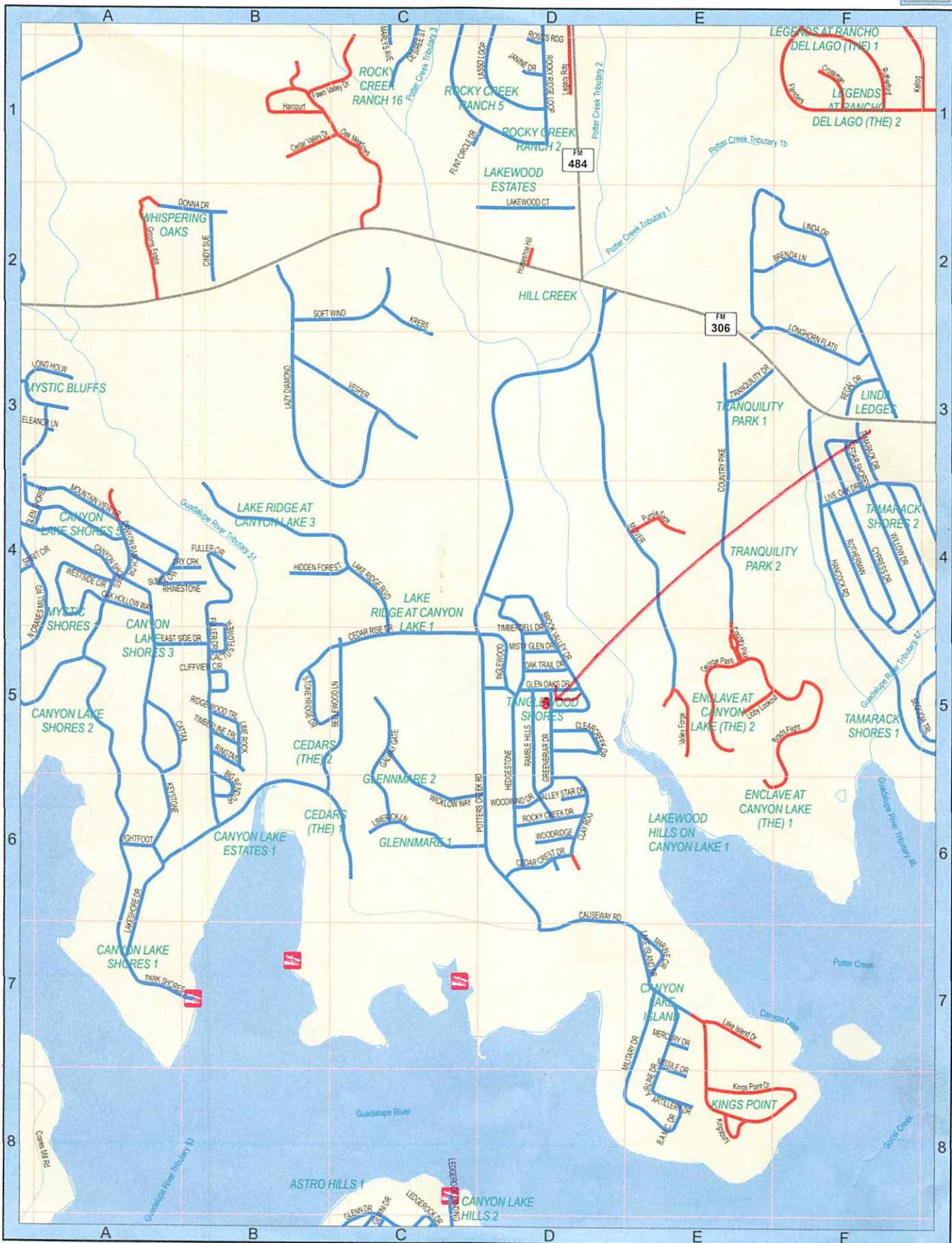

SEE PAGE 19

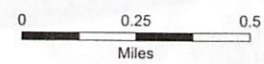

From: [Ritzen,Brenda](#)
To: ["Greg Johnson"](#)
Cc: [Randy Batey](#)
Subject: RE: 1008 GREENBRIAR DR - BAY AREA CONCRETE CONSTRUCTION #117537
Date: Friday, November 22, 2024 1:04:00 PM
Attachments: [image001.png](#)

Greg,

The permit file has been updated.

Thank you,



Brenda Ritzen
Environmental Health Coordinator
195 David Jonas Dr.
New Braunfels, TX 78132
DR:OS00007722
830-608-2090
www.cceo.org

From: Greg Johnson <gregjohnsonpe@yahoo.com>
Sent: Friday, November 22, 2024 8:43 AM
To: Ritzen,Brenda <rabbjr@co.comal.tx.us>
Cc: Randy Batey <randycbatey@gmail.com>
Subject: 1008 GREENBRIAR DR - BAY AREA CONCRETE CONSTRUCTION #117537

This email originated from outside of the organization.

Do not click links or open attachments unless you recognize the sender and know the content is safe.

- Comal IT

VARIANCE REQUEST.

THX,
GREG

Send for Greg W. Johnson, P.E.,R.S.)

170 Hollow Oak

New Braunfels, TX 78132

From: [Ritzen,Brenda](#)
To: [Diandra Linares](#)
Subject: Permit 117446
Date: Thursday, October 10, 2024 2:52:00 PM
Attachments: [117446.pdf](#)
[image001.png](#)

Diandra :

A copy of the License to Operate for the referenced permit is attached.

Thank you,



Brenda Ritzen
Environmental Health Coordinator
195 David Jonas Dr.
New Braunfels, TX 78132
DR:OS00007722
830-608-2090
www.cceo.org

GREENBRIAR DRIVE



VOID

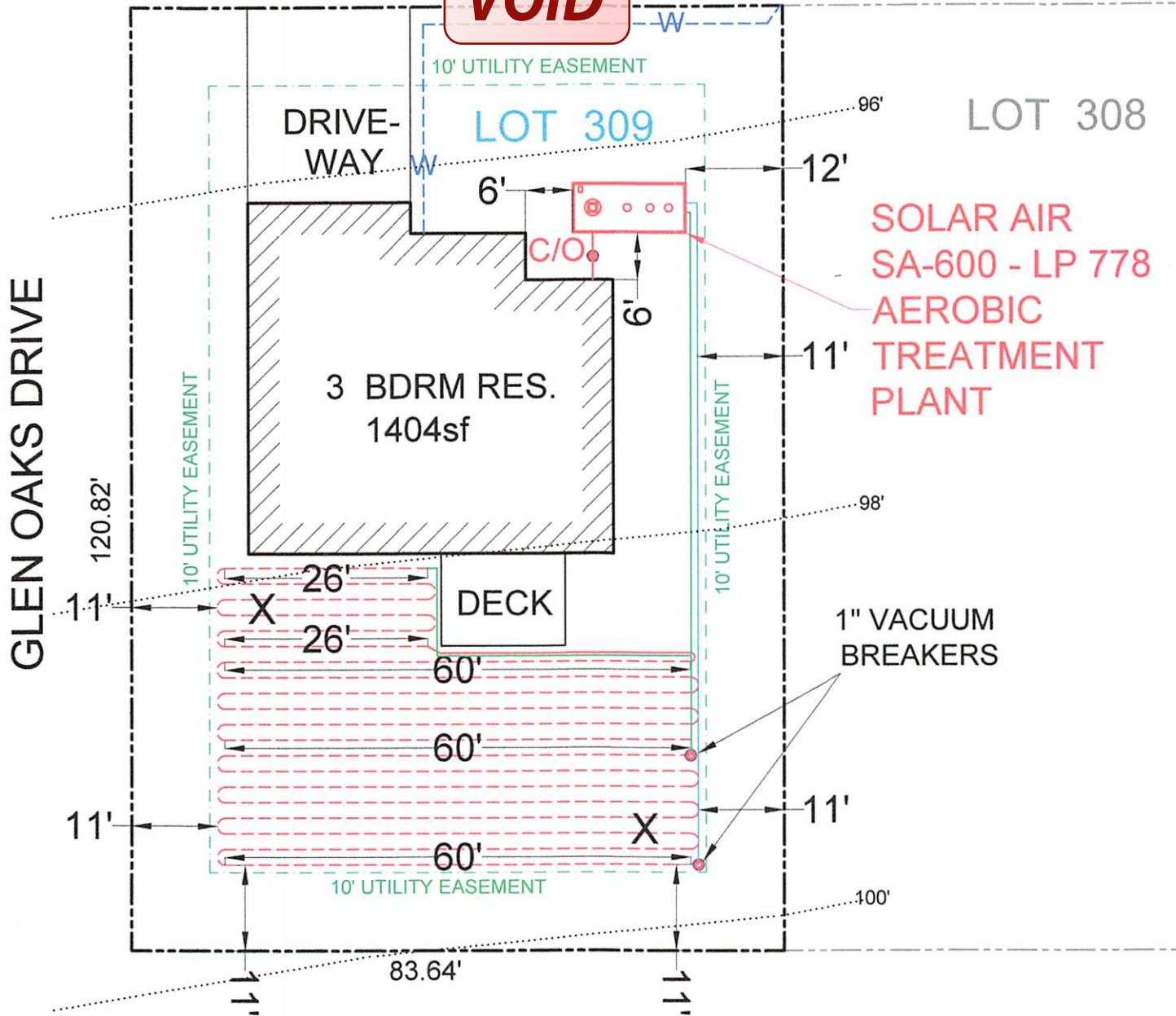

VOID

INSTALL 1992sf OF FIELD USING 996' OF DRIP TUBING. THERE SHALL BE NO PARKING, DRIVING OR STORAGE ON THE SEPTIC FIELD AT ANY TIME FOR ANY REASON.

- *USE TWO WAY CLEAN OUT
- **USE SCH-40 OR SDR-26 TO TANK

X= TEST HOLE



OWNER: BAY AREA CONCRETE CONSTRUCTION, LLC.		DRAWN BY: EJS III	
STREET ADDRESS: 1008 GREENBRIAR DRIVE			
LEGAL DESC: TANGLEWOOD SHORES	UNIT/SECTION/PHASE:	BLOCK:	LOT: 309
PREPARED BY: GREG W. JOHNSON, P.E. F#002585	SCALE: 1"=20'	DATE: 5/24/2024	REVISED:

From: [Ritzen, Brenda](#)
To: mimian@gvtc.com; "gregjohnsonpe@yahoo.com"
Subject: Permit 117537
Date: Friday, June 14, 2024 3:04:00 PM
Attachments: [image001.png](#)

**Re: Bay Area Concrete Construction, LLC
Tanglewood Shores Lot 309
Application for Permit for Authorization to Construct an On-Site
Sewage Facility (OSSF)**

Owner / Agent :

The following information is needed before I can continue processing the referenced permit submittal:

- ✓ 1. Owner signature needed on 2 year initial maintenance contract.
- ✓ A preliminary inspection is scheduled for Monday, June 17th.
Additional comments may be necessary once complete.

Thank you,



Brenda Ritzen
Environmental Health Coordinator
195 David Jonas Dr.
New Braunfels, TX 78132
DR:OS00007722
830-608-2090
www.cceo.org



WASTEWATER TREATMENT SYSTEM MAINTENANCE CONTRACT

Customer	Residential	Initial Contract
Bay Area Concrete Construction LLC	<input checked="" type="checkbox"/>	<input checked="" type="checkbox"/>
Site Address	Agency	
1008 Greenbriar Drive, Canyon Lake, TX 78133	Comal County	
Email	Phone	Permit Number
mimiian@gvtc.com	(210) 326-0661	
System Details		
Treatment: Aerobic Drip Emitters / System: Solar Air - National Wastewater Systems 600 Max GPD		

AGREEMENT

I. General:

This work for hire agreement (hereinafter referred to as "Agreement") is entered into by and between the Client and Luna Environmental, LLC (hereinafter referred to as "Contractor"), located at 4222 FM 482 New Braunfels, Texas 78132. By this agreement, Contractor agrees to render services, as described herein, and Client agrees to fulfill his/her/their responsibilities under the agreement as described herein.

II. Dates:

This agreement is for an initial 2-year maintenance contract and begins once the License to Operate (LTO) has been issued.

III. Services by Contractor:

1. Inspect and perform routine maintenance on the On-Site Sewage Facility ("OSSF") in compliance with code, regulations, and/or rules of the Texas Department of Environmental Quality ("TCEQ") and county in which the OSSF is located and the manufacturer's requirements, at a frequency of approximately once every four (4) months for residential properties, or once every one (1) month for commercial properties.
2. Inspection, adjustment, and servicing of the mechanical, electrical, and other components to ensure proper functioning. This includes inspecting control panels, air pumps, air filters, diffusers, floats, and spray heads.
3. Effluent Inspection will include the following: effluent quality (color, turbidity, overflow, and odor), testing effluent chlorine and pH levels, when necessary, alarm function, filters, operation of effluent pump and chlorinator. Unless otherwise agreed to, Contractor does not provide chlorine. BOD and TSS annually on commercial accounts, additional charges apply.
4. Notify Client of any repairs needed to keep OSSF in proper working condition and up to regulatory standards. Items under warranty may be repaired while the technician is on-site. Additional charges may apply for labor and service calls. Repair quotes of non-warranty items must be approved by Client before work is performed.
5. Report to the appropriate regulatory authority and to Client, as required by the State of Texas' on-site rules and, if required, TCEQ or County rules. All findings must be reported to the appropriate regulatory authority within 14 days.
6. Visit site within 48 hours of a service request.
7. Provide Customer Support line at 855-560-9909.

VOID

IV. Client Responsibilities:

1. Maintain Chlorinator and proper chlorine supply, unless otherwise specified.
2. Provide all necessary lawn or yard maintenance and remove all obstructions, including dogs and other animals as needed to allow the OSSF to function properly and the Contractor easy and safe access to all parts of
3. Immediately notify Contractor of any alarms or system problems.
4. Have tanks pumped out as directed by manufacturer, typically every 3 years.
5. Be available by text, phone, or in person when the Contractor is on site in case of required repair approvals or questions.
6. Maintain site drainage to prevent adverse effects on OSSF.
7. Promptly pay Contractor's bills, fees, and invoices in full.

V. Access By Contractor:

Access By Contractor: The contractor or anyone authorized by the contractor may enter the property at reasonable times without prior notice for the purpose of repairs and services described herein.

VI. Termination of This Agreement:

Either party may terminate this agreement with 30 days' written notice in the event of the other party's substantive failure to perform in accordance with this agreement without fault of the terminating party. If this agreement is terminated, the Contractor will notify the appropriate regulatory authority.

VII. Limitation of Liability:

In no event shall the Contractor be liable for indirect, consequential, incidental, or punitive damages, whether in contract, tort, or any other theory of liability. In no event shall the Contractor's liability for the direct damages exceed payments by the Client under this agreement.

VIII. Payment Terms:

The fee for this agreement only covers the services described herein. This fee does not cover equipment or labor for non-warranty repairs, labor for warranty repairs, or service charges resulting from unscheduled, Client requested trips to the Client's OSSF. Payments not received within 30 days from the date of invoicing will be subject to a \$30.00 late penalty and or a 1.5% monthly carrying charge, whichever is greater. By signing this contract, the Client authorizes the Contractor to remove any parts which were installed but not paid for at the end of 30 days. The Client is still responsible for any labor costs associated with the installation and removal of said parts. All invoices are due upon receipt by Client.

VOID

IX. Severability:

If any provision of this agreement shall be held to be invalid or unenforceable for any reason the remaining provisions shall continue to be held valid and enforceable. If a court finds that any provision of this agreement is invalid or unenforceable, by limiting such provision it would become valid and enforceable, then such provision shall be deemed to be written, construed, and enforced as so limited.

Bay Area Concrete Construction LLC

Luna Environmental / Ryan Seidensticker

DocuSigned by: Customer Name

Maintenance Provider Name

Bay Area Concrete Construction LLC

Ryan Seidensticker

License # MP0001708

086482340EF6418...

Customer Signature

Maintenance Provider Signature

Additional Comments / Special Terms

Independence Title/GF# 2409699 -CLF/ BD

NOTICE OF CONFIDENTIALITY RIGHTS: IF YOU ARE A NATURAL PERSON, YOU MAY REMOVE OR STRIKE ANY OR ALL OF THE FOLLOWING INFORMATION FROM ANY INSTRUMENT THAT TRANSFERS AN INTEREST IN REAL PROPERTY BEFORE IT IS FILED FOR RECORD IN THE PUBLIC RECORDS: YOUR SOCIAL SECURITY NUMBER OR YOUR DRIVER'S LICENSE NUMBER.

GENERAL WARRANTY DEED

Date: April 17, 2024

Grantor: Wesley Cheng a/k/a/ Wesley R. Cheng, a single person

Grantor's Mailing Address (including county):

3900 Threadgill Street Unit 6
Austin, Texas 78723
Travis County

Grantee: Bay Area Concrete Construction, LLC, a Texas limited liability company

Grantee's Mailing Address (including County):

2828 Lakeshore Drive
Canyon Lake, Texas 78133
Comal

Consideration: TEN AND NO/100 DOLLARS and other good and valuable consideration the receipt of which is hereby acknowledged.

Property (including any improvements):

Lots 308 and 309, TANGLEWOOD SHORES SUBDIVISION, according to the map or plat thereof, recorded in Volume 4, Page 63, Map and Plat Records, Comal County, Texas

Reservations from and Exceptions to Conveyance and Warranty:

This conveyance is made and accepted subject to any and all restrictions, covenants, reservations, and easements, if any, relating to the hereinabove described property, but only to the extent they are still in effect, shown of record in the hereinabove mentioned County and State.

Grantor, for the consideration, receipt of which is acknowledged, and subject to the reservations from and exceptions to conveyance and warranty, grants, sells and conveys to Grantee the property, together with all and singular the rights and appurtenances thereto in any wise belonging, to have and hold it to Grantee, Grantee's heirs, executor, administrators, successors or

assigns forever. Grantor binds Grantor and Grantor's heirs, executors, administrators and successors are hereby bound to warrant and forever defend all and singular the property to Grantee and Grantee's heirs, executors, administrators, successors and assigns against every person whomsoever lawfully claiming or to claim the same or any part thereof, except as to the reservations from and exceptions to conveyance and warranty.

Current ad valorem taxes on said property having been prorated, the payment thereof is assumed by Grantee.

When the context requires, singular nouns and pronouns include the plural.

Wesley Cheng
Wesley Cheng a/k/a/ Wesley R. Cheng

ACKNOWLEDGMENT

THE STATE OF TX
COUNTY OF Comal

This instrument was acknowledged before me on this 17 day of April 2024, by Wesley Cheng a/k/a/ Wesley R. Cheng.

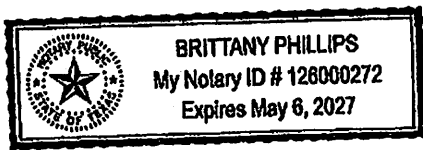

Bobbie Koeppe
Notary Public, State of TX

PREPARED IN THE OFFICES OF:

Stevens & Malone, PLLC
P.O. Box 1744
Canyon Lake, Texas 78133
830.964.4442 – tel.
830.964.4426 – fax

**Filed and Recorded
Official Public Records
Bobbie Koeppe, County Clerk
Comal County, Texas
04/18/2024 11:22:52 AM
CHRISTY 2 Pages(s)
202406011570**

 Bobbie Koeppe



COMAL COUNTY
ENGINEER'S OFFICE

**OSSF DEVELOPMENT APPLICATION
CHECKLIST**

Staff will complete shaded items

		117537
<i>Date Received</i>	<i>Initials</i>	<i>Permit Number</i>

Instructions:

Place a check mark next to all items that apply. For items that do not apply, place "N/A". This OSSF Development Application Checklist must accompany the completed application.

OSSF Permit

- Completed Application for Permit for Authorization to Construct an On-Site Sewage Facility and License to Operate
- Site/Soil Evaluation Completed by a Certified Site Evaluator or a Professional Engineer
- Planning Materials of the OSSF as Required by the TCEQ Rules for OSSF Chapter 285. Planning Materials shall consist of a scaled design and all system specifications.
- Required Permit Fee - See Attached Fee Schedule
- Copy of Recorded Deed
- Surface Application/Aerobic Treatment System
 - Recorded Certification of OSSF Requiring Maintenance/Affidavit to the Public
 - Signed Maintenance Contract with Effective Date as Issuance of License to Operate

I affirm that I have provided all information required for my OSSF Development Application and that this application constitutes a completed OSSF Development Application.

Signature of Applicant

05/29/2024

Date

<input type="checkbox"/> COMPLETE APPLICATION Check No. _____ Receipt No. _____
--

<input type="checkbox"/> INCOMPLETE APPLICATION (Missing Items Circled, Application Refused)
