

Comal County Environmental Health

OSSF Inspection Sheet

Installer Name: _____

OSSF Installer #: _____

1st Inspection Date: _____

2nd Inspection Date: _____

3rd Inspection Date: _____

Inspector Name: _____

Inspector Name: _____

Inspector Name: _____

Permit#:

Address:

No.	Description	Answer	Citations	Notes	1st Insp.	2nd Insp.	3rd Insp.
1	SITE AND SOIL CONDITIONS & SETBACK DISTANCES Site and Soil Conditions Consistent with Submitted Planning Materials		285.31(a) 285.30(b)(1)(A)(iv) 285.30(b)(1)(A)(v) 285.30(b)(1)(A)(iii) 285.30(b)(1)(A)(ii) 285.30(b)(1)(A)(i)				
2	SITE AND SOIL CONDITIONS & SETBACK DISTANCES Setback Distances Meet Minimum Standards		285.91(10) 285.30(b)(4) 285.31(d)				
3	SEWER PIPE Proper Type Pipe from Structure to Disposal System (Cast Iron, Ductile Iron, Sch. 40, SDR 26)		285.32(a)(1)				
4	SEWER PIPE Slope from the Sewer to the Tank at least 1/8 Inch Per Foot		285.32(a)(3)				
5	SEWER PIPE Two Way Sanitary - Type Cleanout Properly Installed (Add. C/O Every 100' &/or 90 degree bends)		285.32(a)(5)				
6	PRETREATMENT Installed (if required) TCEQ Approved List PRETREATMENT Septic Tank(s) Meet Minimum Requirements		285.32(b)(1)(G) 285.32(b)(1)(E)(iii) 285.32(b)(1)(E)(iv) 285.32(b)(1)(F) 285.32(b)(1)(B) 285.32(b)(1)(C)(i) 285.32(b)(1)(C)(ii) 285.32(b)(1)(D) 285.32(b)(1)(E) 285.32(b)(1)(A) 285.32(b)(1)(E)(ii)(II) 285.32(b)(1)(E)(i) 285.32(b)(1)(E)(ii)(I)				
7	PRETREATMENT Grease Interceptors if required for commercial		285.34(d)				

Inspector Notes:

**Comal County Environmental Health
OSSF Inspection Sheet**

No.	Description	Answer	Citations	Notes	1st Insp.	2nd Insp.	3rd Insp.
8	SEPTIC TANK Tank(s) Clearly Marked SEPTIC TANK If Single Tank, 2 Compartments Provided with Baffle SEPTIC TANK Inlet Flowline Greater than 3" and " T " Provided on Inlet and Outlet SEPTIC TANK Septic Tank(s) Meet Minimum Requirements		285.32(b)(1) (E) 285.91(2) 285.32(b)(1) (F) 285.32(b)(1)(E) (iii) 285.32(b)(1)(E)(ii) (II) 285.32(b)(1)(E)(ii) (I) 285.32(b)(1)(E) (i) 285.32(b)(1) (D) 285.32(b)(1)(C) (ii) 285.32(b)(1)(C) (i) 285.32(b)(1) (B) 285.32(b)(1) (A) 285.32(b)(1)(E)(iv)				
9	ALL TANKS Installed on 4" Sand Cushion/ Proper Backfill Used		285.32(b)(1)(F) 285.32(b)(1)(G) 285.34(b)				
10	SEPTIC TANK Inspection / Clean Out Port & Risers Provided on Tanks Buried Greater than 12" Sealed and Capped		285.38(d)				
11	SEPTIC TANK Secondary restraint system provided SEPTIC TANK Riser permanently fastened to lid or cast into tank SEPTIC TANK Riser cap protected against unauthorized intrusions		285.38(d) 285.38(e)				
12	SEPTIC TANK Tank Volume Installed						
13	PUMP TANK Volume Installed						
14	AEROBIC TREATMENT UNIT Size Installed						
15	AEROBIC TREATMENT UNIT Manufacturer AEROBIC TREATMENT UNIT Model Number						
16	DISPOSAL SYSTEM Absorptive		285.33(a)(4) 285.33(a)(1) 285.33(a)(2) 285.33(a)(3)				
17	DISPOSAL SYSTEM Leaching Chamber		285.33(a)(1) 285.33(a)(3) 285.33(a)(4) 285.33(a)(2)				
18	DISPOSAL SYSTEM Evapo-transpirative		285.33(a)(3) 285.33(a)(4) 285.33(a)(1) 285.33(a)(2)				

**Comal County Environmental Health
OSSF Inspection Sheet**

No.	Description	Answer	Citations	Notes	1st Insp.	2nd Insp.	3rd Insp.
19	DISPOSAL SYSTEM Drip Irrigation		285.33(c)(3)(A)-(F)				
20	DISPOSAL SYSTEM Soil Substitution		285.33(d)(4)				
21	DISPOSAL SYSTEM Pumped Effluent		285.33(a)(4) 285.33(a)(3) 285.33(a)(1) 285.33(a)(2)				
22	DISPOSAL SYSTEM Gravelless Pipe		285.33(a)(3) 285.33(a)(2) 285.33(a)(4) 285.33(a)(1)				
23	DISPOSAL SYSTEM Mound		285.33(a)(3) 285.33(a)(1) 285.33(a)(2) 285.33(a)(4)				
24	DISPOSAL SYSTEM Other (describe) (Approved Design)		285.33(d)(6) 285.33(c)(4)				
25	DRAINFIELD Absorptive Drainline 3" PVC or 4" PVC						
26	DRAINFIELD Area Installed						
27	DRAINFIELD Level to within 1 inch per 25 feet and within 3 inches over entire excavation		285.33(b)(1)(A)(v)				
28	DRAINFIELD Excavation Width DRAINFIELD Excavation Depth DRAINFIELD Excavation Separation DRAINFIELD Depth of Porous Media DRAINFIELD Type of Porous Media						
29	DRAINFIELD Pipe and Gravel - Geotextile Fabric in Place		285.33(b)(1)(E)				
30	DRAINFIELD Leaching Chambers DRAINFIELD Chambers - Open End Plates w/Splash Plate, Inspection Port & Closed End Plates in Place (per manufacturers spec.)		285.33(c)(2)				
31	LOW PRESSURE DISPOSAL SYSTEM Adequate Trench Length & Width, and Adequate Separation Distance between Trenches		285.33(d)(1)(C)(i)				

**Comal County Environmental Health
OSSF Inspection Sheet**

No.	Description	Answer	Citations	Notes	1st Insp.	2nd Insp.	3rd Insp.
32	EFFLUENT DISPOSAL SYSTEM Utilized Only by Single Family Dwelling EFFLUENT DISPOSAL SYSTEM Topographic Slopes < 2.0% EFFLUENT DISPOSAL SYSTEM Adequate Length of Drain Field (1000 Linear ft. for 2 bedrooms or Less & an additional 400 ft. for each additional bedroom) EFFLUENT DISPOSAL SYSTEM Lateral Depth of 18 inches to 3 ft. & Vertical Separation of 1ft on bottom and 2 ft. to restrictive horizon and ground water respectfully EFFLUENT DISPOSAL SYSTEM Lateral Drain Pipe (1.25 - 1.5" dia.) & Pipe Holes (3/16 - 1/4" dia. Hole Size) 5 ft. Apart		285.33(b)(3)(A) 285.33(b)(3)(A) 285.33(b)(3)(B)285.91(13) 285.33(b)(3)(D) 285.33(b)(3)(F)				
33	AEROBIC TREATMENT UNIT Is Aerobic Unit Installed According to Approved Guidelines.		285.32(c)(1)				
34	AEROBIC TREATMENT UNIT Inspection/Clean Out Port & Risers Provided AEROBIC TREATMENT UNIT Secondary restraint system provided AEROBIC TREATMENT UNIT Riser permanently fastened to lid or cast into tank AEROBIC TREATMENT UNIT Riser cap protected against unauthorized intrusions						
35	AEROBIC TREATMENT UNIT Chlorinator Properly Installed with Chlorine Tablets in Place.						
36	PUMP TANK Is the Pump Tank an approved concrete tank or other acceptable materials & construction PUMP TANK Sampling Port Provided in the Treated Effluent Line PUMP TANK Check Valve and/or Anti- Siphon Device Present When Required PUMP TANK Audible and Visual High Water Alarm Installed on Separate Circuit From Pump						
37	PUMP TANK Inspection/Clean Out Port & Risers Provided PUMP TANK Secondary restraint system provided PUMP TANK Riser permanently fastened to lid or cast into tank PUMP TANK Riser cap protected against unauthorized intrusions						
38	PUMP TANK Secondary restraint system provided						
39	PUMP TANK Electrical Connections in Approved Junction Boxes / Wiring Buried						

**Comal County Environmental Health
OSSF Inspection Sheet**

No.	Description	Answer	Citations	Notes	1st Insp.	2nd Insp.	3rd Insp.
40	APPLICATION AREA Distribution Pipe, Fitting, Sprinkler Heads & Valve Covers Color Coded Purple?		285.33(d)(2)(G)(iii)(II) 285.33(d)(2)(G)(iii)(III) 285.33(d)(2)(G)(v) 285.33(d)(2)(G)(iii) 285.33(d)(2)(G)(iv) 285.33(d)(2)(G)(i) 285.33(d)(2)(G)(ii) 285.33(d)(2)(G)(iii)(I)				
41	APPLICATION AREA Low Angle Nozzles Used / Pressure is as required APPLICATION AREA Acceptable Area, nothing within 10 ft of sprinkler heads? APPLICATION AREA The Landscape Plan is as Designed		285.33(d)(2)(G) (i)285.33(d)(2) (A)285.33(d)(2)(F)				
42	APPLICATION AREA Area Installed						
43	PUMP TANK Meets Minimum Reserve Capacity Requirements						
44	PUMP TANK Material Type & Manufacturer						
45	PUMP TANK Type/Size of Pump Installed						



COMAL COUNTY

ENGINEER'S OFFICE

Permit of Authorization to Construct an On-Site Sewage Facility Permit Valid For One Year From Date Issued

Permit Number: 118318
Issued This Date: 03/14/2025
This permit is hereby given to: TALAVERA HOMES, LLC

To start construction of a private, on-site sewage facility located at:

5250 SPRING BRANCH RD
SPRING BRANCH, TX 78070

Subdivision: RIVERMONT
Unit: 3
Lot: 42
Block: 12
Acreage: 0.5100

APPROVED MINIMUM SIZES AS PER ATTACHED DESIGN

Type of System: Aerobic
Surface Irrigation

This permit gives permission for the construction of the above referenced on-site facility to commence. Installation must be completed by an installer holding a valid registration card from the Texas Commission on Environmental Quality (TCEQ). Installation and inspection must comply with current TCEQ and Comal County requirements.

Call (830) 608-2090 to schedule inspections.

RECEIVED

By Kathy Griffin at 9:23 am, Jan 27, 2025



COMAL COUNTY
ENGINEER'S OFFICE

**OSSF DEVELOPMENT APPLICATION
CHECKLIST**

Staff will complete shaded items

--	--

Date Received

Initials

118318

Permit Number

Instructions:

Place a check mark next to all items that apply. For items that do not apply, place "N/A". This OSSF Development Application Checklist **must** accompany the completed application.

OSSF Permit

- ☒ Completed Application for Permit for Authorization to Construct an On-Site Sewage Facility and License to Operate
- ☒ Site/Soil Evaluation Completed by a Certified Site Evaluator or a Professional Engineer
- ☒ Planning Materials of the OSSF as Required by the TCEQ Rules for OSSF Chapter 285. Planning Materials shall consist of a scaled design and all system specifications.
- ☒ Required Permit Fee - See Attached Fee Schedule
- ☒ Copy of Recorded Deed
- ☒ Surface Application/Aerobic Treatment System
 - ☒ Recorded Certification of OSSF Requiring Maintenance/Affidavit to the Public
 - ☒ Signed Maintenance Contract with Effective Date as Issuance of License to Operate

I affirm that I have provided all information required for my OSSF Development Application and that this application constitutes a completed OSSF Development Application.

Signature of Applicant

01/22/2025

Date

___ COMPLETE APPLICATION

Check No. _____ Receipt No. _____

INCOMPLETE APPLICATION

___ (Missing Items Circled, Application Refused)



COMAL COUNTY
ENGINEER'S OFFICE

ON-SITE SEWAGE FACILITY APPLICATION

195 DAVID JONAS DR
NEW BRAUNFELS, TX 78132
(830) 608-2090
WWW.CCEO.ORG

Date January 6, 2025

Permit Number 118318

1. APPLICANT / AGENT INFORMATION

Owner Name TALAVERA HOMES, LLC
Mailing Address 8605 EXPLORER DR #250
City, State, Zip COLORADO SPRINGS, CO 80920
Phone # 210-818-2916
Email admin@talavera-homes.com

Agent Name GREG JOHNSON, P.E.
Agent Address 170 HOLLOW OAK
City, State, Zip NEW BRAUNFELS TEXAS 78132
Phone # 830-905-2778
Email gregjohnsonpe@yahoo.com

2. LOCATION

Subdivision Name RIVERMONT Unit 3 Lot 42 Block 12
Survey Name / Abstract Number _____ Acreage _____
Address 5250 SPRING BRANCH ROAD City SPRING BRANCH State TX Zip 78070

3. TYPE OF DEVELOPMENT

☒ Single Family Residential

Type of Construction (House, Mobile, RV, Etc.) HOUSE

Number of Bedrooms 4

Indicate Sq Ft of Living Area 2000

☐ Non-Single Family Residential

(Planning materials must show adequate land area for doubling the required land needed for treatment units and disposal area)

Type of Facility _____

Offices, Factories, Churches, Schools, Parks, Etc. - Indicate Number Of Occupants _____

Restaurants, Lounges, Theaters - Indicate Number of Seats _____

Hotel, Motel, Hospital, Nursing Home - Indicate Number of Beds _____

Travel Trailer/RV Parks - Indicate Number of Spaces _____

Miscellaneous _____

Estimated Cost of Construction: \$ 400,000 (Structure Only)

Is any portion of the proposed OSSF located in the United States Army Corps of Engineers (USACE) flowage easement?

☐ Yes ☒ No (If yes, owner must provide approval from USACE for proposed OSSF improvements within the USACE flowage easement)

Source of Water ☐ Public ☒ Private Well ☐ Rainwater Collection

4. SIGNATURE OF OWNER

By signing this application, I certify that:

- The completed application and all additional information submitted does not contain any false information and does not conceal any material facts. I certify that I am the property owner or I possess the appropriate land rights necessary to make the permitted improvements on said property.
- Authorization is hereby given to the permitting authority and designated agents to enter upon the above described property for the purpose of site/soil evaluation and inspection of private sewage facilities..
- I understand that a permit of authorization to construct will not be issued until the Floodplain Administrator has performed the reviews required by the Comal County Flood Damage Prevention Order.
- I affirmatively consent to the online posting/public release of my e-mail address associated with this permit application, as applicable.

E. H. Skelton
Signature of Owner

01/10/25
Date

#118318



COMAL COUNTY
ENGINEER'S OFFICE

RECEIVED

By Brandon Olvera at 11:46 am, Mar 14, 2025

ON-SITE SEWAGE FACILITY APPLICATION

RIVERMONT, UNIT 3, BLOCK 12, LOT 42

195 DAVID JONAS DR
NEW BRAUNFELS, TX 78132
(830) 608-2090
WWW.CCEO.ORG

Planning Materials & Site Evaluation as Required Completed By GREG W. JOHNSON, P.E.

System Description PROPRIETARY; AEROBIC TREATMENT AND SURFACE IRRIGATION

Size of Septic System Required Based on Planning Materials & Soil Evaluation

Tank Size(s) (Gallons) SOLAR AIR SA600LP Absorption/Application Area (Sq Ft) 4894

Gallons Per Day (As Per TCEQ Table 111) 300

(Sites generating more than 5000 gallons per day are required to obtain a permit through TCEQ.)

Is the property located over the Edwards Recharge Zone? ☐ Yes ☒ No

(if yes, the planning materials must be completed by a Registered Sanitarian (R.S.) or Professional Engineer (P.E.))

Is there an existing TCEQ approved WPAP for the property? ☐ Yes ☒ No

(if yes, the R.S. or P.E. shall certify that the OSSF design complies with all provisions of the existing WPAP.)

Is there at least one acre per single family dwelling as per 285.40(c)(1)? ☐ Yes ☒ No

If there is no existing WPAP, does the proposed development activity require a TCEQ approved WPAP? ☐ Yes ☒ No

(if yes, the R.S or P.E. shall certify that the OSSF design will comply with all-provisions of the proposed WPAP. A Permit to Construct will not be issued for the proposed OSSF until the proposed WPAP has been approved by the appropriate regional office.)

Is the property located over the Edwards Contributing Zone? ☒ Yes ☐ No

Is there an existing TCEQ approval CZP for the property? ☐ Yes ☒ No

(if yes, the P.E. or R.S. shall certify that the OSSF design complies with all provisions of the existing CZP.)

If there is no existing CZP, does the proposed development activity require a TCEQ approved CZP? ☐ Yes ☒ No

(if yes, the R.S. or P.E. shall certify that the OSSF design will comply with all provisions of the proposed CZP. A Permit to Construct will not be issued for the proposed OSSF until the UP has been approved by the appropriate reg

Is this property within an incorporated city? ☐ Yes ☒ No

If yes, indicate the city: _____

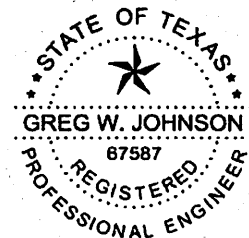

FIRM #2585

By signing this application, I certify that:

- The information provided above is true and correct to the best of my knowledge.
- I affirmatively consent to the online posting/public release of my e-mail address associated with this permit application, as applicable.

[Signature]
Signature of Designer

January 8, 2025
Date

AFFIDAVIT**THE COUNTY OF COMAL
STATE OF TEXAS****CERTIFICATION OF OSSF REQUIRING MAINTENANCE**

According to Texas Commission on Environmental Quality Rules for On-Site Sewage Facilities (OSSFs), this document is filed in the Deed Records of Comal County, Texas.

I

The Texas Health and Safety Code, Chapter 366 authorizes the Texas Commission on Environmental Quality (TCEQ) to regulate on-site sewage facilities (OSSFs). Additionally, the Texas Water Code (TWC), § 5.012 and § 5.013, gives the commission primary responsibility for implementing the laws of the State of Texas relating to water and adopting rules necessary to carry out its powers and duties under the TWC. The commission, under the authority of the TWC and the Texas Health and Safety code, requires owner's to provide notice to the public that certain types of OSSFs are located on specific pieces of property. To achieve this notice, the commission requires a recorded affidavit. Additionally, the owner must provide proof of the recording to the OSSF permitting authority. This recorded affidavit is not a representation or warranty by the commission of the suitability of this OSSF, nor does it constitute any guarantee by the commission that the appropriate OSSF was installed.

II

An OSSF requiring a maintenance contract, according to 30 Texas Administrative Code §285.91(12) will be installed on the property described as (insert legal description):

3 UNIT/HASE/SECTION 12 BLOCK 42 LOT RIVERMONT SUBDIVISION

IF NOT IN SUBDIVISION: _____ ACREAGE _____ SURVEY

The property is owned by (insert owner's full name): TALavera HOMES, LLC,
a Colorado limited liability company

This OSSF must be covered by a continuous maintenance contract for the first two years. After the initial two-year service policy, the owner of an aerobic treatment system for a single family residence shall either obtain a maintenance contract within 30 days or maintain the system personally.

Upon sale or transfer of the above-described property, the permit for the OSSF shall be transferred to the buyer or new owner. A copy of the planning materials for the OSSF can be obtained from the Comal County Engineer's Office.

WITNESS BY HAND(S) ON THIS 10 DAY OF JANUARY, 2025

Eric H. Stensrud
Owner(s) signature(s)

Eric H. Stensrud - MANAGER
Owner (s) Printed name (s)

ERIC H. STENSURD

SWORN TO AND SUBSCRIBED BEFORE ME ON THIS 10 DAY OF

JANUARY, 2025

Greg W. Johnson
Notary Public Signature

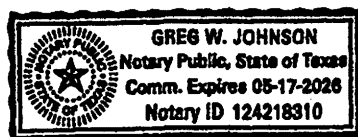

Filed and Recorded
Official Public Records
Bobbie Koepp, County Clerk
Comal County, Texas
01/22/2025 08:08:01 AM
MARY 1 Pages(s)
202506001860



Bobbie Koepp



On-Site Sewage Facility (OSSF) Service Agreement

- I. **General:** This Work for Hire Agreement (hereinafter referred to as "Agreement") is entered into by and between TALAVERA HOMES, LLC, (hereinafter referred to as "Client") and SOTX Septic Services (hereinafter to as "Contractor"). By this agreement, Contractor agrees to render services, as described herein, and the Client agrees to fulfill his/her/their responsibilities under this agreement as described herein.
- II. **Effective Dates:** This agreement commences on receipt of full payment and runs for two (2) years. Agreement's... Starting Date: (Date License to Operate is Issued) Ending Date: (2yrs. From Date of LTQ)
- III. **Services by Contractor:** Contractor will provide the following services (hereinafter referred to as the "Services"):
 1. In compliance with Agency (TCEQ and/or County) and manufacturer's requirements, inspect and perform routine maintenance on the On-Site Sewage Facility (hereinafter referred to as the "OSSF") three (3) times per year (approximately once every four (4) months).
 2. Report to the appropriate regulatory authority and to the Client, as is required by both the State's on-site rules and the local Agency's rules, if more stringent. All findings must be reported to the local Agency within 14 days.
 3. If any components of the OSSF are found to need repair during the inspection, the Contractor will notify the Client of the repairs needed.
 4. Visit in response to Client's request(s) for unscheduled service(s) within two business days from the date of Contractor's receipt of Client's request. All unscheduled responses are in addition to the fee covered by this Agreement and will be billed to the Client.
 5. Provide notification of arrival to site to the homeowner or to site personnel. Additionally, written notification of the visit will be left at the site or with site personnel upon completion or inspection, as well as, forwarded to agency within 14 days.
- IV. **Site Location:** The Services are to be performed at the property located at:

5250 SPRING BRANCH RD, SPRING BRANCH, TX 78070

RIVERMONT UNIT 3, BLOCK 12, LOT 42
- V. **Payment(s):** The fee for this Agreement only covers the Services describes herein. This fee does not cover equipment, parts or labor supplied for the repairs or charges for unscheduled Client-request trips to the site. Payments for such additional services are due when service is provided or rendered. Payments not received within 30 days from due date will be subjected to a \$20.00 late penalty and / or a 1.5% carrying charge, whichever is greater, in addition the reasonable attorney's fees and all costs of collection incurred by Contractor in collection of any unpaid debt(s). By signing this contract, the Client is authorizing the Contractor to remove any parts which were installed but not paid for at the end of 30 days. The Client is still responsible for any labor costs associated with the installation and remove of said parts.

Initials...

Customer: CHSContractor: CDH

Client's Responsibilities: The Client is responsible for each and all the following:

1. Maintain chlorinator and provide proper chlorine supply, if OSSF is equipped with same.
2. Provide all necessary yard or lawn maintenance and removal of obstacles as needed to allow the OSSF to function properly, and to allow Contractor easy access to all parts of the OSSF.
3. Maintain a current license to operate and abide by the conditions and limitations of that license and all requirements for on-site sewage facilities (OSSF's) from the State and local regulatory agency, as well as manufacturer's recommendations.
4. Immediately notify the Contractor and Agency of all problems with, including the failure of the OSSF.
5. Upon receiving a written notification of services needed from the Contractor, it becomes the Client's responsibility to contact the Contractor to authorize the service. If the Client chooses to use a different contractor to perform the service, the Client's responsible for ensuring the contractor holds the proper license (installer II) and is certified by the manufacturer. Also, the Client is responsible for ensuring proper notification is given to the Agency, as required by the State and local Agency rules.
6. Provide the Contractor with water usage records, upon request, for evaluation by the Contractor of the OSSF performance.
7. Clients residing in Harris County should allow for samples at both the inlet and outlet to the OSSF to be obtained by the Contractor for the purpose of evaluating the OSSF's performance when requested by the Client. If these samples are sent to the lab for testing, the Client will directly pay the lab for the cost of the testing plus pay the Contractor for all man-hours expended in providing this additional service at the rate of \$75.00 per hour measured from office to site, site to lab, and lab to office, otherwise known as portal to portal.
8. Not allow the backwash from water treatment or water conditioning equipment to enter the OSSF.
9. Provide for pumping of tanks, when needed, at Clients expense.
10. Maintain site drainage to prevent adverse effects on OSSF.
11. Promptly and fully pay Contactor's bills, fees, or invoices as described herein.

VI. Access by Contractor: Contractor, or personnel authorized by the Contractor, may enter the property at reasonable times without prior notice for the purpose of performing the above-described Services. Contractor will require access to the OSSF electrical and physical components, including tanks, by means of manways or risers for the purpose of evaluations required by manufacturer, and/ or rules. If such manways or risers are not in place, excavation together with other labor and materials will be required and will be billed to Client as additional service at the rate of \$75.00 per hour, plus materials billed at list price. Excavated soil is to be replaced as best as reasonably possible.

VII. Application or Transfer of Payments: The fees paid for this agreement may transfer to subsequent owner(s); however, this agreement will not transfer. The subsequent owner(s) must sign a similar agreement authorizing Contractor to perform the above-described Services and accepting Client's responsibilities. This replacement Agreement must be signed and received within 30 days of transfer of ownership. Contractor will apply all funds received from Client first to any past due obligations arising from this Agreement including late charges, return check charges, and charges for repairs or services not paid within 30 days of invoicing. The consumption of the payment in this manner may lead to early termination of the agreement by Contractor.

VIII. Termination of Agreement: This Agreement may be terminated by either party within 30 days written notice in the event of substantial failure to perform in accordance with its terms by the other party without fault of the terminating party. If this Agreement is so terminated, Contractor shall be paid at the rate of \$75.00 per hour for any work performed, but not yet paid. The party terminating will immediately notify the other party, the equipment manufacturer, and the regulatory agency of the termination.

IX. Limits of Liability: In no event shall the Contractor be liable for indirect, consequential, incidental or punitive damages, whether in contract tort or any other theory. In no event the Contractor's liability for direct damages exceed the price for the Services described in this Agreement.

X. Severability: If any provision in the Agreement shall be held to be invalid or unenforceable for any reason, the remaining provisions shall continue to be valid and enforceable. If court finds that any provision of this

Initials...

Customer: 

Contractor: 

Agreement is invalid or unenforceable, but that by limiting such provision it would become valid and enforceable, then such provision shall be written, construed, and enforced as so limited.

XI. **Performance of Agreement:** Commencement of performance by Contractor under this agreement is contingent on the following conditions (1) Contractor receiving a fully execute original copy of this agreement. (2) Contractor receiving payment in full for the fee as described in Section V. If the above conditions are not met, then Contractor is not obligated to perform any portion of this agreement.

XII. **Entire Agreement:** This agreement contains the entire agreement parties, and there are no other promises or conditions in any other agreement, oral or written.

Client... (And/or authorized agent)

Printed Name: ERIC H. STENSLUND Signature:  Date: 11/10/25

Printed Name: _____ Signature: _____ Date: _____

Physical Address: 5250 SPRING BRANCH RD, SPRING BRANCH Zip: 78070

Mailing Address: 8605 EXPLORER DRIVE, #250, COLORADO SPGS Zip: 80920

Phone # _____ Cell# 210-818-2916 County: COMAL

Email: admin@talavera-homes.com Gate Code: _____

=====Contractor=====Contractor=====

SOTX Septic Services

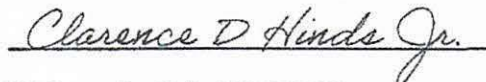
Clarence D. Hinds Jr 

15656 Cranes Mill Rd.

Lic #: OSSF Installer II #: OS0030965

Canyon Lake, TX 78133

Maintenance Provider #: MP0002439

830-481-3249

sotxservices@gmail.com

Installer Name: JESSE KLAERNER

Phone #: 830-838-3087

Email: impact.construction1@yahoo.com

Lic #: OS#0039407

Manufacturer: SOLAR AIR SA600LP

GPD: 600 800 1000 Other: _____

Disposal: Spray Drip Other: _____

Initials...

Customer: 

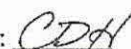
Contractor: 

ON-SITE SEWERAGE FACILITY SOIL EVALUATION REPORT INFORMATION

Date Soil Survey Performed: January 07, 2025

Site Location: RIVERMONT, UNIT 3, BLOCK 12, LOT 42

Proposed Excavation Depth: N/A

Requirements:

At least two soil excavations must be performed on the site, at opposite ends of the proposed disposal area.
Locations of soil boring or dug pits must be shown on the site drawing.
For subsurface disposal, soil evaluations must be performed to a depth of at least two feet below the proposed excavation depth. For surface disposal, the surface horizon must be evaluated.
Describe each soil horizon and identify any restrictive features on the form. Indicate depths where features appear.

SOIL BORING NUMBER <u> </u> SURFACE EVALUATION						
Depth (Feet)	Texture Class	Soil Texture	Gravel Analysis	Drainage (Mottles/ Water Table)	Restrictive Horizon	Observations
0	IV	CLAY	N/A	NONE OBSERVED	LIMESTONE @ 6"	BROWN STONY
1						
2						
3						
4						
5						

SOIL BORING NUMBER <u> </u> SURFACE EVALUATION						
Depth (Feet)	Texture Class	Soil Texture	Gravel Analysis	Drainage (Mottles/ Water Table)	Restrictive Horizon	Observations
0	SAME		AS		ABOVE	
1						
2						
3						
4						
5						

I certify that the findings of this report are based on my field observations and are accurate to the best of my ability.

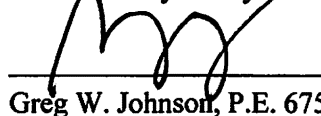
Greg W. Johnson, P.E. 67587-F2585, S.E. 11561

01/07/25
Date

OSSF SOIL EVALUATION REPORT INFORMATION

Date: January 08, 2025

Applicant Information:

Name: TALavera HOMES, LLC.
Address: 8605 EXPLORER DRIVE #250
City: COLORADO SPRINGS State: COLORADO
Zip Code: 80920 Phone: (210) 818-2916

Site Evaluator Information:

Name: Greg W. Johnson, P.E., R.S., S.E. 11561
Address: 170 Hollow Oak
City: New Braunfels State: Texas
Zip Code: 78132 Phone & Fax (830)905-2778

Property Location:

Lot 42 Unit 3 Blk 12 Subd. RIVERMONT
Street Address: 5250 SPRING BRANCH ROAD
City: SPRING BRANCH Zip Code: 78070
Additional Info.: _____

Installer Information:

Name: _____
Company: _____
Address: _____
City: _____ State: _____
Zip Code: _____ Phone _____

Topography: Slope within proposed disposal area: 4 %

Presence of 100 yr. Flood Zone:	YES _____ NO <u>X</u>	
Existing or proposed water well in nearby area.	YES <u>X</u> NO _____	>100'
Presence of adjacent ponds, streams, water impoundments	YES _____ NO <u>X</u>	
Presence of upper water shed	YES _____ NO <u>X</u>	
Organized sewage service available to lot	YES _____ NO <u>X</u>	

Design Calculations for Aerobic Treatment with Spray Irrigation:

Commercial

Q = _____ GPD _____

Residential Water conserving fixtures to be utilized? Yes X No _____

Number of Bedrooms the septic system is sized for: 4 Total sq. ft. living area 2000

Q gal/day = (Bedrooms +1) * 75 GPD - (20% reduction for water conserving fixtures)

Q = (4 +1)*75-(20%)= 300

Trash Tank Size 376 Gal.

TCEQ Approved Aerobic Plant Size 600 G.P.D.

Req'd Application Area = Q/Ri = 300 / 0.064 = 4688 sq. ft.

Application Area Utilized = 4894 sq. ft.

Pump Requirement 12 Gpm @ 41 Psi (Redjacket 0.5 HP 18 G.P.M. series or equivalent)

Dosing Cycle: _____ ON DEMAND or X TIMED TO DOSE IN PREDAWN HOURS

Pump Tank Size = 778 Gal. 18.75 Gal/inch.

Reserve Requirement = 100 Gal. 1/3 day flow.

Alarms: Audible & Visual High Water Alarm & Visual Air Pump malfunction

With Chlorinator NSF/TCEQ APPROVED

SCH-40 or SDR-26 3" or 4" sewer line to tank

Two way cleanout

Pop-up rotary sprinkler heads w/ purple non-potable lids

1" Sch-40 PVC discharge manifold

APPLICATION AREA SHOULD BE SEEDED AND MAINTAINED WITH VEGETATION.

EXPOSED ROCK WILL BE COVERED WITH SOIL .

I HAVE PERFORMED A THOROUGH INVESTIGATION BEING A REGISTERED PROFESSIONAL ENGINEER AND SITE EVALUATOR IN ACCORDANCE WITH CHAPTER 285, SUBCHAPTER D, §285.30, & §285.40 (REGARDING RECHARGE FEATURES), TEXAS COMMISSION OF ENVIRONMENTAL QUALITY (EFFECTIVE DECEMBER 29, 2016)

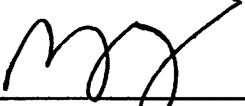
GREG W. JOHNSON, P.E. F#002585 - S.E. 11561

01/08/25
DATE

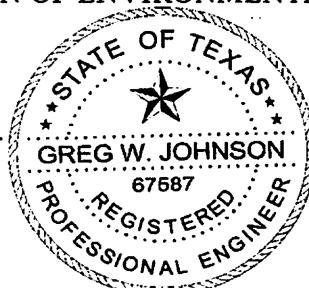

FIRM #2585

Greg W. Johnson, P.E.

170 Hollow Oak
New Braunfels, Texas 78132
830/905-2778

January 8, 2025

Comal County Office of Environmental Health
195 David Jonas Drive
New Braunfels, Texas 78132-3760

RE- Septic Design
5250 SPRING BRANCH ROAD
RIVERMONT, UNIT 3, BLOCK 12, LOT 42
SPRING BRANCH, TX 78070
TALAVERA HOMES, LLC

Brandon/Brenda,

Due to the lack of available application area it is necessary to have the setback from the property line to the spray at ten feet as required by TCEQ Chapter 285 rules Table X. I hereby request a variance to the twenty foot setback to property lines as required by Comal County Order and equivalent protection will be maintained by including a battery backup to the timer clock to assure sprayers to only spray during the predawn hours. In my professional opinion this variance will not pose a threat to the environment or public health.

If I can be of further assistance please contact me.

Respectfully yours,

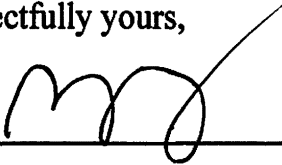

Greg W. Johnson, P.E., F#2585

January 8, 2025

Date

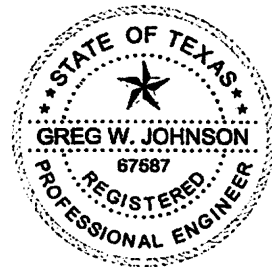

SPRING BRANCH ROAD

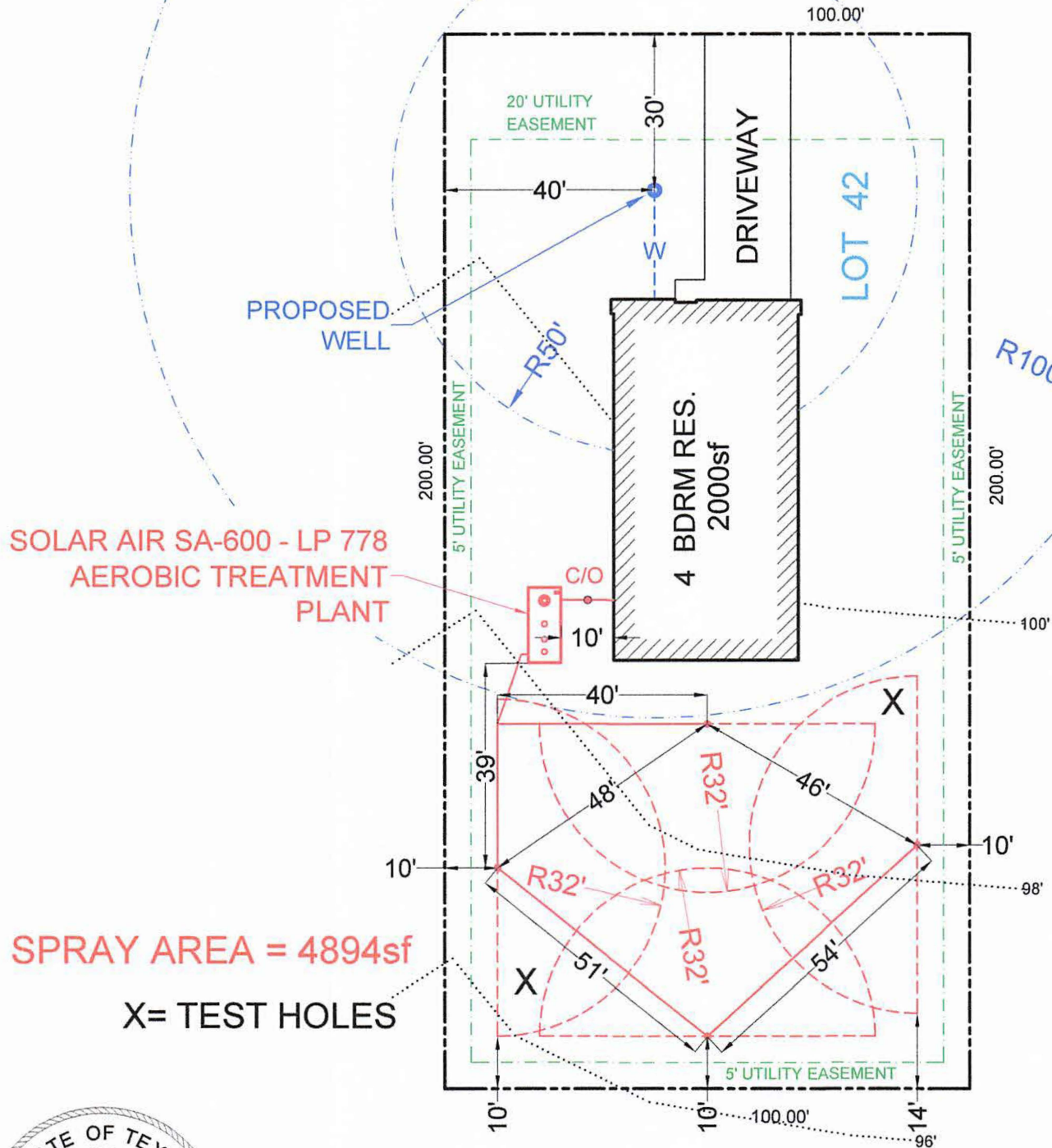

OWNER: TALAVERA HOMES, LLC.				DRAWN BY: EJS III	
STREET ADDRESS: 5250 SPRING BRANCH ROAD					
LEGAL DESC: RIVERMONT			UNIT/SECTION/PHASE: 3	BLOCK: 12	LOT: 42
PREPARED BY: GREG W. JOHNSON, P.E. F#002585		SCALE: 1"=30'	DATE: 1/8/2025		REVISED:

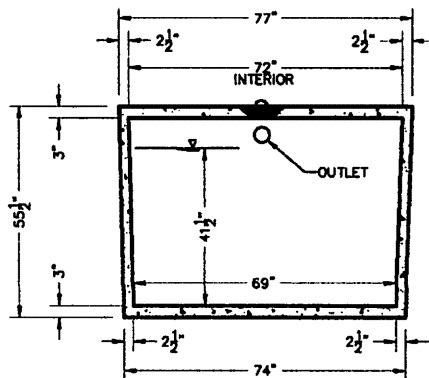

SECTION B-B

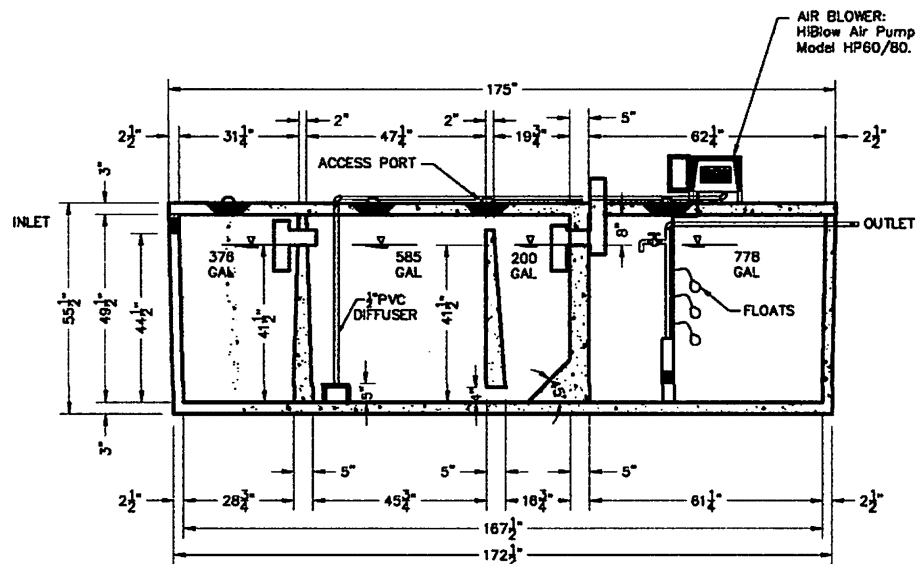

SECTION A-A

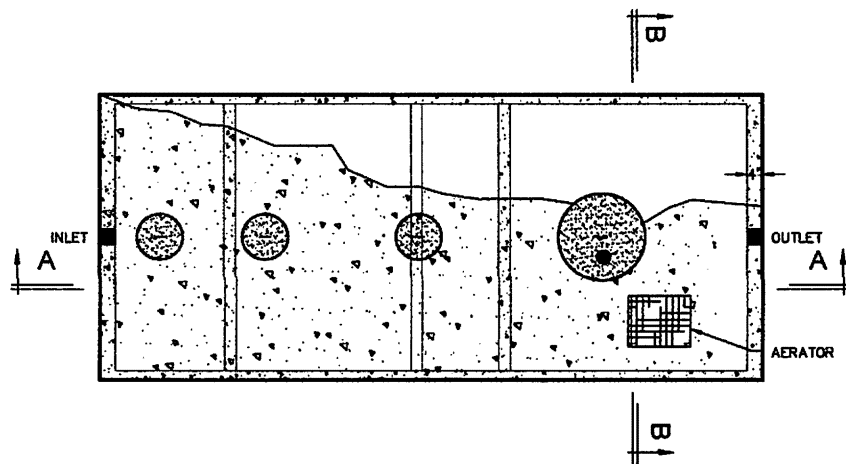

PLAN VIEW

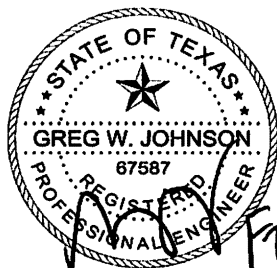

Handwritten: F2505
01/08/25

DATE: DEC 2016	SHEET: SA-3
PROJECT NO:	SCALE: 3/8" = 1'-0"
REVISIONS:	DATE:
BY:	
SOLAR AEROBIC 6754 HWY 80 EAST LAKE CHARLES, LA 70615 PHONE: (337) 439-0680	
MODEL SA 600LP RESIDENTIAL WASTEWATER TREATMENT SYSTEM	
DESIGNED: ESD	CHECKED: ESD
DRAWN: ESD	

TANK NOTES:

Tanks must be set to allow a minimum of 1/8" per foot fall from the residence.

Tightlines to the tank shall be SCH-40 PVC.

A two way sanitary tee is required between residence and tank.

A minimum of 4" of sand, sandy loam, clay loam free of rock shall be placed under and around tanks

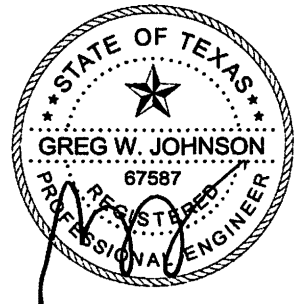
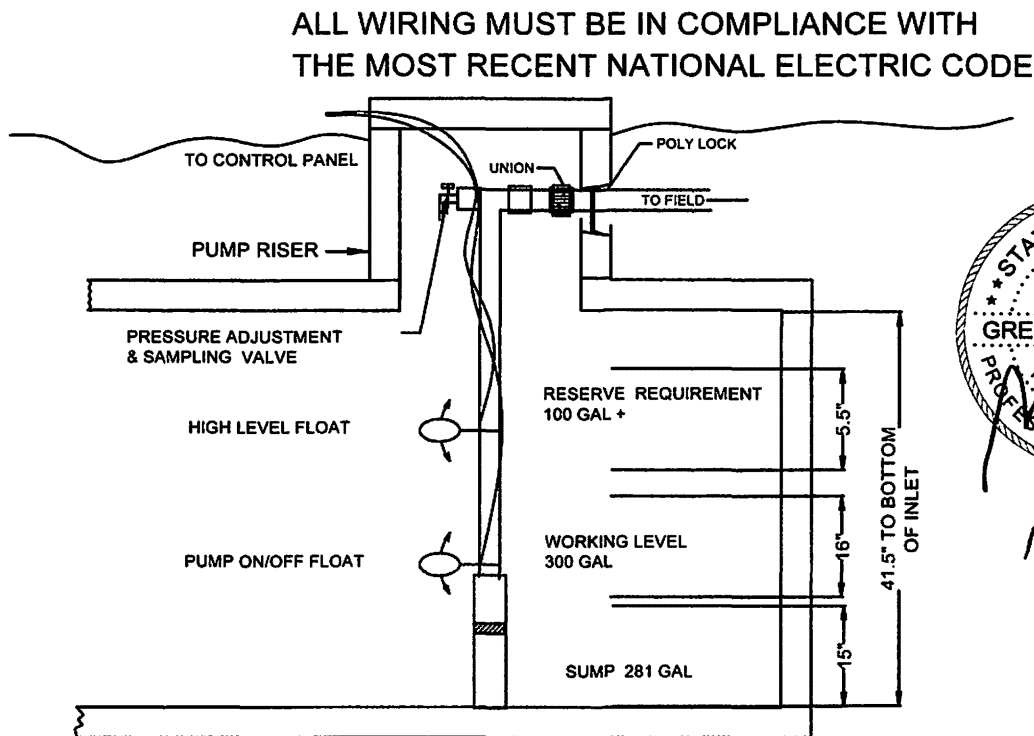

F#2585

1/7/25

TYPICAL PUMP TANK CONFIGURATION SOLAR-AIR SA-600 LP 778 GAL PUMP TANK

Thermoplastic Performance

LOW ANGLE NOZZLE PERFORMANCE CHART

Nozzle	PSI	Radius	GPM
#1	30	22'	1.5
	40	24'	1.7
	50	26'	1.8
	60	28'	2.0
#3	30	29'	3.0
	40	32'	3.1
	50	35'	3.5
	60	37'	3.8
#4	30	31'	3.4
	40	34'	3.9
	50	37'	4.4
	60	38'	4.7
#6	40	38'	6.5
	50	40'	7.3
	60	42'	8.0
	70	44'	8.6

KRAIN
Pro-Plus

*

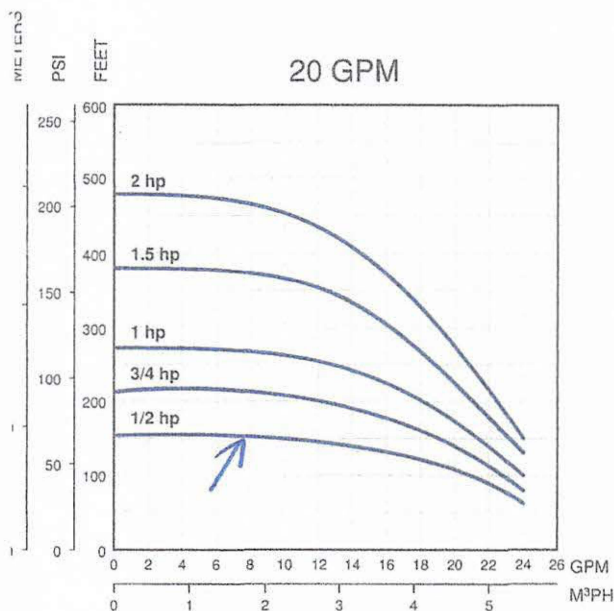

Thermoplastic Units Ordering Information

1/2 - 1.5 HP Single-Phase Units

Order No.	Model	GPM	HP	Volt	Wire	Wt.
94741005	10FE05P4-2W115	10	1/2	115	2	24
94741010	10FE05P4-2W230	10	1/2	230	2	24
94741015	10FE07P4-2W230	10	3/4	230	2	28
94741020	10FE1P4-2W230	10	1	230	2	31
94741025	10FE15P4-2W230	10	1.5	230	2	46
94742005	20FE05P4-2W115	20	1/2	115	2	25
94742010	20FE05P4-2W230	20	1/2	230	2	25
94742015	20FE07P4-2W230	20	3/4	230	2	28
94742020	20FE1P4-2W230	20	1	230	2	31
94742025	20FE15P4-2W230	20	1.5	230	2	40

Thermoplastic 1/2 - 2 HP Pump Ends

Order No.	Model	GPM	HP	Volt	Wire	Wt.
94751005	10FE05P4-PE	10	1/2	N/A	N/A	6
94751010	10FE07P4-PE	10	3/4	N/A	N/A	7
94751015	10FE1P4-PE	10	1	N/A	N/A	8
94751020	10FE15P4-PE	10	1.5	N/A	N/A	12
94752005	20FE05P4-PE	20	1/2	N/A	N/A	6
94752010	20FE07P4-PE	20	3/4	N/A	N/A	7
94752015	20FE1P4-PE	20	1	N/A	N/A	8
94752020	20FE15P4-PE	20	1.5	N/A	N/A	10
94752025	20FE2P4-PE	20	2	N/A	N/A	11



COMAL COUNTY

ENGINEER'S OFFICE

RE: ***5250 Spring Branch Road
Rivermont 3
Lot 43 – Block 12***

Dear Property Owner & Agent,

Thank you for your submission. We have reviewed the planning materials for the referenced permit application, and unfortunately, they are insufficient. To proceed with processing this permit, we require the following:

- ✓ Application page 2 and Soil Report state different utilized sq. ft. of absorption area.
- 2. Revise accordingly and resubmit.

If you have any questions, you can email me or call the office.

Thank You,

| **Brandon Olvera** | **Designated Representative OS0034792** |

| Comal County | www.cceo.org | f: 830-608-2078 | e: olverb@co.comal.tx.us |



COMALCOUNTY
ENGINEER'S OFFICE

ON-SITE SEWAGE FACILITY APPLICATION

RIVERMONT, UNIT 3, BLOCK 12, LOT 42

195 DAVID JONAS DR
NEW BRAUNFELS, TX 78132
(830) 608-2090
WWW.CCEO.ORG

Planning Materials & Site Evaluation as Required Completed By GREG W. JOHNSON, P.E.

System Description PROPRIETARY; AEROBIC TREATMENT AND SURFACE IRRIGATION

Size of Septic System Required Based on Planning Materials & Soil Evaluation

Tank Size(s) (Gallons) SOLAR AIR SA600LP Absorption/Application Area (Sq Ft) 4825

Gallons Per Day (As Per TCEQ Table 111) 300

(Sites generating more than 5000 gallons per day are required to obtain a permit through TCEQ.)

Is the property located over the Edwards Recharge Zone? ☐ Yes ☒ No

(if yes, the planning materials must be completed by a Registered Sanitarian (R.S.) or Professional Engineer (P.E.))

Is there an existing TCEQ approved WPAP for the property? ☐ Yes ☒ No

(if yes, the R.S. or P.E. shall certify that the proposed design complies with all provisions of the existing WPAP.)

Is there at least one additional single-family dwelling per 285.40 sq ft? ☐ Yes ☒ No

If there is no existing WPAP, does the proposed development activity require a TCEQ approved WPAP? ☐ Yes ☒ No

(if yes, the R.S. or P.E. shall certify that the OSSF design will comply with all provisions of the proposed WPAP. A Permit to Construct will not be issued for the proposed OSSF until the UP has been approved by the appropriate regulatory agency.)

Is the property located over the Edwards Contributing Zone? ☒ Yes ☐ No

Is there an existing TCEQ approval CZP for the property? ☐ Yes ☒ No

(if yes, the P.E. or R.S. shall certify that the OSSF design complies with all provisions of the existing CZP.)

If there is no existing CZP, does the proposed development activity require a TCEQ approved CZP? ☐ Yes ☒ No

(if yes, the R.S. or P.E. shall certify that the OSSF design will comply with all provisions of the proposed CZP. A Permit to Construct will not be issued for the proposed OSSF until the UP has been approved by the appropriate regulatory agency.)

Is this property within an incorporated city? ☐ Yes ☒ No

If yes, indicate the city: _____

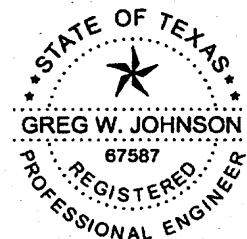

FIRM #2585

By signing this application, I certify that:

- The information provided above is true and correct to the best of my knowledge.
- I affirmatively consent to the online posting/public release of my e-mail address associated with this permit application, as applicable.

[Signature]
Signature of Designer

January 8, 2025
Date

NOTICE OF CONFIDENTIALITY RIGHTS: IF YOU ARE A NATURAL PERSON, YOU MAY REMOVE OR STRIKE ANY OR ALL OF THE FOLLOWING INFORMATION FROM ANY INSTRUMENT THAT TRANSFERS AN INTEREST IN REAL PROPERTY BEFORE IT IS FILED FOR RECORD IN THE PUBLIC RECORDS: YOUR SOCIAL SECURITY NUMBER OR YOUR DRIVER'S LICENSE NUMBER

Warranty Deed with Vendor's Lien

Date: October 11, 2024, but effective as of October 15, 2024

Grantor: Robert Y. Broyles, III and Paulie M. Broyles, a married couple

Grantor's Mailing Address: P.O. Box 464, Spring Branch, TX 78070

Grantee: Talavera Homes, LLC

Grantee's Mailing Address: 8605 Explorer Dr., Suite 250, Colorado Springs, El Paso County, Colorado 80920

Consideration: Ten and no/100 (\$10.00) Dollars and other good and valuable consideration to the undersigned paid by the Grantee herein named, the receipt of which is hereby acknowledged and the further consideration of a Promissory Note of even date herewith in the principal amount of Three Hundred Fifty Eight Thousand Five Hundred and 00/100 Dollars (\$358,500.00) executed by Grantee, payable to the order of All Pro Funding V LLC. The note is secured by a vendor's lien retained in favor of All Pro Funding V LLC to the extent of \$73,000.00 in this deed, and by a deed of trust of even date, from Grantee to Tyler Flynn, Trustee.

All Pro Funding V LLC, at Grantee's request, having paid in cash to Grantor that portion of the purchase price of the property that is evidenced by the note described, the vendor's lien to the extent of \$73,000.00 and superior title to the property are retained for the benefit of All Pro Funding V LLC and are transferred to All Pro Funding V LLC, without recourse on Grantor.

Property (including any improvements): Lot 42, Block 12, RIVERMONT, UNIT NO. 3, situated in Comal County, Texas, according to the map or plat thereof, recorded in Volume 5, Pages 67-70, Map and Plat Records, Comal County, Texas.

Reservations from and Exceptions to Conveyance and Warranty: This conveyance, however, is made and accepted subject to the following matters, to the extent same are in effect at this time: any and all restrictions, covenants, assessments, reservations, outstanding mineral interests held by third parties, conditions, and easements, if any, relating to the hereinabove described property, but only to the extent they are still in effect and shown of record in the hereinabove mentioned County and State or to the extent that they are apparent upon reasonable inspection of the property; and to all zoning laws, regulations and ordinances of municipal and/or other governmental authorities, if any, but only to the extent they are still in effect and relating to the hereinabove described property.

The Contract between Grantor as the Seller and Grantee as the Buyer, if any, may contain limitations as to warranty or other agreed matters; to the extent that the Contract provides for any such limitations or other agreed matters to survive closing and this conveyance, then such limitations or other agreed matters are hereby deemed incorporated by reference. The warranty of title contained in this Deed is hereby expressly excluded from the limitations or other agreed matters referenced in this paragraph.

Grantor, for the Consideration and subject to the Reservations from Conveyance and the Exceptions to Conveyance and Warranty, grants, sells, and conveys to Grantee the Property, together with all and singular the

rights and appurtenances thereto in any way belonging, to have and to hold it to Grantee and Grantee's heirs, successors, and assigns forever. Grantor binds Grantor and Grantor's heirs and successors to warrant and forever defend all and singular the Property to Grantee and Grantee's heirs, successors, and assigns against every person whomsoever lawfully claiming or to claim the same or any part thereof, except as to the Reservations from Conveyance and the Exceptions to Conveyance and Warranty.

When the context requires, singular nouns and pronouns include the plural.

Robert Y. Broyles, III
Robert Y. Broyles, III

Paulie M. Broyles
Paulie M. Broyles

STATE OF TEXAS

COUNTY OF Comal

This instrument was acknowledged before me on this 11 day of October 2024, by Robert Y. Broyles, III and Paulie M. Broyles.

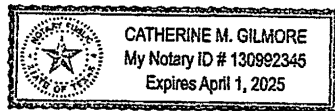

Catherine M. Gilmore
Notary Public, State of Texas

AFTER RECORDING RETURN TO:

Talavera Homes, LLC
8605 Explorer Dr., Suite 250
Colorado Springs, Colorado 80920

Filed and Recorded
Official Public Records
Bobbie Koepp, County Clerk
Comal County, Texas
10/15/2024 01:46:59 PM
LAURA 2 Pages(s)
202406031398

 Bobbie Koepp

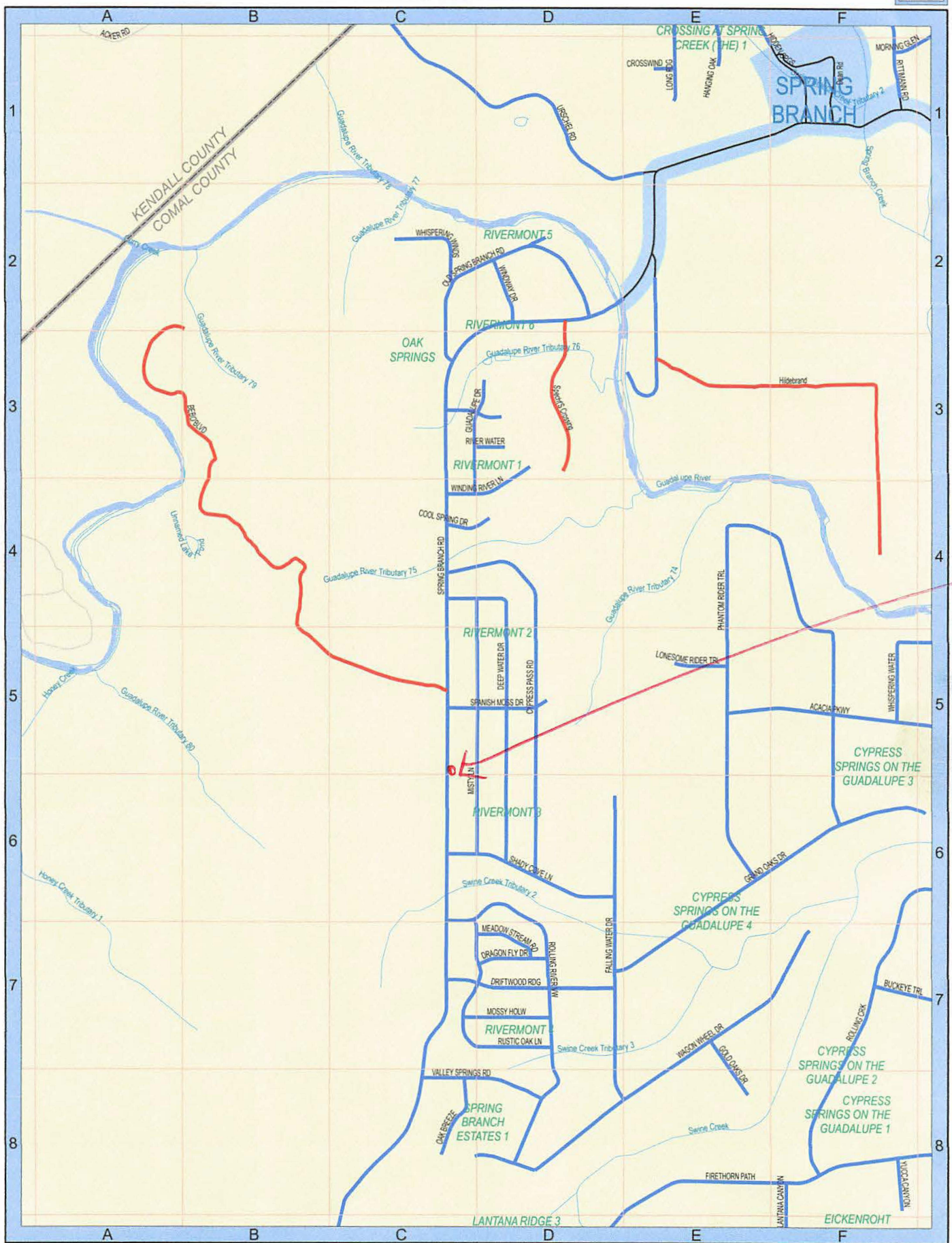

SEE PAGE 26