

Comal County Environmental Health

OSSF Inspection Sheet

Installer Name: _____

OSSF Installer #: _____

1st Inspection Date: _____

2nd Inspection Date: _____

3rd Inspection Date: _____

Inspector Name: _____

Inspector Name: _____

Inspector Name: _____

Permit#:

Address:

No.	Description	Answer	Citations	Notes	1st Insp.	2nd Insp.	3rd Insp.
1	SITE AND SOIL CONDITIONS & SETBACK DISTANCES Site and Soil Conditions Consistent with Submitted Planning Materials		285.31(a) 285.30(b)(1)(A)(iv) 285.30(b)(1)(A)(v) 285.30(b)(1)(A)(iii) 285.30(b)(1)(A)(ii) 285.30(b)(1)(A)(i)				
2	SITE AND SOIL CONDITIONS & SETBACK DISTANCES Setback Distances Meet Minimum Standards		285.91(10) 285.30(b)(4) 285.31(d)				
3	SEWER PIPE Proper Type Pipe from Structure to Disposal System (Cast Iron, Ductile Iron, Sch. 40, SDR 26)		285.32(a)(1)				
4	SEWER PIPE Slope from the Sewer to the Tank at least 1/8 Inch Per Foot		285.32(a)(3)				
5	SEWER PIPE Two Way Sanitary - Type Cleanout Properly Installed (Add. C/O Every 100' &/or 90 degree bends)		285.32(a)(5)				
6	PRETREATMENT Installed (if required) TCEQ Approved List PRETREATMENT Septic Tank(s) Meet Minimum Requirements		285.32(b)(1)(G) 285.32(b)(1)(E)(iii) 285.32(b)(1)(E)(iv) 285.32(b)(1)(F) 285.32(b)(1)(B) 285.32(b)(1)(C)(i) 285.32(b)(1)(C)(ii) 285.32(b)(1)(D) 285.32(b)(1)(E) 285.32(b)(1)(A) 285.32(b)(1)(E)(ii)(II) 285.32(b)(1)(E)(i) 285.32(b)(1)(E)(ii)(I)				
7	PRETREATMENT Grease Interceptors if required for commercial		285.34(d)				

Inspector Notes:

**Comal County Environmental Health
OSSF Inspection Sheet**

No.	Description	Answer	Citations	Notes	1st Insp.	2nd Insp.	3rd Insp.
8	SEPTIC TANK Tank(s) Clearly Marked SEPTIC TANK If Single Tank, 2 Compartments Provided with Baffle SEPTIC TANK Inlet Flowline Greater than 3" and " T " Provided on Inlet and Outlet SEPTIC TANK Septic Tank(s) Meet Minimum Requirements		285.32(b)(1) (E) 285.91(2) 285.32(b)(1) (F) 285.32(b)(1)(E) (iii) 285.32(b)(1)(E)(ii) (II) 285.32(b)(1)(E)(ii) (I) 285.32(b)(1)(E) (i) 285.32(b)(1) (D) 285.32(b)(1)(C) (ii) 285.32(b)(1)(C) (i) 285.32(b)(1) (B) 285.32(b)(1) (A) 285.32(b)(1)(E)(iv)				
9	ALL TANKS Installed on 4" Sand Cushion/ Proper Backfill Used		285.32(b)(1)(F) 285.32(b)(1)(G) 285.34(b)				
10	SEPTIC TANK Inspection / Clean Out Port & Risers Provided on Tanks Buried Greater than 12" Sealed and Capped		285.38(d)				
11	SEPTIC TANK Secondary restraint system provided SEPTIC TANK Riser permanently fastened to lid or cast into tank SEPTIC TANK Riser cap protected against unauthorized intrusions		285.38(d) 285.38(e)				
12	SEPTIC TANK Tank Volume Installed						
13	PUMP TANK Volume Installed						
14	AEROBIC TREATMENT UNIT Size Installed						
15	AEROBIC TREATMENT UNIT Manufacturer AEROBIC TREATMENT UNIT Model Number						
16	DISPOSAL SYSTEM Absorptive		285.33(a)(4) 285.33(a)(1) 285.33(a)(2) 285.33(a)(3)				
17	DISPOSAL SYSTEM Leaching Chamber		285.33(a)(1) 285.33(a)(3) 285.33(a)(4) 285.33(a)(2)				
18	DISPOSAL SYSTEM Evapo-transpirative		285.33(a)(3) 285.33(a)(4) 285.33(a)(1) 285.33(a)(2)				

**Comal County Environmental Health
OSSF Inspection Sheet**

No.	Description	Answer	Citations	Notes	1st Insp.	2nd Insp.	3rd Insp.
19	DISPOSAL SYSTEM Drip Irrigation		285.33(c)(3)(A)-(F)				
20	DISPOSAL SYSTEM Soil Substitution		285.33(d)(4)				
21	DISPOSAL SYSTEM Pumped Effluent		285.33(a)(4) 285.33(a)(3) 285.33(a)(1) 285.33(a)(2)				
22	DISPOSAL SYSTEM Gravelless Pipe		285.33(a)(3) 285.33(a)(2) 285.33(a)(4) 285.33(a)(1)				
23	DISPOSAL SYSTEM Mound		285.33(a)(3) 285.33(a)(1) 285.33(a)(2) 285.33(a)(4)				
24	DISPOSAL SYSTEM Other (describe) (Approved Design)		285.33(d)(6) 285.33(c)(4)				
25	DRAINFIELD Absorptive Drainline 3" PVC or 4" PVC						
26	DRAINFIELD Area Installed						
27	DRAINFIELD Level to within 1 inch per 25 feet and within 3 inches over entire excavation		285.33(b)(1)(A)(v)				
28	DRAINFIELD Excavation Width DRAINFIELD Excavation Depth DRAINFIELD Excavation Separation DRAINFIELD Depth of Porous Media DRAINFIELD Type of Porous Media						
29	DRAINFIELD Pipe and Gravel - Geotextile Fabric in Place		285.33(b)(1)(E)				
30	DRAINFIELD Leaching Chambers DRAINFIELD Chambers - Open End Plates w/Splash Plate, Inspection Port & Closed End Plates in Place (per manufacturers spec.)		285.33(c)(2)				
31	LOW PRESSURE DISPOSAL SYSTEM Adequate Trench Length & Width, and Adequate Separation Distance between Trenches		285.33(d)(1)(C)(i)				

**Comal County Environmental Health
OSSF Inspection Sheet**

No.	Description	Answer	Citations	Notes	1st Insp.	2nd Insp.	3rd Insp.
32	EFFLUENT DISPOSAL SYSTEM Utilized Only by Single Family Dwelling EFFLUENT DISPOSAL SYSTEM Topographic Slopes < 2.0% EFFLUENT DISPOSAL SYSTEM Adequate Length of Drain Field (1000 Linear ft. for 2 bedrooms or Less & an additional 400 ft. for each additional bedroom) EFFLUENT DISPOSAL SYSTEM Lateral Depth of 18 inches to 3 ft. & Vertical Separation of 1ft on bottom and 2 ft. to restrictive horizon and ground water respectfully EFFLUENT DISPOSAL SYSTEM Lateral Drain Pipe (1.25 - 1.5" dia.) & Pipe Holes (3/16 - 1/4" dia. Hole Size) 5 ft. Apart		285.33(b)(3)(A) 285.33(b)(3)(A) 285.33(b)(3)(B)285.91(13) 285.33(b)(3)(D) 285.33(b)(3)(F)				
33	AEROBIC TREATMENT UNIT Is Aerobic Unit Installed According to Approved Guidelines.		285.32(c)(1)				
34	AEROBIC TREATMENT UNIT Inspection/Clean Out Port & Risers Provided AEROBIC TREATMENT UNIT Secondary restraint system provided AEROBIC TREATMENT UNIT Riser permanently fastened to lid or cast into tank AEROBIC TREATMENT UNIT Riser cap protected against unauthorized intrusions						
35	AEROBIC TREATMENT UNIT Chlorinator Properly Installed with Chlorine Tablets in Place.						
36	PUMP TANK Is the Pump Tank an approved concrete tank or other acceptable materials & construction PUMP TANK Sampling Port Provided in the Treated Effluent Line PUMP TANK Check Valve and/or Anti- Siphon Device Present When Required PUMP TANK Audible and Visual High Water Alarm Installed on Separate Circuit From Pump						
37	PUMP TANK Inspection/Clean Out Port & Risers Provided PUMP TANK Secondary restraint system provided PUMP TANK Riser permanently fastened to lid or cast into tank PUMP TANK Riser cap protected against unauthorized intrusions						
38	PUMP TANK Secondary restraint system provided						
39	PUMP TANK Electrical Connections in Approved Junction Boxes / Wiring Buried						

**Comal County Environmental Health
OSSF Inspection Sheet**

No.	Description	Answer	Citations	Notes	1st Insp.	2nd Insp.	3rd Insp.
40	APPLICATION AREA Distribution Pipe, Fitting, Sprinkler Heads & Valve Covers Color Coded Purple?		285.33(d)(2)(G)(iii)(II) 285.33(d)(2)(G)(iii)(III) 285.33(d)(2)(G)(v) 285.33(d)(2)(G)(iii) 285.33(d)(2)(G)(iv) 285.33(d)(2)(G)(i) 285.33(d)(2)(G)(ii) 285.33(d)(2)(G)(iii)(I)				
41	APPLICATION AREA Low Angle Nozzles Used / Pressure is as required APPLICATION AREA Acceptable Area, nothing within 10 ft of sprinkler heads? APPLICATION AREA The Landscape Plan is as Designed		285.33(d)(2)(G) (i)285.33(d)(2) (A)285.33(d)(2)(F)				
42	APPLICATION AREA Area Installed						
43	PUMP TANK Meets Minimum Reserve Capacity Requirements						
44	PUMP TANK Material Type & Manufacturer						
45	PUMP TANK Type/Size of Pump Installed						



COMAL COUNTY

ENGINEER'S OFFICE

Permit of Authorization to Construct an On-Site Sewage Facility Permit Valid For One Year From Date Issued

Permit Number: 118431
Issued This Date: 03/25/2025
This permit is hereby given to: DEBORAH WEAVER BARE & GREGORY GENE BARE

To start construction of a private, on-site sewage facility located at:

1834 PARADISE PKWY
CANYON LAKE, TX 78133

Subdivision: PARADISE ON THE GUADALUPE
Unit: 2
Lot: 72
Block: 0
Acreage: 1.0900

APPROVED MINIMUM SIZES AS PER ATTACHED DESIGN

Type of System: Aerobic
Surface Irrigation

This permit gives permission for the construction of the above referenced on-site facility to commence. Installation must be completed by an installer holding a valid registration card from the Texas Commission on Environmental Quality (TCEQ). Installation and inspection must comply with current TCEQ and Comal County requirements.

Call (830) 608-2090 to schedule inspections.



COMAL COUNTY
ENGINEER'S OFFICE

ON-SITE SEWAGE FACILITY APPLICATION

195 DAVID JONAS DR
NEW BRAUNFELS, TX 78132
(830) 608-2090
WWW.CCFCORP.COM

Date February 7, 2025

Permit Number 118431

1. APPLICANT / AGENT INFORMATION

Owner Name **DEBORAH WEAVER BARE & GREGORY
GENE BARE**

Agent Name _____ **GREG JOHNSON, P.E.**

Mailing Address c/o 4407 SOUTH IH-35 #203

Agent Address 170 HOLLOW OAK

City, State, Zip **GEORGETOWN, TEXAS 78626**

City, State, Zip NEW BRAUNFELS TEXAS 78132

Phone # 512-717-3271

Phone # 830-905-2778

Email karab@grandendeavorhomes.com

Email gregjohnsonpe@yahoo.com

2. LOCATION

Subdivision Name PARADISE ON THE GUADALUPE Unit 2 Lot 72 Block

Survey Name / Abstract Number	Acreage
--------------------------------------	----------------

Address 1834 PARADISE PARKWAY City CANYON LAKE State TX Zip 78133

3. TYPE OF DEVELOPMENT

☒ **Single Family Residential**

Type of Construction (House, Mobile, RV, Etc.) HOUSE

Number of Bedrooms 4

Indicate Sq Ft of Living Area 2672

☐ **Non-Single Family Residential**

(Planning materials must show adequate land area for doubling the required land needed for treatment units and disposal area)

Type of Facility _____

Offices, Factories, Churches, Schools, Parks, Etc. - Indicate Number Of Occupants**Restaurants, Lounges, Theaters - Indicate Number of Seats****Hotel, Motel, Hospital, Nursing Home - Indicate Number of Beds****Travel Trailer/RV Parks - Indicate Number of Spaces**

Miscellaneous

Estimated Cost of Construction: \$ 520,000 (Structure Only)

Is any portion of the proposed OSSF located in the United States Army Corps of Engineers (USACE) flowage easement?

☐ Yes ☒ No (If yes, owner must provide approval from USACE for proposed OSSF improvements within the USACE flowage easement)

Source of Water ☒ Public ☐ Private Well ☐ Rainwater Collection

4. SIGNATURE OF OWNER

By signing this application, I certify that:

- The completed application and all additional information submitted does not contain any false information and does not conceal any material facts. I certify that I am the property owner or I possess the appropriate land rights necessary to make the permitted improvements on said property.
- Authorization is hereby given to the permitting authority and designated agents to enter upon the above described property for the purpose of site/soil evaluation and inspection of private sewage facilities..
- I understand that a permit of authorization to construct will not be issued until the Floodplain Administrator has performed the reviews required by the Comal County Flood Damage Prevention Order.
- I affirmatively consent to the online posting/public release of my e-mail address associated with this permit application, as applicable.

Gregory James Burt
Signature of Owner

Signature of Owner

Date 2/13/2025

Date _____

Signature of Owner Deborah Weaver Bae



COMALCOUNTY
ENGINEER'S OFFICE

ON-SITE SEWAGE FACILITY APPLICATION

PARADISE ON THE GUADALUPE, UNIT 2, LOT 72

195 DAVID JONAS DR
NEW BRAUNFELS, TX 78132
(830) 608-2090
WWW.CCEO.ORG

Planning Materials & Site Evaluation as Required Completed By GREG W. JOHNSON, P.E.

System Description PROPRIETARY; AEROBIC TREATMENT AND SURFACE IRRIGATION

Size of Septic System Required Based on Planning Materials & Soil Evaluation

Tank Size(s) (Gallons) SOLAR AIR SA600LP Absorption/Application Area (Sq Ft) 4825

Gallons Per Day (As Per TCEQ Table 111) 300

(Sites generating more than 5000 gallons per day are required to obtain a permit through TCEQ.)

Is the property located over the Edwards Recharge Zone? ☐ Yes ☒ No

(if yes, the planning materials must be completed by a Registered Sanitarian (R.S.) or Professional Engineer (P.E.))

Is there an existing TCEQ approved WPAP for the property? ☐ Yes ☒ No

(if yes, the R.S. or P.E. shall certify that the OSSF design complies with all provisions of the existing WPAP.)

Is there at least one acre per single family dwelling as per 285.40(c)(1)? ☒ Yes ☐ No

If there is no existing WPAP, does the proposed development activity require a TCEQ approved WPAP? ☐ Yes ☒ No

(if yes, the R.S or P.E. shall certify that the OSSF design will comply with all-provisions of the proposed WPAP. A Permit to Construct will not be issued for the proposed OSSF until the proposed WPAP has been approved by the appropriate regional office.)

Is the property located over the Edwards Contributing Zone? ☒ Yes ☐ No

Is there an existing TCEQ approval CZP for the property? ☒ Yes ☐ No

(if yes, the P.E. or R.S. shall certify that the OSSF design complies with all provisions of the existing CZP.)

If there is no existing CZP, does the proposed development activity require a TCEQ approved CZP? ☐ Yes ☒ No

(if yes, the R.S. or P.E. shall certify that the OSSF design will comply with all provisions of the proposed CZP. A Permit to Construct will not be issued for the proposed OSSF until the UP has been approved by the appropriate reg

Is this property within an incorporated city? ☐ Yes ☒ No

If yes, indicate the city: _____

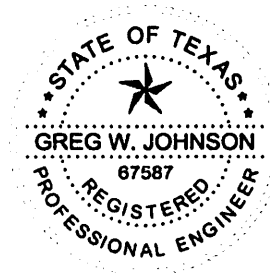

FIRM #2585

By signing this application, I certify that:

- The information provided above is true and correct to the best of my knowledge.

- I affirmatively consent to the online posting/public release of my e-mail address associated with this permit application, as applicable.

[Signature]
Signature of Designer

February 11, 2025
Date

AFFIDAVIT**THE COUNTY OF COMAL
STATE OF TEXAS****CERTIFICATION OF OSSF REQUIRING MAINTENANCE**

According to Texas Commission on Environmental Quality Rules for On-Site Sewage Facilities (OSSF's), this document is filed in the Deed Records of Comal County, Texas.

I

The Texas Health and Safety Code, Chapter 366 authorizes the Texas Commission on Environmental Quality (TCEQ) to regulate on-site sewage facilities (OSSFs). Additionally, the Texas Water Code (TWC), § 5.012 and § 5.013, gives the commission primary responsibility for implementing the laws of the State of Texas relating to water and adopting rules necessary to carry out its powers and duties under the TWC. The commission, under the authority of the TWC and the Texas Health and Safety code, requires owner's to provide notice to the public that certain types of OSSFs are located on specific pieces of property. To achieve this notice, the commission requires a recorded affidavit. Additionally, the owner must provide proof of the recording to the OSSF permitting authority. This recorded affidavit is not a representation or warranty by the commission of the suitability of this OSSF, nor does it constitute any guarantee by the commission that the appropriate OSSF was installed.

II

An OSSF requiring a maintenance contract, according to 30 Texas Administrative Code §285.91(12) will be installed on the property described as (insert legal description):

2 UNIT/PHASE/SECTION BLOCK 72 LOT PARADISE ON THE GUADALUPE SUBDIVISION

IF NOT IN SUBDIVISION: ACREAGE SURVEY

The property is owned by (insert owner's full name): DEBORAH WEAVER BARE & GREGORY GENE BARE

This OSSF must be covered by a continuous maintenance contract for the first two years. After the initial two-year service policy, the owner of an aerobic treatment system for a single family residence shall either obtain a maintenance contract within 30 days or maintain the system personally.

Upon sale or transfer of the above-described property, the permit for the OSSF shall be transferred to the buyer or new owner. A copy of the planning materials for the OSSF can be obtained from the Comal County Engineer's Office.

WITNESS BY HAND(S) ON THIS 13 DAY OF February, 2025

Deborah Weaver Bare

DEBORAH WEAVER BARE

Gregory Gene Bare

GREGORY GENE BARE

Owner(s) signature(s)

Owner (s) Printed name (s)

DEBORAH W. & GREGORY G. BARE SWORN TO AND SUBSCRIBED BEFORE ME ON THIS 13 DAY OF

February, 2025

[Signature]
Notary Public Signature

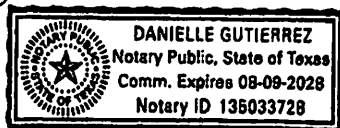

Filed and Recorded
Official Public Records
Bobbie Koepp, County Clerk
Comal County, Texas
02/27/2025 08:44:29 AM
TERRI 1 Pages(s)
202506005451



Bobbie Koepp

Countryside Construction, Inc.
300 Chapman Parkway, Canyon Lake, TX. 78133
Phone: 830-899-2615 or 1-888-379-3721 Fax: 830-899-6662
Septic System Service Agreement

In consideration of payment for this service contract, we will abide by and agree to its terms and conditions:

Name: DEBORAH W. & GREGORY G. BARE Address: 1834 PARADISE PARKWAY
Sub-Div./County: PARADISE ON THE GUADALUPE / COMAL City, State, Zip Code CANYON LAKE, TX 78133
Permit #: _____ TYPE, Model# & SIZE: SOLAR AIR SA600LP Serial #: _____
Phone: _____

(X) Initial Two Year Service & Two Year Limited Warranty

Legal Description: LOT 72, PARADISE ON THE GUADALUPE, UNIT 2, COMAL COUNTY

The effective date of the initial maintenance contract shall be the date the License to Operate is issued.

This contract will be in effect FROM: LTO TO: _____

Countryside Construction, Inc. will provide the following:

- An inspection every (4) four months which will include: Servicing of the mechanical & electrical components as necessary to insure system is functioning as engineer designed, pulling and cleaning the Norweco Brand aerator shaft, cleaning compressor air filters of other brands, check chlorine, conduct solids test to determine if system should be pumped, back flushing tubing for drip irrigation fields and checking sprinklers on above ground systems.
- 1) The property owner is responsible for "purchasing and keeping chlorine" in the chlorinator, (if applicable). If the chlorine test reveals "No Chlorine" in the system, the property owner may incur an additional cost.
- 2) If any improper operation is observed (which cannot be corrected at that time) the property owner will be notified immediately of the conditions and the estimated cost.
- 3) ANY PARTS, WARRANTY OR NON-WARRANTY, FREIGHT CHARGES, LABOR OR SERVICE CALLS NOT PAID IN FULL AT THE END OF (30) DAYS SHALL REMAIN THE PROPERTY OF COUNTRYSIDE CONSTRUCTION AND AUTHORIZES CONTRACTOR TO REMOVE AND REPOSSESS ANY PARTS INSTALLED. CLIENT FURTHER AGREES TO PAY ANY LABOR COST OF THE INSTALLATION AND REASONABLE COST OF REMOVAL OF SAID PARTS.
- 4) THE SIGNING OF THIS SERVICE AGREEMENT AUTHORIZES COUNTRYSIDE CONSTRUCTION TO ENTER THE PROPERTY TO EXECUTE ALL TERMS OF THIS CONTRACT.

Countryside Construction, Inc., will warranty installation of the septic system to be according to state and county regulations and the designs approved by the county. **HOMEOWNER WILL BE RESPONSIBLE FOR SERVICE CALLS, LABOR AND SHIPPING COSTS ON ANY "WARRANTIED PARTS" EXCHANGED DURING WARRANTY.** All other components will be according to manufacturer's warranties.

Important: As Countryside Construction, Inc. cannot control what or how much effluent goes into this septic system, we cannot warranty how the system will function. Refer to manufacturers or installer's instructions, for suggestions on septic operation. If necessary, between inspections, it is the property owner's responsibility to clean the micron filters on drip irrigation systems. This service agreement does not cover the cost of "service calls, labor or materials that are required or parts out of warranty, the failure to maintain electrical power to the system, sprinklers that are broken, leaking, stopped-up or otherwise mal-functioning; or sewage flows exceeding the hydraulic/organic design capabilities and the input of non-biodegradable materials (solvents, grease, oil, paints, etc.), or any usage contrary to the requirements as advised by authorized service representative. Laboratory test work is available at an additional cost. Chlorine, filters, or parts that are out of warranty are available at a reasonable cost.

This contract does not include the pumping of a tank or of any compartment of a tank, or settlement of soil on or around any part of the system regardless of reason:

Violations of the warranty also include: disconnecting the alarm, restricting ventilation to the aerator, overloading the system above its rated capacity; or flooding by external means. Rodent, insect or fire ant damage or any other form of unusual abuse is a violation. A renewal service contract should be "activated" (30) thirty days before expiration of existing contract. We will contact property owner prior to expiration of existing contract.

Serviced by: Countryside Construction Inc.

Walker Chapman – Installer's Licensee #OS0002929-OSSF

Maintenance Provider Licensee #MP0000035

(X) Deborah Bare Print Name (X) Gregory Bare Date: 2-13-2025
Property Owner Signature

(X) Walker Chapman Date: 2-13-2025 Authorized Service Representative (revised 08/13/2020)

Greg W. Johnson, P.E.
170 Hollow Oak
New Braunfels, Texas 78132
830/905-2778

February 11, 2025

Comal County Office of Environmental Health
195 David Jonas Drive
New Braunfels, Texas 78132-3760

RE- SEPTIC DESIGN
1834 PARADISE PARKWAY
PARADISE ON THE GUADALUPE, UNIT 2, LOT 72
CANYON LAKE, TX 78133
BARE RESIDENCE

Brandon/Brenda,

The referenced property is located within the Edwards Aquifer Contributing Zone. This OSSF design will comply with requirements in the CZP.

Temporary erosion and sedimentation controls should be utilized as necessary prior to construction. If any sensitive feature (caves, solution cavities, sink holes, etc.) is discovered during construction, activities must be suspended immediately and the applicant or his agent must immediately notify the TCEQ Regional Office. After that operations can only proceed after the Executive Director approves required additional engineered impact plans.

Designed in accordance with Chapter 285, Subchapter D, §285.40, 285.41, & 285.42, Texas Commission on Environmental Quality (Effective December 29, 2016).

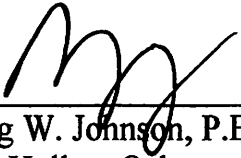
 02/11/25

Greg W. Johnson, P.E. No. 67587 / F#2585
170 Hollow Oak
New Braunfels, Texas 78132 - 830/905-2778

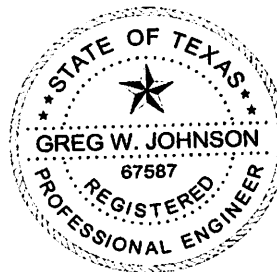

ON-SITE SEWERAGE FACILITY SOIL EVALUATION REPORT INFORMATION

Date Soil Survey Performed: February 10, 2025

Site Location: PARADISE on the GUADALUPE, UNIT 2, LOT 72

Proposed Excavation Depth: N/A

Requirements:

At least two soil excavations must be performed on the site, at opposite ends of the proposed disposal area.
Locations of soil boring or dug pits must be shown on the site drawing.
For subsurface disposal, soil evaluations must be performed to a depth of at least two feet below the proposed excavation depth. For surface disposal, the surface horizon must be evaluated.
Describe each soil horizon and identify any restrictive features on the form. Indicate depths where features appear.

SOIL BORING NUMBER <u> </u> SURFACE EVALUATION						
Depth (Feet)	Texture Class	Soil Texture	Gravel Analysis	Drainage (Mottles/ Water Table)	Restrictive Horizon	Observations
0	III	CLAY LOAM	N/A	NONE OBSERVED	LIMESTONE @ 8"	BROWN
1						
2						
3						
4						
5						

SOIL BORING NUMBER <u> </u> SURFACE EVALUATION						
Depth (Feet)	Texture Class	Soil Texture	Gravel Analysis	Drainage (Mottles/ Water Table)	Restrictive Horizon	Observations
0	SAME		AS		ABOVE	
1						
2						
3						
4						
5						

I certify that the findings of this report are based on my field observations and are accurate to the best of my ability.

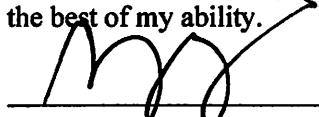
Greg W. Johnson, P.E. 67587-F2585, S.E. 11561

02/10/25
Date

OSSE SOIL EVALUATION REPORT INFORMATION

Date: February 11, 2025

Applicant Information:

DEBORAH WEAVER & GREGORY GENE

Name: BARE
Address: c/o 4407 SOUTH IH-35 #203
City: GEORGETOWN State: TEXAS
Zip Code: 78626 Phone: (512) 717-3271

Site Evaluator Information:

Name: Greg W. Johnson, P.E., R.S., S.E. 11561
Address: 170 Hollow Oak
City: New Braunfels State: Texas
Zip Code: 78132 Phone & Fax (830)905-2778

Property Location:

Lot 72 Unit 2 Blk Subd. PARADISE on the GUADALUPE
Street Address: 1834 PARADISE PARKWAY
City: CANYON LAKE Zip Code: 78133
Additional Info.: _____

Installer Information:

Name: _____
Company: _____
Address: _____
City: _____ State: _____
Zip Code: _____ Phone _____

Topography: Slope within proposed disposal area: 4 to 15 %

Presence of 100 yr. Flood Zone: YES _____ NO X
Existing or proposed water well in nearby area. YES _____ NO X
Presence of adjacent ponds, streams, water impoundments YES _____ NO X
Presence of upper water shed YES _____ NO X
Organized sewage service available to lot YES _____ NO X

Design Calculations for Aerobic Treatment with Spray Irrigation:

Commercial

Q = _____ GPD

Residential Water conserving fixtures to be utilized? Yes X No _____

Number of Bedrooms the septic system is sized for: 4 Total sq. ft. living area 2672

Q gal/day = (Bedrooms +1) * 75 GPD - (20% reduction for water conserving fixtures)

Q = (4 +1)*75-(20%)= 300

Trash Tank Size 376 Gal.

TCEQ Approved Aerobic Plant Size 600 G.P.D.

Req'd Application Area = Q/Ri = 300 / 0.064 = 4688 sq. ft.

Application Area Utilized = 4825 sq. ft.

Pump Requirement 12 Gpm @ 41 Psi (Redjacket 0.5 HP 18 G.P.M. series or equivalent)

Dosing Cycle: _____ ON DEMAND or X TIMED TO DOSE IN PREDAWN HOURS

Pump Tank Size = 778 Gal. 18.75 Gal/inch.

Reserve Requirement = 100 Gal. 1/3 day flow.

Alarms: Audible & Visual High Water Alarm & Visual Air Pump malfunction

With Chlorinator NSF/TCEQ APPROVED

SCH-40 or SDR-26 3" or 4" sewer line to tank

Two way cleanout

Pop-up rotary sprinkler heads w/ purple non-potable lids

1" Sch-40 PVC discharge manifold

APPLICATION AREA SHOULD BE SEEDED AND MAINTAINED WITH VEGETATION.

EXPOSED ROCK WILL BE COVERED WITH SOIL .

I HAVE PERFORMED A THOROUGH INVESTIGATION BEING A REGISTERED PROFESSIONAL ENGINEER AND SITE EVALUATOR IN ACCORDANCE WITH CHAPTER 285, SUBCHAPTER D, §285.30, & §285.40 (REGARDING RECHARGE FEATURES), TEXAS COMMISSION OF ENVIRONMENTAL QUALITY (EFFECTIVE DECEMBER 29, 2016)

GREG W. JOHNSON, P.E. F#002585 - S.E. 11561

02/11/25
DATE



FIRM #2585

PARADISE PARKWAY

#118431

REVISED

9:46 am, Apr 30, 2025

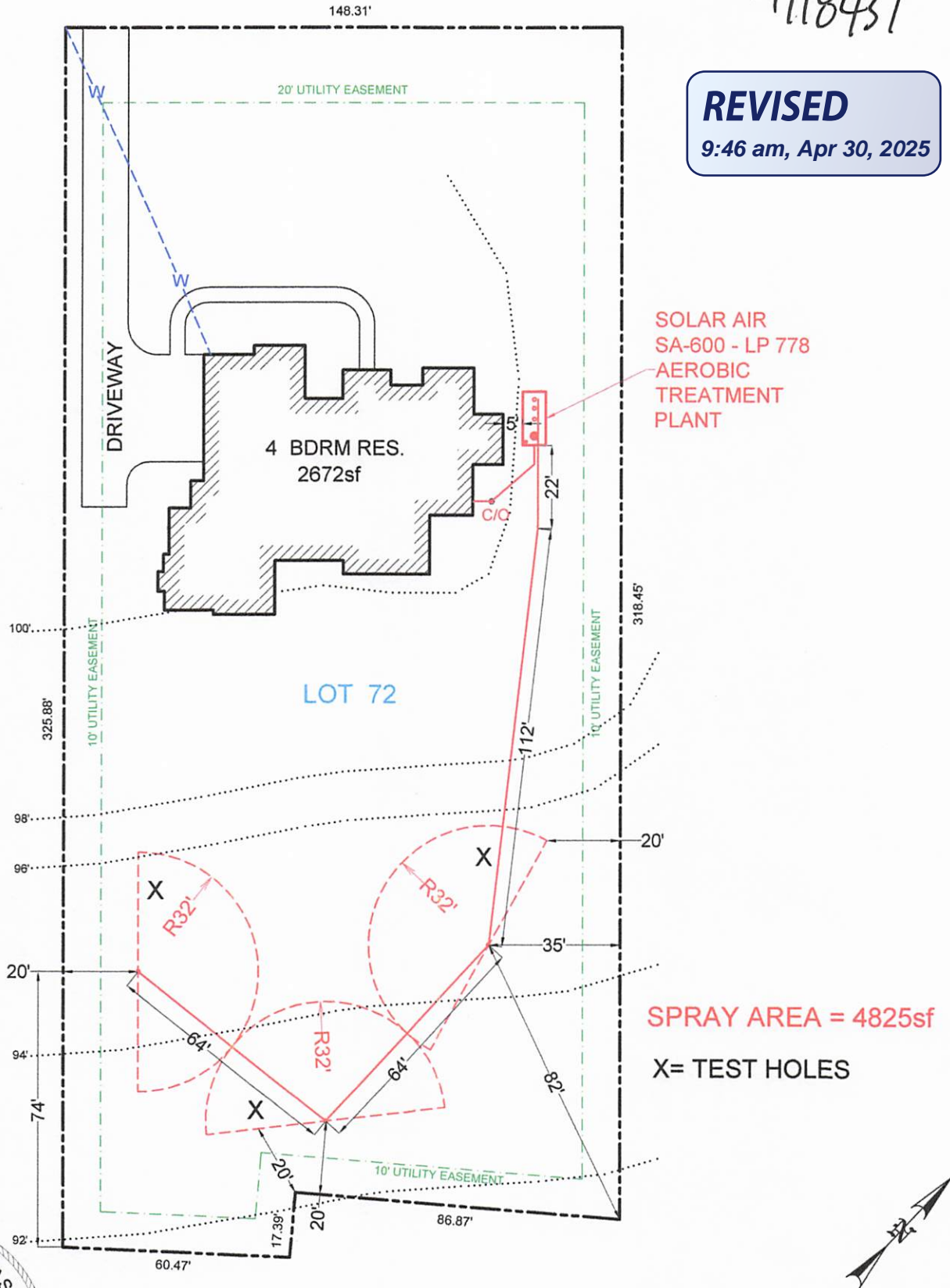

SPRAY AREA = 4825sf

X= TEST HOLES



OWNER: DEBORAH WEAVER & GREGORY GENE BARE				DRAWN BY: EJS III	
STREET ADDRESS: 1834 PARADISE PARKWAY					
LEGAL DESC: PARADISE on the GUADALUPE			UNIT/SECTION/PHASE: 2	BLOCK:	LOT: 72
PREPARED BY: GREG W. JOHNSON, P.E. F#002585		SCALE: 1"=40'	DATE: 2/11/2025	REVISED: 4/29/2025	



PROFESSIONAL ENGINEER
F2588
02/11/25

DESIGNER: ENG	MODEL SA 600LP	SOLAR AEROBIC	PROJECT NO	DATE
DRAWN: ENG	RESIDENTIAL WASTEWATER	6754 HWY 90 EAST		DEC-2010
CHECKED: ENG	TREATMENT SYSTEM	LAKE CHARLES, LA 70615		SHEET:
		PHONE: (337) 439-0680	SCALE:	SA-3
			DATE: 10/1/10	

TANK NOTES:

Tanks must be set to allow a minimum of 1/8" per foot fall from the residence.

Tightlines to the tank shall be SCH-40 PVC.

A two way sanitary tee is required between residence and tank.

A minimum of 4" of sand, sandy loam, clay loam free of rock shall be placed under and around tanks

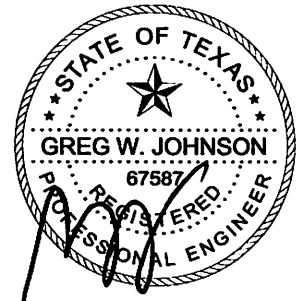
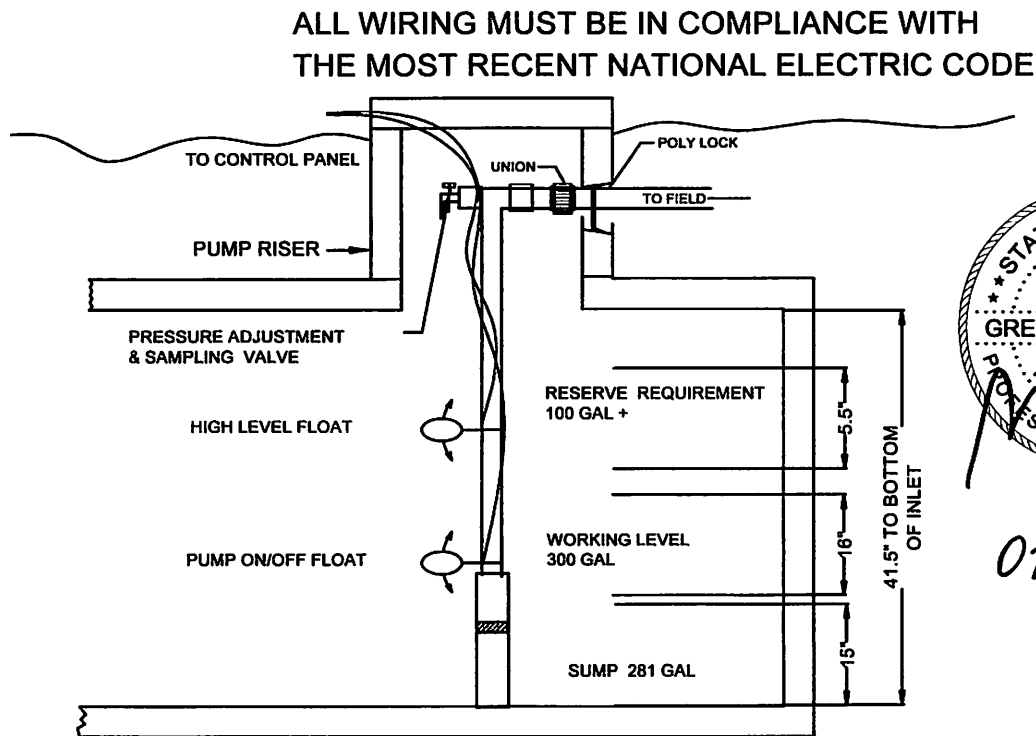

F#2585

02/11/25

TYPICAL PUMP TANK CONFIGURATION SOLAR-AIR SA-600 LP 778 GAL PUMP TANK

Environmental Series Pumps

Thermoplastic Performance

LOW ANGLE NOZZLE PERFORMANCE CHART

Nozzle	PSI	Radius	GPM
#1	30	22'	1.5
	40	24'	1.7
	50	26'	1.8
	60	28'	2.0
#3	30	29'	3.0
	40	32'	3.1
	50	35'	3.5
	60	37'	3.8
#4	30	31'	3.4
	40	34'	3.9
	50	37'	4.4
	60	38'	4.7
#6	40	38'	6.5
	50	40'	7.3
	60	42'	8.0
	70	44'	8.6

KRAIN
Pro-Plus

X

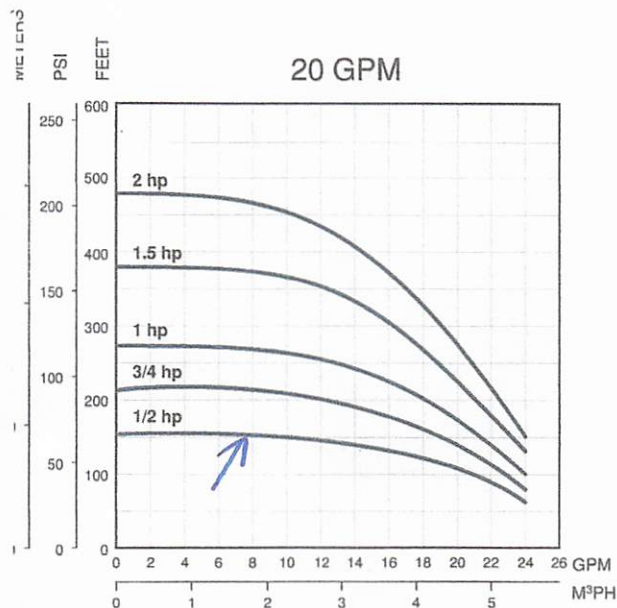

Thermoplastic Units Ordering Information

1/2 - 1.5 HP Single-Phase Units

Order No.	Model	GPM	HP	Volt	Wire	Wt.
94741005	10FE05P4-2W115	10	1/2	115	2	24
94741010	10FE05P4-2W230	10	1/2	230	2	24
94741015	10FE07P4-2W230	10	3/4	230	2	28
94741020	10FE1P4-2W230	10	1	230	2	31
94741025	10FE15P4-2W230	10	1.5	230	2	46
94742005	20FE05P4-2W115	20	1/2	115	2	25
94742010	20FE05P4-2W230	20	1/2	230	2	25
94742015	20FE07P4-2W230	20	3/4	230	2	28
94742020	20FE1P4-2W230	20	1	230	2	31
94742025	20FE15P4-2W230	20	1.5	230	2	40

Thermoplastic 1/2 - 2 HP Pump Ends

Order No.	Model	GPM	HP	Volt	Wire	Wt.
94751005	10FE05P4-PE	10	1/2	N/A	N/A	6
94751010	10FE07P4-PE	10	3/4	N/A	N/A	7
94751015	10FE1P4-PE	10	1	N/A	N/A	8
94751020	10FE15P4-PE	10	1.5	N/A	N/A	12
94752005	20FE05P4-PE	20	1/2	N/A	N/A	6
94752010	20FE07P4-PE	20	3/4	N/A	N/A	7
94752015	20FE1P4-PE	20	1	N/A	N/A	8
94752020	20FE15P4-PE	20	1.5	N/A	N/A	10
94752025	20FE2P4-PE	20	2	N/A	N/A	11

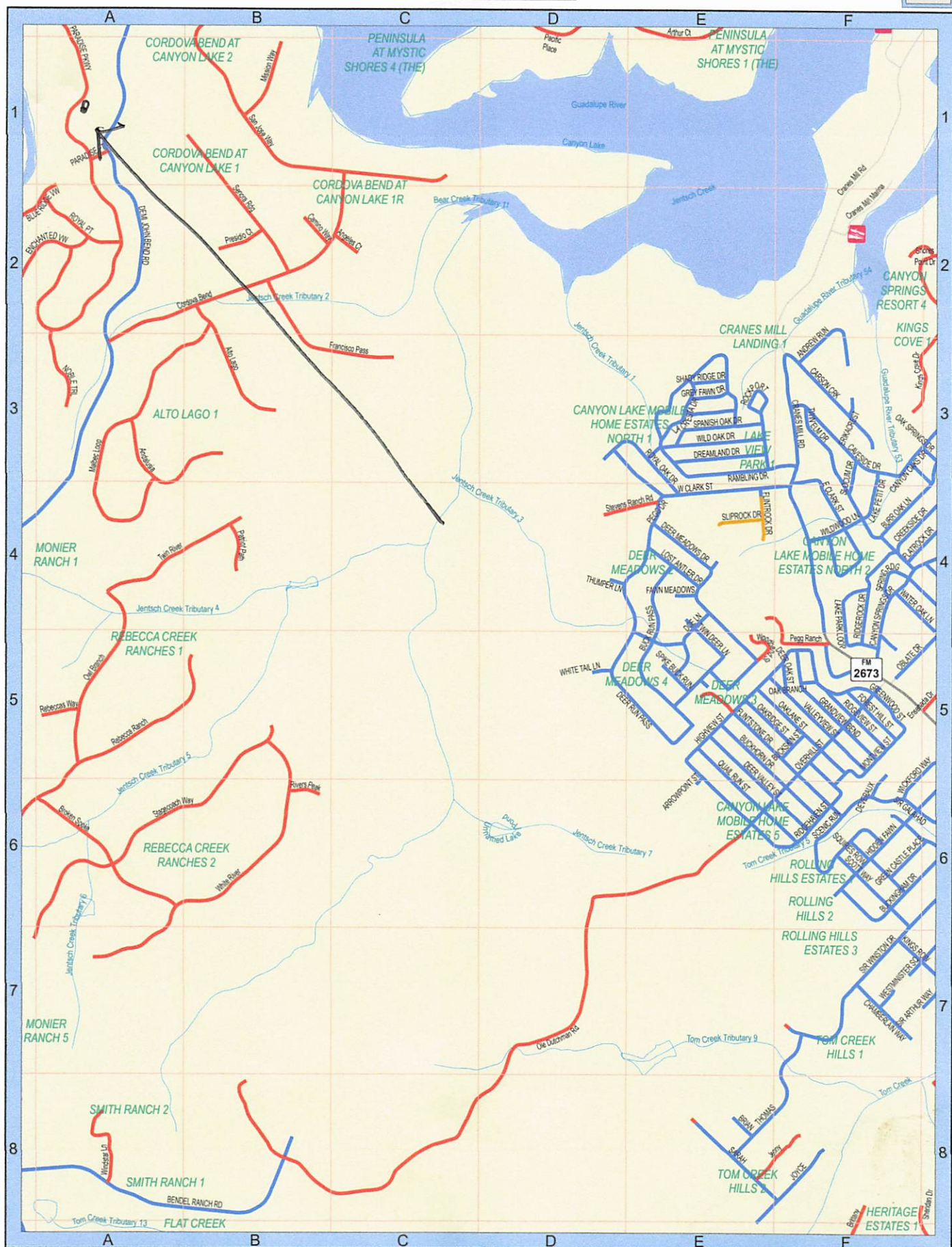

0 1,250 2,500
Feet

0 0.25 0.5
Miles

From: [Ritzen,Brenda](#)
To: ["Greg Johnson"](#)
Cc: [Robert Keltner](#)
Subject: RE: 1834 PARADISE PARKWAY - BARE - #118431
Date: Wednesday, April 30, 2025 9:47:00 AM
Attachments: [image001.png](#)

Greg,

The permit file has been updated.

Thank you,



Brenda Ritzen
Environmental Health Coordinator
195 David Jonas Dr.
New Braunfels, TX 78132
DR:OS00007722
830-608-2090
www.cceo.org

From: Greg Johnson <gregjohnsonpe@yahoo.com>
Sent: Wednesday, April 30, 2025 6:00 AM
To: Ritzen,Brenda <rabbjr@co.comal.tx.us>
Cc: Robert Keltner <rwkeltner@hotmail.com>
Subject: 1834 PARADISE PARKWAY - BARE - #118431

This email originated from outside of the organization.

Do not click links or open attachments unless you recognize the sender and know the content is safe.

- Comal IT

REVISED TANK PLACEMENT.
THX,
GREG

Send for Greg W. Johnson, P.E.,R.S.)
170 Hollow Oak
New Braunfels, TX 78132

VOID

20' UTILITY EASEMENT

LOT 72

DRIVEWAY

4 BDRM RES.
2672sf

SOLAR AIR
SA-600 - LP 778
AEROBIC
TREATMENT
PLANT

VOID

SPRAY AREA = 4825sf

X= TEST HOLES

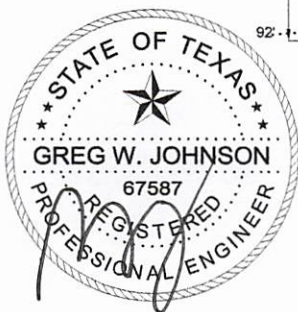

OWNER: DEBORAH WEAVER & GREGORY GENE BARE		DRAWN BY: EJS III	
STREET ADDRESS: 1834 PARADISE PARKWAY			
LEGAL DESC: PARADISE on the GUADALUPE	UNIT/SECTION/PHASE: 2	BLOCK:	LOT: 72
PREPARED BY: GREG W. JOHNSON, P.E. F#002585	SCALE: 1"=40'	DATE: 2/11/2025	REVISED:

Grantor, for the Consideration and subject to the Reservations from Conveyance and the Exceptions to Conveyance and Warranty, grants, sells, and conveys to Grantee the Property, together with all and singular the rights and appurtenances thereto in any way belonging, to have and to hold it to Grantee and Grantee's heirs, successors, and assigns forever. Grantor binds Grantor and Grantor's heirs and successors to warrant and forever defend all and singular the Property to Grantee and Grantee's heirs, successors, and assigns against every person whomsoever lawfully claiming or to claim the same or any part thereof when the claim is by, through, or under Grantor but not otherwise, except as to the Reservations from Conveyance and the Exceptions to Conveyance and Warranty.

When the context requires, singular nouns and pronouns include the plural.

PARADISE I ON THE GUADALUPE, LLC
a Texas limited liability company

By: [Signature]
Printed Name: Harry Ben Adams Jr
Title: Vice President

THE STATE OF TEXAS *
COUNTY OF BEXAR *

This instrument was acknowledged before me on this 15th day of June, 2022 by Harry Ben Adams Jr Vice President of PARADISE I ON THE GUADALUPE, LLC, a Texas limited liability company, in the capacity therein stated on behalf of said company.

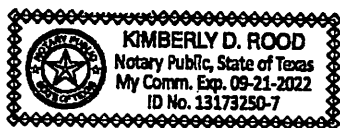

[Signature]
NOTARY PUBLIC, STATE OF TEXAS

AFTER RECORDING RETURN TO:

Seguin Title Company
GF No. 029722SMT
SAN MARCOS

PREPARED IN THE LAW OFFICE OF:

Kristen Quinney Porter
P.O. Box 312643
New Braunfels, Texas 78131-2643

Filed and Recorded
Official Public Records
Bobbie Koepp, County Clerk
Comal County, Texas
06/16/2022 01:38:41 PM
CASHONE 2 Pages(s)
202206028091



Bobbie Koepp



COMAL COUNTY

ENGINEER'S OFFICE

OSSF DEVELOPMENT APPLICATION CHECKLIST

Staff will complete shaded items

--	--

Date Received

Initials

118431

Permit Number

Instructions:

Place a check mark next to all items that apply. For items that do not apply, place "N/A". This OSSF Development Application Checklist **must** accompany the completed application.

OSSF Permit

- ☒ Completed Application for Permit for Authorization to Construct an On-Site Sewage Facility and License to Operate
- ☒ Site/Soil Evaluation Completed by a Certified Site Evaluator or a Professional Engineer
- ☒ Planning Materials of the OSSF as Required by the TCEQ Rules for OSSF Chapter 285. Planning Materials shall consist of a scaled design and all system specifications.
- ☒ Required Permit Fee - See Attached Fee Schedule
- ☒ Copy of Recorded Deed
- ☒ Surface Application/Aerobic Treatment System
 - ☒ Recorded Certification of OSSF Requiring Maintenance/Affidavit to the Public
 - ☒ Signed Maintenance Contract with Effective Date as Issuance of License to Operate

I affirm that I have provided all information required for my OSSF Development Application and that this application constitutes a completed OSSF Development Application.

Signature of Applicant

02/27/2025

Date

___ COMPLETE APPLICATION

Check No. _____ Receipt No. _____

INCOMPLETE APPLICATION

___ (Missing Items Circled, Application Refused)