

Comal County Environmental Health

OSSF Inspection Sheet

Installer Name: _____

OSSF Installer #: _____

1st Inspection Date: _____

2nd Inspection Date: _____

3rd Inspection Date: _____

Inspector Name: _____

Inspector Name: _____

Inspector Name: _____

Permit#:

Address:

No.	Description	Answer	Citations	Notes	1st Insp.	2nd Insp.	3rd Insp.
1	SITE AND SOIL CONDITIONS & SETBACK DISTANCES Site and Soil Conditions Consistent with Submitted Planning Materials		285.31(a) 285.30(b)(1)(A)(iv) 285.30(b)(1)(A)(v) 285.30(b)(1)(A)(iii) 285.30(b)(1)(A)(ii) 285.30(b)(1)(A)(i)				
2	SITE AND SOIL CONDITIONS & SETBACK DISTANCES Setback Distances Meet Minimum Standards		285.91(10) 285.30(b)(4) 285.31(d)				
3	SEWER PIPE Proper Type Pipe from Structure to Disposal System (Cast Iron, Ductile Iron, Sch. 40, SDR 26)		285.32(a)(1)				
4	SEWER PIPE Slope from the Sewer to the Tank at least 1/8 Inch Per Foot		285.32(a)(3)				
5	SEWER PIPE Two Way Sanitary - Type Cleanout Properly Installed (Add. C/O Every 100' &/or 90 degree bends)		285.32(a)(5)				
6	PRETREATMENT Installed (if required) TCEQ Approved List PRETREATMENT Septic Tank(s) Meet Minimum Requirements		285.32(b)(1)(G) 285.32(b)(1)(E)(iii) 285.32(b)(1)(E)(iv) 285.32(b)(1)(F) 285.32(b)(1)(B) 285.32(b)(1)(C)(i) 285.32(b)(1)(C)(ii) 285.32(b)(1)(D) 285.32(b)(1)(E) 285.32(b)(1)(A) 285.32(b)(1)(E)(ii)(II) 285.32(b)(1)(E)(i) 285.32(b)(1)(E)(ii)(I)				
7	PRETREATMENT Grease Interceptors if required for commercial		285.34(d)				

Inspector Notes:

**Comal County Environmental Health
OSSF Inspection Sheet**

No.	Description	Answer	Citations	Notes	1st Insp.	2nd Insp.	3rd Insp.
8	SEPTIC TANK Tank(s) Clearly Marked SEPTIC TANK If Single Tank, 2 Compartments Provided with Baffle SEPTIC TANK Inlet Flowline Greater than 3" and " T " Provided on Inlet and Outlet SEPTIC TANK Septic Tank(s) Meet Minimum Requirements		285.32(b)(1) (E) 285.91(2) 285.32(b)(1) (F) 285.32(b)(1)(E) (iii) 285.32(b)(1)(E)(ii) (II) 285.32(b)(1)(E)(ii) (I) 285.32(b)(1)(E) (i) 285.32(b)(1) (D) 285.32(b)(1)(C) (ii) 285.32(b)(1)(C) (i) 285.32(b)(1) (B) 285.32(b)(1) (A) 285.32(b)(1)(E)(iv)				
9	ALL TANKS Installed on 4" Sand Cushion/ Proper Backfill Used		285.32(b)(1)(F) 285.32(b)(1)(G) 285.34(b)				
10	SEPTIC TANK Inspection / Clean Out Port & Risers Provided on Tanks Buried Greater than 12" Sealed and Capped		285.38(d)				
11	SEPTIC TANK Secondary restraint system provided SEPTIC TANK Riser permanently fastened to lid or cast into tank SEPTIC TANK Riser cap protected against unauthorized intrusions		285.38(d) 285.38(e)				
12	SEPTIC TANK Tank Volume Installed						
13	PUMP TANK Volume Installed						
14	AEROBIC TREATMENT UNIT Size Installed						
15	AEROBIC TREATMENT UNIT Manufacturer AEROBIC TREATMENT UNIT Model Number						
16	DISPOSAL SYSTEM Absorptive		285.33(a)(4) 285.33(a)(1) 285.33(a)(2) 285.33(a)(3)				
17	DISPOSAL SYSTEM Leaching Chamber		285.33(a)(1) 285.33(a)(3) 285.33(a)(4) 285.33(a)(2)				
18	DISPOSAL SYSTEM Evapo-transpirative		285.33(a)(3) 285.33(a)(4) 285.33(a)(1) 285.33(a)(2)				

**Comal County Environmental Health
OSSF Inspection Sheet**

No.	Description	Answer	Citations	Notes	1st Insp.	2nd Insp.	3rd Insp.
19	DISPOSAL SYSTEM Drip Irrigation		285.33(c)(3)(A)-(F)				
20	DISPOSAL SYSTEM Soil Substitution		285.33(d)(4)				
21	DISPOSAL SYSTEM Pumped Effluent		285.33(a)(4) 285.33(a)(3) 285.33(a)(1) 285.33(a)(2)				
22	DISPOSAL SYSTEM Gravelless Pipe		285.33(a)(3) 285.33(a)(2) 285.33(a)(4) 285.33(a)(1)				
23	DISPOSAL SYSTEM Mound		285.33(a)(3) 285.33(a)(1) 285.33(a)(2) 285.33(a)(4)				
24	DISPOSAL SYSTEM Other (describe) (Approved Design)		285.33(d)(6) 285.33(c)(4)				
25	DRAINFIELD Absorptive Drainline 3" PVC or 4" PVC						
26	DRAINFIELD Area Installed						
27	DRAINFIELD Level to within 1 inch per 25 feet and within 3 inches over entire excavation		285.33(b)(1)(A)(v)				
28	DRAINFIELD Excavation Width DRAINFIELD Excavation Depth DRAINFIELD Excavation Separation DRAINFIELD Depth of Porous Media DRAINFIELD Type of Porous Media						
29	DRAINFIELD Pipe and Gravel - Geotextile Fabric in Place		285.33(b)(1)(E)				
30	DRAINFIELD Leaching Chambers DRAINFIELD Chambers - Open End Plates w/Splash Plate, Inspection Port & Closed End Plates in Place (per manufacturers spec.)		285.33(c)(2)				
31	LOW PRESSURE DISPOSAL SYSTEM Adequate Trench Length & Width, and Adequate Separation Distance between Trenches		285.33(d)(1)(C)(i)				



COMAL COUNTY

ENGINEER'S OFFICE

Permit of Authorization to Construct an On-Site Sewage Facility Permit Valid For One Year From Date Issued

Permit Number: 118715
Issued This Date: 06/26/2025
This permit is hereby given to: RHONA JEAN NOLEN

To start construction of a private, on-site sewage facility located at:

1529 LONESOME
CANYON LAKE, TX 78133

Subdivision: CANYON LAKE ACRES
Unit: 2
Lot: 393
Block: 0
Acreage: 0.3000

APPROVED MINIMUM SIZES AS PER ATTACHED DESIGN

Type of System: Septic Tank
Leaching Chambers

This permit gives permission for the construction of the above referenced on-site facility to commence. Installation must be completed by an installer holding a valid registration card from the Texas Commission on Environmental Quality (TCEQ). Installation and inspection must comply with current TCEQ and Comal County requirements.

Call (830) 608-2090 to schedule inspections.



ON-SITE SEWAGE FACILITY APPLICATION

195 DAVID JONAS DR
NEW BRAUNFELS, TX 78132
(830) 608-2090
WWW.CCEO.ORG

Date May 4, 2025

Permit Number 118715

1. APPLICANT / AGENT INFORMATION

Owner Name	RHONDA JEAN NOLEN
Mailing Address	1529 LONESOME
City, State, Zip	CANYON LAKE TEXAS 78133
Phone #	210-219-4242
Email	rjblueeyes2002@yahoo.com

Agent Name	GREG JOHNSON, P.E.
Agent Address	170 HOLLOW OAK
City, State, Zip	NEW BRAUNFELS TEXAS 78132
Phone #	830-905-2778
Email	gregjohnsonpe@yahoo.com

2. LOCATION

Subdivision Name	CANYON LAKE ACRES	Unit	2	Lot	393	Block	
Survey Name / Abstract Number				Acreage			
Address	1529 LONESOME	City	CANYON LAKE	State	TX	Zip	78133

3. TYPE OF DEVELOPMENT

☒ Single Family ResidentialType of Construction (House, Mobile, RV, Etc.) EXISTING HOUSE

Number of Bedrooms	2
--------------------	---

Indicate Sq Ft of Living Area 896

☐ Non-Single Family Residential

(Planning materials must show adequate land area for doubling the required land needed for treatment units and disposal area)

Type of Facility

Offices, Factories, Churches, Schools, Parks, Etc. - Indicate Number Of Occupants

Restaurants, Lounges, Theaters - Indicate Number of Seats

Hotel, Motel, Hospital, Nursing Home - Indicate Number of Beds

Travel Trailer/RV Parks - Indicate Number of Spaces

Miscellaneous

Estimated Cost of Construction: \$ EXISTING (Structure Only)

Is any portion of the proposed OSSF located in the United States Army Corps of Engineers (USACE) flowage easement?

☐ Yes ☒ No (If yes, owner must provide approval from USACE for proposed OSSF improvements within the USACE flowage easement)

Source of Water ☒ Public ☐ Private Well ☐ Rainwater Collection

4. SIGNATURE OF OWNER

By signing this application, I certify that:

- The completed application and all additional information submitted does not contain any false information and does not conceal any material facts. I certify that I am the property owner or I possess the appropriate land rights necessary to make the permitted improvements on said property.

- Authorization is hereby given to the permitting authority and designated agents to enter upon the above described property for the purpose of site/soil evaluation and inspection of private sewage facilities..

4. I understand that a permit of authorization to construct will not be issued until the Floodplain Administrator has performed the reviews required by the Comal County Flood Damage Prevention Order.

- I affirmatively consent to the online posting/public release of my e-mail address associated with this permit application, as applicable.

Signature of Owner

Date _____



COMAL COUNTY
ENGINEER'S OFFICE

ON-SITE SEWAGE FACILITY APPLICATION

CANYON LAKE ACRES, UNIT 2, LOT 393

195 DAVID JONAS DR
NEW BRAUNFELS, TX 78132
(830) 608-2090
WWW.CCEO.ORG

Planning Materials & Site Evaluation as Required Completed By GREG W. JOHNSON, P.E.

System Description PROPRIETARY; SEPTIC TANK AND LEACHING CHAMBERS

Size of Septic System Required Based on Planning Materials & Soil Evaluation

Tank Size(s) (Gallons) 750 GAL. DUAL COMP. SEPTIC TANK (#83855) Absorption/Application Area (Sq Ft) 702

Gallons Per Day (As Per TCEQ Table 111) 180

(Sites generating more than 5000 gallons per day are required to obtain a permit through TCEQ.)

Is the property located over the Edwards Recharge Zone? ☐ Yes ☒ No

(if yes, the planning materials must be completed by a Registered Sanitarian (R.S.) or Professional Engineer (P.E.))

Is there an existing TCEQ approved WPAP for the property? ☐ Yes ☒ No

(if yes, the R.S. or P.E. shall certify that the OSSF design complies with all provisions of the existing WPAP.)

Is there at least one acre per single family dwelling as per 285.40(c)(1)? ☐ Yes ☒ No

If there is no existing WPAP, does the proposed development activity require a TCEQ approved WPAP? ☐ Yes ☒ No

(if yes, the R.S or P.E. shall certify that the OSSF design will comply with all-provisions of the proposed WPAP. A Permit to Construct will not be issued for the proposed OSSF until the proposed WPAP has been approved by the appropriate regional office.)

Is the property located over the Edwards Contributing Zone? ☒ Yes ☐ No

Is there an existing TCEQ approval CZP for the property? ☐ Yes ☒ No

(if yes, the P.E. or R.S. shall certify that the OSSF design complies with all provisions of the existing CZP.)

If there is no existing CZP, does the proposed development activity require a TCEQ approved CZP? ☐ Yes ☒ No

(if yes, the R.S. or P.E. shall certify that the OSSF design will comply with all provisions of the proposed CZP. A Permit to Construct will not be issued for the proposed OSSF until the UP has been approved by the appropriate reg

Is this property within an incorporated city? ☐ Yes ☒ No

If yes, indicate the city: _____

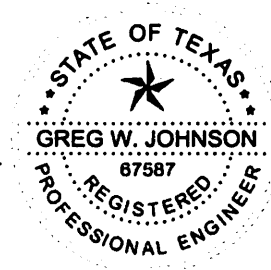

FIRM #2585

By signing this application, I certify that:

- The information provided above is true and correct to the best of my knowledge.

- I affirmatively consent to the online posting/public release of my e-mail address associated with this permit application, as applicable.



Signature of Designer

May 13, 2025

Date

ON-SITE SEWERAGE FACILITY SOIL EVALUATION REPORT INFORMATION

Date Soil Survey Performed: May 12, 2025

Site Location: CANYON LAKE ACRES, UNIT 2, LOT 393

Proposed Excavation Depth: 18" to 36"

Requirements:

At least two soil excavations must be performed on the site, at opposite ends of the proposed disposal area.
Locations of soil boring or dug pits must be shown on the site drawing.
For subsurface disposal, soil evaluations must be performed to a depth of at least two feet below the proposed excavation depth. For surface disposal, the surface horizon must be evaluated.
Describe each soil horizon and identify any restrictive features on the form. Indicate depths where features appear.

SOIL BORING NUMBER <u>1</u>						
Depth (Feet)	Texture Class	Soil Texture	Gravel Analysis	Drainage (Mottles/ Water Table)	Restrictive Horizon	Observations
0	III	CLAY LOAM				BROWN
1						
2						
3						
4						
5	III	SILTY LOAM	N/A	NONE OBSERVED	NONE OBSERVED	TAN CALICHE

SOIL BORING NUMBER <u>2</u>						
Depth (Feet)	Texture Class	Soil Texture	Gravel Analysis	Drainage (Mottles/ Water Table)	Restrictive Horizon	Observations
0	SAME		AS		ABOVE	
1						
2						
3						
4						
5						

I certify that the findings of this report are based on my field observations and are accurate to the best of my ability.

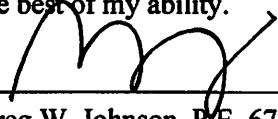
Greg W. Johnson, P.E. 67587-F2585, S.E. 11561

05/12/25
Date

FIRM #2585

INSTALL 702sf OF
FIELD USING 34 - 5'-0"
LEACHING CHAMBER
PANELS. THERE
SHALL BE NO
PARKING, DRIVING OR
STORAGE ON THE
SEPTIC FIELD AT ANY
TIME FOR ANY
REASON.

*USE TWO WAY CLEAN
OUT

**USE SCH-40 OR
SDR-26 TO TANK

X= TEST HOLE

NOTE:
EXISTING SEPTIC
FIELD TO BE
ABANDONED.

VERIFY THE
SLEEVED WATER LINE
WITH 2"-SCH-40
PVC PIPE WHEN
ENTERING CLOSER
THAN 10' FROM
SEPTIC SYSTEM OR
SEPTIC FIELD
WHICH MEETS
TAC 30 CHAPTER
290.44(e)(B)(i).

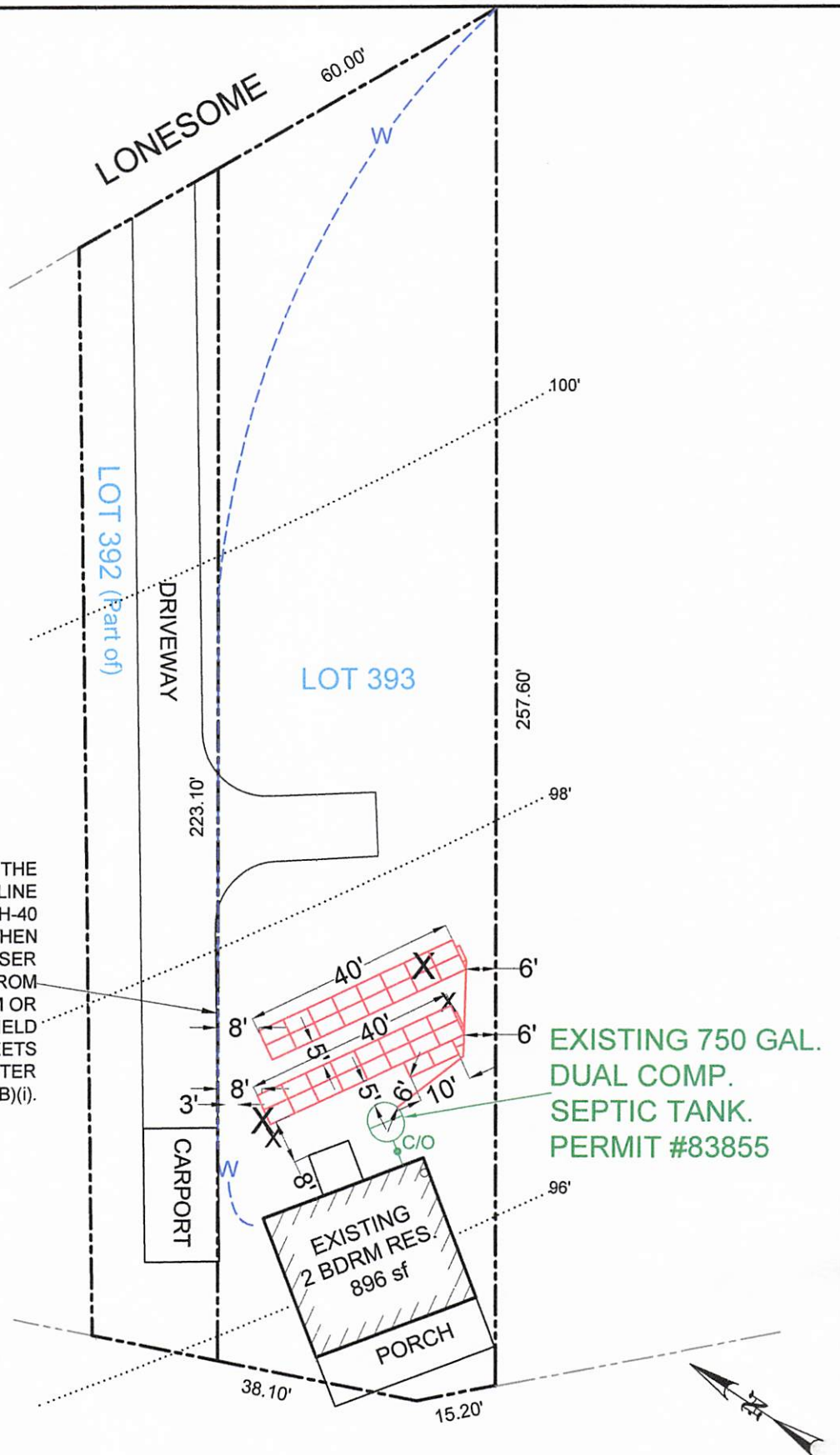

OWNER: RHONDA JEAN NOLEN		DRAWN BY: EJS III	
STREET ADDRESS: 1529 LONESOME			
LEGAL DESC: CANYON LAKE ACRES	UNIT/SECTION/PHASE: 2	BLOCK:	LOT: 393
PREPARED BY: GREG W. JOHNSON, P.E. F#002585	SCALE: 1"=30'	DATE: 5/13/2025	REVISED:

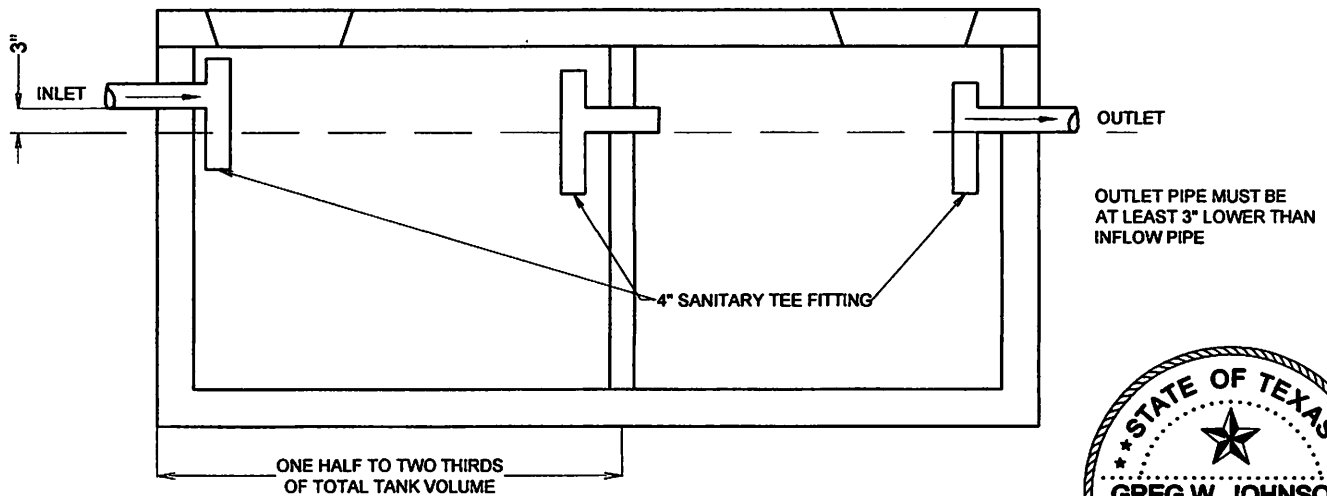

TYPICAL TWO COMPARTMENT SEPTIC TANK

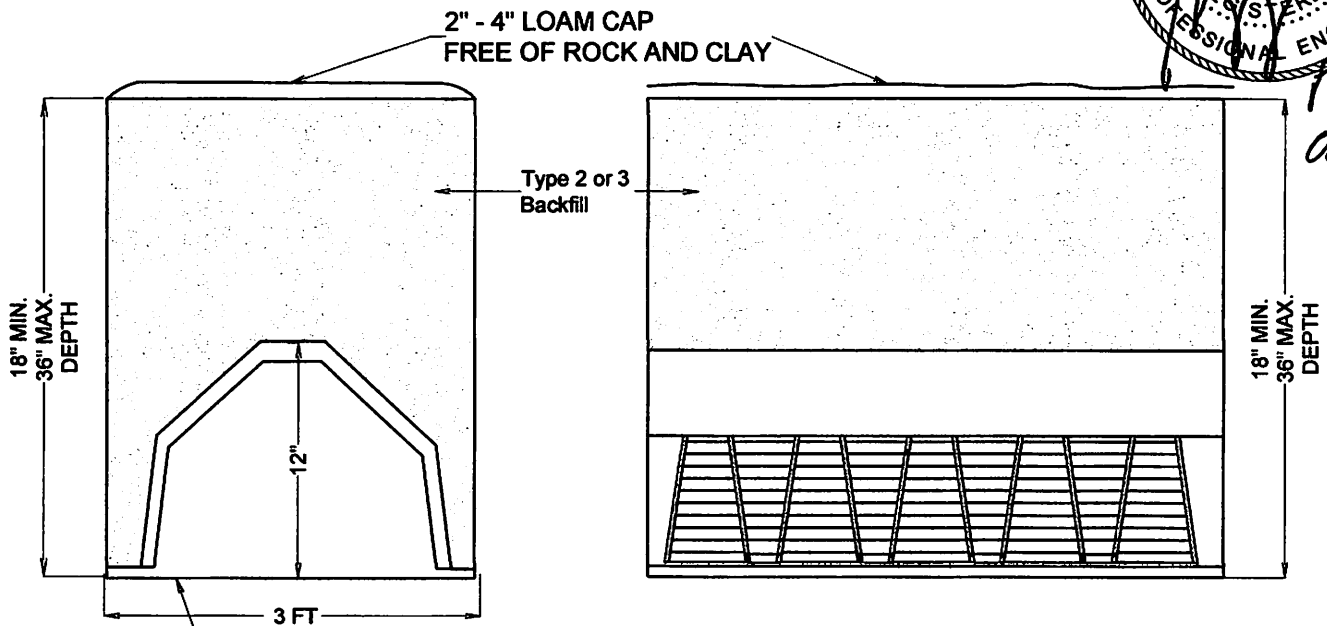
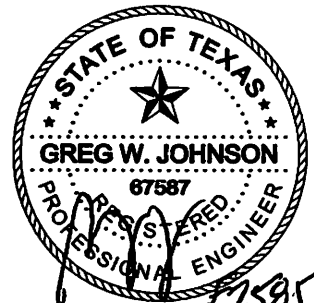

HANCOR ARC 36 LEACHING CHAMBER DETAIL

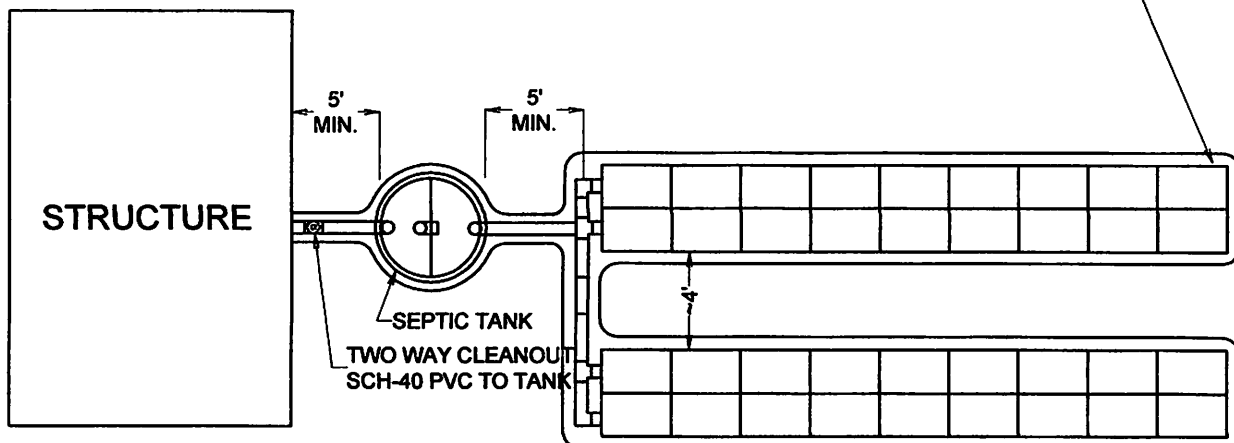

HANCOR ARC 36 LEACHING CHAMBER DETAIL

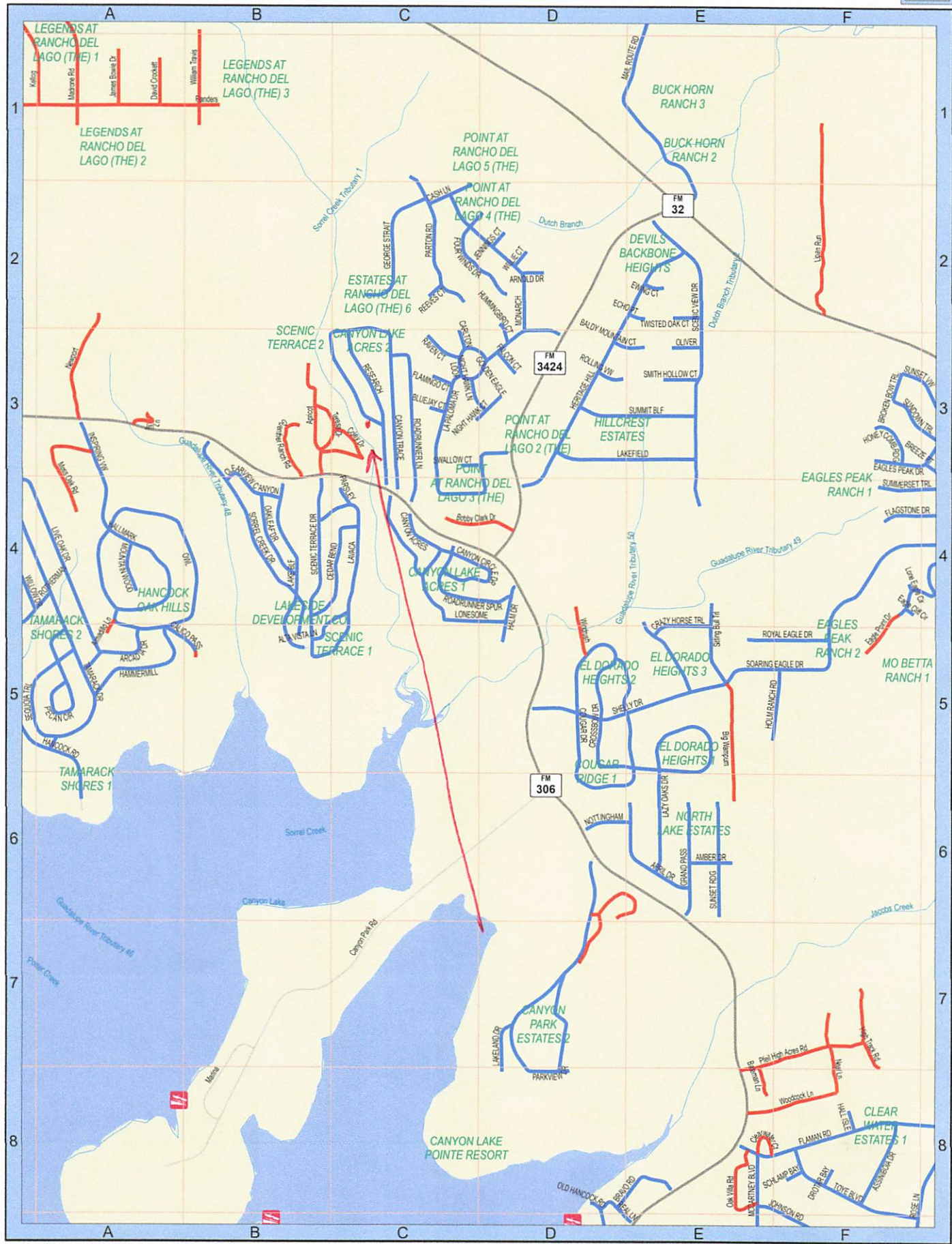

SEE PAGE 20



**CCEO
COPY**



Comal County

OFFICE OF COMAL COUNTY ENGINEER

License to Operate On-site Sewage Treatment and Disposal Facility

Date Issued: 6/18/2003

Permit Number: 83855

Location Description: 1529 Lonesome, Canyon Lake, TX 78133

Lot 393, Canyon Lake Acres Unit 2 Subdivision

Type of System: Septic Tank Treatment with Leaching Chambers Discharge

License issued to: Rhonda Nolen

This license is authorization for the owner to operate and maintain a private facility at the location described in accordance to the rules and regulations for on-site sewerage facilities of Comal County, Texas, and the Texas Natural Resource Conservation Commission.

The license grants permission to operate the facility. It does not guarantee successful operation. It is the responsibility of the owner to maintain and operate the facility in a satisfactory manner.

Inspection and licensing of a facility indicates only that the facility meets certain minimum requirements. It does not impede any governmental entity in taking the proper steps to prevent or control pollution, to abate nuisance, or to protect the public health.

This license to operate is valid for an indefinite period. The holder may transfer it to a succeeding owner, provided the facility has not been remodeled and is functioning properly.

Licensing Authority

Comal County Environmental Health

ENVIRONMENTAL HEALTH INSPECTOR OS8479

ENVIRONMENTAL HEALTH COORDINATOR OS7722

This "License-Operate" report was printed on 6/18/2003 by: Comal County Environmental Health, operator, using CASST Ver 2.1

**CCEO
COPY**

83855

LONESOME

INSTALL 675 sf OF FIELD
USING 28 STANDARD
LEACHING CHAMBER PANELS

*USE TWO WAY CLEANOUT
**USE SCH-40 OR SDR-26 TO TANK

X = TEST HOLE

RECEIVED

DEC 13 2002

COUNTY ENGINEER

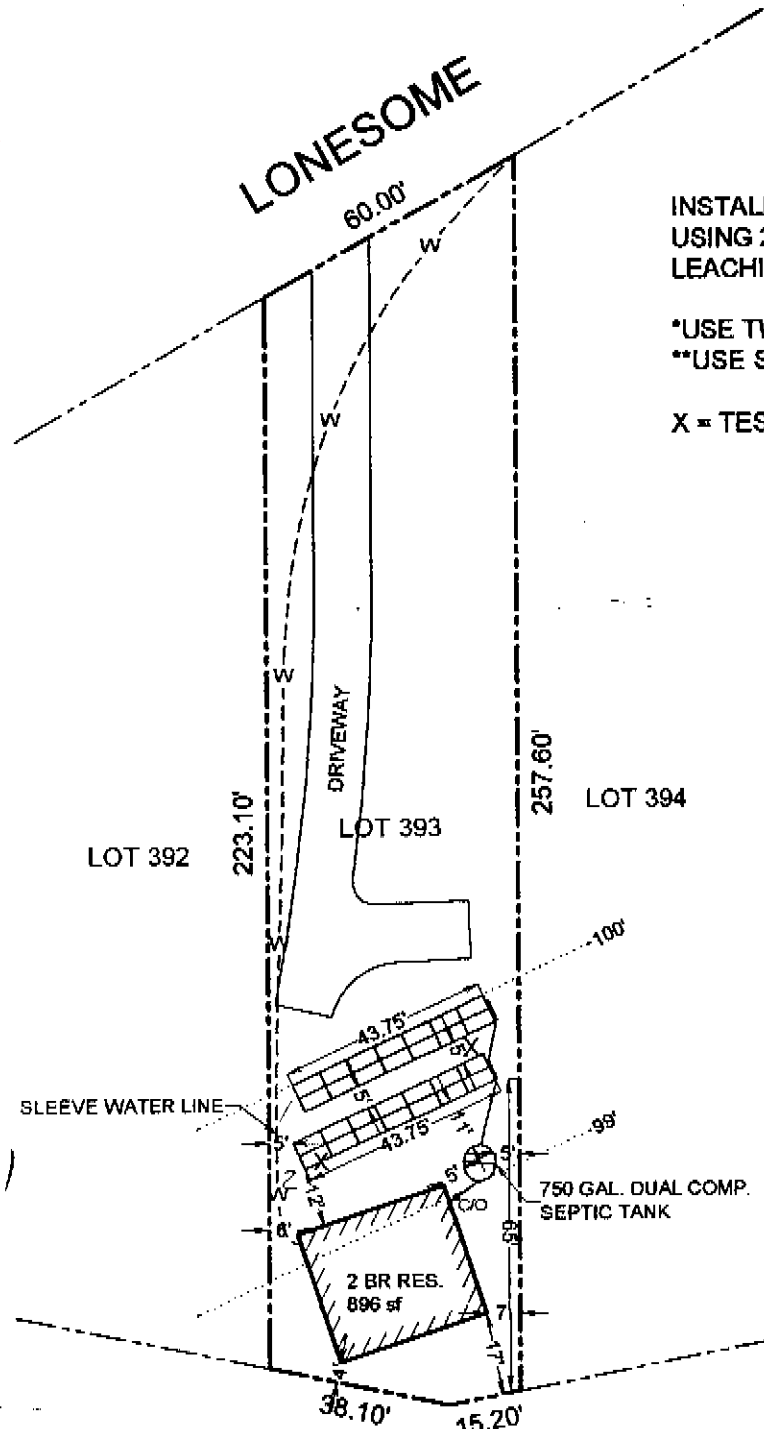

MT
51- 6/2/03
Tank set level
1) 5'9 1/4"
2) 5'9"

MT
52 6/10/03
1) 6'
2) 6'

MT
53- 6/16/03
covered, ready
for L.T.O.



OWNER: RHONDA JEAN NOLEN		DRAWN BY: CAM	
STREET ADDRESS: LONESOME			
LEGAL DESC: CANYON LAKE ACRES	UNIT/SECTION: 2	BLOCK:	LOT: 393
PREPARED BY: GREG W. JOHNSON, P.E.	SCALE: 1"=40'	DATE: 12/12/2002	REVISED:

2/c

General Warranty Deed

Date: February 27, 2002

Grantor: Philip Campbell and wife, Wanda Campbell

Grantor's Mailing Address:

Philip Campbell and wife, Wanda Campbell
22211 Buescher Road
Tomball, Texas 77375-3701
Harris County

Grantee: Rhonda Jean Nolen

Grantee's Mailing Address:

Rhonda Jean Nolen
8210 Lone Deer Run
Austin, Texas 78737
Travis County

Consideration:

TEN AND NO/100 DOLLARS (\$10.00) and other good and valuable consideration.

Property (including any improvements):

Lot No. 393, CANYON LAKE ACRES, UNIT NO. 2, according to map or plat recorded in Volume 1, Page 50, Plat Record of Comal County, Texas.

Reservations from Conveyance:

None

Exceptions to Conveyance and Warranty:

Liens described as part of the Consideration and any other liens described in this deed as being either assumed or subject to which title is taken; validly existing easements, rights-of-way, and prescriptive rights, whether of record or not; all presently recorded and validly existing instruments, other than conveyances of the surface fee estate, that affect the Property; and taxes for 2002, which Grantee assumes and agrees to pay, and subsequent assessments for that and prior years due to change in land usage, ownership, or both, the payment of which Grantee assumes.

Grantor, for the Consideration and subject to the Reservations from Conveyance

the Property, together with all and singular the rights and appurtenances thereto in any way belonging, to have and to hold it to Grantee and Grantee's heirs, successors, and assigns forever. Grantor binds Grantor and Grantor's heirs and successors to warrant and forever defend all and singular the Property to Grantee and Grantee's heirs, successors, and assigns against every person whomsoever lawfully claiming or to claim the same or any part thereof, except as to the Reservations from Conveyance and the Exceptions to Conveyance and Warranty.

When the context requires, singular nouns and pronouns include the plural.

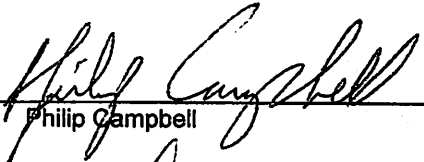

Philip Campbell



Wanda Campbell

STATE OF TEXAS)

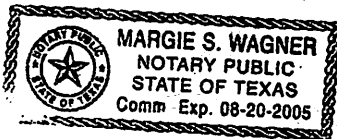
COUNTY OF HARRIS)

This instrument was acknowledged before me on March 6, 2002,
by Philip Campbell and wife, Wanda Campbell.

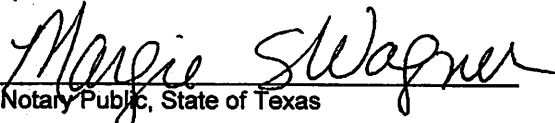

Notary Public, State of Texas

PREPARED IN THE OFFICE OF:

Law Office of Dwain W. Blaschke
P.O. Box 1744
Canyon Lake, TX 78130-1744
Tel: (830) 964-4442
Fax: (830) 964-4426

AFTER RECORDING RETURN TO:

Rhonda Jean Nolen
8210 Lone Deer Run
Austin, Texas 78737

Doc# 200206009245
Pages 2
03/18/2002 03:40:26 PM
Filed & Recorded in
Official Records of
COAH COUNTY
JOY STREATER
COUNTY CLERK
Fees \$11.00

Doc# 200206009245



COMAL COUNTY
ENGINEER'S OFFICE

**OSSF DEVELOPMENT APPLICATION
CHECKLIST**

Staff will complete shaded items

		118715
<i>Date Received</i>	<i>Initials</i>	<i>Permit Number</i>

Instructions:

Place a check mark next to all items that apply. For items that do not apply, place "N/A". This OSSF Development Application Checklist **must** accompany the completed application.

OSSF Permit

- ☒ Completed Application for Permit for Authorization to Construct an On-Site Sewage Facility and License to Operate
- ☒ Site/Soil Evaluation Completed by a Certified Site Evaluator or a Professional Engineer
- ☒ Planning Materials of the OSSF as Required by the TCEQ Rules for OSSF Chapter 285. Planning Materials shall consist of a scaled design and all system specifications.
- ☒ Required Permit Fee - See Attached Fee Schedule
- ☒ Copy of Recorded Deed
- ☒ Surface Application/Aerobic Treatment System

Recorded Certification of OSSF Requiring Maintenance/Affidavit to the Public

Signed Maintenance Contract with Effective Date as Issuance of License to Operate

I affirm that I have provided all information required for my OSSF Development Application and that this application constitutes a completed OSSF Development Application.

Signature of Applicant

06/04/2025

Date

___ COMPLETE APPLICATION	
Check No. _____	Receipt No. _____

INCOMPLETE APPLICATION ____ (Missing Items Circled, Application Refused)
